

BID NO. 26-702

BIDDING DOCUMENT

LAKE COUNTY
FLORIDA

INSTRUCTIONS TO BIDDERS, GENERAL CONDITIONS,
SPECIAL PROVISIONS AND TECHNICAL SPECIFICATIONS,
BID FORM, CONTRACT FORM, CONTRACT BOND FORM

FOR

NORTH LAKE TRAIL – EAST COLLINS STREET TO BEACH STREET
PROJECT NO. 2026-01, BID NO. 26-702

ROADWAY CONSTRUCTION

Plans Prepared by: Arlene I. Morales, Stantec Consulting Services, Inc.

Design Division Contact: Jeffrey Earhart, P.E., Lake County Public Works

NOTE: Attach Your Bid Bond or Letter of Credit to This Document. All Extensions Must Be Carried Out. Any Changes Made in Unit Bid Prices Must Be Initialed by Bidder.

This Notice to be issued if a Pre Bid Conference is to be held.

NON-MANDATORY PRE-BID CONFERENCE NOTICE

BID NO. 26-702

NORTH LAKE TRAIL – EAST COLLINS STREET TO BEACH STREET
PROJECT NO. 2026-01

In Lake County, Florida

Non-Mandatory Pre-Bid Conference

THE ATTENTION OF PROSPECTIVE BIDDERS IS DIRECTED TO THE NON-MANDATORY
PRE-BID CONFERENCE TO BE CONDUCTED AT THE DATE, TIME AND PLACE INDICATED
BELOW:

DATE: November 13, 2025

TIME: 9:00 a.m.

INTERESTED PARTIES CAN ATTEND VIA A TELECONFERENCE MEETING BY DIALING
(321) 332-7400 AND ENTERING CONFERENCE NO. 584 445 58#

The County will point out specific job conditions which are difficult to describe or show on the Drawings. Questions that require additional clarification will be covered by an addendum which will be issued following the Non-Mandatory Pre-bid conference.

CONTRACT DOCUMENTS

CONTENTS

DIVISION A **INSTRUCTIONS TO BIDDERS**

| | | |
|-----|--|------|
| 1. | Definitions..... | A-1 |
| 2. | Bids..... | A-3 |
| 3. | Bid Guarantee | A-4 |
| 4. | Pre-Qualification of Contractor | A-4 |
| 5. | Contract Security | A-4 |
| 6. | Interpretations Prior to Bid Opening | A-5 |
| 7. | Licenses, Permits, Fees and Taxes | A-5 |
| | A. Acquisition of Permits and Licenses..... | A-5 |
| | B. Payment of Fees and Taxes..... | A-6 |
| | C. Reimbursements to the Contractor..... | A-6 |
| | D. Compliance with Permit and License Requirement..... | A-6 |
| 8. | Compliance with Laws..... | A-6 |
| 9. | Certification Regarding Scrutinized Companies | A-7 |
| 10. | Insurance | A-7 |
| 11. | Quantities | A-9 |
| 12. | Quantities Reflected in Permitting Documents | A-10 |
| 13. | Arithmetic Discrepancies in Bids..... | A-10 |
| 14. | Award of Contract..... | A-10 |
| 15. | Notice to Proceed to Contractor | A-10 |
| 16. | Indemnification | A-10 |
| 17. | Contract Documents | A-10 |

DIVISION B **GENERAL CONDITIONS**

| | | |
|-----|--|------|
| 1. | Intent of Contract Documents..... | B-1 |
| 2. | Storage of Materials..... | B-1 |
| 3. | Sanitation | B-1 |
| 4. | Maintenance of Construction Site | B-2 |
| 5. | Errors and Omissions | B-2 |
| 6. | Contractors Obligations | B-3 |
| | A. Qualification..... | B-3 |
| | B. Identification..... | B-3 |
| | C. Contractor's Supervision..... | B-3 |
| | D. General Inspection Requirement..... | B-5 |
| 7. | Authority of the Engineer & Engineer's Assistants | B-6 |
| 8. | Contract Time and Time Extensions | B-8 |
| 9. | Prosecution of Work on Saturdays, Sundays and Recognized Holidays..... | B-9 |
| 10. | Liquidated Damages | B-9 |
| 11. | Changes in the Work..... | B-10 |
| 12. | Claims and Disputes..... | B-11 |
| 13. | Measurement and Payment | B-12 |
| 14. | Payments to Contractor..... | B-13 |
| 15. | Substantial Completion/Punchlist..... | B-14 |
| 16. | Acceptance and Final Payment..... | B-14 |
| | A. Final Inspection..... | B-14 |

| | | |
|---|--|-------------|
| | B. Maintenance of Work..... | B-15 |
| | C. Final Acceptance | B-15 |
| | D. Waiver of Claims | B-15 |
| | E. Termination of Contractor's Responsibility | B-15 |
| | F. Recovery Rights, Subsequent to Final Payment | B-16 |
| 17. | Covenant Against Contingent Fees..... | B-16 |
| 18. | Lands for Work and Access Thereto..... | B-16 |
| 19. | Excavated Material and Fill Material | B-17 |
| 20. | Site Investigation | B-17 |
| 21. | Protection of Existing Structures, Utilities, Work and Vegetation..... | B-18 |
| 22. | Other Work | B-19 |
| 23. | Termination..... | B-20 |
| | A. Termination for Default..... | B-20 |
| | B. Termination for Convenience and Right of Suspension..... | B-21 |
| 24. | Submittals | B-21 |
| | A. Schedule | B-21 |
| | B. Shop Drawings/Working Drawings | B-22 |
| | C. Material Safety Data Sheets Requirement..... | B-23 |
| | D. Materials | B-23 |
| 25. | Right to Audit..... | B-24 |
| 26. | Interest on Judgments | B-24 |
| 27. | Drainage and Erosion Control..... | B-24 |
| 28. | Standard Specifications..... | B-24 |
| 29. | Priority..... | B-25 |
| 30. | Survey and Layout | B-25 |
| 31. | Laboratory Testing..... | B-26 |
| 32. | Conformity of Work with Plans | B-26 |
| 33. | Guarantee | B-27 |
| 34. | Warranty..... | B-27 |
| 35. | Public Records | B-27 |
| DIVISION J TESTING AND SAMPLING SCHEDULE..... | | J-1 |
| DIVISION P PERMITS..... | | P-1 |
| DIVISION W BID FORM | | |
| | Bid | W-1 |
| | Florida Trench Safety Act..... | W-10 |
| DIVISION X AGREEMENT | | X-1 |
| DIVISION Y BONDS | | |
| | Performance Bond | Y-1 |
| | Payment Bond | Y-4 |
| DIVISION Z AFFIDAVIT AND GUARANTEE BY GENERAL CONTRACTOR | | Z-1 |
| APPENDIX A1 SAMPLE CHANGE ORDER | | A1-1 |

DIVISION A

INSTRUCTIONS TO BIDDERS

LAKE COUNTY TRANSPORTATION CONSTRUCTION PROGRAM

1. DEFINITIONS

Whenever the following terms, or pronouns used in place of them, are used in these Contract Documents, they shall have the meanings given below:

Addendum – A modification, revision or clarification of the Plans or other Contract Documents, issued by the Engineer and distributed to prospective bidders before the opening of bids.

Board of County Commissioners – Governing body of Lake County, hereinafter referred to as the Board.

Calendar Day – Every day shown on the calendar, ending and beginning at Midnight.

Change Order – A written order issued by the Engineer in accordance with Board policy, and accepted by the Contractor directing certain changes, additions or reductions in the work or in the materials used.

Consultant – The Professional Engineer or Engineering Firm registered in the State of Florida who performs Professional Engineering Services for the County, other than County personnel. The Consultant may be the Engineer of Record or may provide services through and be subcontracted to the Engineer of Record.

Contingency – A pay item included for usage as directed by the Engineer and for usage under conditions or circumstances unforeseen at the time of contract.

Contractor – The General Contractor, the Individual, Partnership or Corporation bidding or agreeing to do the work for the Owner as Prime Contractor.

Contract Documents – All documents referred to in Division X in addition to all duly executed and issued addenda, legal advertisements and change orders.

County/Owner – Lake, County, Florida, a political subdivision of the State of Florida.

Engineer – The County Senior Director of Public Works or his duly authorized representative, acting on behalf of the County.

Engineer of Record – The Professional Engineer or Engineering Firm contracted with by the County and registered in the State of Florida who develops criteria and concept for the project, performs the analysis and is responsible for the preparation of the Contract Plans and Specifications. The Engineer of Record may be County in-house staff or a Consultant retained by the County.

FDOT – The Florida Department of Transportation.

ID – Inside diameter, or dimension.

Inspector – An authorized representative of the Engineer, assigned to make any or all necessary inspections of the work performed and materials furnished by the Contractor.

LCPWD – The Lake County Public Works Department.

Plans – The approved drawings or reproductions thereof, that show the location, character, dimension and details of the work to be done as issued by the Engineer.

Regular Work Day – Any calendar day except a Saturday, Sunday or recognized Holiday.

Scope of Work – The general intent of the work to be accomplished as defined by the project plans and specifications.

Schedule of Values – The individual values as set forth by the Contractor as payment for the bid quantity units identified on the bid sheets. The total of the extended units in the schedule of values determines the contract limit. This contract limit amount may only be modified by change order approved in accordance with Board policy.

Special Provisions – Specific clauses adding to or revising the Standard Specifications, setting forth conditions varying from or additional to the Standard Specifications, for a specific project.

Specifications – The directions, provisions and requirements contained herein, together with all stipulations contained in the plans or in the Contract Documents, setting out or relating to the method and manner of performing the work, or to the quantities and qualities of materials and labor to be furnished under the contract.

Standard Specifications – FDOT "STANDARD SPECIFICATIONS FOR ROAD AND BRIDGE CONSTRUCTION," JULY, 2025, or 2025 FDOT DESIGN MANUAL (FDM) (or latest edition), and all supplemental specifications thereto, or otherwise depicted on the construction plans.

Technical Special Provisions – Specifications prepared, signed and sealed by an Engineer registered in the State of Florida other than the State Specifications Engineer, or his designee, which are made part of the Contract as an attachment to the Specifications Package.

Work – All labor, materials and incidentals required for the construction of the improvement for which the contract is made, including superintendence, use of equipment and tools, and all services and responsibilities prescribed or implied, which are necessary for the complete performance by the Contractor of his obligations under the contract. Unless otherwise specified herein or in the Contract, all costs of liability and of performing the work shall be at the Contractor's expense.

2. BIDS

- A. Sealed bids will be received by the Office of Procurement Services, on behalf of the Lake County Board of County Commissioners, until 3:00 p.m. on December 11, 2025, for the furnishing of all services, labor, materials and equipment for the construction of the following project:

BID NO. 26-702

NORTH LAKE TRAIL – EAST COLLINS STREET TO BEACH STREET
PROJECT NO. 2026-01

- B. This project is located in North Lake County, in the City of Umatilla and shall consist of constructing a multi-use trail along SR 19. Contractors shall bid to construct the multi-use trail from Station 12+00 to Station 42+50 as the base bid. Between Station 12+00 and 12+60 Lake County will connect to Hatfield Drive instead of the proposed connection to E. Collins Street (CR 450 East) as shown in the plans. Trail construction shall consist of stabilized subgrade under the concrete as well as asphalt, limerock, asphalt, installation of Reinforced Concrete Pipe and Miter End Sections, striping, signing, cast in place detectable warning mats, 4' concrete separators, 6" concrete, sod, and other miscellaneous incidental construction.

Contractor shall also provide a cost to construct the multi-use trail from Station 42+50 to Station 58+50 as bid alternate 1.

Contractor shall also provide a cost to construct the multi-use trail from Station 58+50 to Station 74+00 as bid alternate 2.

- C. Hand delivery of submittals will not be accepted.

RESPONSES MUST BE SUBMITTED THROUGH THE SOLICITATION RESPONSE PORTAL TO BE CONSIDERED – <https://procurement.lakecountyfl.gov/login>

A response will not be accepted if completed and submitted after the official due date and time.

Interested parties may listen to the 3:01 P.M. solicitation opening by calling 1-321-332-7400, Conference ID 971 920 36# or clicking on the MICROSOFT TEAMS MEETING link in the solicitation.

- D. All bids shall be received not later than the date and time specified above, at which time they will be publicly opened and read aloud in the Office of Procurement Services, Fourth Floor, Administration Building, Room 441, 315 West Main Street, Tavares, Florida. A bid will not be considered for award if received in the Procurement Services Office after the official opening date and time regardless of when or how it was received by the Lake County Clerk of the Circuit Court Mail Receiving Center. Allow sufficient time for transportation and inspection.

- E. Bids may be withdrawn prior to the date of opening, but no bids may be withdrawn for a period of sixty (60) days after the date of opening of bids.
- F. The Board of County Commissioners reserves the right to reject any or all bids, to waive formalities, and to award the contract in the best interest of Lake County, Florida.
- G. Bids which are incomplete, unbalanced, conditional, obscure, or which contain additions not allowed for, alterations or irregularities of any kind, or which do not comply with the Contract Documents may be rejected at the option of the County.
- H. Each Bid by an individual or firm shall state the name and address of each person who owns an interest therein, and, if a corporation, the name and addresses of its officers. Bids shall be signed by the person or member of the firm making the same, and if a corporation, by an authorized officer or agent subscribing the name of the corporation, together with his own name and the corporate seal.

3. BID GUARANTEE

- A. All bids must be accompanied by a Bid Guarantee acceptable to the County Attorney, which shall be one of the following; bid bond or letter of credit, in the sum of five percent (5%) of the base bid and made payable to Lake County. Said bid bond or letter of credit shall be a guarantee that should the bid be accepted, the bidder will, within ten (10) days after written notice of the award of the contract, enter into a contract with Lake County for the services proposed to be performed and will at that time furnish an acceptable contract surety. Cash, company, certified or personal checks will not be accepted.
- B. Said instruments and the monies payable thereon, will, at the option of the County, be forfeited if the bidder fails to execute the written contract and furnish the required surety bond within ten (10) consecutive calendar days following written notice of the award of the contract.
- C. Attorneys-in-fact who sign bonds must file with such bond one (1) certified copy of their power of attorney to sign said bond.
- D. All instruments shall have been issued within thirty (30) days of the date for receiving bids.

4. PRE-QUALIFICATION OF CONTRACTOR

This is not a pre-qualification project.

5. CONTRACT SECURITY

- A. The Contractor shall provide a Performance Bond and a Payment Bond, in the form prescribed in Division Y, each in the amount of 100% of the Contract amount, the costs of which are to be paid by the Contractor. The Bonds will be acceptable to the County only if the following conditions are met:
 - 1. For contracts that do not exceed \$500,000.00, the Surety Company:

- a. is licensed to do business in the State of Florida;
 - b. holds a certificate of authority authorizing it to write surety bonds in this state;
 - c. has twice the minimum surplus and capital required by the Florida Insurance Code at the time the invitation to bid is issued;
 - d. is otherwise in compliance with the provisions of the Florida Insurance Code; and
 - e. holds a currently valid certificate of authority issued by the United States Department of Treasury under 31 U.S.C. ss 9304-9308.
2. For contracts over \$500,000.00, all of the requirements of paragraph A.1 above apply. In addition, the Surety Company must have a current rating of at least Excellent (A or A-) all as reported in the most current Best Key Rating Guide, published by A.M. Best Company, Inc., of 75 Fulton Street, New York, New York 10038, with an underwriting limitation of at least two times the dollar amount of the contract.
- B. If the Surety for any Bond furnished by the Contractor is declared bankrupt, becomes insolvent, its right to do business is terminated in the State of Florida, or it ceases to meet the requirements imposed by the Contract Documents, the Contractor shall, within five (5) calendar days thereafter, substitute another Bond and Surety, both of which shall be subject to the County's approval.
 - C. By execution of these bonds, the Surety acknowledges that it has read the Surety qualifications and Surety obligations imposed by the construction documents and hereby satisfies those conditions.

6. INTERPRETATIONS PRIOR TO BID OPENING

No oral interpretations will be made to any bidder as to the meaning of the Specifications, or any other Contract Documents. Every request for such an interpretation must be in writing, and shall be received by the Office of Procurement Services not less than ten (10) calendar days prior to the date set for opening of bids. Every interpretation made to a bidder will be made by an addendum to the Contract Documents, which, when issued, will be sent as promptly as is practicable to all persons to whom the Specifications have been issued by the County. All such addenda shall become part of the Contract Documents. No substitution of any kind or riders of any nature to the bids will be considered except by the above-described method. For purposes of this Contract the term "Interpretations" shall include the approval of product substitution.

7. LICENSES, PERMITS, FEES AND TAXES

- A. Acquisition of Permits and Licenses

1. The County has obtained all known Federal and State environmental permits required for the construction of the project.
2. The Contractor shall secure and maintain all other permits required for the construction of the Project, including building permits, National Pollution Discharge Elimination System (NPDES) Construction Permits, and permits required for tree removal or relocation.
3. The Contractor shall secure and maintain all contractor licenses required for the prosecution of the work.

B. Payment of Fees and Taxes

1. All fees associated with those permits and licenses that the Contractor is required to obtain shall be paid by the Contractor.
2. All sales, consumer, use and other similar taxes associated with the work, or portions thereof, and which are applicable during the performance of the work, shall be paid by the Contractor.
3. All fees required in connection with the Contractor's recording of bonds or other documents in the public records shall be paid by the Contractor.
4. All County permit fees shall be waived or paid by the County.

C. Reimbursements to the Contractor

1. The County will reimburse the Contractor for those fees paid for applicable permits. Reimbursement will be for the actual amount paid, as evidenced by official receipts from the offices collecting the fees. Reimbursement will not include, nor will any separate payment be made for, Contractor mark-up, "interest" or other charges claimed by the Contractor in connection with the payment of permit fees.
2. No reimbursement will be made for Contractor license fees.
3. No reimbursement will be made for fees or other charges (such as the cost of documentary stamps) required in connection with the recording of bonds or other documents in the public records.

D. Compliance with Permit and Licenses Requirements

The Contractor shall comply with all permit conditions and license requirements, applicable building and construction code requirements, and such other rules and regulations as may apply to the prosecution of the work.

8. COMPLIANCE WITH LAWS

The Contractor agrees to comply, at its own expense, with all Federal, State and Local laws, codes, statutes, ordinances, rules, regulations and requirements applicable to the project, including but not limited to those dealing with taxation, Workers' Compensation,

equal employment, safety (including, but not limited to, the Trench Safety Act, Chapter 553.60, Florida Statutes), labor, work hours, labor conditions, environment, and related matters. If the Contractor observes that the Contract Documents are at variance therewith, it shall promptly notify the Engineer in writing.

9. CERTIFICATION REGARDING SCRUTINIZED COMPANIES.

By executing this Agreement, CONTRACTOR hereby certifies that, pursuant to Section 287.135, Florida Statutes, it is not listed on the Scrutinized Companies that Boycott Israel and is not participating in a boycott of Israel. CONTRACTOR understands that pursuant to Section 287.135, Florida Statutes, the submission of a false certification may subject it to civil penalties, attorneys' fees, and costs. CONTRACTOR further understands that any contract with the County for goods or services may be terminated at the option of the County if the CONTRACTOR is found to have submitted a false certification or has been listed on the Scrutinized Companies that Boycott Israel list or is participating in a boycott of Israel.

CONTRACTOR, by entering this Agreement, hereby certifies that, pursuant to Section 287.135, Florida Statutes, it is not listed on the Scrutinized Companies with activities in the Iran Petroleum Energy Sector List, or the Scrutinized Companies with Activities in Sudan List, is not listed on the Scrutinized Companies that Boycott Israel and is not participating in a boycott of Israel, and is not engaged in business operations in Cuba or Syria. CONTRACTOR understands that pursuant to Section 287.135, Florida Statutes, the submission of a false certification may subject it to civil penalties, attorneys' fees, and costs. The CONTRACTOR further understands that any contract with the County for goods or services of \$1 million or more may be terminated at the option of the COUNTY if the CONTRACTOR is found to have submitted a false certification or has been listed on the Scrutinized Companies with activities in the Iran Petroleum Energy Sector List or the Scrutinized Companies with Activities in Sudan List, is listed on the Scrutinized Companies that Boycott Israel list or is participating in a boycott of Israel, or is engaged in business operations in Cuba or Syria."

10. INSURANCE

The contractor shall purchase and maintain, at its expense, from a company or companies authorized to do business in the State of Florida, and which are acceptable to the County, insurance policies containing the following selected types of coverage and minimum limits of liability protecting from claims which may arise out of or result from the performance or non-performance of services under this Contract by the contractor or by anyone directly or indirectly employed by it, or by anyone for whose acts it may be liable:

At time of contract, the Contractor will be required to provide a copy of all policy endorsement(s), reflecting the required coverage, with Lake County listed as an additional insured along with all required provisions to include waiver of subrogation. Contracts cannot be completed without this required insurance documentation. (Note: A simple COI WILL NOT be accepted in lieu of).

Contractor shall not commence work under the Contract until County has received an acceptable certificate or certificates of insurance evidencing the required insurance and all policy endorsement(s), reflecting the required coverage, with Lake County listed as

an additional insured, along with all required provisions to include waiver of subrogation, which is as follows:

General Liability insurance on forms no more restrictive than the latest edition of the Occurrence Form Commercial General Liability policy (CG 00 01) of the Insurance Services Office or equivalent without restrictive endorsements, with the following minimum limits and coverage:

| | |
|-----------------------------------|-----------------------|
| Each Occurrence/General Aggregate | \$1,000,000/2,000,000 |
| Products-Completed Operations | \$2,000,000 |
| Personal & Adv. Injury | \$1,000,000 |
| Fire Damage | \$50,000 |
| Medical Expense | \$5,000 |
| Contractual Liability | Included |

Automobile liability insurance, including owned, non-owned, and hired autos with the following minimum limits and coverage:

| | |
|-----------------------|-------------|
| Combined Single Limit | \$1,000,000 |
|-----------------------|-------------|

Workers' compensation insurance based on proper reporting of classification codes and payroll amounts in accordance with Chapter 440, Florida Statutes, and/or any other applicable law requiring workers' compensation (Federal, maritime, etc). If not required by law to maintain workers compensation insurance, the Contractor must provide a notarized statement that if he or she is injured, he or she will not hold the County responsible for any payment or compensation.

Employers Liability with the following minimum limits and coverage:

| | |
|-----------------------|-------------|
| Each Accident | \$1,000,000 |
| Disease-Each Employer | \$1,000,000 |
| Disease-Policy Limit | \$1,000,000 |

Railroad Protective Liability with bodily injury protection of Two Million dollars (\$2,000,000) and property damage of Two Million dollars (\$2,000,000) for any project or portion of the project which is located on Railroad property. The Railroad shall be endorsed to this policy as an additional insured.

Lake County, a Political Subdivision of the State of Florida, and the Board of County Commissioners, shall be named as additional insured as their interest may appear on all applicable policies.

Certificate(s) of insurance shall provide for a minimum of sixty (60) days prior written notice to the County of any change, cancellation, or nonrenewal of the required insurance.

Certificate(s) of insurance shall identify the contract number in the Description of Operations section of the Certificate.

Certificate of insurance shall evidence a waiver of subrogation in favor of the County, that coverage shall be primary and noncontributory, and that each evidenced policy

includes a Cross Liability or Severability of Interests provision, with no requirement of premium payment by the County.

Certificate holder shall be:

LAKE COUNTY, A POLITICAL SUBDIVISION OF THE STATE OF FLORIDA,
AND THE BOARD OF COUNTY COMMISSIONERS.
P.O. BOX 7800
TAVARES, FL 32778-7800

The County shall be exempt from, and in no way liable for, any sums of money, which may represent a deductible or self-insured retention in any insurance policy. The payment of such deductible or self-insured retention shall be the sole responsibility of the Contractor and/or subcontractor providing such insurance.

The Contractor shall be responsible for subcontractors and their insurance. Subcontractors are to provide Certificates of Insurance to the County evidencing coverage and terms in accordance with the Contractor's requirements.

Failure to obtain and maintain such insurance as set out above will be considered a breach of contract and may result in termination of the contract for default.

Neither approval by the County of any insurance supplied by the Contractor, nor a failure to disapprove that insurance, shall relieve the Contractor of full responsibility of liability, damages, and accidents as set forth herein.

The Contractor shall submit to Lake County Public Works a copy of all accident reports arising out of any injuries to its employees or those of its subcontractors, or any personal injuries or property damage arising or alleged to have arisen on account of any work under the Contract.

If it is not possible for the Contractor to certify compliance, on the certificate of insurance, with all of the above requirements, then the Contractor is required to provide a copy of the actual policy endorsements(s) providing the required coverage and notification provisions.

11. QUANTITIES

- A. Quantities, if shown on the Bid, are estimated for bidding purposes only and shall be verified by the Contractor.
- B. Payment for work performed under this contract shall be based on a lump sum bid. Bidder shall determine quantities.
- C. Regardless of uncertainties of material supply and production at the time of bidding, Contractors shall base their bids in strict accordance with items, materials and methods as set forth in the Contract Documents.
- D. Pay items may be added, or deleted, to the list of pay items by the Engineer or Contractor, that are required to complete the scope of the work as defined by the project plans and specifications.

12. QUANTITIES REFLECTED IN PERMITTING DOCUMENTS

Any construction items or quantities reflected in the permitting documents, if any, required for this project are provided only for the purpose of enabling permitting authorities to assess the probable impact of the project, and are in no way intended to reflect or represent actual construction items or quantities for pay purposes.

13. ARITHMETIC DISCREPANCIES IN BIDS

- A. For the purpose of evaluation of bids, the following criteria will be utilized in resolving discrepancies in arithmetic found on the face of the bidding schedule of values as submitted by the bidders:
1. In case of discrepancy between unit values and extended values the unit value shall take precedence.
 2. Errors in extension of unit values will be corrected by the County.
 3. Errors in addition of lump sum and extended values to determine the total bid amount will be corrected by the County.
- B. For the purposes of bid evaluation, the County will proceed on the assumption that the bidder intends his bid to be evaluated on the basis of a lump sum bid with the numerical unit values, extensions and totals arrived at by resolution of arithmetic discrepancies as provided above.

14. AWARD OF CONTRACT

The Contract will be awarded for the entire work on the Base Bid plus any accepted options to the lowest responsive and responsible bidder, provided that the bid is reasonable, and that it is in the best interest of the County to accept. Lake County reserves the right to award any and all options as part of this contract. County will provide written notice of award to the Contractor.

15. NOTICE TO PROCEED TO CONTRACTOR

After all contract documents are signed and approved, a Notice to Proceed will be issued which shall include the commencement date. The Contractor shall be required to set up a pre-construction conference before any work shall begin.

16. INDEMNIFICATION

The Contractor will agree to indemnify the County as described in Division X of the Contract documents.

17. CONTRACT DOCUMENTS

The Contractor will be furnished with one (1) original of the Contract Documents for the project. Additional copies may be purchased from the LCPWD at the price per set listed in Division A. Copies of the "Standard Specifications" may be purchased from the FDOT.

The Contractor shall have available on the job, at all times, one (1) copy of the Contract Documents.

DIVISION B

GENERAL CONDITIONS

1. INTENT OF THE CONTRACT DOCUMENTS

- A. It is the intent of the Contract Documents to describe a functionally complete project (or portion thereof) to be constructed in accordance with the Contract Documents which combine to define the Scope of Work. Any work, materials or equipment that may reasonably be inferred from the Contract Documents as being required to produce the intended result shall be supplied whether or not specifically called for. When words that have a well-known technical or trade meaning are used to describe work, materials or equipment, such words shall be interpreted in accordance with that meaning. Reference to standard specifications, manuals or codes of any technical society, organization or association or to the laws or regulations of any governmental authority having jurisdiction over the Project, whether such reference be specific or by implication, shall mean the latest standard specification, manual, code, law or regulation in effect at the time the work is performed, except as may be otherwise specifically stated herein.
- B. The Contract Documents and all referenced standards cited therein are essential parts of the Contract requirements. A requirement occurring in one is as binding as though occurring in all. They are intended to be complimentary and to describe and provide for a complete project.
- C. Drawings are intended to show general arrangements, design and extent of work. Specifications are separated into divisions for convenience of reference only and shall not be interpreted as establishing divisions for the work, trades, subcontracts, or extent of any part of the work. In the event of a discrepancy between or among the drawings, specifications or other Contract Document provisions, the Contractor shall be required to comply with the provision, which is the more restrictive or stringent requirement upon the Contractor, as determined by the Engineer. Unless otherwise specifically mentioned, all anchors, bolts, screws, fittings, fillers, hardware, accessories, trim and other parts required in connection with any portion of the work to make a complete, serviceable, finished and first quality installation shall be furnished and installed as part of the work, whether or not called for by the Contract Documents.

2. STORAGE OF MATERIALS

Materials shall be so placed so as to permit easy access for proper inspection and identification of each shipment. Any material which has deteriorated, become damaged, or is otherwise unfit for use, as determined by the Engineer, shall not be used in the work, and shall be removed from the site by the Contractor at his expense.

3. SANITATION

The Contractor shall provide and maintain adequate sanitary conveniences for the use of persons employed on the work. These conveniences shall be maintained at all times

without nuisance, and their use shall be strictly enforced. The location of these conveniences shall be subject to the Engineer's approval.

4. MAINTENANCE OF CONSTRUCTION SITE

- A. **Mowing:** Contractor shall be responsible to mow and maintain all rights of way owned by the County within the limits of the construction project. Any retention areas that are built in conjunction with the road project shall also be mowed and maintained. Contractor shall be responsible to pick up trash prior to mowing. Mowing shall be completed every four (4) weeks (equivalent to 28 calendar days) unless authorized by the Project Manager. The height of the mowed vegetation shall be between four (4) and six (6) inches. At no time shall the Contractor mow wildflowers that may be growing whether or not they are in designated wildflower area. Sign posts, trees, retention pond inlet/outfall structures, fences, shrubs, plants, light poles, utility flags, mailboxes or other such obstacles to mowing shall be hand mowed or trimmed around as necessary to present a groomed appearance. Areas determined to be unsatisfactory by the Project Manager shall be re-mowed at no additional cost to the County.
- B. **Trash Removal:** Contractor shall be responsible to remove trash and debris from the rights of way owned by the County within the limits of the construction project. The Contractor shall be responsible for the pickup, removal, and disposal of items such as, but not limited to: bottles, cans, tires, bags of trash, newspapers, cigarette packages, magazines, boxes, cups, food containers, sheets of paper, etc. The Contractor is responsible to remove trash from drainage ditches, headwalls, and along fence/tree lines. Trash removal shall not precede the mowing by more than twenty-four (24) hours.
- C. **Maintenance Liquidated Damages:** In the event Contractor fails to comply with sections 4(A) and 4(B) above, the County may assess against the Contractor liquidated damages in the amount of \$200 (two hundred dollars) per day if the Contractor does not correct any deficient area within two (2) calendar days after written notification from the County, unless otherwise authorized by the Project Manager. Written notification may be delivered to the Contractor or its agent by email, fax, mail or hand delivery. These liquidated damages will start the third (3rd) calendar day after notification and will continue for each calendar day thereafter until reported deficiencies are corrected to the satisfaction of the Project Manager.

5. ERRORS AND OMISSIONS

The Contractor shall not take advantage of any apparent error or omission in the Contract Documents. If any errors and/or omissions appear in the Contract Documents, or construction stakeout, the Contractor shall immediately notify the Engineer, in writing, of such errors and/or omissions. In the event the Contractor knows or should have known of any errors and/or omissions and fails to provide such notification, he shall be deemed to have waived any claim for increased time or compensation he may have had and he shall be held responsible for the results and the costs of rectifying any such errors and/or omissions.

6. CONTRACTOR'S OBLIGATIONS.

A. Qualification

1. The Contractor shall assure that all personnel are competent, careful and reliable. All personnel must have sufficient skill and experience to properly perform the work assigned them. All personnel shall have had sufficient experience to perform their assigned task properly and satisfactorily and to operate any equipment involved, and shall make due and proper effort to execute the work in the manner prescribed in the Contract Documents, or the Engineer may take action as prescribed below.
2. Whenever the Engineer shall determine that any person is incompetent, unfaithful, intemperate, disorderly or insubordinate, the Engineer shall notify the Contractor that such person is to be discharged from the work. The Contractor shall immediately discharge said person from the work and shall not again employ said person on this work except with the written consent of the Engineer. Should the Contractor fail to remove such person or persons the Engineer may withhold all payments.
3. The Contractor shall utilize the U.S. Department of Homeland Security's E-Verify system to verify employment eligibility of all new employees hired by the Contractor during the term of the Contract and shall expressly require any subcontractors performing work or providing services pursuant to the Contract to likewise utilize the U.S. Department of Homeland Security's E-Verify system to verify the employment eligibility of all new employees hired by the subcontractor during the Contract term.

B. Identification

1. Within ten (10) days after the award of any subcontract, either by himself or a subcontractor, the Contractor shall deliver to the Engineer a statement setting forth the name and address of the subcontractor and a summary description of the work subcontracted.
2. The Contractor shall be as fully responsible to the Owner for acts and omissions of his subcontractor and of persons either directly or indirectly employed by them, as he is for the acts and omissions of persons directly employed by him.

C. Contractor's Supervision

1. Prosecution of Work:

The Contractor shall give the work the constant attention necessary to assure the scheduled progress and he shall cooperate fully with the Engineer and with other Contractors at work in the vicinity.

2. Contractor's Superintendent:

- a. The Contractor shall at all times have on the work as his agent, a competent superintendent capable of thoroughly interpreting the plans and

specifications and thoroughly experienced in the type of work being performed, who shall receive the instructions from the Engineer or his authorized representatives. The superintendent shall have full authority to execute the orders or directions of the Engineer and to supply promptly any materials, tools, equipment, labor and incidentals, which may be required. Such superintendence shall be furnished regardless of the amount of work sublet.

- b. The Contractor's superintendent shall speak and understand English, and at least one responsible person who speaks and understands English shall be on the project during all working hours.

3. Supervision for Emergencies:

The Contractor shall have a responsible person available at or reasonably near the work site on a twenty-four (24) hour basis, seven (7) days a week, in order that he may be contacted in emergencies and in cases where immediate action must be taken to maintain traffic or to handle any other problem that might arise. The Contractor's responsible person for supervision for emergencies shall speak and understand English. The Contractor shall submit to the Engineer, by certified mail, phone numbers and names of personnel designated to be contacted in cases of emergencies along with a description of the project location to the Florida Highway Patrol and all other local law enforcement agencies.

4. Worksite Traffic Supervisor:

- a. The Contractor shall have a Worksite Traffic Supervisor who will be responsible for initiating, installing and maintaining all traffic control devices as described in Section 102 of the FDOT Standard Specifications for Road and Bridge Construction, and in the plans. The Worksite Traffic Supervisor shall have at least one year of experience directly related to worksite traffic control in a supervisory or responsible capacity and shall be certified by the American Traffic Safety Services Association Worksite Traffic Supervisor Certification Program or an equal approved by the FDOT. Approved alternate Worksite Traffic Supervisors may be used when necessary.
- b. The Worksite Traffic Supervisor shall be available on a twenty-four (24) hour per day basis and shall review the project on a day to day basis as well as being involved in all changes to traffic control. The Worksite Traffic Supervisor shall have access to all equipment and materials needed to maintain traffic control and handle traffic related situations. The Worksite Traffic Supervisor shall ensure that routine deficiencies are corrected within a 24-hour period.
- c. The Worksite Traffic Supervisor shall be available on the site within forty-five (45) minutes after notification of an emergency situation, prepared to positively respond to repair the work zone traffic control or to provide alternate traffic arrangements.
- d. Failure of the Worksite Traffic Supervisor to comply with the provisions of the Section 102 of the FDOT Standard Specifications for Road and Bridge

Construction may be grounds for decertification or removal from the project or both. Failure to maintain a designated Worksite Traffic Supervisor or failure to comply with these provisions will result in temporary suspension of all activities except traffic and erosion control and such other activities deemed to be necessary for project maintenance.

D. General Inspection Requirements

1. Cooperation by the Contractor:

No work shall be done nor materials used, without suitable supervision or inspection by the Engineer or his representative, and the Contractor shall furnish the Engineer with every reasonable facility for ascertaining whether the work performed and materials used are in accordance with the requirements and intent of the plans and specifications. If the Engineer so requests, the Contractor shall, at any time before final acceptance of the work, remove or uncover such portions of the finished work as may be directed. After examination, the Contractor shall restore the uncovered portions of the work to the standard required by the specifications. Should the work so exposed or examined prove unacceptable, the uncover or removal, and the replacing of the covering or making good of the parts removed, shall be at the Contractor's expense. However, should the work thus exposed or examined prove acceptable, the uncovering or removing, and the replacing of the covering or making good of the parts removed, shall be paid for as Unforeseeable Work.

2. Failure to Remove and Renew Defective Materials and Work:

- a. Should the Contractor fail or refuse to remove and renew any defective materials used or work performed, or to make any necessary corrections in an acceptable manner and in accordance with the requirements of the specifications, within the time indicated in writing, the Engineer shall have the authority to cause the unacceptable or defective materials or work to be repaired, removed and renewed, as may be necessary; all at the Contractor's expense.
- b. Any expense incurred by the County in making these repairs, removals, or renewals, which the Contractor has failed or refused to make, shall be paid for out of any moneys due or which may become due the Contractor, or may be charged against the contract bond. Continued failure or refusal on the part of the Contractor to make any or all necessary repairs promptly, fully and in an acceptable manner shall be sufficient cause for the County, at its option, to perform the work with its own organization, or to contract with any other individual, firm or corporation to perform the work. All costs and expenses incurred thereby shall be charged against the defaulting Contractor and the amount thereof deducted from any moneys due or which may become due him, or shall be charged against the contract bond. Any work performed subsequent to forfeiture of the contract, as described in this Paragraph, shall not relieve the Contractor in any way of his responsibility for the work performed by him.

3. Inspection by the Federal Government or State of Florida:

When the United States Government, or State of Florida, is to pay a portion of the cost of construction, the construction work will be subject to such inspection by its representatives as they may deem necessary, but such inspection will in no case make the Federal Government, or State of Florida, a party to this contract.

7. AUTHORITY OF THE ENGINEER AND ENGINEER'S ASSISTANTS

- A. All work shall be done in accordance with the Contract Documents.
- B. It is agreed by the parties hereto that the Engineer shall decide all questions, difficulties and disputes, of whatever nature, which may arise relative to the interpretation of the plans, construction, prosecution and fulfillment of the contract, and as to the character, quality, amount and value of any work done, and materials furnished, under or by reason of the contract.
- C. The County retains the right to inspect all work to verify compliance with the Contract Documents. The Engineer may appoint such assistants and representatives as desired. They shall be authorized to inspect all work done and all materials furnished. This right of inspection in no way means or implies County control or other supervision over the work done or the work site. This right is solely for the County's benefit and imposes no duties or responsibilities on the County and confers no rights on any other parties. Such inspection may extend to all or any part of the work and to the manufacture, preparation or fabrication of the materials to be used. Such assistants shall not be authorized to revoke, alter or waive any requirement of the Contract Documents.
- D. The assistants and representatives shall be authorized to call to the attention of the Contractor any failure of the work or materials to conform to the Contract Documents, and shall have the authority to reject materials or suspend the work until any questions at issue can be referred to and decided by the Engineer. The Contractor shall be immediately notified in writing of any such suspension of the work and such notice shall state in detail the reasons for the suspension. The presence of the Inspector or other assistant shall in no way lessen the responsibility of the Contractor.
- E. Failure of the Engineer to Reject Work During Construction:

If, during or prior to construction operations, the Engineer should fail to reject defective work or materials, whether from lack of discovery of such defect or for any other reason, such initial failure to reject shall in no way prevent his later rejection when such defect is discovered, or obligate the County to final acceptance, and the Contractor shall make no claim for losses suffered due to any necessary removals or repairs of such defects.
- F. Authority to Suspend Contractor's Operations:

The Engineer has the authority to suspend the Contractor's operations, wholly or in part. The Engineer will order such suspension in writing, giving in detail the reasons

for the suspension. Contract Time will be charged during all suspensions of Contractor's operations. The County may grant an extension of Contract Time in accordance with 8-7.3.2 when determined appropriate in the County's sole judgment.

No additional compensation or time extension will be paid or granted to the Contractor when the operations are suspended for the following reasons:

1. The Contractor fails to comply with the Contract Documents.
2. The Contractor fails to carry out orders given by the Engineer.
3. The Contractor causes conditions considered unfavorable for continuing the Work.

The Contractor shall immediately comply with any suspension order and should not resume operations until authorized to do so by the Engineer in writing. Any operations performed by the Contractor, and otherwise constructed in conformance with the provisions of this contract, after the issuance of the suspension order and prior to the Engineer's authorization to resume operations will be at no cost to the County. Further, failure to immediately comply with any suspension order will also constitute an act of default by the Contractor and is deemed sufficient basis in and of itself exception that the Contractor will not have ten (10) calendar days to correct the conditions for which the suspension was ordered.

G. State of Emergency:

The Engineer has the authority to suspend the Contractor's operations, wholly or in part, pursuant to a Governor's Declaration of a State of Emergency. The Engineer will order such suspension in writing, giving in detail the reasons for the suspension. Contract Time will be charged during all suspensions of Contractor's operations. The County, at its sole discretion, may grant an extension of Contract Time and reimburse the Contractor for specific costs associated with such suspension. Further, in such instances, the County's determination as to entitlement to either time or compensability will be final, unless the Contractor can prove by clear and convincing evidence to a Disputes Review Board that the County's determination was without any reasonable factual basis

H. Prolonged Suspensions:

If the Engineer suspends the Contractor's operations for an indefinite period, the Contractor shall store all materials in such manner that they will not obstruct or impede the traveling public unnecessarily or become damaged in any way and shall take every reasonable precaution to prevent damage to or deterioration of the work performed. The Contractor shall provide suitable drainage of the roadway by opening ditches, shoulder drains, etc., and provide any temporary structures necessary for public travel through the project.

I. Permission to Suspend Contractor's Operations:

The Contractor shall not suspend operations or remove equipment or materials necessary for completing the work without obtaining the Engineer's written permission. The Contractor shall submit all requests for suspension of operations in writing to the Engineer, and identify specific dates to begin and end the suspension. The Contractor is not entitled to any additional compensation for suspension of operations during such periods.

8. CONTRACT TIME AND TIME EXTENSIONS

- A. Unless otherwise provided, contract time shall mean the number of consecutive calendar days from the commencement date noted in the Notice to Proceed to the date on which all work is to be completed. The Contractor shall diligently pursue the completion of the work and coordinate the work being done on the project by its subcontractors and material suppliers, as well as coordinate his work with the work of other contractors so that his work or the work of others shall not be delayed or impaired by any act or omission of any act by a Contractor. The Contractor shall be solely responsible for all construction means, methods, techniques, sequences and procedures, as well as coordination of all portions of the work under the Contract Documents.
- B. Should the Contractor be obstructed or delayed in the prosecution of or completion of the work as a result of unforeseeable causes beyond the control of the Contractor, and not due to his fault or neglect, including but not restricted to acts of God or the public enemy, acts of government, fires, floods, discovery of pre-existing hazardous materials, utility conflicts, epidemics, quarantine regulations, strikes or lockouts, the Contractor shall notify the Engineer in writing within two (2) regular work days after the commencement of such delay, stating the cause or causes thereof, or be deemed to have waived any right which the Contractor may have had to request a time extension.
- C. **NO CLAIM FOR DAMAGES OR ANY CLAIM OTHER THAN FOR AN EXTENSION OF TIME SHALL BE MADE OR ASSERTED AGAINST THE COUNTY BY REASON OF ANY DELAYS.** No interruption, interference, inefficiency, suspension or delay in the commencement or progress of the work shall relieve the Contractor of his duty to perform or give rise to any right to damages or additional compensation from the County. The Contractor expressly acknowledges and agrees that the Contractor shall receive no damages for delay. However, this provision shall not preclude recovery or damages by the Contractor for hindrances or delays due solely to fraud, bad faith or active interference on the part of the County. Otherwise, Contractor shall be entitled to extensions of the Contract Time as the sole and exclusive remedy for such resulting delay, in accordance with and to the extent specifically provided above. This provision applies to claims for early completion as well as late completion. Such extensions of time will not be granted for delays caused by unfavorable weather, ground conditions related to the weather, inadequate construction force or for the failure of the Contractor to timely order equipment or materials.
- D. If the Contractor complies with the two (2) regular work days' notice requirement, the Engineer shall ascertain the facts and the extent of the delay being claimed. The Engineer's findings of fact justify such an extension, and the Engineer's finding of fact shall be final and conclusive on the parties. The Contractor shall cooperate with the Engineer's investigation of the delays by providing any schedules, correspondence or other data that may be required to complete the findings of fact. Extensions to the contract time may be granted for only those delays that impact the Contractor's Construction Schedule. Extensions of contract time must be authorized by Change Order approved in accordance with Board policy.

9. PROSECUTION OF WORK ON SATURDAYS, SUNDAYS AND RECOGNIZED HOLIDAYS

A. Unless the Contractor submits a written request to work during one or more days of a Holiday or Special Event at least ten (10) calendar days in advance of the beginning date of the Holiday or Special Event and receives written approval from the Engineer, the Contractor shall not work on the following days: Martin Luther King, Jr. Day; Memorial Day; the Saturday and Sunday immediately preceding Memorial Day; Independence Day (Observed); Labor Day; the Friday, Saturday, and Sunday immediately preceding Labor Day; Veterans Day; Veterans Day (Observed); the Wednesday immediately preceding Thanksgiving Day; the Friday, Saturday and Sunday immediately following Thanksgiving Day; December 24 through January 2, inclusive; and Special Events noted in the Plans. Contract Time will be charged during these Holiday and Special Event periods. The Contractor is not entitled to any additional compensation beyond any allowed Contract Time adjustment for suspension of operations during such Holiday and Special Event Periods.

B. No work will be permitted on:

New Years Day
Independence Day
Thanksgiving Day
Christmas Day

C. If Christmas or New Year's Day shall fall on Tuesday or Thursday, the preceding Monday or the following Friday shall be recognized as a holiday also. If any recognized holiday shall fall on a Saturday, the preceding Friday shall be observed as a holiday. If any recognized holiday shall fall on a Sunday, the following Monday shall be observed as a holiday.

D. The Contractor shall pay to the County, as reimbursement of costs incurred by the County, the sum of TWO HUNDRED FIFTY and 00/100 DOLLARS (\$250.00) per man per day for each Sunday or recognized Holiday on which the Contractor works. Payment to the County of such sums as may become payable under the provisions of this Article shall be made by identifying the said sums as a credit item on the Contractor's pay estimate for the period during which the liability for the sums occurred. The credit item shall show the total number of days applicable under (D) times the corresponding per day or per hour cost.

E. During such suspensions, remove all equipment and materials from the clear zone, except those required for the safety of the traveling public and retain sufficient personnel at the job site to properly meet the requirements of Sections 102 and 104 of the Standard Specifications.

10. LIQUIDATED DAMAGES

A. The County and the Contractor recognize that, since time is of the essence for this Contract, the County will suffer financial loss if the work is not completed within the time specified.

- B. The County shall be entitled to assess, as liquidated damages, but not as a penalty, for each calendar day after the scheduled completion date. The project shall be deemed to be completed on the date the work is deemed complete to the satisfaction of the Engineer. The Contractor hereby expressly waives and relinquishes any right which it may have to seek to characterize the above-noted liquidated damages as a penalty. The parties agree that the liquidated damages sum represents a fair and reasonable estimate of the County's actual damages at the time of contracting if the Contractor fails to complete the work in a timely manner. The liquidated damages shall be as follows:

| Original Contract Amount | Daily Charge Per Calendar Day |
|--|--|
| \$299,999 and under..... | \$904 |
| \$300,000 but less than \$2,000,000..... | \$1,685 |
| \$2,000,000 but less than \$5,000,000..... | \$2,667 |
| \$5,000,000 but less than \$10,000,000..... | \$3,813 |
| \$10,000,000 but less than \$20,000,000..... | \$5,021 |
| \$20,000,000 but less than \$40,000,000..... | \$7,442 |
| \$40,000,000 and over..... | \$10,224 plus 0.00005 of any amount over \$40 million (Round to nearest whole dollar) |

- C. Any Contractor that is in default for not completing the work within the time specified will be removed from the bidder's list, at the option of the County, and not permitted to bid work for Lake County until the project is complete and the liquidated damages sum is satisfied.

11. CHANGES IN THE WORK

- A. Without invalidating the contract, the Engineer may at any time, by written order, direct extra work within the general scope or alter the work by addition or deduction of items that do not alter the scope of the work. Such changes may be effected by Change Order or by other written order. Such changes shall be binding on the Contractor. No officer, employee, or agent of the County is authorized to direct any extra or change work orally. All changes orders shall be executed in the manner set forth in the Lake County Purchasing Procedures. A copy of such procedures shall be available upon request.
- B. If changes to the scope of the work are required or if the contract time or the total contract price is increased or decreased, a Change Order in accordance with Board policy will be required.
- C. The value of such extra work or change shall be determined by contract unit values if applicable unit values are set forth in the contract. The amount of the change shall be computed from such values and added to or deducted from the contract price. If the applicable unit values are not in the contract, the value of such extra work or change shall be determined by negotiation.
- D. Should a Change Order be required, and the County and the Contractor are unable to agree on the requested change, the Contractor shall, nevertheless, promptly perform the change as directed in writing by the Engineer. If the Contractor disagrees with the Engineer's adjustment determination, the Contractor must make

a claim pursuant to the Claims and Dispute Section herein, or else be deemed to have waived any claim on this matter it might otherwise have had.

- E. For new work not covered by contract unit values, the amount of an increase shall be limited to the Contractor's reasonable direct labor and material costs and reasonable actual equipment costs as a result of the change (including allowance for labor burden costs) plus a maximum ten percent (10%) markup for all overhead and profit. In the event such change work is performed by a subcontractor, a maximum ten percent (10%) markup for all overhead and profit for all subcontractors' direct labor and material costs and actual equipment costs shall be permitted, with a maximum five percent (5%) markup thereon by the Contractor for all of its overhead and profit, for a total overall maximum markup of fifteen percent (15%) of the amount of change work. All compensation due the Contractor and any Subcontractor or sub-subcontractor for field and home office overhead is included in the markups noted above.
- F. In an emergency endangering life or property, or as expressly set forth herein, the Engineer has the authority to order the necessary work in writing. The County shall not be liable to the Contractor for any increased compensation without such written order. The payment authorized by a written order shall represent full and complete compensation to the Contractor for labor, materials, incidental expenses, overhead, profit, impact costs, and time associated with the work authorized by such written order.
- G. Execution by the Contractor of a properly authorized Change Order (see appendix) shall be considered a waiver of all claims or requests for additional time or compensation for any activities prior to the time of execution related to items included in the Change Order.

12. CLAIMS AND DISPUTES

- A. Claims by the Contractor shall be made in writing to the Engineer within two (2) business days after the commencement of the event giving rise to such claim or else the Contractor shall be deemed to have waived the claim. Written supporting data shall be submitted to the Engineer within ten (10) calendar days after the occurrence of the event, unless the County grants additional time in writing, or else the Contractor shall be deemed to have waived the claim. All claims shall be priced in accordance with the provisions of the section in this document entitled "Changes in Work".
- B. The Contractor shall proceed diligently with its performance as directed by the County, regardless of any pending claim, action, suit, or administrative proceeding, unless otherwise agreed to by the County in writing. The County shall continue to make payments on the undisputed portion of the contract in accordance with the contract documents during the pendency of any claim.
- C. Claims by the Contractor shall be resolved in the following manner:
 - 1. Upon receiving the claim and supporting data, the County shall within fifteen (15) business days respond to the claim in writing stating that the claim is either approved or denied. If denied, the County shall specify the grounds for denial.

The Contractor shall then have fifteen (15) calendar days in which to provide additional supporting documentation, or to notify the County that the original claim stands as is.

2. If the claim is not resolved, the County may, at its option, choose to submit the matter to mediation. A mediator shall be mutually selected by the parties and each party shall pay one-half (1/2) the expense of mediation. If the County declines to mediate the dispute, the Contractor may bring an action in the County or Circuit Court sitting in Lake County, Florida.
- D. Claims by the County against the Contractor shall be made in writing to the Contractor as soon as the event leading to the claim is discovered by the County. Written supporting data shall be submitted to the Engineer. All claims shall be priced in accordance with the provisions of the section in this document entitled "Changes in Work". The Engineer shall make a determination on the claim within fifteen (15) business days of receipt of the claim and shall communicate said determination to the County and the Contractor in writing. The Contractor may appeal the determination as set forth in subsection C(2) above.
 - E. Arbitration shall not be considered as a means of dispute resolution.

13. MEASUREMENT AND PAYMENT

- A. All work completed under the terms of this contract shall be measured according to United States Standard Measures.
- B. All measurements shall be taken horizontally or vertically, unless specifically provided otherwise.
- C. In the measurement of items to be paid for on the basis of area of finished work, when the pay quantity is designated to be determined by calculation, the lengths and/or widths to be used in the calculations shall be the station-to-station dimensions shown on the plans, the station-to-station dimensions actually constructed within the limits designated by the Engineer, or the final dimensions measured of the completed work within the lines shown on the plans or designated by the Engineer. The method, or combination of methods, shall be those which reflect with reasonable accuracy the actual area of finished work as determined and authorized by the Engineer.
- D. No payment will be made for either construction over a greater area than authorized, or for material moved from outside of stakes and data shown on the plans, except when such work is performed upon instructions of the Engineer.
- E. The Contractor shall accept compensation provided under the terms of this contract as full payment for furnishing all materials and for performing all work contemplated and embraced under this contract. Such compensation shall also be for any and all loss or damage arising out of the nature of the work or from the action of the elements, or from any unforeseen difficulties or obstructions encountered during the contract period until final acceptance by the County.

- F. Whenever any change, or combination of changes in the plans, results in an increase or decrease in the original contract quantities, and the work added or decreased/eliminated is of the same general character as that called for in the plans, the Contractor shall accept payment in full at the original contract unit prices for the actual quantity of work performed, with no allowance for any loss of anticipated profits.
- G. Where the pay quantity for an item is designated to be Lump Sum, and the plans or specifications indicate an estimated quantity, compensation for that item will be adjusted proportionately if a plan change results in a significant change in the quantity from such estimated plan quantity.
- H. Failure to construct any item to plan or authorized dimensions within the specification tolerances shall result in reconstruction by the Contractor to acceptable tolerances at no additional cost to the County, acceptance at no pay, or acceptance at reduced final pay as determined by the Engineer. Adjustments to final pay for those items designated to be paid on the basis of Lump Sum quantity under these provisions shall not be made unless such adjustments results in an aggregate change per item of more than \$1,000.00 for earthwork items, or more than \$100.00 for any other item.
- I. Materials purchased by the Contractor for drainage structures, drainage pipe, and road base delivered to job site for this contract are eligible as determined by the Engineer for payment up to one half the bid unit price. If payment is made the materials shall become the property of Lake County. The Contractor shall be responsible for loss or theft and shall replace, at the Contractor's expense, any such materials lost for any reason. The remainder of payment shall not be made until such materials are properly constructed and in place per plans and specifications.

14. PAYMENTS TO CONTRACTOR

Monthly progress payments will be made to the Contractor. In accordance with the items listed within the Bid Form - Tabulation of Estimated Quantities (Division W), a list of items rendered complete, satisfactory, and acceptable will be prepared by the Contractor and submitted with each payment request. The payment request shall be based on extension of the unit values for said quantities. The Contractor's project representative will be required to review the payment requests with the Inspector and sign the request in agreement. The payment request will then be checked by the Inspector's supervisor, who will reconfirm with the Inspector and Contractor any required corrections, before further processing for payment.

All payments made to the Contractor and all payment of subcontractors, sub-contractors, materialmen, and suppliers shall be in accordance with Part VII, Chapter 218, Florida Statutes.

Federal or State Funding: If any project given to the Contractor under this Agreement is one in which federal or state funds shall be used, the Contractor is hereby informed that payment shall be contingent upon receipt of said federal or state funds or approval. Additionally, payment shall be contingent upon the Contractor completing all required forms and documentation as is necessary in order to obtain such federal or state funding or approval.

15. SUBSTANTIAL COMPLETION/PUNCH LIST

Upon substantial completion of the project, or at least 30 days prior to contract completion date, Lake County shall provide to the Contractor a list of items and the estimated cost to complete each item on the list required to render complete, satisfactory, and acceptable the construction services purchased.

The cost to complete each item will be based on the unit cost for said item as bid by the Contractor and the percentage of what remains to be paid for said item on the last pay application.

For construction projects having an estimated cost of less than \$10 million, the contractor shall have 30 calendar days to complete the punch list items. For construction projects having an estimated cost of \$10 million or more shall have up to 45 days to complete the punch list items.

If the list is not provided to the contractor at least 30 days prior to the contract completion date, the contract time for completion must be extended by the number of days Lake County exceeded the delivery date.

The failure to include any corrective work or pending items not yet completed on the list does not alter the responsibility of the contractor to complete all the construction services purchased pursuant to the contract.

Upon receipt of a proper invoice or payment request and within 20 business days after the list is created, Lake County must pay the Contractor the remaining contract balance that includes all retainage previously withheld by Lake County, less an amount equal to 150 percent of the estimated cost to complete the items on the punchlist.

Upon completion of all items on the list, the Contractor may submit a payment request for the amount withheld by Lake County. If a good faith dispute exists as to whether one or more items identified on the punchlist have been completed pursuant to the contract, Lake County may continue to withhold up to 150 percent of the total costs to complete such items. All items that require correction under the contract which are identified after the preparation and delivery of the punchlist remain the obligation of the contractor as defined by the contract.

Warranty items or items not included in the punchlist may not affect the final payment of retainage.

16. ACCEPTANCE AND FINAL PAYMENT

A. Final Inspection

Whenever all materials have been furnished, all work has been performed, and the construction contemplated by the contract has been satisfactorily completed, the Engineer will make the final inspection.

B. Maintenance of Work

The Contractor shall maintain all work in first-class condition until final inspection is completed and accepted by the Engineer. All Bonds and Insurance shall be maintained until final acceptance by the Board of County Commissioners.

C. Final Acceptance

1. Upon completion of the final construction inspection and where the work is found to be completed satisfactorily, the Contractor shall prepare a final estimate.
2. Whenever the work provided for under the contract has been completely performed by the Contractor, and the final inspection has been made by the Engineer, a final pay request showing the value of the work will be prepared by the Contractor as soon as the necessary measurements and computations can be made. All prior estimates and payments shall be subject to correction in the final estimate and payment. The amount of this estimate, less any sums that may have been deducted or retained under the provisions of the contract, will be paid to the Contractor within 20 days after receipt of a proper invoice or payment request, and after the Contractor has furnished a sworn Affidavit in the form provided in Division Z of this Contract, to the effect that all bills are paid and no suits are pending, and after the Contractor has agreed in writing to accept the balance due, as determined by the County, as full settlement of his account under contract and of all claims in connection therewith.
3. The surety on the contract bonds consents, by completion of their portion of the affidavit and surety release subsequent to the Contractor's completion of his portion, to final payment to the Contractor and agrees that the making of such payment shall not relieve the surety of any of its obligations under the bonds.

D. Waiver of Claims

1. The Contractor's acceptance of final payment shall constitute a full waiver of any and all claims by the Contractor against the County arising out of this Contract or otherwise related to the project, except those previously made in writing and identified by the Contractor as unsettled at the time the final estimate is prepared.
2. Neither the acceptance of the work nor payment by the County shall be deemed to be a waiver of the County's rights to enforce any continuing obligations of the Contractor hereunder or to the recovery of damages for defective work not discovered by the County at the time of final inspection.

E. Termination of Contractor's Responsibility

The contract will be considered complete when all work has been completed and has been accepted by the Engineer. The Contractor will then be released from further obligation except as set forth in his bonds and in this Division.

F. Recovery Rights, Subsequent to Final Payment

The County reserves the right, should an error be discovered in the partial or final estimates, or should proof of defective work or materials used by or on the part of the Contractor be discovered after the final payment has been made, to claim and recover from the Contractor or his surety, or both, by process of law, such sums as may be sufficient to correct the error or make good the defects in the work and materials.

17. COVENANT AGAINST CONTINGENT FEES

The Contractor warrants that no person or selling agency has been employed or retained to solicit or secure this Contract upon an agreement or understanding for a commission, percentage, brokerage or contingent fee, except bona fide employees of bona fide established commercial or selling agencies maintained by the Contractor for the purpose of securing business. For breach or violation of this warranty the County shall have the right to annul this Contract without liability or, in its discretion, to deduct from the Contract price or consideration, or otherwise recover, the full amount of such commission, percentage, brokerage or contingent fee.

18. LANDS FOR WORK AND ACCESS THERETO

- A. The County will furnish and define the limits of land for access to the construction site and for the site proper. All information shown in the Contract Documents constitutes the extent of land provided by the County. Any and all other lands required by the Contractor shall be procured by the Contractor at the Contractor's expense.
- B. As the work progresses, the Contractor shall keep the site reasonably clear of rubbish, trash, waste and other disposable materials on a daily basis.
 - 1. If the Contractor allows the site to become littered and unsightly, any payments otherwise due may be withheld until the Contractor cleans up the site to the satisfaction of the Engineer. If the Contractor fails to clean-up the site, the County may choose to clean-up the site at the Contractor's expense.
- C. Temporary buildings (storage sheds, shops, offices, etc.) may be erected by the Contractor only with the approval of the Engineer after obtaining necessary permits, and shall be built with labor and materials furnished by the Contractor without expense to the County. Such temporary buildings and/or utilities shall remain the property of the Contractor and will be removed by him at his expense upon the completion of the work. With the written consent of the Engineer, such buildings and/or utilities may be abandoned and need not be removed.
- D. The Contractor shall confine all construction equipment, the storage of materials and equipment and the operations of workers to the project site and land and areas identified in and permitted by the Contract Documents, and shall not unreasonably encumber the project site with construction equipment or other material or equipment. The Contractor shall assume full responsibility for any damage to any

such land or area, or to the owner or occupant thereof, or any land or areas contiguous thereto, resulting from the performance of the work.

- E. The Contractor is responsible for ensuring and complying with any permit requirements from Federal, State, County, or local agencies in the storage of material on properties not under the control of Lake County. The Contractor shall provide best management practices at storage sites to prevent erosion, hazardous materials contamination, or other contaminations from occurring.

19. EXCAVATED MATERIAL AND FILL MATERIAL

- A. Any and all excavated material shall be hauled to legally permitted and environmentally appropriate locations only. Legally permitted locations shall be able to receive such material complying with all federal, state, and local laws.
- B. Any fill material used for a County project shall be exclusively sourced from legally permitted and properly zoned sources. Legally permitted sources shall mean those sources complying with all federal, state, and local laws. Properly zoned shall refer to county and municipal local laws or regulations that govern how real property can and cannot be used in certain geographic areas.
- C. Any contractor found not to be in compliance with Sections A and B above shall be held responsible and liable to repair and bring back into compliance any location in accordance with federal, state, or local requirements.

20. SITE INVESTIGATION

- A. Each Contractor shall visit the site of the proposed work and fully acquaint himself with conditions relating to construction and labor so that he may fully understand the facilities, difficulties and restrictions attending the execution of work under the contract. The Contractor shall thoroughly examine and be familiar with the Contract Documents. Failure or omission of the Contractor to receive or examine any form, instrument, addendum or other documents, or to visit the site and acquaint himself with conditions existing thereon, shall in no way relieve the Contractor from any obligation with respect to the Contract.

The Geotechnical Report dated June 26, 2024, as prepared by Ardaman & Associates, Inc. is included in Appendix B-1 for review.

Lake County does not warrant the accuracy or completeness of these reports, soil samples, or any other site condition information or data made available including, but not limited to, underground utility location. The submission of a bid shall be taken as prima-facie evidence of compliance with this section.

- B. The Contractor acknowledges that he has satisfied himself as to the nature and location of the work; the general and local conditions, including but not restricted to, those bearing upon transportation, disposal, handling and storage of materials; availability of labor, water, electric power, roads; and uncertainties of weather, river stages, tides or similar physical conditions at the site; the conformation and conditions of the ground; the character of equipment and facilities needed preliminary to and during prosecution of the work.

- C. The Contractor further acknowledges that he has satisfied himself as to the character, quality and quantity of surface and subsurface materials, obstacles, or conditions to be encountered.
- D. Any failure by the Contractor to acquaint himself with any aspect of the work or with any of the applicable conditions shall not relieve the Contractor from responsibility for adequately evaluating the difficulty or cost of successfully performing the work under the Contract Documents, nor shall it be considered the basis for any claim for additional time or compensation.
- E. The County assumes no responsibility for any conclusions or interpretations made by the Contractor on the basis of the information made available by the County. The County also assumes no responsibility for any understanding or representations made by its officers or agents during or prior to the execution of this Contract, unless such understanding or interpretations are made in writing.

21. PROTECTION OF EXISTING STRUCTURES, UTILITIES, WORK AND VEGETATION

- A. Location of existing structures and utilities provided in the Contract Documents are approximate only. Any damage to existing structures or work of any kind, or the interruption of a utility service resulting from failure to comply with the requirements of the Contract Documents, shall be repaired or restored promptly by, and at the expense of the Contractor.
- B. The Contractor will preserve and protect all existing vegetation such as trees, shrubs and grass on or adjacent to the site which do not unreasonably interfere with the construction as may be determined by the Engineer. The Contractor will be responsible for all unauthorized cutting or damaging of trees and shrubs, including damage due to careless operation of equipment, stockpiling of materials or tracking of grass areas by equipment.
- C. Care will be taken by the Contractor in felling trees authorized for removal to avoid unnecessary damage to vegetation that is to remain in place. Any limbs or branches of trees broken during such operations shall be trimmed without cutting into the trunk and left with a clean cut and a small stub. The Contractor will be liable for, or may be required to replace or restore at his own expense, all vegetation that may be destroyed or damaged due to the Contractor's failure to protect and preserve same as required herein.
- D. Where the Contractor hauls material or equipment to the project over roads and bridges on the State road system, County road system or City street system, and such use causes damage, he shall immediately, at his expense, repair such road or bridge to as good a condition as before the hauling began. Such hauling shall be conducted in accordance with all applicable environmental and safety regulations.
- E. The Contractor shall fully protect the work from loss or damage and shall bear the cost of any such loss or damage until final payment has been made. If the Contractor or any one for whom the Contractor is legally liable for is responsible for any loss or damage to the work, or other work or materials of the County or County's separate contractors, the Contractor shall be charged with the same, and any monies

necessary to replace such loss or damage shall be deducted from any amounts due the contractor.

- F. All existing monuments shown on these plans are to be preserved, if possible. Any monuments damaged or destroyed without the express written permission of Lake County, including but not limited to horizontal and vertical control points and property corners, are to be restored at the expense of the Contractor by a professional surveyor and mapper, licensed to do business in the State of Florida.

22. OTHER WORK

- A. The Contractor will cooperate with County forces or others who may be engaged in authorized work prior to final completion of the project.
- B. The Contractor shall cooperate with the owners of any underground or overhead utility lines in their removal and rearrangement operations in order that these operations may progress in a reasonable manner and that service rendered by these parties will not be interrupted.
- C. The County may perform other work related to the project at the site by the County's own forces, have other work performed by utility owners or let other direct contracts. If the fact that such other work is to be performed is not noted in the Contract Documents, notice thereof will be given to the Contractor. If the Contractor believes that such performance will involve additional expense to the Contractor or require additional time, the Contractor shall send written notice of that fact to the County and the Engineer within forty-eight (48) hours of being notified of the other work. If the Contractor fails to send the above required forty-eight (48) hour notice, the Contractor will be deemed to have waived any rights it otherwise may have had to seek an extension to the contract time or adjustment to the contract amount. The Contractor shall afford each utility owner and other contractors (or the County, if the County is performing the additional work with the County's employees) proper and safe access to the site and a reasonable opportunity for the introduction and storage of materials and equipment and the execution of such work and shall properly connect and coordinate its work with theirs. The Contractor shall not endanger any work of others by cutting, excavating or otherwise altering their work and will only cut or alter their work with the written consent of the Engineer and the others whose work will be affected.
- D. If any part of the Contractor's work depends, for proper execution or results, upon the work of any other contractor other than a subcontractor or utility owner, the Contractor shall inspect and promptly report to the Engineer, in writing, any delays, defects or other problems in such other work that render it impossible for the Contractor to obtain proper execution or results. The Contractor's failure to report will constitute an acceptance of the other work as fit and proper for integration with the Contractor's work.

23. TERMINATION

A. Termination for Default

1. The Contractor shall be considered in material default of the Contract and such default shall be considered cause for the County to terminate the Contract, in whole or in part, as further set forth in this Section, for any of the following reasons:
 - a. Failing to begin the work under the Contract Documents within the time specified herein;
 - b. Failing to properly and timely perform the work as directed by the Engineer or as provided for in the approved Construction Schedule;
 - c. Performing the work unsuitably or neglecting or refusing to remove materials or to correct or replace such work as may be rejected as unacceptable, unsuitable or otherwise defective;
 - d. Discontinuing the prosecution of the work;
 - e. Failing to resume work that has been suspended within a reasonable time after being notified to do so;
 - f. Becoming insolvent or declared bankrupt, or committing any act of bankruptcy;
 - g. Allowing any final judgment to stand unsatisfied for more than ten (10) days;
 - h. Making an assignment for the benefit of creditors;
 - i. Failing to obey laws, ordinances, regulations or other codes of any governmental authority with jurisdiction on the project;
 - j. Failing to perform or abide by the terms or spirit of the Contract Documents.
 - k. Failing to maintain contract security as required by the Contract Documents.
2. The County shall notify the Contractor in writing of the Contractor's default. If the County determines that the Contractor has not taken substantial steps toward effecting a remedy or cure of the default or defaults in his performance within seven (7) calendar days following receipt by the Contractor of written notice of default or defaults, then the County, at its option, without releasing or waiving its rights and remedies against the Contractor's sureties, and without prejudice to any other right it may be entitled to hereunder or by law, may terminate the Contractor's right to proceed under this Contract, in whole or in part, and may take possession of the work and any materials, tools, equipment, and appliances of the Contractor, take assignments of any of the Contractor's subcontracts and purchase orders and complete the Contractor's work by whatever means, method or agency which the County, in its sole discretion, may choose.

3. If the County deems any of the foregoing remedies necessary, the Contractor agrees it shall not be entitled to receive any further payment until after the work is completed. All money expended and all of the costs, losses, damages and extra expenses, including all management, administrative and other overhead and other direct and indirect expenses, (including engineering, architectural and attorney's fees) or damages incurred by the County incident to such completion, shall be deducted from the contract price, and if such expenditures exceed the unpaid balance of the contract price, the Contractor agrees to pay promptly to the County on demand, the full amount of such excess, including costs of collection, attorneys' fees (including appeal) and interest thereon at the maximum legal rate of interest until paid.
4. The liability of the Contractor hereunder shall extend to and include the full amount of any and all sums paid, expenses and losses incurred, damages sustained and obligations assumed by the County in good faith under the belief that such payments or assumptions were necessary or required, in completing the work and providing labor, materials, equipment, supplies, and other items therefore or relating to the work, and in settlement, discharge, or compromise of any claims, demands, suits or judgments pertaining to or arising out of the work hereunder.
5. If after notice of termination of the Contractor's right to proceed pursuant to this subparagraph A it is determined for any reason that the Contractor was not in default or that his default was excusable, or that the County is not entitled to the remedies against the Contractor provided herein, then the Contractor's remedies against the County shall be the same as and limited to those afforded the Contractor pursuant to the Termination for Convenience subparagraph B below.

B. Termination for Convenience and Right of Suspension

1. The County shall have the right to terminate or suspend this Contract, in whole or in part, without cause upon seven (7) calendar days written notice to the Contractor.
2. In the event of such termination or suspension for convenience, the Contractor's sole recovery against the County shall be limited to that portion of the contract price earned through the date of termination or suspension, together with any retainage withheld and reasonable termination or suspension expenses incurred, but the Contractor shall not be entitled to any other or further recovery against the County, including, but not limited to, damages and any anticipated profit or work not performed.

24. SUBMITTALS

A. Schedule

1. At or before the Pre-construction Conference, the Contractor shall submit a preliminary Construction Progress Schedule to the Engineer. The County will review the schedule and provide the Contractor with comments. Within ten (10)

days after receipt of the County's comments, the Contractor shall deliver to the Engineer a Construction Progress Schedule in a form satisfactory to the Engineer and showing the proposed dates of commencement and completion of each of the various subdivisions of work. A bar graph format is acceptable for the Construction Progress Schedule. If required by the Engineer, at or before the Pre-construction Conference, the Contractor shall provide to the County a breakdown of estimated monthly payments for the entire duration of the contract period.

2. For lump sum contracts the Contractor shall also furnish the Engineer with a detailed estimate giving a complete breakdown of the value of items of work to be paid for the purpose of making partial payments thereon. The values employed in making up this estimate and the schedule will be used for determining the basis of partial payment and as a basis for determining work quantity pricing for additions to or deductions from the contract price.
3. The Construction Progress Schedule shall be updated by the Contractor. All updates to the progress schedule shall be submitted for the Engineer's file.
4. The work shall be planned and carried out so as to minimize the interruption of existing services, and/or traffic, or as directed by the Engineer.
5. The Contractor is to furnish the Engineer for approval a Traffic Control Plan (TCP) that complies with the Manual on Uniform Traffic Control Devices (MUTCD).
6. If a National Pollution Discharge Elimination System (NPDES) Construction Permit is required for the Project, prior to construction the Contractor is to furnish the Engineer a copy of the Stormwater Pollution Prevention Plan (SWPPP).

B. Shop Drawings/Working Drawings

1. Four (4) complete sets of detailed shop or working drawings shall be furnished by the prime Contractor to the County for review and processing. The submittal shall include all details, computations, materials, loads, stresses, member sizes, deflections, and temporary connections for precasting.
2. All shop, working and erection drawings prepared by the Contractor or his subcontractor, fabricator or supplier shall be REVIEWED, DATED, STAMPED, APPROVED, SEALED (if required), and SIGNED BY THE CONTRACTOR prior to submission to the County for Public Works' approval. By approving and submitting shop or working drawings, the Contractor represents that he has verified work requirements, field measurements, construction criteria, sequence of assembly and erection, access and clearances, catalog numbers and other similar data. Each submission shall indicate the specification section or bid item number and page and/or sheet number to which the submission applies. Under no circumstances will submittals be accepted from subcontractors.

The Contractor shall indicate on the working, shop and erection drawings all deviations from the Contract Documents and shall itemize all deviations in the letter of transmittal.

3. Submittals shall be made to the County for approval by the Department of Public Works. The Contractor shall identify each submittal by contract number and title on the form provided by the Engineer. All submittals are to be transmitted in an expeditious manner to ensure "next day delivery". The approval by the County of shop drawings does not relieve the Contractor of liability to order materials and construct per FDOT specifications and the approved construction plans.
4. All submittals by the Contractor shall be made sufficiently in advance of the scheduled start of the applicable construction operation to allow for shop drawings review and for Contractor action required in addressing review comments. The review period shall begin on the day the submittal is received by the Department of Public Works and shall be completed on the day the County transmits reviewed drawings to the Contractor.
5. The Contractor shall schedule the submission of shop drawing sheets (to be discussed at the pre-construction meeting) so that approximately twenty-one (21) days are allowed for review by the County for routine work. For more complex work, the number of copies and the scheduled time for review shall be increased proportionately to the complexity of the work. Contractor submittals that are to be considered as complex and requiring proportionately greater review time include, but are not limited to, the following:
 - a. Contractor submittals of alternative design features or modifications to the original design.
 - b. Contractor submittals of complex designs, unusual construction or equipment and methods requiring analysis of design calculations.

C. Material Safety Data Sheets Requirement

If any chemicals, or materials or products containing toxic substances are to be used at any time during this Contract, pursuant to completion of this Contract, the Contractor shall furnish a Material Safety Data Sheet to both the Lake County Department of Risk Management and the Engineer, prior to commencing such use.

D. Materials

1. Delivery Tickets: The Contractor shall submit a copy of all delivery tickets for materials used on the project, regardless of the basis of payment.
 - c. Job Mix Formula for Asphaltic Concrete: Attention is directed to the provisions of FDOT "STANDARD SPECIFICATIONS FOR ROAD AND BRIDGE CONSTRUCTION" July 2025, and all supplemental specifications thereto which require the submission of job mix formulas for asphaltic concrete, of the type specified, at least fourteen (14) days before plant operations begin. The submitted formula shall be approved by the County. The Contractor shall prepare the mix formula to be submitted to the County.
 - d. Job Mix Formula for Portland Cement Concrete: Attention is directed to the requirement that job mix design formulas for all Portland Cement Concrete, of the type specified, be submitted at least fourteen (14) days prior to use

on the project. The submitted formulas shall be approved by the County and/or its agents prior to its use. All concrete mix designs shall meet FDOT Concrete Class mix guidelines or the requirements included in the Technical Specifications included in these Contract Documents.

- e. All Job mix formulas shall be submitted to the Engineer.

25. RIGHT TO AUDIT

The County reserves the right to require the Contractor to submit to an audit by any auditor of the County's choosing. The Contractor shall provide access to all of its records, which relate directly or indirectly to this Agreement at its place of business during regular business hours. The Contractor shall retain all records pertaining to this Agreement and upon request make them available to the County for ten (10) years following expiration of the Agreement; provided, however, that records related to unresolved audit findings, appeals or litigation shall be retained until the action is completed or the dispute is resolved. The Contractor agrees to provide such assistance as may be necessary to facilitate the review or audit by the County to ensure compliance with applicable accounting and financial standards. Additionally, the Contractor agrees to include the requirements of this provision in all contracts with subcontractors and material suppliers in connection with the work performed hereunder. If an audit inspection or examination pursuant to this section discloses overpricing or overcharges of any nature by the Contractor to the County in excess of one percent (1%) of the total contract billings, in addition to making adjustments for the overcharges, the reasonable actual costs of the County's audit shall be reimbursed to the County by the Contractor. Any adjustments and/or payments which must be made as a result of any such audit or inspection of the Contractor's invoices and/or records shall be made within a reasonable amount of time, but in no event shall the time exceed ninety (90) days, from presentation of the County's audit findings to the Contractor.

26. INTEREST ON JUDGMENTS

In the event of any disputes between the parties to this contract, including without limited thereto, their assignees and/or assigns, arising out of or relating in any way to this contract, which results in litigation and a subsequent judgment, award or decree against either party, it is agreed that any entitlement to post judgment interest, to either party and/or their attorneys, shall be fixed by the proper court at the rate of five (5%) percent, per annum, simple interest. Under no circumstances shall either party be entitled to pre-judgment interest. The parties expressly acknowledge and, to the extent allowed by law, hereby opt out of any provision of federal or state statute not in agreement with this paragraph.

27. DRAINAGE AND EROSION CONTROL

The Contractor shall so conduct his operations and maintain the work in such condition that adequate drainage and erosion control will be in effect at all times.

28. STANDARD SPECIFICATIONS

Unless otherwise specified, the standard specifications to be used for this work shall be the FDOT "STANDARD SPECIFICATIONS FOR ROAD AND BRIDGE CONSTRUCTION,"

July 2025, or 2025 FDOT DESIGN MANUAL (FDM), (or latest edition), and all supplemental specifications thereto, or otherwise depicted on the construction plans.

29. PRIORITY

In any instance where there is an apparent conflict between Special Provisions and the corresponding terms of the "Standard Specifications," the Special Provisions shall be controlling.

30. SURVEY AND LAYOUT

- A. The Contractor shall be responsible for providing all lines, grades, boundaries and required survey and/or layout necessary to construct and inspect the project. All centerline control points shall be established and maintained through the contract period by the Contractor.
- B. The Contractor shall employ or retain the services of a Florida registered Professional Land Surveyor to perform and supervise the establishment and setting of the project centerline control at intervals not to exceed 500 feet. All primary control points such as section corners, points of intersection, points of curvature and points of tangency shall be installed, referenced by acceptable standards, and maintained through the contract period. All stakes and points shall be clearly marked and identified.
- C. The Contractor shall employ or retain the services of a Florida registered Professional Land Surveyor to perform and supervise the establishment of all rights-of-way/boundary staking at all project sidelines. Such staking shall be established and maintained by the Contractor's registered Professional Land Surveyor along each sideline or perimeter at each station and all points of intersection, points of curvature, and points of tangency. All stakes shall be clearly marked and identified.
- D. The Contractor's registered Professional Land Surveyor and all employees engaged in survey efforts shall keep proper documentation of survey notes in hard bound books. The use of digital data storage capabilities may be used in lieu of hardbound books. Standard ASCII files/format shall be used with software compatibility to that of the LCPWD. The Contractor shall submit for approval the selected format and software application(s).
- E. The Contractor may perform or select the option to employ a Florida registered Professional Engineer or registered Professional Land Surveyor to provide construction layout. All layout and measurements shall be performed from control and boundaries established and maintained by the Contractor's Florida registered Professional Land Surveyor.
- F. The Contractor shall be responsible to perform all layout in acceptable standard methods. All items shall be clearly staked and marked. Roadway items shall be staked for horizontal alignment relative to the edge of pavement with appropriate offset stakes. All vertical grades should be referenced to the nearest even foot cut or fill where practical. Tabulated cut/fill sheets are acceptable for utility work items, copies of which shall be furnished to the Engineer prior to the work.

- G. All calculations for intermediate grades and locations shall be performed by the Contractor. All calculations shall be transcribed in hardbound field books prior to layout and staking.
- H. The Contractor shall submit, for information only, a Survey and Layout Plan comprised of the following:
 - 1. Name, address and certificate number of the registered Professional Land Surveyor to be in responsible charge of performing all survey control and boundary work.
 - 2. Name, address and certificate registration number, if applicable, of the person in responsible charge of performing all layout, measurements and calculations for the project, if opted by the Contractor. This person must be a Contractor, Professional Land Surveyor or Professional Engineer.
- I. Stakes Set by County: The Engineer will provide all construction stakes establishing right-of-way limits.
- J. Preservation of Stakes and Marks: The Contractor will be held responsible for the preservation of all the stakes and marks. If any of the stakes or marks are carelessly or willfully destroyed or disturbed by the Contractor, the cost of replacing them shall be deducted from the payment for the work.

31. LABORATORY TESTING

Cost of all required laboratory testing shall be borne by the County with the exception of the cost of failing tests and subsequent re-tests which shall be borne by the Contractor. Testing shall be in accordance with the Standard Specifications.

32. CONFORMITY OF WORK WITH PLANS

- A. All work performed and all materials furnished shall be in reasonably close conformity with the lines, grades, cross sections, dimensions, and material requirements, including tolerances, shown on the plans or indicated in the specifications.
- B. In the event the Engineer finds the materials or the finished product in which the materials are used not within reasonably close conformity with the plans and specifications, but that reasonably acceptable work has been produced, he shall then make a determination if the work shall be accepted and remain in place. In this event, the Engineer will document the basis of acceptance by contract modification which will provide for an appropriate adjustment in the contract price for such work or materials as he deems necessary to conform to his determination based on engineering judgment.
- C. For base and surface courses, the finished grade may vary as much as 0.1 foot from the grade shown in the plans, provided that all template and straight edge requirements are met and that suitable transitions are in place.

33. GUARANTEE

All work shall be guaranteed for eighteen (18) months after completion and acceptance of the work unless otherwise specified. The guarantees are to be construed as being supplemental in nature and in addition to any and all other remedies available to the County under the laws of the State of Florida.

34. WARRANTY

The Contractor shall obtain and assign to the County all express warranties given to the Contractor or any subcontractors by any material suppliers, equipment or fixtures to be incorporated into the Project. The Contractor warrants to the County that any materials and equipment furnished under the Contract Documents shall be new unless otherwise specified, and that all work shall be of good quality, free from all defects and in conformance with the Contract Documents. The Contractor further warrants to the County that all materials and equipment furnished under the Contract Documents shall be applied, installed, connected, erected, used, cleaned and conditioned in accordance with the instructions of the applicable manufacturers, fabricators, suppliers or processors except as otherwise provided for in the Contract Documents. Unless otherwise specified, if within eighteen (18) months after final completion and acceptance, any work is found to be defective or not in conformance with the Contract Documents, the Contractor shall correct it promptly after receipt of written notice from the County. The Contractor shall also be responsible for and pay for replacement or repair of adjacent materials or work which may be damaged as a result of such replacement or repair. These warranties are in addition to those implied warranties to which the County is entitled as a matter of law.

35. PUBLIC RECORDS

Pursuant to Section 119.0701, Florida Statutes, the Contractor shall comply with the Florida Public Records' laws, and shall:

- A. Keep and maintain public records required by the County to perform the services identified herein.
- B. Upon request from Lake County, provide the County with a copy of the requested records or allow the records to be inspected or copied within a reasonable time at a cost that does not exceed the cost provided in this chapter or as otherwise provided by law.
- C. Ensure that public records that are exempt or confidential and exempt from public records disclosure requirements are not disclosed except as authorized by law for the duration of the contract term and following completion of the contract if the contractor does not transfer the records to the County.
- D. Upon completion of the contract, transfer, at no cost, to the County all public records in possession of the contractor or keep and maintain public records required by the County to perform the service. If the contractor transfers all public records to the County upon completion of the contract, the contractor shall destroy any duplicate public records that are exempt or confidential and exempt from public records disclosure requirements. If the contractor keeps

and maintains public records upon completion of the contract, the contractor shall meet all applicable requirements for retaining public records. All records stored electronically must be provided to the County, upon request from the County's custodian of public records, in a format that is compatible with the information technology systems of the County.

- E. **IF THE CONTRACTOR HAS QUESTIONS REGARDING THE APPLICATION OF CHAPTER 119, FLORIDA STATUTES, TO THE CONTRACTOR'S DUTY TO PROVIDE PUBLIC RECORDS RELATING TO THIS CONTRACT, CONTACT THE CUSTODIAN OF PUBLIC RECORDS AT 352-253-6007, DMARCHESE@LAKECOUNTYFL.GOV, OR DEB MARCHESI, LAKE COUNTY PUBLIC WORKS, PO BOX 7800, TAVARES, FL 32778.**

Failure to comply with this section shall be deemed a breach of the contract and enforceable as set forth in Section 119.0701, Florida Statutes.

DIVISION J
LABORATORY TESTING AND SAMPLING SCHEDULE

| OPERATION | MATERIAL SPECIFICATION | TESTS | PROJECT REQUIREMENTS | TESTING FREQUENCY |
|-----------------------------------|---|---------------------------------|--------------------------------------|--|
| Prime and Tack Coats | FDOT Standard Specifications (Latest Edition) | | Certification | Every Transport |
| Type Superpave Asphaltic Concrete | FDOT Standard Specifications (Latest Edition) | Job Mix Formula | Certification | Each mix design or change of aggregates |
| | | RICE (Gmm) | Section 334 | One per subplot |
| | | Extraction Gradation Analysis | Section 334 | One per subplot |
| | | Field Density (Gmb) | Section 334 | 5 six Inch cores per subplot (Random Locations) |
| | | Asphalt Binder Thickness | Section 334 Section 330 | 1 sample for the first 1000 tons and 1 per 4000 tons after Daily |
| | | | | |
| Pavement Smoothness | FDOT Standard Specifications (Latest Edition) | Rolling Straight Edge | Section 330 (FM 5-509) Max 3/16 inch | Final SP structural layer and friction course layer |
| Concrete | FDOT Standard Specifications (Latest Edition) | Compression Strength | FDOT Section 346 and 347 | Section 347 acceptance based on Certification; Section 346 One (1) set of cylinders for 10 CY or more per day. Additional set(s) for each 50 CY/day. One (1) set for each class of concrete placed each day. |
| | | Each class of concrete used | Certification | Each mix design or change |
| Embankment | FDOT Standard Specifications (Latest Edition) | Standard Proctor AASHTO T-99 | Section 120 | Per material type |
| | | Field Density | Section 120 -100% AASHTO T-99/180 | Section 120-One test per 500 LF per 12" lift of embankment Section 125-One test per 300 LF of pipe trench (or between structures) per 6' lift until 1 ft above pipe; 12" lift of backfill 1 ft above pipe Section 125 (modified) One test per 12" lift of structure backfill alternating sides |
| Compacted Subgrade | FDOT Standard Specifications (Latest Edition) | Standard Proctor AASHTO T-99 | Section 120 | One per material type |
| | | Field Density | 100% AASHTO T-99 | Section 120 (modified)-One per 300 LF of sidewalk One per driveway |
| Stabilized Subgrade | FDOT Standard Specifications (Latest Edition) | Limerock Bearing Ratio FM 5-515 | Section 160 | One per 1,000 LF per lane (One per 2 lots) One per 2,000 LF per shoulder (One per 4 lots) |
| | | Field Density/Thickness | Section 160-98% AASHTO T-180 | Density-One per 500 LF per lane (1 per lot) Thickness - 3 per lot Density/thickness (modified)-One per 500 LF per shoulder |
| Limerock Base Course | FDOT Standard Specifications (Latest Edition) | Modified Proctor AASHTO T-180 | Section 200 | One per 8 lots |
| | | Field Density/Thickness | Section 200-98% AASHTO T-180 | Density-One per 300 LF per lane Thickness- 3 per lot Density/Thickness-One per 500 LF per shoulder |
| Sodding | FDOT Standard Specifications (Latest Edition) Section 575, Sodding, and Section 981 | Each type of sod used | Certification | All seed, sod and mulch shall be free of noxious weeds and exotic pest plants, plant parts or seed listed in the current Category I "List of Invasive Species" from the Florida Exotic Pest Plant Council |

This page to be used if permits are required.

DIVISION P

PERMITS

BID NO. 2026-01

PERMIT INDEX

| <u>AGENCY</u> | <u>PERMIT NO.</u> | <u>PAGE NO. (s)</u> |
|---------------|-------------------|---------------------|
| | | |
| | | |
| | | |
| | | |
| | | |

DIVISION W

BID FORM

BULLDOG SITEWORK LLC

COMPANY NAME

NOTE: BIDDER SHALL SUBMIT BID IN DUPLICATE ON FORM PROVIDED HEREIN.

BID

OF

NAIARA PETRALANDA

(Name)

PO BOX 490048, LEESBURG, FL 34749

(Address)

(352) 267-4664

(Phone No.)

FOR

BID NO. 26-702

NORTH LAKE TRAIL – EAST COLLINS STREET TO BEACH STREET
PROJECT NO. 2026-01

Lake County, Florida

Submitted DEC 11 2025

TO THE COUNTY OF LAKE, FLORIDA:

We, the undersigned, hereby declare that no person or persons, firm or corporation, other than the undersigned, are interested in this proposal, as principals, and that this Bid is made without collusion with any person, firm or corporation, and we have carefully and to our full satisfaction examined the Special Provisions and form of Contract and Bond, together with the approved Plans and Specifications for the above described project, and that we have made a full examination of the location of the proposed work and the source of supply of materials, and we hereby agree to furnish all necessary labor, equipment, and materials, fully understanding that the quantities shown herewith are approximate only, and that we will fully complete all necessary work in accordance with the Plans and Specifications, and the requirements under them of the Engineer, within the time limit specified in this Bid for the following unit values, to-wit:

BID FORM – TABULATION OF ESTIMATED QUANTITIES
 NORTH LAKE TRAIL – EAST COLLINS STREET TO BEACH STREET
 PROJECT NO. 2026-01, BID NO. 26-702
BASE BID - STA 12+60 TO STA 42+50

| Item Number | Item Description | Unit | Unit Price | Quantity | Amount |
|-------------------------------|---|------|------------|----------|-----------|
| 0101 1 | MOBILIZATION | LS | 55519.28 | 1 | 55519.28 |
| 0102 1 | MAINTENANCE OF TRAFFIC | DA | 423.14 | 10 | 4231.40 |
| 0104 10 3 | SEDIMENT BARRIER | LF | 2.62 | 3853 | 10094.86 |
| 0110 4 10 | REMOVAL OF EXISTING CONCRETE | SY | 36.24 | 103 | 3732.72 |
| 0120 1 | REGULAR EXCAVATION | CY | 29.99 | 706 | 21172.94 |
| 0120 2 2 | BORROW EXCAVATION, TRUCK MEASURE | CY | 18.63 | 553 | 10302.39 |
| 0160 4 | TYPE B STABILIZATION | SY | 5.91 | 5441 | 32156.31 |
| 0285704 | OPTIONAL BASE, BASE GROUP 04 | SY | 16.65 | 4065 | 67682.25 |
| 0334 1 12 | SUPERPAVE ASPHALTIC CONC, TRAFFIC B | TN | 284.72 | 292 | 83138.24 |
| 0430175118 | PIPE CULVERT, OPTIONAL MATERIAL, ROUND, 18"S/CD | LF | 0 | 0 | 0 |
| 0430982125 | MITERED END SECTION, OPTIONAL ROUND, 18" CD | EA | 0 | 0 | 0 |
| 0522 1 | CONCRETE SIDEWALK AND DRIVEWAYS, 4" THICK | SY | 0 | 0 | 0 |
| 0522 2 | CONCRETE SIDEWALK AND DRIVEWAYS, 6" THICK | SY | 112.38 | 908 | 102041.04 |
| 0523 3 | PATTERNED PAVEMENT | SY | 0 | 0 | 0 |
| 0527 2 | DETECTABLE WARNINGS | SF | 48.00 | 247 | 11856.00 |
| 0570 1 2 | PERFORMANCE TURF, SOD | SY | 7.49 | 4200 | 31458.00 |
| 0634 4600 | SPAN WIRE ASSEMBLY, REMOVE- POLES REMAIN | PI | 900.00 | 1 | 900.00 |
| 0700 1111 | SINGLE COLUMN GROUND SIGN ASSEMBLY, F&I GROUND MOUNT, LESS THAN 12 SF | EA | 363.60 | 25 | 9090.00 |
| 0700 1500 | SINGLE COLUMN GROUND SIGN ASSEMBLY, RELOCATE | EA | 210.12 | 5 | 1050.60 |
| 0710 90 | PAINTED PAVEMENT MARKINGS, FINAL SURFACE | LS | 9348.20 | 1 | 9348.20 |
| Continued on Next Page | | | | | |

BID FORM – TABULATION OF ESTIMATED QUANTITIES
 NORTH LAKE TRAIL – EAST COLLINS STREET TO BEACH STREET
 PROJECT NO. 2026-01, BID NO. 26-702
BASE BID - STA 12+60 TO STA 42+50

| Item Number | Item Description | Unit | Unit Price | Quantity | Amount |
|---|---|------|--|----------|---------|
| 0711 11123 | THERMOPLASTIC, STANDARD, WHITE, SOLID, 12" FOR CROSSWALK AND ROUNDABOUT | LF | 4.80 | 322 | 1545.60 |
| 0711 11125 | THERMOPLASTIC, STANDARD, WHITE, SOLID, 24" FOR STOP LINE AND CROSSWALK | LF | 9.60 | 337 | 3235.20 |
| 0711 11170 | THERMOPLASTIC, STANDARD, WHITE, ARROW | EA | 603.30 | 4 | 2413.20 |
| 0711 11180 | THERMOPLASTIC, STANDARD, WHITE, YIELD LINE | LF | 0 | 0 | 0 |
| 0711 15101 | THERMOPLASTIC, STANDARD-OPEN GRADED ASPHALT SURFACES WHITE, SOLID, 6" | GM | 4800.00 | 0.1 | 480.00 |
| 1080 21500 | UTILITY FIXTURE, VALVE/METER BOX, ADJUST | EA | 720.23 | 1 | 720.23 |
| | MOWING | LS | 1980.00 | 1 | 1980.00 |
| | LITTER REMOVAL | LS | 4246.20 | 1 | 4246.20 |
| 0430175115 | PIPE CULVERT, OPTIONAL MATERIAL, ROUND, 15" S CD | LF | 125.10 | 34 | 4253.40 |
| 0430982123 | MITERED END SECTION, OPTIONAL ROUND, 15" CD | EA | 1941.60 | 2 | 3883.20 |
| | CONCRETE SEPARATOR (FDOT INDEX 520-020) | EA | 7632.00 | 1 | 7632.00 |
| 0110 11 | CLEAR & GRUBB | AC | 4616.25 | 1.63 | 7524.49 |
| Subtotal Base Bid (Figures) | | | \$491,687.75 | | |
| Subtotal Base Bid (Words) | | | FOUR HUNDRED NINETY-ONE THOUSAND SIX HUNDRED EIGHTY-SEVEN AND SEVENTY-FIVE CENTS | | |
| Number of Calendar Days to Complete Base Bid Construction | | | 120 DAYS | | |
| Continued on Next Page | | | | | |

BID FORM - TABULATION OF ESTIMATED QUANTITIES
 NORTH LAKE TRAIL - EAST COLLINS STREET TO BEACH STREET
 PROJECT NO. 2026-01, BID NO. 26-702

ALTERNATE BID #1 STA 42+50 TO STA 58+50

| Item Number | Item Description | Unit | Unit Price | Quantity | Amount |
|------------------------|---|------|------------|----------|----------|
| 0101 1 | MOBILIZATION | LS | 41827.66 | 1 | 41827.66 |
| 0102 1 | MAINTENANCE OF TRAFFIC | DA | 330.30 | 5 | 1651.50 |
| 0104 10 3 | SEDIMENT BARRIER | LF | 3.00 | 1783 | 5349.00 |
| 0110 4 10 | REMOVAL OF EXISTING CONCRETE | SY | 35.79 | 42 | 1503.18 |
| 0120 1 | REGULAR EXCAVATION | CY | 43.05 | 157 | 6758.85 |
| 0120 2 2 | BORROW EXCAVATION, TRUCK MEASURE | CY | 24.66 | 959 | 23648.94 |
| 0160 4 | TYPE B STABILIZATION | SY | 7.67 | 3147 | 24137.49 |
| 0285704 | OPTIONAL BASE, BASE GROUP 04 | SY | 16.88 | 2845 | 48023.60 |
| 0334 1 12 | SUPERPAVE ASPHALTIC CONC, TRAFFIC B | TN | 278.40 | 206 | 57350.40 |
| 0430175115 | PIPE CULVERT, OPTIONAL MATERIAL, ROUND, 15"S/CD | LF | 106.94 | 86 | 9196.84 |
| 0430982123 | MITERED END SECTION, OPTIONAL ROUND, 15" CD | EA | 1905.60 | 4 | 7622.40 |
| 0515 1 2 | PIPE HANDRAIL - GUIDERAIL, ALUMINUM | LF | 92.19 | 400 | 36876.00 |
| 0522 1 | CONCRETE SIDEWALK AND DRIVEWAYS, 4" THICK | SY | 0 | 0 | 0 |
| 0522 2 | CONCRETE SIDEWALK AND DRIVEWAYS, 6" THICK | SY | 142.20 | 122 | 17348.40 |
| 0523 3 | PATTERNED PAVEMENT | SY | 0 | 0 | 0 |
| 0527 2 | DETECTABLE WARNINGS | SF | 0 | 0 | 0 |
| 0570 1 2 | PERFORMANCE TURF, SOD | SY | 7.59 | 3300 | 25047.00 |
| 0639 2 4 | ELECTRICAL SERVICE WIRE, RELOCATE | LF | 0 | 0 | 0 |
| 0700 1111 | SINGLE COLUMN GROUND SIGN ASSEMBLY, F&I GROUND MOUNT, LESS THAN 12 SF | EA | 0 | 0 | 0 |
| 0700 1500 | SINGLE COLUMN GROUND SIGN ASSEMBLY, RELOCATE | EA | 0 | 0 | 0 |
| Continued on Next Page | | | | | |

BID FORM – TABULATION OF ESTIMATED QUANTITIES
 NORTH LAKE TRAIL – EAST COLLINS STREET TO BEACH STREET
 PROJECT NO. 2026-01, BID NO. 26-702
ALTERNATE BID #1 STA 42+50 TO STA 58+50

| Item Number | Item Description | Unit | Unit Price | Quantity | Amount |
|---|--|------|--|----------|----------|
| 0710 90 | PAINTED PAVEMENT MARKINGS, FINAL SURFACE | LS | 0 | 0 | 0 |
| | MOWING | LS | 903.56 | 1 | 903.56 |
| | LITTER REMOVAL | LS | 3075.63 | 1 | 3075.63 |
| 0110 1 1 | CLEAR AND GRUBB | AC | 12406.56 | 1.18 | 14639.75 |
| | | | | | |
| | | | | | |
| | | | | | |
| | | | | | |
| | | | | | |
| | | | | | |
| | | | | | |
| | | | | | |
| Subtotal Alternate #1 (Figures) | | | \$ 324,960.20 | | |
| Subtotal Alternate #1 (Words) | | | THREE HUNDRED TWENTY-FOUR THOUSAND NINE HUNDRED SIXTY AND TWENTY CENTS | | |
| Number of Calendar Days to Complete Alternate #1 Construction | | | 75 | | |
| | | | | | |
| | | | | | |
| | | | | | |
| | | | | | |
| Continued on Next Page | | | | | |

BID FORM – TABULATION OF ESTIMATED QUANTITIES
 NORTH LAKE TRAIL – EAST COLLINS STREET TO BEACH STREET
 PROJECT NO. 2026-01, BID NO. 26-702

ALTERNATE BID #2 STA 58+50 TO STA 74+00

| Item Number | Item Description | Unit | Unit Price | Quantity | Amount |
|------------------------|---|------|------------|----------|----------|
| 0101 1 | MOBILIZATION | LS | 37964.55 | 1 | 37964.55 |
| 0102 1 | MAINTENANCE OF TRAFFIC | DA | 663.87 | 3 | 1991.61 |
| 0104 10 3 | SEDIMENT BARRIER | LF | 2.67 | 2624 | 7006.08 |
| 0110 4 10 | REMOVAL OF EXISTING CONCRETE | SY | 39.72 | 151 | 5997.72 |
| 0120 1 | REGULAR EXCAVATION | CY | 17.33 | 231 | 4003.23 |
| 0120 2 2 | BORROW EXCAVATION, TRUCK MEASURE | CY | 105.81 | 46 | 4867.26 |
| 0160 4 | TYPE B STABILIZATION | SY | 7.50 | 2798 | 20985.00 |
| 0285704 | OPTIONAL BASE, BASE GROUP 04 | SY | 16.78 | 2407 | 40389.46 |
| 0334 1 12 | SUPERPAVE ASPHALTIC CONC, TRAFFIC B | TN | 281.40 | 180 | 50652.00 |
| 0430175118 | PIPE CULVERT, OPTIONAL MATERIAL, ROUND, 18"S/CD | LF | 0 | 0 | 0 |
| 0430982125 | MITERED END SECTION, OPTIONAL ROUND, 18" CD | EA | 0 | 0 | 0 |
| 0522 1 | CONCRETE SIDEWALK AND DRIVEWAYS, 4" THICK | SY | 0 | 0 | 0 |
| 0522 2 | CONCRETE SIDEWALK AND DRIVEWAYS, 6" THICK | SY | 121.08 | 271 | 32812.68 |
| 0523 3 | PATTERNED PAVEMENT | SY | 0 | 0 | 0 |
| 0527 2 | DETECTABLE WARNINGS | SF | 48.00 | 235 | 11280.00 |
| 0570 1 2 | PERFORMANCE TURF, SOD | SY | 6.77 | 2300 | 15571.00 |
| 0634 4600 | SPAN WIRE ASSEMBLY, REMOVE- POLES REMAIN | PI | 0 | 0 | 0 |
| 0700 1111 | SINGLE COLUMN GROUND SIGN ASSEMBLY, F&I GROUND MOUNT, LESS THAN 12 SF | EA | 360.00 | 22 | 7920.00 |
| 0700 1500 | SINGLE COLUMN GROUND SIGN ASSEMBLY, RELOCATE | EA | 305.68 | 1 | 305.68 |
| 0710 90 | PAINTED PAVEMENT MARKINGS, FINAL SURFACE | LS | 6892.28 | 1 | 6892.28 |
| Continued on Next Page | | | | | |

BID FORM – TABULATION OF ESTIMATED QUANTITIES
 NORTH LAKE TRAIL – EAST COLLINS STREET TO BEACH STREET
 PROJECT NO. 2026-01, BID NO. 26-702
ALTERNATE BID #2 STA 58+50 TO STA 74+00

| Item Number | Item Description | Unit | Unit Price | Quantity | Amount |
|---|---|------|--|----------|---------|
| 0711 11123 | THERMOPLASTIC, STANDARD, WHITE, SOLID, 12" FOR CROSSWALK AND ROUNDABOUT | LF | 6.00 | 201 | 1206.00 |
| 0711 11125 | THERMOPLASTIC, STANDARD, WHITE, SOLID, 24" FOR STOP LINE AND CROSSWALK | LF | 10.49 | 272 | 2853.28 |
| 0711 11170 | THERMOPLASTIC, STANDARD, WHITE, ARROW | EA | 0 | 0 | 0 |
| 0711 11180 | THERMOPLASTIC, STANDARD, WHITE, YIELD LINE | LF | 0 | 0 | 0 |
| 0711 15101 | THERMOPLASTIC, STANDARD-OPEN GRADED ASPHALT SURFACES WHITE, SOLID, 6" | GM | 0 | 0 | 0 |
| 1080 21500 | UTILITY FIXTURE, VALVE/METER BOX, ADJUST | EA | 0 | 0 | 0 |
| | MOWING | LS | 397.78 | 1 | 397.78 |
| | LITTER REMOVAL | LS | 3312.77 | 1 | 3312.77 |
| 0110 1 1 | CLEAR AND GRUBB | AC | 12196.05 | 0.76 | 9269.00 |
| 0700 1500 | ELECTRICAL SERVICE WIRE, RELOCATE | LF | 60.00 | 20 | 1200.00 |
| | | | | | |
| | | | | | |
| Subtotal Alternate #2 (Figures) | | | \$ 266,877.38 | | |
| Subtotal Alternate #2 (Words) | | | TWO HUNDRED SIXTY-SIX THOUSAND EIGHT HUNDRED SEVENTY-SEVEN AND THIRTY-EIGHT CENTS | | |
| Number of Calendar Days to Complete Alternate #2 Construction | | | 75 | | |
| | | | | | |
| TOTAL BASE BID PLUS ALTERNATES #1 AND #2 (Figures) | | | \$ 1,083,525.33 | | |
| TOTAL BASE BID PLUS ALTERNATES #1 AND #2 (Words) | | | ONE MILLION EIGHTY-THREE THOUSAND FIVE HUNDRED TWENTY-FIVE AND THIRTY-THREE CENTS | | |
| NUMBER OF CALENDAR DAYS TO COMPLETE BASE BID AND ALTERNATES #1 AND #2 CONSTRUCTION | | | 270 | | |

The undersigned further agrees to execute the Contract within ten (10) calendar days after receipt of notice of award, and within the time frame of Division X.

The undersigned further agrees to bear the full cost of maintaining all work until the final acceptance.

The undersigned further declares that his Bid is based on specifications as modified by the following Addenda:

Addendum No. 1 Dated 11/19/25 Addendum No. 4 Dated 12/3/2025
Addendum No. 2 Dated 11/20/25 Addendum No. _____ Dated _____
Addendum No. 3 Dated 11/26/25 Addendum No. _____ Dated _____

The undersigned Contractor's address and principal place of business is 609 HWY 466, LADY LAKE, FL 32159.

If Contractor is a corporation list the names, titles, and business addresses of its President, Secretary and Treasurer:

1. PRESIDENT _____ Address _____
(Name)
2. SECRETARY _____ Address _____
(Name)
3. TREASURER _____ Address _____
(Name)

Said corporation is qualified to do business in the State of Florida.

Corporate Name

By: _____
_____, President
(Print Name)

CORPORATE SEAL

or Qualifying Agent

Contractor's Registration or Certification No.

If Contractor is not a corporation, list the name(s) and business address(es) of its owner(s), joint venturers or partners:

1. NAIARA PETRALANDA Address 1533 YOUNGS RD
(Name) LEESBURG, FL 34748

2. _____ Address _____
(Name)

3. _____ Address _____
(Name)

The said company or business entity is a sole proprietorship, partnership, or joint venture and is trading and doing business as BULLDOG SITEWORK LLC (Company Name).

By: NAIARA PETRALANDA
Name of Firm or Qualifying Agent

WC 1225579 / CBC 1261467
Contractor's Registration or Certification No.

FLORIDA TRENCH SAFETY ACT CERTIFICATION AND DISCLOSURE STATEMENT

The undersigned acknowledges the requirements of the Florida Trench Safety Act (Section 553.60 et. seq. Florida Statutes).

A. The Bidder further acknowledges that the Florida Trench Safety Act, (the Act) establishes the Federal excavation safety standards set forth at 29 C.F.R. Section 1926.650 Subpart P, as the interim state standard until such time as the State of Florida, through its Department of Labor and Employment Security, or any successor agency, adopts, updates or revises said interim standard. This State of Florida standard may be supplemented by special shoring requirements established by the State of Florida or any of its political subdivisions.

B. The Bidder, as Contractor, shall comply with all applicable excavation/trench safety standards.

C. The Contractor shall consider the geotechnical data available from the County, if any, the Contractor's own sources, and all other relevant information in its design of the trench safety system to be employed on the subject Project. The Contractor acknowledges sole responsibilities for the selection of the data on which it relies in designing the safety system, as well as for the system itself.

D. The amounts that the Bidder has set forth for pipe installation includes the following excavation/trench safety measures and the linear feet of trench excavated under each safety measure. These units, costs, and unit values shall be disclosed solely for the purpose of compliance with procedural requirements of the Act. No adjustment to the Contract time or price shall be made for any difference in the actual number of linear feet of trench excavation, except as may be otherwise provided in these Contract Documents.

| Trench Safety Measure (Description) | Units of Measure (LF, SF) | Unit (Quantity) | Unit Cost | Extended Cost |
|-------------------------------------|---------------------------|-----------------|-------------|---------------|
| A. \emptyset | \emptyset | \emptyset | \emptyset | \emptyset |
| B. | | | | |
| C. | | | | |
| D. | | | | |
| E. | | | | |
| F. | | | | |

For Information Only, Not for Payment Purposes \$ 0.00

Bidder may use additional sheets as necessary to extend this form.

Failure to complete the above may result in the bid being declared non-responsive.

E. The amount disclosed as the cost of compliance with the applicable trench safety requirements does not constitute the extent of the Contractor's obligation to comply with said standards. The Contractor shall extend additional sums at no additional cost to the County, if necessary, to comply with the Act (except as may otherwise be provided).

F. Acceptance of the bid to which this certification and disclosure applies in no way represents that the County or its representative has evaluated and thereby determined that the above costs are adequate to comply with the applicable trench safety requirements nor does it in any way relieve the Contractor of its sole responsibility to comply with the applicable trench safety requirements.

BULLDOG SITEWORK LLC
Company

NALARA PETRALANDA, OWNER
Name and Title

Address:

PO BOX 490048

LEESBURG, FL 34749

Telephone: (352) 267-4664

DIVISION X

AGREEMENT

THIS AGREEMENT, made and entered into by and between the Board of County Commissioners of Lake County, a political subdivision of the State of Florida, hereinafter designated the COUNTY, and Bulldog Sitework LLC authorized to do business in the State of Florida, with principal place of business located at PO Box 490048, Leesburg, FL 34749 hereinafter designated the CONTRACTOR,

WITNESSETH:

That for and in consideration of the sum of One Million Eighty Three Thousand Five Hundred Twenty Five and 33/100 Dollars (\$1,083,525.33) to be paid by the COUNTY to the CONTRACTOR as herein provided, and in further consideration of the mutual covenants and promises to be kept and performed by and between the parties hereto, it is agreed as follows:

A. THE CONTRACTOR AGREES:

1. To furnish all services, labor, materials and equipment necessary for the complete performance, in a thorough and workmanlike manner, of the work contemplated under North Lake Trail – East Collins Street to Beach Street; Project No. 2026-01, Bid No. 26-702 in Lake County, Florida, to comply with the applicable standards, and to perform all work in strict accordance with the terms of the Contract Documents, defined in Section D of this Agreement.

2. To commence work under this contract with an adequate force and equipment within thirty (--30--) consecutive calendar days after receipt of written notice from the COUNTY to proceed hereunder, and to fully complete all necessary work under the same within not more than Two Hundred Seventy (270) consecutive calendar days. It is understood and agreed that the date on which the consecutive calendar days will begin to be charged to the project shall be the thirtieth (30th) calendar day from the date of receipt

of the Notice to Proceed. Time of performance and completion of the work of this contract is of the essence.

3. That upon failure to complete all work within the time provided for above, the Contractor shall pay to the County such sums as shall be determined in accordance with the Liquidated Damages provision of this contract, and the payment of such sum shall be secured as provided for therein.

4. That the CONTRACTOR and each subcontractor shall furnish to the COUNTY, upon demand, a certified copy of the payroll covering work under this contract, together with such other information as may be required by the COUNTY to ensure compliance with the law and the provisions of this contract.

5. To procure and maintain all insurance as required by the Instructions to Bidders.

6. To procure and maintain all permits and licenses which may be required by law in connection with the prosecution of the work contemplated hereunder, except for those permits obtained by the County as expressly set forth in Division P of the Contract Documents.

7. To permit any representative(s) of the COUNTY, at all reasonable times, to inspect the work in progress or any of the materials used or to be used in connection therewith, whether such work is located on or off the project site, and to furnish promptly, without additional charge, all reasonable facilities, labor and materials deemed necessary by the County's Engineer, for the conducting of such inspections and tests as he may require.

8. Unless otherwise provided in the special provisions, conditions and specifications, to assume liability for all damage to work under construction or completed, whether from fire, water, winds, vandalism, or other causes, until final completion and acceptance by the County and notwithstanding the fact that partial payments may have been made during construction.

9. No subcontract or transfer of contract shall in any case release either the Contractor or his surety of any liability under the contract and bonds. The County reserves the right to reject any subcontractors or equipment.

10. The Contractor shall indemnify, pay the cost of defense, including attorneys' fees, and hold harmless the County from all suits, actions or claims of any character brought on account of any injuries or damages received or sustained by any person, persons or property by or from the said Contractor; or by, or in consequence of any neglect in safeguarding the work; or through the use of unacceptable materials in the construction of improvements; or by, or on account of any act or omission, neglect or misconduct of the said Contractor; or by, or on account of, any claim or amounts recovered for any infringement of patent, trademark or copyright; or from any claims or amounts arising or recovered under the "Workers' Compensation Law" or of any other laws, by-laws, ordinance, order or decree, including any joint negligence of the County, except only such injury or damage as shall negligence of the County, except only such injury or damage as shall have been occasioned by the sole negligence of the County; and so much of the money due the said Contractor under and by virtue of his Contract as shall be considered necessary, may be retained by the County or, in case no money is due, his surety shall be held until such suits, actions or claims for injuries or damages shall have been settled and suitable evidence to that effect furnished to the County. The County and the Contractor agree the first \$100.00 of the Contract amount paid by the County to the Contractor shall be given as separate consideration for this indemnification, and any other indemnification of the County by the Contractor provided for within the Contract Documents, the sufficiency of such separate consideration being acknowledged by the Contractor by the Contractor's execution of the Agreement.

The Contractor shall guarantee the payment of all just claims for materials, supplies, tools, labor or other just claims against him or any subcontractor in connection with this

Contract; and his bonds will not be released by final acceptance and payment by the County unless all such claims are paid or released.

B. THE COUNTY AGREES:

To pay to the Contractor the contract price hereinabove specified, as follows:

If progress satisfactory to the County is being made by the Contractor, the Contractor will receive partial payments, not more frequently than once a month, on this contract as the work progresses, based upon estimates of the amount of work done less payments previously made. The County shall withhold 5% of each progress payment. Payment of retainage shall be as set forth in Section 218.735, Florida Statutes. Neither progress payment nor partial or entire use or occupancy of the project by the County shall constitute an acceptance of work not in accordance with the Contract Documents.

The County, prior to making of any payment, may require the Contractor to furnish a certificate or other evidence showing the amount of work done or completed at that time.

C. IT IS MUTUALLY AGREED:

1. That no change, alteration, amendment, payment for extra work or agreement to pay for same, shall be binding upon the County until its Engineer has approved the same, and until the same shall be properly approved in accordance with Board policy.

2. That the Engineer shall represent the County insofar as prosecution of the work, and interpretation of the plans and specifications are concerned, and that no payments shall be made by the County under this contract except upon the certificate of the Engineer.

3. This Contract shall be interpreted under and its performance governed by the laws of the State of Florida.

4. The failure of the County to enforce at any time or for any period of time any one or more of the provisions of the Contract Documents shall not be construed to

be and shall not be a waiver of any such provision or provisions or of its rights thereafter to enforce each and every such provision.

5. Each of the parties hereto agrees and represents that this Contract comprises the full and entire agreement between the parties affecting the work contemplated, and that no other agreement or understanding of any nature concerning the same has been entered into or will be recognized, and that all negotiations, acts, work performed, or payments made prior to execution hereof shall be deemed merged into, integrated and superseded by this Contract.

6. Should any provision of this Contract be determined by a court to be unenforceable, such determination shall not affect the validity or enforceability of any section or part thereof.

D. The following named Documents, which shall be referred to as the "Contract Documents," are by reference hereby incorporated into this contract:

| | | |
|----------|---------------|--|
| DIVISION | A | Instructions to Bidders |
| DIVISION | B | General Conditions |
| DIVISION | J | Laboratory Testing and Sampling Schedule |
| DIVISION | P | Permits |
| DIVISION | W | Proposal and Bid |
| DIVISION | Y | Performance Bond Payment Bond |
| DIVISION | Z | Affidavit by General Contractor |
| APPENDIX | A1 | "Sample Change Order" |
| ADDENDUM | #1 through #4 | |

Construction Plans prepared by the Engineer of record for this project.

E. Notices.

1. All notices, demands, or other writings required to be given or made or sent in this Contract, or which may be given or made or sent, by either party to the other, shall be deemed to have been fully given or made or sent when in writing and addressed as follows:

| | |
|-----------------------------|----------------------|
| <u>County</u> | <u>Contractor</u> |
| County Manager | Naiara Petralanda |
| P. O. Box 7800 | Bulldog Sitework LLC |
| 315 West Main Street | PO Box 490048 |
| Tavares, Florida 32778-7800 | Leesburg, FL 34749 |

CC: Public Works Director
PO Box 7800
Tavares, FL 32778

2. All notices required, or which may be given hereunder, shall be considered properly given if (a) personally delivered, (b) sent by certified United States mail, return receipt requested, or (c) sent by Federal Express or other equivalent overnight letter delivery company.

3. The effective date of such notices shall be the date personally delivered, or if sent by mail, the date of the postmark, or if sent by overnight letter delivery company, the date the notice was picked up by the overnight letter delivery company.

4. Parties may designate other parties or addresses to which notice shall be sent by notifying, in writing, the other party in a manner designed for the filing of notice hereunder.

F. This contract shall be binding upon, and shall insure to the benefit of the executors, administrators, heirs, successors and assigns of the Contractor.

IN WITNESS WHEREOF, the parties hereto have caused this instrument to be executed on the day and year as written.

LAKE COUNTY acting by and through its Board of County Commissioners

Leslie Campione
Leslie Campione, Chairman

This 4th day of March, 2026.

BULLDOG SITEWORK LLC

Naiara Petralanda
Naiara Petralanda, President

This 23 day of Feb, 2026.

ATTEST:

Gary J. Cooney
Gary J. Cooney, Clerk of the Board of County Commissioners of Lake County, Florida

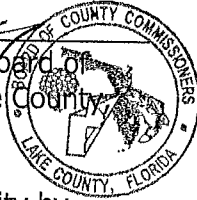

Approved as to form and legality by County Attorney for Lake County, Florida
Lake County Administration Building
315 West Main Street
Tavares, Florida 32778
(352) 343-9787

Melanie Marsh 3/4/26
Melanie Marsh
County Attorney

ATTEST: _____

Print Name: _____
Title: _____

CORPORATE SEAL

OR

WITNESSES:
Diane Burgess
Print Name: DIANE BURGESS

Charity Witt
Print Name: Charity Witt

Business Address: PO BOX 490048
LEESBURG, FL 34749

Contractor's Reg. or Cert. No.

LC1225579

CBC 1261467

DIVISION Y

BONDS

Executed in 3 Counterparts

BOND NO. 101715688

PERFORMANCE BOND

KNOW ALL MEN BY THESE PRESENTS: that We,

Contractor Bulldog Sitework, LLC
Contractor Address P.O. Box 490048
Contractor Address 2 Leesburg, FL 34749
Contractor Phone (352) 267-4664

(hereinafter called the "Principal"), whose principal business address and telephone number is as stated above; and

Surety Merchants National Bonding, Inc.
Surety Address PO Box 14498, Des Moines, IA 50306-3498
Surety Address 2 6700 Westtown Parkway, West Des Moines, IA 50266-7754
Surety Phone (515) 243-8171

(hereinafter called the "Surety"), whose principal address and telephone number is as stated above, a surety insurer chartered and existing under the laws of the State of Iowa and authorized to do business in the State of Florida;

are held and firmly bound unto Lake County Board of County Commissioners, Lake County, Florida, a political subdivision of the State of Florida, whose principal address is P.O. Box 7800, Tavares, Florida 32778, and whose principal telephone number is (352) 253-6000 (hereinafter called the "Obligee"), in the sum of One Million Eighty-Three Thousand Five Hundred Twenty-Five and 33/100 Dollars Dollars (\$1,083,525.33),

for payment of which we bind ourselves, our heirs, our legal representatives, our successors and our assignees, jointly and severally.

WHEREAS, Principal has entered into a contract with Obligee as the owner for North Lake Trail - East Collins Street to Beach Street; Project No. 2026-01, Bid No. 26-702* (hereinafter called the "Contract"), which conditions and provisions as are further described in the aforementioned Contract, which Contract is incorporated herein by reference and made a part hereof for the purpose of perfecting this bond.

NOW THEREFORE, THE CONDITION OF THIS BOND, are such that if Principal:

1. Fully, promptly, and faithfully performs the Contract at the times and in the manner prescribed in the Contract, including all obligations imposed by the Contract documents, specifications, and changes orders; and
2. Pays Obligee any and all losses, damages, costs and attorneys' fees, including appellate proceedings, that Obligee sustains because of any default by Principal under the Contract, including, but not limited to, all delay damages, whether liquidated or actual, incurred by Obligee; and

Executed in 3 Counterparts

- 3. Performs the guarantee of all work and materials furnished under the Contract for the time specified in the Contract; and
- 4. Promptly make all payments to all persons defined in Section 713.01, Florida Statutes, as amended, whose claims derive directly or indirectly from the prosecution of the work provided for in the Contract;

then this bond shall be void; otherwise it remains in full force and effect.

The Surety, for value received, hereby stipulates and agrees that no changes, extensions of time, alterations or additions to the terms of the Contract or other work to be performed hereunder, or the specifications referred to therein shall in any way affect Surety's obligation under this bond, and it does hereby waive notice of any such changes, extensions of time, alterations or additions to the terms of the Contract or to work or to the specifications.

This instrument shall be construed in all respects as a statutory bond. It is expressly understood the time provisions and statute of limitations under Section 255.05, Florida Statutes, as amended, shall apply to this bond.

By execution of this bond, the Surety acknowledges that it has read the Surety qualifications and obligations imposed by the Contract and hereby satisfies those conditions.

The parties agree that this public performance bond and any claims instituted under this bond shall be governed by the laws, rules and regulations of the State of Florida and venue shall be in a court of competent jurisdiction in and for Lake County, Florida.

IN WITNESS WHEREOF, the above bounded parties have executed this instrument on the day and year below mentioned, the name of each party being affixed and these presents duly signed by its/their undersigned representative(s), pursuant to authority of its governing body.

Signed, sealed and delivered
in the presence of:

Contractor, as PRINCIPAL:

Company: Bulldog Sitework, LLC

By: [Signature]
(Authorized Signature)

Printed Name: NAIARA PETRALANDA

Title: OWNER

Date: 2/23/2026

[Signature]

#1 Witness as to Principal

[Signature]

#2 Witness as to Principal

STATE OF FLORIDA
COUNTY OF Lake

The foregoing instrument was acknowledged before me by means of physical presence or online notarization, this 23rd day of Feb, 2026, by Naiara Petralanda as President for Bulldog Sitework, LLC.

Personally Known OR Produced Identification
Type of Identification Produced _____

[Signature]
(Notary Signature)

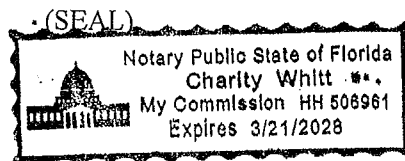

Executed in 3 Counterparts
BOND NO. 101715688

SURETY:

Company: Merchants National Bonding, Inc.

By: N/A
(Authorized Signature)

Printed Name: N/A

Title: N/A

Date: N/A

N/A
#1 Witness as to Surety

N/A
#2 Witness as to Surety

OR BY ATTORNEY IN FACT (POWER OF ATTORNEY MUST BE ATTACHED)

Merchants National Bonding, Inc.

By: Jeffrey W. Reich
(As Attorney In Fact) & FL Lic. Resident Agent

Printed Name: Jeffrey W. Reich*

Date: 01/27/2026

Address: PO Box 14498
Des Moines, IA 50306-3498

Phone: Surety: (515) 243-8171 *Agent: (407) 786-7770

Meadow Medal
#1 Witness as Attorney In Fact, Meadow Medal

Sophia Golecki
#2 Witness as Attorney In Fact, Sophia Golecki

STATE OF FLORIDA
COUNTY OF ORANGE

The foregoing instrument was acknowledged before me by means of physical presence or online notarization, this 27th day of January, 2026, by Jeffrey W. Reich as Attorney-in-Fact for Merchants National Bonding, Inc.

Personally Known OR Produced Identification
Type of Identification Produced N/A

Migdiel Burgos
(Notary Signature) Migdiel Burgos

(SEAL)

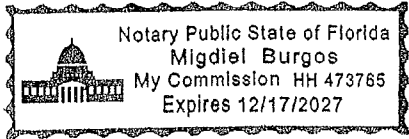

Executed in 3 Counterparts

BOND NO. 101715688

PAYMENT BOND

KNOW ALL MEN BY THESE PRESENTS: that We,

Contractor Bulldog Sitework, LLC
Contractor Address P.O. Box 490048
Contractor Address 2 Leesburg, FL 34749
Contractor Phone (352) 267-4664

(hereinafter called the "Principal"), whose principal business address and telephone number is as stated above; and

Surety Merchants National Bonding, Inc.
Surety Address PO Box 14498, Des Moines, IA 50306-3498
Surety Address 2 6700 Westtown Parkway, West Des Moines, IA 50266-7754
Surety Phone (515) 243-8171

(hereinafter called the "Surety"), whose principal address and telephone number is as stated above, a surety insurer chartered and existing under the laws of the State of Iowa and authorized to do business in the State of Florida;

are held and firmly bound unto Lake County Board of County Commissioners, Lake County, Florida, a political subdivision of the State of Florida, whose principal address is P.O. Box 7800, Tavares, Florida 32778, and whose principal telephone number is (352) 253-6000 (hereinafter called the "Obligee"), in the sum of One Million Eighty-Three Thousand Five Hundred Twenty-Five and 33/100 Dollars Dollars (\$1,083,525.33)

for payment of which we bind ourselves, our heirs, our legal representatives, our successors and our assignees, jointly and severally.

WHEREAS, Principal and Obligee as Owner have reached a mutual agreement for North Lake Trail – East Collins Street to Beach Street; Project No. 2026-01, Bid No. 26-702* (hereinafter referred to as the "Contract") which conditions and provisions as are further described in the aforementioned Contract, which said Contract being made a part of this Bond by this reference for the purpose of perfecting this Bond.

NOW THEREFORE, THE CONDITIONS OF THIS BOND are such that if Principal:

1. Shall promptly make payments to all claimants as defined in Section 255.05(1), Florida Statutes, as amended, supplying the Principal with labor, materials or supplies, as used directly or indirectly by the Principal in the prosecution of the work provided for in the Contract; and
2. Shall pay the Obligee for all losses, damages, expenses, costs and attorneys' fees, including those resulting from appellate proceedings, that the Obligee sustains because of a default by the Principal in contravention to the Contract in regard to payment for such labor, materials, or supplies furnished to the Principal;

then this bond shall be void; otherwise this Bond remains in full force and effect.

* Lake County, Florida

Executed in 3 Counterparts
BOND NO. 101715688

BE IT FURTHER KNOWN AND AGREED TO BY THE PARTIES THAT:

1. Any changes in or under the Contract and compliance or noncompliance with any formalities connected with the said Contract or alterations which may be made in the terms of the said Contract, or in the work to be done under it, or the giving by the Obligee of any extension of time for the performance of the said Contract, or any other forbearance on the part of the Obligee or Principal to the other, shall not in any way release the Principal and the Surety, or either of them, their heirs, personal representatives, successors or assigns from liability hereunder, notice to the Surety of any such changes, alterations, extensions or forbearance being hereby waived.
2. Certain claimants seeking the protection of this Bond must timely comply with the strict requirements set forth in Section 255.05, Florida Statutes, as amended, and as otherwise provided by law.
3. The Provisions of this bond are subject to the limitations of Section 255.05(2), Florida Statutes, as amended.

By execution of this bond, the Surety acknowledges that it has read the Surety qualifications and obligations imposed by the Contract and hereby satisfies those conditions.

The parties agree that this public bond and any claims instituted under this bond shall be governed by the laws, rules and regulations of the State of Florida and venue shall be in a court of competent jurisdiction in and for Lake County, Florida.

IN WITNESS WHEREOF, the above bounded parties have executed this instrument on the day and year below mentioned, the name of each party being affixed and these presents duly signed by its/their undersigned representative(s), pursuant to authority of its governing body.

Signed, sealed and delivered
in the presence of:

Contractor, as PRINCIPAL:

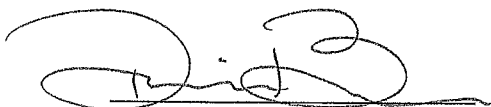
#1 Witness as to Principal

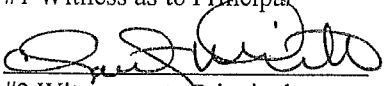
#2 Witness as to Principal

Company: Bulldog Sitework, LLC

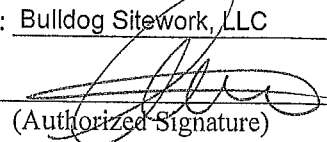
By: 
(Authorized Signature)

Printed Name: NAIARA PETRALANDA

Title: OWNER

Date: 2/23/2026

STATE OF FLORIDA
COUNTY OF Lake

The foregoing instrument was acknowledged before me by means of physical presence or online notarization, this 23rd day of Feb, 2026, by Naiara Petralanda as President for Bulldog Sitework, LLC.

Personally Known OR Produced Identification
Type of Identification Produced _____

(Notary Signature)

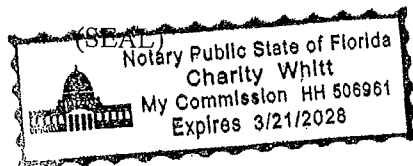

Executed in 3 Counterparts
BOND NO. 101715688

SURETY:

Company: Merchants National Bonding, Inc.

N/A
#1 Witness as to Surety

By: N/A
(Authorized Signature)

N/A
#2 Witness as to Surety

Printed Name: N/A

Title: N/A

Date: N/A

OR BY ATTORNEY IN FACT (POWER OF ATTORNEY MUST BE ATTACHED)

Meadow Medal
#1 Witness as Attorney In Fact, Meadow Medal
[Signature]
#1 Witness as Attorney In Fact, Sophia Golecki

Merchants National Bonding, Inc.

By: Jeffrey W. Reich
(As Attorney In Fact) & FL Lic. Resident Agent

Printed Name: Jeffrey W. Reich*

Date: 01/27/2026

Address: PO Box 14498
Des Moines, IA 50306-3498

Phone: Surety: (515) 243-8171 *Agent: (407) 786-7770

STATE OF FLORIDA
COUNTY OF ORANGE

The foregoing instrument was acknowledged before me by means of physical presence or online notarization, this 27th day of January, 2026, by Jeffrey W. Reich as Attorney-in-Fact for Merchants National Bonding, Inc.

Personally Known OR Produced Identification
Type of Identification Produced N/A

[Signature]
(Notary Signature) Migdiel Burgos

(SEAL)

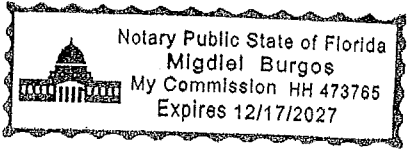

MERCHANTS BONDING COMPANY™

POWER OF ATTORNEY

Know All Persons By These Presents, that MERCHANTS BONDING COMPANY (MUTUAL) and MERCHANTS NATIONAL BONDING, INC., both being corporations of the State of Iowa, d/b/a Merchants National Indemnity Company (in California only) (herein collectively called the "Companies") do hereby make, constitute and appoint, individually,

Cheryl A Foley; Emily J Golecki; Jeffrey W Reich; Kim E Niv; Lisa A Roseland; Nathan K Reich; Robert P Olinn; Sarah K Olinn; Sonja Amanda Floree Harris; Susan L Reich; Teresa L Durham

their true and lawful Attorney(s)-in-Fact, to sign its name as surety(ies) and to execute, seal and acknowledge any and all bonds, undertakings, contracts and other written instruments in the nature thereof, on behalf of the Companies in their business of guaranteeing the fidelity of persons, guaranteeing the performance of contracts and executing or guaranteeing bonds and undertakings required or permitted in any actions or proceedings allowed by law.

This Power-of-Attorney is granted and is signed and sealed by facsimile under and by authority of the following By-Laws adopted by the Board of Directors of Merchants Bonding Company (Mutual) on April 23, 2011 and amended August 14, 2015 and April 27, 2024 and adopted by the Board of Directors of Merchants National Bonding, Inc., on October 16, 2015 and amended on April 27, 2024.

"The President, Secretary, Treasurer, or any Assistant Treasurer or any Assistant Secretary or any Vice President shall have power and authority to appoint Attorneys-in-Fact, and to authorize them to execute on behalf of the Company, and attach the seal of the Company thereto, bonds and undertakings, recognizances, contracts of indemnity and other writings obligatory in the nature thereof."

"The signature of any authorized officer and the seal of the Company may be affixed by facsimile or electronic transmission to any Power of Attorney or Certification thereof authorizing the execution and delivery of any bond, undertaking, recognizance, or other suretyship obligations of the Company, and such signature and seal when so used shall have the same force and effect as though manually fixed."

In connection with obligations in favor of the Florida Department of Transportation only, it is agreed that the power and authority hereby given to the Attorney-in-Fact includes any and all consents for the release of retained percentages and/or final estimates on engineering and construction contracts required by the State of Florida Department of Transportation. It is fully understood that consenting to the State of Florida Department of Transportation making payment of the final estimate to the Contractor and/or its assignee, shall not relieve this surety company of any of its obligations under its bond.

In connection with obligations in favor of the Kentucky Department of Highways only, it is agreed that the power and authority hereby given to the Attorney-in-Fact cannot be modified or revoked unless prior written personal notice of such intent has been given to the Commissioner-Department of Highways of the Commonwealth of Kentucky at least thirty (30) days prior to the modification or revocation.

In Witness Whereof, the Companies have caused this instrument to be signed and sealed this 24th day of March, 2025.

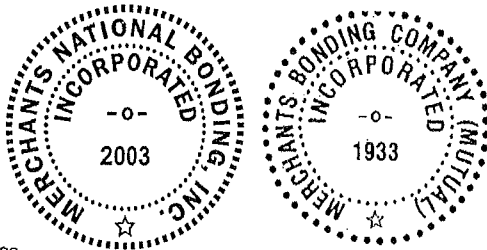

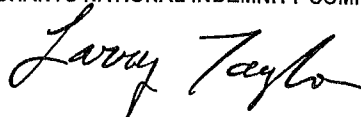

MERCHANTS BONDING COMPANY (MUTUAL)
MERCHANTS NATIONAL BONDING, INC.
d/b/a MERCHANTS NATIONAL INDEMNITY COMPANY

By 
President

STATE OF IOWA
COUNTY OF DALLAS ss.

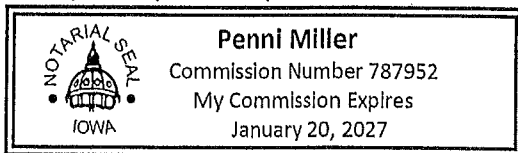
On this 24th day of March, 2025, before me appeared Larry Taylor, to me personally known, who being by me duly sworn did say that he is President of MERCHANTS BONDING COMPANY (MUTUAL) and MERCHANTS NATIONAL BONDING, INC.; and that the seals affixed to the foregoing instrument are the Corporate Seals of the Companies; and that the said instrument was signed and sealed in behalf of the Companies by authority of their respective Boards of Directors.





Notary Public

(Expiration of notary's commission does not invalidate this instrument)

I, Elisabeth Sandersfeld, Secretary of MERCHANTS BONDING COMPANY (MUTUAL) and MERCHANTS NATIONAL BONDING, INC., do hereby certify that the above and foregoing is a true and correct copy of the POWER-OF-ATTORNEY executed by said Companies, which is still in full force and effect and has not been amended or revoked.

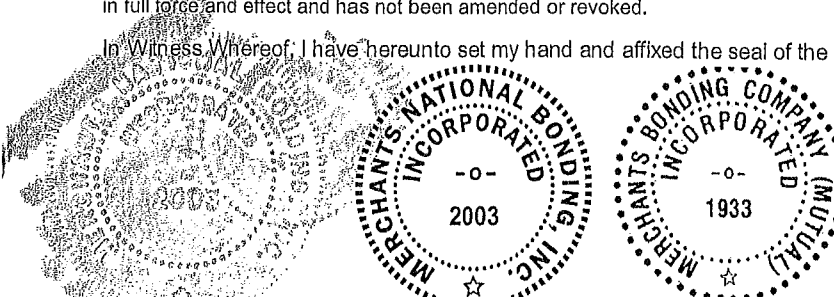
In Witness Whereof, I have hereunto set my hand and affixed the seal of the Companies on this 27th day of January, 2026.



Secretary

DIVISION Z

AFFIDAVIT OF RELEASE AND GUARANTEE

Before me, the undersigned authority, personally appeared _____ after being duly sworn, deposes and says:

All charges for labor, materials, supplies, lands, licenses and other expenses arising from the Contract, North Lake Trail – East Collins Street to Beach Street; Project No. 2026-01, Bid No. 26-702, for which Lake County, Florida, hereinafter "County" might be sued or for which a lien or a demand against any payment bond might be filed, have been fully satisfied and paid or will be fully satisfied and paid promptly upon receipt of payment by the Contractor. The Contractor will fully indemnify, defend and save harmless the County from all demands, suits, actions, claims of lien or other charges filed or asserted against the County in connection with matters certified to herein.

On behalf of itself and its subcontractors, suppliers, materialmen, successors and assigns, the Contractor releases and waives all claims, demands, damages, costs and expenses, against the Board of County Commissioners of Lake County, relating in any way to the performance or payment of the above-numbered Contract, for the period from the date of execution of the Contract through and including the date of acceptance of Final Payment.

The Contractor is aware of contractual provisions for warranties and guarantees contained in the General Conditions of the above numbered contract, and acknowledges that those provisions shall have the same force and effect as if this Affidavit had not been executed, and understands that the County's remedies are not limited by same but are in addition to any other remedies provided by law.

This Affidavit is given in connection with the Contractors application for Final Payment.

FURTHER AFFIANT SAYETH NAUGHT.

(Affiant)

STATE OF FLORIDA
COUNTY OF _____

The foregoing instrument was acknowledged before me by means of physical presence or online notarization, this ____ day of _____, 20____, by _____ as _____ for _____.

Personally Known OR Produced Identification
Type of Identification Produced _____

(Notary Signature)

(SEAL)

**APPENDIX A1
SAMPLE CHANGE ORDER**

Contract Change Order

Lake County
Department of Public Works
323 North Sinclair Avenue
Tavares, FL 32778

Date:
Project No.:
Location:
Contract No.:
Change Order No.:

To:

YOU ARE HEREBY REQUESTED TO COMPLY WITH THE FOLLOWING CHANGES FOR THE AGREEMENT, PLANS AND SPECIFICATIONS

| ITEM NO. | DESCRIPTION IN CHANGES - QUANTITIES, UNITS, UNIT PRICES, CHANGE IN COMPLETION SCHEDULE, ETC. | DECREASE IN CONTRACT PRICE | INCREASE IN CONTRACT PRICE |
|----------|--|----------------------------|----------------------------|
| 1 | | \$ - | \$ - |
| 2 | | | |
| 3 | | | |
| | Per attached Exhibit "A" | | |
| | Change in contract price due to change order: | | |
| | Total Decrease | \$ - | |
| | Total Increase | | \$ - |
| | Difference | | \$ - |
| | Net- Increase /Decrease Contract Price | | \$ - |

The sum of \$ 0 is hereby **added to/subtracted from** the total agreement price, and the total adjusted agreement price to date thereby is \$ _____. This document shall become an amendment to the agreement and all other provisions of the agreement shall apply hereto.

Recommended by: _____ Date: _____
(type name)

Accepted by: _____ Date: _____
(type name)

Approved by: _____ Date: _____
(type name)

To be funded from Account #

APPENDIX B-1

Soil Survey

SOIL SURVEY
North Lake Trail Segment IIIA
E. Collins Street to Altoona Road
Lake County, Florida



Ardaman & Associates, Inc.

CORPORATE HEADQUARTERS

8008 S. Orange Avenue, Orlando, Florida 32809 - Phone: (407) 855-3860 Fax: (407) 859-8121

Branch Office Locations

Florida: Bartow, Cocoa, Fort Myers, Miami, Orlando, Port St. Lucie, Sarasota, Tallahassee, Tampa, West Palm Beach

Louisiana: Baton Rouge, New Orleans, Shreveport

Texas: Houston

MEMBERS:

ASTM International
Society of American Military Engineers
American Council of Engineering Companies



Ardaman & Associates, Inc.

Geotechnical, Environmental and
Materials Consultants

June 26, 2024
Ardaman File No. 22-6454A

Stantec
300 Primera Boulevard, Suite 300
Lake Mary, Florida 32746-2146

Attention: Mr. Luis Diaz, P.E.

Subject: SOIL SURVEY
North Lake Trail Segment IIIA
E. Collins Street to Altoona Road
Lake County, Florida

Dear Mr. Diaz:

As requested and authorized, we have completed a soil survey for the proposed North Lake Trail Segment IIIA project. The purposes of performing this exploration were to evaluate the general subsurface conditions at selected locations along the proposed trail alignment. In addition, we have provided geotechnical engineering information for use during design of the project. This report documents our findings and presents our engineering recommendations.

References made in this report and on the attached figures are to Florida Department of Transportation (FDOT) Standard Plans and Indices.

This report has been prepared in accordance with generally accepted geotechnical engineering practices for specific application to the project limits indicated in this report. No other warranty, expressed or implied, is made. The soils information and recommendations submitted herein are based on the data obtained from the soil borings presented on Figure 5. This report does not reflect any variations which may occur adjacent to or between the borings. The nature and extent of the variations adjacent to or between the borings may not become evident until during construction.

We are pleased to be of assistance to you on this phase of the project. When we may be of further service to you or should you have any questions, please contact us.

Very truly yours,
ARDAMAN & ASSOCIATES, INC.
Florida Registry 5950

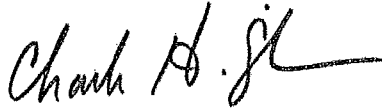

Charles H. Cunningham, P.E.
Vice President
Florida License No. 38189

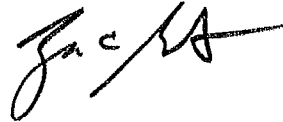

Zan C. Bates, P.E.
Senior Engineer
Florida License No. 49917

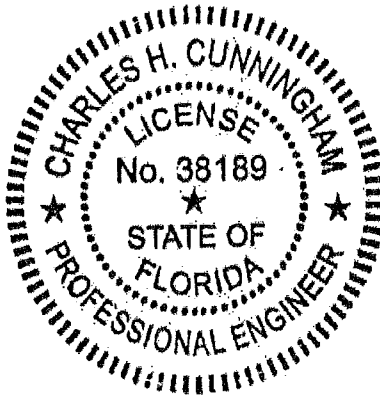

THIS ITEM HAS BEEN DIGITALLY
SIGNED AND SEALED BY:

ON THE DATE ADJACENT TO THIS SEAL.

PRINTED COPIES OF THIS DOCUMENT ARE
NOT CONSIDERED SIGNED AND SEALED
AND THIS SIGNATURE MUST BE VERIFIED
ON ANY ELECTRONIC COPIES.

ARDAMAN & ASSOCIATES, INC.
8008 S. ORANGE AVENUE
ORLANDO, FLORIDA 32809
(407) 855-3860
FLORIDA REGISTRY 5950
CHARLES H. CUNNINGHAM, P.E. NO 38189

CHC/ZCB/bls/lms

22-6454A Stantec North Lake Trail Phase 3 E Collins Street to E Altoona.docx (Geo 2024)

TABLE OF CONTENTS

| <u>Chapter</u> | <u>Title</u> | <u>Page</u> |
|----------------|---|-------------|
| 1.0 | INTRODUCTION | 1 |
| | 1.1 Site Location | 1 |
| | 1.2 Project Considerations | 1 |
| | 1.3 Purpose and Scope of Project | 1 |
| | 1.4 Review of Available Data | 2 |
| | 1.4.1 USGS Quadrangle Map | 2 |
| | 1.4.2 Soil Survey Map | 2 |
| 2.0 | FIELD EXPLORATION PROGRAM | 2 |
| | 2.1 Auger Borings | 2 |
| | 2.2 Groundwater Level | 2 |
| | 2.3 Test Locations | 2 |
| 3.0 | LABORATORY PROGRAM | 3 |
| 4.0 | CONCLUSIONS AND RECOMMENDATIONS | 3 |
| | 4.1 General Soil Stratigraphy | 3 |
| | 4.2 Groundwater Control | 4 |
| | 4.3 Estimated Seasonal High Water Table | 5 |
| | 4.4 Construction Considerations | 5 |

List of Tables:

| | |
|---|------------------------------------|
| 1 | Summary of Laboratory Test Results |
|---|------------------------------------|

List of Figures:

| | |
|---------------|--|
| 1 | Site Location Map |
| 2 | Project Alignment |
| 3A, 3B and 3C | Soil Survey Map & Boring Location Plan |
| 4 | Report of Tests |
| 5 | Soil Boring Profiles |

Appendices:

| | |
|-----|---|
| I | USCS Soil Survey Soil Descriptions |
| II | Hand Auger Boring Procedures |
| III | Soil Boring Locations Plotted on Trail Plan & Profile Sheets by Stantec Consulting Services, Inc. |

1.0 INTRODUCTION

1.1 Site Location

The proposed trail construction project is located in Sections 1, 6, 12 and 31, Townships 17 and 18 South, and Ranges 26 and 27 East in Lake County, Florida. The approximate limits of the project alignment are shown superimposed on the Umatilla, Florida, U.S.G.S. quadrangle map presented on Figure 1.

The project limits from south to north are from E. Collins Street to E. Altoona Road. The alignment is generally offset from, and somewhat parallel to, State Road 19. The trail alignment is shown superimposed on an aerial photograph obtained from Google Earth Pro on Figure 2.

The majority of the proposed trail alignment is in greenspace, although the trail crosses existing paved and dirt roads. We understand that some of the proposed trail alignment is on an abandoned railroad bed.

1.2 Project Considerations

It is our understanding that the proposed construction includes a paved pedestrian and bike trail. Based on review of plan and profile sheets provided by Stantec, the length of construction is approximately 2.99 miles; and maximum fill height and cut depth to finished grade are approximately 3 feet and 2 feet, respectively.

1.3 Purpose and Scope of Project

The purposes of this exploration were to explore shallow subsurface conditions within the trail alignment and to provide geotechnical engineering evaluation of the conditions encountered.

We accomplished these purposes by:

1. Obtaining and evaluating readily available soil survey data.
2. Conducting auger borings.
3. Observing recovered soil samples in our laboratory and performing tests on selected samples to aid in classification.
4. Analyzing and interpreting the field and laboratory data.
5. Performing geotechnical engineering analyses to develop recommendations for site preparation.

1.4 Review of Available Data

1.4.1 USGS Quadrangle Map

The approximate project alignment is shown superimposed on the Umatilla, Florida USGS quadrangle map presented on Figure 1. The approximate ground surface elevations shown on the USGS quadrangle map along the project alignment range from approximately +85 to +110 feet NGVD (1929 National Geodetic Vertical Datum).

1.4.2 Soil Survey Map

Based on information obtained online from the Web Soil Survey as operated by the U.S. Department of Agriculture Natural Resources Conservation Services, various soil series are mapped along the project alignment as shown on Figures 3A, 3B and 3C.

Descriptions obtained from United States Soil Conservation Service publications for each soil series are included in Appendix I.

2.0 FIELD EXPLORATION PROGRAM

2.1 Auger Borings

The field exploration program included performing 12 auger borings to a depth of 5 feet below the existing ground surface at locations designated by Stantec. The auger borings were conducted using a 3-inch diameter manual bucket auger. A summary of the auger boring procedure is included in Appendix II.

The borings were backfilled with soil cuttings upon completion.

In Boring SB-01, limerock road base-type material was encountered at about 6 inches deep, underlain by soil mixed with some granite railroad-type ballast gravel to 1½-inch size. We used a pick and shovel to excavate through these materials.

2.2 Groundwater Level

We attempted to measure the groundwater level in the boreholes upon completion of drilling each boring. However, groundwater was not encountered in the borings.

2.3 Test Locations

The locations of the borings were determined in the field by representatives of Ardaman and Associates using a hand-held GPS unit and coordinates obtained from a Google Earth KMZ file

provided by Stantec. The locations are schematically illustrated on Figures 3A, 3B and 3C. In addition, Plan & Profile sheets provided by Stantec that show the boring locations are included in Appendix III. The boring locations are designated as SB-01 through SB-12 on the sheets. Only the Plan & Profile sheets that show boring locations are included in Appendix III (i.e., the entire set of Plan & Profile sheets are not included in Appendix III).

The boring locations should be considered accurate only to the degree implied by the method of locating used.

3.0 LABORATORY PROGRAM

Representative soil samples obtained during our field sampling operation were packaged and transferred to our laboratory for further visual examination and classification. The soil samples were classified using visual-manual procedures in general accordance with the AASHTO Soil Classification System.

In addition, sieve analysis tests were conducted on representative soil samples to aid in classification. The results of the sieve analysis tests are shown in Table 1. The resulting soil descriptions are summarized on the Report of Tests sheet presented as Figure 4.

4.0 CONCLUSIONS AND RECOMMENDATIONS

4.1 General Soil Stratigraphy

The results of the field exploration and laboratory testing programs are graphically summarized on the Report of Tests sheet (Figure 4) and Boring Profiles sheet (Figure 5). The stratification of the boring profiles represents our interpretation of the field boring logs and the results of the laboratory examination of the recovered samples. The stratification lines represent the approximate boundary between soil types. The actual transitions may be more gradual than implied.



The results of our borings indicate the following general soil types:

| Stratum No. | Description | Classification | |
|-------------|---|----------------|---------------|
| | | AASHTO | Index 120-001 |
| 1 | Light brown to brown and orangish brown fine sand to fine sand with silt | A-3 | S |
| 2 | Limerock road base-type material with limerock gravel to 2½-inch size, and granite railroad ballast-type gravel to 1½-inch size mixed with brown fine sand with silt. | -- | S* |

* Stratum 2 material can be considered Select for use as fill if mixed with A-3 soil so that gravel larger than ¼-inch size comprises less than 25 percent of the mixture.

Assuming the granite gravel encountered in Boring SB-01 is railroad ballast rock, it did not appear that the amount of granite gravel encountered in Boring SB-01 would be typical of a full depth railroad ballast gravel bed, and would more likely be associated with remnants of a ballast bed. Additional exploration could be performed to further explore for ballast rock. Railroad ballast rock was not encountered in the other eleven soil borings; however, an iron railroad spike was encountered at 2 inches below ground surface in Boring SB-10.

The results of our exploration indicate that the soil conditions encountered in the borings presented on Figure 5 are appropriate for construction of the proposed trail, in accordance with standard Florida Department of Transportation (FDOT) design and construction practices.

Soil Stratum 1 and amended Soil Stratum 2 may be considered as Select materials based on FDOT criteria and the gravel content as stated above (Standard Plan Index 120-001). The use of these soils relative to embankment construction should be in accordance with Standard Plan Index 120-001, and with proper moisture conditioning, should densify using conventional compaction equipment. Soil Stratum 2, if undisturbed during construction, may remain in-place under the trail.

Organic topsoil as encountered in the auger borings to depths of 1 to 3 inches and roots should be removed from the trail construction area.

4.2 Groundwater Control

Groundwater was not encountered in the boreholes. This does not necessarily mean that groundwater would not be encountered within the vertical reach of the borings in the future. Fluctuation of groundwater levels should be anticipated throughout the year primarily due to seasonal variations in rainfall and other factors that may vary from the time the borings were conducted.

Some form of groundwater control (dewatering) may be required during construction. Positive site drainage should be established early during construction in order to reduce ponding of surface water during heavy or prolonged rainfall. Means and methods of groundwater and surface water control should be the responsibility of the contractor.

4.3 Estimated Seasonal High Water Table

The groundwater level is affected by a number of factors. The amount of rainfall and the drainage characteristics of the soils, the land surface elevation, relief points such as drainage ditches, lakes, rivers, swamp areas, etc., and distance to relief points are some of the more important factors influencing the groundwater level.

The normal seasonal high groundwater level each year is the level in the August-September period at the end of the rainy season during a year of normal (average) rainfall. The water table elevations associated with a higher than normal rainfall and in the extreme case, flood, would be higher to much higher than the normal seasonal high groundwater level, and could occur at times outside of the August-September period. The normal high water levels would more approximate the normal seasonal high groundwater levels.

Based on our interpretation of the site conditions using our boring log data, we estimate the normal seasonal high water table at the boring locations to be greater than 3½ feet below ground surface, assuming that the site drainage conditions existing at the time the borings were conducted are maintained. If site drainage conditions are altered from those existing at the time of our borings, our estimates may not be valid.

4.4 Construction Considerations

Construction should be performed in accordance with the appropriate sections of the Florida Department of Transportation (FDOT) current edition of the Standard Specifications for Road and Bridge Construction. If needed, fill should generally consist of select material (A-3, A-2-4) compacted in accordance with the FDOT Standard Specification for Road and Bridge Construction. In accordance with these specifications, the removal of organic materials and any plastic soils should be accomplished in accordance with FDOT Standard Plans Index 120-002 unless otherwise shown on the plans. In-place density tests should be performed on the fill soils to verify the specified degree of compaction. The minimum density test frequency should be in accordance with the FDOT Materials, Sampling, Testing, and Reporting Guide. Fill placement and side slopes for embankment construction are presented in the FDOT Standard Plan Index 120-001. We recommend that the designer add notes to the plans relative to removal of unsuitable soils, difficult excavation, dewatering, maintaining positive site drainage, and wrapping pipe joints.



Some form of groundwater control (dewatering) may be required during construction. Positive site drainage should be established early during construction in order to reduce ponding of surface water during heavy or prolonged rainfall. Means and methods of groundwater and surface water control should be the responsibility of the contractor.



TABLE 1

Summary of Laboratory Test Results
 North Lake Trail Segment IIIA
 Lake County, Florida

| Boring I.D. | Approximate Station No. | Offset (ft) | Depth (ft) | Stratum No. | Grain Size Distribution - Percent Passing | | | | | OC (%) | NIM (%) | Atterberg Limits (%) | |
|-------------|-------------------------|-------------|------------|-------------|---|---------|---------|----------|----------|--------|---------|----------------------|------------------|
| | | | | | #10 (%) | #40 (%) | #60 (%) | #100 (%) | #200 (%) | | | Liquid Limit | Plasticity Index |
| SB-01 | 12+30 | 0 | 2.5 | 1 | -- | -- | -- | -- | 3.6 | -- | -- | -- | |
| SB-02 | 44+55 | 0 | 3 | 1 | -- | -- | -- | -- | 2.5 | -- | -- | -- | |
| SB-04 | 80+35 | 0 | 1.5 | 1 | -- | -- | -- | -- | 3.5 | -- | -- | -- | |
| SB-06 | 88+30 | 0 | 1.5 | 1 | -- | -- | -- | -- | 4.6 | -- | -- | -- | |
| SB-09 | 115+20 | 0 | 1.5 | 1 | -- | -- | -- | -- | 4.4 | -- | -- | -- | |
| SB-09 | 115+20 | 0 | 3.5 | 1 | -- | -- | -- | -- | 2.0 | -- | -- | -- | |
| SB-11 | 155+05 | 0 | 1.5 | 1 | -- | -- | -- | -- | 2.2 | -- | -- | -- | |
| SB-12 | 167+05 | 0 | 2.5 | 1 | -- | -- | -- | -- | 2.7 | -- | -- | -- | |

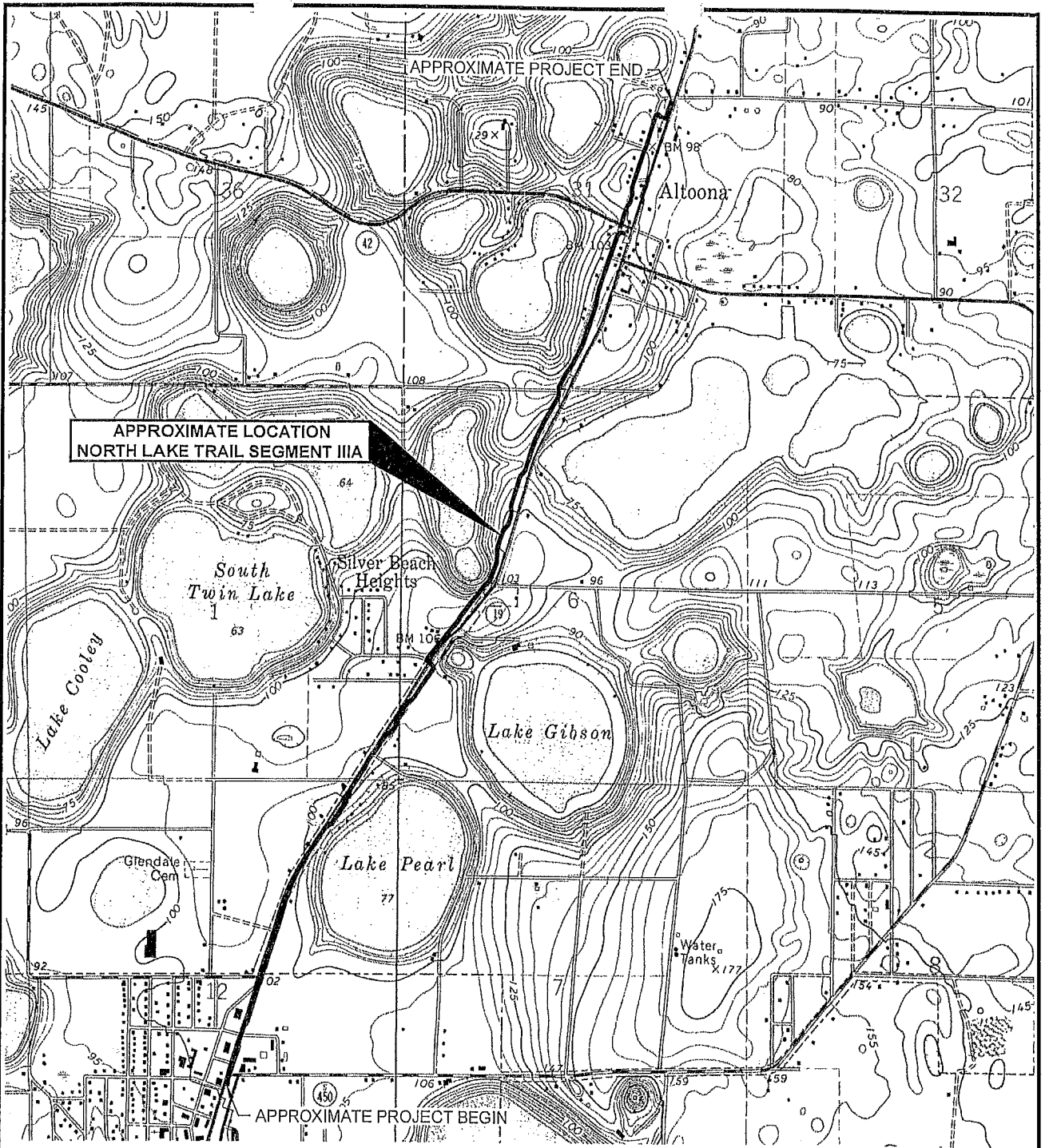

SECTIONS 1, 6, 12, AND 31
TOWNSHIPS 17 AND 18 SOUTH
RANGES 26 AND 27 EAST

OBTAINED FROM U.S.G.S. QUAD MAP: UMATILLA, FLORIDA 1965
(PHOTOREVISED 1980)
(PHOTOINSPECTED 1985)

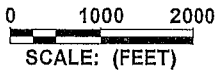

QUADRANGLE LOCATION

| SITE LOCATION MAP | | |
|---|----------------------------|-----------------------|
|  Ardaman & Associates, Inc. Geotechnical, Environmental and Materials Consultants | | |
| SOIL SURVEY NORTH LAKE TRAIL SEGMENT IIIA E. COLLINS STREET TO ALTOONA ROAD LAKE COUNTY, FLORIDA | | |
| DRAWN BY: CD | APPROVED BY: | DATE: 06/18/24 |
| FILE NO. 22-6454A | Eric C. Balog, P.E. | FIGURE: 1 |

T:\Orlando\2202-6454A\226454A01.dwg 6/25/2024 10:14:39 AM, Chris.Drew



NOTE: AERIAL PHOTO OBTAINED FROM BING MAPS, DATED 2024.

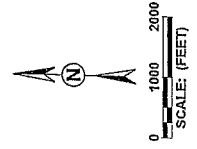

| | |
|--|------------------------------|
| PROJECT ALIGNMENT | |
| Ardaman & Associates, Inc. Geotechnical, Environmental and Materials Consultants | |
| SOIL SURVEY NORTH LAKE TRAIL SEGMENT IIIA E. COLLINS STREET TO ALTOONA ROAD LAKE COUNTY, FLORIDA | |
| DRAWN BY: CD | DATE: 08/15/24 |
| APPROVED BY: | Checked: H. Cunningham, P.E. |
| Sheet: 2 | |

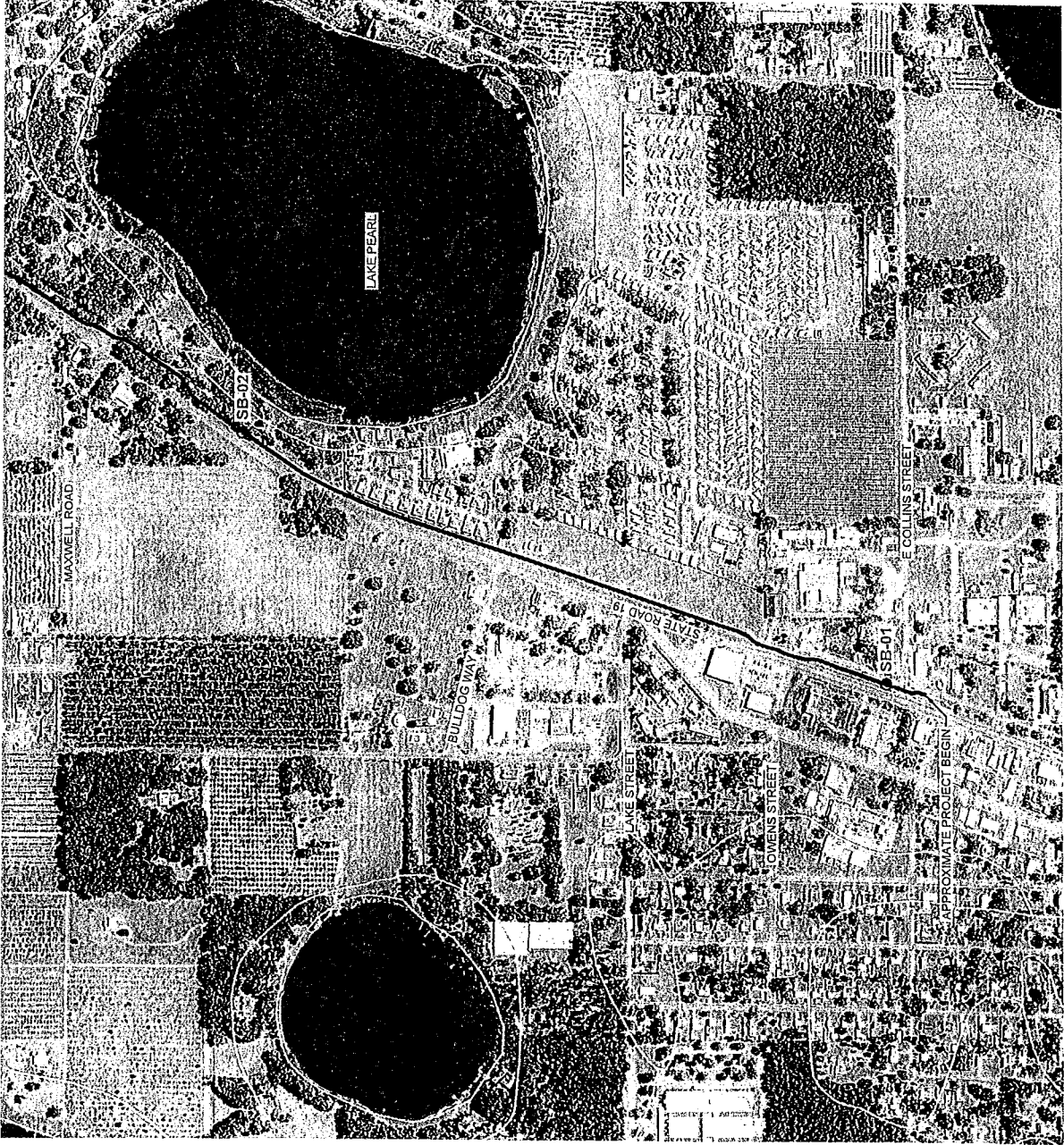

LAKE COUNTY SOIL SURVEY LEGEND
 3 - CANDLER SAND, 0 TO 5 PERCENT SLOPES

LEGEND
 SB - APPROXIMATE AUGER BORING LOCATION

- NOTES:**
1. AERIAL PHOTO OBTAINED FROM FDOT, DATED 2020.
 2. MAPPED SOIL SERIES AREAS, OBTAINED FROM U.S. DEPARTMENT OF AGRICULTURAL, NATURAL RESOURCES CONSERVATION SERVICE, DATED 08/29/07.

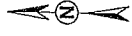

| | |
|---|-------------------|
| SOIL SURVEY MAP & BORING LOCATION PLAN | |
| Ardaman & Associates, Inc. Geotechnical, Environmental and Materials Consultants | |
| SOIL SURVEY NORTH LAKE TRAIL SEGMENT IIA E. COLLINS STREET TO ALTOONA ROAD LAKE COUNTY, FLORIDA | |
| DATE: 08/18/24 | PROJECT: 22-6454A |
| APPROVED BY: Charles H. Cunningham, P.E. | SCALE: 3A |



- LAKE COUNTY SOIL SURVEY LEGEND**
- 8 - CANDLER SAND, 0 TO 5 PERCENT SLOPES
 - 9 - CANDLER SAND, 5 TO 12 PERCENT SLOPES
 - 10 - CANDLER SAND, 12 TO 40 PERCENT SLOPES
 - 21 - LAKE SAND, 0 TO 5 PERCENT SLOPES
 - 23 - LAKE SAND, 12 TO 22 PERCENT SLOPES
 - 34 - ORLANDO FINE SAND, 0 TO 5 PERCENT SLOPES

LEGEND

SB APPROXIMATE AUGER BORING LOCATION

- NOTES:**
1. AERIAL PHOTO OBTAINED FROM FDOT, DATED 2020.
 2. MAPPED SOIL SERIES AREAS OBTAINED FROM U.S. DEPARTMENT OF AGRICULTURAL, NATURAL RESOURCES CONSERVATION SERVICE, DATED 08/28/07.

SOIL SURVEY MAP & BORING LOCATION PLAN

Ardaman & Associates, Inc.
 Geotechnical, Environmental and Materials Consultants

SOIL SURVEY
 NORTH LAKE TRAIL SEGMENT IIIA
 E. COLLINS STREET TO ALTOONA ROAD
 LAKE COUNTY, FLORIDA

| | | | |
|--------------|-----------|----------|-----------------------------|
| PROJECT NO. | CD | DATE | 06/18/24 |
| APPROVED BY: | | DATE: | |
| FILE NO. | 22-6-654A | PROJECT: | Charles H. Cunningham, P.E. |
| | | | PAGES: 3B |

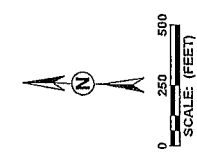

OCALA NATIONAL FOREST SOIL SURVEY LEGEND
 9 - ASTATULA SAND, FIRE REGIME, 0 TO 5 PERCENT SLOPES
 10 - ASTATULA SAND, FIRE REGIME, 5 TO 12 PERCENT SLOPES

LEGEND

○ SB APPROXIMATE AUGER BORING LOCATION

- NOTES: 1. AERIAL PHOTO OBTAINED FROM FDOT, DATED 2020.
 2. MAPPED SOIL SERIES AREAS OBTAINED FROM U.S. DEPARTMENT OF AGRICULTURAL, NATURAL RESOURCES CONSERVATION SERVICE, DATED 08/28/07.

| | |
|---|-------------------------------------|
| SOIL SURVEY MAP & BORING LOCATION PLAN | |
| Ardaman & Associates, Inc. Geotechnical, Environmental and Materials Consultants | |
| SOIL SURVEY NORTH LAKE TRAIL SEGMENT IIIA E. COLLINS STREET TO ALTOONA ROAD LAKE COUNTY, FLORIDA | |
| DATE: 05/2024 | SCALE: 3C |
| PROJECT NO: 22-6464A | CLIENT: Charles H. Cunningham, P.E. |

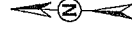

0 250 500
 SCALE: (FEET)



REPORT OF TESTS

PROJECT NAME: NORTH LAKE TRAIL SEGMENT IIIA
 CROSS SECTION OF SOIL SURVEY

DATE OF SURVEY: 06/2024
 SURVEY MADE BY: MOORE, CUNNINGHAM
 SUBMITTED BY: CHARLES H. CUNNINGHAM, P.E.

SURVEY BEGINS STA. : SURVEY ENDS STA. :

| STRATA NO. | ORGANIC CONTENT | | MOISTURE CONTENT | | SIEVE ANALYSIS RESULTS | | | | | ATTERBERG LIMITS (%) | | SOIL CLASSIFICATION | | CORROSION TEST RESULTS | | | | | |
|------------|-----------------|-----------|------------------|------------|------------------------|---------|---------|---------|----------|----------------------|--------------|---------------------|---------------|--|--------------|--------------------|--------------|--------------|-----|
| | NO. OF TESTS | % ORGANIC | NO. OF TESTS | % MOISTURE | NO. OF TESTS | 10 MESH | 40 MESH | 60 MESH | 100 MESH | 200 MESH | LIQUID LIMIT | PLASTICITY INDEX | ASHFORD GROUP | DESCRIPTION | NO. OF TESTS | RESISTIVITY ohm-cm | CHLORIDE ppm | SULFATES ppm | PH |
| 1 | --- | --- | --- | --- | (6) | --- | --- | --- | --- | 2 TO 5 | --- | --- | A-3 | LIGHT BROWN TO BROWN AND ORANGISH BROWN FINE SAND TO FINE SAND WITH SILT | --- | --- | --- | --- | --- |
| 2 | --- | --- | --- | --- | --- | --- | --- | --- | --- | --- | --- | --- | --- | LIMESTONE ROUGH-SURFACE MATERIAL TO 2-1/2 INCH SIZE AND UNDER THE SURFACE OF THE CHANNEL TO 1-1/2 INCH SIZE MIXED WITH BROWN FINE SAND WITH SILT | --- | --- | --- | --- | --- |

EMBANKMENT AND SUBGRADE MATERIAL

- SOIL BOUNDARIES ARE APPROXIMATE AND REPRESENT SOIL STRATA AT EACH BORING LOCATION ONLY. ANY SUBSOIL CONNECTING LINES SHOWN ARE FOR ESTIMATING ACTUAL STRATUM LIMITS. SUBSURFACE VARIATIONS BETWEEN BORINGS SHOULD BE ANTICIPATED AS INDICATED IN SECTION 2-4 OF THE STANDARD SPECIFICATIONS FOR ROAD AND BRIDGE CONSTRUCTION. FOR FURTHER DETAILS SEE SECTION 120-3.
- ONE DENOTES GROUNDWATER NOT ENCOUNTERED.
- REMOVAL OF ORGANIC TOPSOIL, MUCK AND PLASTIC MATERIAL OCCURRING WITHIN THE TRAIL SHALL BE ACCOMPLISHED IN ACCORDANCE WITH STANDARD PLANS INDEX NO. 120-002. UNLESS OTHERWISE SHOWN ON THE PLANS, THE MATERIAL USED IN EMBANKMENT CONSTRUCTION SHALL BE IN ACCORDANCE WITH FOOT STANDARD PLANS INDEX NO. 120-001 FOR FOOT DESIGN STANDARDS.
- SOIL PARAMETER NOT TESTED DENOTED AS "----" ABOVE.
- STRATA NOS. 1 AND 2 SHALL BE TREATED AS SELECT (S) MATERIAL IN ACCORDANCE WITH FOOT STANDARD PLANS INDICES 120-002 AND 120-001.
- () DENOTES PERCENT FINES TEST ONLY.

| | | | | | | |
|------|-------------|-----------|------|-------------|-------------------------------------|-------------------------------|
| DATE | DESCRIPTION | REVISIONS | DATE | DESCRIPTION | LAKE COUNTY PUBLIC WORKS DEPARTMENT | SHEET NO. |
| | | | | | ROAD NO. | |
| | | | | | QUANTITY | |
| | | | | | LAKE | |
| | | | | | FINANCIAL PROJECT ID | |
| | | | | | | NORTH LAKE TRAIL SEGMENT IIIA |
| | | | | | | |

Adelman & Associates, Inc.
 2908 S. Orange Avenue
 Orlando, FL 32809
 E.O.P. - Charles H. Cunningham, P.E. NO. 38109
 Florida Reg. 57538

LAKE COUNTY PUBLIC WORKS DEPARTMENT

SOIL SURVEY

FIGURE 4

APPENDIX I

USCS Soil Survey Soil Descriptions

REVIEW OF SOIL SURVEY MAP – LAKE COUNTY SOIL DESCRIPTIONS

North Lake Trail Segment IIIA

Lake County, Florida

| Soil Map Unit | Description | Permeability | | Seasonal High Groundwater Level |
|--|--|-------------------|----------------------|---|
| | | Depth (in.) | In./hr. | |
| 8; Candler sand, 0 to 5 percent slopes | Consists of nearly level to gently sloping, excessively drained sandy soil that has thin lamellae of loamy sandy within a depth of 60 to 80 inches. It occurs as small and large areas on sandy ridges in the uplands. | 0 - 67 67 - 99 | >20 6 - 20 | The seasonal high water table is typically at a depth of more than 72 inches below the natural ground surface. |
| 9; Candler sand, 5 to 12 percent slopes | Consists of sloping to strongly sloping, excessively drained sandy soil that has thin lamellae of loamy sandy within a depth of 60 to 80 inches. It occurs as small and large areas on sandy ridges in the uplands. | 0 - 67 67 - 99 | >20 6 - 20 | The seasonal high water table is typically at a depth of more than 72 inches below the natural ground surface. |
| 10; Candler sand, 12 to 40 percent slopes | Consists of steep, excessively drained sandy soil that has thin lamellae of loamy sandy within a depth of 60 to 80 inches. It occurs as small and large areas on sandy ridges in the uplands. | 0 - 67 67 - 99 | >20 6 - 20 | The seasonal high water table is typically at a depth of more than 72 inches below the natural ground surface. |
| 21; Lake sand, 0 to 5 percent slopes | Consists of nearly level to gently sloping, well-drained to excessively drained sandy soil. It is formed in thick beds of marine and eolian sands. | 0 - 98 | >20 | The seasonal high water table is typically at a depth of more than 120 inches below the natural ground surface. |
| 23; Lake sand, 12 to 22 percent slopes | Consists of moderately steep to steep, well drained to excessively drained sandy soil. It is formed in sandy marine sediment. | 0 - 98 | >20 | The seasonal high water table is typically at a depth of more than 120 inches below the natural ground surface. |
| 34; Orlando fine sand, 0 to 5 percent slopes | Consists of nearly level to gently sloping, well drained sandy soil. It is on the upland ridge, formed in sandy marine sediment. | 0 - 30 30 - 80 | 6.3 - 20 6.3 - 20 | The seasonal high water table is typically at a depth of more than 80 inches below the natural ground surface. |

REVIEW OF SOIL SURVEY MAP – OCALA NATIONAL FOREST SOIL DESCRIPTIONS

North Lake Trail Segment IIIA

Lake County, Florida

| Soil Map Unit | Description | Permeability | | Seasonal High Groundwater Level |
|--|---|--------------|---------|--|
| | | Depth (in.) | In./hr. | |
| 9; Astatula sand, fire regime, 0 to 5 percent slopes | Consists of nearly level to gently sloping, excessively drained sandy soils. It is on ridges on marine terraces and hills on marine terraces. | 0 - 80 | 6 - 20 | The seasonal high water table is typically at a depth of more than 80 inches below the natural ground surface. |
| 10; Astatula sand, fire regime, 5 to 12 percent slopes | Consists of sloping to strongly sloping, excessively drained sandy soil. It is on ridges on marine terraces and hills on marine terraces. | 0 - 80 | 6 - 20 | The seasonal high water table is typically at a depth of more than 80 inches below the natural ground surface. |

APPENDIX II

Hand Auger Boring Procedure

HAND AUGER BORINGS

Auger borings are used when continuous sampling of soil strata close to ground surface is desired. A 3-inch diameter, hand-held bucket auger with a cutting head at its end is rotated into the ground in 1-foot sections. The sample is recovered by withdrawing the auger out of the ground without rotating it. The soil sample so obtained, is classified and representative samples put in bags or jars and brought back to the laboratory for further evaluation and testing, if necessary.

APPENDIX III

Soil Boring Locations Plotted on Trail Plan & Profile Sheets by Stantec Consulting Services, Inc.

| | | | | | | | | | | | | | | | |
|-----------|------|---------------|-----------|-----------|----------------|---------------|----------------|------------------|------------|----------------|----------------|-------------------|-------------------|------|------|
| SIGNATURE | DATE | APPROVED: TBO | DATE: TBD | DRAWN: JG | DATE: 04/01/24 | DESIGNED: CSM | DATE: 04/01/24 | FIELD BOOK: N.A. | PAGE: N.A. | SURVEYED: N.A. | DATE: 07/07/21 | REVISION: R - 185 | REVISION: R - 276 | DATE | DATE |
| | | | | | | | | | | | | | | | |

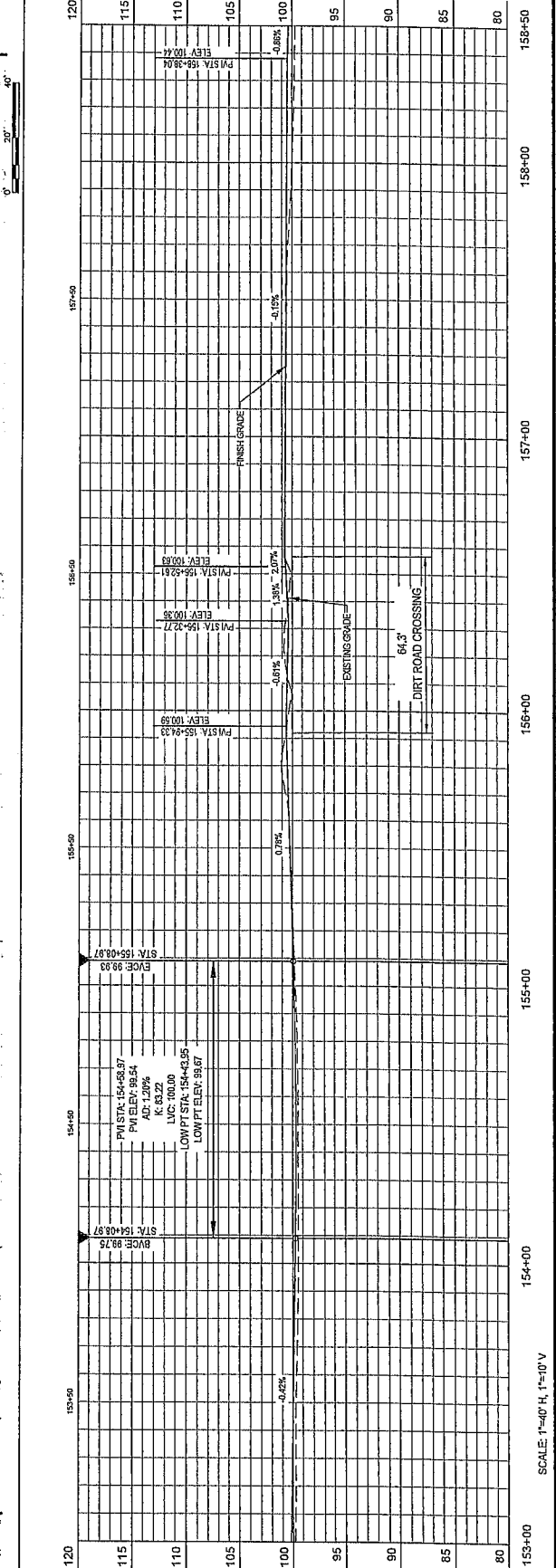
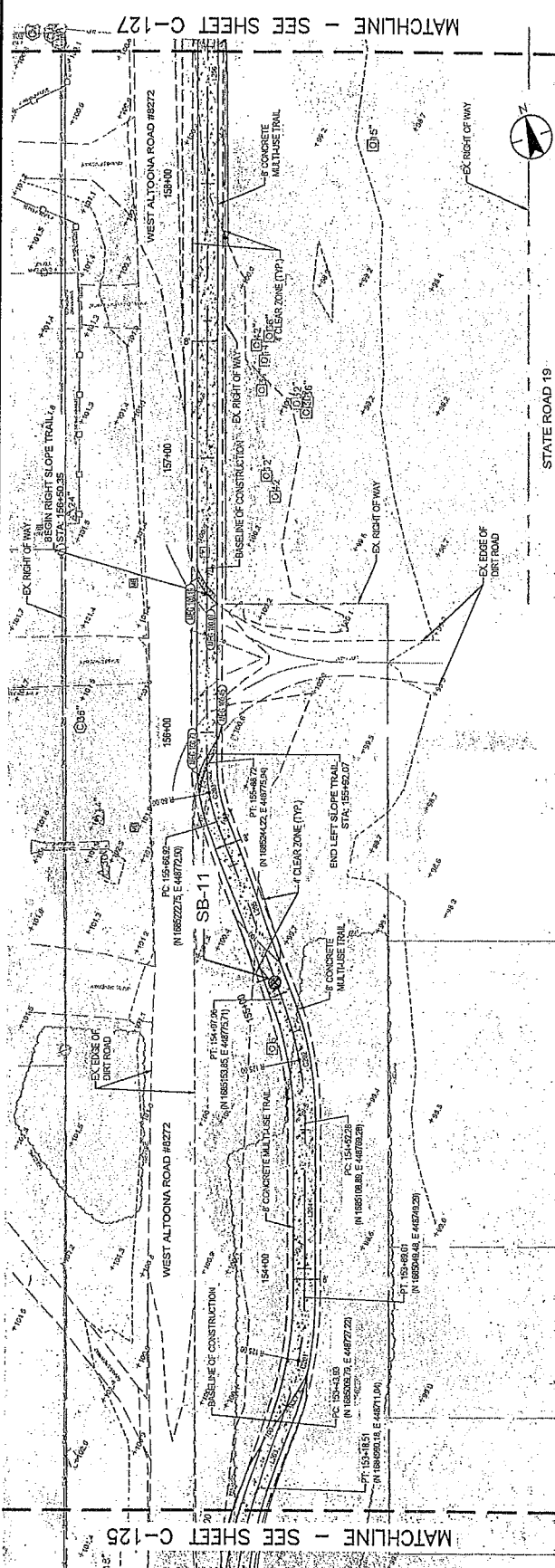

SCALE: 1"=40' H, 1"=10' V
90% DESIGN SUBMITTAL

NORTH LAKE TRAIL
SEGMENT III-A
TRAIL PLAN & PROFILE STA.
153+00 TO STA. 158+50
DRAFT FOR REVIEW ONLY

JOB NO.: 215811267
SHEET: C-126

DEPARTMENT OF PUBLIC WORKS
ENGINEERING DIVISION
350 N. SHILAH
TALLAHASSEE, FLORIDA 32378

| | | | | | | | | | | |
|------|-----------|----------|------|----------|------|----------|------|----------|------|----------|
| DATE | SIGNATURE | REVISION | DATE | REVISION | DATE | REVISION | DATE | REVISION | DATE | REVISION |
| | | | | | | | | | | |

DEPARTMENT OF PUBLIC WORKS
ENGINEERING DIVISION

350 N. SHUCLAR AVENUE, FLORIDA 32775

NORTH LAKE TRAIL
SEGMENT III-A
TRAIL PLAN & PROFILE STA. 165+50 TO STA. 170+50
DRAFT FOR REVIEW ONLY

JOB NO.: 215B1267
SHEET: C-129

SURVEYED: N.A. DATE: 07/07/21
FIELD BOOK: N.A. PAGE: N.A.
DESIGNED: CSM DATE: 04/01/24
DRAWN: JC DATE: 04/01/24
APPROVED: TBD DATE: TBD

S. - 6
1. - 1B5
R. - 27E

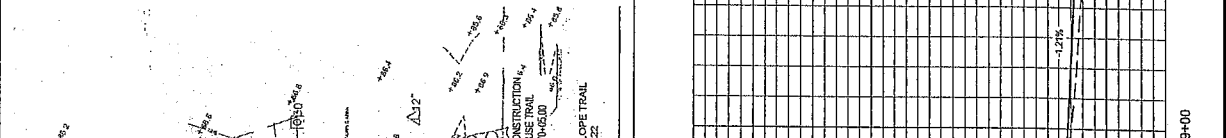
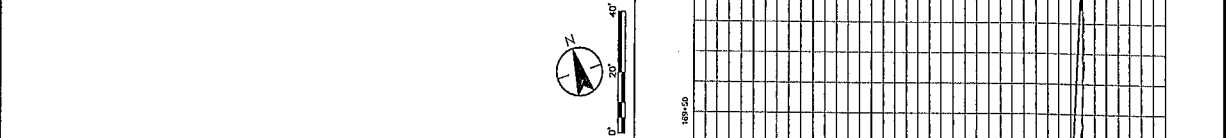

MATCHLINE - SEE SHEET C-128

SCALE: 1"=40' H, 1"=10' V

90% DESIGN SUBMITTAL

PLOTTED BY: Hatcher, Chandler 5/22/2024 3:45 PM

V:\2156\Temporary\Segment_3A-Design\drawing\03_design\sheet_files\215B11267_01c_0126-129.dwg

ADDENDUM #1

North Lake Trail – East Collins Street to Beach Street
Project No. 2026-01, Bid No. 26-702

This addendum is being issued to make the following changes, corrections, clarifications and additions to the bidding document. The information in this addendum modifies and changes the original bidding documents and takes precedence over the original documents. **Receipt of this addendum shall be acknowledged by the bidder by signing and dating the appropriate line on page W-4 of the bid proposal.** Failure to acknowledge this addendum may preclude consideration of the bid proposal for award.

The bid opening date remains December 11, 2025. All requests for information must be submitted by December 1, 2026.

A non-mandatory pre-bid meeting for the referenced project was held at 9:00 a.m. on November 13, 2025, via a telephone conference. The following were in attendance:

| Name | Company | Phone Number | Email Address |
|---------------|--------------------------|----------------|--|
| Tim Lusher | Art Walker Construction | | timlusher@artwalkerconstruction.com |
| Matt Kennard | Paqco Company, Inc. | | Matt@paqcoinc.com |
| Ryan Bare | SDC Construction | | RBare@sdcfl.com |
| Makayla | RCS Construction | | Makayla@rcsconstructionco.com |
| Kathy Barnes | CW Roberts Contracting | | Kathy@CWRcontracting.com |
| Diane | Bulldog Site Work | | diane@bulldogsitework.com |
| Jeff Earhart | Lake County Public Works | (352) 253-6009 | jeffrey.earhart@lakecountyfl.gov |
| Nathan Litten | Lake County Public Works | (352) 253-9027 | nathan.litten@lakecountyfl.gov |
| Joe Hinton | Lake County Public Works | (352) 253-9023 | joseph.hinton@lakecountyfl.gov |
| Deb Marchese | Lake County Public Works | (353) 253-6007 | dmarchese@lakecountyfl.gov |

This project is located in North Lake County, in the City of Umatilla and shall consist of constructing a multi-use trail along SR 19. Contractors shall bid to construct the multi-use trail from Station 12+60 to Station 42+50 as the base bid. At approximate Station 12+60 Contractor will connect to Hatfield Drive with 45 degree sidewalk/trail instead of the proposed connection to E. Collins Street (CR 450 East) as shown in the plans. Trail construction shall consist of stabilized subgrade under the concrete as well as asphalt, limerock, installation of Reinforced Concrete Pipe and Miter End Sections, striping, signing, cast-in-place detectable warning mats, 4' concrete separators, 6" concrete, sod, and other miscellaneous incidental construction.

Contractor shall also provide a cost to construct the multi-use trail from Station 42+50 to Station 58+50 as bid alternate 1.

Contractor shall also provide a cost to construct the multi-use trail from Station 58+50 to Station 74+00 as bid alternate 2.

Work performed under this contract shall be based on a lump sum bid. Quantities, if shown in the construction plans, are estimated for bidding purposes only and shall be verified by the contractor.

Pay special attention to all notes shown in the construction plans.

Any fences to be relocated shall be moved to the right of way line. If there is an existing gate at a driveway, then match the width of the driveway to the width of the gate. Contractor shall coordinate any fence relocation with the property owner.

Contractor shall video the project limits prior to beginning construction. The video shall be on a thumb drive and provided to Lake County before construction begins. Detail should be given to all existing fence lines, driveways, hedge lines, etc., to document existing conditions prior to construction.

Bid to sod all disturbed areas matching all existing grass types. Contractor shall be responsible for watering all sod until there is established growth.

All utilities shown in the construction plans to be relocated shall be the responsibility of the utility provider to relocate. Contractor is responsible for the coordination of all utility relocation.

Contractor shall provide two complete sets of red-lined record drawings upon completion of the project. One submitted set is to be on a flash drive while the other in paper format. The record drawings must show all additions, omissions, and adjustments made throughout construction of the project. The record drawings are to be signed and sealed by a professional engineer or surveyor, licensed to do business in the State of Florida. The record drawings are to be a complete set of construction plans, but only sheets that display changes must be signed and sealed by the engineer or surveyor.

Contractor shall add a line item to the bid tabulation sheet in Division W of the bidding document for any items that may be required but not shown on the tabulation sheet.

No oral interpretations will be made to any bidder as to the meaning of the Specifications, or any other Contract Documents. Every request for such an interpretation must be in writing, and shall be received by the Office of Procurement Services not less than ten (10) calendar days prior to the date set for opening of bids. Every interpretation made to a bidder will be made by an addendum to the Contract Documents, which, when issued, will be sent as promptly as is practicable to all persons to whom the Specifications have been issued by the County. All such addenda shall

become part of the Contract Documents. No substitution of any kind or riders of any nature to the bids will be considered except by the above described method. For purposes of this Contract the term "Interpretations" shall include the approval of product substitution. All requests for interpretation shall be submitted to Gretchen Bechtel, Senior Contracting Officer, at gretchen.becht@lakecountyfl.gov and copied to Deb Marchese, Construction Program Supervisor, at deborah.marchese@lakecountyfl.gov .

Each Contractor shall visit the site of the proposed work and fully acquaint themselves with conditions relating to construction and labor so that they may fully understand the facilities, difficulties and restrictions attending the execution of work under the contract.

Questions Asked Via Email:

Q1: Is there an engineer's estimate or budget number for the North Lake Trail – East Collins Street to Beach Street project?

A1: The engineer's estimate is \$828,864 for the base bid, \$550,765 for Alternate #1, and \$418,814 for Alternate #2.

Questions Asked at the Pre-Bid Meeting:

Q2: There appears to be pages missing from the construction plans posted on the website?

A2: The construction plans posted on the Procurement website were reviewed and it was verified that all 80 pages are available on the website to be downloaded and printed. Please contact Deb Marchese at 352-253-6007 if you have any questions regarding the construction plans or feel you do not have all the construction plan pages.

Q3: There is a bid tabulation item shown as Patterned Pavement. Please advise what this means – stamped asphalt or something in the concrete?

A3: Contractor shall disregard item 0523-3 "Pattern Pavement" as this item is not needed for this project.

Q4: The bid tabulation shows 4" thick concrete sidewalk and driveways and 6" thick concrete sidewalk and driveways as pay items. Is that where you want the trail to go or is there going to be a separate line item for the trail?

A4: The areas of the trail that are concrete shall be constructed with 6" thick concrete.

Q5: Everywhere on the plans it shows 6" thick concrete. I did not see any 4" thick concrete – please confirm if and where 4" thick concrete is required on this project.

A5: There does not appear to be 4" thick concrete on this project. Please disregard item 522-1 "Concrete sidewalk and driveways 4" thick".

Q6: Are CADD files available?

A6: The CADD files are now available on the Procurement website.

Q7: Plan sheet CD105, approximately station 62+00 identifies a private sign and electrical service to be relocated outside the clear zone and to coordinate with property owner. Who is absorbing the cost of this work? Is the property owner responsible for the relocation expense?

A7: Contractor shall provide a cost to relocate this sign and the electrical components outside of the clear zone of the trail. There are blank spaces in the Bid Tabulation sheets for added items.

Q8: Typical sections show stabilized subgrade beyond the limits of base and paving, however, the cross sections do not show stabilized subgrade to be outside of the base-paving limits. Please clarify.

A8: Contractor shall bid to construct the stabilized subgrade 2 feet outside of the edge of the trail as shown on Sheets C-501 and 502 of the construction plans.

Q9: Bid for identifies that the base bid is to start at Station 12+60, however the plan sheets show work to occur at Station 10+56 and 11+26. Please confirm starting station.

A9: . Contractors shall bid to construct the multi-use trail from Station 12+60 to Station 42+50 as the base bid. At approximate Station 12+60 Contractor will connect to Hatfield Drive with 45 degree sidewalk/trail instead of the proposed connection to E. Collins Street (CR 450 East) as shown in the plans.

Q10: Plans issued show work beyond station 74+00 which is identified as the end station for Alternate 2. Please confirm the bid is only through Station 74.

A10: This project ends at Station 74+00.

Deborah Marchese, Construction Program Supervisor

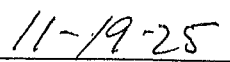
Date

ADDENDUM #2

North Lake Trail – East Collins Street to Beach Street
Project No. 2026-01, Bid No. 26-702

This addendum is being issued to make the following changes, corrections, clarifications and additions to the bidding document. The information in this addendum modifies and changes the original bidding documents and takes precedence over the original documents. **Receipt of this addendum shall be acknowledged by the bidder by signing and dating the appropriate line on page W-4 of the bid proposal.** Failure to acknowledge this addendum may preclude consideration of the bid proposal for award.

The bid opening date remains December 11, 2025. All requests for information must be submitted by December 1, 2025.

To ensure that you have the most up to date construction plans, please go to the Procurement Website at www.lakecountyfl.gov. Click on Services and then Purchasing/Bids. Click on Solicitations and then you will see 26-702 which is the North Lake Trail solicitation. Once you open the North Lake Trail solicitation you need to open the Bid Announcement and there is a link titled "26-702 – Construction North Lake Trail – E Collins-Altoona Rd" That link will bring up all documents including the final plans.

Questions Asked Via Email:

Q1: Is there an engineer's estimate or budget for the North Lake Trail Base Bid? Alternate #1? Alternate #2?

A1: As stated in Addendum #1, the engineer's estimate is \$828,864 for the base bid, \$550,765 for Alternate #1, and \$418,814 for Alternate #2.

Q2: What is the proposed contract time to substantial completion for the Base Bid? What is the proposed contract time to Final completion for the Base Bid? What is the proposed contract time to substantial completion for the Base Bid combined with Alternate #1? What is the proposed contract time to final completion for the Base Bid combined with Alternate #1? What is the proposed contract time to substantial completion for the Base Bid combined with Alternate #2? What is the proposed contract time to final completion for the Base Bid combined with Alternate #2? What is the proposed contract time to substantial completion for the Base Bid combined with Alternate #1 and #2? What is the proposed contract time to final completion for the Base Bid combined with Alternate #1 and #2?

A2: Contractor shall determine and bid the number of days for completion of the project.

Q3: Is there a Bid Bond Form?

A3: Contractor shall utilize a standard bid form from a surety authorized to do business in the State of Florida.

Q4: Do you have a summary of quantities for the Base Bid, Alternate #1 and Alternate #2?

A4: As stated at the pre-bid meeting and in Addendum #1, "Work performed under this contract shall be based on a lump sum bid. Quantities, if shown in the construction plans, are estimated for bidding purposes only and shall be verified by the contractor."

Q5: There is no drainage shown in the plans for Alternate 2 area.

A5: Contractor shall disregard pay items in Alternate Bid #2 that do not apply. There are blank spaces provided in the Bid Tabulation for the Contractor to write in any missing items they find.

Q6: The drainage is the incorrect size in the base bid according to the plans. The plans show 15" RCP, and the bid form is 18" RCP.

A6: Contractor shall disregard pay items 0430175118 and 0430982125 and add pay items 04301755115 "Pipe Culvert, Optional Material, Round, 15" S/CD" and 0430982123 "Mitered End Section, Round, 15" CD" in the Base Bid portion.

Q7: Can you add an embankment item for all 3 sections?

A7: As stated at the pre-bid meeting and in Addendum #1, Contractor shall add a line item to the bid tabulation sheet in Division W of the bidding document for any items that may be required but not shown on the tabulation sheet.

Q8: For the borrow item I don't know how you want to have it set up since the other sections are alternates, but base bid is an excess. Alternate 1 is a deficit, and Alternate 2 is an excess and all 3 together is an excess. So no dirt needs to be bought and imported unless it is not quality material.

A8: The county will provide a location within the project area to store the excess borrow if alternative 2 is not awarded.

Q9: Can you add an inlet protection item for the base bid please?

A9: As stated at the pre-bid meeting and in Addendum #1, Contractor shall add a line item to the bid tabulation sheet in Division W of the bidding document for any items that may be required but not shown on the tabulation sheet.

Q10: Can a Clear and Grub item be added to the bid form please?

A10: As stated at the pre-bid meeting and in Addendum #1, Contractor shall add a line item to the bid tabulation sheet in Division W of the bidding document for any items that may be required but not shown on the tabulation sheet.

Q5: Please confirm if there is any existing striping that will need to be removed or painted over.

A5: Contractor shall include in their bid a cost to remove, by grinding, all conflicting striping.

Q6: It seems as though most of the intersections and driveway crossings are missing or don't match which case number sheet to reference for signage and striping. For each intersection and driveway crossing, please provide which case number sheet to follow.

A6: At approximate Station 16+80, (Mary Street) contractor shall use Plan sheet C-504 "Case II Minor Street Crossing" along with the noted "Special Emphasis" crosswalk and traffic separator as shown on Sheet C-102. At approximate Station 17+80, contractor shall include a Thermoplastic Stop bar and a R1-1 Stop sign. It appears the rest of the crossings have the correct Case numbers.



Deborah Marchese, Construction Program Supervisor

12-3-25
Date