



Right-of-Way Utilization Permit

Please complete a separate application for each road

Applicant Name: City of Clermont / Attn: Paul Roy

Date: 3-3-15

Paul Roy
Name Permit Will Be Returned To:

1733 / 24 / 22 / 25
County Road # Section Township Range

3335 Hancock Road
Street Address

12th Street / Lake Minnedoa Shores
Road Name

Clermont, FL 34711
City, State, Zip

Westside Water Main Loop /
Subdivision and/or Site Plan Name / Number

352-241-0178
Telephone Number

proy@clermontfl.org
Applicant's e-mail address

32615 / Credit Card
Paid Date Rec'd By

If this project will result in any new above ground structures, poles, or facilities please state where and what is proposed. Applicant may be requested to provide an engineer's certification that roadway clearance and sight distances have been met.

Description of Work: Construction of 12" Water Main via Horizontal Directional Drilling and Open Cut methods see attached plans). Plans are being submitted for 12th Street only, CR 561.

Contractor: N/A
Start of Construction Date: Summer 2015 (est.)
Is proposed work within city limits? YES

Telephone Number: N/A
Length of time of construction: 365 +/- days
If so, what city? CLERMONT

A letter of notification was mailed on (see attached please) to the following utilities & municipalities:

Applicant declares that he/she has determined the location of all existing underground and aerial utilities.
Applicant declares that he/she has read the attached application requirements and permit conditions.

[Signature]
Signature Of Applicant

PAUL ROY
Applicant, Please Print Name

To be completed by County Staff

Permit # <u>6608</u>	Permit Fee: \$100.00	Fee Code: <u>PWRW</u>
Checked by: <u>[Signature]</u>	Date Checked: <u>3-23-15</u>	
Approved by: <u>[Signature]</u>	Date Approved: <u>3-23-15</u>	
Special Conditions: <u>See Lake County's open cut detail - attached. Amended to go on additional 3-23-17 1/5. Block 75 2-25-16</u>	Expiration Date: <u>3-23-16</u>	
For inspection, call the Lake County Public Works Department at 352-483-9000 Submit Permit to: Lake County Public Works, 437 Ardice Avenue, Eustis, FL 32726		

Public Works Department
Road Operations Division

Entered Data One	<u>3-4-15</u>
First Scan	<u>"</u>
Updated Data One	<u>3-25-15</u>
Second Scan	<u>"</u>
Returned to Client	<u>"</u>

Right-of-Way Utilization Permit
Effective July 2012



Right-of-way Utilization Permit Requirements

The purpose of the Right-of-Way Utilization permit is to control the use of public rights-of-way and public easements and protect the health, safety and welfare of the public. Any work within public rights-of-way requires an approved right-of-way utilization permit.

Application Requirements:

For each road involved, please submit one (1) original application and supporting documentation to the Lake County Department of Public Works.

Completed applications must include a sketch or construction plans drawn to scale, showing the following:

1. The offset from the centerline of the right-of-way or roadway to the proposed utility installation, the road right-of-way width and pavement width, the distance from the edge of pavement to the utility, sidewalks, and the location of all other utilities, including traffic signal utilities, within the area of work.
2. One or more typical cross sections to adequately reflect the location of the utility. Please indicate the minimum vertical clearance above or below the pavement or natural ground.
3. The location of the area of work in relation to the nearest road intersection, bridges, railroad crossings, and other physical features. Please include a location or vicinity map showing the general location of the installation.

All permit applications must demonstrate that the proposed improvements conform to the right-of-way utilization requirements included in the *Lake County Land Development Regulations*.

Projects of significant length and land size may require a complete right-of-way survey.

A performance bond may be required of the applicant in the event the work covered by the right-of-way utilization permit has the potential to significantly damage the right-of-way. The amount of the performance bond shall be 110% of the estimated cost to repair such damage, as determined by Lake County.

Prior to construction, applicant shall provide written notice to all property owners adjacent to the project limits. This notice shall include, at a minimum, the anticipated construction schedule, maintenance of traffic plan and any impacts, permanent or temporary, to the adjacent properties. The notice must provide contact information including the name and telephone number of the project manager. Within a minimum of fourteen (14) calendar days prior to construction, applicant shall provide to the County a copy of the notification with a list of the parties notified.

A copy of the approved permit and related supporting documents shall be on site at all times during construction.

Permit Conditions:

Whenever necessary for the construction, maintenance, operation or alteration of the right-of-way, as determined by the County, any or all of the appurtenances authorized by this permit shall be immediately removed from the right-of-way or relocated, as required by the County, at the expense of the applicant unless reimbursement is specifically authorized.

If above ground utilities are being replaced, the old utilities and utility appurtenances must be removed from County right-of-way within thirty (30) days after new utilities are installed.

All work, materials and equipment shall meet all County codes and standards and shall be subject to inspection by the County. All right-of-way disturbed by this work shall be restored to its original condition or better and in accordance to applicable County Codes. All disturbed areas must be sodded, matching existing grass type. Bahia sod shall be used if no grass is present at time of construction.

The construction and maintenance of this utility shall not interfere with the property and rights of a prior applicant.

Where possible, excavation shall not be allowed within five (5) feet from the edge of the pavement. Situations that cannot meet this requirement shall require prior approval of the County.

The County shall be notified twenty-four (24) hours in advance of starting work. In the interest of public safety all operations shall take place during daylight hours, unless specifically authorized, and discontinued by sunset with proper signage and traffic control devices maintained during off hours.

All traffic detours shall be restricted to the limits of right-of-way with necessary flagmen and marking devices. A traffic detour or lane closure shall require specific approval by the County.

Written approval from the Lake County Engineer shall be required before any alterations to existing traffic signal equipment including, but not limited to: vehicle detection loops and signal timing.

If traffic signal vehicle detection loops are rendered inoperable, temporary detection shall be installed within twenty-four (24) hours.

All traffic signal utilities disturbed by this work shall be restored to its original condition or better. Traffic signal utilities include but not limited to: vehicle detection loops, conduit, cabling, pull boxes, pedestrian signal equipment, span assemblies, signal heads, cabinet assemblies, cameras and fiber optic infrastructure.

All utility construction and maintenance shall be performed with proper shoring, barricades, and maintenance of traffic signage in accordance with the *Manual of Uniform Traffic Control Devices*, with the regulations of Florida Industrial Safety Board, and the *Florida Department of Transportation Safety Manual*.

The County shall not be responsible for damages to any structure placed within the right-of-way. All structures shall be properly maintained, adequately visible or properly delineated to prevent damage due to normal maintenance of the right-of-way.

Open cuts of roads will not be allowed unless specifically authorized by Lake County. Directional bore or jack and bore operations should maintain a five (5) foot minimum clearance from edge of pavement on road crossing each side. Recommended bore depth is thirty-six inches (36") and a minimum bore depth is thirty inches (30"). Any overhead installations should maintain a minimum of eighteen (18) feet vertical clearance over all roadways and driveways.

This permit is effective for one year from its approval date, unless otherwise rescinded by Lake County.

Inspection and Approval of Work:

The County shall have the right to inspect and approve all materials and/or phases of work. Final inspection and acceptance of work by the County must be obtained to document the completion of the work. All work shall be subject to the construction requirements and inspections as required in other provisions of the *Lake County Land Development Regulations*. Pursuant to Section 337.403(1), Florida Statutes, any utility placed upon, under, over, or along any public road or publicly owned rail corridor that is found by Lake County to be unreasonably interfering in any way with the convenient, safe, or

continuous use, or maintenance, improvement, extension, or expansion, of such public road or publicly owned rail corridor shall, upon thirty (30) days written notice to the utility or its agent by Lake County be removed or relocated by such utility at its own expense.

It is agreed that in the event the installation, adjustment or relocation of said utilities are scheduled to be done simultaneously with Lake County construction work, the applicant shall coordinate with Lake County before proceeding and shall cooperate with the Lake County's contractor to arrange the sequence of work so as not to delay the work of Lake County contractor, defend any legal claims of Lake County's contractor due to delays caused by the applicant's failure to comply with the approved schedule, and shall comply with all provisions of the law and Lake County's current *Utility Accommodation Manual*. The applicant shall not be responsible for delay beyond its control.

All right-of-way utilization activities shall be reported to Sunshine State One-Call at least seventy-two (72) hours prior to commencement.

Guarantee and Responsibility for Compliance:

In the case of noncompliance with the County's requirements, this permit will be void and the facility will be brought into compliance or removed from the right-of-way at no cost to the County.

The County may issue "Stop Work" order(s) upon any permittee committing or creating an unsafe act which may create a public hazard or who is not complying with this permit or the applicable codes. The order shall remain in effect until such time as these matters are corrected.

Permits shall be issued with the understanding that the applicant shall guarantee all work performed under the terms of the permit for a period of one (1) year from the date of final inspection and acceptance of work.

Any failures shall be repaired by the applicant, at the direction of the County, within five (5) days, unless the urgency of the problem requires a quicker reaction time.

The applicant shall be responsible for all repair costs incurred due to damages to existing utilities by failure to use due care, including errors in locating existing utilities during construction.

Removal/Relocation of Improvements: Upon ten (10) days written notice, the applicant shall be required to remove and/or relocate the improvements placed within the right-of-way at the applicant's sole expense.

It is expressly stipulated that this permit is a license for permissive use only and that the placing of facilities upon public property pursuant to this permit shall not operate to create or vest any property right in said holder.

It is understood and agreed that the rights and privileges herein set out are granted only to the extent of the County's right, title and interest in the land to be entered upon and used by the holder, and the holder will, at all times, assume all risk of and indemnify, defend and save harmless the County of Lake from and against any and all loss, damage, cost or expense arising in any manner on account of the exercise or attempted exercises by said holder of the aforesaid rights and privileges.

I have read and understand the above requirements

Applicant's Signature/Date

See updated application dated Feb 2015

It is agreed that in the event the installation, adjustment or relocation of said utilities are scheduled to be done simultaneously with Lake County construction work, the applicant shall coordinate with Lake County before proceeding and shall cooperate with the Lake County's contractor to arrange the sequence of work so as not to delay the work of Lake County contractor, defend any legal claims of Lake County's contractor due to delays caused by the applicant's failure to comply with the approved schedule, and shall comply with all provisions of the law and Lake County's current *Utility Accommodation Manual*. The applicant shall not be responsible for delay beyond its control.

All right-of-way utilization activities shall be reported to Sunshine State One-Call at least seventy-two (72) hours prior to commencement.

Guarantee and Responsibility for Compliance:

In the case of noncompliance with the County's requirements, this permit will be void and the facility will be brought into compliance or removed from the right-of-way at no cost to the County.

The County may issue "Stop Work" order(s) upon any permittee committing or creating an unsafe act which may create a public hazard or who is not complying with this permit or the applicable codes. The order shall remain in effect until such time as these matters are corrected.

Permits shall be issued with the understanding that the applicant shall guarantee all work performed under the terms of the permit for a period of one (1) year from the date of final inspection and acceptance of work.

Any failures shall be repaired by the applicant, at the direction of the County, within five (5) days, unless the urgency of the problem requires a quicker reaction time.

The applicant shall be responsible for all repair costs incurred due to damages to existing utilities by failure to use due care, including errors in locating existing utilities during construction.

Removal/Relocation of Improvements: Upon ten (10) days written notice, the applicant shall be required to remove and/or relocate the improvements placed within the right-of-way at the applicant's sole expense.

It is expressly stipulated that this permit is a license for permissive use only and that the placing of facilities upon public property pursuant to this permit shall not operate to create or vest any property right in said holder.

It is understood and agreed that the rights and privileges herein set out are granted only to the extent of the County's right, title and interest in the land to be entered upon and used by the holder, and the holder will, at all times, assume all risk of and indemnify, defend and save harmless the County of Lake from and against any and all loss, damage, cost or expense arising in any manner on account of the exercise or attempted exercises by said holder of the aforesaid rights and privileges.

I have read and understand the above requirements



Applicant's Signature

3/3/2015

Date

OPEN CUT DETAIL

STANDARD INSTALLATION OF CROSS DRAIN PIPE FOR APPROVED OPEN CUTS OR ROAD CROSSINGS DURING CONSTRUCTION.

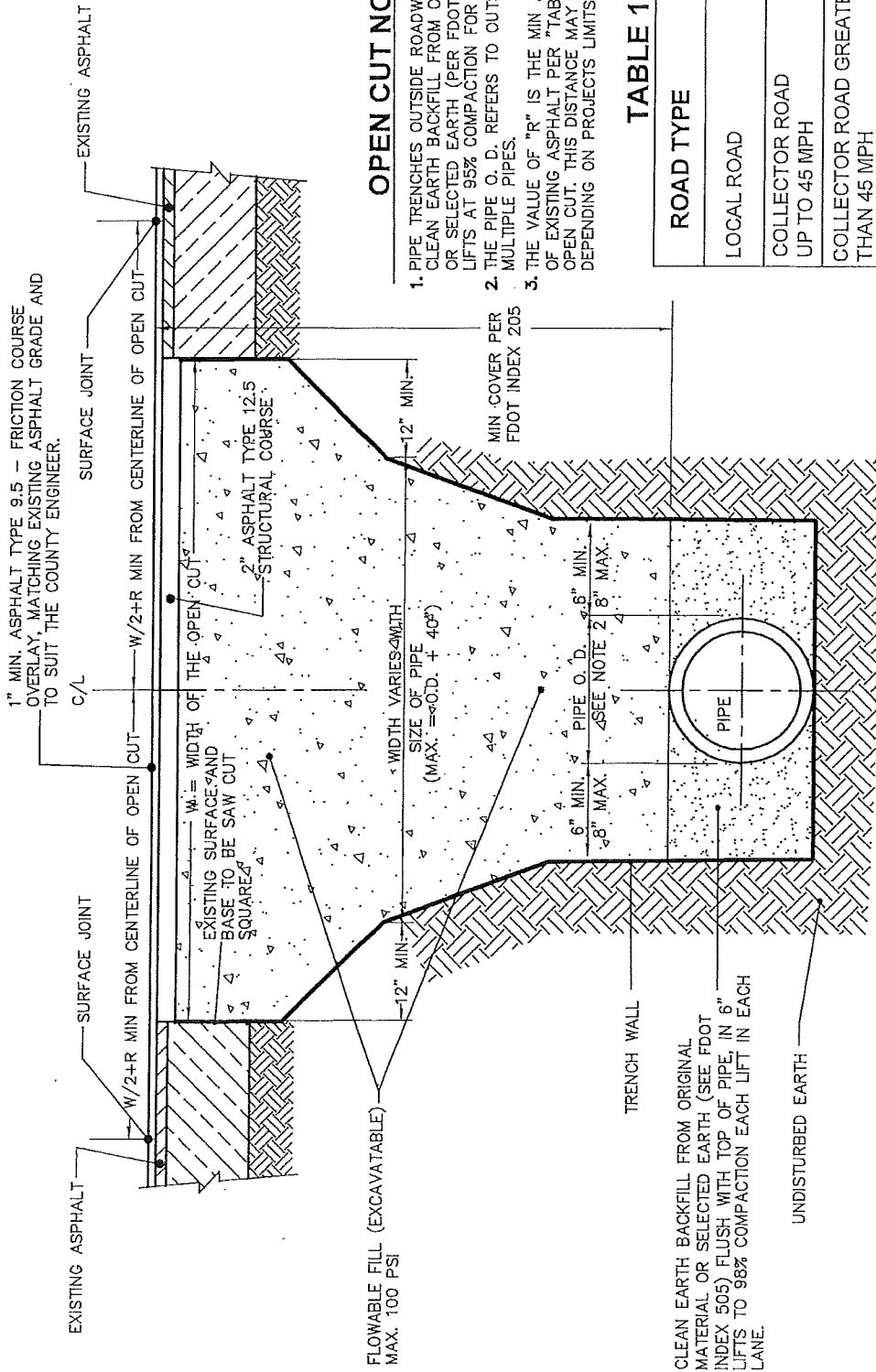

OPEN CUT NOTES

1. PIPE TRENCHES OUTSIDE ROADWAY WILL REQUIRE CLEAN EARTH BACKFILL FROM ORIGINAL MATERIAL OR SELECTED EARTH (PER FDOT INDEX 505) IN 6" LIFTS AT 95% COMPACTION FOR EACH LIFT.
2. THE PIPE O. D. REFERS TO OUTSIDE EDGES OF MULTIPLE PIPES.
3. THE VALUE OF "R" IS THE MIN. AMOUNT OVERLAY OF EXISTING ASPHALT PER "TABLE 1" PAST THE OPEN CUT. THIS DISTANCE MAY BE INCREASED DEPENDING ON PROJECTS LIMITS.

TABLE 1

ROAD TYPE	R
LOCAL ROAD	2'
COLLECTOR ROAD UP TO 45 MPH	15'
COLLECTOR ROAD GREATER THAN 45 MPH	25'

OPEN CUTS WILL NOT BE ALLOWED UNLESS SPECIFICALLY AUTHORIZED BY LAKE COUNTY PUBLIC WORKS DEPARTMENT

SECTION	TOWNSHIP	RANGE	CAD FILE ST01DCP
	DESIGNED: FJS	DATE: FEB 2012	
DRAWN: FJS	DATE: FEB 2012	DATE: FEB 2012	DATE: FEB 2012
APPROVED:	FJS	DATE: FEB 2012	DATE: FEB 2012
DEPARTMENT OF PUBLIC WORKS ENGINEERING DIVISION 437 ARDICE AVE. EUSTIS, FLORIDA 32726			OPEN CUT DETAIL FOR LAKE COUNTY MAINTAINED ROADS
 LAKE COUNTY FLORIDA			SHEET # 1

3/26/2015

<https://ebc.cybersource.com/ebc/virtualterminal/PrintSingleReceiptLoad.do>

RECEIPT

LAKE COUNTY BOCC
315 W MAIN ST
Tavares , FL 32778
Phone

03/26/2015

Transaction Type : Sale

Comment : RIGHT OF WAY PERMIT FOR 12TH ST/ LAKE MINNEOLA SHORES

Merchant-Defined Data Fields

Merchant-Defined Data Field 1 : RIGHT OF WAY UTILIZATION PERMIT

Department : PUBLIC WORKS

Merchant-Defined Data Field 3 : 5056260-341213

Total : 101.00 USD

Cardholder Information

Name HEATHER WOODING

Credit Card Type : MasterCard

Credit Card Number : #####1586

Company : CITY OF CLERMONT

Phone : 3522410178

Email : HWOODING@CLERMONTFL.ORG

CITY OF CLERMONT WESTSIDE WATER MAIN LOOP



201 EAST PINE STREET, SUITE 1000
ORLANDO, FL 32801
PHONE: (407) 839-3355 FAX: (407) 839-3700
Engineering Business No. 2429
www.tetra-tech.com



TETRA TECH

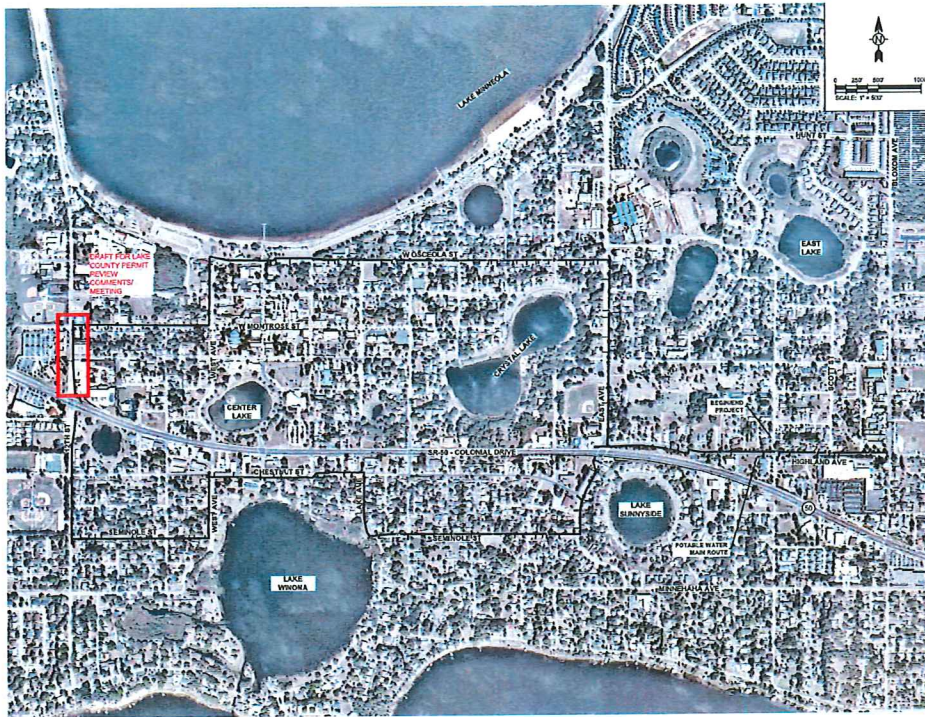

PROJECT LOCATION:
CLERMONT, FL 34711

CLIENT INFORMATION:
CITY OF CLERMONT
655 W. MONTROSE ST
CLERMONT, FL 34711

TI PROJECT No.:
200-05310-14006

CLIENT PROJECT No.:

PROJECT DESCRIPTION / NOTES:

THE CITY OF CLERMONT INTENDS TO UPGRADE PORTIONS OF THEIR EXISTING POTABLE WATER DISTRIBUTION SYSTEM TO INCREASE SYSTEM RELIABILITY IN THE WESTSIDE WATER SERVICE AREA AND TO REPLACE EXISTING AGELESS-CEMENT WATER MAINS. THE PROJECT INCLUDES CONSTRUCTION OF APPROXIMATELY 23,000 LF OF 12-INCH WATER MAINS. CONSTRUCTION OF WATER MAINS WILL UTILIZE A COMBINATION OF OPEN CUT METHODS AND TRENCHLESS TECHNOLOGIES.

ISSUED: JANUARY 2015

80% SUBMITTAL

Jarvis M. Alexander, P.E.
P.E. No. 82344, FL
251 East Pine Street, Suite 1000
Orlando, Florida 32801
Engineering Business No. 2429
DATE: _____

VICINITY MAP:

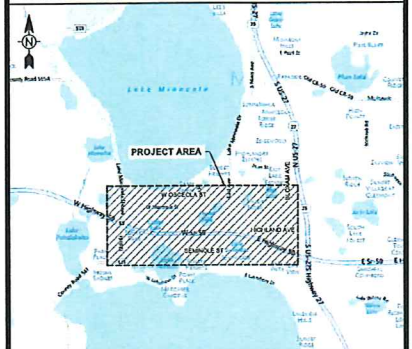

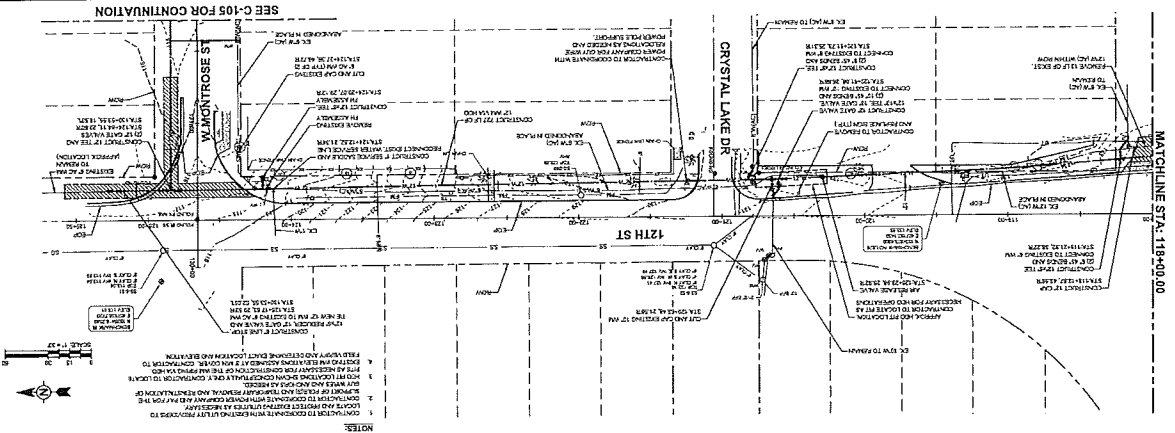
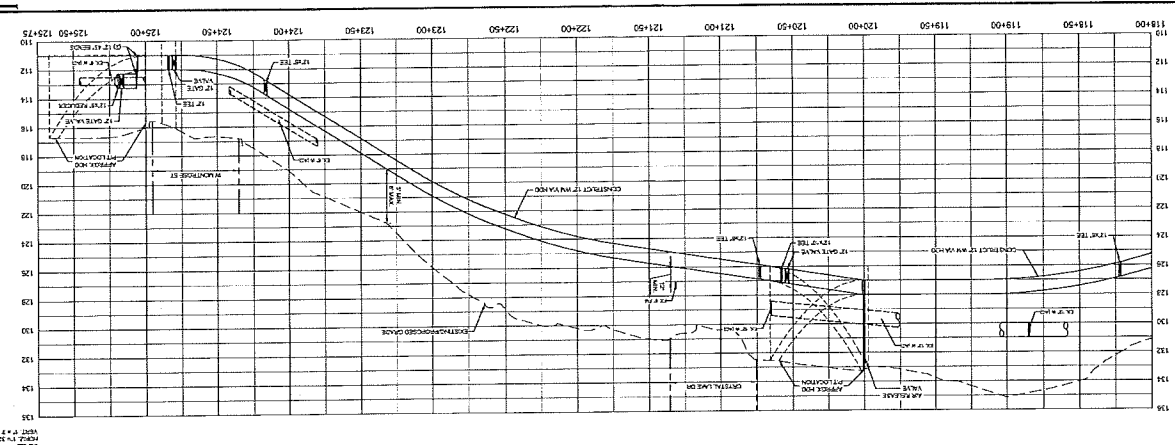

NOTES:
 1. CONTRACTOR TO COORDINATE WITH EXISTING UTILITY RECORDS TO DETERMINE EXACT LOCATION AND DEPTH OF ALL EXISTING UTILITIES.
 2. CONTRACTOR TO VERIFY THE LOCATION AND DEPTH OF ALL EXISTING UTILITIES BY FIELD SURVEY.
 3. CONTRACTOR TO VERIFY THE LOCATION AND DEPTH OF ALL EXISTING UTILITIES BY FIELD SURVEY.
 4. CONTRACTOR TO VERIFY THE LOCATION AND DEPTH OF ALL EXISTING UTILITIES BY FIELD SURVEY.
 5. CONTRACTOR TO VERIFY THE LOCATION AND DEPTH OF ALL EXISTING UTILITIES BY FIELD SURVEY.

C-104

WESTBROOK WASTEWATER TREATMENT PLANT

PLAN AND PROFILE

DATE: 11/15/11

SCALE: 1" = 40'

PROJECT NO.: 118-400-00

DESIGNED BY: M. J. WILSON, P.E.

ENGINEER: M. J. WILSON, P.E.

TETRA TECH

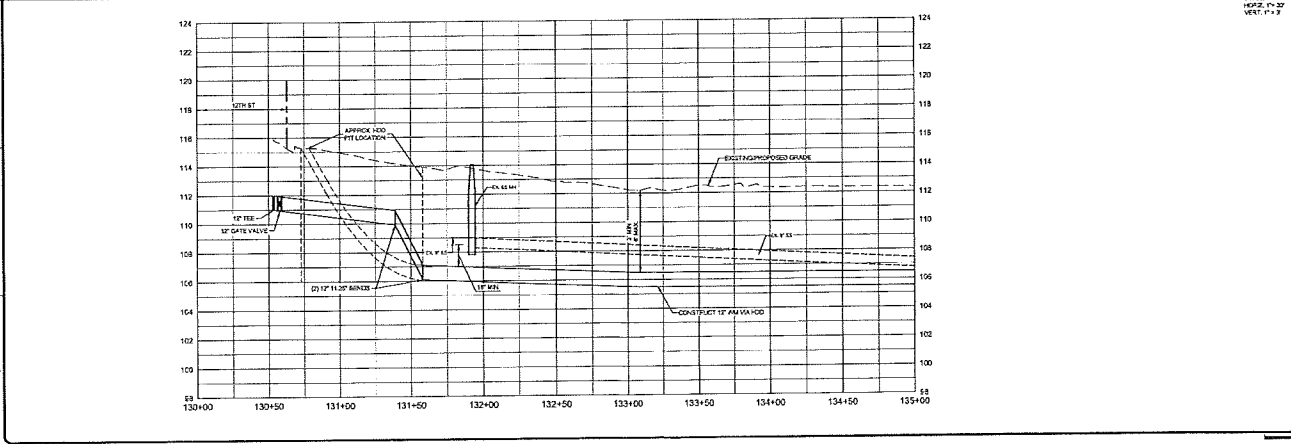
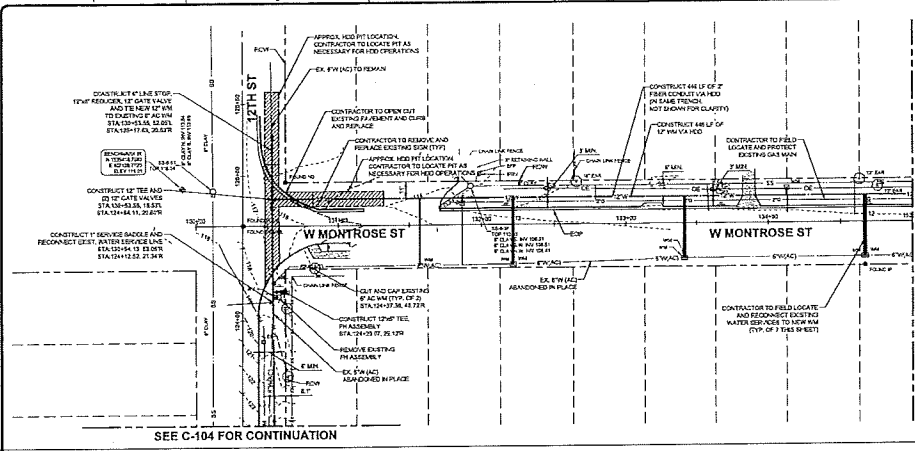

TETRA TECH
 Engineering Corporation
 201 East Pine Street, Suite 100
 Phoenix, AZ 85004
 PHONE: 602.955.1100 FAX: 602.955.1101

PROJECT: WESTSIDE WATER MAIN LOOP
 SHEET: C-105
 DATE: 08/11/11

SCALE: 1" = 10'
 HORIZ. SCALE: 1" = 40'
 VERT. SCALE: 1" = 4'

CITY OF CLEMSON
 WESTSIDE WATER MAIN LOOP
 PLAN AND PROFILE

Project No.: 20-203-D-0000
 Drawn By: JG
 Checked By: JG
 Date: 08/11/11

C-105
 Sheet
 8/11/2011 11:00 AM

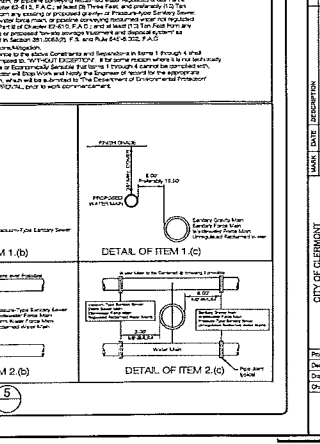
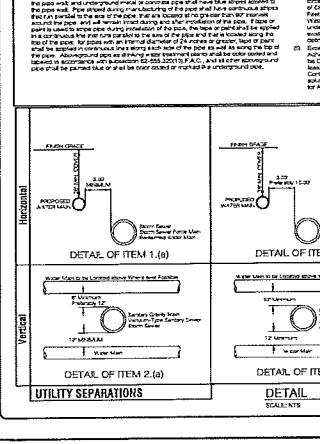
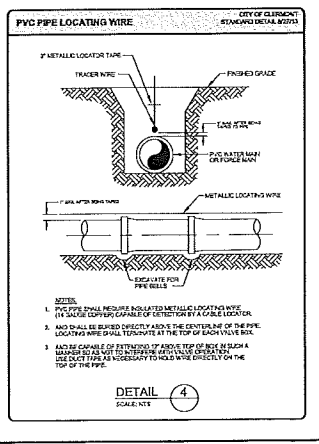
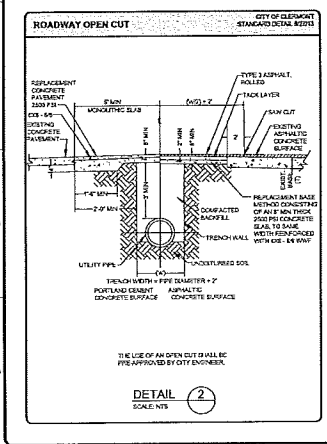
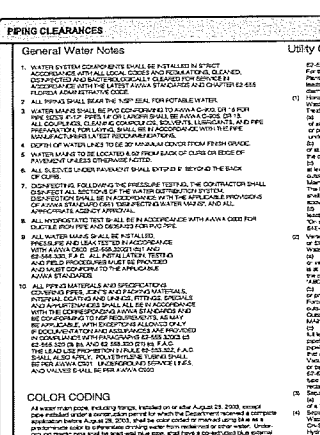
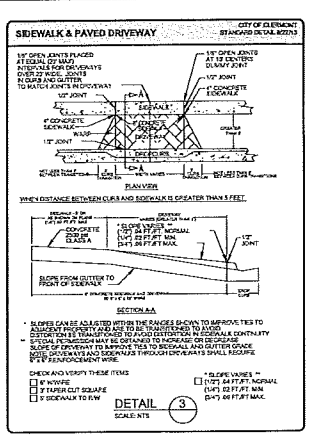
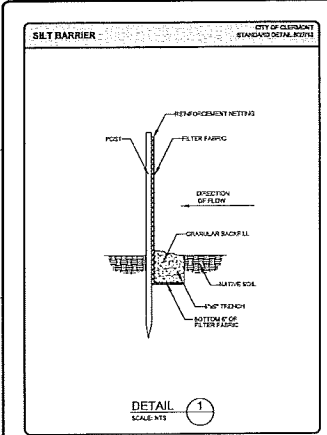

TETRA TECH
Engineering Solutions for Water
10000 W. 11th Street, Suite 1000
Tampa, FL 33613
Phone: (813) 288-1100
Fax: (813) 288-1101

PROJECT: 200-0015-0002
DESIGNED BY: JLS
CHECKED BY: JLS
DATE: 08/15/02

C-501

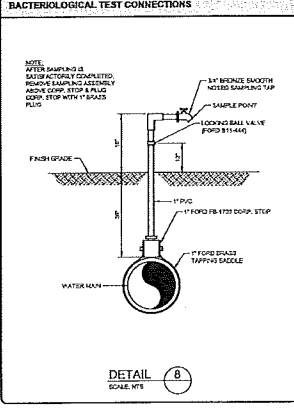
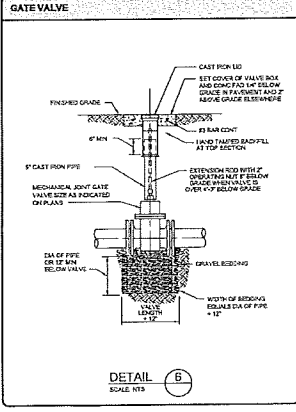
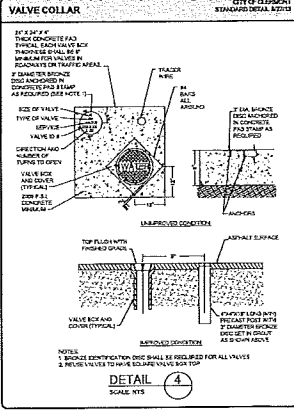
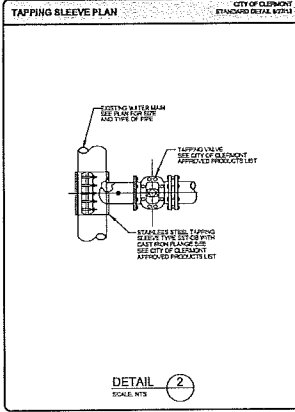
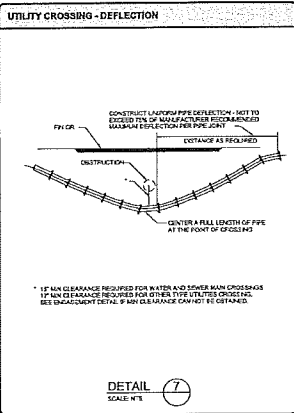
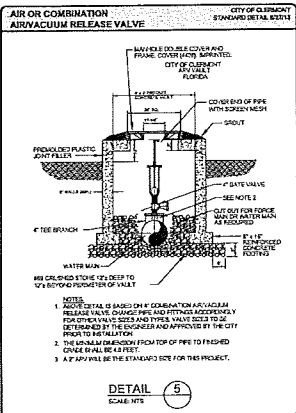
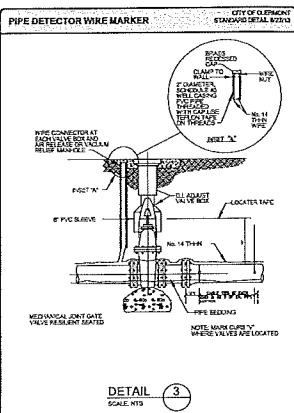
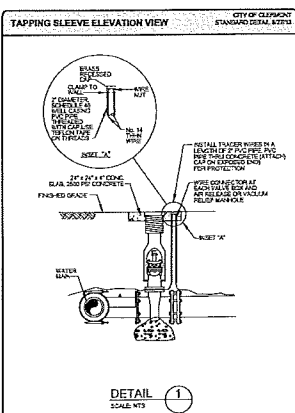

TETRA TECH
Engineering Division No. 1278
1278 East Park Street, Suite 100
Clemont, CA 92319
Phone: (951) 621-1278
Fax: (951) 621-1279

PROJECT: WATER MAIN LOOP
DATE: 05/11/11
DRAWN BY: JH
CHECKED BY: JH
DATE: 05/11/11

CITY OF CLEMONT
WATER MAIN LOOP
DETAILS

Project No.: 2010-0119-1428
Designed By: JH
Checked By: JH
Date: 05/11/11

C-503

#16608

Bilbrey, Michelle

From: Alexander, Janine <Janine.Alexander@tetrattech.com>
Sent: Tuesday, August 18, 2015 9:03 AM
To: Bilbrey, Michelle
Subject: FW: City of Clermont Westside WM Loop ROW Use Permit Submittal - Revised Plans
Attachments: Lake Co ROW Use FINAL Permit Submittal Plans.pdf; Lake Co ROW Use_Rev Plans w SR50 xing.pdf

Importance: High

Hi Michelle:

The City decided that they would replace the SR50 crossings as part of this project after all. As such, a few items changed for tie-ins at each side of the SR50 crossings where your ROW limits start. Technically, nothing really changed for your ROW limits, but I didn't want your inspector or field guys to have a set of plans that are not the most current set of plans.

As such, please see attached for your feedback and for "updating" the ROW use permit as necessary.

Please let me know if you should need anything else and thank you!
Janine

Approved ROW Permit excerpt:

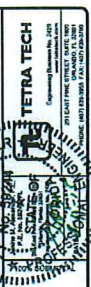

DATE	DESCRIPTION

PROJECT: WESTSIDE WATER MAIN LOOP
 CITY OF CLEERMONT
 PLAN NO.: 2024-01-005
 Drawn By: JMS
 Check By: JMS
G-005
 For Visuals Only

PROJECT: WESTSIDE WATER MAIN LOOP - CITY OF CLEERMONT - TETRA TECH, INC.

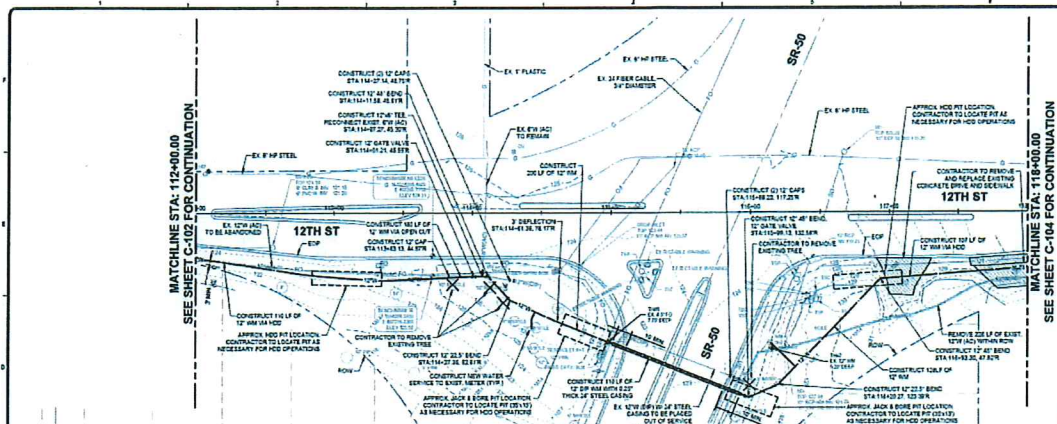

MATCHLINE STA: 112+00.00
SEE SHEET C-102 FOR CONTINUATION

MATCHLINE STA: 118+00.00
SEE SHEET C-104 FOR CONTINUATION

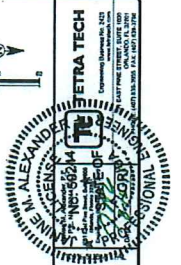

TETRA TECH
Engineering & Construction
1000 North 17th Street, Suite 1000
Falls Church, VA 22046
Tel: 703.261.1000
Fax: 703.261.1001
www.tetra-tech.com

- NOTES:**
1. CONTRACTOR TO COORDINATE WITH EXISTING UTILITY PROVIDERS AND TO LOCATE AND PROTECT EXISTING UTILITIES AS NECESSARY.
 2. CONTRACTOR TO COORDINATE WITH POWER COMPANY AND PAY FOR THE SUPPORT OF POLES AND TEMPORARY FRENDS AND REINSTALLATION OF COLD WIRES AND CONDUITS AS NEEDED.
 3. ALL PIT LOCATIONS SHOWN COMPLETELY UNLESS CONTRACTOR BY LOCATE PITS AS NECESSARY FOR CONSTRUCTION OF THE NEW PIPING AND HED EXISTING UTILITIES (ELEVATIONS SHOWN) IF ANY OTHER CONTRACTOR TO FIELD VERIFY AND DETERMINE EXACT LOCATION AND ELEVATION.

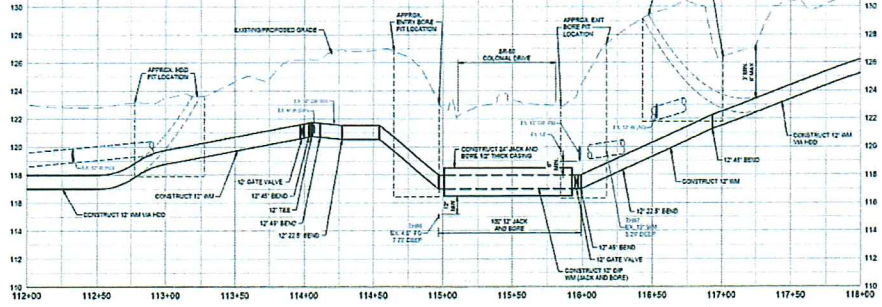

SCALE
HORIZ. 1" = 40'
VERT. 1" = 4'

DATE	SCALE	DESCRIPTION

CITY OF CLEMENT
WATER MAIN LOOP
PLAN AND PROFILE
Project No. 202470-000
Designed By: JMS
Drawn By: JMS
Checked By: JMS
C-103
Sheet
For Review Only

Bilbrey, Michelle

From: Alexander, Janine <Janine.Alexander@tetrattech.com>
Sent: Thursday, February 25, 2016 3:22 PM
To: Bilbrey, Michelle
Subject: RE: Westside Inspector/Contact

Hi Michelle:

In reviewing the approved permit, it looks like it is expiring soon. Can we have a year extension please due to the Contractor just now mobilizing in the near future?

Thanks!
Janine

From: Bilbrey, Michelle [<mailto:mbilbrey@lakecountyfl.gov>]
Sent: Tuesday, February 16, 2016 3:30 PM
To: Alexander, Janine <Janine.Alexander@tetrattech.com>
Cc: Hinton, Joseph <jhinton@lakecountyfl.gov>; McArdle, Heath <HMcaArdle@lakecountyfl.gov>
Subject: RE: Westside Inspector/Contact

Janine,

My apologies, I gave you the phone number for the wrong inspector. The number you need to call for Joe is 352-516-7712. Sorry for any inconvenience.

Thank you,
Michelle Bilbrey
Permitting Technician II
Lake County Public Works

From: Bilbrey, Michelle
Sent: Tuesday, February 16, 2016 12:30 PM
To: 'Alexander, Janine'
Cc: Hinton, Joseph; McArdle, Heath
Subject: RE: Westside Inspector/Contact

Joe Hinton is the Inspector for that area. His cell phone number is 352-516-4370.

Thank you,
Michelle Bilbrey
Permitting Technician II
Lake County Public Works

From: Alexander, Janine [<mailto:Janine.Alexander@tetrattech.com>]
Sent: Monday, February 15, 2016 8:09 AM

Rodriguez, Jeremy

From: Mark Griffin <mgriffin@clermontfl.org>
Sent: Thursday, June 02, 2016 10:57 AM
To: Rodriguez, Jeremy
Subject: RE: Permit
Attachments: 12th st water main.pdf

Follow Up Flag: Follow up
Flag Status: Flagged

Jeremy,

Attached is a map of the project location. The new 6" water main is identified by the yellow line on the map, the existing main will be abandoned in place.

Thank you,



Mark Griffin,
Environmental Services Coordinator
3335 Hancock Rd, Clermont, FL 34711
Tel 352- 241-0178 | Fax 352- 241-0542
Mgriffin@clermontfl.org
www.ClermontFl.gov

Our mission: To Preserve and enhance the quality of life for the Clermont community by providing exceptional services.

From: Rodriguez, Jeremy [<mailto:jdrodriguez@lakecountyfl.gov>]
Sent: Tuesday, May 31, 2016 4:15 PM
To: Mark Griffin <mgriffin@clermontfl.org>
Cc: Scott, Jimmy <JScott@lakecountyfl.gov>
Subject: RE: Permit

Mark,

Apologies for the delay—I was able to pass this permit along to another inspector, Paul Erickson, while Joe Hinton is out. He asked if you could provide a drawing for the PVC water main to be installed from West Montrose to West Minneola.

Thank you,

Jeremy Rodriguez
Permitting Technician II
jdrodriguez@lakecountyfl.gov
Lake County Public Works
323 N. Sinclair Ave.
Tavares, FL 32778
(352) 253-6019

From: Mark Griffin [<mailto:mgriffin@clermontfl.org>]
Sent: Wednesday, May 25, 2016 7:29 AM
To: Rodriguez, Jeremy
Cc: Tim Mattozzi; Rick Jiles; Jerrone McLaren
Subject: RE: Permit

Thank you Jeremy.



Mark Griffin,
Environmental Services Coordinator
3335 Hancock Rd, Clermont, FL 34711
Tel 352- 241-0178 | Fax 352- 241-0542
Mgriffin@clermontfl.org
www.ClermontFL.gov

Our mission: To Preserve and enhance the quality of life for the Clermont community by providing exceptional services.

From: Rodriguez, Jeremy [<mailto:jdrodriguez@lakecountyfl.gov>]
Sent: Tuesday, May 24, 2016 4:03 PM
To: Mark Griffin <mgriffin@clermontfl.org>
Cc: Scott, Jimmy <JScott@lakecountyfl.gov>
Subject: RE: Permit

Thank you Mark, I got your message. I have forwarded your request to Joe Hinton, one of our inspectors – he or I will update you as soon as we can.

Thank you,

Jeremy Rodriguez
Permitting Technician II
jdrodriguez@lakecountyfl.gov
Lake County Public Works
323 N. Sinclair Ave.
Tavares, FL 32778
(352) 253-6019

From: Mark Griffin [<mailto:Mgriffin@clermontfl.org>]
Sent: Tuesday, May 24, 2016 7:52 AM
To: Rodriguez, Jeremy
Subject: Permit

Jeremy, We would like to amend permit #6608 to include installing a PVC water main from West Montrose St to West Minneola Ave in the Eastern right-of-way of 12th St. Thank you, Mark Griffin

Website: www.clermontfl.gov

PLEASE NOTE: Under Florida law, e-mail addresses are public records. If you do not want your email address released in response to a public-records request, do not send electronic mail to this entity. Instead, contact this office by phone or in writing.

Website: www.clermontfl.gov

PLEASE NOTE: Under Florida law, e-mail addresses are public records. If you do not want your email address released in response to a public-records request, do not send electronic mail to this entity. Instead, contact this office by phone or in writing.



MINNEOLA

11TH

Connect to existing valve.

Install new 6" PVC water main.

Tie into new 12" water main.

12TH

MONTROSE

1"

1"