



Residential Driveway Apron Permit Application (Please Print or Type)

Date: 1/29/14 Bldg Permit No. _____

Name Permit Will Be Returned To: Garcia Maria

Street Address: 12826 Lake Shore Dr.

City, State, Zip: Dorment, FL 34711

Signature Of Applicant: [Signature] Phone Number: 407-420-9055

Applicant's e-mail address: VBC.GROUP@GMAIL.COM

Alt. Key# 1658713 Section 31 Township 22 Range 26

House Number / Road Name: 12826 Lake Shore Dr.

Subdivision Name: _____

Applicant, Please Print Name: ANDREIA PIROUPO

A driveway permit is required to construct a new driveway, modify an existing driveway to meet county requirements, or install a temporary construction entrance within the public rights-of-way of County maintained roads. Issuance of a driveway permit does not vest any rights to the property owner for zoning, land use changes, or site improvements. The owner must follow all County procedures for permitting.

Driveway must be constructed in accordance with the Lake County Land Development Regulations and as shown on the attached sketch. Applicant holds Lake County harmless from all damages, claims, or injuries which may result from such work. Any deviation from the attached sketch must first be approved in writing by Lake County Public Works Department. Please see attached minimum requirement details for specifications.

Check one:

- Clay Road - No apron required - culvert pipe may be required - sod all disturbed areas.
- Paved Road - Option 1: 6" limerock base and minimum 1" Type S-III Asphalt. Option 2: 6" reinforced concrete (3000 PSI) using 10 foot square of 6" x 6" wire mesh placed a minimum of 10' from edge of existing pavement. Culvert pipe may be required - Sod all disturbed areas.

In areas where sidewalks are present or planned, the driveway must include a minimum 4 foot wide path traversing the driveway apron (at a maximum 1.5% cross slope) in compliance with ADA requirements.

County Road # <u>1040</u>	To be completed by County Staff		
Driveway Permit Fee: \$50.00	- PAID	Check Number: <u>Credit Card</u>	Date: <u>1.29.14</u> Fee Code: PUBSVI
Permit # <u>14160</u>	Maint Area: _____	Signed: <u>Glennell Nichols</u>	Date Approved: <u>02/10/14</u>
Permit Shall Expire One (1) Year From Date Approved		Date Expired: <u>2.10.2015</u>	
Date of Final Inspection: _____		Inspector: _____	
Comments or special conditions: _____			
<p>The design has been reviewed and upon completion should meet the regulations and requirements as noted on this application. The driveway shall be constructed per approved subdivision plans if applicable. For inspection, call Lake County Building Services Division at 352-343-9634. For Joint (Common Split) driveway inspection, call Lake County Public Works Department at 352-483-9000. Submit permit to Lake County Public Works, 437 Ardlee Avenue, Eustis, FL 32726</p>			

Public Works Department
Road Operations Division

Entered Data One	<u>1.29.14</u>
First Scan	<u>11</u>
Updated Data One	<u>2.4.14</u>
Second Scan	<u>11</u>
Returned to Client	<u>11</u>

Residential Driveway Apron Permit
Effective August 2013



Residential Driveway Apron Permit Application Requirements

- Single Family Driveway (standard A)
- Joint Driveway (Common/Split) (standard B)
- Driveway apron as Swale Check (standard C)
- Piped Driveway apron (standard D)
- Driveway apron conforming to Grade or Swale (standard E)
- Driveway apron with Miami Curb & Gutter (standard M)
- Driveway apron with Standard Curb & Gutter (standard S)

Permit Number

*The applicable driveway apron standard will be included with approved permit that is sent to applicant. *

1. Sidewalks must be constructed per FDOT Index 310, with maximum cross slope of 1.5%, 6 inches minimum thickness. (See detail on attachment).
2. To conform to sidewalk requirements, subdivision construction plans are available for review in the Lake County Public Works Department located at 437 Ardice Avenue in Eustis.
3. Driveways are not permitted in the radius return of an intersection. Driveway aprons must be 100 feet from the nearest intersecting road and may not exceed 24 feet in width at the edge of the roadway. Variance requests should be submitted to the Lake County Public Works Department.
4. Pavers installed as a driveway apron are the resident's responsibility to maintain, replace and/or repair. If pavers are removed to facilitate Lake County and/or a utility company to perform utility installation and/or maintenance, the paver(s) used as replacements may not be able to be matched.
5. If a culvert pipe is required, it shall be the same diameter of existing culverts in neighborhood. If there are no other culverts in the neighborhood, the culvert pipe shall be a minimum of 15 inches in diameter and a minimum of 30 feet in length measured from the end of miter to the end of miter. All right-of-way must be restored to its original condition and in accordance with applicable Lake County Codes. All disturbed areas must be sodded, matching existing grass type. Applicant shall be responsible for sod until it is established.
6. Driveway apron slope may not exceed 14%. Variance requests should be submitted to the Lake County Public Works Department. In areas where sidewalks are present or planned, the driveway must include a minimum 4 foot wide path traversing the driveway apron (at a maximum 1.5% cross slope) in compliance with ADA requirements.
7. Driveway permit shall expire one (1) year from date approved.
8. Driveway Apron Permit Application shall include a check made payable to the Lake County Board of County Commissioners (BOCC).

I have read and understand the above requirements



Applicant's Signature/Date

CUSTOMER: Maria Garcia
address: 18826 Lake Shore Drive, Clermont, FL 34711
email: fala1maria@yahoo.com
phone: 787-238-6745

ANDREIA PIROUPO
407-420-91055

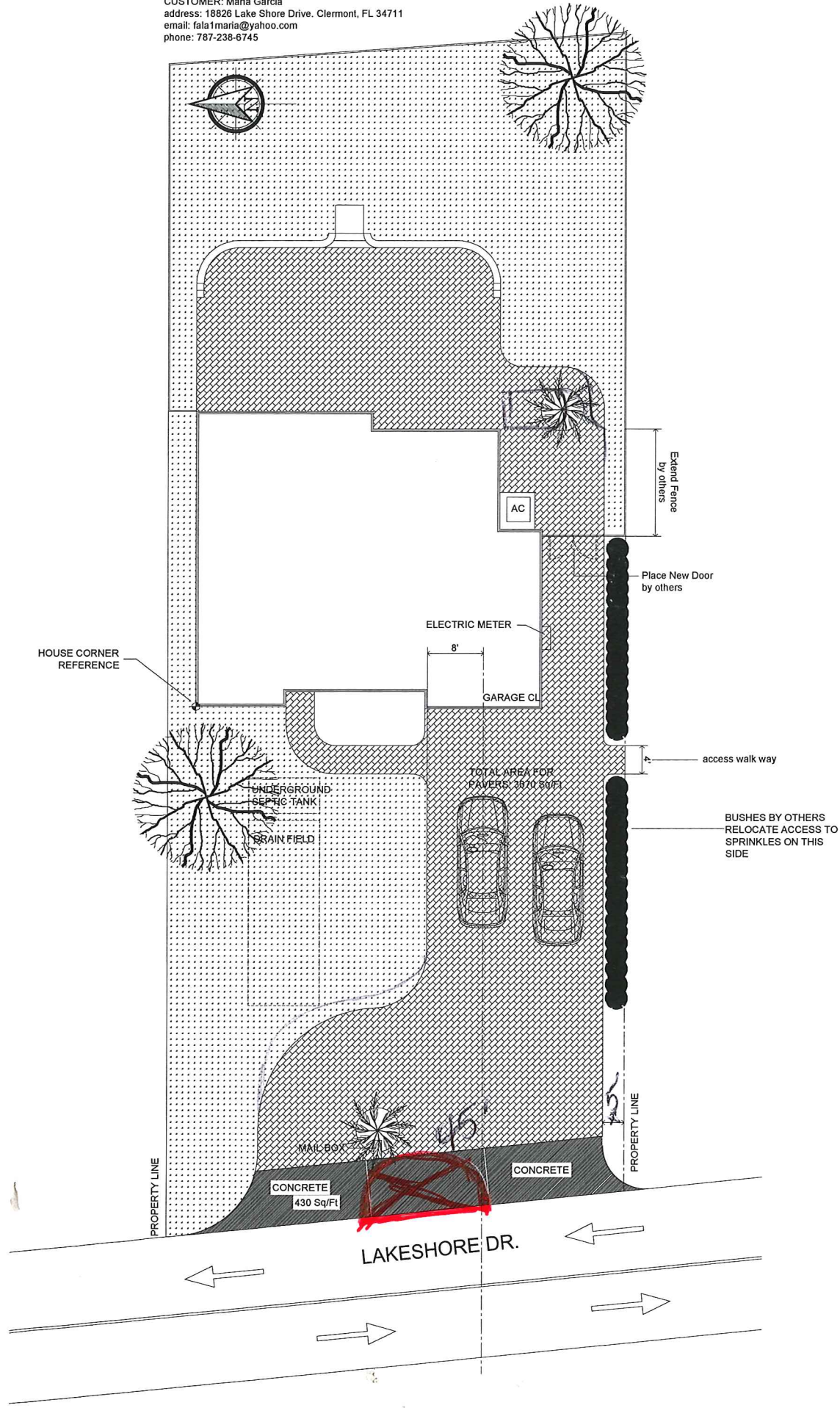



Account ID: bofasb
CyberSource Merchant ID: v9492713

- User: mbilbrey
- Support Center
- Log Out

Transaction Receipt

[Page help](#) [Page feedback](#)

The Virtual Terminal transaction succeeded.

Return Codes	
Result Code	SOK - Request was processed successfully.
Authorization Code	
AVS Code	
Request ID	3910059421040176056169
Payment Information	
Payment Type	Credit Card
Total Amount	50.50 USD
Currency	United States: Dollar
Transaction Source	MOTO - Mail/Phone Order
Transaction Type	Capture
Credit Card Type	Visa
Credit Card Number	#####1779
Customer Information	
Name	ANDREIA PIROUPO
Company	
Street Address 1	2586 ROBERT TRENT JONES DR
Street Address 2	
City, State Postal Code	ORLANDO, FL 32835
Country	United States
Phone Number	4074209055
Email Address	VBCGROUP@GMAIL.COM
Order Information	
Order or Merchant Reference Number	1391005928648
Comment	GARCIA
Merchant-Defined Data Field 1	RESIDENTIAL DRIVEWAY
Department	DRIVEWAY PERMIT
Merchant-Defined Data Field 3	5056260-341213

[New Transaction](#)

[Print Single Receipt Format](#)

[Print Double Receipt Format](#)

© CyberSource, 2014



DEPARTMENT OF PUBLIC WORKS
 ENGINEERING DIVISION
 437 ARDICE AVE.
 EUSTIS, FLORIDA 32726

A

RESIDENTIAL DRIVEWAY

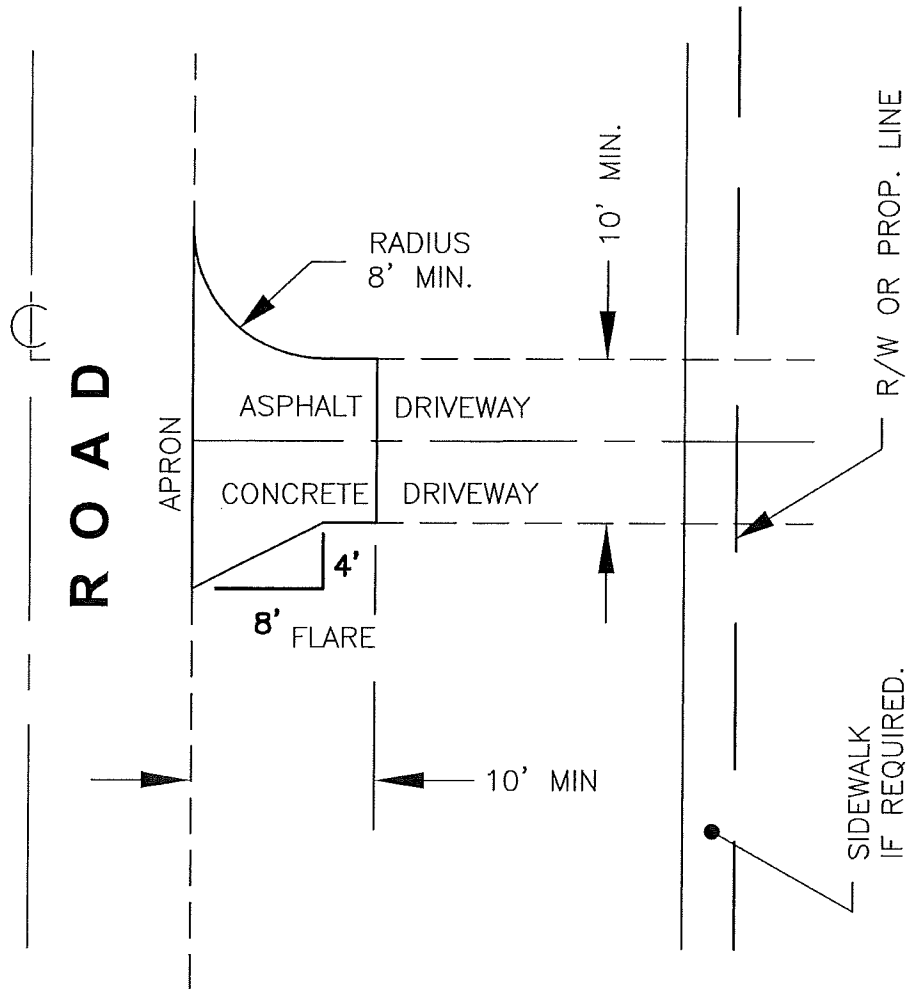

(SIDEWALK SHALL BE CONSTRUCTED TO MEET FDOT INDEX 310, ADA SPECIFICATIONS FOR PUBLIC RIGHT-OF-WAYS, AND LAKE COUNTY STANDARDS WITH A MAXIMUM CROSS SLOPE OF 1.5% AND A MAXIMUM RUNNING GRADE SLOPE OF 5%.)

1. 1" ASPHALT W/6" COMPACTED LIMEROCK BASE.

OR

2. 6" 3,000 PSI CONCRETE REINFORCED W/ 10-10x6"x6" MESH AND 6" COMPACTED SUBGRADE

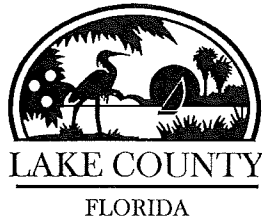

DEPARTMENT OF PUBLIC WORKS
ENGINEERING DIVISION
437 ARDICE AVE.
EUSTIS, FLORIDA 32726

E

RESIDENTIAL DRIVEWAY CONFORMING TO GRADE OR SWALE.

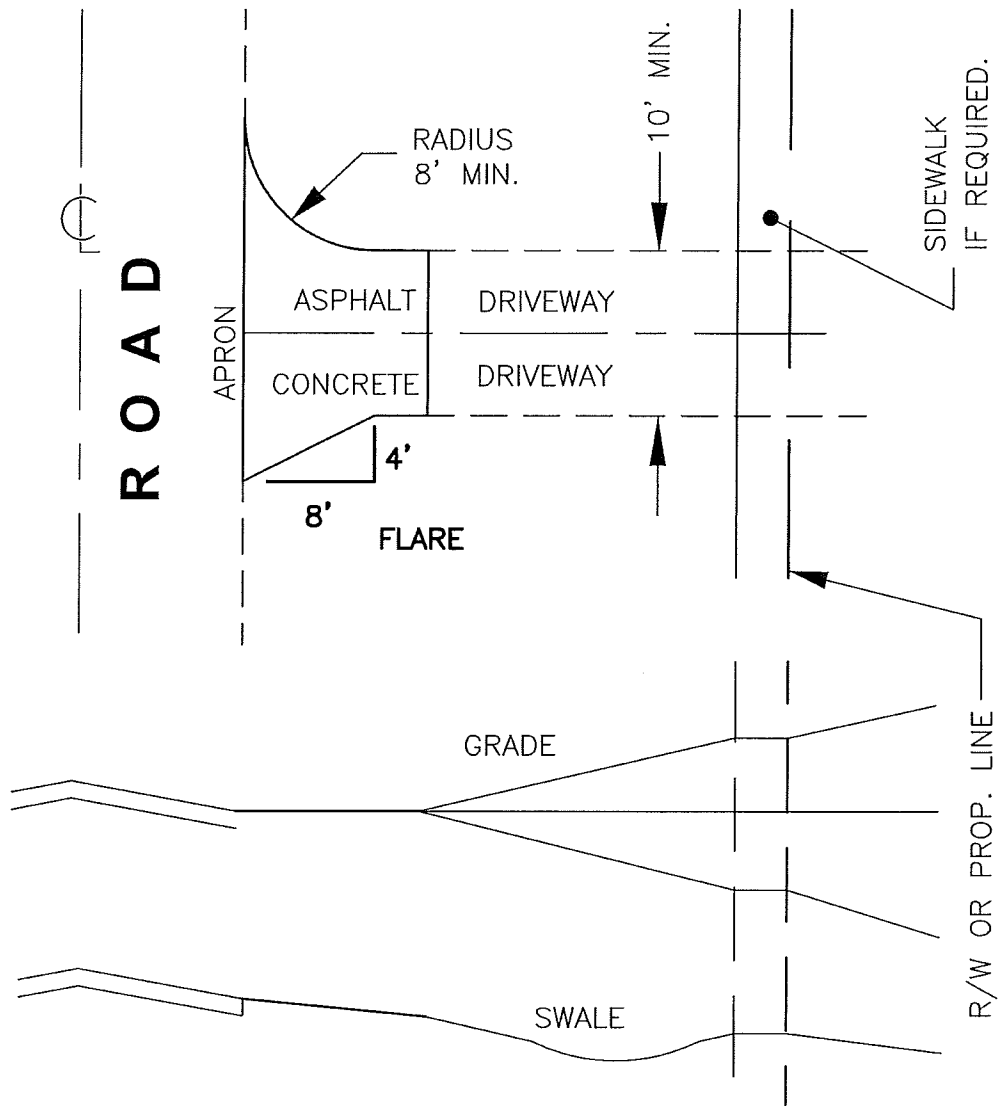

1. 1" ASPHALT W/6" COMPACTED LIMEROCK BASE.

OR

2. 6" 3,000 PSI CONCRETE REINFORCED W/ 10-10x6"x6" MESH AND 6" COMPACTED SUBGRADE

(SIDEWALK SHALL BE CONSTRUCTED TO MEET FDOT INDEX 310, ADA SPECIFICATIONS FOR PUBLIC RIGHT-OF-WAYS, AND LAKE COUNTY STANDARDS WITH A MAXIMUM CROSS SLOPE OF 1.5% AND A MAXIMUM RUNNING GRADE SLOPE OF 5%.)

Bilbrey, Michelle

From: Bilbrey, Michelle
Sent: Tuesday, February 11, 2014 8:52 AM
To: vbcgroup@gmail.com
Subject: ****updated**** Residential Driveway permit # 14166
Attachments: 14166-1.pdf

Andreia,

Please see the attached ***updated*** approved Residential Driveway permit for 12826 Lakeshore Drive with the applicable county standards. Please disregard the previous version of this permit that was returned to you, this one will replace it.

We have approved a circular driveway as indicated in the drawing. The area indicated in red on the site plan is the aprox area the must be removed and left open. Please feel free to contact us back with any questions you may have.

Thank you,

Michelle Bilbrey

Permitting Technician
Lake County Public Works
437 Ardice Avenue
Eustis, Florida 32726
Phone: 352-483-9020
Fax: 352-483-9025
MBilbrey@lakecountyfl.gov

Please note: Florida has a very broad public records law. Most written communication to or from government officials regarding government/public business is public record available to the public and media upon request. Your e-mail communications may be subject to public disclosure.