

Date: 7/20/2018

Sec: 2 Twp: 18 Rng: 25

Department of Public Works
323 N. Sinclair Ave.
Tavares, FL 32778-7800



Voice: (352) 253-9081
FAX: (352) 253-6016

FLOOD INSURANCE RATE MAP INFORMATION

Person Inquiring: JOHN & PATRICIA OSTEEN

Phone Number:

Fax Number:

Email:

Lake County Community No: 120421

Map No: 12069C Panel No: 0185E

Effective Date: 12/18/2012

LEGAL DESCRIPTION OF PROPERTY:

HIGLEY A PART OF BLK 30 DESCRIBED AS, BEG . . .

ALT KEY NUMBER 1071160

PARCEL I.D. NUMBER 02-18-25-010003000002

10932 EM EN EL GROVE RD., GROVELAND, FL 34788

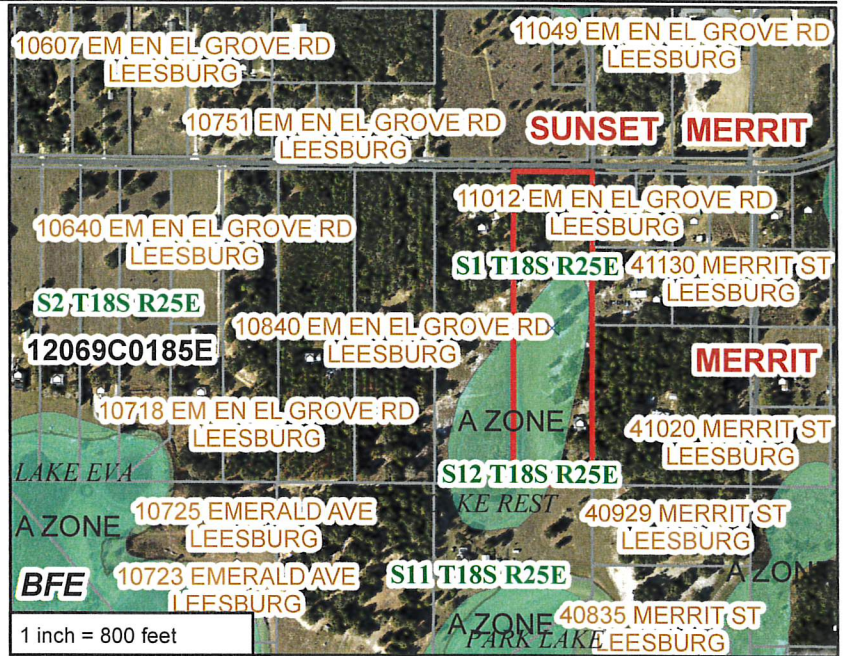

This Property is Located (X Partially, Fully) in the Special Flood Hazard Area (SFHA):

- ZONE "X" (Areas of minimal flooding: no shading)
ZONE "X Shaded" (Areas between limits of the 100-yr flood and the 500-yr flood; light shading)
X ZONE "A" (Areas of 100-yr flood; BFE not determined by FEMA)
ZONE "AE" (Areas of 100-yr flood; BFE determined by FEMA)
Please note: Lake County Base Flood elevation Determinations of "A" Zones may be used for development activities not requiring commercial / subdivision site plan approval and which are less than five (5) acres or fifty (50) lots. Reference Lake County Land Development Code Chapter IX & XIV and Title 44 CFR Sec. 60.3.
BASE FLOOD ELEVATION (BFE): 69 FT. NAVD 1988 , DERIVED FROM:
X Flood Insurance Rate Map (FIRM) identified above (Panel Number)
X Base Flood Elevation (BFE) is undetermined by FEMA
Exact location of property cannot be determined on the FIRM
Aerial Topographic Map
Flood Study
X USGS Survey (quad) Map EMERALDA ISLAND, FLORIDA

NOTES:

*** Some land may have the presence of Wetlands even if no floodplain is located there. Please refer to those agencies that handle wetlands issues such as FL. D.E.P., S.J.R.W.M.D. and S.W.F.W.M.D for more information ***

Federal law requires that a Flood Insurance Policy be obtained as a condition of a Federally backed mortgage or loan that is secured by the building located in a flood zone. For more information on flood insurance visit your public library system or ask your insurance agent. NOTE: This information is based on the Flood Insurance Rate Map (FIRM) for Lake County. This Document does not imply that the referenced property will or will not be free from flooding or damage. A property not located in a Special Flood Hazard Area may be damaged by a flood greater than that predicted on the FIRM or from a local drainage problem not shown on the map. This document does not create liability on the part of Lake County, nor any officer or employee thereof, for any damage that results from reliance on this determination.

X Insurance Information Distributed

Handwritten signature of County Official

County Official

Official Receipt - Lake County Board of County Commissioners

CDPR1103 - Official Receipt

Trans Number	Date	Post Date	Payment Slip Nbr
542189	07/20/2018 11:24:32 AM	07/20/2018	AD 34922

Address: 10932 EM-EN-EL GROVE RD
Primary Owner: O'STEEN JOHN & PATRICIA

PO BOX 855
KEY LARGO, FL 33037

Payor: JOLEEN COOPER HOW

Fee Information

Fee Code	Description	GL Account	Amount	Waived
PWFD	PE FLOOD DETERMINATION	5055600 344902	\$15.00	
CCARDPW	CREDIT CARD PUBLIC WORKS	5055600 369908	\$0.30	
PWLMA	LETTER OF MAP AMENDMENT	5055600 344902	\$15.00	
Total			\$30.30	

Payments

Payment Code	Account/Check Number	Amount
CC	7383	\$30.30
Total Cash		\$0.00
Total Non-Cash		\$30.30
Total Paid		\$30.30

Memo:

Cashier/location: PWK14 / 8

User: PWK14

LAKE COUNTY PUBLIC WOR
315 WEST MAIN STREET
TAVARES, FL 32778

07/20/2018

11:17:16

CREDIT CARD

VISA SALE

Card # XXXXXXXXXXXX7383
SEQ #: 1
Batch #: 61
INVOICE 1
Approval Code: 01492B
Entry Method: Manual
Mode: Online
Avs Code: YYY

SALE AMOUNT \$30.30

CUSTOMER COPY

Hogan, Sharon

From: no-reply@riskmapcds.com
Sent: Friday, July 20, 2018 12:26 PM
To: Hogan, Sharon
Subject: Amendment Project is Created with Project Number = 18-04-6169A

We have received your request that the Department of Homeland Security's Federal Emergency Management Agency (FEMA) determine if the requested property is located within an identified Special Flood Hazard Area on the applicable National Flood Insurance Program (NFIP) map for: LAKE COUNTY *, Lake County, FL.

The Case Number assigned to your request is 18-04-6169A, and the Project ID is BLOCK Part Blk 30, Higley - 10932 Em En El Grove Road.

Your Online LOMC Application ID was 2625947509613.

We are reviewing your submitted data and will contact you if additional information is required to process your request.

If additional information is not required, we will issue a final determination letter within 30-60 days.

You may obtain project status information from MIP via the Online LOMC homepage. To return to your application, click on the following link or copy and paste the link into the address bar of your browser:

<https://na01.safelinks.protection.outlook.com/?url=https%3A%2F%2Fhazards.fema.gov%2Ffemportal%2Fonlinelomc&data=02%7C01%7Cshogan%40lakecountyfl.gov%7Ce89f6f41dbc14384f3eb08d5ee5d6f99%7C8499232ea71a45edaeca64041089512e%7C0%7C0%7C636677007439934100&data=9VWNGUrT5qz1CyKGzj3bELx3smSmtMOc8leYhaFGw38%3D&reserved=0>

Inquiries concerning the status of your request should be made by calling the FEMA Map Information eXchange (FMIX) toll free at (877) 336-2627 (877-FEMA-MAP) or by letter addressed to the Federal Emergency Management Agency, LOMC Clearinghouse, 3601 Eisenhower Ave Ste 500, Alexandria, VA 22304-6426, Attn: LOMA Manager.

Please be assured we will do our best to respond to all inquiries in a timely manner.

This message has been generated automatically. Please do not reply to this message.