

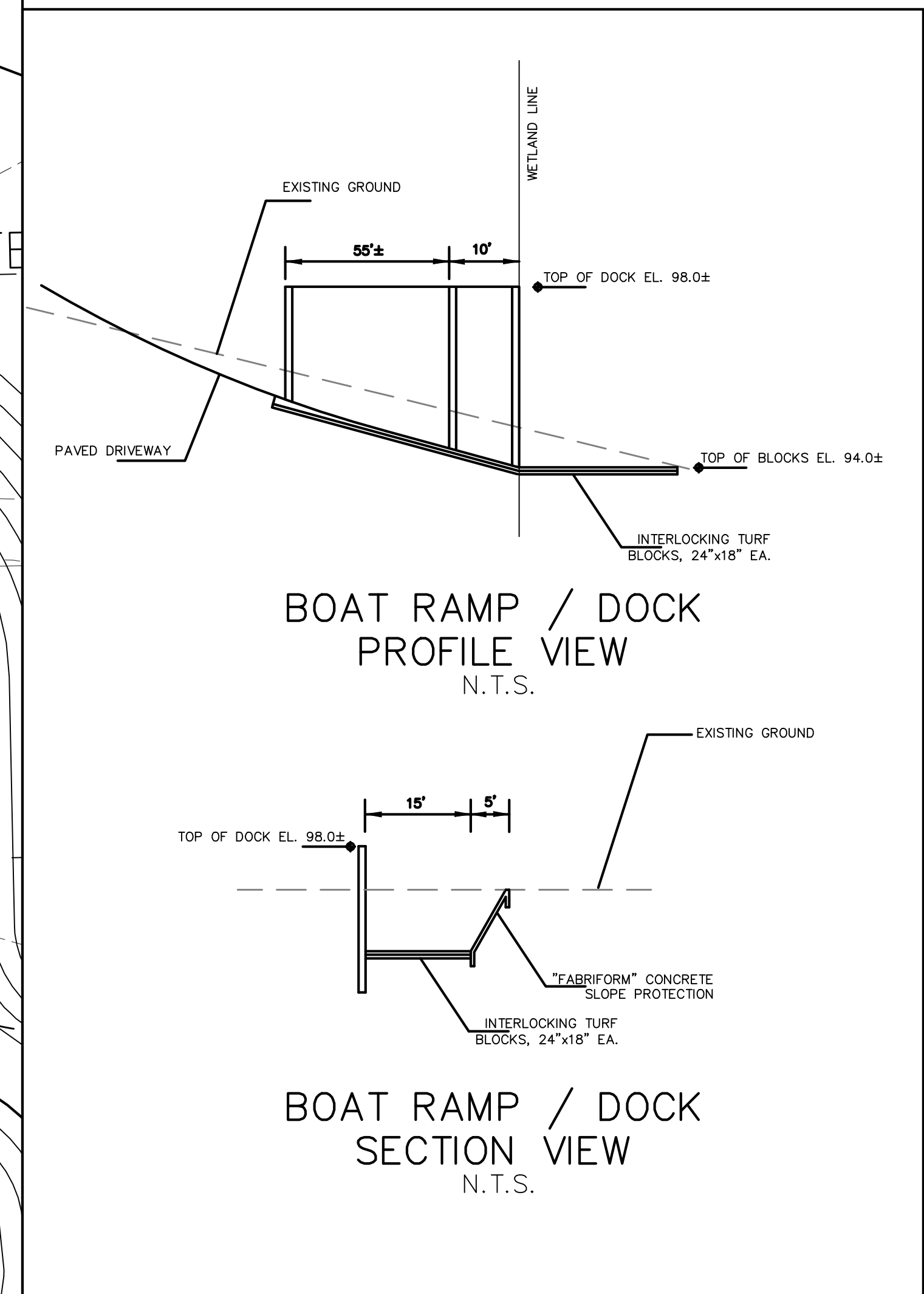

SCALE: 1"=20'

- NOTES:
DOCK TO BE INTERLOCKING TURF BLOCKS
- LAKE ACCESS PAVEMENT TO BE AS FOLLOWS:
- 1 1/2" TYPE SP 9.5 ASPHALT
 - 6" LIMEROCK BASE (LBR 100) COMPACTED TO 98% MAX. DENSITY, PRIMED W/AEP
 - 12" TYPE B STAB. (LBR 40) COMPACTED TO 98% MAX. DENSITY

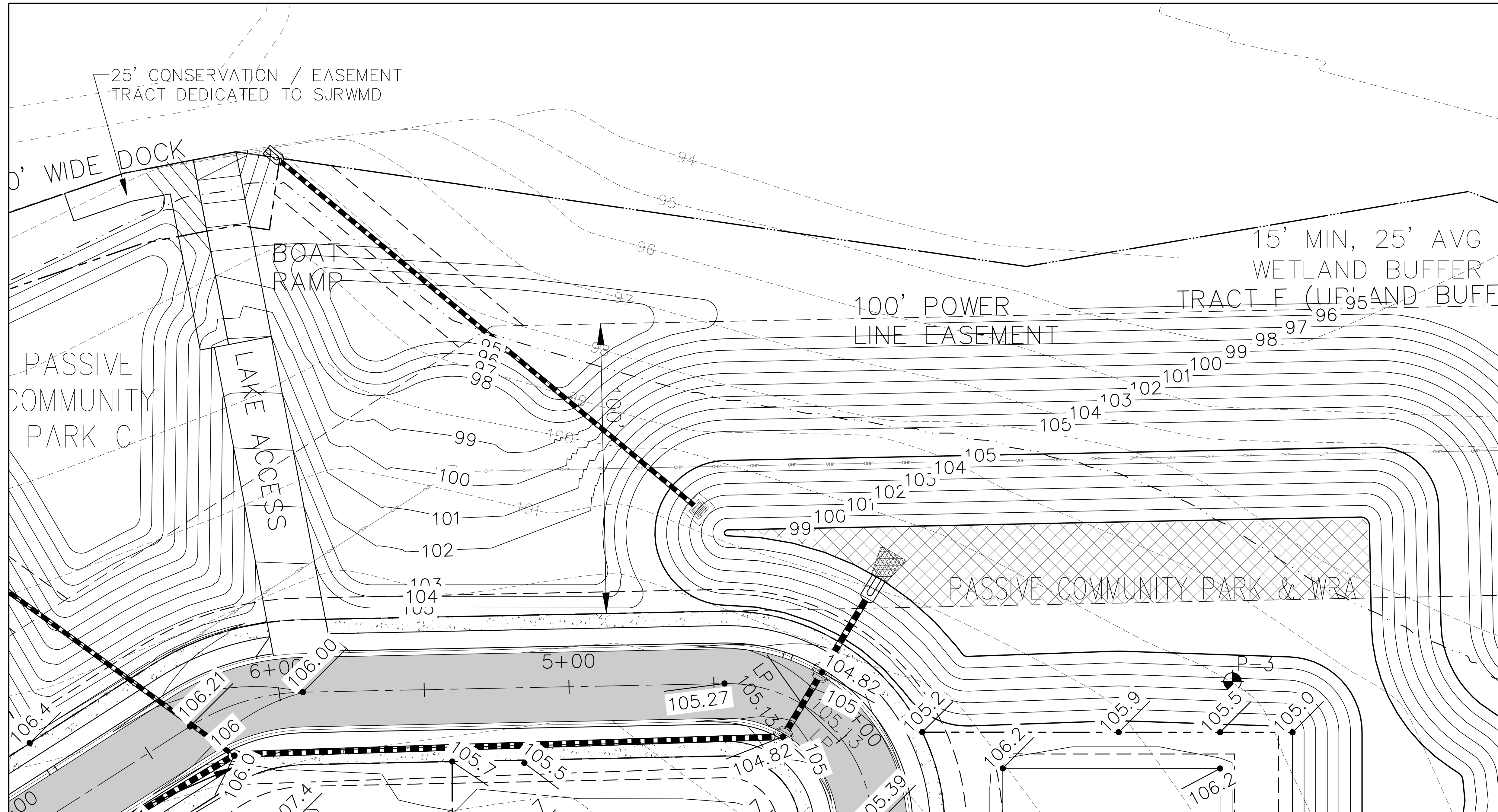

Boat Ramp Details

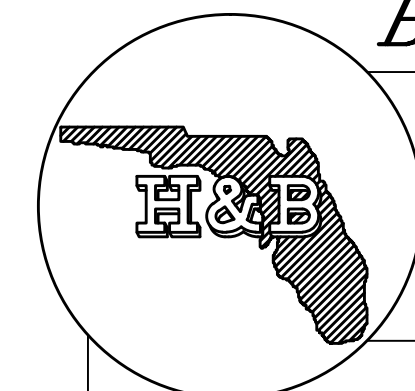

H & B CONSULTING ENGINEERS, INC.
Certificate of Authorization # 4829
P.O. Box 520
218 N. Florida Street - Suite 3
Bushnell, Florida 33513
Phone : (352) 793-2113

**Lake Minneola Landings
C.R. 561
Groveland, Fl. 34711**

REVISIONS	

Drawn: WSR	Checked: MZB
Date: 06/16	Scale: as shown

D:\Documents\Projects\Wetlands & B. John Lake Minneola Landings\Minneola Landings\Total.dwg, sat 13 Boat Ramp Details, 7/9/2017 11:20 PM, Bldg. DWG TO PDF.pc3, AECI Full Speed D (38.00 x 24.00 Inches), 1:1