

THE ENGINEER EXPRESSLY RESERVES THE EXCLUSIVE COPYRIGHT AND PROPRIETARY RIGHTS TO THESE DRAWINGS WHICH MAY NOT BE REPRODUCED, COPIED OR TRANSMITTED IN ANY FORM OR BY ANY MEANS, WITHOUT THE WRITTEN CONSENT OF THE ENGINEER.

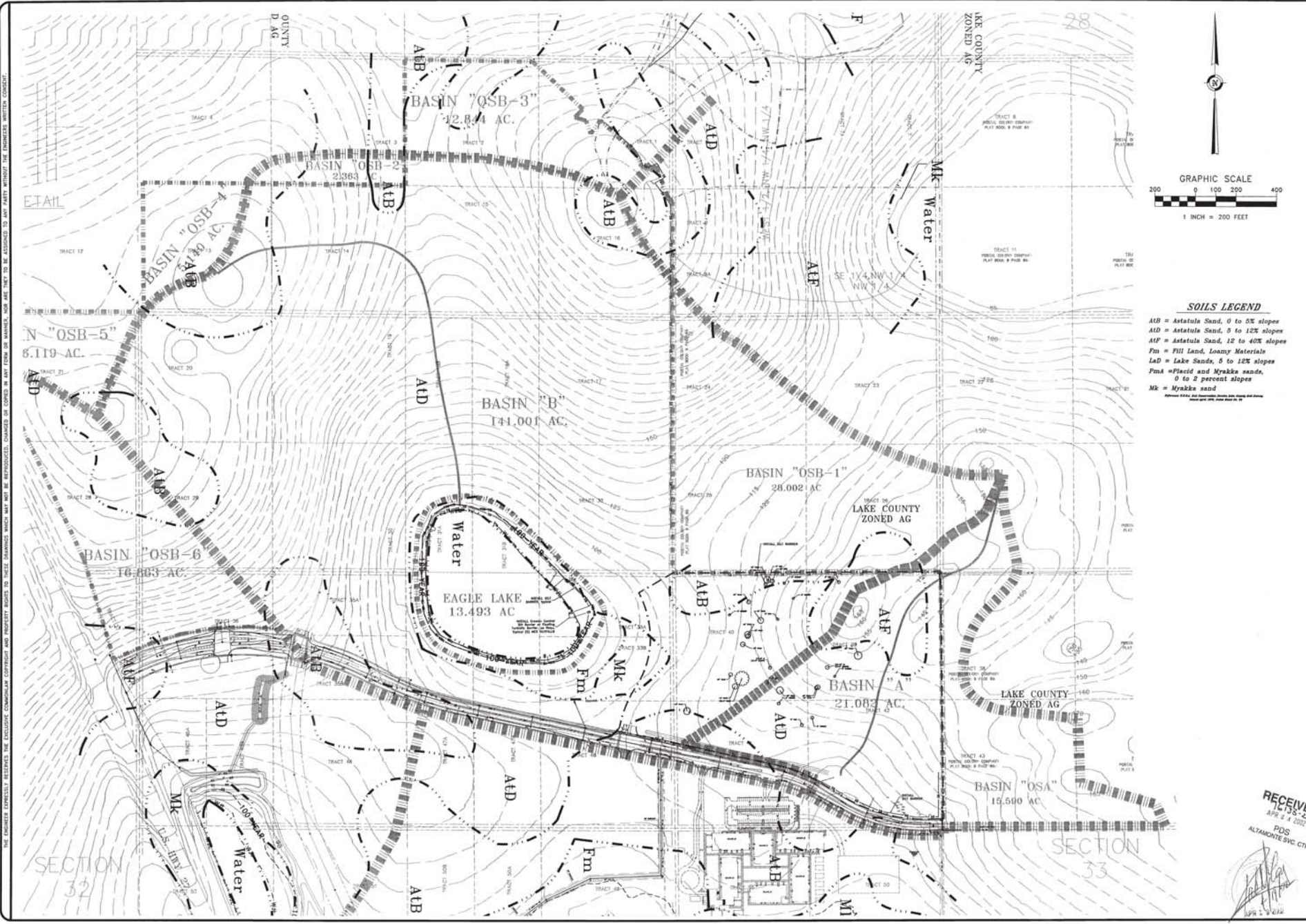

<p>RECEIVED APR 24 2001 PDS ALTAIRONE SVC. CTR.</p>	
<p>JOB NO. 01-005 DATE SEPT. 2001 DES. BY: [Signature] CHK'D BY: [Signature] APP'D BY: [Signature] SHEET 5 OF 27</p>	<p>PRE-DEVELOPMENT PLAN Lost Lake Reserve Sec. 32 & 33, Twp. 28S, Rng. 28E; City of Clermont, Lake County, FL. Marty P. DeYoung, Inc., Inc. 5901 N. Bayco Blvd., Suite 808, Tampa, FL 33618</p>
<p>McCOY & ASSOCIATES ENGINEERS & LAND PLANNERS 14000 W. University Blvd., Suite 200, Tampa, FL 33613 (813) 984-9750 FAX (813) 984-9758 CA# 6974</p>	<p>DONALD MCINTOSH ASSOCIATES, INC. 2500 PARK AVENUE NORTH WINTER PARK, FL 32789 (407) 644-4088</p>
<p>DESCRIPTION</p>	<p>DATE</p>

DATE PLOTTED: 09/11/01 10:00 AM

THE ENGINEER EXPRESSLY DISCLAIMS THE EXCLUSIVE CONTRACTUAL COVENANT AND PROPERTY RIGHTS TO THESE DRAWINGS, WHICH MAY NOT BE REPRODUCED, COPIED OR ANY FORM OF MANNER, NOW OR LATER, BE ASSIGNED TO ANY PARTY WITHOUT THE ENGINEER'S WRITTEN CONSENT.

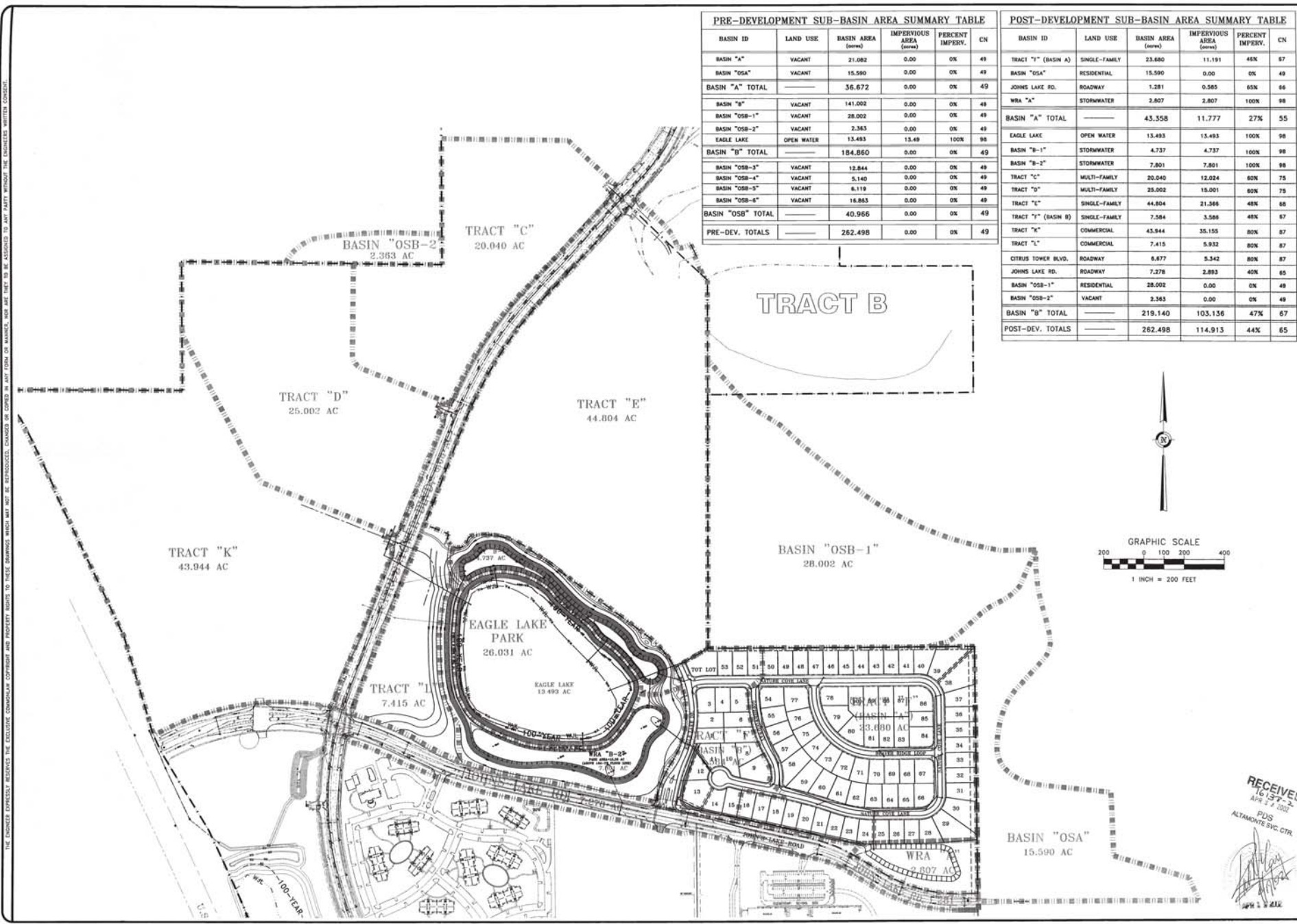

PRE-DEVELOPMENT SUB-BASIN AREA SUMMARY TABLE					
BASIN ID	LAND USE	BASIN AREA (acres)	IMPERVIOUS AREA (acres)	PERCENT IMPERV.	CN
BASIN "A"	VACANT	21.082	0.00	0%	49
BASIN "OSA"	VACANT	15.590	0.00	0%	49
BASIN "A" TOTAL		36.672	0.00	0%	49
BASIN "B"	VACANT	141.002	0.00	0%	49
BASIN "OSB-1"	VACANT	28.002	0.00	0%	49
BASIN "OSB-2"	VACANT	2.363	0.00	0%	49
EAGLE LAKE	OPEN WATER	13.493	13.49	100%	98
BASIN "B" TOTAL		184.860	0.00	0%	49
BASIN "OSB-3"	VACANT	12.844	0.00	0%	49
BASIN "OSB-4"	VACANT	5.140	0.00	0%	49
BASIN "OSB-5"	VACANT	6.118	0.00	0%	49
BASIN "OSB-6"	VACANT	16.853	0.00	0%	49
BASIN "OSB" TOTAL		40.966	0.00	0%	49
PRE-DEV. TOTALS		262.498	0.00	0%	49

POST-DEVELOPMENT SUB-BASIN AREA SUMMARY TABLE					
BASIN ID	LAND USE	BASIN AREA (acres)	IMPERVIOUS AREA (acres)	PERCENT IMPERV.	CN
TRACT "I" (BASIN A)	SINGLE-FAMILY	23.680	11.191	48%	67
BASIN "OSA"	RESIDENTIAL	15.590	0.00	0%	49
JOHNS LAKE RD.	ROADWAY	1.281	0.585	65%	66
WRA "A"	STORMWATER	2.807	2.807	100%	98
BASIN "A" TOTAL		43.358	11.777	27%	55
EAGLE LAKE	OPEN WATER	13.493	13.493	100%	98
BASIN "B-1"	STORMWATER	4.737	4.737	100%	98
BASIN "B-2"	STORMWATER	7.801	7.801	100%	98
TRACT "C"	MULTI-FAMILY	20.040	12.024	60%	75
TRACT "D"	MULTI-FAMILY	25.002	15.001	60%	75
TRACT "E"	SINGLE-FAMILY	44.804	21.586	48%	66
TRACT "I" (BASIN B)	SINGLE-FAMILY	7.584	3.586	48%	67
TRACT "K"	COMMERCIAL	43.944	35.155	80%	67
TRACT "L"	COMMERCIAL	7.415	5.932	80%	67
CITRUS TOWER BLVD.	ROADWAY	6.677	5.342	80%	67
JOHNS LAKE RD.	ROADWAY	7.278	2.892	40%	65
BASIN "OSB-1"	RESIDENTIAL	28.002	0.00	0%	49
BASIN "OSB-2"	VACANT	2.363	0.00	0%	49
BASIN "B" TOTAL		219.140	103.136	47%	67
POST-DEV. TOTALS		262.498	114.913	44%	65

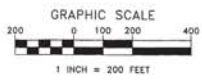

REVISIONS

NO. DATE

DONALD MCINTOSH ASSOCIATES, INC.
2500 PARK AVENUE NORTH
WINTER PARK, FL 32789
(407) 644-4088

Mc MCOY & ASSOCIATES
ENGINEERS & LAND PLANNERS
70 WEST MONTGOMERY ST., CLERMONT, FLORIDA 34711
TEL: (888) 364-9796 FAX: (888) 364-9796
CA# 674

POST-DEV. DRAINAGE BASIN PLAN

Job No. 01-005
 Date SEPT. 2001
 DES BY: XSR
 DWN BY: XSR
 CHK'D BY: SMJ
 APP'D BY: XSR

Lost Lake Reserve
City of Clermont, Lake County, FL
Sec. 3C & 3D, Twp. 28S, Rge. 18W, S. 31E, Sec. 30, 31, 32, 33
Mazy Development Group, Inc.
2901 W. Bunch Blvd., Suite 906, Tampa, FL 33618

RECEIVED
 10/17/02
 APR 2 2 2002
 PDS
 ALTAIR SIV. CTR.

SHEET
 6 of 27