

CONSTRUCTION PLANS FOR ABERDEEN PHASE III AT KINGS RIDGE

A PLANNED UNIT DEVELOPMENT

Section 4, Township 23 S., Range 26 E.
Lake County, Florida

Owner/Developer:

LENNAR ACTIVE ADULT COMMUNITIES
1110 Douglas Avenue
Altamonte Springs, FL 32714
(407) 682-9291

Engineer/Planner:

FARNER, BARLEY & ASSOC., INC.
350 North Sinclair Avenue
Tavares, FL 32778
(352) 343-8481
DUANE K. BOOTH, P.E.

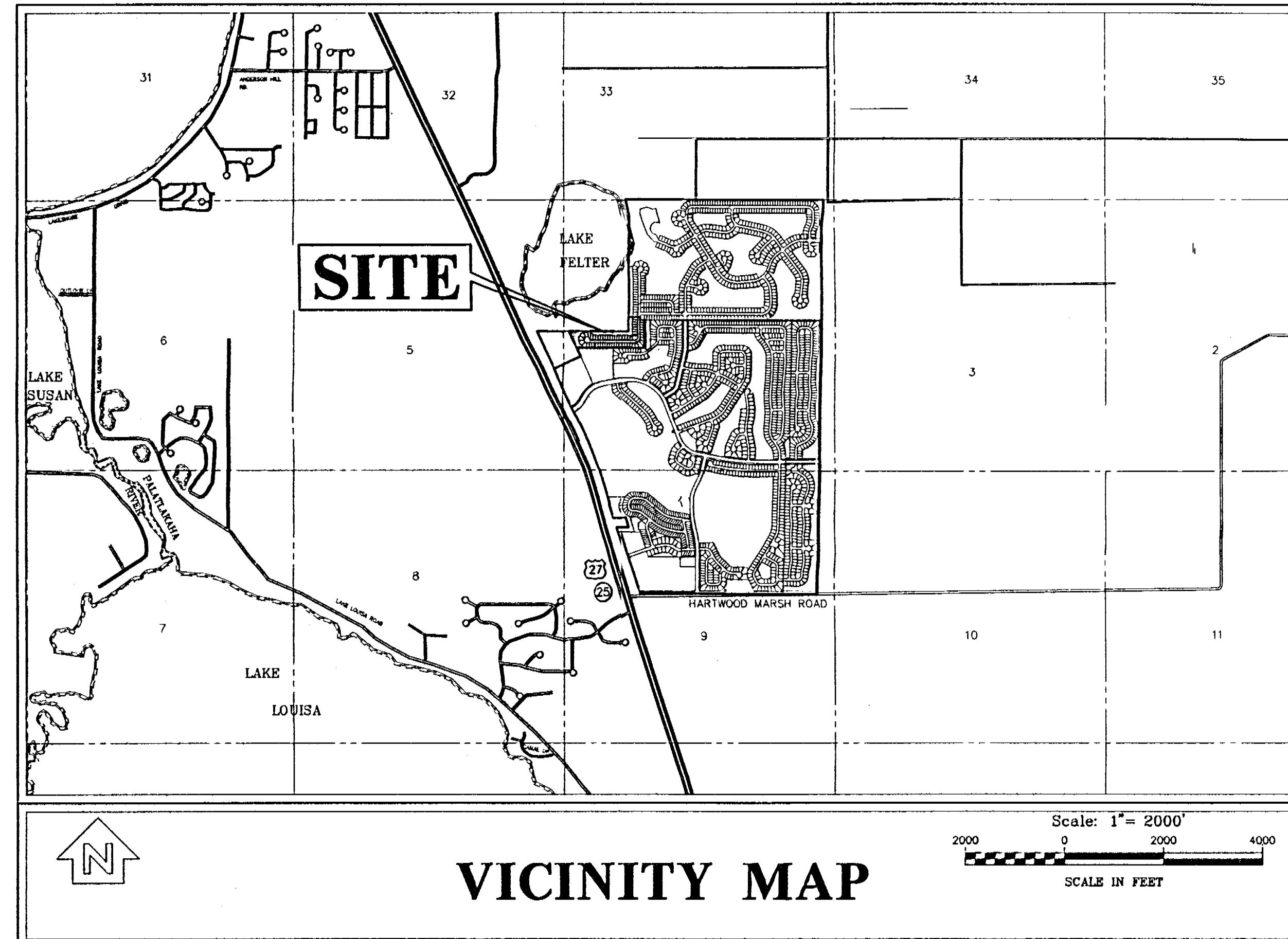

**ABERDEEN PHASE III
DESCRIPTION**

THAT PORTION OF SECTION 4, TOWNSHIP 23 SOUTH, RANGE 26 EAST, LAKE COUNTY, FLORIDA, DESCRIBED AS FOLLOWS:

BEGIN AT THE SOUTHWEST CORNER OF 'ABERDEEN AT KINGS RIDGE PHASE I', AS RECORDED IN PLAT BOOK 44, PAGES 69 AND 70 OF THE PUBLIC RECORDS OF LAKE COUNTY, FLORIDA; THENCE ALONG THE SOUTHERLY BOUNDARY THEREOF THE FOLLOWING THREE (3) COURSES: RUN SOUTH 89°18'07" EAST FOR 230.00 FEET; THENCE SOUTH 00°41'53" WEST FOR 54.09 FEET; THENCE SOUTH 89°18'07" EAST FOR 100.00 FEET TO THE WESTERLY BOUNDARY OF 'DEVONSHIRE AT KINGS RIDGE', AS RECORDED IN PLAT BOOK 37, PAGES 29 THROUGH 31 OF THE PUBLIC RECORDS OF LAKE COUNTY, FLORIDA; THENCE SOUTH 00°41'53" WEST ALONG SAID WESTERLY BOUNDARY FOR 565.99 FEET THE NORTHERLY BOUNDARY OF 'DEVONSHIRE AT KINGS RIDGE PHASE II', AS RECORDED IN PLAT BOOK 46, PAGES 39 AND 40 OF THE PUBLIC RECORDS OF LAKE COUNTY, FLORIDA; THENCE NORTH 89°49'14" WEST ALONG SAID NORTHERLY BOUNDARY AND THE EXTENSION THEREOF FOR 1,352.77 FEET; THENCE NORTH 24°33'22" WEST FOR 363.34 FEET TO THE NORTH LINE OF THE SOUTHWEST 1/4 OF AFORESAID SECTION 4; THENCE SOUTH 89°49'14" EAST ALONG SAID NORTH LINE FOR 1,177.78 FEET TO THE WEST LINE OF THE SOUTHEAST 1/4 OF THE NORTHWEST 1/4 OF SAID SECTION 4; THENCE NORTH 00°41'53" EAST ALONG SAID WEST LINE FOR 293.05 FEET TO THE POINT OF BEGINNING.

CONTAINING 12.92 ACRES, MORE OR LESS.

Index of Sheets

- | | |
|-------------------------|------------------------------------|
| 1. COVER SHEET | 8. PLAN AND PROFILE |
| 2. PRELIMINARY PLAT | 9. PAVING & DRAINAGE DETAILS |
| 3. DEMOLITION PLAN | 10. SANITARY SEWER DETAILS |
| 4. MASTER DRAINAGE PLAN | 11. WATER DISTRIBUTION DETAILS |
| 5. MASTER UTILITY PLAN | 12. CITY OF CLERMONT GENERAL NOTES |
| 6. AERIAL PHOTOGRAPH | 13. MASTER GRADING PLAN |
| 7. PLAN AND PROFILE | 14. MASTER REUSE PLAN |

19411-16

RECEIVED
MAR 0 8 2003
PDS
ALTAMONTE SVC. CTR.

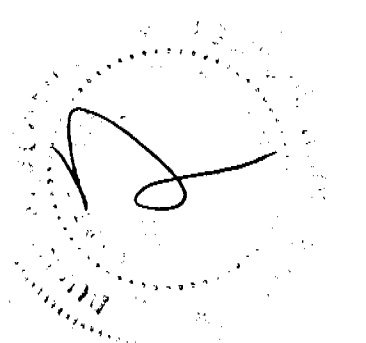

FEB 28 2003