

APPLICATION

1719

Fee Receipt

ST. JOHNS RIVER WATER MANAGEMENT DISTRICT
P. O. Box 1429
Palatka, FL 32178-1429

Date: Feb. 23, 2001
By: Christine H Davies

RECEIPT #: 11906
RECEIVED FROM: LENNAR LAND PARTNERS
THE SUM OF: \$1,000.00
FOR: Application Fee

FEE DETAIL INFORMATION

F/A Receipt O-021441 \$1,000.00

*Lewis
Prynski*

11906

DATE 2/23/2001 021441

RECEIVED OF LENNAR LAND PROPERTIES
ADDRESS KINGS RIDGE NORTH PH # 4
4-069-19411-11 DOLLARS \$1,000.00

ACCT. NO. 109080

CASH CHECK
 MONEY ORDER DRAFT

ST. JOHNS RIVER WATER MANAGEMENT DISTRICT
P.O. Box 1429
Palatka, Florida 32178-1429

by Christine Davies
Thank You

FOR _____
803

DO NOT ACCEPT THIS CHECK UNLESS YOU CAN SEE A DUAL-TONE TRUE WATERMARK THAT APPEARS AS A CHAIN LINK PATTERN WHEN HELD TO THE LIGHT. Ⓐ

Lennar Land Partners
700 N.W. 107th Ave.
Miami, FL 33172

0-021441
11906

00109080

BANK ONE -0710
Chicago, Illinois
Payable through FCC Ntrl. Bank
Wilmington, Delaware

62-28
311

DATE	AMOUNT
12/12/00	*****1,000.00

ONE THOUSAND AND 00/100 *****

Dollars



ST JOHN'S RIVER WATER MGMT DISTRICT

TO
THE
ORDER
OF

Two Signatures Required on Amounts Over \$50,000.00

THE FACE OF THIS CHECK HAS A BLUE AND GREEN BACKGROUND - ANY OTHER COLORS MAY BE EVIDENCE OF CHEMICAL ALTERATION OR ERASURE - SEE REVERSE SIDE FOR MORE SAFETY FEATURES. Ⓐ

⑈00109080⑈



Scale: 1"=2000'
1000' 0' 1000'

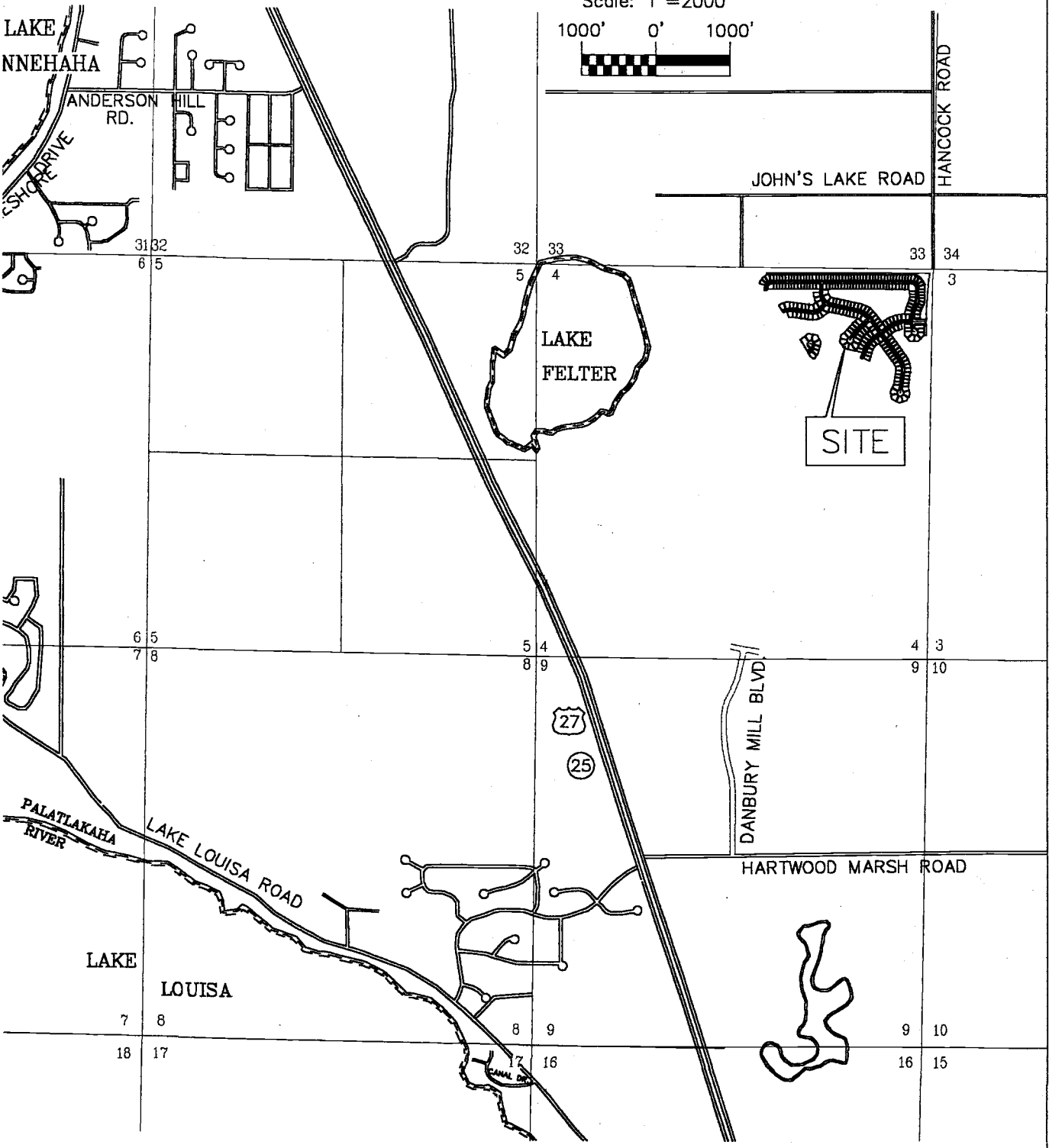

**FARNER
BARLEY**
AND ASSOCIATES, INC.
30 North Shulze Avenue O Tequesta, Florida 33778 O (305) 343-9481

- ▲ ENGINEERS
- ▲ SURVEYORS
- ▲ PLANNERS

HIGHGATE AND SUSSEX
AT KINGS RIDGE
LOCATION MAP



DATE: DEC 26, 2000

JOB NO. 941216.113

FOR AGENCY USE ONLY

ACOE Application # _____ SJR Application # H-069-19411-11
 Date Application Received _____ Date Application Received 2-23-01
 Proposed Project Lat. _____ Fee Received \$ 1000
 Proposed Project Long. _____ Fee Receipt # 0-081441/11906
 Date Received _____ Project Use Codes _____
 Assigned Reviewers LEWIS Reviewer#s _____
RYNOSKI

SECTION A

Are any of the activities described in this application proposed to occur in, on, or over wetlands or other surface waters? yes X no

A. Type of Environmental Resource Permit Requested (check at least one)

- Noticed General - include information requested in Section B.
- Standard General (Single Family Dwelling) - include information requested in Sections C and D.
- Standard General (all other projects) - include information requested in Sections C and E.
- Individual (Single Family Dwelling) - include information requested in Sections C and D.
- Individual (all other projects) - include information requested in Sections C and E.
- Conceptual - include information requested in Sections C and E.
- Mitigation Bank Permit (construction) - include information requested in Sections C and F.
(If the proposed mitigation bank involves the construction of a surface water management system requiring another permit defined above, check the appropriate box and submit the information requested by the applicable section.)
- Mitigation Bank (conceptual) - include information requested in Sections C and F.
- Standard General Stormwater - include information requested in Sections C and H
- Individual Stormwater - include information requested in Sections C and H

B. Type of activity for which you are applying (check at least one)

- (onstruction and operation of a new system including dredging or filling in, on or over wetlands and other surface waters.)
- Alteration and operation of an existing system which was not previously permitted by a WMD or DEP.
- Modification of a system previously permitted by a WMD or DEP. Provide previous permit numbers:
4-069-0326AM9-ERP
- Alteration and operation of a system
- Abandonment of a system
- Removal of a system
- Extension of permit duration
- Construction and operation of additional phases of a system

C. Are you requesting authorization to use State Owned Submerged Lands? yes X no
(If yes, include the information requested in Section G.)

D. For activities in, on or over wetlands or other surface waters, check type of federal dredge and fill permit requested:

- Individual
- General
- Programmatic General
- Nationwide

E. Are you claiming to qualify for an exemption? yes X no

If yes provide rule number if known _____

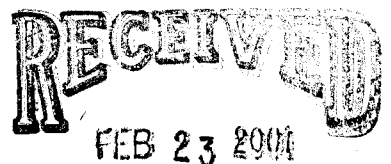

OWNER(S) OF LAND	ENTITY TO RECEIVE PERMIT (IF OTHER THAN OWNER)
NAME ROBERT AHRENS	NAME Same
ADDRESS 1100 DOUGLAS AVENUE, SUITE 2040	ADDRESS
CITY, STATE, ZIP ALTAMONTE SPRINGS, FL 32714	CITY, STATE, ZIP
COMPANY AND TITLE LENNAR LAND PARTNERS, A FLORIDA GENERAL PARTNERSHIP	COMPANY AND TITLE
TELEPHONE (407) 682-9291 FAX (407) 682-1977	TELEPHONE () FAX ()
AGENT AUTHORIZED TO SECURE PERMIT (IF AN AGENT IS USED)	CONSULTANT (IF DIFFERENT FROM AGENT)
NAME	NAME Duane K. Booth, P.E.
COMPANY AND TITLE	COMPANY AND TITLE Farner, Barley & Associates, Inc.
ADDRESS	ADDRESS 350 North Sinclair Avenue
CITY, STATE, ZIP	CITY, STATE, ZIP Tavares, Florida 32778
TELEPHONE () FAX ()	TELEPHONE (352) 343-8481 FAX (352) 343-8495
<p>Name of project, including phase if applicable: <u>KINGS RIDGE NORTH PHASE III</u></p> <p>Is this application for part of a multi-phase project? <input checked="" type="checkbox"/> yes <input type="checkbox"/> no</p> <p>Total applicant-owned area contiguous to the project <u>968.44</u> ac</p> <p>Total project area for which a permit is sought <u>52.91</u> ac</p> <p>Impervious area for which a permit is sought <u>24.97</u> ac</p> <p>What is the total area (metric equivalent for federally funded projects) of work in, on or over wetlands or other surface waters: <u>N/A</u> acres <u> </u> square feet <u> </u> hectares <u> </u> square meters</p> <p>If a docking facility, the number of proposed new slips <u>N/A</u>.</p> <p>Project location (use additional sheets, if needed)</p> <p>County(ies) <u>Lake</u></p> <p>Section(s) <u>4</u> Township(s) <u>23S</u> Range(s) <u>26E</u></p> <p>Section(s) <u> </u> Township(s) <u> </u> Range(s) <u> </u></p> <p>Land Grant name, if applicable <u>N/A</u></p> <p>Tax Parcel Identification Number <u>N/A</u></p> <p>Street address, road, or other location <u>KINGS RIDGE BOULEVARD</u></p> <p>City, Zip Code if applicable <u>CLERMONT, FLORIDA</u></p>	

Describe, in general terms, the proposed project, system or activity.

Construct a stormwater management system to serve a single family development.

If there have been any pre-application meetings, including at the project site, with regulatory staff, please list the date(s), location(s), and names of key staff and project representatives.

N/A

Please identify by number any MSSW/Wetland Resource/ERP/ACOE permits pending, issued or denied for projects at the location and any related enforcement actions.

Agency	Date	No. \ Type of Application	Action Taken (Pending/Issued/Denied)
<u>SJRWMD</u>	_____	<u>ERP INDIVIDUAL</u>	<u>ISSUED</u>
_____	_____	<u>4-069-0326AM9-ERP</u>	_____
_____	_____	_____	_____

Note: The following information is required for projects proposed to occur in, on or over wetlands or other surface waters that need a federal dredge and fill permit and/or authorization to use state owned submerged lands. Please provide the names, addresses and zip codes of property owners whose property directly adjoins the project (excluding applicant). Please attach a plan view showing the owner's names and adjoining property lines. Attach additional sheets if necessary.

- | | |
|----------|----------|
| 1. _____ | 2. _____ |
| _____ | _____ |
| _____ | _____ |
| 3. _____ | 4. _____ |
| _____ | _____ |
| _____ | _____ |

By signing and submitting this application on, I am applying, or I am applying on behalf of the applicant, for the permit and any proprietary authorizations identified above, according to the supporting data and other incidental information filed with this application. I am familiar with the information contained in this application, and represent that such information is true complete and accurate. I understand this is an application and not a permit, and work prior to approval is a violation. I understand that this application and any permit issued or proprietary authorization issued pursuant thereto, does not relieve me of any obligation for obtaining any other required federal, state, water management district or local permit prior to commencement of construction. I agree, or I agree on behalf of my corporation, to operate and maintain the permitted system unless the permitting agency authorizes transfer of the permit to a responsible operation entity. I understand that knowingly making any false statement or representation in this application is a violation of Section 373.430, F.S., and 18 U.S.C. Section 1001.

ROBERT AHRENS

Typed/Printed Name of Applicant (If no Agent is used) or Agent (If one is so authorized below)

Signature of Applicant/Agent

Date

12-01-00

VICE-PRESIDENT

(Corporate Title if applicable)

AN AGENT MAY SIGN ABOVE ONLY IF, THE APPLICANT COMPLETES THE FOLLOWING:

I hereby designate and authorize the agent listed above to act on my behalf, or on behalf of my corporation, as the agent in the processing of this application for the permit and/or proprietary authorization indicated above; and to furnish, on request, supplemental information in support of the application. In addition, I designate and authorize the above-listed agent to bind me, or my corporation, to perform any requirement which may be necessary to procure the permit or authorization indicated above. I understand that knowingly making any false statement or representation in this application is a violation of Section 373.430, F.S., and 18 U.S.C. Section 1001.

Typed/Printed Name of Applicant

Signature of Applicant

Date

(Corporate Title if applicable)

Please note: The applicant's original signature (not a copy) is required above.

PERSON AUTHORIZING ACCESS TO THE PROPERTY MUST COMPLETE THE FOLLOWING:

I either own the property described in this application or I have legal authority to allow access to the property, and I consent, after receiving prior notification, to any site visit on the property by agents or personnel from the Department of Environmental Protection, the Water Management District and the U.S. Army Corps of Engineers necessary for the review and inspection of the proposed project specified in this application. I authorize these agents or personnel to enter the property as many times as may be necessary to make such review and inspection. Further, I agree to provide entry to the project site for such agents or personnel to monitor permitted work if a permit is granted.

ROBERT AHRENS

Typed/Printed Name

Signature

Date

VICE-PRESIDENT

(Corporate Title if applicable)

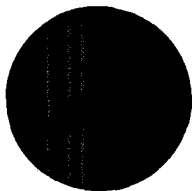

FARNER ENGINEERS ▲ SURVEYORS ▲ PLANNERS
BARLEY
AND ASSOCIATES, INC.

VIA FEDERAL EXPRESS
February 22, 2001

St. Johns River Water Management District
618 E. South Street
Orlando, Florida 32801

RE: KINGS RIDGE PHASE III (FBA #941216.113) (Highgate Ph II + Sussex)

To Whom It may Concern:

Enclosed please find the following with regards to the above mentioned project:

1. Original and five (5) copies of the ERP stormwater permit application.
2. Five sets of construction drawings (signed, sealed & dated)
3. Five (5) sets pf Stormwater Calculations (signed, sealed & dated)
4. Five (5) Notice and Receipt Forms.
5. Check in the amount of \$ 1000.00.

Should you have any questions or comments with regards to this matter, please feel free to contact our office.

Sincerely,

FARNER, BARLEY & ASSOCIATES, INC.

Duane K. Booth, P.E., Project Engineer

DKB/sm

cc: Rob Ahrens, Lennar Homes, Inc. (w/out encl.)
Guy Trussell, Lennar Homes, Inc. (w/out encl.)

4-069-19411-11
RECEIVED

FEB 23 2001

PDS
ORLANDO
SJR WMD

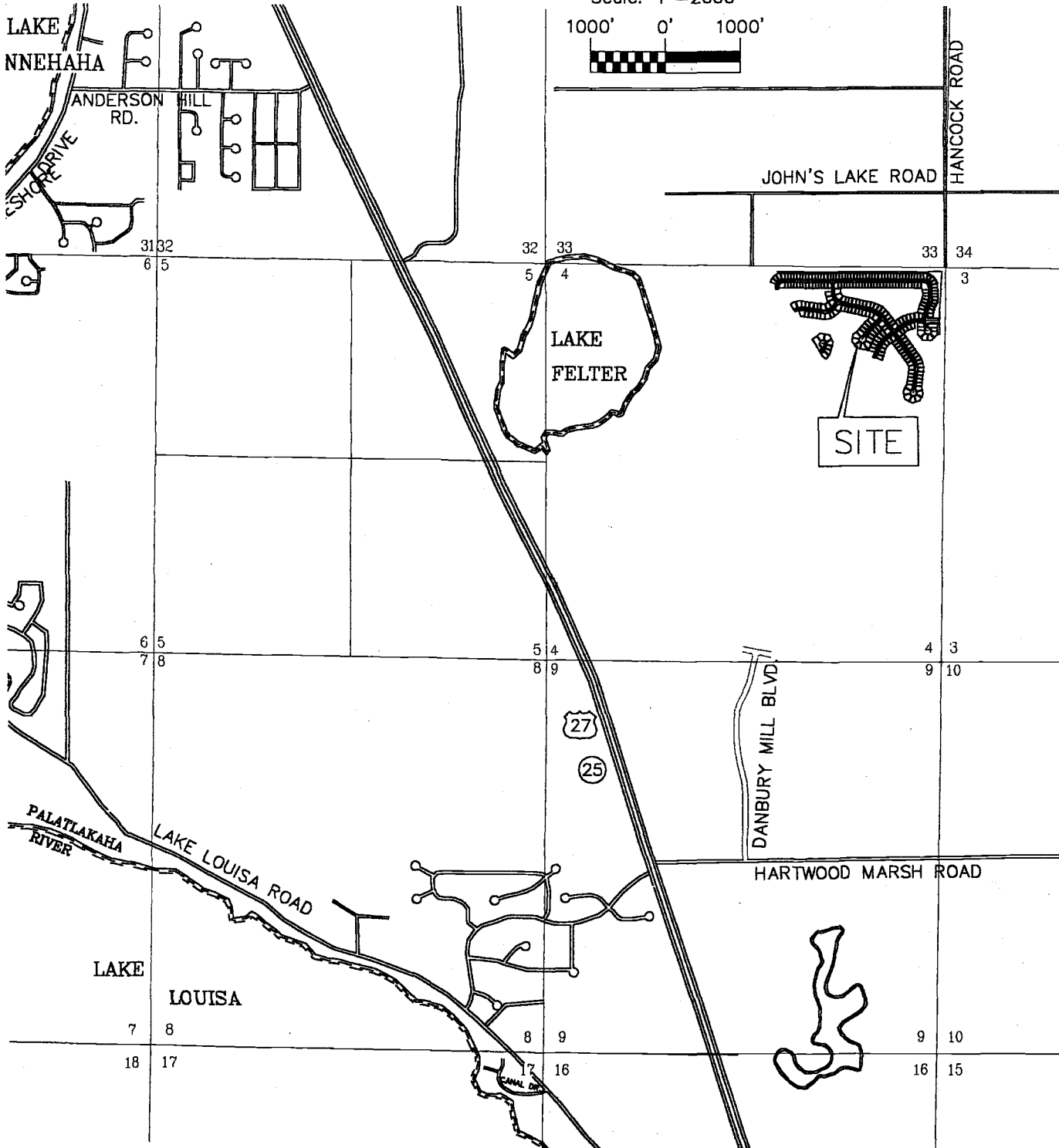
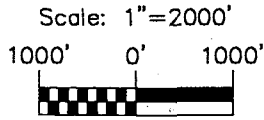

**FARNER
BARLEY**
AND ASSOCIATES, INC.
30 North Woodland Avenue O. Tallahassee, Florida 32302 904-343-8401

▲ ENGINEERS
▲ SURVEYORS
▲ PLANNERS

HIGHGATE AND SUSSEX
AT KINGS RIDGE

LOCATION MAP

DATE: DEC 26, 2000

JOB NO. 941216.113

40069-19411-11
Attachment A

PERMIT NO.	PROJECT NAME	DATE ISSUED
42-069-1062N	Kings Ridge P.U.D., Phase I	6/28/95
40-069-0196	Kings Ridge P.U.D., Phase II	10/11/95
4-069-0326-ERP	Kings Ridge P.U.D., Phase III	2/13/96
4-069-0326M-ERP	Kings Ridge P.U.D., Phase IV	8/13/96
4-069-0326M2-ERP	Wellington at Kings Ridge	8/12/97
4-069-0326M3-ERP	Danbury Mill Road Blvd. at Kings Ridge	9/9/97
40-069-0196M-ERP	Danbury Mill Blvd. Extension at Kings Ridge	11/17/97
4-069-0326M4-ERP	(not in vault, ACCESS, or GRS)	(not in vault, ACCESS, or GRS)
4-069-0326M5-ERP	Sutherland at Kings Ridge	became 40-069-0196AM2-ERP
40-069-0196M2-ERP	Sutherland at Kings Ridge	12/17/97
40-069-0196M3-ERP	Wellington III at Kings Ridge	1/27/98
4-069-0326M6-ERP	Whitehall at Kings Ridge	5/12/98
4-069-0326M7-ERP	Cambridge at Kings Ridge	6/9/98
4-069-0326M8-ERP	Manchester at Kings Ridge	7/8/98
40-069-0316-ERP	Remington at Kings Ridge	8/10/98
40-069-0317-ERP	Stratford at Kings Ridge	8/10/98
40-069-0196M4-ERP	Lancaster at Kings Ridge	3/1/99
40-069-0351-ERP	Somerset at Kings Ridge	5/27/99
40-069-0355G-ERP	Fire Station at Kings Ridge	6/9/99
40-069-0370-ERP	North Ridge	6/30/99

**ATTACHMENT B: Permitting history for Kings Ridge P.U.D.
Kings Ridge North Ph. III, Application #4-069-19411-11**

PERMIT NO.	PROJECT NAME	DATE ISSUED
4-069-0326M9-ERP	Kings Ridge North	4/11/00
4-069-0326M10-ERP	Publix at Kings Ridge	5/9/00
40-069-19411-9	Aberdeen Phase II @ Kings Ridge	8/22/00
4-069-19411-10	Somerset Estates Phase II at Kings Ridge	pending
4-069-19411-11	Kings Ridge North Phase III	pending

4-069-19411-12

Kings Ridge North Phase I

4/11/01

**ATTACHMENT B: Permitting history for Kings Ridge P.U.D.
Somerset Estates Ph. II at Kings Ridge, Application #4-069-19411-10**

ERP Wetland Inventory

Project Name: Kings Ridge North Phase III

Application Number: 40-069-19411-11

	Off-Site	On-Site	FLUCFCS
A: Total Wetland Acreage:	0.00	0.00	
B: Total Wetlands "Preserved" (i.e. not disturbed or lost):		0.00	
C: Total Wetlands Disturbed (temporary, not lost):		0.00	
D: Total Wetlands Lost:		0.00	
1. Contiguous to Waters of the State:		0.00	
2. Isolated Wetlands:		0.00	
a. Less than 0.5 acre:		0.00	
b. 0.5 acre or greater:		0.00	
c. 62-340.700 exempted:		0.00	
E: Total Wetlands Created as Mitigation:		0.00	
F: Total Wetlands Enhanced as Mitigation:		0.00	
G: Other Compensation:		0.00	
1. Wetland Preservation:	0.00	0.00	
2. Upland Preservation:	0.00	0.00	
3. Upland Enhancement:	0.00	0.00	
4. Mitigation Banks (credits)	0.00		
4. Cash Contribution (Dollars)	\$0.00		

The FLUCFCS code must be appended to the acreage values.

Comments:

PDS ROUTING SHEET

DELIVERED: US Mail (HD) UPS Fed Ex Other _____

MAIL TYPE: application mail _____

RECEIVED ON: 2/23 BY: CD

OPENED ON: 2/23 BY: CD

CHECK ENTERED ON: 2/23 BY: CD

STAMPED IN ON: 2-28-01 BY: AB

NUMBERED ON: 2-28-01 BY: AB

ENTERED INTO GRS ON: 2-28-01 BY: AB

ENTERED INTO ACCESS ON: _____ BY: _____

COPIED ON: 2-28-01 BY: AB

4-069-0326
NOW 19411 - 11

Lewis
Raynashi

GIS - Date Received / /

MSSW GIS Processing Sheet

Application # 4-069-19411-11

Section(s) 04

Township(s) 23

Range(s) 26

Basin Code EB OB UB WB WP Other

Date Mapped 03-13-01 Acceptable? Yes No

Map # 41 Quad Name 586 Clermont-E

Additional Quads/Comments _____

Mapper's Initials AR

Reviewer _____