

# Project Correspondence

1724

RESOURCE MANAGEMENT ROUTING SHEET

Permit#: 4-069-19411-10

Report Date: Apr 02, 2001

Date Mail Received: Mar 20, 2001

Appl. Received: Dec 12, 2000

Date Permit Issued:

Mail Type: Pending Application Correspondence

Project Name: Somerset Estates Phase II At Kings Ridge

Name	Job Title	Office
Rickie A Ottesen	Engineer III	Orlando
Victoria L Nations	Regulatory Scientist I	Orlando

GENERAL COUNCIL:

\_\_\_\_\_

\_\_\_\_\_

Copied and Routed By:  on 4/2/01

Routed from: Orlando

RESOURCE MANAGEMENT ROUTING SHEET

Permit#: 4-069-19411 -10

Report Date: Feb 14, 2001

Date Mail Received: Feb 08, 2001

Appl. Received: Dec 12, 2000

Date Permit Issued:

Mail Type: Response to RAI

Project Name: Somerset Estates Phase II At Kings Ridge

Name	Job Title	Office
Rickie A Ottesen	Engineer III	Orlando
Victoria L Nations	Regulatory Scientist I	Orlando

GENERAL COUNCIL:

\_\_\_\_\_

\_\_\_\_\_

Copied and Routed By: ACH on 2-14-1

Routed from: Orlando

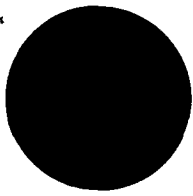

VIA FEDERAL EXPRESS  
February 7, 2001

Mr. Rick Ottesen  
St Johns River Water Management District  
618 East South Street  
Orlando, Florida 32801

**RECEIVED**

FEB 08 2001

19411-10

PDS  
ORLANDO  
SJR WMD

RE: **SOMERSET PHASE II & III (FBA #941216.114) - APPLICATION #4-069-19411-10**

Dear Mr. Ottesen:

Enclosed, please find our response to your comments dated January 9, 2001 along with (3) three copies that include (3) preliminary plat and (3) three Post Development Plans in regards to the above mentioned project.

1. The post-development master drainage basin map doesn't show the associated total amount of area that contributes to each pond. Also, it is unclear from the master drainage basin map the identity of the pond that basin B-3 discharges to. Please provide a revised drainage basin map that clearly indicated the drainage basin boundaries, the identification of each pond, and the area, in acres or square feet of each basin that contributes stormwater runoff to each pond. Demonstrate that the information associated with the drainage basin map corresponds with the calculations. Submit any revised plans and calculations, as applicable.

**Master drainage map has been revised showing acreage of each basin. Pond B-3 is designed to hold the 25-96 hour storm event, therefore B-3 does not discharge. In phase I, the City required an emergency outfall set at the 25 yr. 96 hour peak stage. The City is not requiring this in Phase II & III.**

2. The plans indicate a retention pond located behind proposed lots 48 through 51 that appears to be associated with the Somerset-Phase I project. It appears from the plans submitted, especially from plan sheet 17, that a portion of the retention pond is sited within the Phase II project area. Please clarify. Please clearly indicate, on the plans, the entire location of the retention pond that basin B-3 discharges to. Include the top and bottom contours, with elevations. Also, please indicate the plans that the retention pond in question will be within a drainage easement.

**The pond was built in phase I. The area from lots 48 through half of lot 52 was used in the design of the pond under Somerset Phase I construction plans. The phase line under Somerset Phase I was incorrectly shown in the Phase I submittal. A portion of pond B-3 is designated on the Plat of Somerset Estates Phase I. The additional part of the pond will be a tract of the Somerset Estates Phase II plat. See sheet 2 of the construction plans titled Preliminary Plat. Tract is titled Tract "B".**

3. Please provide a pre-development and a post development nodal diagram in a drainage basin map for the proposed project site. The requested nodal diagram should include all reaches and nodes clearly identified. Submit any revised plans and calculations, as applicable.

**See attached nodal diagram, basin B-4 flows into basin 6-A via storm pipe. Basin 6-A is a landlocked system and is designed for 25 yr.-96 hour stormwater event. Basin B-5 flows into basin 5-A via storm pipe. Basin 5A also is in a landlocked system and is designed for the 25 yr - 96 hr storm event. There is no discharge from either basin during the 25 yr-96 hr. storm event .**

4. The post-development master drainage basin map includes all of lot 35 within basin B-3. The plans indicate lot 35 having a proposed type "B" lot grading scheme with half of the runoff from the lot discharging away from basin B-3. Please clarify and submit any revisions, as applicable.

**The proposed drainage basin map was incorrectly shown. The map has been revised. The calculations reflect the construction drawings.**

5. Please provide a certification that is signed, sealed, and dated by an appropriate registrant holding a valid certificate of registration within the State of Florida. The requested certification (EN-46) must confirm that the existing "dry-bottom" retention ponds are functioning as intended. Submit any revised plans and calculations as applicable.

**See attached EN-46.**

Sincerely,

FARNER, BARLEY & ASSOCIATES, INC.

  
Duane K. Booth, P.E.  
Project Engineer

DKB/sm

# PROPOSED NODAL MAP

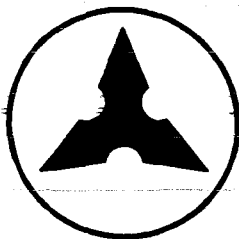
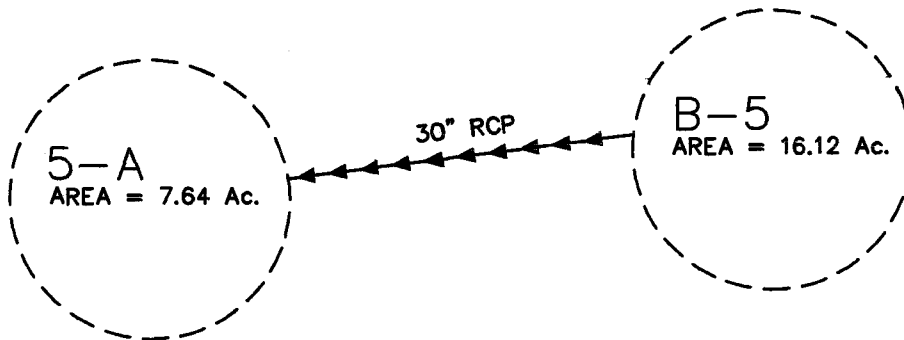
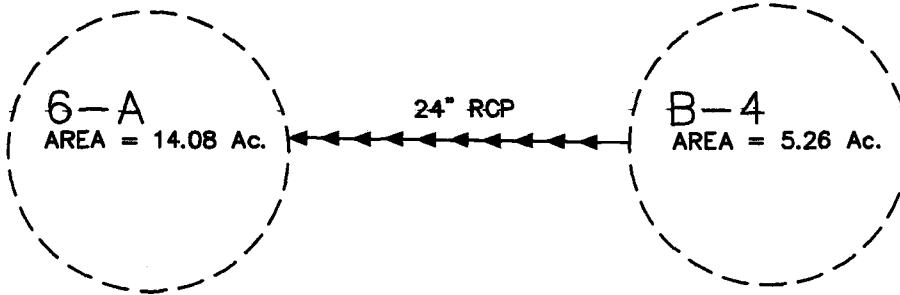
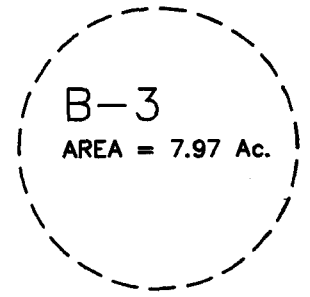

**FARNER**  
**BARLEY**  
AND ASSOCIATES, INC.

- ▲ ENGINEERS
- ▲ SURVEYORS
- ▲ PLANNERS

350 North Sinclair Avenue ○ Tavares, Florida 32778 ○ (904) 343-8481

# EXISTING NODAL MAP

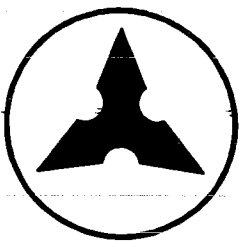
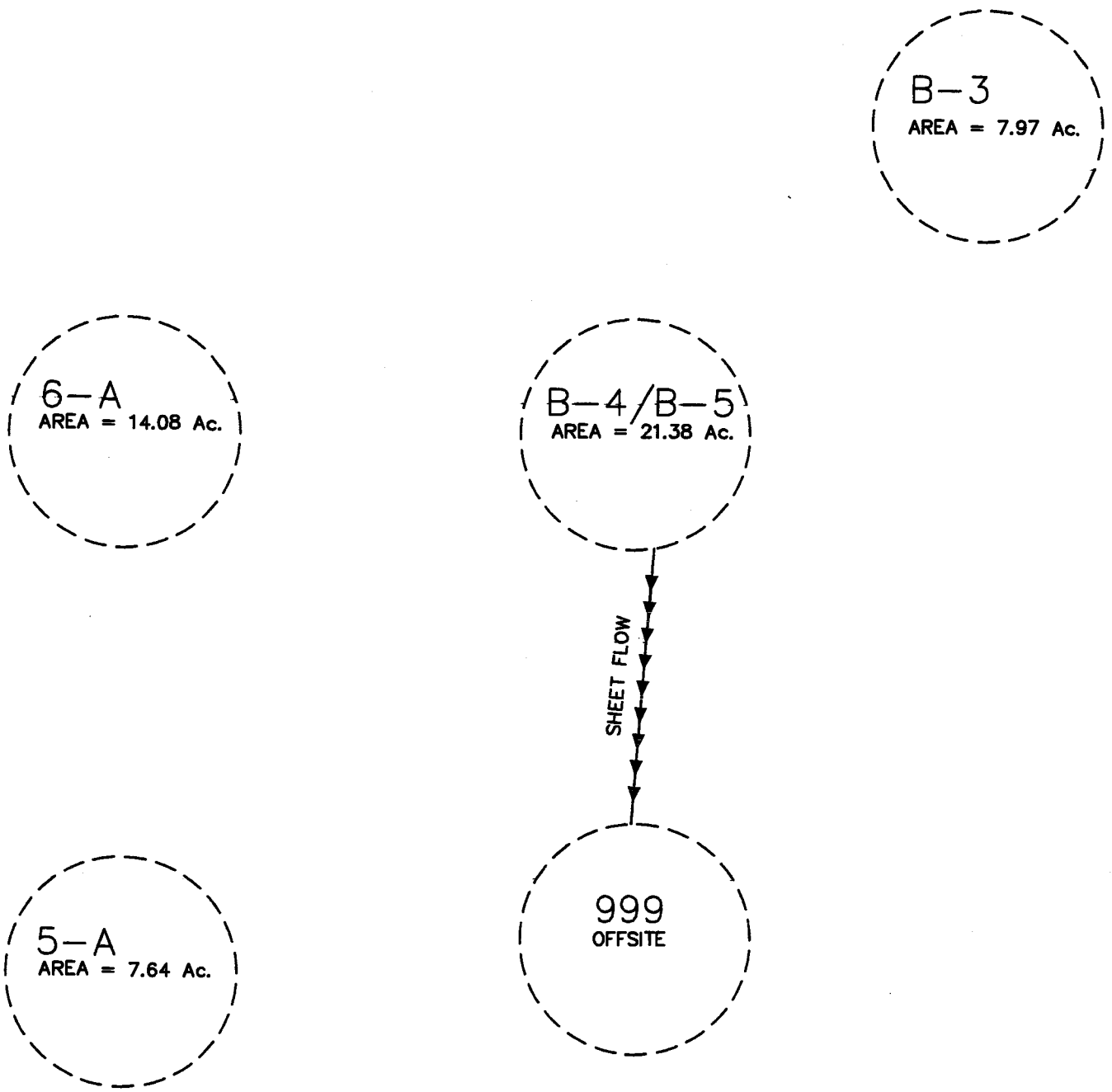

**FARNER**  
**BARLEY**  
AND ASSOCIATES, INC.

- ▲ ENGINEERS
- ▲ SURVEYORS
- ▲ PLANNERS

### STATEMENT OF INSPECTION REPORT

PERMIT NUMBER: #4-069-19411-10 (APPLICATION NO.)  
PROJECT NAME: SOMERSET PHASE II & III  
INSPECTION DATE(S): January 25, 2001

STORMWATER MANAGEMENT SYSTEM INSPECTION RESULTS: (CHECK ONE)

I HEREBY VERIFY THAT I OR MY AUTHORIZED AGENT HAVE INSPECTED THE SYSTEM AT THE ABOVE REFERENCED PROJECT AND THAT IT APPEARS TO BE FUNCTIONING ACCORDING TO THE REQUIREMENTS OF THE PERMIT AND CHAPTER 40C-42, F.A.C. THE FOLLOWING NECESSARY MAINTENANCE WAS CONDUCTED:

I HEREBY CERTIFY THAT I OR MY AUTHORIZED AGENT HAVE INSPECTED THE SYSTEM AT THE ABOVE REFERENCED PROJECT AND THAT THE SYSTEM DOES NOT APPEAR TO BE FUNCTIONING IN COMPLIANCE WITH THE REQUIREMENTS OF THE PERMIT AND CHAPTER 40C-42, F.A.C. I UNDERSTAND THE FOLLOWING: (A) THAT MAINTENANCE IS REQUIRED TO BRING THE SYSTEM INTO COMPLIANCE, AND (B) IF MAINTENANCE MEASURES ARE NOT ADEQUATE TO BRING THE SYSTEM INTO COMPLIANCE, THE SYSTEM MAY HAVE TO BE REPLACED OR AN ALTERNATE DESIGN CONSTRUCTED SUBSEQUENT TO DISTRICT APPROVAL. I WILL CONDUCT THE FOLLOWING MAINTENANCE WITHIN 15 DAYS:

 _____ SIGNATURE	February 6, 2001 _____ DATE
Duane K. Booth, P.E. _____ NAME (PLEASE PRINT)	Project Engineer _____ TITLE
FARNER, BARLEY & ASSOCIATES, INC. _____ COMPANY/AGENCY NAME	(352) 343-8481 _____ PHONE
350 NORTH SINCLAIR AVENUE, TAVARES, FLORIDA 32778 _____ ADDRESS	

WITHIN 30 DAYS OF INSPECTION OF THE SYSTEM, SUBMIT TO COPIES OF THIS FORM TO :

Department of Permit Data Services  
ST. JOHNS RIVER WATER MANAGEMENT DISTRICT  
Post Office Box 1429  
Palatka, Florida 32178-1429





# St. Johns River Water Management District

Henry Dean, Executive Director • John R. Wehle, Assistant Executive Director  
David Dewey, Orlando Service Center Director

618 East South Street • Orlando, FL 32801 • (407) 897-4300

January 9, 2001

CERTIFIED NO. 7000 0600 0024 1459 6370

RECEIVED  
JAN 10 2001

Duane K. Booth, P.E.  
Farner, Barley & Associates, Inc.  
350 North Sinclair Avenue  
Tavares, FL 32778

Re: Somerset Estates Phase II @ Kings Ridge; Application No. 4-060009  
(Please reference the above number on any submittal)

RECEIVED

Dear Mr. Booth:

FEB 08 2001  
19411-10

The St. Johns River Water Management District is in receipt of your Individual Environmental Resource Permit application. Upon preliminary review of the proposed project, the following technical information is required to sufficiently review the possible impacts the project may have on the surrounding area. This information is being requested pursuant to the authority vested in the St. Johns River Water Management District under subsection 373.413(2), Florida Statutes, and sections 40C-4.101 and 40C-4.301, Florida Administrative Code.

In order to expedite the review of your application, please use the application number referenced above on all correspondence, and submit three (3) copies of all requested information unless otherwise indicated by a specific information request.

- The post-development master drainage basin map does not show the associated total amount of area that contributes to each pond. Also, it is unclear from the master drainage basin map the identity of the pond that basin B-3 discharges to. Please provide a revised drainage basin map that clearly indicates the drainage basin boundaries, the identification of each pond, and the area, in acres or square feet of each basin that contributes stormwater runoff to each pond. Demonstrate that the information associated with the drainage basin map corresponds with the calculations. Submit any revised plans and calculations, as applicable. [40C-4.301(1)(a)(b)(c); 40C-42.026(1), F.A.C.]
- The plans indicate a retention pond located behind proposed lots 48 through 51 that appears to be associated with the Somerset – Phase I project. It appears from the plans submitted, especially from plan sheet 17, that a portion of the retention pond is sited within the Phase II project area. Please clarify. Please clearly indicate, on the plans, the entire location of the retention pond that basin B-3 discharges to. Include the top and bottom contours, with elevations. Also, please indicate on the plans that the retention

#### GOVERNING BOARD

William Kerr, CHAIRMAN MELBOURNE BEACH	Ometrias D. Long, VICE CHAIRMAN APOPKA	Jeff K. Jennings, SECRETARY MATLAND	Duane Ottenstrofer, TREASURER JACKSONVILLE
Dan Roach FERNANDINA BEACH	William M. Segal MATLAND	Otis Mason ST. AUGUSTINE	Clay Albright EAST LAKE WEIR
			Reid Hughes DAYTONA BEACH

pond in question will be within a drainage easement. [40C-4.301(1)(a)(b)(c); 40C-42.026(1), F.A.C.]

3. ✓ Please provide a pre-development and a post-development nodal diagram on a drainage basin map for the proposed project site. The requested nodal diagram should include all reaches and nodes clearly identified. Submit any revised plans and calculations, as applicable. [40C-4.301(1)(a)(b)(c)(d)(i); 40C-42.023(1)(b); 40C-42.026(1), F.A.C.]
4. ✓ The post-development master drainage basin map includes all of lot 35 within basin B-3. The plans indicate lot 35 having a proposed type "B" lot-grading scheme with half of the runoff from the lot discharging away from basin B-3. Please clarify and submit any revisions, as applicable. [40C-4.301(1)(a)(b)(c); 40C-42.026(1), F.A.C.]
5. ✓ Please provide a certification that is signed, sealed, and dated by an appropriate registrant holding a valid certificate of registration within the State of Florida. The requested certification (EN-46) must confirm that the existing "dry-bottom" retention ponds are functioning as intended. Submit any revised plans and calculations, as applicable. [40C-4.301(1)(a)(b)(c); 40C-42.023(1)(b); 40C-42.026(1), F.A.C.]

If the applicant wishes to dispute the necessity for any information requested on an application form or in a letter requesting additional information, he or she may pursuant to section 373.4141, Florida Statutes, request that District staff process the application without the requested information. If the applicant is then unsatisfied with the District's decision regarding issuance or denial of the application, the applicant may request a section 120.569, Florida Statutes, hearing pursuant to Chapter 28-106 and section 40C-1.1007, F.A.C.

Please be advised, pursuant to subsection 40C-1.1008, F.A.C., the applicant shall have 90 days from receipt of a request for additional information regarding a permit or license application undergoing review by the District to submit that information to the District. If an applicant requires more than 90 days in which to complete an application, the applicant may notify the District in writing of the circumstances and for good cause shown, the application shall be held in active status for additional periods commensurate with the good cause shown. Any application which has not been completed by the applicant within the given time period following a request for additional information by the District shall be recommended for denial at the next regularly scheduled Board meeting. Denial of an application due to failure to submit requested additional information shall be a denial without prejudice to the applicant's right to file a new application.

In addition, no construction shall begin on the proposed project until a permit is issued by the St. Johns River Water Management District. This is pursuant to subsection 40C-4.041(1),

Duane K. Booth, P.E.  
January 9, 2001  
Page 2

F.A.C., which states in relevant part, "unless expressly exempt an individual or general environmental resource permit must be obtained from the District under Chapter 40C-4, 40C-40, 40C-42, 40C-44, or 40C-400, F.A.C. prior to the construction, alteration, operation, maintenance, removal or abandonment of any dam, impoundment, reservoir, appurtenant work or works...."

If you have any questions, please call me at 407/897-4322.

Sincerely,



Rick Ottesen, Engineer  
Department of Water Resources

cc: PDS/RAIL, David Dewey, <sup>we for</sup> Joan B. Budzynski, Victoria Nations

Lennar Land Partners, A Florida General Partnership  
Attn: Mr. Robert Ahrens  
7600 Nob Hill  
Tamarac, FL 33321



# St. Johns River Water Management District

Henry Dean, Executive Director • John R. Wehle, Assistant Executive Director  
David Dewey, Orlando Service Center Director

618 East South Street • Orlando, FL 32801 • (407) 897-4300

January 9, 2001

CERTIFIED NO. 7000 0600 0024 1459 6370

Duane K. Booth, P.E.  
Farner, Barley & Associates, Inc.  
350 North Sinclair Avenue  
Tavares, FL 32778

Re: Somerset Estates Phase II @ Kings Ridge; Application No. 4-069-19411-10  
(Please reference the above number on any submittal)

Dear Mr.Booth:

The St. Johns River Water Management District is in receipt of your Individual Environmental Resource Permit application. Upon preliminary review of the proposed project, the following technical information is required to sufficiently review the possible impacts the project may have on the surrounding area. This information is being requested pursuant to the authority vested in the St. Johns River Water Management District under subsection 373.413(2), Florida Statutes, and sections 40C-4.101 and 40C-4.301, Florida Administrative Code.

In order to expedite the review of your application, please use the application number referenced above on all correspondence, and submit three (3) copies of all requested information unless otherwise indicated by a specific information request.

1. The post-development master drainage basin map does not show the associated total amount of area that contributes to each pond. Also, it is unclear from the master drainage basin map the identity of the pond that basin B-3 discharges to. Please provide a revised drainage basin map that clearly indicates the drainage basin boundaries, the identification of each pond, and the area, in acres or square feet of each basin that contributes stormwater runoff to each pond. Demonstrate that the information associated with the drainage basin map corresponds with the calculations. Submit any revised plans and calculations, as applicable. [40C-4.301(1)(a)(b)(c); 40C-42.026(1), F.A.C.]
2. The plans indicate a retention pond located behind proposed lots 48 through 51 that appears to be associated with the Somerset – Phase I project. It appears from the plans submitted, especially from plan sheet 17, that a portion of the retention pond is sited within the Phase II project area. Please clarify. Please clearly indicate, on the plans, the entire location of the retention pond that basin B-3 discharges to. Include the top and bottom contours, with elevations. Also, please indicate on the plans that the retention

---

#### GOVERNING BOARD

William Kerr, CHAIRMAN MELBOURNE BEACH	Ometrias D. Long, VICE CHAIRMAN APOPKA	Jeff K. Jennings, SECRETARY MAITLAND	Duane Ottenstroer, TREASURER JACKSONVILLE	
Dan Roach FERNANDINA BEACH	William M. Segal MAITLAND	Otis Mason ST. AUGUSTINE	Clay Albright EAST LAKE WEIR	Reid Hughes DAYTONA BEACH

pond in question will be within a drainage easement. [40C-4.301(1)(a)(b)(c); 40C-42.026(1), F.A.C.]

3. Please provide a pre-development and a post-development nodal diagram on a drainage basin map for the proposed project site. The requested nodal diagram should include all reaches and nodes clearly identified. Submit any revised plans and calculations, as applicable. [40C-4.301(1)(a)(b)(c)(d)(i); 40C-42.023(1)(b); 40C-42.026(1), F.A.C.]
4. The post-development master drainage basin map includes all of lot 35 within basin B-3. The plans indicate lot 35 having a proposed type "B" lot-grading scheme with half of the runoff from the lot discharging away from basin B-3. Please clarify and submit any revisions, as applicable. [40C-4.301(1)(a)(b)(c); 40C-42.026(1), F.A.C.]
5. Please provide a certification that is signed, sealed, and dated by an appropriate registrant holding a valid certificate of registration within the State of Florida. The requested certification (EN-46) must confirm that the existing "dry-bottom" retention ponds are functioning as intended. Submit any revised plans and calculations, as applicable. [40C-4.301(1)(a)(b)(c); 40C-42.023(1)(b); 40C-42.026(1), F.A.C.]

If the applicant wishes to dispute the necessity for any information requested on an application form or in a letter requesting additional information, he or she may pursuant to section 373.4141, Florida Statutes, request that District staff process the application without the requested information. If the applicant is then unsatisfied with the District's decision regarding issuance or denial of the application, the applicant may request a section 120.569, Florida Statutes, hearing pursuant to Chapter 28-106 and section 40C-1.1007, F.A.C.

Please be advised, pursuant to subsection 40C-1.1008, F.A.C., the applicant shall have 90 days from receipt of a request for additional information regarding a permit or license application undergoing review by the District to submit that information to the District. If an applicant requires more than 90 days in which to complete an application, the applicant may notify the District in writing of the circumstances and for good cause shown, the application shall be held in active status for additional periods commensurate with the good cause shown. Any application which has not been completed by the applicant within the given time period following a request for additional information by the District shall be recommended for denial at the next regularly scheduled Board meeting. Denial of an application due to failure to submit requested additional information shall be a denial without prejudice to the applicant's right to file a new application.

In addition, no construction shall begin on the proposed project until a permit is issued by the St. Johns River Water Management District. This is pursuant to subsection 40C-4.041(1),

Duane K. Booth, P.E.

January 9, 2001

Page 2

F.A.C., which states in relevant part, "unless expressly exempt an individual or general environmental resource permit must be obtained from the District under Chapter 40C-4, 40C-40, 40C-42, 40C-44, or 40C-400, F.A.C. prior to the construction, alteration, operation, maintenance, removal or abandonment of any dam, impoundment, reservoir, appurtenant work or works...."

If you have any questions, please call me at 407/897-4322.

Sincerely,



Rick Ottesen, Engineer  
Department of Water Resources

cc:  IL, <sup>we for</sup> David Dewey, Joan B. Budzynski, Victoria Nations

Lennar Land Partners, A Florida General Partnership  
Attn: Mr. Robert Ahrens  
7600 Nob Hill  
Tamarac, FL 33321