



Compliance Submittal

1721

1997

Henry Dean, Executive Director
John R. Wehle, Assistant Executive Director



POST OFFICE BOX 1429 **PALATKA, FLORIDA 32178-1429**
TELEPHONE 904-329-4500 1-800-451-7106 SUNCOM 904-860-4500
TDD 904-329-4450 TDD SUNCOM 860-4450
FAX (Executive) 329-4125 (Legal) 329-4485 (Permitting) 329-4315 (Administration/Finance) 329-4508

SERVICE CENTERS
618 E. South Street 7775 Baymeadows Way **PERMITTING:**
Orlando, Florida 32801 Suite 102 305 East Drive
407-897-4300 Jacksonville, Florida 32256 Melbourne, Florida 32904
1-877-228-1658 904-730-6270 407-984-4940
TDD 407-897-5960 1-800-852-1563 1-800-295-3264
TDD 904-448-7900 TDD 407-722-5368

January 21, 1999

Mr. James C. Branch, P.E.
Conklin, Porter and Holmes Engineers, Inc.
101 N. Woodland Boulevard
DeLand, Florida 32720

ENTERED
2/16/99

Re: Proposed Construction Sequence
Greater Pines Phases 5-7, Permit Number 4-069-0276M2-ERP

Dear Mr. Branch:

The District received your letter in regard to compliance with the referenced permit. This permit authorizes the construction of phases 5 through 7 of Greater Pines. From our conversation of January 19, 1999, I understand that construction of the phase 5 infrastructure is nearing completion and that construction phases 6 and 7 will be initiated in the near future. The subject of your letter relates to the sodding of ponds to serve this portion of the development.

I understand that construction sequencing and the layout of the site has resulted in the excavation of the ponds to serve phases 6 and 7 prior to construction of any impervious surfaces or the secondary drainage system for these phases. Greater Construction proposes to finish grade and sod the portions of this system necessary to serve the nearly completed phase 5. Completion of finish grading work and sod placement for the remainder of the system will be completed with construction of the next phase of the infrastructure. This delay for sod placement is proposed to reduce costs at this time and reduce the need for extensive irrigation due to dry weather. I explained to you that we recommend sodding of disturbed areas as soon as possible to prevent erosion.

It appears that any eroded sediments will be deposited and contained within the ponds and that sufficient stabilization will occur to secure the stormwater structures as well as required treatment and storage volumes for phase 5. Therefore the proposed construction sequence complies with permit 4-069-0276M2-ERP. Should erosion result in sedimentation of the ponds, the District will require excavation of the ponds to the permitted contours. Finish grading to the permitted contours and stabilization of all sidebanks will be required prior to acceptance of an as-built certification or transfer of this system to the Operation and Maintenance Entity.

Please be aware that the information in this letter is based on the information that you provided and as described herein. If the description of the proposed activities is incorrect, or your plans change in the future, it is recommended that you contact District staff to assure compliance with District permit requirements.

Dan Roach, CHAIRMAN Kathy Chinoy, VICE CHAIRMAN James T. Swann, TREASURER Otis Mason, SECRETARY
FERNANDINA BEACH PONTE VEDRA COCOA ST. AUGUSTINE
William M. Segal Griffin A. Greene James H. Williams Patricia T. Harden Reid Hughes
MAITLAND VERO BEACH Ocala SANFORD DAYTONA BEACH

Mr. James C. Branch
January 21, 1999
Page 2

Finally, this letter applies only to the permit requirements of St. Johns River Water Management District and does not relieve you of meeting the permit requirements of local, county, or other legally constituted authorities.

Thank you for your cooperation with our permit compliance program. If you have questions about the above information, please contact me at (407/897-4317)

Sincerely,



William E. Carlie Jr., Compliance Manager
Department of Resource Management

cc: David Dewey ^{DD} Wil Causseaux, Orlando Permit Files, PDS/PDL

21

Conklin, Porter and Holmes
cph ENGINEERS, INC.
MAINSTREET CENTER, SUITE 100
101 N. WOODLAND BLVD.
DELAND, FLORIDA 32720
TEL 904-736-4142 FAX 904-736-8412
SANFORD 407-322-6841

January 20, 1999

Mr. Bill Carlie
St. Johns River Water Management District
Suite 200
618 E. South Street
Orlando, Florida 32801

Via Facsimile (Total of 6 Pages) to: (407) 897-4354, With Original to Follow by Mail

Re: Construction Completion - Greater Pines Phase 5
SJRWMD Permit No. LR-069-0276M2-ERP
CPH Job No. G6765.07

RECEIVED
JAN 21 1999
4-069-0276M2-ERP
FDS
ORLANDO
SJR WMD

Dear Bill:

Per our telephone conversation yesterday, attached is a second copy of our letter sent to you on December 23, 1998, requesting SJRWMD approval of the reduction of sodding at the Greater Pines site. As you can see from the letter, we are requesting that the District approve putting in the sodding necessary to serve Phase 5 only, at this time. Further sodding, to serve the future phases approved under that SJRWMD permit, would be put in when those phases are, in fact, built.

Per our conversations, we understand that you have no objection to us reducing the sodding in this manner. We would request a short written response from the District to that end. We need this written confirmation to provide to Lake County, so that we can get Phase 5 of Greater Pines finished and accepted by the County.

Please call if you have any questions concerning the above.

Sincerely,

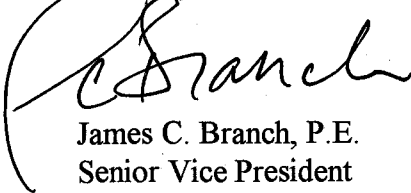
James C. Branch, P.E.
Senior Vice President

Enclosures

cc: w/enclosures

Mr. Hamp Conley, Greater Construction Via Fax: (407) 862-0057
Mr. Terry M. Zaudtke, P.E., DEE, CPH-Orlando Via Fax: (407) 648-1036

A:\G6765.07\jcb1-20.ltr:ss



December 23, 1998

Conklin, Porter and Holmes
cph **ENGINEERS, INC.**
MAINSTREET CENTER, SUITE 100
101 N. WOODLAND BLVD.
DELAND, FLORIDA 32720
TEL 904-736-4142 FAX 904-736-8412
SANFORD 407-322-6841

Mr. Bill Carlie
St. Johns River Water Management District
618 E. South Street
Orlando, Florida 32801

**FILE COPY
DUPLICATE**

RE: Construction Completion – Greater Pines Phase 5
SJRWMD Permit No. 4-069-0276M2-ERP
CPH Job No. G6765.07

Dear Bill:

Our Client, Greater Construction Corporation, and their Contractor, are nearing completion of the utility, roadway, and storm system infrastructure to serve Phase 5 of Greater Pines. As part of the construction of Phase 5 of Greater Pines, three dry retention/detention ponds and the system outfall have been constructed. Phases 6 and 7 of Greater Pines have not yet been built.

The approved Engineering Plans for Greater Pines Phase 5-7 call for sodding of the pond side slopes for all three ponds. The total sodding required for all three ponds and to serve all three phases permitted is 55,700 SY.

Our Client has asked us to investigate the possibility of sodding only those portions of the ponds necessary to serve Phase 5 alone. Greater is hesitant to install all of the sod to serve all three phases for three reasons:

1. It is now the end of December and this is usually a relatively dry period and sod placed during this time will require extensive watering to ensure its survival.
2. Final grading work has not been completed on Phase 6 of Greater Pines, and this final grading may affect the pond side slopes and, thus, kill any sod located in the areas adjacent to the Phase 6 construction.
3. The sod cost for the full 55,700 SY is approximately \$70,000 and if substantial portions of the sod do not survive due to the weather or subsequent construction of Phases 6 and 7, the cost of that sod would be wasted.

The attached sketch shows those areas that we feel need to be sodded to serve Phase 5 alone. The area is approximately 30,000 SY.

We inquired of Lake County as to whether they would accept the Phase 5 stormwater system as complete, with the sodding limited to that shown on the attached. Their verbal response was to check with the Water Management District to ensure that the District did not have any problems with this, more limited, sodding program. We have reviewed the conditions of issuance for Permit No. 4-069-0276M2-ERP, and find only one condition that might speak to this issue at all.



Mr. Bill Carlie
December 23, 1998
Page 2

That is Condition No. 5, which speaks to the need for stabilization measures for erosion and sedimentation control on disturbed areas. It is the Developer's intent to leave in-place silt fences and other sedimentation and erosion control measures on the future phases, so as to reduce the amount of eroded material, both reaching the retention ponds and that which would be windborne throughout the development, affecting the house construction of Phase 5 and the existing homes in Phases 1 through 4.

Please review the above and the attached drawing and let us know, in writing, whether this more limited sodding program to serve Phase 5 alone would be acceptable to the District. Please note that long-term, once Phases 6 and 7 are constructed, full grassing of all the retention pond areas, in accordance with the requirements of the approved Engineering Plans is proposed. This is a request that some portion of that full grassing measures be delayed until the construction of the future phases make it necessary.

Please call if you have any questions concerning the above.

Sincerely,

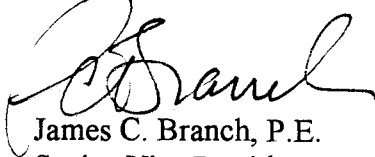

James C. Branch, P.E.
Senior Vice President

Cc: Greater Construction, Attn: Hamp Conley (w/enclosures)

December 18, 1998

Mr. Gary Gant, Engineering Inspector
Lake County Public Services
123 N. Sinclair Avenue
Tavares, Florida 32778

DUPLICATE
FILE COPY

VIA FACSIMILE (Total of 3 Pages) to: (352) 343-9596, With Original to Follow by Mail

Re: Greater Pines Phase 5 – Retention Pond Sodding
CPH Job No. G6765.07

Dear Gary:

Based on our previous telephone conversation on December 17, 1998, we are proposing at this time that only a portion of Ponds No. 2, 3, and 4 be sodded. and the sodding of the remaining areas be delayed until future adjacent phases are constructed. Our concern in sodding the entire pond is two-fold.

1. The probability of the sod dying is very high due to the dry winter season, and the difficulty in maintaining the sod where irrigation is not available.
2. The pond slope areas on the north and south sides of Ponds 3 and 4, (where we are proposing to delay the sodding), are adjacent to future phases in which final grading of the lots has not occurred. Adjustments may be needed to the pond slopes when these future phases are constructed.

Per the attached sketch, we propose that the areas most likely to erode (hatched) be sodded at this time, as part of the construction for Phase 5. These areas include:

1. All pond slopes adjacent to Phase 5.
2. Existing headwall and flow dissipator areas where existing storm drainage outfall occurs.
3. All retention pond berms and side slopes at discharge structures.
4. Retention pond and roadway side slopes between Retention Pond No. 4 and existing Lost Lake, where future roadway crossing was constructed.
5. All berm and side slopes at the discharge pond adjacent to Lost Lake.



recycled paper

Mr. Gary Gant
December 18, 1998
Page 2

We understand that all pond side slopes are to be sodded per our Engineering Plans and St. Johns River Water Management District (SJRWMD) permits, in which we are in agreement; however, we would request that the northern edges of Ponds 2, 3, and 4, and southern edges of Ponds 3 and 4 be sodded at a later date closer to the rainy season, or at time of construction with future Phases 6, 7, etc.

It is our understanding that you will discuss this matter with your supervisor. Please notify us as to the acceptance or denial of this proposal, so that we may have the Contractor proceed with the sodding.

If you have any questions regarding this submittal, please don't hesitate to contact us. Happy Holidays!

Sincerely,



J. Brett Markovitz
Senior Design Technician

Enclosure

Cc: Hamp Conley, Greater Construction Via Fax: (407) 862-0057

A:\G6765.07\jbm12-17.ltr:ss

 = Proposed SOD AREAS w/ phase 5

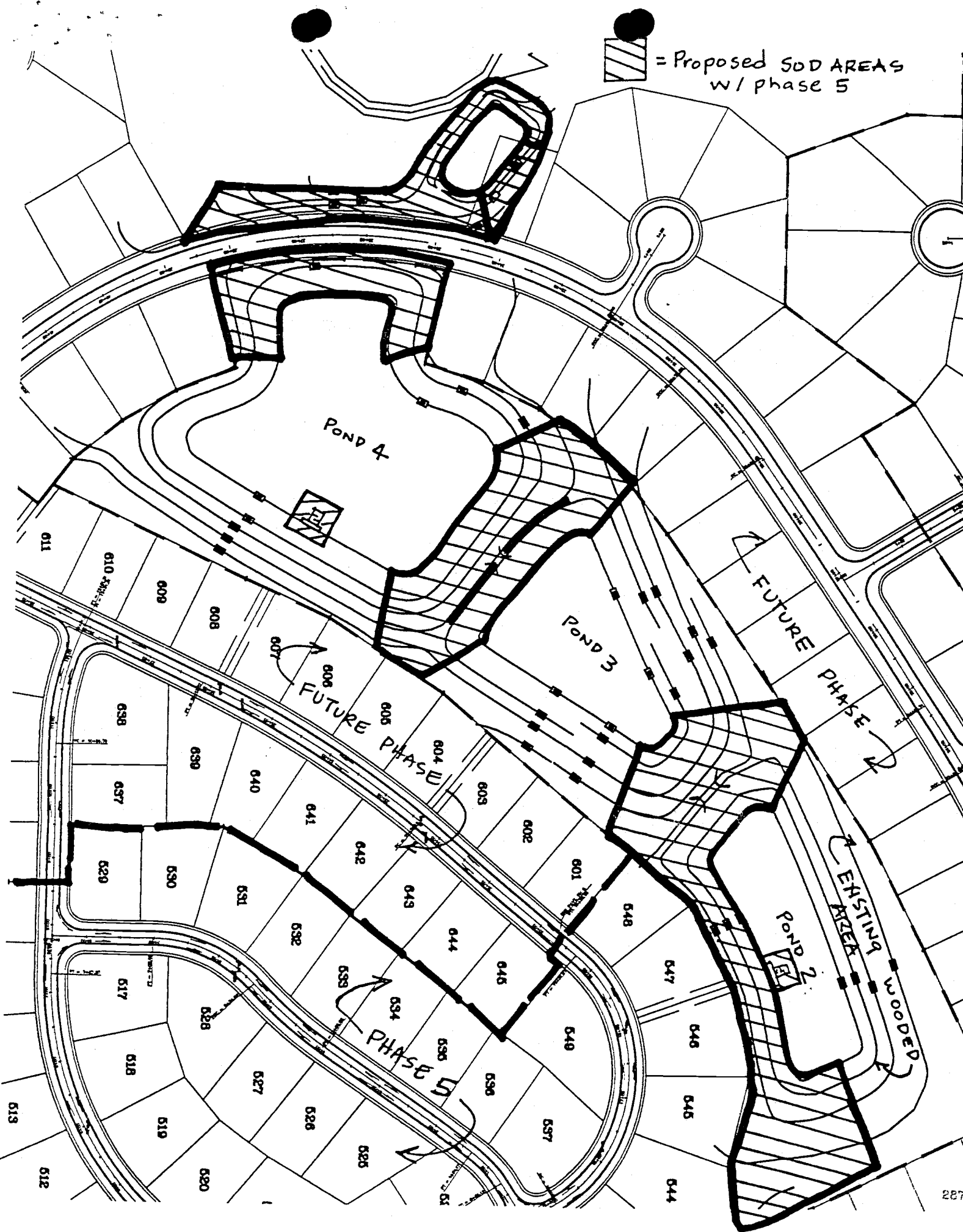

RESOURCE MANAGEMENT COMPLIANCE ROUTING SHEET

1997

Application Number: 4-069-0276AM2-ERP Date : 12/29/98
Date Received: 12/28/98 Appl. Received: 6/ 2/97
Date Issued: 9/ 9/97 Related Permit: 4-069-0276
Mail Type: COMPLIANCE INFORMATION F.O.R.:
Project Name: GREATER PINES, PHASES 5-7

* Name Job Title Office *

* FOR COUNTY COMPLIANCE COORDINATORS INFORMATION ONLY *
* THIS COMPLIANCE INFORMATION HAS BEEN RECEIVED *
* CONTACT YOUR COMPLIANCE COORD. FOR MORE INFO *

MARY BRADHAM COMPLIANCE MANAGER ORL

WILLIAM CARLIE COMPLIANCE MANAGER ORL

GENERAL COUNSEL:

Comments:

LETTER

Copied and Routed By: CA on 12/29
MAIL ROUTED FROM: ORL PROCESSED BY: SA

December 23, 1998

Mr. Bill Carlie
St. Johns River Water Management District
618 E. South Street
Orlando, Florida 32801

RE: Construction Completion – Greater Pines Phase 5
SJRWMD Permit No. 4-069-0276M2-ERP
CPH Job No. G6765.07

RECEIVED

DEC 28 1998

4-069-0276 M2
ERP

Dear Bill:

Our Client, Greater Construction Corporation, and their Contractor, are nearing completion of the utility, roadway, and storm system infrastructure to serve Phase 5 of Greater Pines. As part of the construction of Phase 5 of Greater Pines, three dry retention/detention ponds and the system outfall have been constructed. Phases 6 and 7 of Greater Pines have not yet been built.

The approved Engineering Plans for Greater Pines Phase 5-7 call for sodding of the pond side slopes for all three ponds. The total sodding required for all three ponds and to serve all three phases permitted is 55,700 SY.

Our Client has asked us to investigate the possibility of sodding only those portions of the ponds necessary to serve Phase 5 alone. Greater is hesitant to install all of the sod to serve all three phases for three reasons:

1. It is now the end of December and this is usually a relatively dry period and sod placed during this time will require extensive watering to ensure its survival.
2. Final grading work has not been completed on Phase 6 of Greater Pines, and this final grading may affect the pond side slopes and, thus, kill any sod located in the areas adjacent to the Phase 6 construction.
3. The sod cost for the full 55,700 SY is approximately \$70,000 and if substantial portions of the sod do not survive due to the weather or subsequent construction of Phases 6 and 7, the cost of that sod would be wasted.

The attached sketch shows those areas that we feel need to be sodded to serve Phase 5 alone. The area is approximately 30,000 SY.

We inquired of Lake County as to whether they would accept the Phase 5 stormwater system as complete, with the sodding limited to that shown on the attached. Their verbal response was to check with the Water Management District to ensure that the District did not have any problems with this, more limited, sodding program. We have reviewed the conditions of issuance for Permit No. 4-069-0276M2-ERP, and find only one condition that might speak to this issue at all.

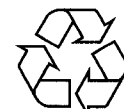

Mr. Bill Carlie
December 23, 1998
Page 2

That is Condition No. 5, which speaks to the need for stabilization measures for erosion and sedimentation control on disturbed areas. It is the Developer's intent to leave in-place silt fences and other sedimentation and erosion control measures on the future phases, so as to reduce the amount of eroded material, both reaching the retention ponds and that which would be windborne throughout the development, affecting the house construction of Phase 5 and the existing homes in Phases 1 through 4.

Please review the above and the attached drawing and let us know, in writing, whether this more limited sodding program to serve Phase 5 alone would be acceptable to the District. Please note that long-term, once Phases 6 and 7 are constructed, full grassing of all the retention pond areas, in accordance with the requirements of the approved Engineering Plans is proposed. This is a request that some portion of that full grassing measures be delayed until the construction of the future phases make it necessary.

Please call if you have any questions concerning the above.

Sincerely,

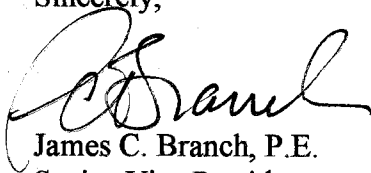

James C. Branch, P.E.
Senior Vice President

Cc: Greater Construction, Attn: Hamp Conley (w/enclosures)

December 18, 1998

Mr. Gary Gant, Engineering Inspector
Lake County Public Services
123 N. Sinclair Avenue
Tavares, Florida 32778

DUPLICATE
FILE COPY

VIA FACSIMILE (Total of 3 Pages) to: (352) 343-9596, With Original to Follow by Mail

Re: Greater Pines Phase 5 – Retention Pond Sodding
CPH Job No. G6765.07

Dear Gary:

Based on our previous telephone conversation on December 17, 1998, we are proposing at this time that only a portion of Ponds No. 2, 3, and 4 be sodded, and the sodding of the remaining areas be delayed until future adjacent phases are constructed. Our concern in sodding the entire pond is two-fold.

1. The probability of the sod dying is very high due to the dry winter season, and the difficulty in maintaining the sod where irrigation is not available.
2. The pond slope areas on the north and south sides of Ponds 3 and 4, (where we are proposing to delay the sodding), are adjacent to future phases in which final grading of the lots has not occurred. Adjustments may be needed to the pond slopes when these future phases are constructed.

Per the attached sketch, we propose that the areas most likely to erode (hatched) be sodded at this time, as part of the construction for Phase 5. These areas include:

1. All pond slopes adjacent to Phase 5.
2. Existing headwall and flow dissipator areas where existing storm drainage outfall occurs.
3. All retention pond berms and side slopes at discharge structures.
4. Retention pond and roadway side slopes between Retention Pond No. 4 and existing Lost Lake, where future roadway crossing was constructed.
5. All berm and side slopes at the discharge pond adjacent to Lost Lake.



recycled paper

Mr. Gary Gant
December 18, 1998
Page 2

We understand that all pond side slopes are to be sodded per our Engineering Plans and St. Johns River Water Management District (SJRWMD) permits, in which we are in agreement; however, we would request that the northern edges of Ponds 2, 3, and 4, and southern edges of Ponds 3 and 4 be sodded at a later date closer to the rainy season, or at time of construction with future Phases 6, 7, etc.

It is our understanding that you will discuss this matter with your supervisor. Please notify us as to the acceptance or denial of this proposal, so that we may have the Contractor proceed with the sodding.

If you have any questions regarding this submittal, please don't hesitate to contact us. Happy Holidays!

Sincerely,



J. Brett Markovitz
Senior Design Technician

Enclosure

Cc: Hamp Conley, Greater Construction Via Fax: (407) 862-0057

A:\G6765.07\jbm12-17.ltr:ss



= Proposed SOD AREAS
w/ phase 5

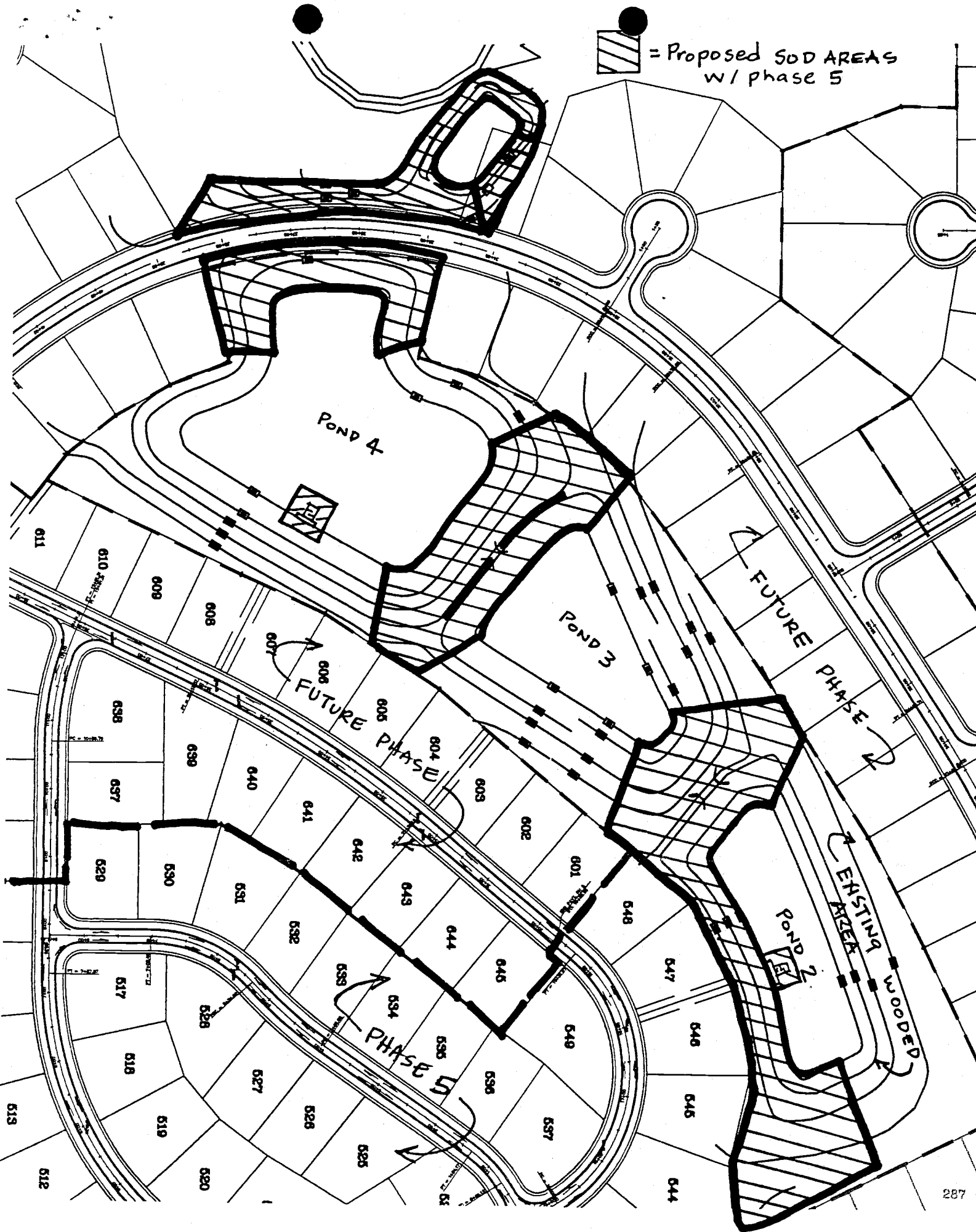

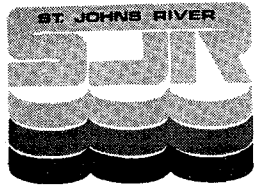

**WATER
MANAGEMENT
DISTRICT**

October 3, 1997

POST OFFICE BOX 1429

PALATKA, FLORIDA 32178-1429

TELEPHONE 904-329-4500

SUNCOM 904-880-4500

TDD 904-329-4450

TDD SUNCOM 860-4450

FAX (Executive) 329-4125

(Legal) 329-4485

(Permitting) 329-4315

(Administration/Finance) 329-4508

SERVICE CENTERS

618 E. South Street
Orlando, Florida 32801
407-897-4300
TDD 407-897-5960

7775 Baymeadows Way
Suite 102
Jacksonville, Florida 32256
904-730-6270
TDD 904-448-7900

PERMITTING:
305 East Drive
Melbourne, Florida 32904
407-984-4940
TDD 407-722-5368

OPERATIONS:
2133 N. Wickham Road
Melbourne, Florida 32935-8109
407-752-3100
TDD 407-752-3102

Greater Construction Corp.
ATTN: Hampton P. Conley
1105 Kensington Park Drive
Altamonte Springs, FL 32714

Re: Greater Pines, Phases 5-7; Permit No. 4-069-0276M2-ERP
(Please reference the above number on any submittal)

Dear Mr. Conley:

The District issued your organization a permit for the above-referenced project on September 9, 1997. In order to avoid being subjected to civil penalties, **read carefully the conditions that are part of your permit**, and comply with the requirements of those conditions.

Also, we would like to offer our assistance in assuring that the project is constructed in accordance with the District's permit. We can offer our assistance by attending any pre-construction meetings that may be scheduled for the project. We ask that you notify us at least 10 days prior to the scheduled meeting. This will make it possible for us to obtain needed information concerning your permit. This pre-construction meeting can be one that you schedule with other individuals, or it can be a separate meeting with only District staff.

If your project involves the creation of a mitigation area, staff are willing to meet on-site during the construction of the mitigation area. Such a meeting for site specific condition evaluation may provide assistance that may ensure compliance upon completion of the mitigation construction.

Please call me at 407/897-4312, for notice of any pre-construction meetings, if you would like to arrange for a meeting with District staff, if you have not received a copy of your permit, or if you have questions concerning your permit. Thank you for your assistance.

Sincerely,

Karen B. Davis
Karen B. Davis, C.P.S., Executive Staff Assistant
Department of Resource Management

KBD:sa

cc: PDS-CI, PDS-Orlando, David Dewey, William Carlie, Rod Pakzadian, Dave Eunice

Conklin, Porter & Holmes-Engineers, Inc., ATTN: James C. Branch, PE
101 N. Woodland Blvd., Suite 100, Deland, FL 32720

William M. Segal, CHAIRMAN
MAITLAND

Dan Roach, VICE CHAIRMAN
FERNANDINA BEACH

James T. Swann, TREASURER
COCOA

Otis Mason, SECRETARY
ST. AUGUSTINE

Kathy Chinoy
JACKSONVILLE

Griffin A. Greene
VERO BEACH

James H. Williams
OCALA

Patricia T. Harden
SANFORD

Reid Hughes
DAYTONA BEACH

97

