



LAKE COUNTY FLORIDA CONTRACT PLANS

INDEX OF ROADWAY PLANS

SHEET NO.	SHEET DESCRIPTION	
1	KEY SHEET	
2-4	DRAINAGE MAP	
5	BASIN AREAS	
6-11	STRUCTURE DATA	
12-17	SUMMARY OF DRAINAGE STRUCTURES	
18-21	TYPICAL SECTIONS	
22	GENERAL NOTES	
23	PROJECT LAYOUT	
24-27 28-29	PLAN SHEETS	
58-88	PROFILE SHEETS	
89-91	PLAN AND PROFILE SHEETS	
92-94	INTERSECTION DETAILS	
95	DRAINAGE DETAILS	
96-99	POND DETAILS	
100	NOT USED	
101-103	101-116 111-112	POND CROSS SECTIONS
117-118	NOT USED	
119-202 135-149	CROSS SECTIONS	
204	203-208	SWPPP
		TRAFFIC CONTROL PLAN
		UTILITY ADJUSTMENTS
		GENERAL NOTES
		TABULATION OF QUANTITIES
		SIGNING AND PAVEMENT MARKING PLANS

GOVERNING STANDARDS AND SPECIFICATIONS:
FLORIDA DEPARTMENT OF TRANSPORTATION,
DESIGN STANDARDS DATED JANUARY 2008,
AND STANDARD SPECIFICATIONS FOR ROAD AND
BRIDGE CONSTRUCTION DATED 2007,
AS AMENDED BY CONTRACT DOCUMENTS.

APPLICABLE DESIGN STANDARDS MODIFICATIONS: 01-01-09

For Design Standards Modifications click on
"Design Standards" at the following web site:
<http://www.dot.state.fl.us/rddesign/>

**FINAL PERMITTED
PLANS**

DATE 9/27/09
INITIAL SO

HARTWOOD MARSH ROAD - PHASE II FROM SOUTH HANCOCK TO ORANGE COUNTY LINE

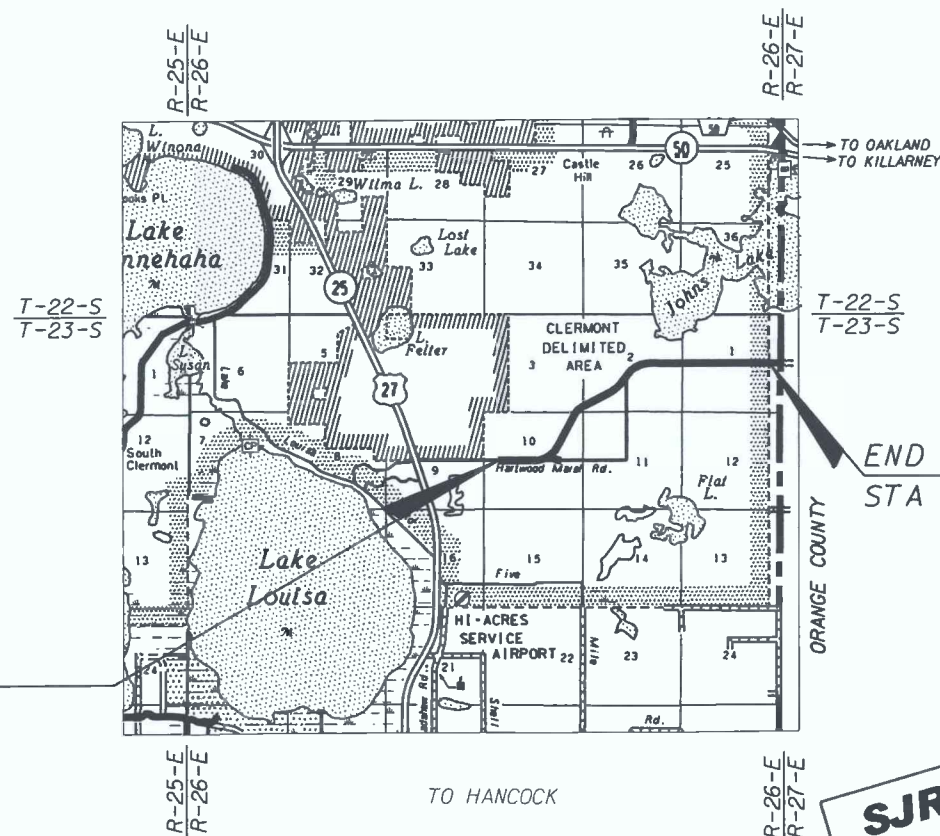

BEGIN PROJECT
STA 155+50.00

END PROJECT
STA 322+98.06

**SJRWMD RAI SUBMITTAL
MAY 2009**

PROJECT LENGTH IS BASED ON E OF CONSTRUCTION

LENGTH OF PROJECT		
	LINEAR FEET	MILES
ROADWAY	16,748.06	3.171
BRIDGES	0.00	0.000
NET LENGTH OF PROJECT	16,748.06	3.171
EXCEPTIONS	0.00	0.000
GROSS LENGTH OF PROJECT	16,748.06	3.171

LAKE COUNTY PROJECT MANAGER: THOMAS MCCANN, P.E.

KEY SHEET REVISIONS		
DATE	BY	DESCRIPTION

ROADWAY PLANS
ENGINEER OF RECORD: MICHAEL VERNON O'DONNELL, P.E.

P.E. NO. 67442

FISCAL YEAR	SHEET NO.
09	1

PROJECT LOCATION

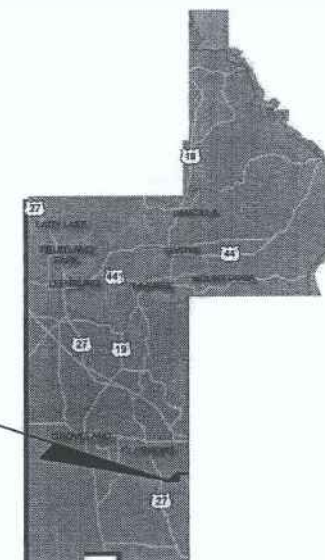

114354-2

COUNTY MANAGER:
CINDY HALL

COUNTY COMMISSIONERS:
JENNIFER HILL
ELAINE RENICK
JIMMY CONNER
LINDA STEWART
WELTON G. CADWELL

ROADWAY SHOP DRAWINGS
TO BE SUBMITTED TO:

MICHAEL VERNON O'DONNELL, PE
HNTB CORPORATION
300 PRIMERA BOULEVARD, SUITE 200
LAKE MARY, FLORIDA 32746

PLANS PREPARED BY:

HNTB

HNTB CORPORATION
300 PRIMERA BOULEVARD, SUITE 200
LAKE MARY, FL 32746
PHONE: (407) 805-0355
FAX: 407-805-0227
CERT. OF AUTH. NO. 6500
VENDOR NO.: V98567003

NOTE: THE SCALE OF THESE PLANS MAY
HAVE CHANGED DUE TO REPRODUCTION.

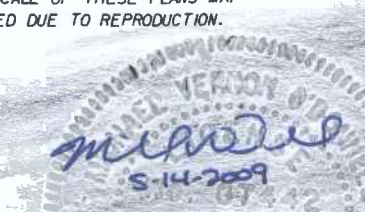

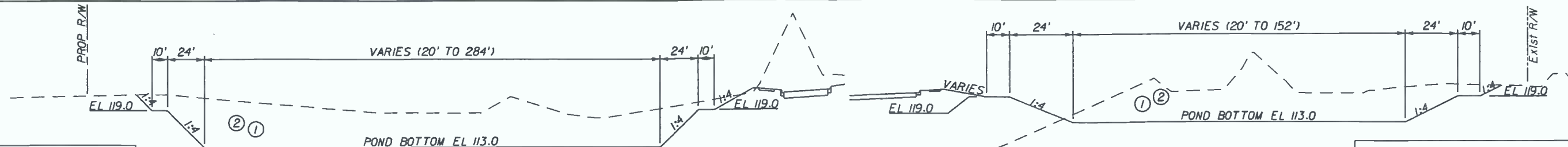

POND 3A	
① 25 YR DHW/24 HR	EL. 116.50
② 25 YR DHW/96 HR	EL. 118.23

POND 3B	
① 25 YR DHW/24 HR	EL. 116.50
② 25 YR DHW/96 HR	EL. 118.23

- NOTES:
1. AVERAGE ESTIMATED SEASONAL HIGH WATER TABLE ELEVATION ∇ (EL 103.80)
 2. AVERAGE ENCOUNTERED WATER TABLE ∇ (IGNE)
 3. APPROXIMATE LOCATION OF THE BORING \odot
 4. PRIOR TO SODDING THE POND, REMOVE ALL CONSTRUCTION MATERIAL THAT MAY HAVE DEPOSITED IN THE POND. RAKE AND LOOSEN POND BOTTOM FOR OPTIMAL INFILTRATION.
 5. MUCK GROWN SOD SHOULD NOT BE USED IN THE POND BOTTOM.

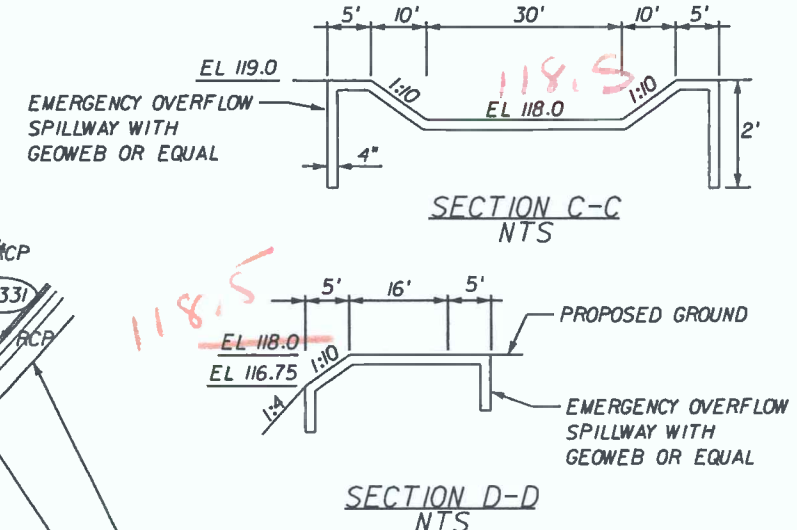
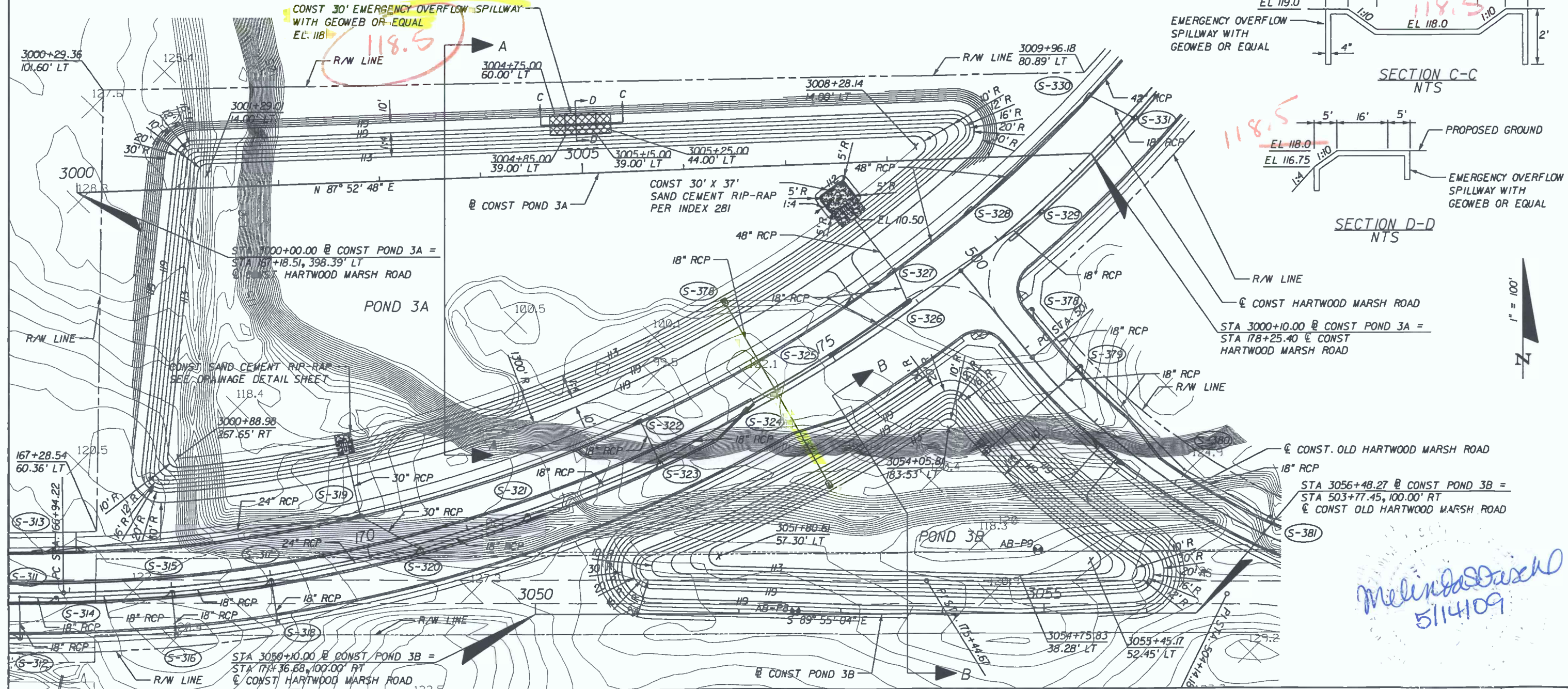

Melinda S. Fischl
5114109

REVISIONS	
DATE	DESCRIPTION

HNTB
HNTB CORPORATION
300 PRIMERA BLVD,
SUITE 200
LAKE MARY, FL 32746
(407) 805-0355
CERT. OF AUTH. NO. 6500

ENGINEER OF RECORD: MELINDA S. FISCHL, P.E.
FL. REGISTRATION NO. 68406

LAKE COUNTY
FLORIDA

HARTWOOD MARSH
ROAD - PHASE II

POND DETAIL SHEET
PONDS 3A & 3B

SHEET NO.
96A

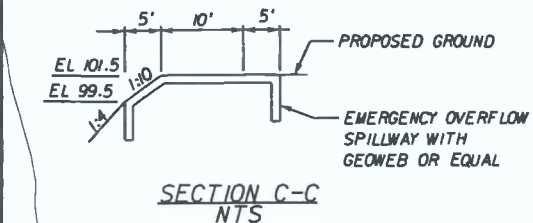
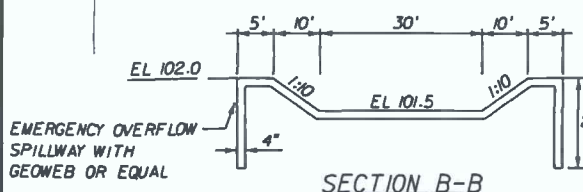
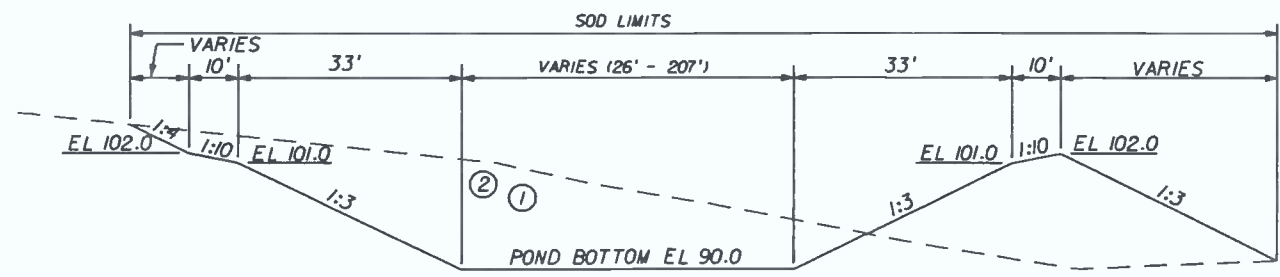
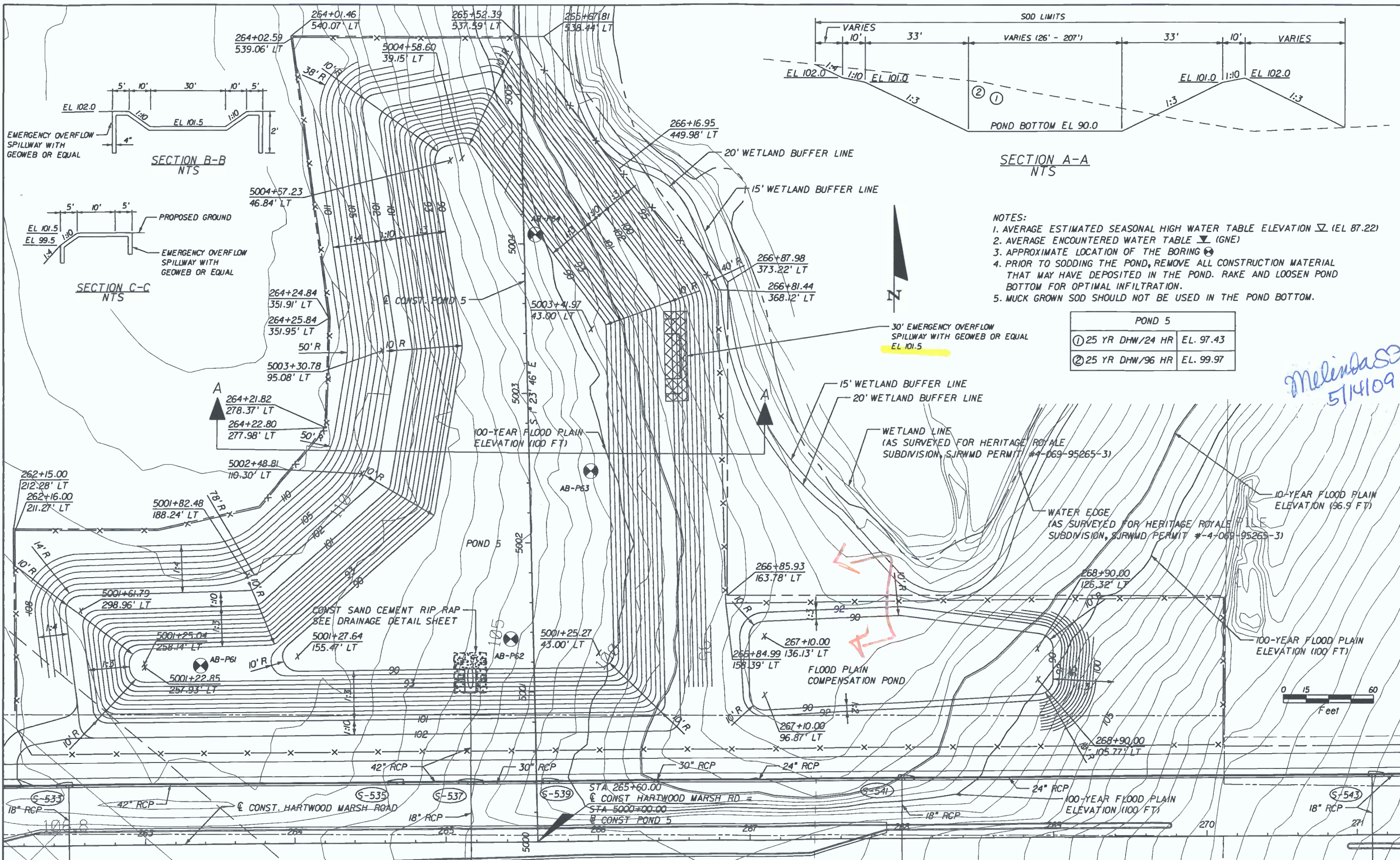

SECTION A-A
NTS

SECTION B-B
NTS

SECTION C-C
NTS

NOTES:

1. AVERAGE ESTIMATED SEASONAL HIGH WATER TABLE ELEVATION ∇ (EL 87.22)
2. AVERAGE ENCOUNTERED WATER TABLE ∇ (GNE)
3. APPROXIMATE LOCATION OF THE BORING \odot
4. PRIOR TO SODDING THE POND, REMOVE ALL CONSTRUCTION MATERIAL THAT MAY HAVE DEPOSITED IN THE POND. RAKE AND LOOSEN POND BOTTOM FOR OPTIMAL INFILTRATION.
5. MUCK GROWN SOD SHOULD NOT BE USED IN THE POND BOTTOM.

POND 5	
① 25 YR DHW/24 HR	EL. 97.43
② 25 YR DHW/96 HR	EL. 99.97

Melinda Fischl
5/14/09

REVISIONS	
DATE	DESCRIPTION

HNTB
HNTB CORPORATION
300 PRIMERA BLVD,
SUITE 200
LAKE MARY, FL 32746
(407) 805-0355
CERT. OF AUTH. NO. 6500

ENGINEER OF RECORD: MELINDA S. FISCHL, P.E.
FL. REGISTRATION NO. 68406

LAKE COUNTY
FLORIDA

**HARTWOOD MARSH
ROAD - PHASE II**

**POND DETAIL SHEET
POND 5**

SHEET NO.
97

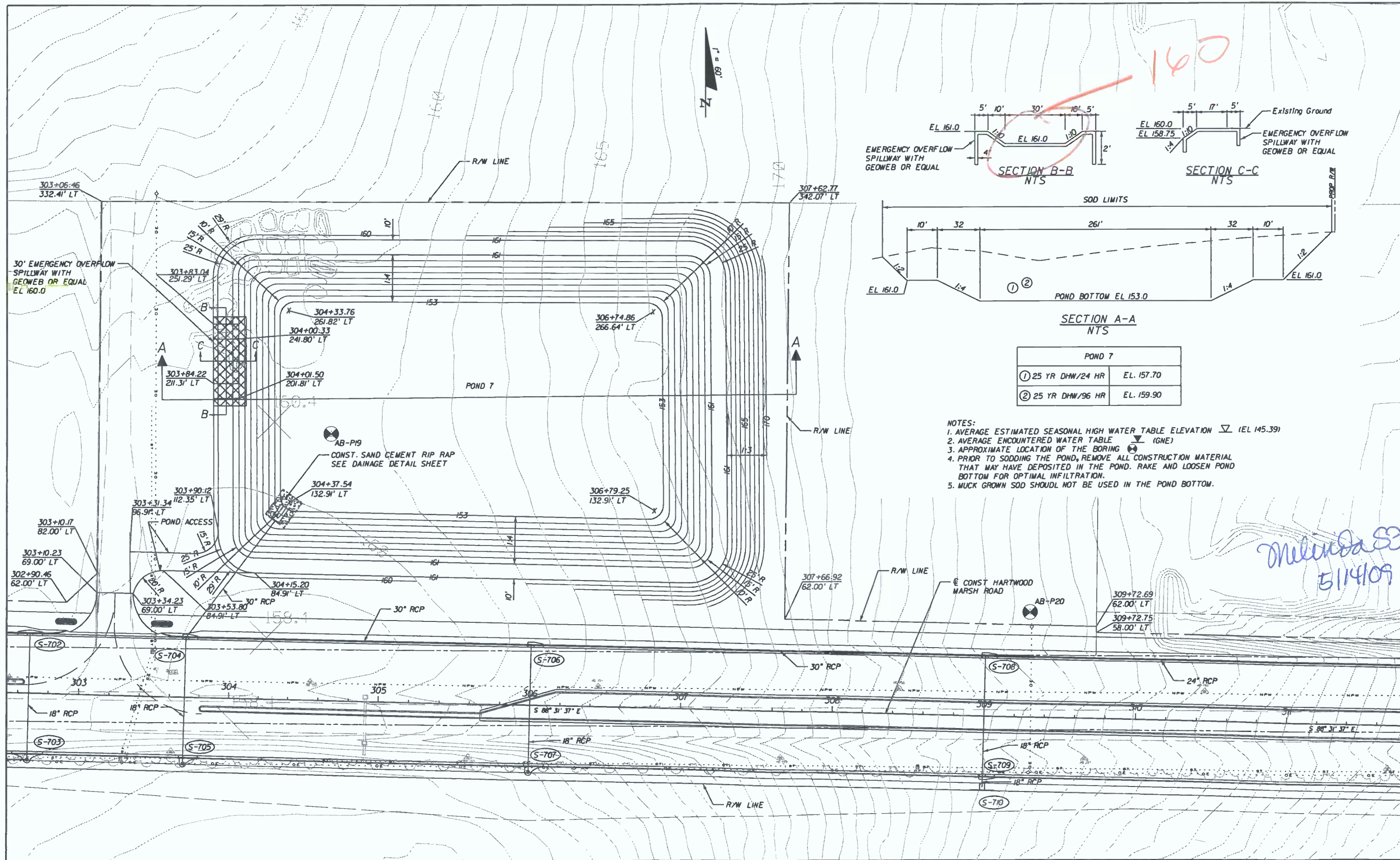

140

POND 7	
① 25 YR DHW/24 HR	EL. 157.70
② 25 YR DHW/96 HR	EL. 159.90

- NOTES:
1. AVERAGE ESTIMATED SEASONAL HIGH WATER TABLE ELEVATION ∇ (EL 145.39)
 2. AVERAGE ENCOUNTERED WATER TABLE ∇ (GNE)
 3. APPROXIMATE LOCATION OF THE BORING \odot
 4. PRIOR TO SODDING THE POND, REMOVE ALL CONSTRUCTION MATERIAL THAT MAY HAVE DEPOSITED IN THE POND. RAKE AND LOOSEN POND BOTTOM FOR OPTIMAL INFILTRATION.
 5. MUCK GROWN SOD SHOULD NOT BE USED IN THE POND BOTTOM.

Melinda Strick
5/14/09

REVISIONS	
DATE	DESCRIPTION

HNTB
 HNTB CORPORATION
 300 PRIMERA BLVD,
 SUITE 200
 LAKE MARY, FL 32746
 (407) 805-0355
 CERT. OF AUTH. NO. 6500

ENGINEER OF RECORD: MELINDA S. FISCHL, P.E.
 FL. REGISTRATION NO. 68406

LAKE COUNTY
 FLORIDA

**HARTWOOD MARSH
 ROAD - PHASE II**

**POND DETAIL SHEET
 POND 7**

SHEET NO.
 99