

COMPONENTS OF CONTRACT PLANS SET



LAKE COUNTY
FLORIDA

CONTRACT PLANS

PROJECT LOCATION

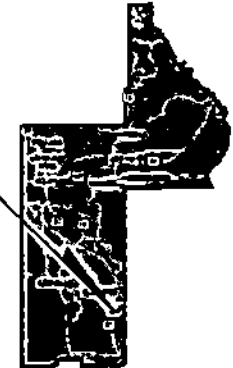

INDEX OF ROADWAY PLANS

SHEET NO	SHEET DESCRIPTION
1	KEY SHEET
2-4	DRAINAGE MAP
5-9	TYPICAL SECTIONS
10	SUMMARY OF QUANTITIES
11-13	SUMMARY OF DRAINAGE STRUCTURES
14	PROJECT LAYOUT AND GENERAL NOTES
15-17	REFERENCE POINTS
18-28	PLAN SHEETS
29-39	PROFILE SHEETS
40-41	PLAN AND PROFILE SHEETS
42-45	INTERSECTION DETAILS
46-67A	DRAINAGE STRUCTURE SHEETS
68-80	POND OUTFALL SHEETS
81-92	POND DETAILS
93-99	POND CROSS SECTIONS
100	STORM WATER POLLUTION PREVENTION PLAN
101-155	CROSS SECTIONS
156-173	TRAFFIC CONTROL PLANS
174-179	UTILITY ADJUSTMENTS
5-1	SIGNING & PAVEMENT MARKING GENERAL NOTES
5-2 - 5-3	SIGNING & PAVEMENT MARKING TABULATION OF QUANTITIES
5-4 - 5-16	SIGNING & PAVEMENT MARKING PLAN SHEETS
7-1	SIGNALIZATION TABULATION OF QUANTITIES
7-2	SIGNALIZATION GENERAL NOTES
7-3 - 7-5	SIGNALIZATION PLAN SHEETS
7-6	CONCRETE STRAIN POLE SCHEDULE

HARTWOOD MARSH ROAD - PHASE 1
FROM SR 25 (US 27) TO HANCOCK ROAD

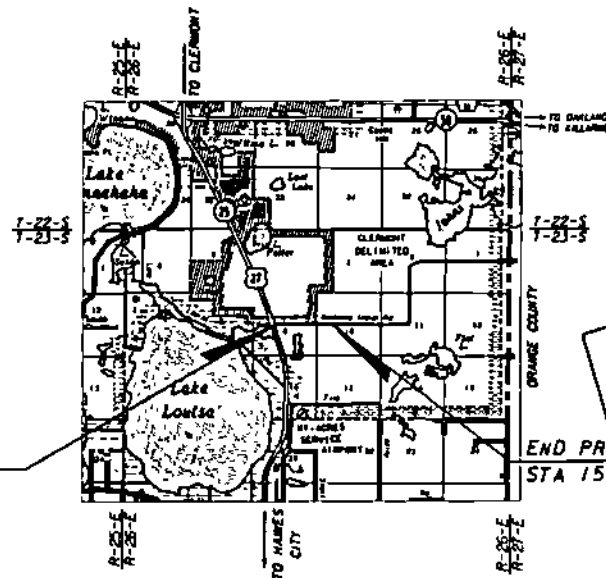

**PERMIT
SUBMITTAL
12/04/2007**

COUNTY MANAGER
CINDY HALL

COUNTY COMMISSIONERS
CATHERINE HANSON
DEBBIE STVENDER
JENNIFER HILL
ROBERT POOL
WELTON GADWELL

ROADWAY SHOP DRAWINGS
TO BE SUBMITTED TO:

KAREN H VAN DEN AORT, PE
HNTB CORPORATION
300 PRIMAVERA BOULEVARD, SUITE 200
LAKE MARY, FLORIDA 32746

PLANS PREPARED BY

HNTB

HNTB CORPORATION
300 PRIMAVERA BOULEVARD, SUITE 200
LAKE MARY, FL 32746
PHONE: 1-800-825-0335
FAX: 407-805-0227
CERT. OF AUTH. NO. 6550
VENDOR NO. : Y98567003

NOTE: THE SCALE OF THESE PLANS MAY
HAVE CHANGED DUE TO REPRODUCTION

GOVERNING STANDARDS AND SPECIFICATIONS,
FLORIDA DEPARTMENT OF TRANSPORTATION,
DESIGN STANDARDS DATED JANUARY 2006,
AND STANDARD SPECIFICATIONS FOR ROAD AND
BRIDGE CONSTRUCTION DATED 2007,
AS AMENDED BY CONTRACT DOCUMENTS

APPLICABLE DESIGN STANDARDS MODIFICATIONS: 07-01-07

For Design Standards modifications refer to
"Design Standards" of the following web site:
http://www.dot.state.fl.us/TS/060607/

PROJECT LENGTH IS BASED ON E OF CONSTRUCTION

LENGTH OF PROJECT		
	LINEAR FEET	MILES
ROADWAY	5238.80	0.992
BRIDGES	0.00	0.000
NET LENGTH OF PROJECT	5238.80	0.992
EXCEPTIONS	0.00	0.000
GROSS LENGTH OF PROJECT	5238.80	0.992

KEY SHEET REVISIONS	
DATE	DESCRIPTION

ROADWAY PLANS
ENGINEER OF RECORD: KAREN H VAN DEN AORT, PE

P.E. NO. 44794

FISCAL YEAR	SHEET NO
07	1

LAKE COUNTY PROJECT MANAGER: THOMAS MCCANN, PE

NOTICE: THE OFFICIAL RECORD OF THIS SHEET IS THE PRINTED COPY WHICH WILL BE MAINTAINED BY THE COUNTY ENGINEER.