

FILENAME: S:\ROAD PLANS\Citrus Grove Rd Phase 5 east of TP - Engineering\ESplanade Landscape Plans\CG5 Esplanade Landscape LCPW.dwg PLOTTED BY: Nunez, Osvaldo PLOTTED: 2/4/2022 11:52 AM

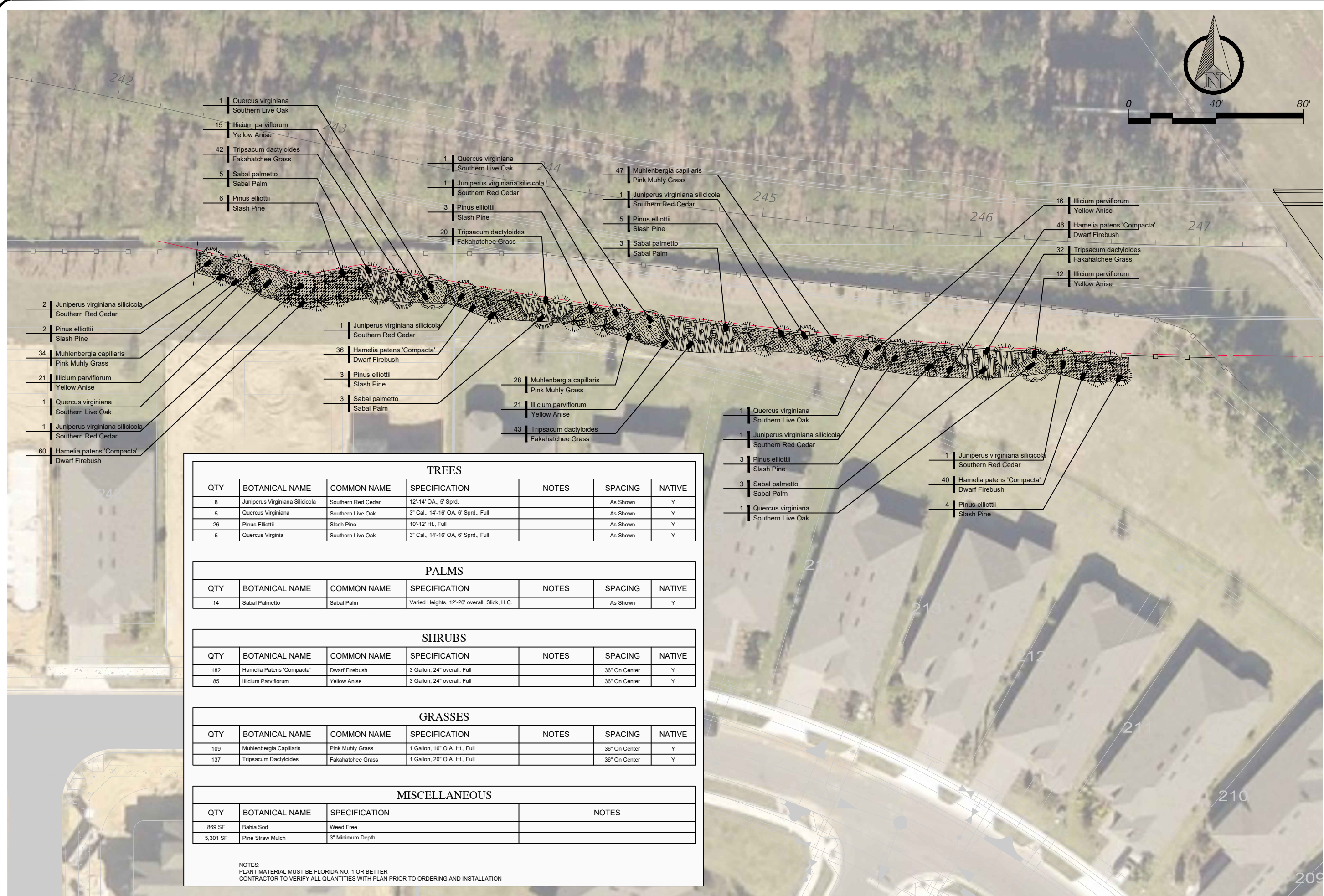

TREES						
QTY	BOTANICAL NAME	COMMON NAME	SPECIFICATION	NOTES	SPACING	NATIVE
8	Juniperus Virginiana Silicicola	Southern Red Cedar	12'-14" OA., 5' Sprd.		As Shown	Y
5	Quercus Virginiana	Southern Live Oak	3" Cal., 14'-16" OA, 6' Sprd., Full		As Shown	Y
26	Pinus Elliottii	Slash Pine	10'-12' Ht., Full		As Shown	Y
5	Quercus Virginia	Southern Live Oak	3" Cal., 14'-16" OA, 6' Sprd., Full		As Shown	Y

PALMS						
QTY	BOTANICAL NAME	COMMON NAME	SPECIFICATION	NOTES	SPACING	NATIVE
14	Sabal Palmetto	Sabal Palm	Varied Heights, 12'-20' overall, Slick, H.C.		As Shown	Y

SHRUBS						
QTY	BOTANICAL NAME	COMMON NAME	SPECIFICATION	NOTES	SPACING	NATIVE
182	Hamelia Patens 'Compacta'	Dwarf Firebush	3 Gallon, 24" overall. Full		36" On Center	Y
85	Illicium Parviflorum	Yellow Anise	3 Gallon, 24" overall. Full		36" On Center	Y

GRASSES						
QTY	BOTANICAL NAME	COMMON NAME	SPECIFICATION	NOTES	SPACING	NATIVE
109	Muhlenbergia Capillaris	Pink Muhly Grass	1 Gallon, 16" O.A. HT., Full		36" On Center	Y
137	Tripsacum Dactyloides	Fakahatchee Grass	1 Gallon, 20" O.A. HT., Full		36" On Center	Y

MISCELLANEOUS			
QTY	BOTANICAL NAME	SPECIFICATION	NOTES
869 SF	Bahia Sod	Weed Free	
5,301 SF	Pine Straw Mulch	3" Minimum Depth	

NOTES:  
 PLANT MATERIAL MUST BE FLORIDA NO. 1 OR BETTER  
 CONTRACTOR TO VERIFY ALL QUANTITIES WITH PLAN PRIOR TO ORDERING AND INSTALLATION

SIGNATURE \_\_\_\_\_

2/4/2022

DEPARTMENT OF PUBLIC WORKS  
ENGINEERING DIVISION

350 N. SINCLAIR AVE., TAVARES, FLORIDA 32778

REVISION:	DATE	T. - 285	R. - 23E	S. - 18&19	DATE: ##/##/##
SURVEYED: VALUE	DATE: ##/##/##	FIELD BOOK:	DATE: ##/##/##	DESIGNED: DEN	DATE: ##/##/##
DRAWN:	DATE: ##/##/##	APPROVED: # # #	DATE: ##/##/##		

**CITRUS GROVE RD PHASE 5**

**ESPLANADE AT HIGHLAND RANCH**

**LANDSCAPE TYPE & QUANTITIES**

**DRAFT - FOR REVIEW ONLY**

JOB NO.: CITRUS GROVE RD PHASE 5

SHEET: LE - 2