

LAKE COUNTY, FLORIDA



DEPARTMENT OF PUBLIC WORKS
ENGINEERING DIVISION
350 N. SINCLAIR AVE.
TAVARES, FLORIDA 32778

FINANCIAL PROJECT ID 443511-1-58-01
F. A. NO.

INDEX OF SIGNALIZATION PLANS

SHEET NO.	SHEET DESCRIPTION
T-1	KEY SHEET
T-2	SIGNATURE SHEET
T-3	TABULATION OF QUANTITIES
T-4	GENERAL NOTES
T-5	SIGNALIZATION PLAN
T-6 - T-7	SIGNAL DETAILS
T-8	GUIDE SIGN WORKSHEET
T-9	TEMPORARY SIGNAL
T-10	STRAIN POLE SCHEDULE (TO BE INCLUDED AT 90%)
T-11	SOIL BORINGS REPORT (TO BE INCLUDED AT 90%)

SIGNALIZATION PLANS

CR 452 AND CR 44

PROJECT LOCATION

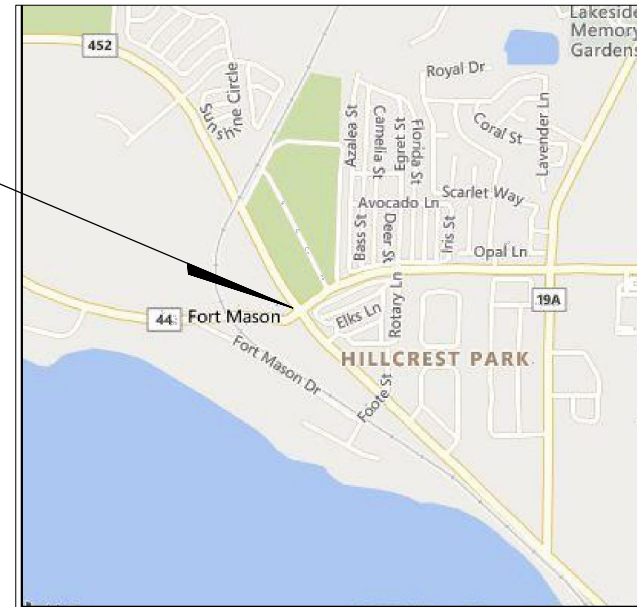

wo: 37830712
DATE: 2/26/2021
REV3
Gonzalo A. Guillen
Engineer II (E.I.) | Major Projects - Central
GGUILL1@DUKE-ENERGY.COM
Office: 407-464-1281 Cell: 407-280-3465

SIGNALIZATION SHOP DRAWINGS
TO BE SUBMITTED TO:
CHRIS J. WALSH, PE No. 57626
Traffic Engineering Data Solutions, Inc.
80 Spring Vista Drive Phone: 386.753.0558
DeBary, FL 32713 Fax: 386.753.0778

PLANS PREPARED BY:
Traffic Engineering Data Solutions, Inc.
80 Spring Vista Drive Phone: 386.753.0558
DeBary, FL 32713 Fax: 386.753.0778

NOTE: THE SCALE OF THESE PLANS MAY
HAVE CHANGED DUE TO REPRODUCTION.

SUBMITTAL: 60%
DATE: SEPTEMBER 2020

SIGNALIZATION PLANS
ENGINEER OF RECORD: CHRIS J. WALSH, P.E.

P.E. NO.: 57626

SHEET
NO.

T-1

THE OFFICIAL RECORD OF THIS SHEET IS THE ELECTRONIC FILE DIGITALLY SIGNED AND SEALED UNDER RULE 61G15-23.004, F.A.C.

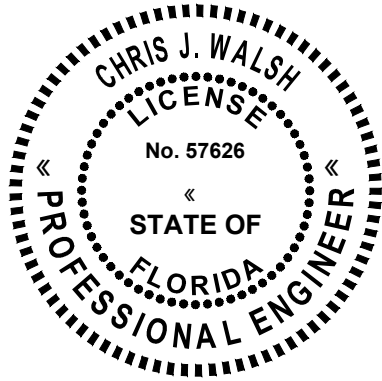

THIS ITEM HAS BEEN DIGITALLY SIGNED AND SEALED BY

ON THE DATE ADJACENT TO THE SEAL

PRINTED COPIES OF THIS DOCUMENT ARE NOT CONSIDERED SIGNED AND SEALED AND THE SIGNATURE MUST BE VERIFIED ON ANY ELECTRONIC COPIES.

TRAFFIC ENGINEERING DATA SOLUTIONS, INC.
80 SPRING VISTA DRIVE
DEBARY, FLORIDA 32713
CHRIS J. WALSH, P.E. NO: 57626

THE ABOVE NAMED PROFESSIONAL ENGINEER SHALL BE RESPONSIBLE FOR THE FOLLOWING SHEETS IN ACCORDANCE WITH RULE 61G15-23.004. F.A.C.

- T-1 KEY SHEET
- T-2 SIGNATURE SHEET
- T-3 TABULATION OF QUANTITIES
- T-4 GENERAL NOTES
- T-5 SIGNALIZATION PLAN
- T-6 - T-7 SIGNAL DETAILS
- T-8 GUIDE SIGN WORKSHEET

THIS ITEM HAS BEEN DIGITALLY SIGNED AND SEALED BY

ON THE DATE ADJACENT TO THE SEAL

PRINTED COPIES OF THIS DOCUMENT ARE NOT CONSIDERED SIGNED AND SEALED AND THE SIGNATURE MUST BE VERIFIED ON ANY ELECTRONIC COPIES.

THE ABOVE NAMED PROFESSIONAL ENGINEER SHALL BE RESPONSIBLE FOR THE FOLLOWING SHEETS IN ACCORDANCE WITH RULE 61G15-23.004. F.A.C.

- T-2 SIGNATURE SHEET
- T-101 SOIL BORING REPORT

THIS ITEM HAS BEEN DIGITALLY SIGNED AND SEALED BY

ON THE DATE ADJACENT TO THE SEAL

PRINTED COPIES OF THIS DOCUMENT ARE NOT CONSIDERED SIGNED AND SEALED AND THE SIGNATURE MUST BE VERIFIED ON ANY ELECTRONIC COPIES.

THE ABOVE NAMED PROFESSIONAL ENGINEER SHALL BE RESPONSIBLE FOR THE FOLLOWING SHEETS IN ACCORDANCE WITH RULE 61G15-23.004. F.A.C.

- T-2 SIGNATURE SHEET
- T-10 STRAIN POLE SCHEDULE

REVISIONS			
DATE	DESCRIPTION	DATE	DESCRIPTION

CHRIS J. WALSH, P.E. PE No. 57626
Traffic Engineering Data Solutions, Inc.
80 Spring Vista Drive Phone: 386.753.0558
DeBary, FL 32713 Fax: 386.753.0778
CERTIFICATION OF AUTHORIZATION # 27392

DEPARTMENT OF PUBLIC WORKS
ENGINEERING DIVISION
350 N. SINCLAIR AVE.
TAVARES, FLORIDA 32778

SIGNATURE SHEET

SHEET NO.
T-2

THE OFFICIAL RECORD OF THIS SHEET IS THE ELECTRONIC FILE DIGITALLY SIGNED AND SEALED UNDER RULE 61G15-23.004, F.A.C.

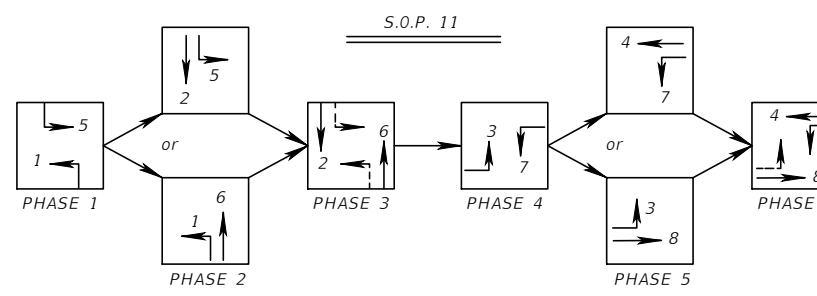
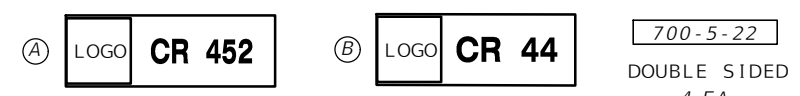
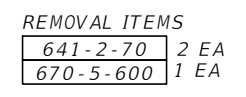
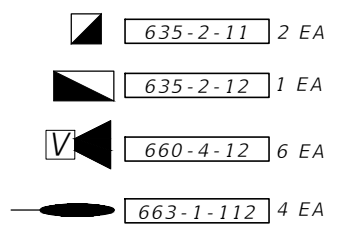
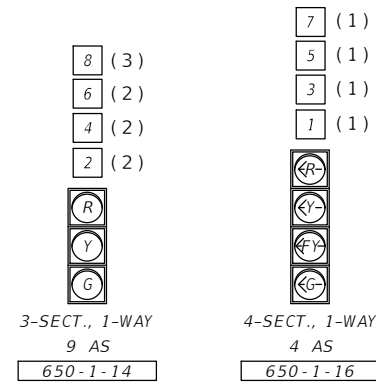

DETECTION ASSIGNMENTS		
DETECTION	DETECTION ZONE	DELAY TIME (SEC)
D1	DZ5	5
	DZ6	
D2	DZ3	5
	DZ8	
D3	DZ1	5
	DZ2	
D4	DZ7	5
	DZ4	

- NOTES:
1. MAJOR ROAD: CR 452
MINOR ROAD: CR 44
 2. FLASHING MODE: YELLOW - MOVEMENT 2 & 6
RED - MOVEMENTS 1, 3, 4, 5, 7 & 8
 3. CONTROLLER TIMINGS AND PHASING

Proposed
50' WOOD POLE,
STA. 13+76, L144

- 630-2-11 25 LF
- 630-2-14 20 LF
- 639-2-111 1 AS
- 639-2-1 20 LF
- 641-2-18 1 EA
- 715-5-31 1 EA

- CONTROLLER
- 630-2-11 20 LF
 - 660-4-11 1 EA
 - 663-1-111 1 EA
 - 670-5-111 1 AS

Existing pole to
remain, sta 13+54,
L 130

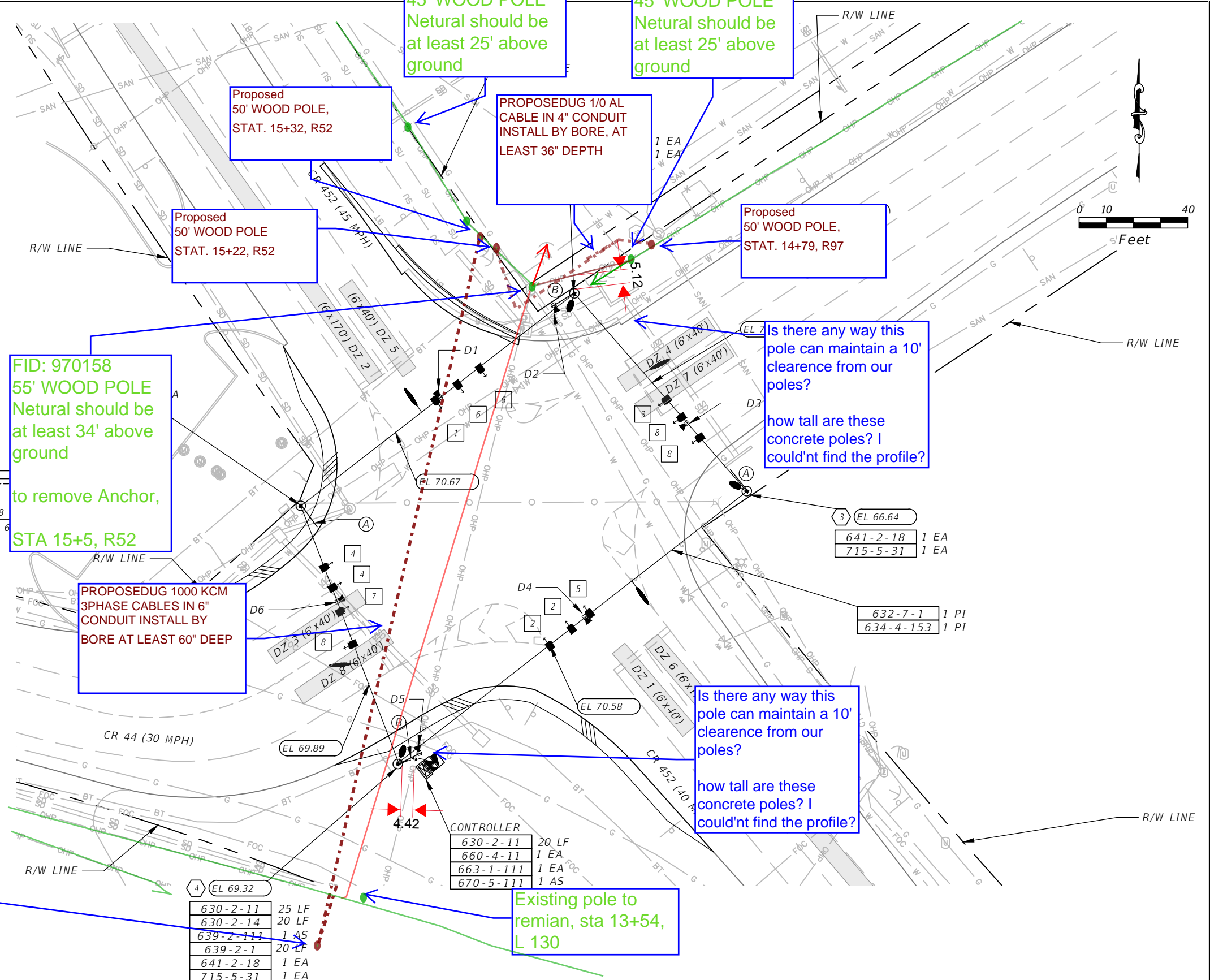

REVISIONS			
DATE	DESCRIPTION	DATE	DESCRIPTION

ALDS
CHRIS J. WALSH P.E. PE No. 57626
Traffic Engineering Data Solutions, Inc.
80 Spring Vista Drive Phone: 386.753.0558
DeBary, FL 32713 Fax: 386.753.0778
CERTIFICATE OF AUTHORIZATION # 27392



DEPARTMENT OF PUBLIC WORKS
ENGINEERING DIVISION
350 N. SINCLAIR AVE.
TAVARES, FLORIDA 32778

SIGNALIZATION PLAN

SHEET NO.
T-5

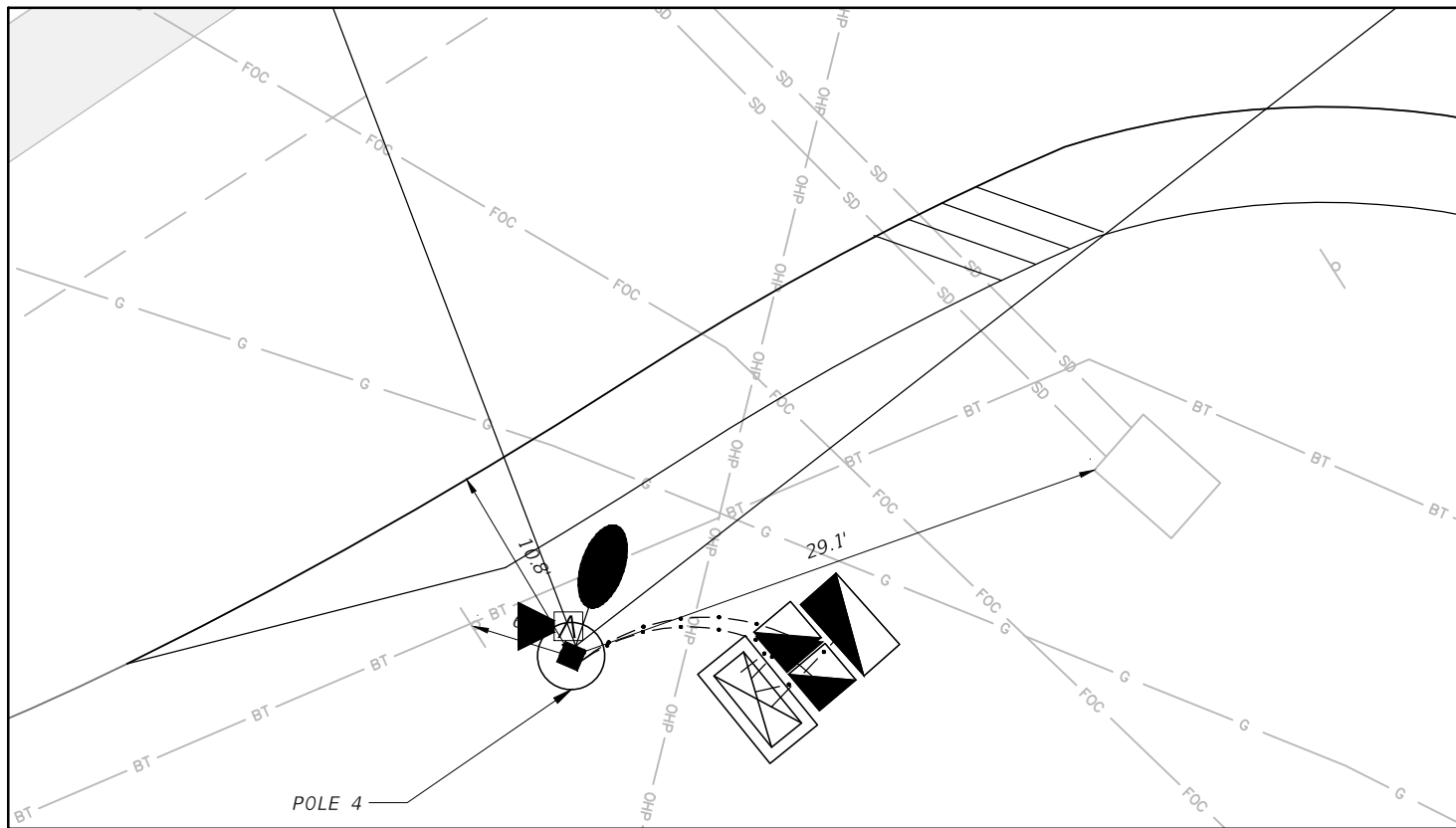
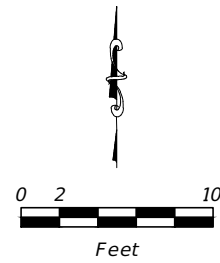
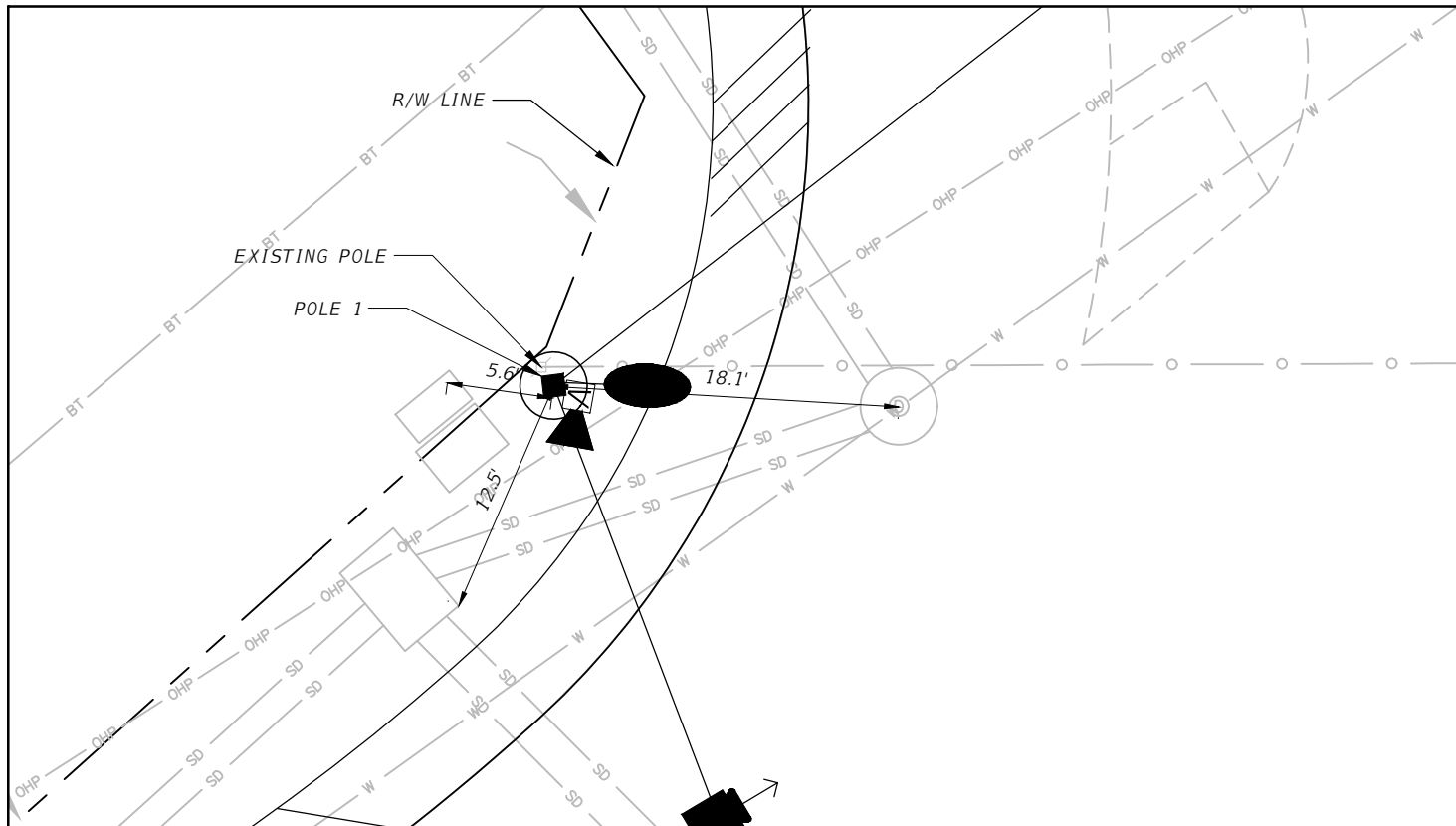

REVISIONS			
DATE	DESCRIPTION	DATE	DESCRIPTION

ALDS
 CHRIS J. WALSH P.E. PE No. 57626
Traffic Engineering Data Solutions, Inc.
 80 Spring Vista Drive Phone: 386.753.0558
 DeBary, FL 32713 Fax: 386.753.0778
 CERTIFICATE OF AUTHORIZATION # 27392



DEPARTMENT OF PUBLIC WORKS
 ENGINEERING DIVISION
 350 N. SINCLAIR AVE.
 TAVARES, FLORIDA 32778

SIGNAL DETAILS

SHEET NO.
 T-6

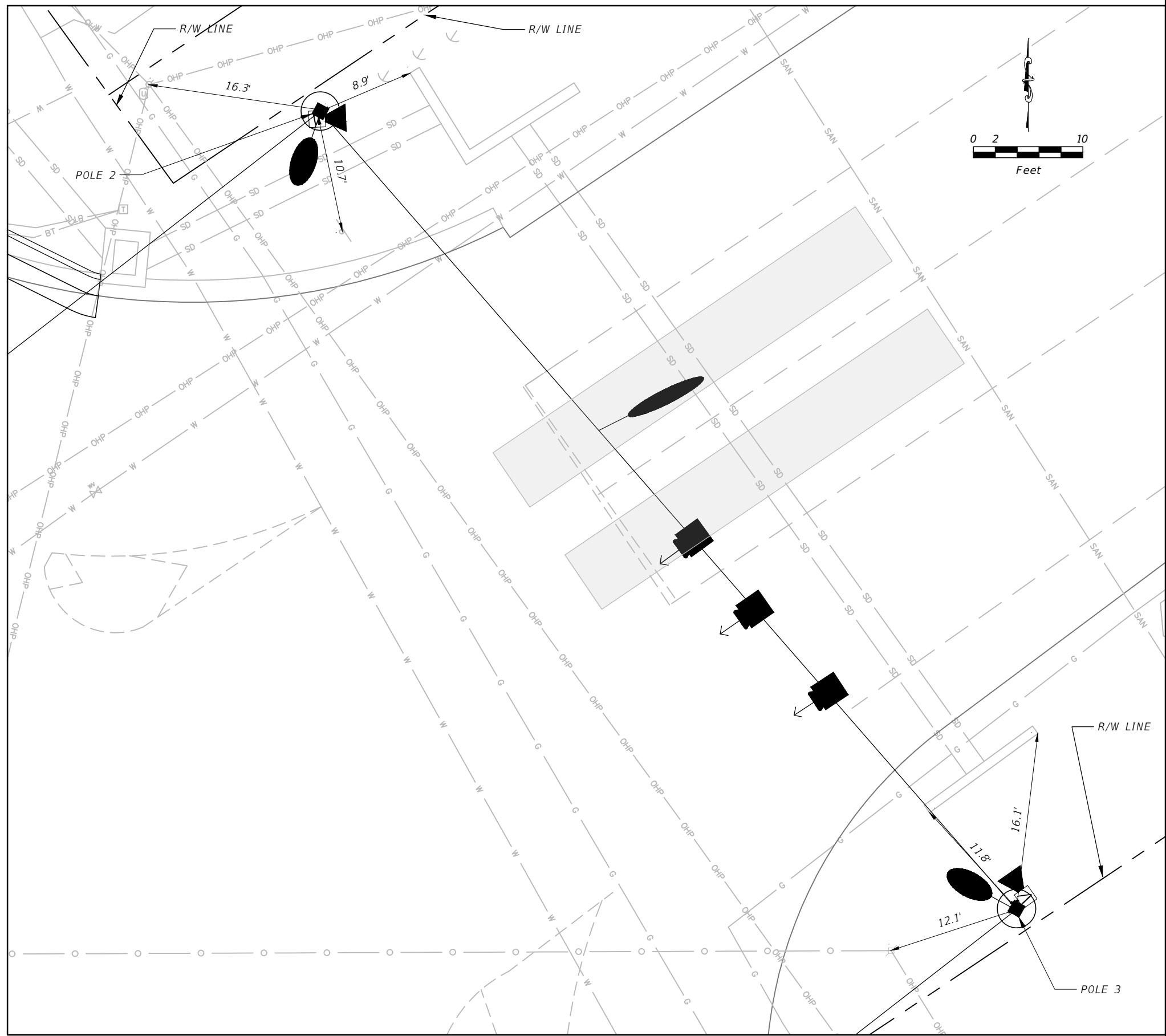

REVISIONS			
DATE	DESCRIPTION	DATE	DESCRIPTION

FLDS
 CHRIS J. WALSH P.E. PE No. 57626
Traffic Engineering Data Solutions, Inc.
 80 Spring Vista Drive Phone: 386.753.0558
 DeBary, FL 32713 Fax: 386.753.0778
 CERTIFICATE OF AUTHORIZATION # 27392

LAKE COUNTY, FL
 DEPARTMENT OF PUBLIC WORKS
 ENGINEERING DIVISION
 350 N. SINCLAIR AVE.
 TAVARES, FLORIDA 32778

SIGNAL DETAILS

SHEET NO.
 T-7

SIGN NAME A		QTY	SIGN NUMBER	STATION(S)	
PANEL		BORDER		none	
WIDTH	9'-0"	WIDTH	0.5"		
HEIGHT	2'-0"	RADII	1.5"		
LEGEND	WHITE	COLOR	WHITE		
COLOR		WHITE			
SYMBOL(S)	ANGLE	X	Y	WID	HT
LOGO	0	6.8	1.5	21	21
SIGN NUMBER		CLEARANCE Edge Of Lane	COLUMN SIZE	AVERAGE LENGTH	

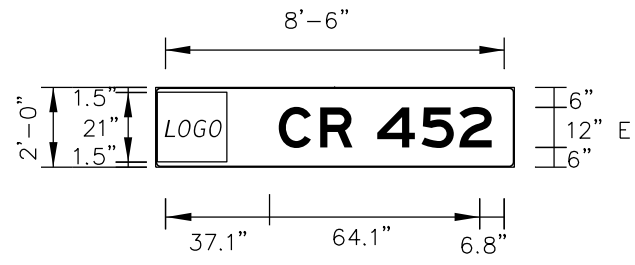

SIGN NAME B		QTY	SIGN NUMBER	STATION(S)	
PANEL		BORDER		none	
WIDTH	8'-0"	WIDTH	0.5"		
HEIGHT	2'-0"	RADII	1.5"		
LEGEND	WHITE	COLOR	White		
COLOR		Green			
SYMBOL(S)	ANGLE	X	Y	WID	HT
	0	0.5	1.3	21	21
SIGN NUMBER		CLEARANCE Edge Of Lane	COLUMN SIZE	AVERAGE LENGTH	

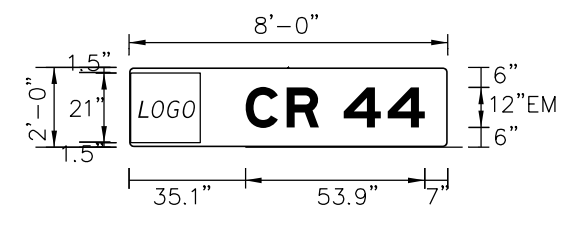

NO. OF LIGHT FIXTURES		FIXTURE SPACING		PHOTOMETRIC CURVE		WATT		VOLTAGE	
COPY		C	R	4	5	2		L	
SPACE	37.1	12.5	9.7	7.5	13.3	11.4	9.7	6.8	64.1
COPY									
SPACE									
COPY									
SPACE									
COPY									
SPACE									
COPY									
SPACE									
COPY									
SPACE									
COPY									
SPACE									

REVISIONS					
DATE	BY	DESCRIPTION	DATE	BY	DESCRIPTION

 CHRIS J. WALSH, P.E. PE No. 57626
Traffic Engineering Data Solutions, Inc.
 80 Spring Vista Drive Phone: 386.753.0558
 DeBary, FL 32713 Fax: 386.753.0778

DEPARTMENT OF PUBLIC WORKS
ENGINEERING DIVISION
 350 N. SINCLAIR AVE.
 TAVARES, FLORIDA 32778

GUIDE SIGN WORKSHEET

CONSTRUCTION NOTES:

PHASE 1:

1. USE EXISTING SIGNAL SPAN AND HEADS AND CONTROLLER.
2. INSTALL NEW POLES 2, 3, AND 4 WITH PROPOSED SPAN WIRE AND SIGNAL HEADS AND TEMPORARY SPAN WITH TEMPORARY SIGNAL HEADS.
3. INSTALL NEW CONTROLLER.

PHASE 2:

1. REMOVE EXISTING SIGNAL AND CONTROLLER.
2. INSTALL POLE 1 AND COMPLETE PROPOSED SPAN AND SIGNAL HEADS FOR MOVEMENTS 1, 6, 4 AND 7.
3. REMOVE TEMPORARY SPAN AND SIGNAL HEADS.

TEMPORARY SPAN AND SIGNAL HEADS
102-104 1 ED

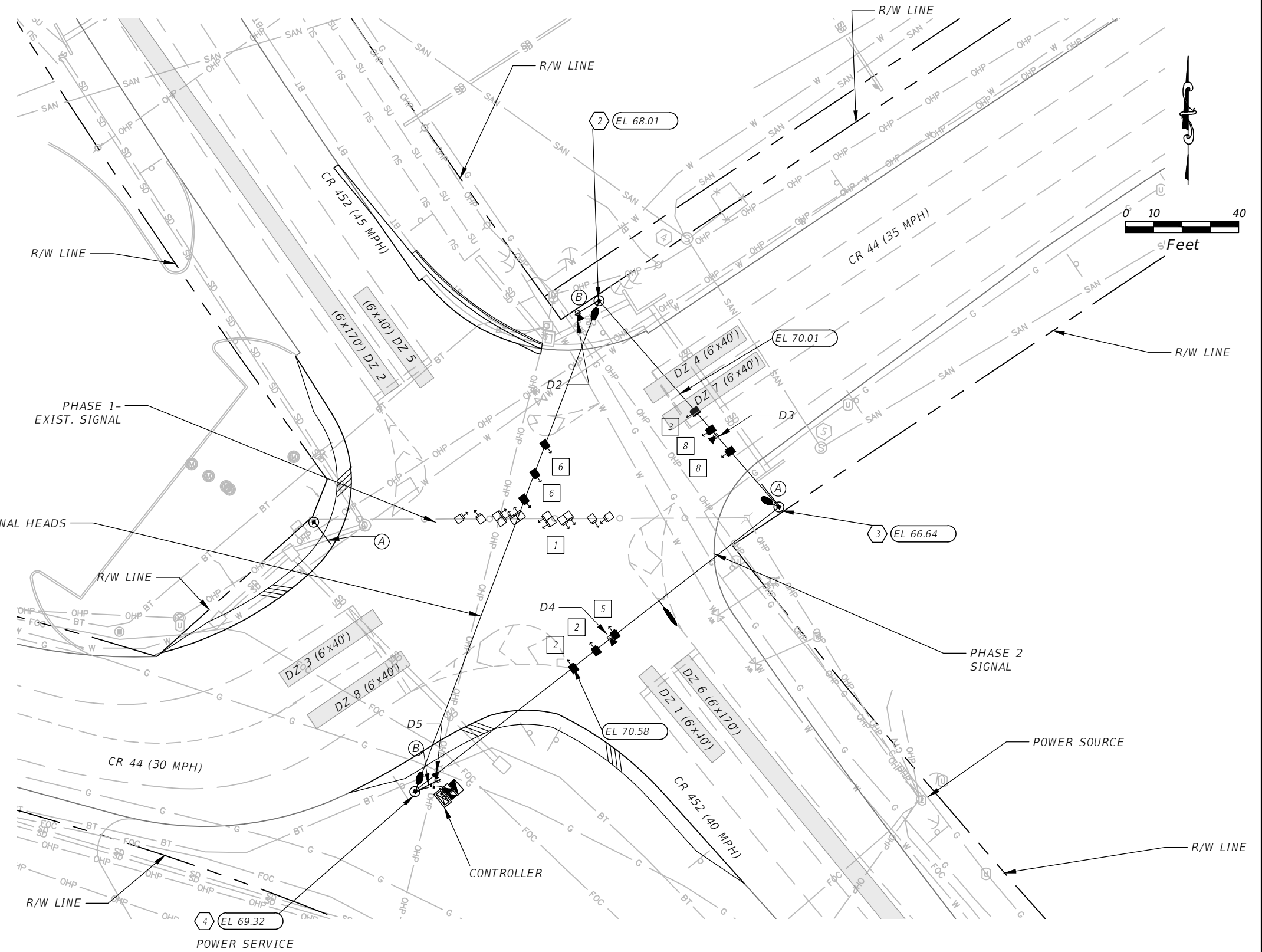

REVISIONS		REVISIONS		 <p>CHRIS J. WALSH P.E. PE No. 57626 80 Spring Vista Drive Phone: 386.753.0558 DeBary, FL 32713 Fax: 386.753.0778 CERTIFICATE OF AUTHORIZATION # 27392</p>	 <p>DEPARTMENT OF PUBLIC WORKS ENGINEERING DIVISION 350 N. SINCLAIR AVE. TAVERES, FLORIDA 32778</p>	<p>TEMPORARY SIGNAL</p>	SHEET NO.
DATE	DESCRIPTION	DATE	DESCRIPTION				T-9