

RECEIVED

DEC. 28 2015

LAKE COUNTY
ROAD OPERATIONS



Tip Top Tree Experts, llc

Mailing Address - P.O. Box 490064
Leesburg, FL 34749 US
(352)750-9056
tiptoptrees@gmail.com
http://www.tiptoptreeexpertsllc.com

BILL TO

Lake County Road Operations
Brenda Press
P.O. BOX 7800
Tavares, FL 32778

000-2679

DATE 12/23/2015

DUE DATE 12/31/2015

SALES REP JOB LOCATION
Francois Tasse Mt. Plymouth

ACTIVITY	AMOUNT
TREE SERVICE Contract # 15-0436 - Right of Way Tree Trimming, Vegetation Removal & Other Related Services for Mt. Plymouth area - Aberdovey Ave, Alpena St., Brae Burn St., Interlachen Dr., Lido Ave, Lochmore Cir., Oakmont Ave., Pinehurst St., Pinevalley Dr., Prestwick Ave., Ridgewood St., Sackamaxon St., Shawnee St., St. Andrews Blvd., Timuquana Dr. and Troon Ave.	38,575.00 <i>AB 12-28-15</i>

Please Note For Customer: Cancellations, Reschedules, Specific Time Frame Requests & Payment Plans, An Additional Amount Of 5% or \$25.00 Increase Will Be Added To Price. Late Payments: A Fee Of \$50.00 Will Be Added For Payments Not Made By 4:00pm On Due Date.

Contact Tip Top Tree Experts, llc for any Tree, Lawn, Landscape or Remodeling needs.

Thank You For Your Business!

TOTAL DUE

\$38,575.00

Stivender for JSR 12/28/15

OK TO PAY

Jim Stivender
Public Works Director

OK TO PAY - FY 15/16

PO#: 20160267
Acct#: 1120.5053200. 830460
Goods Recd: 12 / 22 / 2015
(NB) 12/28

Please note all customers receiving stump grinding services. We are not responsible for any damages under ground. We will call locates on all stumps to be ground. Any damages resulting from stump grinding is at owners expense and is responsible for their own repairs for damages. Thank you MGMT.

BP
12/28/15



LAKE COUNTY
BOARD OF COUNTY COMMISSIONERS
www.lakecountyfl.gov

Change Orders 000

Expiration Date

Purchase Order

Fiscal Year 2016 Page 1 of

THIS NUMBER MUST APPEAR ON ALL INVOICES,
PACKAGES AND SHIPPING PAPERS.

Purchase Order # **20160267**

FOB: Destination Inside Delivery

Office of Procurement Services
Phone: 352-343-9839 Fax 352-343-9473

B
I
L
L
T
O

PWROC
PUBLIC WORKS ROAD OPER. CTR
12901 COUNTY LANDFILL ROAD
PO BOX 7800
TAVARES, FL 32778

I
S
S
U
E
D

S
H
I
P
T
O

RO
PW ROAD OPERATIONS
12901 COUNTY LANDFILL RD
PO BOX 7800
TAVARES, FL 32778

V
E
N
D
O
R

18582
TIP TOP TREE EXPERTS LLC
PO BOX 891
WEIRSDALE, FL 32195

Vendor Phone Number		Vendor Fax Number		Requisition Number		Delivery Reference	
352-217-4924		352-750-9056		20160262		MT PLYMOUTH AREA TREE TRIMMING	
Date Ordered	Vendor Number	Date Required	Confirmed To			Contracting Officer	
10/08/2015	18582	10/05/2015				SANDRA ROGERS	
Item#	Description/Part No.			Qty	UOM	Cost Each	Extended Price
1	CONTRACT 15-0436E (EXPIRES 9/30/2016) TREE TRIMMING, VEGETATION REMOVAL AND RELATED SERVICES FOR MOUNT PLYMOUTH AREA PER QUOTE 1120-540-541-50-53200-830460-			1.00	LS	\$38,575.00	\$38,575.00

IMPORTANT: This order is subject to the terms & conditions herein.

Sandra Rogers
Authorized By

Department Copy

Purchase Order Total
38,575.00

15-0436
Roadside Tree Trimming

Route name:	Route #	Segment #	Ok To Pay	Date:	Notes:
Aberdovey Av.	3989A	01,02	Yes	12-22-15	one limb south end OK
Alpena St.	3989E	1	Yes	12-22-15	
Brae Burn St.	3989B	1	Yes	12-22-15	
Interlachen Dr.	4189A	1	Yes	12-22-15	
Lido Av.	4088B	1	Yes	12-22-15	
Lochmore Circle	4188C	1	Yes	12-22-15	
Oakmont Av.	4189C	1	Yes	12-22-15	
Pinehurst St.	4089	1	Yes	12-22-15	
Pine Valley Dr.	4088A	1	Yes	12-22-15	
Prestwick Av.	4090	01,02	Yes	12-22-15	
Ridgewood St.	4189B	1	Yes	12-22-15	
Sackamaxon Dr.	4289	1	Yes	12-22-15	3 1430 cut limb (back end) OK
Shawnee St.	3989C	1	Yes	12-22-15	
St. Andrews Blvd.	3989	1	Yes	12-22-15	
Timuquana Dr.	3889	1	Yes	12-22-15	
Troon Av.	4189	01,07	Yes	12-22-15	

ok to pay:  12-22-15

SECTION 4 – PRICING/ CERTIFICATIONS/ SIGNATURES

RFP Number: 15-0436

Prestwick Avenue	5	\$ 4,950
Ridgewood Street	1	\$ 625
Sackamaxon Drive	4	\$ 3,525
Shawnee Street	1	\$ 850
St. Andrews Boulevard	1	\$ 1,525
Timuquana Drive	1	\$ 1,250
Troon Avenue	8	\$ 6,925
Total for Mount Plymouth Area Roads:		\$ 38,575

Certification of mandatory site examination: Vendors are required to visit the site of the initial work proposed. By initialing this block: FT, the vendor confirms compliance with the site examination requirements stated in Section 1.4 of this solicitation.

Other Items for Completion by Vendor:

By Signing this Proposal the Proposer Attests and Certifies that:

- It satisfies all legal requirements (as an entity) to do business with the County.
- The undersigned vendor acknowledges that award of a contract may be contingent upon a determination by the County that the vendor has the capacity and capability to successfully perform the contract.
- The proposer hereby certifies that it understands all requirements of this solicitation, and that the undersigned individual is duly authorized to execute this proposal document and any contract(s) and/or other transactions required by award of this solicitation.

Purchasing Agreements with Other Government Agencies

This section is optional and will not affect contract award. If Lake County awarded you the proposed contract, would you sell under the same terms and conditions, for the same price, to other governmental agencies in the State of Florida? Each governmental agency desiring to accept to utilize this contract shall be responsible for its own purchases and shall be liable only for materials or services ordered and received by it. Yes No (Check one)

Certification Regarding Felony Conviction

Has any officer, director, or an executive performing equivalent duties, of the bidding entity been convicted of a felony during the past ten (10) years? Yes No (Check one)

Certification Regarding Acceptance of County VISA-based Payment System

Vendor will accept payment through the County VISA- based payment system: Yes No

Reciprocal Vendor Preference:

Vendors are advised the County has established, under Lake County Code, Chapter 2, Article VII, Sections 2-221 and 2-222; a process under which a local vendor preference program applied by another county may be applied in a reciprocal manner within Lake County. The following information is needed to support application of the Code:

1. Primary business location of the responding vendor (city/state): Weirsdale - FL - LK County

2. Does the responding vendor maintain a significant physical location in Lake County at which employees are located and business is regularly transacted: Yes No If "yes" is checked, provide supporting detail:

Tip Top and all employees live in lake county

PRICING SECTION

The pricing table below is for provision of the required services for the two (2) initial projects as noted in the Scope of Services. Please note that this job-specific pricing table will be used, along with additional requirements as stated in Section 1.3, to obtain a specific vendor for the two (2) initial projects, and select the vendors for future spot-bidding of right of way tree trimming, vegetation removal and other related services.

The vendor shall base the cost for these two (2) initial projects in a lump sum price and shall be all inclusive to include all items such as, but not limited to, Maintenance of Traffic (MOT), equipment, materials, fuel, and labor to satisfactorily complete the work in accordance with contract specifications. No change orders, modification of quantities, or additions will be provided after acceptance is provided for the performance of work under this initial scope.

First Initial Project:

Project Site	No. Days to Complete (Not-to-exceed 60 calendar days)	Unit Price
CR 474	50	\$ 416,250
Total for CR 474:		\$ 416,250

Second Initial Project:

Project Site	No. Days to Complete (Not-to-exceed 60 calendar days)	Unit Price
Aberdovey Avenue	3	\$ 2,350
Alpena Street	1	\$ 500
Brae Burn Street	1	\$ 1,150
Interlachen Drive	3	\$ 2,250
Lido Avenue	1	\$ 1,750
Lochmore Circle	3	\$ 2,300
Oakmont Avenue	3	\$ 2,525
Pinchurst Street	2	\$ 1,250
Pine Valley Drive	4	\$ 4,850

SCOPE OF SERVICES

The purpose of this solicitation is to select one or more vendor(s) for the two (2) specific right-of-way vegetation encroachment projects specified herein, and establish a pool of qualified vendors for future pricing competition for right of way tree trimming and encroaching vegetation efforts on an “on-call” basis in conjunction with the County’s needs.

The Contractor shall be well versed and experienced with the current processes to be able to complete the work in accordance with the specifications within this document and as directed by the County. The Contractor shall have the ability, personnel, fuel, and the equipment to complete all work within the specified time.

Specific Work Requirements for Initial Projects

18 Limit

1. The first project under this solicitation is located on CR 474, beginning at SR 33 and ending at US Highway 27 (approximately 8.6 miles) and the work shall be completed utilizing the specifications and pricing sheet that are included in this solicitation. The successful respondent with the lowest price will be the sole responsible party for this proposed project. The side clearance along this road shall vary between twenty (20) to forty (40) feet from the edge of pavement. There should be a clearly defined tree trunk/fence line after all tree trimming, palm removal, brush clearing, vegetation removal and debris cleanup is completed.

2. The second project under this solicitation is located in the Mount Plymouth area. This is a residential area consisting of sixteen (16) roads as defined below requiring tree trimming and minimal brush clearing as detailed within.

2.1 12-16-15
2.1 Aberdovey Avenue (3989A): Beginning at Prestwick Avenue (4090) and ending at Hunstaunton Drive (private road) (approximately .38 miles). The side clearance along this road shall be fifteen (15) feet from the edge of pavement. The vendor shall trim all trees within the project limits. An oak tree located at 25624 Aberdovey Avenue shall be completely removed and the work shall include stump grinding.

2.2 Alpena Street (3989E): Beginning at Aberdovey Avenue (3989A) and ending at Brae Burn Street (3989B) (approximately .07 miles). The side clearance along this road shall be fifteen (15) feet from the edge of pavement. The vendor shall trim all trees within the project limits.

2.3 Brae Burn Street (3989B): Beginning at Aberdovey Avenue (3989A) and ending at St. Andrews Boulevard (3989) (approximately .13 miles). The side clearance along this road shall be fifteen (15) feet from the edge of pavement. The vendor shall trim all trees within the project limits.

2.4 Interlachen Drive (4189A): Beginning at Pine Valley Drive (4088A) and ending at Sackamaxon Drive (4289) (approximately .44 miles). The side clearance along this road shall be fifteen (15) feet from the edge of pavement. The vendor shall trim all trees within the project limits. There is an area of dense trees on the east side of Interlachen Drive where the vendor shall remove all tree limbs and brush within this area to clear the area to the main tree trunk line.

SECTION 2 – STATEMENT OF WORK

RFP Number: 15-0436

2.5 Lido Avenue (4088B): Beginning at CR 435 (3888) and ending at Troon Avenue (4189) (approximately .38 miles). The side clearance along this road shall be fifteen (15) feet from the edge of pavement. The vendor shall trim all trees within the project limits.

2.6 Lochmore Circle (4188C): Beginning at CR 435 (3888) and ending at Sackamaxon Drive (4289) (approximately .42 miles). The side clearance along this road shall be fifteen (15) feet from the edge of pavement. The vendor shall trim all trees within the project limits.

2.7 Oakmont Avenue (4189C): Beginning at Pine Valley Drive (4088A) and ending at the end of County maintenance (approximately .26 miles). The side clearance along this road shall be fifteen (15) feet from the edge of pavement. The vendor shall trim all trees within the project limits.

2.8 Pinehurst Street (4089): Beginning at St. Andrews Boulevard (3989) and ending at Prestwick Avenue (4090) (approximately .27 miles). The side clearance along this road shall be fifteen (15) feet from the edge of pavement. The vendor shall trim all trees within the project limits.

2.9 Pine Valley Drive (4088A): Beginning at CR 435 (3888) and ending at Troon Avenue (4189) (approximately .76 miles). The side clearance along this road shall be fifteen (15) feet from the edge of pavement. The vendor shall trim all trees within the project limits.

2.10 Prestwick Avenue (4090): Beginning at CR 435 (3888) and ending at Sandwich Place (private road) (approximately 1.64 miles). The side clearance along this road shall be fifteen (15) feet from the edge of pavement. The vendor shall trim all trees within the project limits.

2.11 Ridgewood Street (4189B): Beginning at Oakmont Avenue (4189C) and ending at Interlachen Drive (4189A) (approximately .06 miles). The side clearance along this road shall be fifteen (15) feet from the edge of pavement. The vendor shall trim all trees within the project limits.

2.12 Sackamaxon Drive (4289): Beginning at Lochmore Circle (4188C) and ending at Prestwick Avenue (4090) (approximately .71 miles). The side clearance along this road shall be fifteen (15) feet from the edge of pavement. The vendor shall trim all trees within the project limits.

2.13 Shawnee Street (3989C): Beginning at St. Andrews Boulevard (3989) and ending at Hoylake Street (private road) (approximately .19 miles). The side clearance along this road shall be fifteen (15) feet from the edge of pavement. The vendor shall trim all trees within the project limits.

2.14 St. Andrews Boulevard (3989): Beginning at Timuquana Drive (3889) and ending at Prestwick Avenue (4090) (approximately .32 miles). The side clearance along this road shall be fifteen (15) feet from the edge of pavement. The vendor shall trim all trees within the project limits.

¹²⁻¹⁵⁻¹⁵
OR 2.15 Timuquana Drive (3889): Beginning at CR 435 (3888) and ending at the end of County maintenance (approximately .38 miles). The side clearance along this road shall be fifteen (15) feet from the edge of pavement. The vendor shall trim all trees within the project limits.

2.16 Troon Avenue (4189): Beginning at CR 435 (3888) and ending at Sackamaxon Drive (4289) (approximately 1.39 miles). The side clearance along this road shall be fifteen (15) feet from the edge of pavement. The vendor shall trim all trees within the project limits. There are a few areas on the north side of Troon Avenue that have patches of dense trees. The vendor shall remove all tree limbs and brush within these areas to clear the area to the main tree trunk line.

GENERAL REQUIREMENTS / CONTRACT ADMINISTRATION

Order of Operation

This section describes the chronological order of events that will take place to begin, perform, and complete a project under this contract:

1. When the County has determined that work is needed, the Project Manager shall issue a request for quote utilizing the County's RFQ System. The request shall include the location, clearly defined project limits, and description of the scope of work to be completed. The request for quote notification shall be sent to all contractors qualified under this solicitation utilizing the County's RFQ system.
2. The County will hold a mandatory site visit within three (3) business days of the issuance of the request for quote.
3. Each contractor shall provide a proposal within three (3) business days from the date of the mandatory site visit. The proposal shall include the number of days necessary to accomplish the work. If the contractor fails to provide a proposal within the specified time frame, the non-responsive firm will not be considered for that particular project.

Any discrepancy concerning measurements and/or work limits shall be resolved and confirmed by the Project Manager prior to beginning any work. The vendor shall not be entitled to any additional compensation for the extra work performed if the vendor completes the work without the confirmation from the Project Manager.

4. Project Manager shall review the quotes and, if all are acceptable, shall issue a Notice to Proceed to the vendor submitting the lowest price and days. The Project Manager will issue a Notice to Proceed based on the lowest price offer; provided that the contractor has the ability to complete the work within the time frame submitted on the quote.
5. Contractor shall provide signed acceptance of the Notice to Proceed within three (3) business days. The contractor shall provide the County with a schedule of completion by email (preferred method) or fax within five (5) business days of issuance of the Notice to Proceed.

CD-4

MA-3

- 32) ODEN ST
- 33) INWOOD ST
- 34) SLEEPY HOLLOW
- 35) SUNNINGDALE

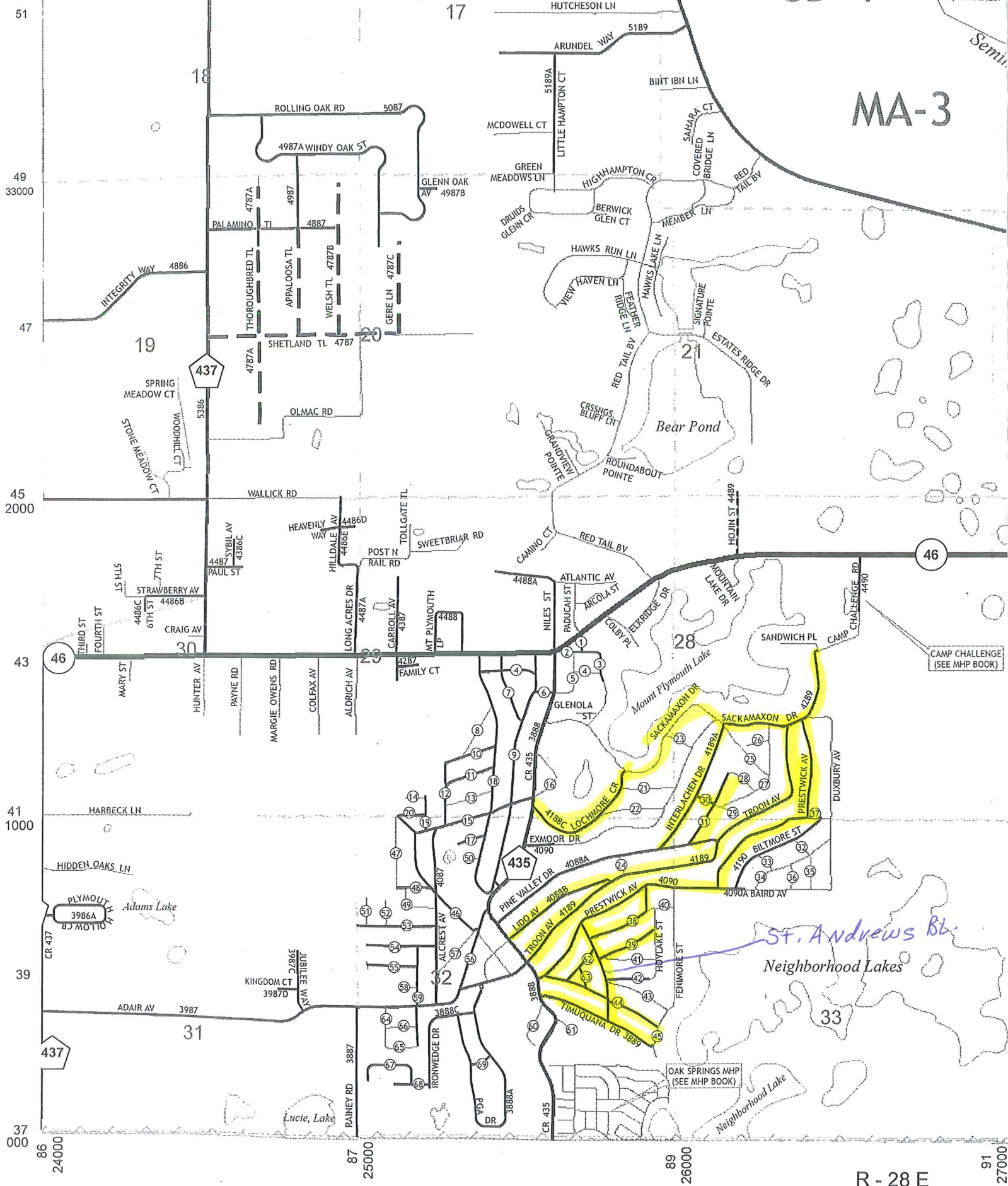

CAMP CHALLENGE (SEE MHP BOOK)

OAK SPRINGS MHP (SEE MHP BOOK)

St. Andrews Bk.
Neighborhood Lakes

R - 28 E

91
27000

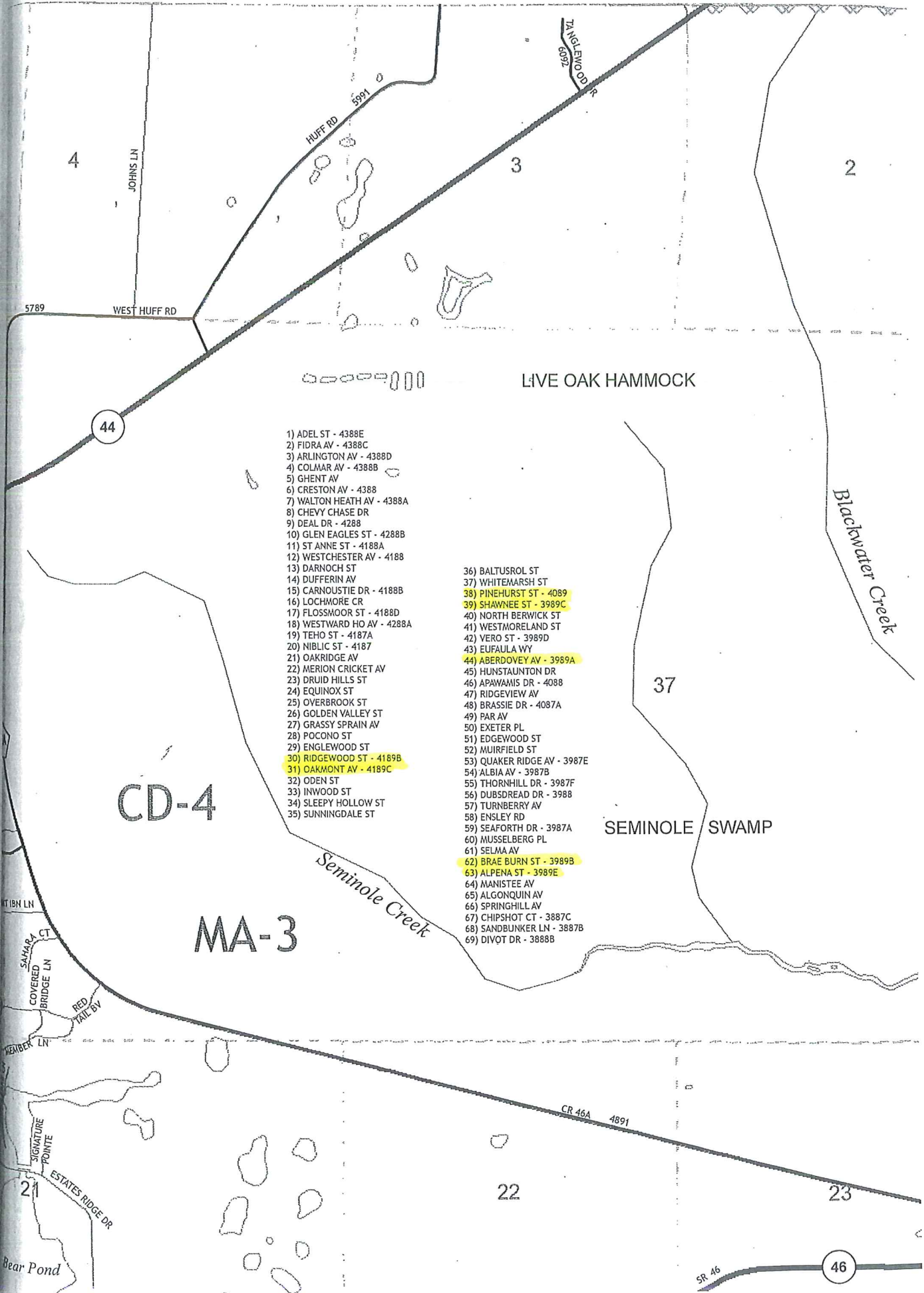

- 1) ADEL ST - 4388E
- 2) FIDRA AV - 4388C
- 3) ARLINGTON AV - 4388D
- 4) COLMAR AV - 4388B
- 5) GHENT AV
- 6) CRESTON AV - 4388
- 7) WALTON HEATH AV - 4388A
- 8) CHEVY CHASE DR
- 9) DEAL DR - 4288
- 10) GLEN EAGLES ST - 4288B
- 11) ST ANNE ST - 4188A
- 12) WESTCHESTER AV - 4188
- 13) DARNOCH ST
- 14) DUFFERIN AV
- 15) CARNOUSTIE DR - 4188B
- 16) LOCHMORE CR
- 17) FLOSSMOOR ST - 4188D
- 18) WESTWARD HO AV - 4288A
- 19) TEHO ST - 4187A
- 20) NIBLIC ST - 4187
- 21) OAKRIDGE AV
- 22) MERION CRICKET AV
- 23) DRUID HILLS ST
- 24) EQUINOX ST
- 25) OVERBROOK ST
- 26) GOLDEN VALLEY ST
- 27) GRASSY SPRAIN AV
- 28) POCONO ST
- 29) ENGLEWOOD ST
- 30) RIDGEWOOD ST - 4189B
- 31) OAKMONT AV - 4189C
- 32) ODEN ST
- 33) INWOOD ST
- 34) SLEEPY HOLLOW ST
- 35) SUNNINGDALE ST
- 36) BALTUSROL ST
- 37) WHITEMARSH ST
- 38) PINEHURST ST - 4089
- 39) SHAWNEE ST - 3989C
- 40) NORTH BERWICK ST
- 41) WESTMORELAND ST
- 42) YERO ST - 3989D
- 43) EUFAULA WY
- 44) ABERDOVEY AV - 3989A
- 45) HUNSTAUNTON DR
- 46) APAWAMIS DR - 4088
- 47) RIDGEVIEW AV
- 48) BRASSIE DR - 4087A
- 49) PAR AV
- 50) EXETER PL
- 51) EDGEWOOD ST
- 52) MUIRFIELD ST
- 53) QUAKER RIDGE AV - 3987E
- 54) ALBIA AV - 3987B
- 55) THORNHILL DR - 3987F
- 56) DUBSDREAD DR - 3988
- 57) TURNBERRY AV
- 58) ENSLEY RD
- 59) SEAFORTH DR - 3987A
- 60) MUSSELBERG PL
- 61) SELMA AV
- 62) BRAE BURN ST - 3989B
- 63) ALPENA ST - 3989E
- 64) MANISTEE AV
- 65) ALGONQUIN AV
- 66) SPRINGHILL AV
- 67) CHIPSHOT CT - 3887C
- 68) SANDBUNKER LN - 3887B
- 69) DIVOT DR - 3888B

CD-4

MA-3

LIVE OAK HAMMOCK

SEMINOLE SWAMP

Blackwater Creek

Seminole Creek

TIBB LN
 SAHARA CT
 COVERED BRIDGE LN
 RED TAIL BY
 MEMBER LN
 SIGNATURE POINTE
 ESTATES RIDGE DR
 Bear Pond

CR 46A 4891

44

37

22

23

SR 46

46