

SIGNAL HEAD DETAILS

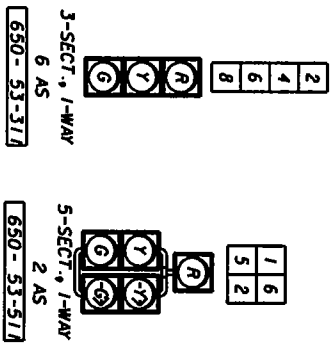

OVERHEAD SIGN DETAILS

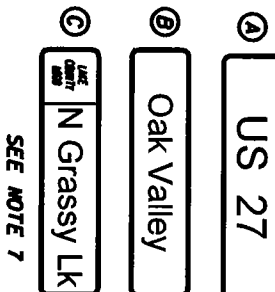

CONTROLLER TIMINGS

MOVEMENT NO.	1	2	3	4	5	6	7	8
MINIMUM GREEN	17	17	17	17	17	17	17	17
EXTENSION	3	2.5	3	3	2.5	3	2.5	3
MAXIMUM GREEN 1	50	25	50	50	25	50	25	50
MAXIMUM GREEN 2	5	4	5	5	4	5	4	5
YELLOW CLEARANCE	2	1	2	2	1	2	1	2
ALL RED								
PEDESTRIAN WALK								
PEL. CLEARANCE								
RECALL								
DETECTOR								

DURING FLASH OPERATIONS MOVEMENTS 2 AND 6 SHALL FLASH YELLOW. ALL OTHER MOVEMENTS SHALL FLASH RED.

PRE-CONSTRUCTION NOTES:

- CONTRACTOR TO NOTIFY THE FLORIDA DEPARTMENT OF TRANSPORTATION RAY MARLIN (386-943-5388) AND LAKE COUNTY FRED SCHNEIDER (352-253-4905) 2 FULL BUSINESS DAYS PRIOR TO BEGINNING CONSTRUCTION.
- CONTRACTOR TO SUBMIT CONCRETE MIX DESIGN TO ENGINEER PRIOR TO JOB START.

GENERAL NOTES:

- NO LANE CLOSURES FROM 7 AM TO 7 PM NORTHBOUND AND SOUTHBOUND ON US 27.
- ALL LANE CLOSURES TO BE APPROVED BY THE PROJECT ENGINEER.
- CONTRACTOR IS TO PLACE TURN ARROWS PER INDEX 07346.
- THE MAJOR STREET IS US 27 AND THE MINOR STREET IS OAK VALLEY BLVD./N. GRASSY LAKE RD.
- THE SPEED LIMIT ON US 27 IS 55 MPH.
- ASSUED ELEVATION OF 500.00' AT FOUNDATION OF POLE A.
- CONTRACTOR SHALL CONTACT LAKE COUNTY (STEVE BOLLINGER: 352-742-7766) REGARDING INSTALLATION OF INTERNALLY ILLUMINATED STREET NAME SIGNS, CONTROLLER GENERATOR SWITCH, AND ETHERNET CONNECTION.
- THE LOCATION OF UTILITIES SHOWN ON THE PLANS ARE APPROXIMATE. PRIOR TO DIGGING, THE CONTRACTOR SHALL DETERMINE THE EXACT LOCATION OF ALL UTILITIES.
- THE BASELINE IS LOCATED ALONG THE NORTHBOUND EDGE OF TRAVEL WITH STATION 0+00 LOCATED ALONG THE DOUBLE-YELLOW CENTERLINE FOR GRASSY LAKE ROAD.
- PAV. ITEM NO. R2-99 INCLUDES ONE VARIABLE MESSAGE SIGN ON THE SOUTHBOUND AND NORTHBOUND APPROACHES FOR A TOTAL OF 14 DAYS AFTER SIGNAL ACTIVATION. EACH TO READ "CAUTION CAUTION CAUTION" ON PANEL ONE AND "NEW SIGNAL AHEAD" ON PANEL TWO.
- CONTRACTOR TO CONTACT ERIC PETERSON (PROGRESS ENERGY @ 352-461-4676) 21 DAYS PRIOR TO CONSTRUCTION FOR OVERHEAD LINE COORDINATION.

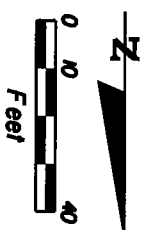
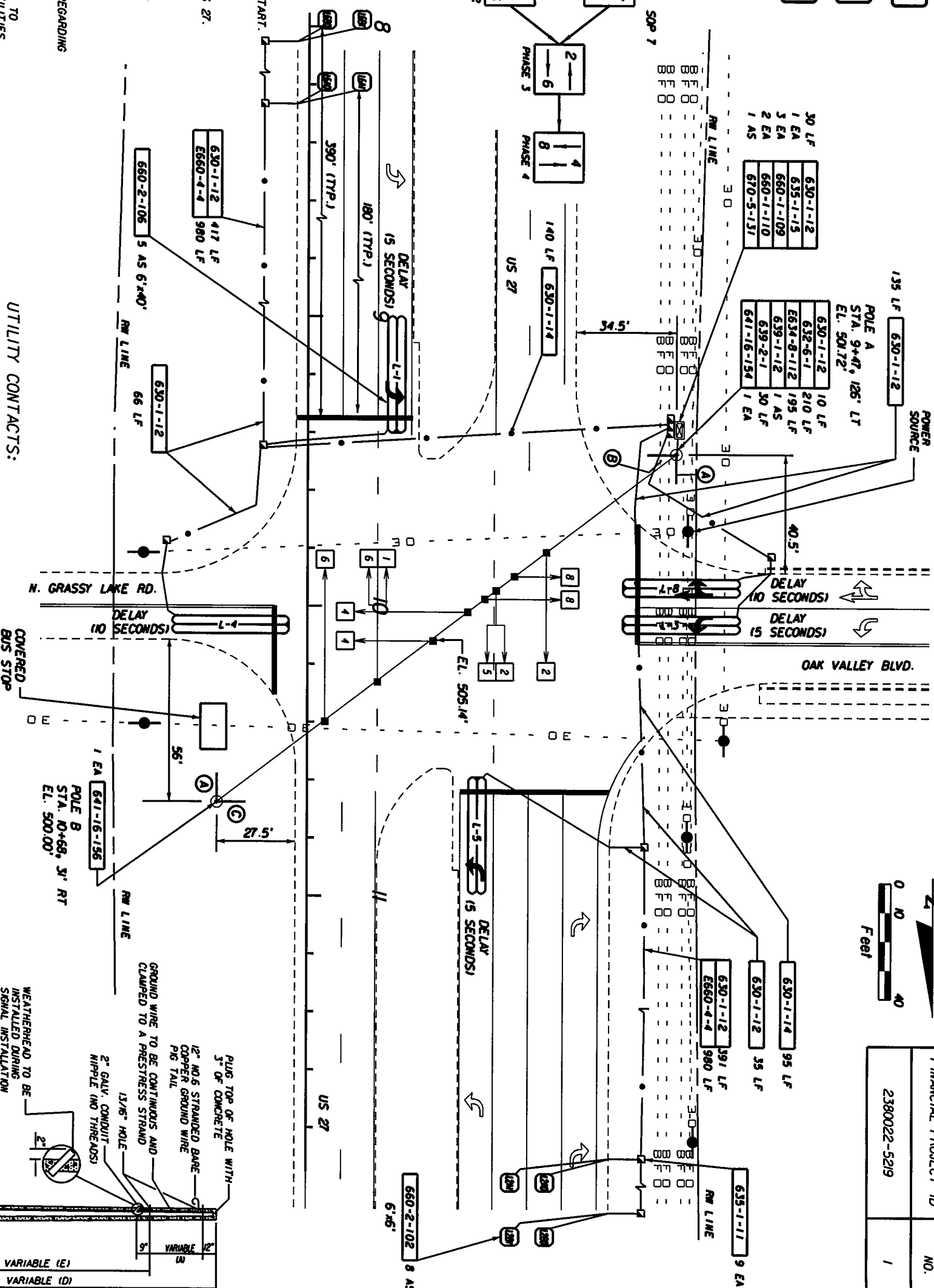

FINANCIAL PROJECT ID	2380022-5219
SHEET NO.	1

REVISIONS

DATE	BY	DESCRIPTION	DATE	BY	DESCRIPTION
6/12/07	JSS	PROVIDE PROTECTED-REMITTED LEFT TURN PHASE FOR US 27.			

DESIGNED BY	NAME	DATE	DRAWN BY	NAME	DATE
DESIGNED BY	KCH	6/06	DRAWN BY	KCH	6/06
CHECKED BY	JSS	6/06	CHECKED BY	JSS	6/06

STATE OF FLORIDA
DEPARTMENT OF TRANSPORTATION
ENGINEER OF RECORD:
JAMES S. STROZ, JR., PE
FL REGISTRATION NO. 56984

US 27 @ OAK VALLEY BLVD./N. GRASSY LAKE RD.
SECTION 11200 M.P. 18.636
LAKE COUNTY

6/13/07

FINANCIAL PROJECT ID	2380022-5219
SHEET NO.	2

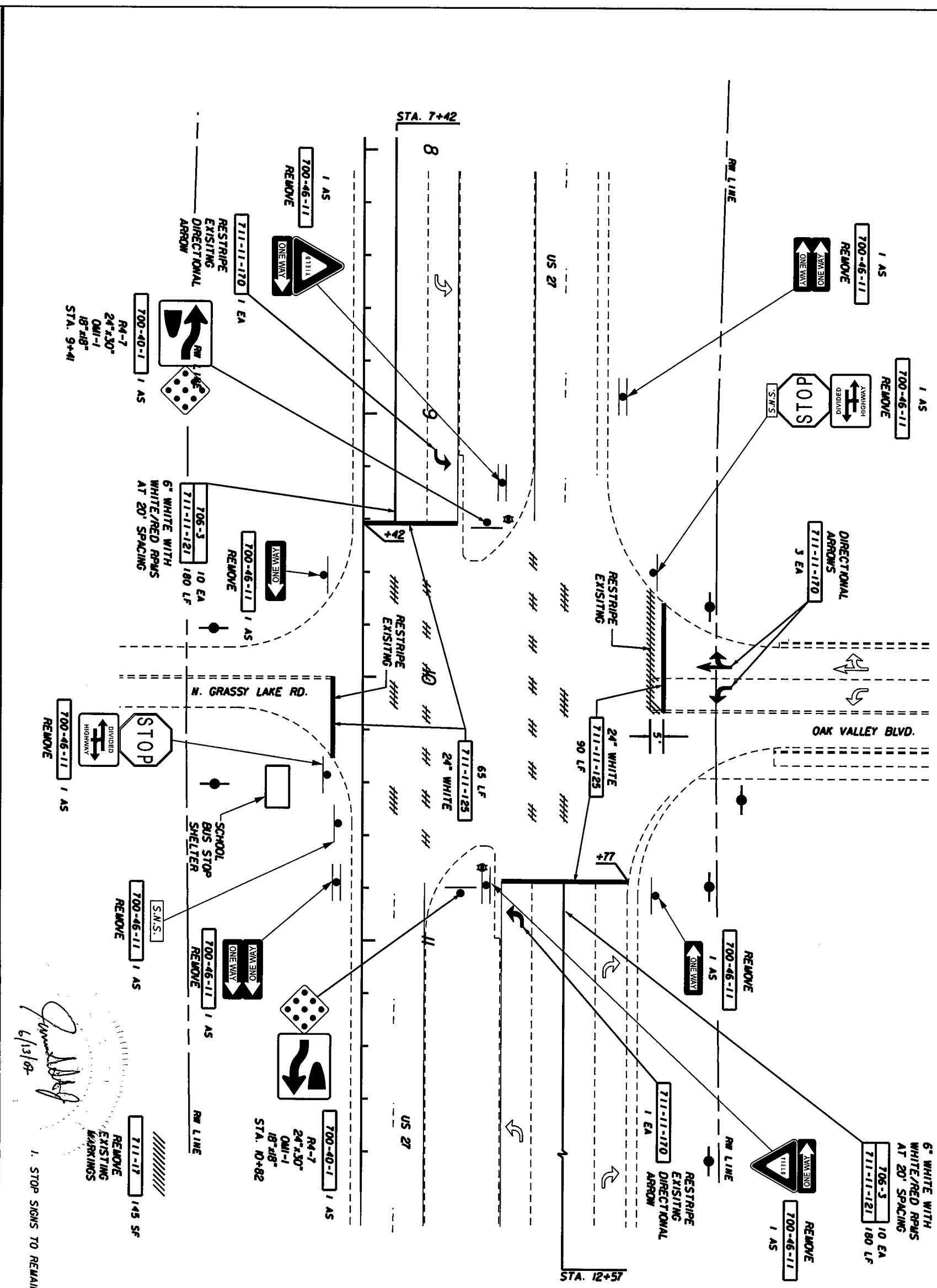
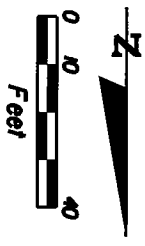

NOTES:
 1. STOP SIGNS TO REMAIN IN PLACE UNTIL SIGNAL IS IN "STOP-60" OPERATION.

James S. Strodt, Jr.
 6/13/08

REVISIONS			
DATE	BR	DESCRIPTION	DATE
6/12/07	JSS	PROVIDE PROTECTED-PERMITTED LEFT TURN PHASE FOR US 27.	

NAME	DATE	NAME	DATE
DESIGNED BY: KCH	6/06	DRAWN BY: KCH	6/06
CHECKED BY: JSS	6/06	CHECKED BY: JSS	6/06

STATE OF FLORIDA	US 27 @ OAK VALLEY BLVD./N. GRASSY LAKE RD.
DEPARTMENT OF TRANSPORTATION	SECTION 11200 M.P. 18.636
ENGINEER OF RECORD:	LAKE COUNTY
JAMES S. STRODT, JR., P.E.	
FL REGISTRATION NO. 56984	