

SIGNAL HEAD DETAILS

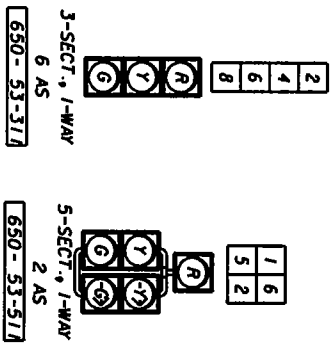

OVERHEAD SIGN DETAILS

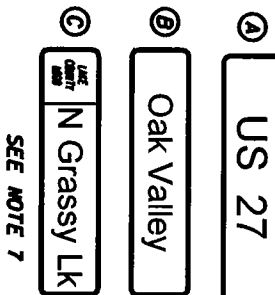

CONTROLLER TIMINGS

| MOVEMENT NO.     | 1  | 2   | 3  | 4  | 5   | 6  | 7   | 8  |
|------------------|----|-----|----|----|-----|----|-----|----|
| MINIMUM GREEN    | 17 | 17  | 17 | 17 | 17  | 17 | 17  | 17 |
| EXTENSION        | 3  | 2.5 | 3  | 3  | 2.5 | 3  | 2.5 | 3  |
| MAXIMUM GREEN 1  | 50 | 25  | 50 | 50 | 25  | 50 | 25  | 50 |
| MAXIMUM GREEN 2  | 5  | 4   | 5  | 5  | 4   | 5  | 4   | 5  |
| YELLOW CLEARANCE | 2  | 1   | 2  | 2  | 1   | 2  | 1   | 2  |
| ALL RED          |    |     |    |    |     |    |     |    |
| PEDESTRIAN WALK  |    |     |    |    |     |    |     |    |
| PEL. CLEARANCE   |    |     |    |    |     |    |     |    |
| RECALL           |    |     |    |    |     |    |     |    |
| DETECTOR         |    |     |    |    |     |    |     |    |

DURING FLASH OPERATIONS MOVEMENTS 2 AND 6 SHALL FLASH YELLOW. ALL OTHER MOVEMENTS SHALL FLASH RED.

PRE-CONSTRUCTION NOTES:

- CONTRACTOR TO NOTIFY THE FLORIDA DEPARTMENT OF TRANSPORTATION RAY MARLIN (386-943-5388) AND LAKE COUNTY FRED SCHNEIDER (352-253-4905) 2 FULL BUSINESS DAYS PRIOR TO BEGINNING CONSTRUCTION.
- CONTRACTOR TO SUBMIT CONCRETE MIX DESIGN TO ENGINEER PRIOR TO JOB START.

GENERAL NOTES:

- NO LANE CLOSURES FROM 7 AM TO 7 PM NORTHBOUND AND SOUTHBOUND ON US 27.
- ALL LANE CLOSURES TO BE APPROVED BY THE PROJECT ENGINEER.
- CONTRACTOR IS TO PLACE TURN ARROWS PER INDEX 7346.
- THE MAJOR STREET IS US 27 AND THE MINOR STREET IS OAK VALLEY BLVD./N. GRASSY LAKE RD.
- THE SPEED LIMIT ON US 27 IS 55 MPH.
- ASSUMED ELEVATION OF 500.00' AT FOUNDATION OF POLE A.
- CONTRACTOR SHALL CONTACT LAKE COUNTY (STEVE BOLLINGER: 352-742-7766) REGARDING INSTALLATION OF INTERNALLY ILLUMINATED STREET NAME SIGNS, CONTROLLER GENERATOR SWITCH, AND ETHERNET CONNECTION.
- THE LOCATION OF UTILITIES SHOWN ON THE PLANS ARE APPROXIMATE. PRIOR TO DIGGING, THE CONTRACTOR SHALL DETERMINE THE EXACT LOCATION OF ALL UTILITIES.
- THE BASELINE IS LOCATED ALONG THE NORTHBOUND EDGE OF TRAVEL WITH STATION 0+00 LOCATED ALONG THE DOUBLE-YELLOW CENTERLINE FOR GRASSY LAKE ROAD.
- PAV. ITEM NO. R2-99 INCLUDES ONE VARIABLE MESSAGE SIGN ON THE SOUTHBOUND AND NORTHBOUND APPROACHES FOR A TOTAL OF 14 DAYS AFTER SIGNAL ACTIVATION. EACH TO READ "CAUTION CAUTION CAUTION" ON PANEL ONE AND "NEW SIGNAL AHEAD" ON PANEL TWO.
- CONTRACTOR TO CONTACT ERIC PETERSON (PROGRESS ENERGY @ 352-461-4676) 21 DAYS PRIOR TO CONSTRUCTION FOR OVERHEAD LINE COORDINATION.

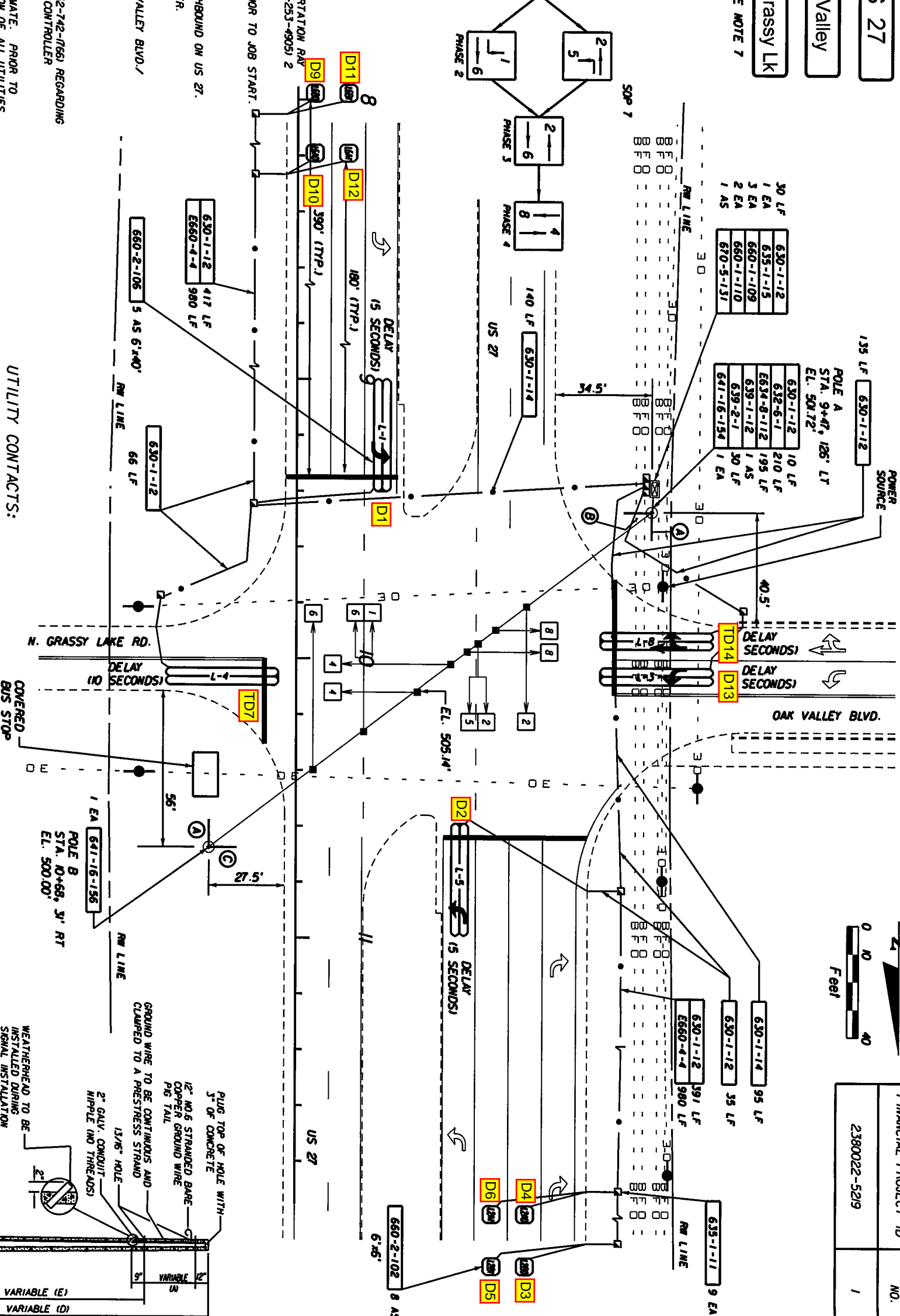

REVISIONS

| DATE    | BY  | DESCRIPTION   | DATE | BY | DESCRIPTION |
|---------|-----|---|------|----|-------------|
| 6/12/07 | JSS | PROVIDE PROTECTED-REMITTED LEFT TURN PHASE FOR US 27. |      |    |             |

|                      |              |
|----------------------|--------------|
| FINANCIAL PROJECT ID | 2380022-5219 |
| SHEET NO.            | 1            |

US 27 @ OAK VALLEY BLVD./N. GRASSY LAKE RD.  
SECTION 11200 M.P. 18.636  
LAKE COUNTY