

**SIGNAL HEAD DETAILS**

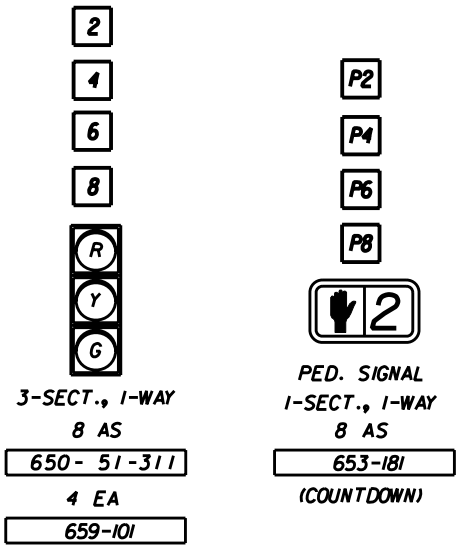

**INTERNALLY ILLUMINATED OVERHEAD SIGNS**

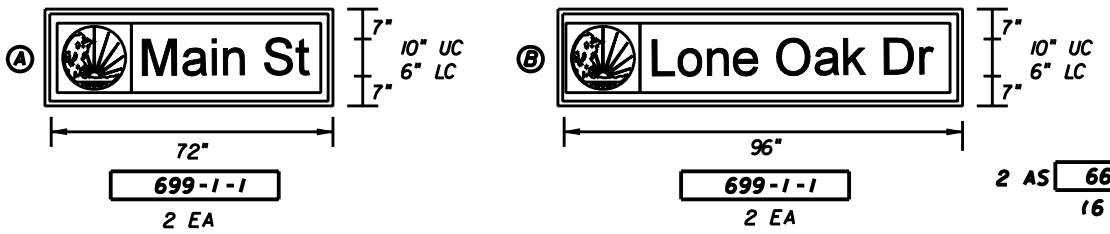

**MOVEMENT DIAGRAM**

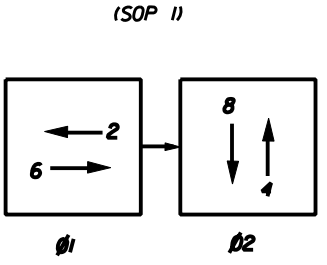

**CONTROLLER TIMINGS**

| TIMING FUNCTION  | 1 | 2   | 3 | 4  | 5 | 6   | 7 | 8  |
|------------------|---|-----|---|----|---|-----|---|----|
| MOVEMENT NUMBER  | 1 | 2   | 3 | 4  | 5 | 6   | 7 | 8  |
| MINIMUM GREEN    | - | 16  | - | 5  | - | 16  | - | 5  |
| EXTENSION        | - | 3.5 | - | 3  | - | 3.5 | - | 3  |
| MAXIMUM GREEN 1  | - | 50  | - | 30 | - | 50  | - | 21 |
| MAXIMUM GREEN 2  | - | -   | - | -  | - | -   | - | -  |
| YELLOW CLEARANCE | - | 4   | - | 4  | - | 4   | - | 4  |
| ALL RED          | - | 1.5 | - | 2  | - | 1.5 | - | 2  |
| PEDESTRIAN WALK  | - | 7   | - | 7  | - | 7   | - | 7  |
| PED. CLEARANCE   | - | 17  | - | 8  | - | 17  | - | 8  |
| RECALL           | - | MIN | - | -  | - | MIN | - | -  |

TIMINGS ARE INITIAL AND MAY REQUIRE FIELD ADJUSTING AS DIRECTED BY PROJECT ENGINEER.

- NOTES:**
1. LOOP SPACING BASED ON A SPEED LIMIT OF 40 MPH.
  2. EAST-WEST FACING HEADS SHALL HAVE BACKPLATES.
  3. MAJOR STREET IS MAIN STREET (2 & 6) AND MINOR STREET IS LONE OAK DR. (4 & 8).
  4. DURING FLASH OPERATION, SIGNAL HEADS 2 AND 6 SHALL FLASH YELLOW AND SIGNAL HEADS 4 AND 8 SHALL FLASH RED.
  5. LANDING PADS SHALL BE CONSTRUCTED CONCURRENTLY WITH THE SIGNAL INSTALLATION. SIDEWALK SHALL BE CONSTRUCTED BY OTHERS AT A LATER DATE.

**DETECTORS FOR LOOPS**

| NO. OF LOOPS | NO. OF LOOPS | NO. OF NEW DETS. | DELAY TIME (SECS.) |
|--------------|--------------|------------------|--------------------|
| L-2          | 1            | 1                | -                  |
| L-4          | 1            | 1                | -                  |
| L-6          | 1            | 1                | -                  |
| L-8          | 1            | 1                | -                  |

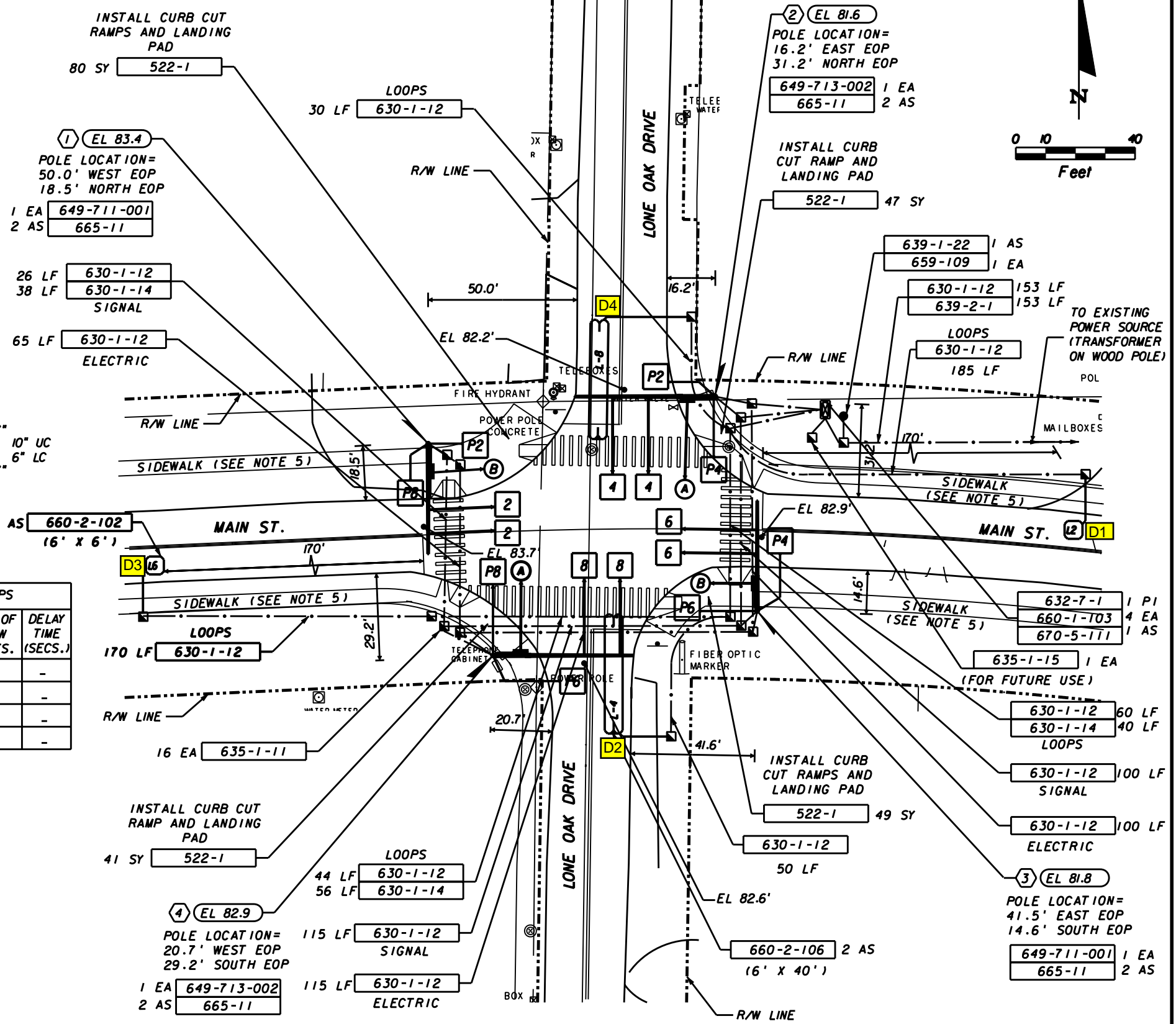

**REVISIONS**

| DATE | BY | DESCRIPTION | DATE | BY | DESCRIPTION |
|------|----|-------------|------|----|-------------|
|      |    |             |      |    |             |

| NAME   | DATE  | NAME            | DATE  |
|--|-------|-----------------|-------|
| DESIGNED BY: AJD                             | 10/05 | DRAWN BY: AJD   | 10/05 |
| CHECKED BY: RLL                              | 10/05 | CHECKED BY: RLL | 10/05 |
| SUPERVISED BY: DANTE A. GABRIEL, P.E. *37271 |       |                 |       |

GMB Engineers & Planners, Inc.  
3751 Maguire Boulevard, Suite 111  
Orlando, FL 32803  
Phone: 407-898-5424 Fax: 407-898-5425

LAKE COUNTY

**SIGNALIZATION PLAN**