

# SIGNALIZATION PLANS FOR VILLAGE CROSSROADS U.S. 27 / 441 and FENNELL BOULEVARD

SECTION 11230000, MILEPOST 0.801

TOWN OF LADY LAKE, FL

NOVEMBER, 2007

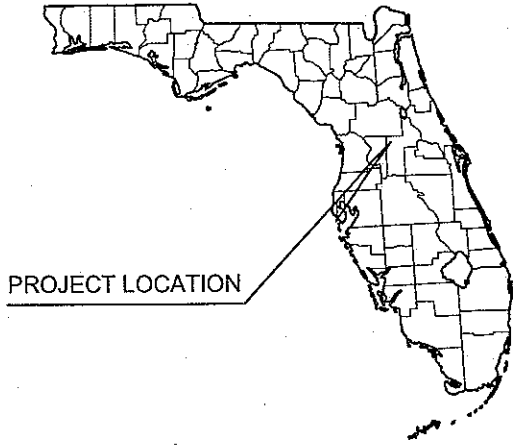

PROJECT LOCATION

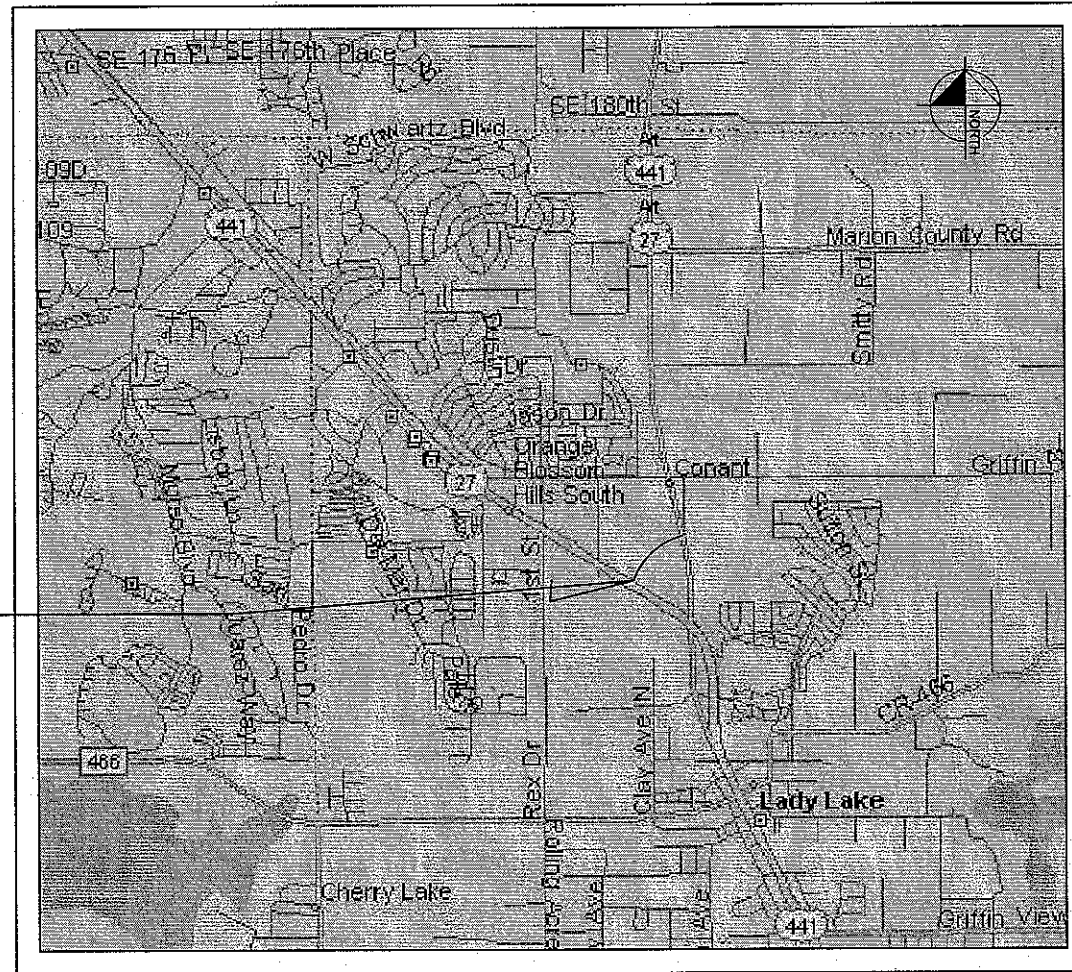

PROJECT LOCATION

VICINITY MAP  
N.T.S.

**SHEET INDEX**

SHEET NO.	DESCRIPTION
T1	KEY SHEET
T2	TABULATION OF QUANTITIES
T3	GENERAL NOTES
T4	SIGNALIZATION PLAN
T5	STRIPING MODIFICATION PLAN
T6	STRAIN POLE SCHEDULE
T7	GUIDE SIGN WORK SHEET

RECEIVED  
DEC 21 2007  
TRAFFIC OPERATIONS

APPLICABLE DESIGN STANDARDS MODIFICATIONS: 01/01/07  
FOR DESIGN STANDARDS MODIFICATIONS GO TO THE FOLLOWING WEB SITE:  
<http://www.dot.state.fl.us/rddesign/>

GOVERNING STANDARDS AND SPECIFICATIONS:  
FLORIDA DEPARTMENT OF TRANSPORTATION,  
DESIGN STANDARDS DATED 2006,  
AND STANDARD SPECIFICATIONS FOR ROAD  
AND BRIDGE CONSTRUCTION DATED 2007,  
AS AMENDED BY CONTRACT DOCUMENTS.

PREPARED BY  
 Kimley-Horn  
and Associates, Inc.  
© 2007 KIMLEY-HORN AND ASSOCIATES, INC.  
3660 Maguire Boulevard, Suite 200, Orlando, FL 32803  
Phone: (407) 898-1511 Fax: (407) 894-4791  
WWW.KIMLEY-HORN.COM CA 0000696

*Ronald C. Hildebrand*  
12/13/07  
RONALD C. HILDEBRAND, P.E.  
FL P.E. # 41936

Drawing name: G:\49372002 - Lady Lake - 42 Area Site\CADD\CIVIL\CONST\SIGNAL\T1-KEYSHEET\_Fennell.dwg T1 Dec 07, 2007 8:17am by: herrykates  
This document, together with the contracts and designs presented herein, is intended only for the specific purpose and client for which it was prepared. Release of and improper reliance on this document without written authorization and signature of Kimley-Horn and Associates, Inc. shall be without liability to Kimley-Horn and Associates, Inc.

APRIL 2007  
ENGINEER'S PROJECT No. 049372002

Drawing name: Q:\CADD\049372002 - Lady Lake - 42 Acre Site\CADD\CIVIL\CONST\SIGNAL\CROSSROADS\_LL\_Fennell\_Signal.dwg T2 Dec 07, 2007 10:18am by: don.moacher  
 This document, together with the concepts and designs presented herein, is intended only for the specific purpose and client for which it was prepared. Reuse of and improper reliance on this document without written authorization is prohibited by Kimley-Horn and Associates, Inc. and will be without liability to Kimley-Horn and Associates, Inc.

## TABULATION OF QUANTITIES

PAY ITEM NO.	DESCRIPTION	UNIT	SHEET NO.				TOTAL	
			T4		T5		PLAN	FINAL
			PLAN	FINAL	PLAN	FINAL		
102-99	CHANGEABLE VARIABLE MESSAGE SIGN - TEMPORARY	ED	28		-		28	
630-1-12	CONDUIT (FURNISH & INSTALL) (ABOVEGROUND)	LF	1345		-		1345	
630-1-14	CONDUIT (FURNISH) (UNDERGROUND JACKED)	LF	170		-		170	
632-7-1	CABLE (SIGNAL) (FURNISH & INSTALL)	PI	1		-		1	
634-4-112	SPAN WIRE ASSEMBLY (DIAGONAL)	PI	1		-		1	
635-1-11	PULL AND JUNCTION BOXES (F&I)	EA	15		-		15	
639-1-22	ELECTRICAL POWER SERVICE (UNDERGROUND)	AS	1		-		1	
639-2-1	ELECTRICAL SERVICE WIRE	LF	150		-		150	
641-41-112	PRESTRESSED CONCRETE POLE (TYPE NII SERVICE POLE)	EA	1		-		1	
641-17-152	PRESTRESSED CONCRETE POLE (TYPE N-VIII)	EA	1		-		1	
641-17-154	PRESTRESSED CONCRETE POLE (TYPE N-VIII)	EA	1		-		1	
650-51-313	SIGNAL TRAFFIC (F&I) (3 SECT 1 WAY) (L.E.D.)	AS	10		-		10	
653-191	SIGNAL, PEDESTRIAN (F&I) (L.E.D.-COUNTDOWN) (1-WAY)	AS	2		-		2	
659-106	SIGNAL HEAD AUXILIARIES (TUNNEL VISORS)	EA	30		-		30	
659-109	SIGNAL HEAD AUXILIARIES (CONCRETE PEDESTAL)	EA	2		-		2	
660-1-109	LOOP DETECTOR, INDUCTIVE (DELAY)	EA	6		-		6	
660-1-110	LOOP DETECTOR, INDUCTIVE	EA	1		-		1	
660-2-102	LOOP ASSEMBLY (TYPE B) (6'x6')	AS	8		-		8	
660-2-106	LOOP ASSEMBLY (TYPE F) (6'x40')	AS	6		-		6	
663-74-1	VEHICLE DETECTOR ASSEMBLY (OPTICAL) (2-WAY)	PI	1		-		1	
665-11	PEDESTRIAN DETECTOR	EA	2		-		2	
670-5-110	CNTL ASSEM ACT SS F&I NEMA	AS	1		-		1	
685-128	SYSTEM AUXILIARIES (INTERFACE PANEL)	EA	1		-		1	
699-1-1	INTERNALLY ILLUMINATED SIGN	EA	4		-		4	
700-20-11	SIGN, SINGLE POST (FURNISH & INSTALL) (LESS THAN 12)	AS	-		4		4	
700-20-60	SIGN, SINGLE POST (REMOVE)	AS	-		1		1	
700-46-11	REMOVE SIGN ASSEMBLY	AS	-		2		2	
706-3	REFLECTIVE PAVEMENT MARKERS (WHITE/RED)	EA	-		16		16	
711-11-121	THERMO., (STD) (WHITE) (SOLID) (6")	LF	-		350		350	
711-11-125	THERMO., (STD) (WHITE) (SOLID) (24")	LF	-		137		137	
711-11-170	THERMO., (STD) (WHITE) (ARROWS)	EA	-		2		2	
711-11-221	THERMO., (STD) (YELLOW) (SOLID) (6")	LF	-		70		70	
711-17	THERMO., (REMOVE)	SF	-		288		288	
783-6-1	ITS SPLICE BOX FOR FIBER OPTIC	EA	1		-		1	
999-2	GENERATOR PAD (3'x3'x4")	EA	1		-		1	

*Pat C Hill*  
12/13/07

SCALE AS NOTED DESIGNED BY DRAWN BY CHECKED BY	DESIGN ENGINEER Ronald C. Hill, P.E. FLORIDA REGISTRATION NUMBER 41936	KIMLEY-HORN and Associates, Inc. 2007 KIMLEY-HORN AND ASSOCIATES, INC. 3660 McGuire Boulevard, Suite 200, Orlando, FL 32803 Phone: (407) 858-1511 Fax: (407) 858-4791 WWW.KIMLEY-HORN.COM CA 0000096	REVISIONS No. DATE BY
TABULATION OF QUANTITIES		SEAL	
VILLAGE CROSSROADS		FLORIDA	
TOWN OF LADY LAKE		DATE Nov., 2007 PROJECT NO. 049372002 SHEET NUMBER T2	

Drawing name: Q:\CADD\049372002 - Lady Lake - 42 Acre Site\CADD\CIVIL\CONST\SIGNAL\CROSSROADS\_LL\_Fennell\_Signal.dwg T3 Dec 11, 2007 1:07pm by: den.mecher  
 This document, together with the concepts and designs presented herein, is intended only for the specific purpose and client for which it was prepared. Reuse of and incisor reliance on this document without written authorization and approval by Kimley-Horn and Associates, Inc. shall be without liability to Kimley-Horn and Associates, Inc.

GENERAL

- The Contractor shall verify color codes for signal cable with Steve Bollinger, Lake County Traffic Operations, 352-742-1766 before ordering.
- The Contractor is required to inspect the installation of the traffic signals in accordance with FDOT Specification 105-5.10. The Contractor shall coordinate the final acceptance inspection in accordance with FDOT Specification 611-2.2 with the Engineer at least ten days in advance. Steve Bollinger of Lake County Traffic Operations at (352) 742-1766 and Ray Marlin of FDOT at (386) 943-5318 should also be contacted ten days before the inspection is to be performed so they may be present.
- It should be noted that no test borings were made where conduit runs are to be installed by directional boring, or trenching. It shall be the Contractor's responsibility to examine job site conditions before submitting bid proposals in accordance with Section 2-4 of the Specifications.
- A pre-construction meeting shall be scheduled with Lake County Traffic Operations, (352) 742-1766, prior to any construction.
- All materials and hardware shall be F.D.O.T. approved, and pre-approved by Lake County Traffic Operations.
- The Contractor shall furnish Lake County Traffic Operations with emergency contacts and phone numbers and have an I.M.S.A. Level II or III certified signal technician on call within a two hour maximum response time.
- The Contractor shall furnish Lake County Traffic Operations two complete sets of As-Built Plans that include conduit and pull box locations, at final inspection.
- The Contractor shall notify Lake County Traffic Operations and FDOT 2 business days prior to beginning construction.
- Lane closures shall be allowed only between 7:00 pm and 7:00 am.
- The Contractor shall hand dig the first 4 feet at each pole location to verify there are no utility conflicts.

CONDUITS / PULL BOXES / CABLING

- All signal cable, loop cable, and communication cable shall be installed in separate pull boxes.
- Pull boxes and covers shall be FDOT approved of non-metallic construction with recessed cover logo "Traffic Signal" or "Fiber Optic" as appropriate.
- Multiple conduit runs in the same trench shall be Jack and bored or directional bored for the first conduit only. Subsequent conduit runs shall be paid for as underground.
- Conduit under reconstructed driveways shall be placed prior to placing pavement and shall be paid as underground conduit.
- Signal cable shall be attached to messenger wire using proper size spiral wrap.
- A fiber optic splice box and conduit into the controller assembly shall be furnished and installed.
- 'F' Type loops shall be 40' long by 6' wide and extend 5' beyond the stop line.
- Any new or existing striping cut because of loop placement shall be re-striped prior to acceptance.

TIMINGS / CONTROLLER

- The controller cabinet assembly shall be a Lake County Naztec Regional TS-2 with a TS-1 controller, ethernet enabled for the Lake County closed loop system. The additional equipment and accessories for the fiber optic cable interconnect shall be furnished and installed as part of the controller assembly.
- The controller shall be wired for future S.O.P. IO Operation.
- Delay times shall be set to 5 seconds.
- Spare cabinet conduit shall be stubbed and capped in the nearest pull box.
- Grounding for the controller assembly shall measure 25 ohms or less.
- The mounting of the electrical service to the traffic signal cabinet shall be prohibited.
- A manual pushbutton cord shall be furnished in the controller cabinet.
- The cabinet door shall open away from the intersection, within the FDOT right-of-way.
- Traffic signal shall flash for no less than 7 days and no more than 14 days prior to turn-on inspection. Contractor shall contact permit engineer 48 hours prior to turning signal on flash.
- Contractor shall contact permit engineer 48 hours before any directional bores.

SIGNAL HEADS

- All signal displays including pedestrian signals shall be LED.
- All signal head assemblies shall be black cast aluminum.
- All signal head assemblies shall include tunnel visors.
- The use of "Jones" plugs shall be prohibited.

PEDS

- Contractor to ensure that a 4'X4' flat landing is adjacent to all pedestrian buttons for pedestrian access.
- Three (3) spare conductors are to be run to the furthest pedestrian signal head.
- All pedestrian signals shall be 16" L.E.D., countdown type.
- Pushbuttons shall be Pelco oversized metal buttons or approved equal.

STREET NAME SIGNS

- All internally illuminated street name signs shall be illuminated by LED's installed one foot below the messenger cable, powered by a separate circuit breaker, and be installed in accordance with the internally illuminated Street Name Sign Detail for Lake County Public Works.

PAY ITEM NOTE

- Pay Item No. 102-99 shall include furnishing, installing, operating, and removing two (2) VMS's. The VMS's shall be installed along US 27/441 approximately 750 feet in advance of the proposed northbound and southbound stop bars. The VMS's shall be activated when the proposed signal is fully operational, and shall operate for 7 to 14 full days thereafter. The messages shall alternate and be as follows:

N	E	W				
S	I	G	N	A	L	
A	H	E	A	D		

- Pay Item Nos. 783-5-1 and 783-6-1 shall include all costs for furnishing and installing fiber optic pull boxes and splice boxes as specified in Specifications Section 783 attached hereto.
- Pay Item 639-1-22 The Contractor shall be responsible for contacting the power company providing the electrical power, to determine if any additional fees are required to connect power and for connection of power. If required, the fee shall be included as part of bid item payment for electrical service assembly. The Contractor is also responsible for acquiring the electrical permit and coordinating the application for power with the Town of Lady Lake.
- Pay Item Nos. 653-191 shall include FTP-25-04 and RIO-3E Modified signs without arrow.
- Pay Item No. 663-74-1 shall be bid, furnished, and installed as a per-intersection item, and shall include all equipment and timings fully operational and functional for each approach to the intersection. The brand of emergency preemption shall be Opticom.
- Pay Item No. 783-1-122 shall include all costs for furnishing and installing fiber optic cable as specified in Specifications Section 783 attached hereto.

All CADD  
 12/13/07

DESIGN ENGINEER	DESIGNED BY	DRAWN BY	CHECKED BY	SCALE	DATE	PROJECT NO.	SHEET NUMBER
Ronald C. Hubbard, P.E.	dcm	dcm	RCH	4:19.36	Nov., 2007	049372002	T3
SIGNALIZATION GENERAL NOTES				VILLAGE CROSSROADS			
				TOWN OF LADY LAKE FLORIDA			
Kimley-Horn and Associates, Inc.				3860 Maguire Boulevard, Suite 200, Orlando, FL 32803 Phone: (407) 886-1511 Fax: (407) 886-4791 WWW.KIMLEY-HORN.COM CA 0000086			

# SIGNAL DISPLAY DETAILS

ALL SIGNAL INDICATIONS SHALL BE L.E.D.

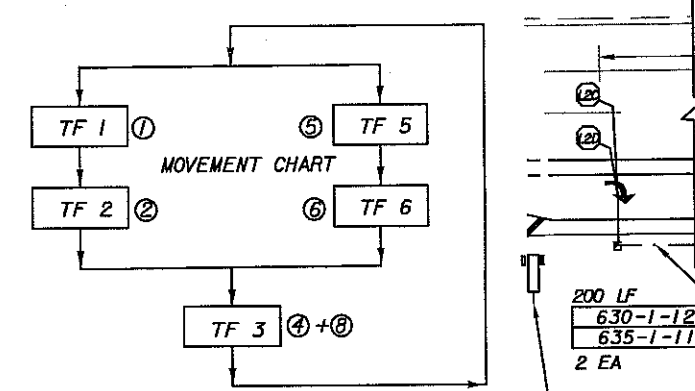
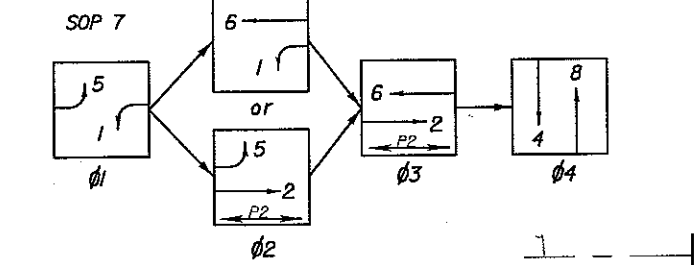
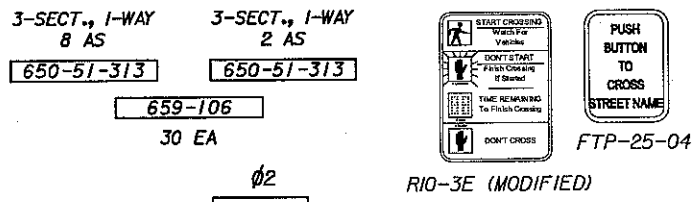
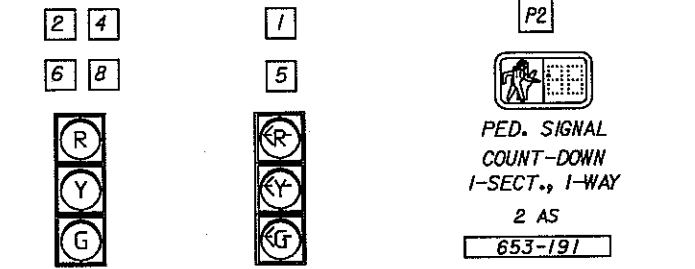

# SIGN DETAILS

INTERNALLY ILLUMINATED STREET NAME SIGNS (DOUBLE-SIDED) SEE SHEET T7 FOR DETAILS

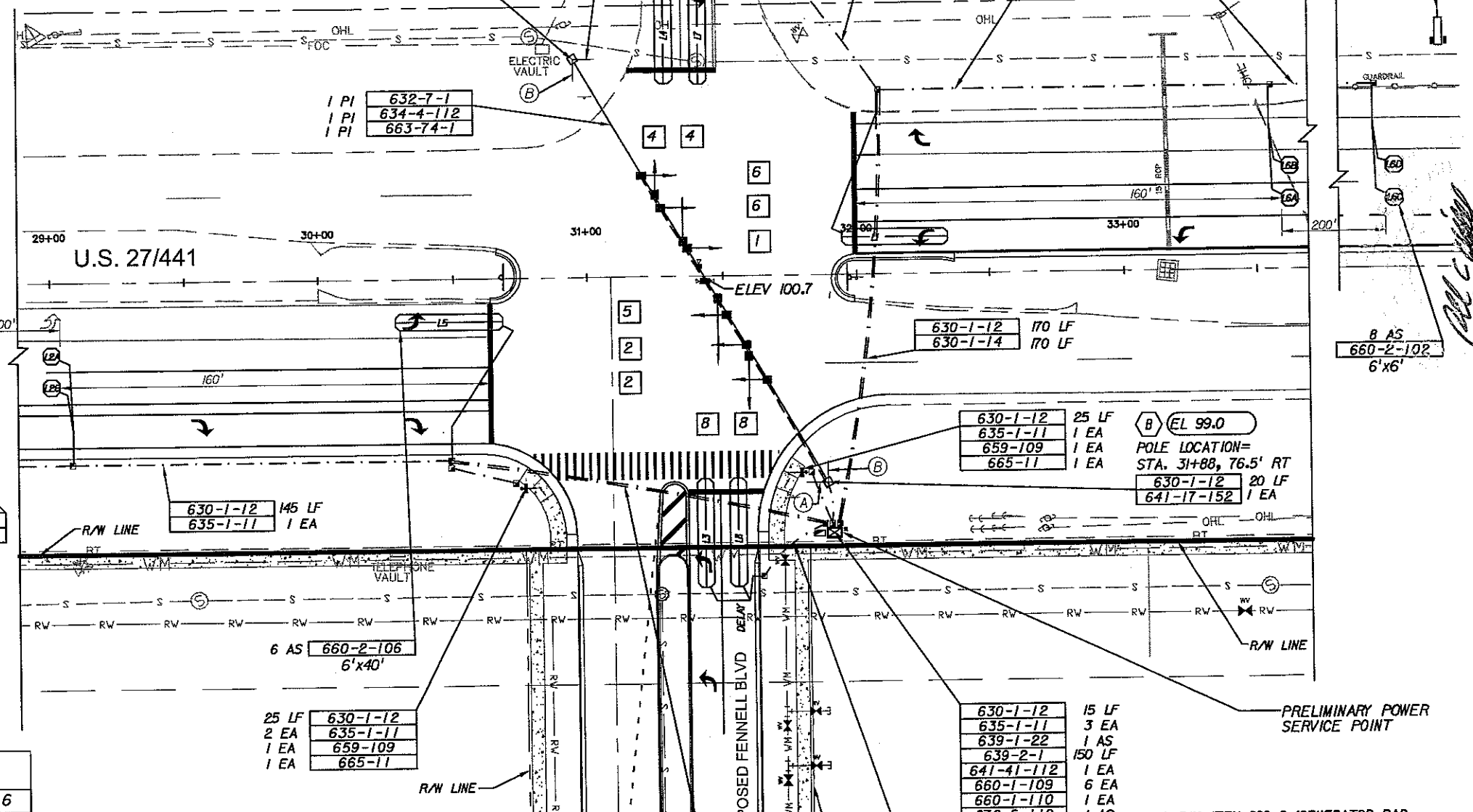
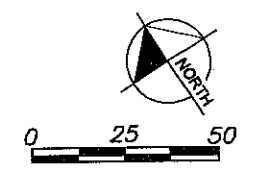
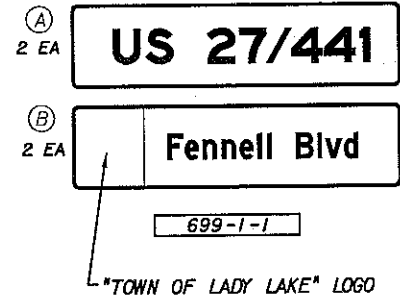

TIMING FUNCTION	1	2	3	5	6
MOVEMENT(S)	1	2	4,8	5	6
MINIMUM GREEN (INITIAL)	5	16	5	5	16
EXTENSION (PASSAGE)	3	3	3	3	3
MAXIMUM GREEN I	15	60	20	15	60
MAXIMUM GREEN II *	-	-	-	-	-
YELLOW	4.6	5.0	3.5	4.6	5.0
ALL RED	1.0	1.0	1.0	1.0	1.0
PEDESTRIAN WALK	-	7	-	-	=
FLASH DON'T WALK	-	13	-	-	-
RECALL	-	MIN	-	-	MIN
DETECTOR FUNCTION	NL	LOCK	NL	NL	LOCK

LOOP	NO. OF LOOPS	NO. OF DETS.	DETECTOR CHANNEL	DETECTOR OPERATION	TIMING FUNCTION	SECONDS OF DELAY
L1	1	1	1A	NORMAL	TF1	-
L2A,L2B,L2C,L2D	4	2	2A,2B,5A,5B	NORMAL	TF2	-
L3	1	1	3A	NORMAL	TF3	-
L4	1	1	4A	DELAY	TF3	5
L5	1	-	1B	NORMAL	TF5	-
L6A,L6B,L6C,L6D	4	2	6A,6B,7A,7B	NORMAL	TF6	-
L7	1	-	3B	NORMAL	TF3	-
L8	1	-	4B	DELAY	TF3	5

- NOTES:
- MAJOR STREET IS U.S. 27/441 (SPEED LIMIT 50). MINOR STREET IS FENNEL BLVD (SPEED LIMIT 30).
  - POWER SERVICE POINT SHALL BE VERIFIED AFTER A SITE VISIT WITH A POWER SERVICE REPRESENTATIVE.
  - FLASHING OPERATION: 2 AND 6 YELLOW. ALL OTHER HEADS RED.
  - INITIAL S.O.P. 7 PHASING. INTERSECTION SHALL BE WIRED FOR FUTURE S.O.P. 10 PHASING.
  - FOR STRIPING REVISIONS TO THE INTERSECTION, SEE SHEET T5.

DESIGN ENGINEER: Ronald C Hildebrand, P.E.  
 SCALE: AS NOTED  
 DESIGNED BY: gcm  
 DRAWN BY: gcm  
 CHECKED BY: RCH  
 SEAL: [Signature]  
 PROJECT NO. 049372002  
 SHEET NUMBER T4  
 TOWN OF LADY LAKE, FLORIDA  
 Kimley-Horn and Associates, Inc.  
 2007 KIMLEY-HORN AND ASSOCIATES, INC.  
 3800 Lake Nona Boulevard, Suite 200, Orlando, FL 32803  
 Phone: (407) 884-1791  
 WWW.KIMLEY-HORN.COM

Drawing name: G:\CADD\049372002 - Lady Lake - 42 Acre Site\CADD\CIVIL\CONSTR\SIGNAL\CROSSROADS\_U\_S\_Fennell\_Signal.dwg T4 Dec 07, 2007 10:21am by: don.macher  
 This document, together with the concepts and design presented herein, is intended only for the specific purpose and client for which it was prepared. Review of and proper reliance on this document without written authorization and adoption by Kimley-Horn and Associates, Inc. shall be without liability to Kimley-Horn and Associates, Inc.

Drawing name: G:\CADD\049372002 - Lady Lake - 42 Acra Site\CADD\CIVIL\CONST\SIGNAL\CROSSROADS\_LL\_Fennell\_stripping.dwg T5-stripping Dec 07, 2007 9:41am by: don.mocher  
 This document, together with the concepts and designs presented herein, is intended only for the specific purpose and client for which it was prepared. Please do not disseminate or use for any other purpose without the written consent of Kinley-Horn and Associates, Inc. Kinley-Horn and Associates, Inc. shall be without liability to Kinley-Horn and Associates, Inc.

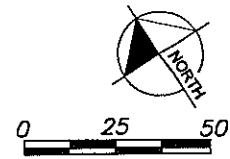
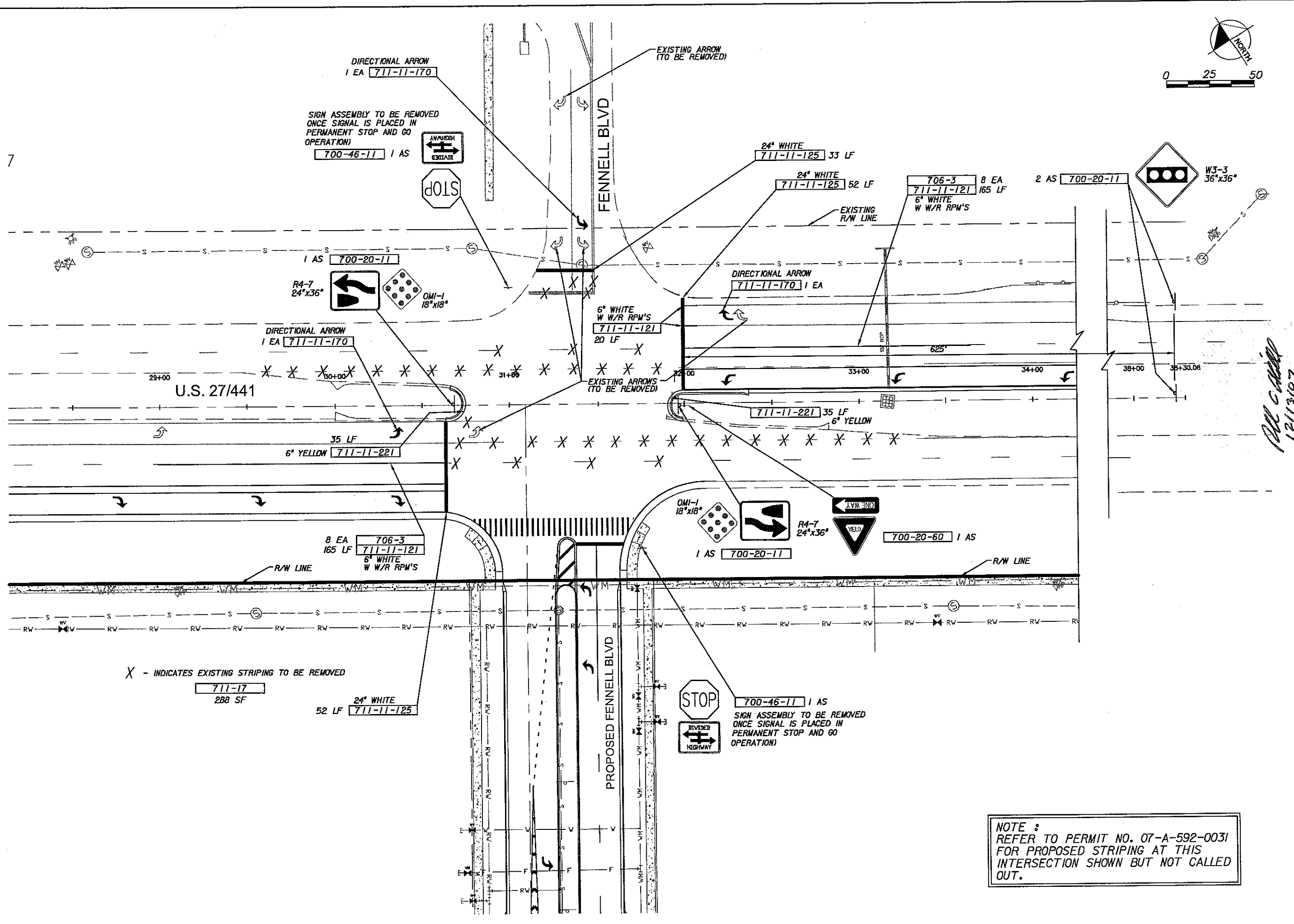

X - INDICATES EXISTING STRIPING TO BE REMOVED

NOTE :  
 REFER TO PERMIT NO. 07-A-592-0031  
 FOR PROPOSED STRIPING AT THIS  
 INTERSECTION SHOWN BUT NOT CALLED  
 OUT.

SHEET NUMBER		T5	
PROJECT NO.		049372002	
DATE		Nov, 2007	
TOWN OF LADY LAKE		FLORIDA	
VILLAGE CROSSROADS		STRIPING MODIFICATION PLAN	
SCALE	AS NOTED	DESIGNED BY	dcm
DRAWN BY	dcm	CHECKED BY	RCH
DESIGN ENGINEER	Ronald C. Hildebrand, P.E.		
FLORIDA REGISTRATION NUMBER	41936		
SEAL	[Signature]		
DATE	12/13/07		
REVISIONS	No.		
BY	[Signature]		

**Kinley-Horn and Associates, Inc.**  
 2007 KIMLEY-HORN AND ASSOCIATES, INC.  
 3660 Maguire Boulevard, Suite 200, Orlando, FL 32803  
 Phone: (407) 888-1511 Fax: (407) 888-4791  
 WWW.KIMLEY-HORN.COM CA 06030586

Drawing name: Q:\CADD\049372002 - Lady Lake - 42 Acre Site\CADD\CIVIL\CONST\SIGNAL\CROSSROADS\_LL\_Fennell\_Signal.dwg T6 Dec 13, 2007 2:27pm by: donmachner

This document, together with the concepts and designs presented herein, is an instrument of service, is intended only for the specific purpose and client for which it was prepared. Reuse of any information contained herein without written authorization and approval by Kimley-Horn and Associates, Inc. shall be without liability to Kimley-Horn and Associates, Inc.

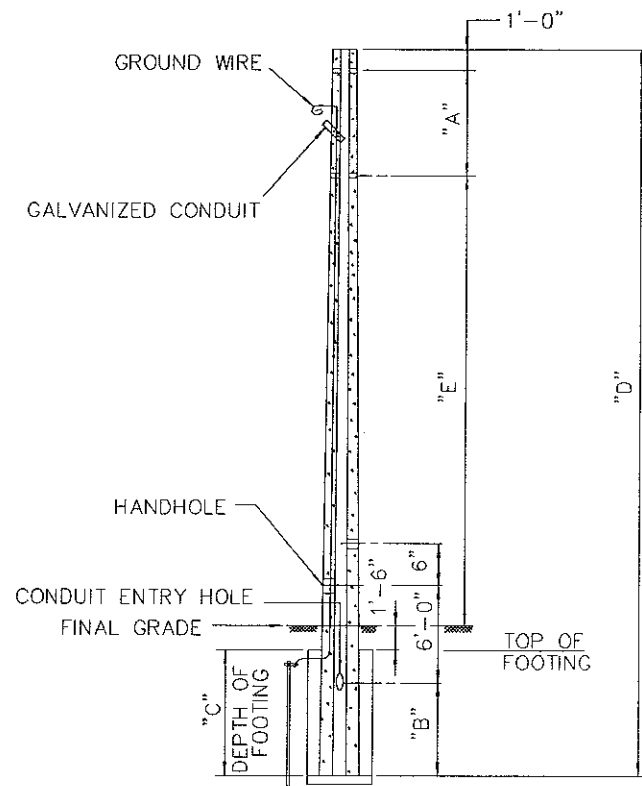

DETAIL OF PRESTRESSED CONCRETE

STRAIN POLE NOTES

1. THIS DESIGN IS FOR A SPAN WIRE ASSEMBLY WITH TWO POINTS ATTACHMENT. INSTALLATION SHALL BE IN ACCORDANCE WITH THE 2007 EDITION OF THE STANDARD SPECIFICATIONS FOR ROAD AND BRIDGE CONSTRUCTION.
2. DESIGN PARAMETERS:
  - COHESIONLESS SOIL
  - SOIL FRICTION ANGLE = 29 DEGREES
  - SOIL WEIGHT (SUBMERGED) = 45.6 pcf
  - DESIGN WIND SPEED = 110 mph
3. ALL LABOR, MATERIALS, AND EXPENSES FOR DESIGN, FURNISHING AND INSTALLING THESE POLES SHALL BE INCLUDED IN BID ITEMS 641-17-152 AND 641-17-154.
4. ALL DIMENSIONS ARE IN FEET UNLESS OTHERWISE SPECIFIED.

CONCRETE STRAIN POLE SCHEDULE													
POLE DATA										CABLE DATA		MINIMUM MOMENT CAPACITY (KIP-FT)	
STATION / OFFSET	POLE NO.	SPAN NO.	TYPE	A	B	C	D	E	ITEM NO.	QUAN.	CATENARY SIZE (in)		MESSENGER SIZE (in)
30+96, 80.5' LT	A	A-B	N-VIII	10	15	16	54	25.5	641-17-154	1	3/8"	1/2"	346
31+88, 76.5' RT	B	A-B	N-VIII	10	14	15	52	24.5	641-17-152	1	3/8"	1/2"	338

DESIGN ENGINEER: Angelina G. Forchid, P.E. FLORIDA REGISTRATION NUMBER: 4395B	SCALE: AS NOTED DESIGNED BY: dcm DRAWN BY: dcm CHECKED BY: RCH	DESIGNER'S SEAL	NO.	REVISIONS	DATE	BY
<p>© 2007 KIMLEY-HORN AND ASSOCIATES, INC. 3660 Maguire Boulevard, Suite 200, Orlando, FL 32803 Phone: (407) 888-1511 Fax: (407) 884-7791 WWW.KIMLEY-HORN.COM CA 00000696</p>						
<p>VILLAGE CROSSROADS TOWN OF LADY LAKE FLORIDA</p>			<p>STRAIN POLE SCHEDULE</p>			
<p>DATE: Nov., 2007 PROJECT NO.: 049372002 SHEET NUMBER: T6</p>			<p>12/13/07</p>			

Drawing name: C:\CADD\049372002 - Lady Lake - 42 Acre Site\CADD\CIVIL\CONSTR\SIGNAL\CROSSROADS\_LL\_Fennell\_Signals.dwg T7 Dec 07, 2007 10:49am by: dan.machter  
This document, together with the concepts and designs presented herein, is intended only for the specific purpose and client for which it was prepared. Reuse of and improper reliance on this document without written authorization and adaptation by Kimley-Horn and Associates, Inc. shall be without liability to Kimley-Horn and Associates, Inc.

SIGN NUMBER	A
QUANTITY	2
WIDTH	8'-0"
HEIGHT	2'-0"
BORDER WIDTH	1"
BORDER RADI	2"
BACKGROUND COLOR	Green
LEGEND & BORDER COLOR	White
STATION(S)	none
SYMBOL(S)	X Y WID HT

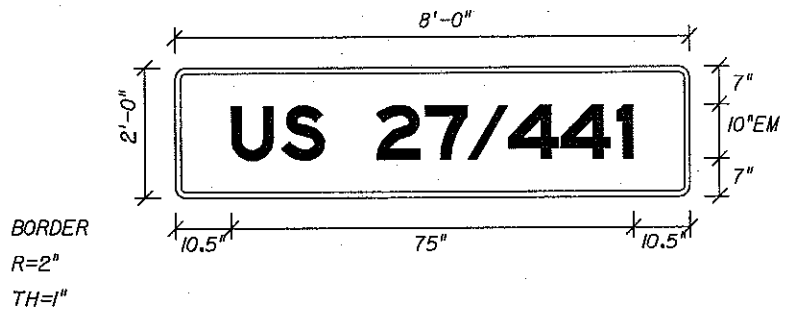

COPY	U	S	2	7	/	4	4	1	L										
SPACE	10.5	9.5	8	10	9.2	8	7.3	9.6	10.5	3	10.5	75							
COPY																			
SPACE																			
COPY																			
SPACE																			
COPY																			
SPACE																			
COPY																			
SPACE																			
COPY																			
SPACE																			

SIGN NUMBER	
QUANTITY	
WIDTH	
HEIGHT	
BORDER WIDTH	
BORDER RADI	
BACKGROUND COLOR	
LEGEND & BORDER COLOR	
STATION(S)	
SYMBOL(S)	X Y WID HT

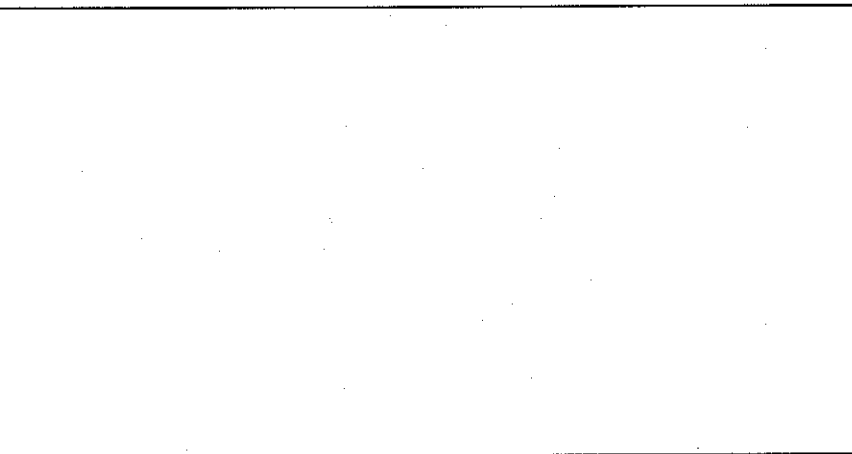

SIGN NUMBER	B
QUANTITY	2
WIDTH	8'-0"
HEIGHT	2'-0"
BORDER WIDTH	1"
BORDER RADI	2"
BACKGROUND COLOR	Green
LEGEND & BORDER COLOR	White
STATION(S)	none
SYMBOL(S)	X Y WID HT

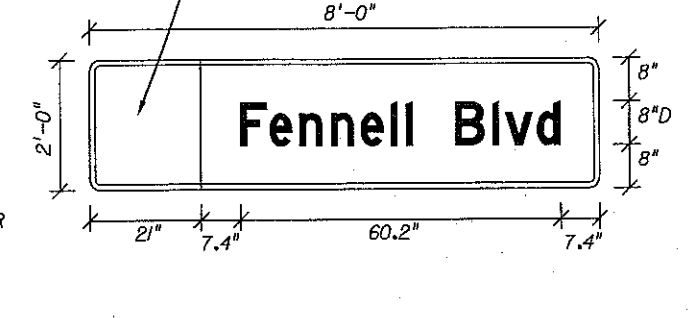

COPY	F	e	n	n	e	l	l	B	I	v	d	L							
SPACE	28.4	5.4	5.7	6	5.6	5.7	2.9	1.3	8	7	2.5	5.9	4.3	7.4	60.2				
COPY																			
SPACE																			
COPY																			
SPACE																			
COPY																			
SPACE																			
COPY																			
SPACE																			
COPY																			
SPACE																			
COPY																			
SPACE																			

SIGN NUMBER	
QUANTITY	
WIDTH	
HEIGHT	
BORDER WIDTH	
BORDER RADI	
BACKGROUND COLOR	
LEGEND & BORDER COLOR	
STATION(S)	
SYMBOL(S)	X Y WID HT

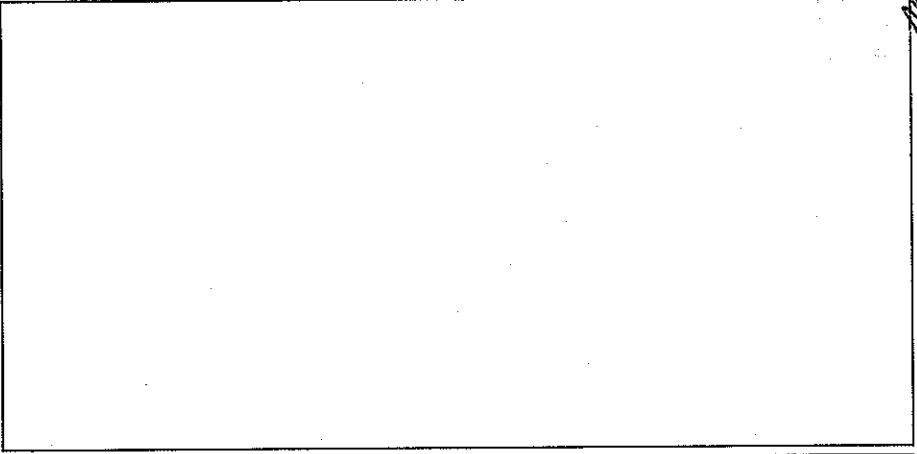

COPY																			
SPACE																			
COPY																			
SPACE																			
COPY																			
SPACE																			
COPY																			
SPACE																			
COPY																			
SPACE																			
COPY																			
SPACE																			
COPY																			
SPACE																			

COPY																			
SPACE																			
COPY																			
SPACE																			
COPY																			
SPACE																			
COPY																			
SPACE																			
COPY																			
SPACE																			
COPY																			
SPACE																			
COPY																			
SPACE																			

DATE		BY	
Nov., 2007			
PROJECT NO.		REVISONS	
049372002		No.	
SHEET NUMBER		No.	
T7			
DESIGN ENGINEER: Ronald C. Hildebrand, P.E. FLORIDA REGISTRATION NUMBER: 41936			
DESIGNED BY		DRAWN BY	
dcm		dcm	
CHECKED BY		RCH	
SEAL			
GUIDE SIGN WORK SHEET			
VILLAGE CROSSROADS FLORIDA			
TOWN OF LADY LAKE			
Kimley-Horn and Associates, Inc. 3660 Bayside Parkway, Suite 200, Orlando, FL 32803 Phone: (407) 889-1511 Fax: (407) 884-4791 WWW.KIMLEY-HORN.COM CA 00000986			