

SIGNAL DISPLAY DETAILS
ALL INDICATIONS SHALL BE L.E.D.

2 4 6 8



3-SECT., 1-WAY
7 AS
650-51-313

1 5



3-SECT., 1-WAY
2 AS
650-51-313

3 8 7 4

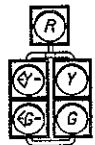

5-SECT., 1-WAY
2 AS
650-51-513

BACKPLATES REQUIRED FOR
SIGNAL HEADS FACING
EAST/WEST DIRECTION

659-101 3 EA
659-118 2 EA

PEDESTRIAN DISPLAY DETAILS

P2 P4 P6 P8



PED. SIGNAL
COUNT-DOWN
1-SECT., 1-WAY
4 AS
653-191

P2 P4 P6 P8



PED. SIGNAL
COUNT-DOWN
1-SECT., 2-WAY
2 AS
653-192



FTP-25-04

RIO-3E (MODIFIED)

DELAY TIME IS INITIAL AND MAY REQUIRE FIELD
ADJUSTING AS DIRECTED BY PROJECT ENGINEER.

DETECTORS FOR LOOPS

LOOP	NO. OF LOOPS	DETECT. CHANNEL	DELAY TIME (SEC)	TIMING FUNCTION
L-1	1	1A	-	1
L-2A	1	2A	-	2
L-2B	1	2B	-	2
L-3A	1	3A	-	3
L-3B	1	3B	-	3
L-4	1	4A	5	4
L-5	1	5A	-	5
L-6A	1	6A	-	6
L-6B	1	6B	-	6
L-7	1	7A	-	4
L-8	1	8A	5	3

CONTROLLER TIMINGS

TIMING FUNCTION	1	2	3	4	5	6
MOVEMENT NUMBER	1	2	3,8	4,7	5	6
MINIMUM GREEN	4	15	6	6	4	15
EXTENSION	3	3	3	3	3	3
MAXIMUM GREEN 1	20	45	30	30	20	45
MAXIMUM GREEN 2	-	-	-	-	-	-
YELLOW CLEARANCE	4.0	4.0	4.0	3.5	4.0	4.0
ALL RED	1.0	1.0	1.0	1.0	1.0	1.0
PEDESTRIAN WALK	-	7	7	7	-	7
PED. CLEARANCE	-	20	25	25	-	15
RECALL	-	MIN	-	-	-	MIN
DETECTOR FUNC.	NL	L	NL	NL	NL	L

SIGNAL OPERATING PLAN

SOP 9

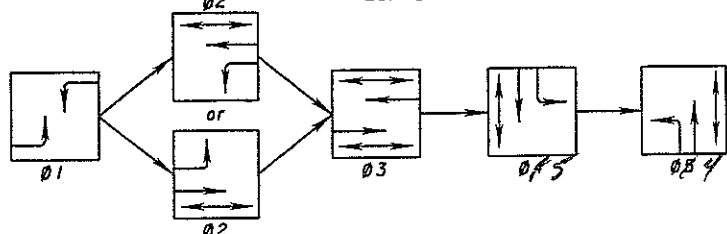

- NOTES:
- MAJOR STREET IS U.S. 27/441 (SPEED LIMIT 40 MPH). MINOR STREETS ARE C.R. 466 AND LEMON STREET (SPEED LIMIT 35 MPH).
 - POWER SERVICE POINT SHALL BE VERIFIED AFTER A SITE VISIT WITH A POWER SERVICE REPRESENTATIVE.
 - FLASHING OPERATION: 2 AND 6 YELLOW. ALL OTHER HEADS RED.
 - S.O.P. 9 WITH CONCURRENT PEDESTRIAN PHASES P2 (MOVEMENT 2), P4 (MOVEMENT 4), P6 (MOVEMENT 6) AND P8 (MOVEMENT 8).
 - SEE GUIDE SIGN WORK SHEET FOR SIGN DETAILS.

REVISIONS

DATE	BY	DESCRIPTION	DATE	BY	DESCRIPTION

Kimley-Horn and Associates, Inc.
Certificate of Authorization No. 696
Ronald C. Hildebrand, P.E.
License No. 41936
3660 Maguire Boulevard, Suite 200
Orlando, FL 32803-3062

COUNTY ROAD 466
LAKE COUNTY, FLORIDA

SIGNALIZATION PLAN

SHEET NO.

62

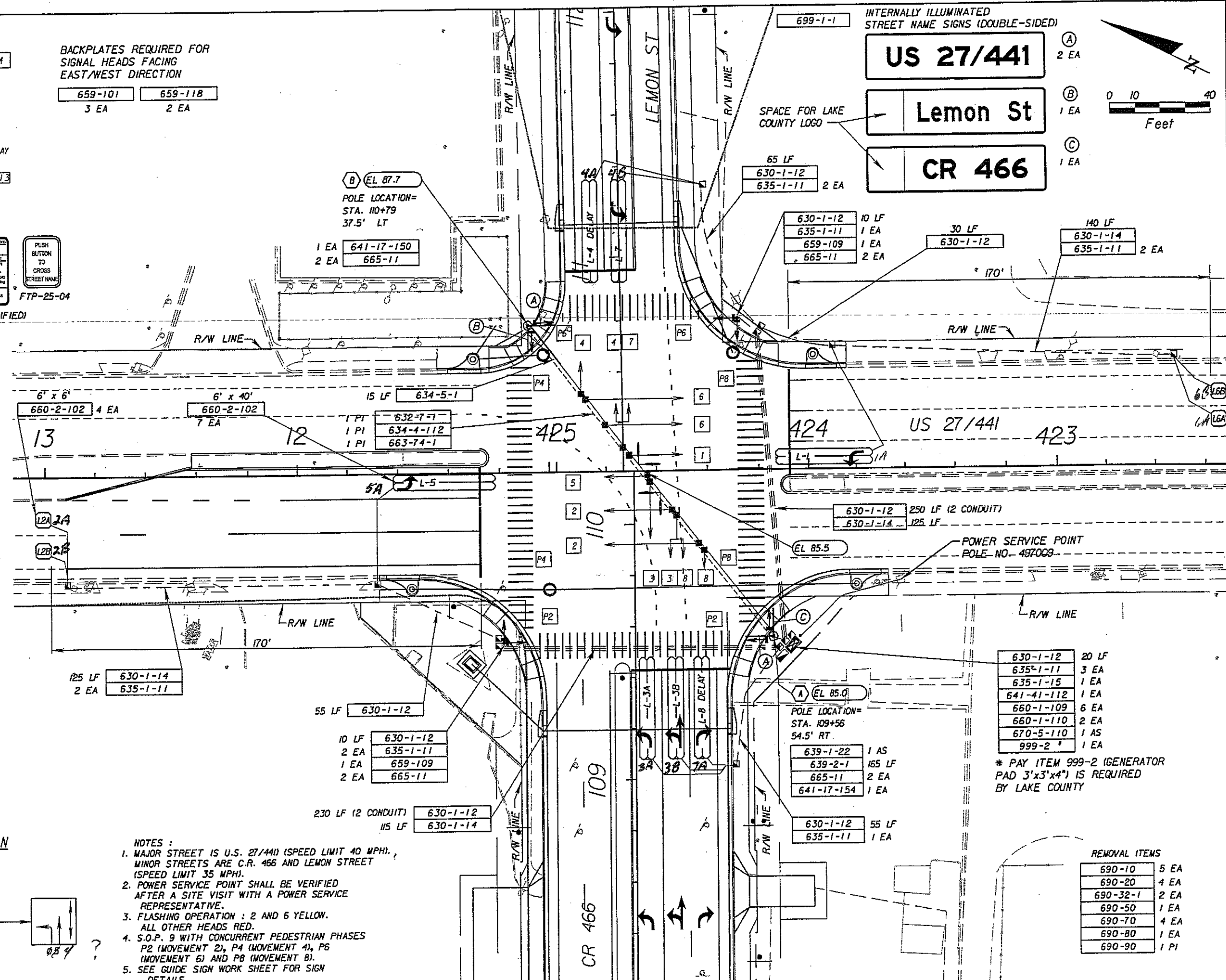

INTERNALLY ILLUMINATED
STREET NAME SIGNS (DOUBLE-SIDED)

US 27/441 2 EA
Lemon St 1 EA
CR 466 1 EA

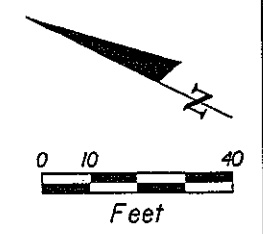

630-1-12 20 LF
635-1-11 3 EA
635-1-15 1 EA
641-41-112 1 EA
660-1-109 6 EA
660-1-110 2 EA
670-5-110 1 AS
999-2 1 EA

* PAY ITEM 999-2 (GENERATOR PAD 3'x3'x4") IS REQUIRED BY LAKE COUNTY

REMOVAL ITEMS

690-10 5 EA
690-20 4 EA
690-32-1 2 EA
690-50 1 EA
690-70 4 EA
690-80 1 EA
690-90 1 PI