

MATCHLINE STA. 98+88.013 (FOR INTERCONNECT SEE 301)

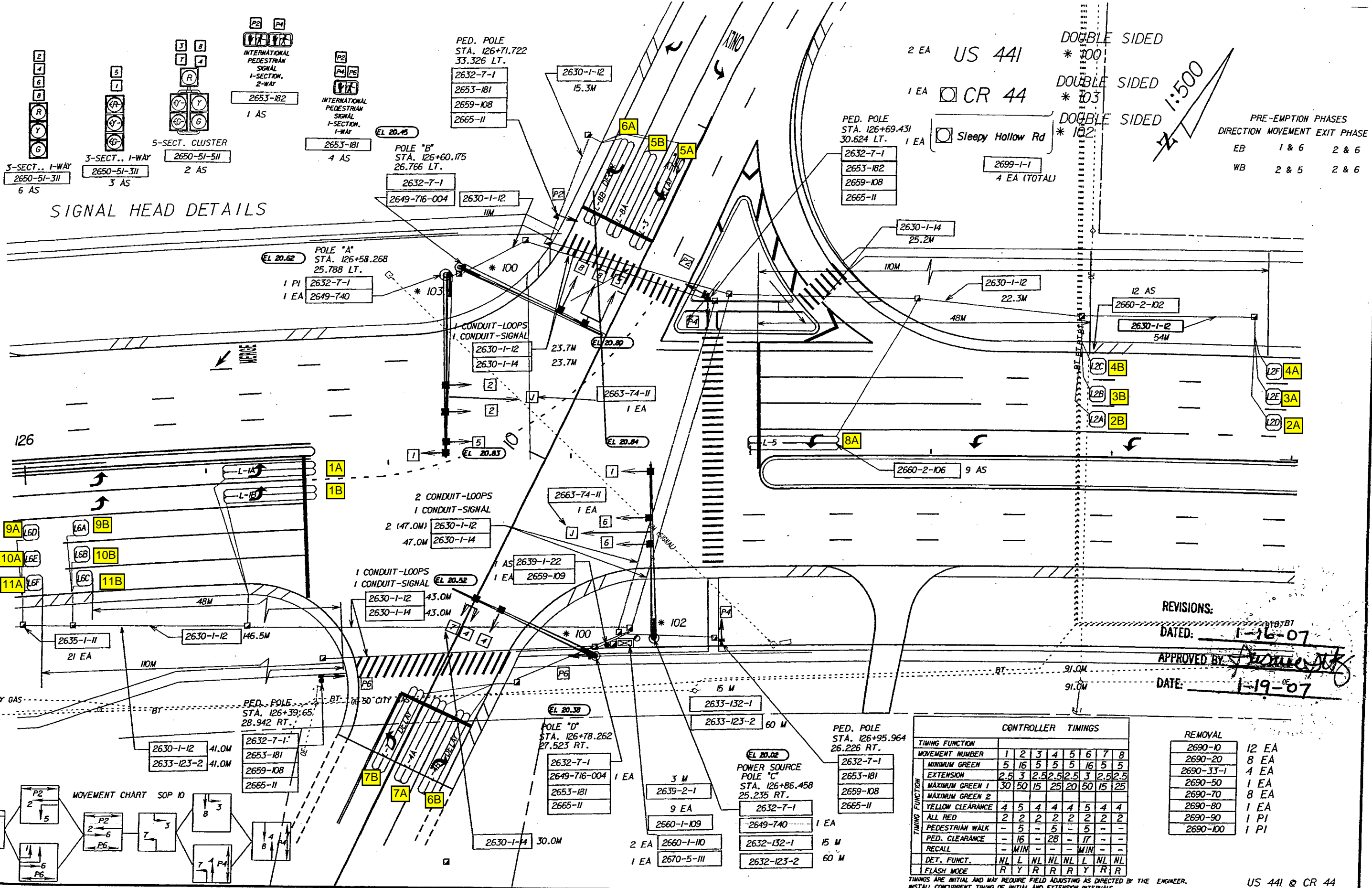

PRE-EMPTION PHASES

DIRECTION	MOVEMENT	EXIT PHASE
EB	1 & 6	2 & 6
WB	2 & 5	2 & 6

REVISIONS:
 DATED: 1-16-07
 APPROVED BY: [Signature]
 DATE: 1-19-07

CONTROLLER TIMINGS

MOVEMENT NUMBER	1	2	3	4	5	6	7	8
MINIMUM GREEN	5	16	5	5	5	16	5	5
EXTENSION	2.5	3	2.5	2.5	2.5	3	2.5	2.5
MAXIMUM GREEN 1	30	50	15	25	20	50	15	25
MAXIMUM GREEN 2								
YELLOW CLEARANCE	4	5	4	4	4	5	4	4
ALL RED	2	2	2	2	2	2	2	2
PEDESTRIAN WALK	-	5	-	5	-	5	-	-
PED. CLEARANCE	-	16	-	28	-	17	-	-
RECALL	-	MIN	-	MIN	-	MIN	-	-
DET. FUNCT.	NL	L	NL	NL	NL	L	NL	NL
FLASH MODE	R	Y	R	R	R	Y	R	R

REMOVAL

2690-10	12 EA
2690-20	8 EA
2690-33-1	4 EA
2690-50	1 EA
2690-70	8 EA
2690-80	1 EA
2690-90	1 PI
2690-100	1 PI

REVISIONS

DATE	BY	DESCRIPTION	DATE	BY	DESCRIPTION
1/16/07	SSH	MODIFICATION TO MAST ARMS A & C INCLUDING SLIGHT SHIFTS IN HEADS			

DISTRICT FIVE
 Michael L. Cornejo
 P.E. No.: 47734
 719 South Woodland Blvd.
 DeLand, Florida 32720

STATE OF FLORIDA
 DEPARTMENT OF TRANSPORTATION

ROAD NO.	COUNTY	FINANCIAL PROJECT ID
SR 500	Lake	238315-1-52-01

SIGNALIZATION PLAN

SHEET NO. T-10