

**PRE-CONSTRUCTION NOTES:**

1. CONTRACTOR TO NOTIFY THE FLORIDA DEPARTMENT OF TRANSPORTATION SUSANNE HERTZ, @ 386-943-5332) AND LAKE COUNTY (FRED SCHNEIDER @ 352-253-4905) 48 HOURS PRIOR TO BEGINNING CONSTRUCTION.
2. CONTRACTOR TO SUBMIT ASPHALT AND CONCRETE DESIGN MIXES TO PROJECT ENGINEER PRIOR TO BEGINNING CONSTRUCTION.

**GENERAL NOTES:**

1. NO LANE CLOSURES FROM 8 AM TO 6 PM NORTHBOUND AND FROM 9 AM TO 6PM SOUTHBOUND ON US 27.
2. ALL LANE CLOSURES TO BE APPROVED BY THE PROJECT ENGINEER.
3. CONTRACTOR WILL NEED TO USE OPTIONAL SHOULDER TREATMENT FOR DROPOFF PROTECTION PER INDEX 600.
4. CONTRACTOR IS TO PLACE TURN ARROWS PER INDEX I7346.
5. CONTRACTOR IS TO TRANSITION THE PITCH OF THE SLOPE AT THE SOUTHBOUND LEFT TURN LANE TO THE TURNPIKE AT 1" PER 100' TOWARDS THE MEDIAN.
6. PROPOSED LANE WIDENING AND MEDIAN MODIFICATIONS SHALL PROVIDE PROPER DRAINAGE FLOW.

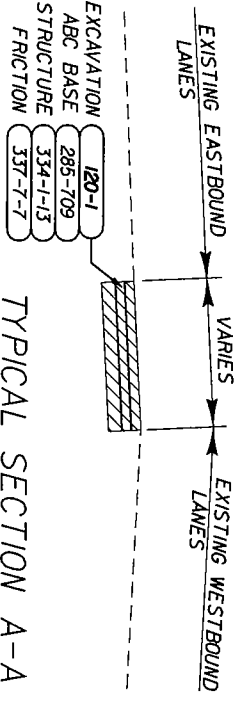
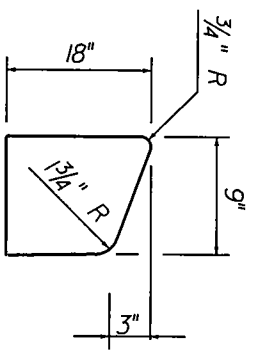

OPTIONAL BASE COURSE 9 (6") WITH STRUCTURAL COURSE SUPERPAVE TRAFFIC C (3") and FRICTION COURSE FC-9.5 (80 LB/SY) (RUBBER) (1")

WIDENING LIMITS N.T.S.

STA. 28+70.1 to STA. 29+83.7  
STA. 30+16.2 to STA. 30+75.0

**REVISIONS**

DESCRIPTION	DATE	BY	DESCRIPTION	NAME	DATE	DESIGNED BY	DATE	DRAWN BY	DATE	CHECKED BY	DATE	CHECKED BY	DATE
				EFD	11/04	SH		EFD	11/04	SH		SH	11/04
				SH	11/04	SH		SH	11/04	SH		SH	11/04

STATE OF FLORIDA  
DEPARTMENT OF TRANSPORTATION

US 27 @ SR 19 / FLORIDA TURNPIKE  
SECTION I1200 M.P. 23.520  
LAKE COUNTY

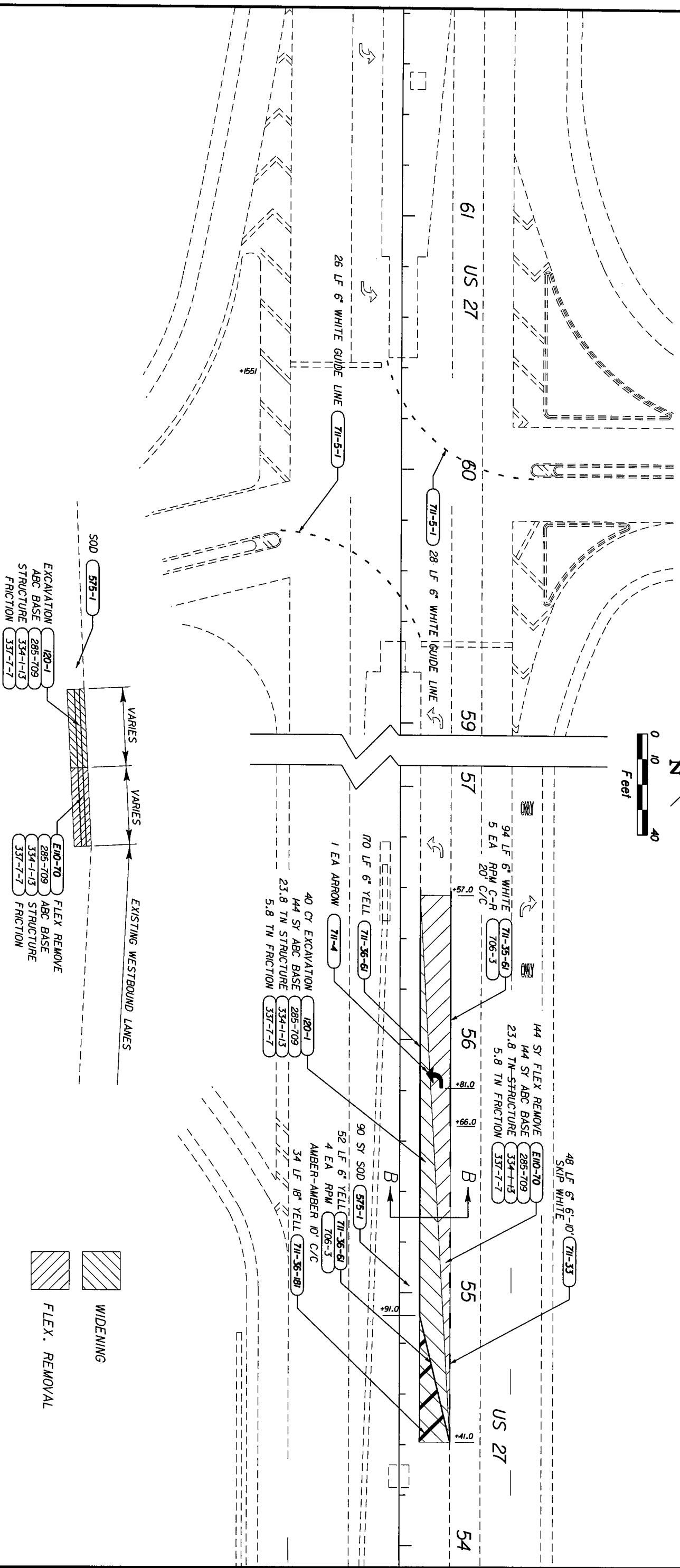
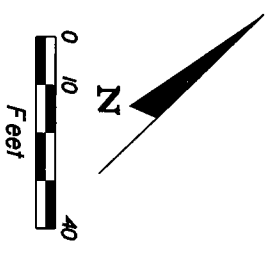

**TYPICAL SECTION B-B**

WIDENING LIMITS  
 STA. 54+41.0 to STA. 56+57.0  
 WIDENING  
 OPTIONAL BASE COURSE 9 (6") WITH  
 STRUCTURAL COURSE SUPERPAVE TRAFFIC C (3") and  
 FRICTION COURSE FC-9.5 (80 LB/SY) (RUBBER) (1")

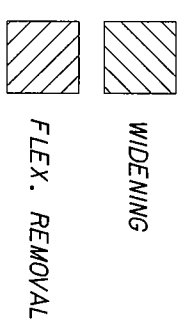

REVISIONS				STATE OF FLORIDA DEPARTMENT OF TRANSPORTATION			
DESCRIPTION	DATE	BY	DESCRIPTION	NAME	DATE	NAME	DATE
			DESIGNED BY	EFD	11/04	DRAWN BY	EFD
			CHECKED BY	SH	11/04	CHECKED BY	SH
			SUPERVISED BY	SUSANNE S. HERTZ, P.E.			

US 27 @ SR 19 / FLORIDA TURNPIKE  
 SECTION 11200 M.P. 23.520  
 LAKE COUNTY

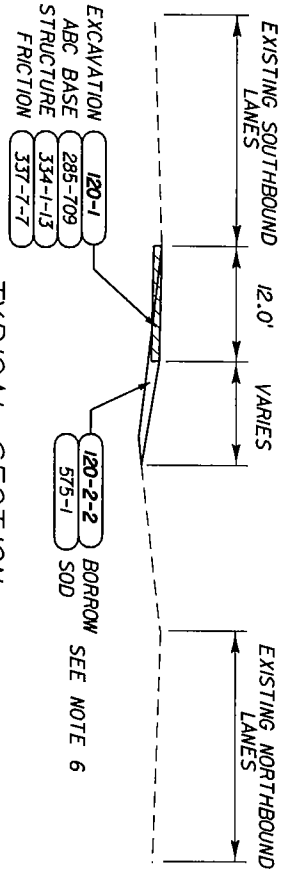
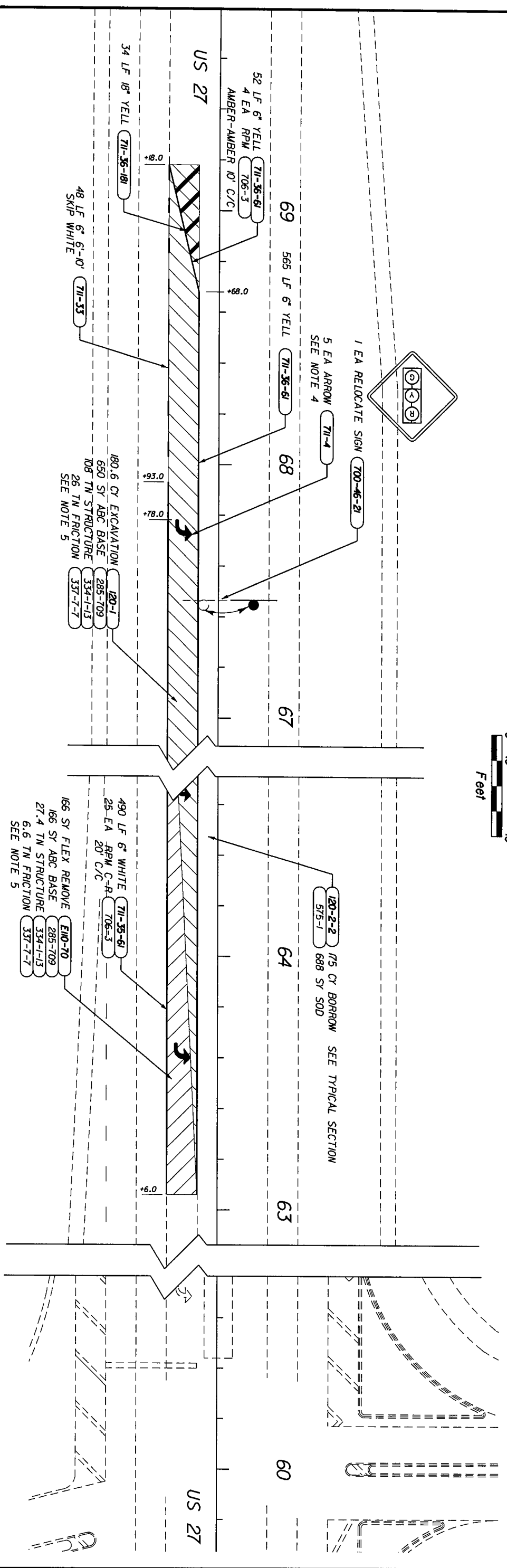
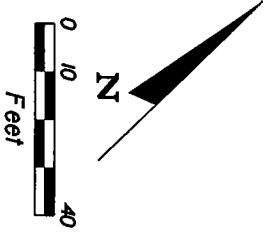

TYPICAL SECTION  
SCALE: 1" = 20'

WIDENING LIMITS  
STA. 63+6.0 to STA. 69+18.0  
WIDENING

OPTIONAL BASE COURSE 9 (6") WITH  
STRUCTURAL COURSE SUPERPAVE TRAFFIC C (3") AND  
FRICTION COURSE FC-9.5 (80 LB/SY) (RUBBER) (1")

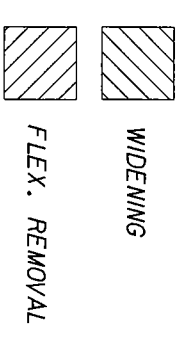

REVISIONS

DESCRIPTION	DATE	BY	DESIGNED	NAME	DATE	DRAWN	NAME	DATE
			EFD	EFD	11/04	SH	SH	11/04
			CHECKED	SH	11/04	CHECKED	SH	11/04
			BR	BR		BR	BR	

STATE OF FLORIDA  
DEPARTMENT OF TRANSPORTATION

US 27 @ SR 19 / FLORIDA TURNPIKE  
SECTION 11200 M.P. 23.520  
LAKE COUNTY

SUPERVISED BY: SUSANNE S. HERTZ, P.E.