

DETAIL OF SIGNAL HEADS

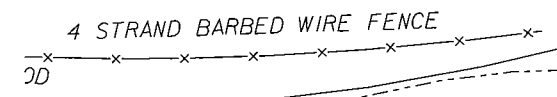

* EXISTING STOP SIGN TO BE REMOVED AFTER TRAFFIC SIGNAL GOES INTO OPERATION.

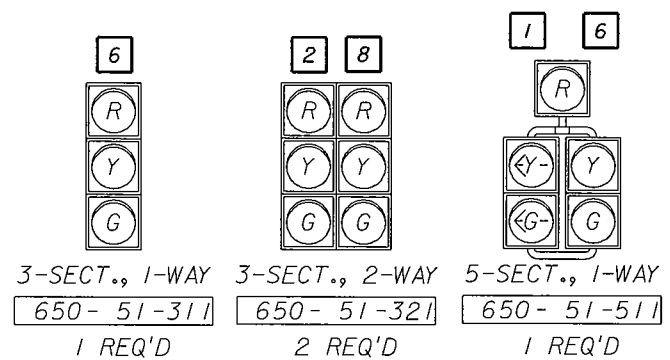
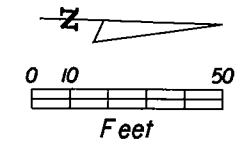
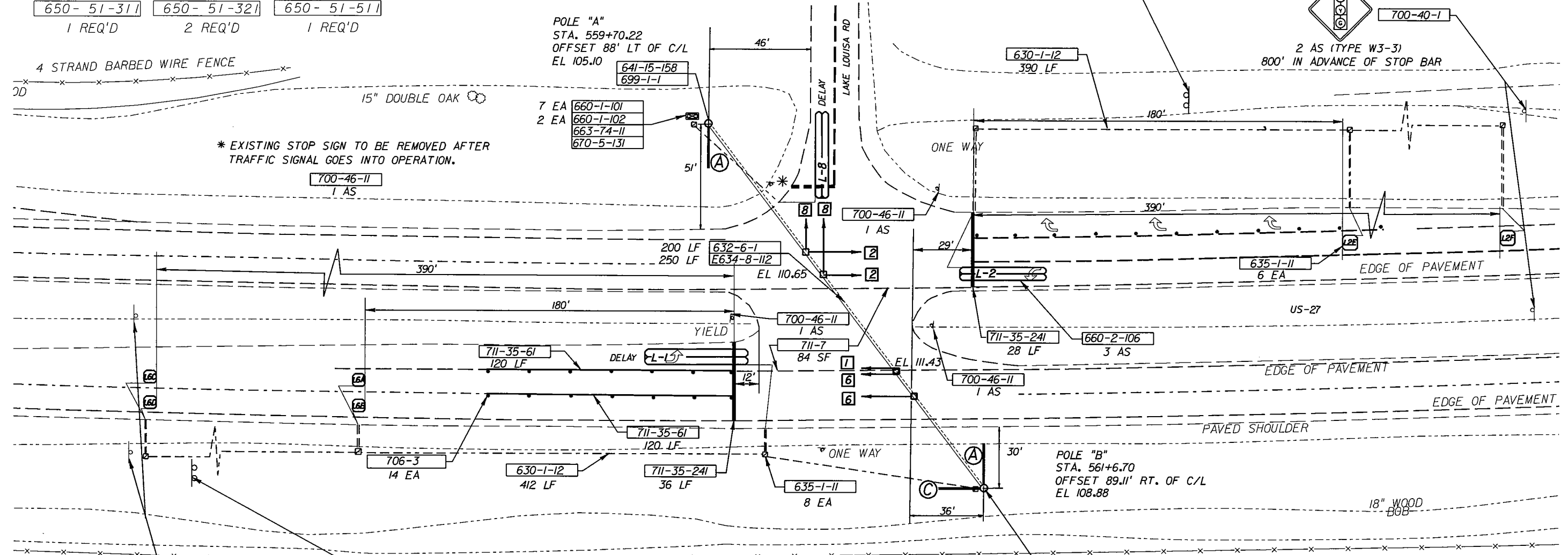

MOVEMENT CHART
SOP 12

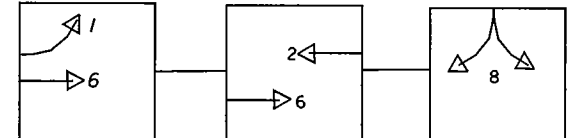

FLASH MODE

Movement	Indication
2 & 6	Yellow
8	Red

CONTROLLER TIMINGS

MOVEMENT	MIN.	EXT.	MAX.	CLEAR	ALL RED	WALK	FDW.	RECALL	DETECTOR FUNCTION
1	5	3	20	4	2			OFF	NL
2 & 6	17	3	30	5	2			MIN.	LOCK
8	5	3	15	4	2			OFF	NL

INTERNALLY ILLUMINATED
CANTILEVER ARM MOUNTED
STREET NAME SIGNS

REVISIONS					
DATE	BY	DESCRIPTION	DATE	BY	DESCRIPTION

STATE OF FLORIDA DEPARTMENT OF TRANSPORTATION		
ROAD NO.	COUNTY	FINANCIAL PROJECT ID
US-27	LAKE	238002 1 52 49

US 27 * LAKE LOUISA RD
SECTION 11200 MP 10.258

SHEET NO.
T-1

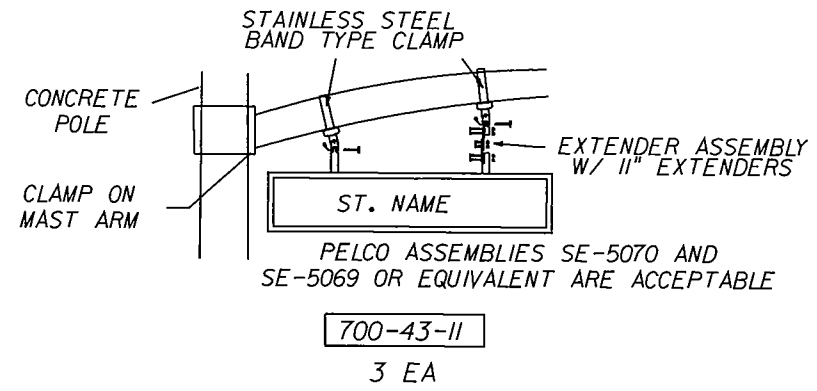

UTILITY CONTACTS 48 HRS PRIOR TO CONSTRUCTION:

- CITY OF CLERMONT - TAMARA RICHARDSON - 352-394-4083
- BRIGHT HOUSE NETWORKS - LARRY HENDERSON - 386-445-8804 EXT 1308
- PROGRESS ENERGY - BRIAN HATTON - 863-678-4550
- BROADWING - JERRY HAMMES - 407-859-7661
- LAKE APOPKA NATURAL GAS - RICK GULLET - 407-656-2734 EXT 108
- LAKE UTILITY SERVICES - DAVID ORR - 407-869-1919
- SUMTER ELECTRIC COOPERATIVE - DAVE CLEAVENGER - 352-793-3801
- SPRINT - JOHN BRUGNOLI - 352-326-1757

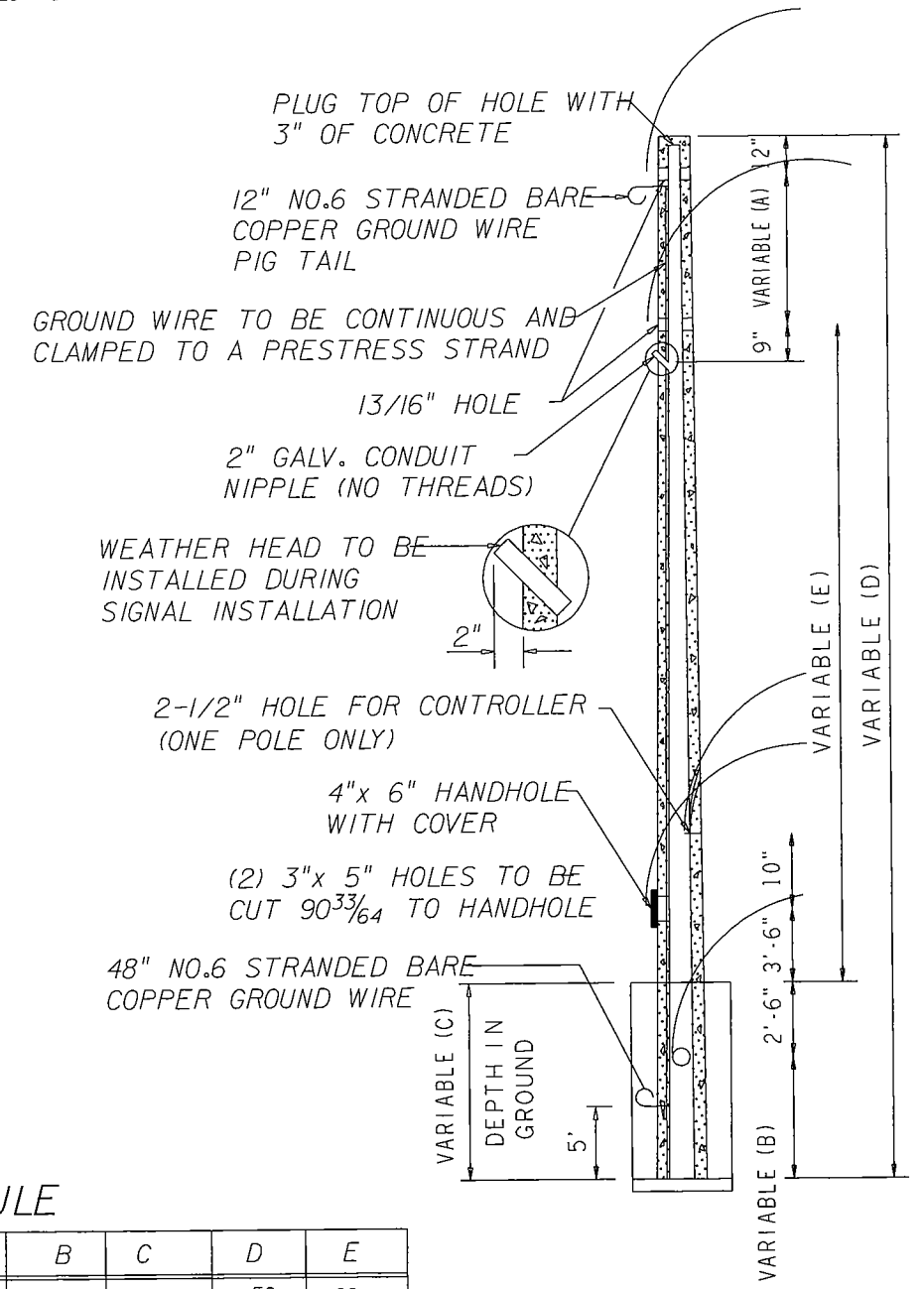
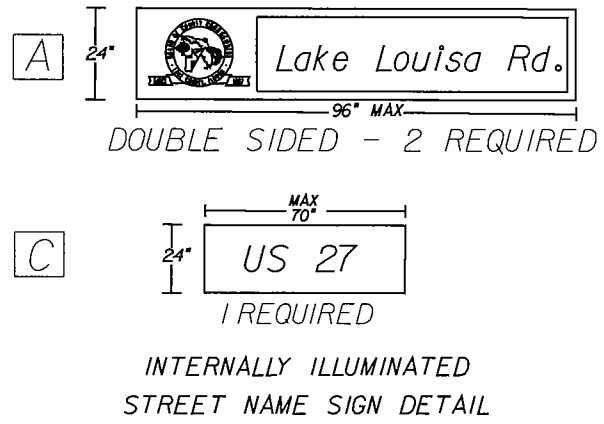

PRE-CONSTRUCTION NOTES:

1. CONTRACTOR SHALL NOTIFY THE FDOT PROJECT ENGINEER (SUSANNE HERTZ @ (386)-943-5332) AND LAKE COUNTY TRAFFIC ENGINEERING (FRED SCHNEIDER @ 352-253-4905) 48 HOURS PRIOR TO BEGINNING CONSTRUCTION.
2. CONTRACTOR SHALL SUBMIT CLASS 1 CONCRETE DESIGN MIX TO THE PROJECT ENGINEER PRIOR TO BEGINNING CONSTRUCTION.
3. IN ORDER TO EXPEDITE ENERGIZING THE SIGNAL, CONTACT LAKE COUNTY TRAFFIC ENGINEERING TO VERIFY THAT AN APPLICATION FOR POWER HAS BEEN MADE PRIOR TO BEGINNING CONSTRUCTION. IF NO APPLICATION HAS BEEN MADE, CONTACT THE FDOT PROJECT ENGINEER (SUSANNE HERTZ @ (386) 943-5332).

GENERAL NOTES:

1. CONTRACTOR IS NOT TO USE JONES PLUGS.
2. DELAY DETECTORS SHALL BE SET TO FIVE (5) SECONDS.
3. NO LANE CLOSURES 7 AM TO 7 PM NORTHBOUND AND 7 AM TO 7 PM SOUTHBOUND ON US 27. ALL LANE CLOSURES SHALL BE APPROVED BY THE FDOT PROJECT ENGINEER.
4. STOP SIGNS SHALL BE REMOVED AT THE SAME TIME THE SIGNAL IS FULLY OPERATIONAL.
5. PAY ITEM NO. 102-99 INCLUDES ONE VARIABLE MESSAGE SIGN ON THE NB AND SB APPROACHES OF US 27 FOR A TOTAL OF 14 DAYS EACH TO READ "CAUTION CAUTION CAUTION" ON PANEL ONE AND "TRAFFIC SIGNAL AHEAD" ON PANEL TWO.
6. ALL INTERNALLY ILLUMINATED STREET NAME SIGNS SHALL BE DOUBLE FACED AND MOUNTED 1' BELOW THE MESSENGER CABLE.
7. CONTROLLER CABINET ASSEMBLY SHALL MEET LAKE COUNTY REQUIREMENTS. CONTACT DAN SAILE OF NAZTEC AT 407-716-5948 OR STEVE BOLLINGER OF LAKE COUNTY AT 352-742-1766.
8. THE CONTRACTOR IS TO NOTIFY PROGRESS ENERGY, BRIAN HATTON AT 863-678-4550 7 DAYS BEFORE START OF CONSTRUCTION TO ALLOW PROGRESS ENERGY TO PERFORM THEIR WORK.

POLE SCHEDULE

ITEM NO.	POLE	TYPE	QTY.	A	B	C	D	E
641-15-158	'A'	VI	1	15	11.5	14	58	28
641-15-156	'B'	VI	1	15	10.5	13	56	27

Catenary Cable: 3/8"
Messenger Cable: 1/2"