

① EL. 135.01
POLE LOCATION =
STA. 110+09.78
102.48 LT.

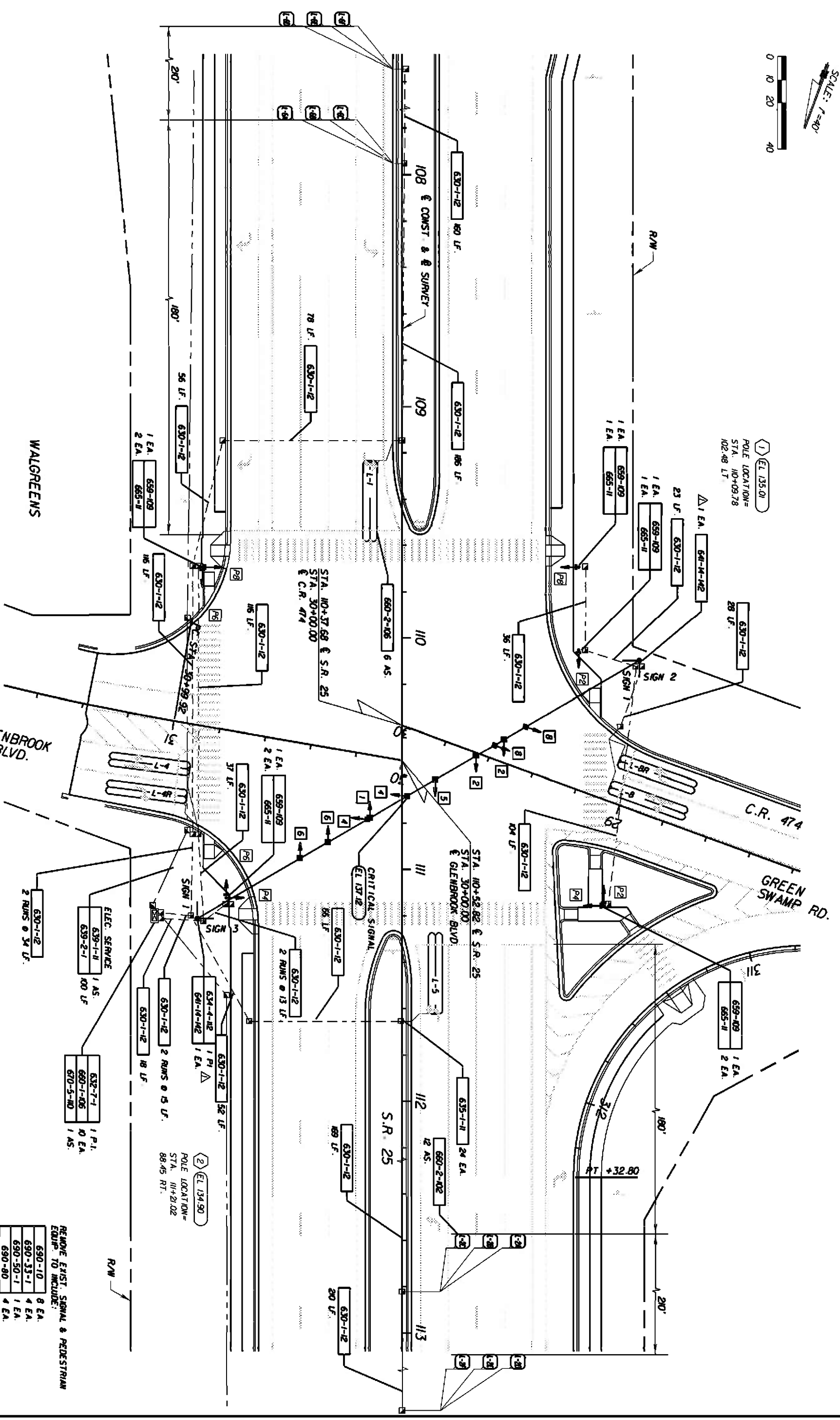

WALGREENS

GLENBROOK BLVD.

C.R. 474

GREEN SWAMP RD.

S.R. 25

- REMOVE EXIST. SIGNAL & PEDESTRIAN EQUIP. TO INCLUDE:
- 690-10 8 EA.
 - 690-33-1 4 EA.
 - 690-50-1 1 EA.
 - 690-80 4 EA.
 - 690-100 1 PI.

DATE		DESCRIPTION		REVISIONS	
6/24/05	BY SAH	ADDED SPAN WIRE PAV ITEM			
	BY	REVISED STRAIN POLE PAV ITEM.			

STATE OF FLORIDA		DEPARTMENT OF TRANSPORTATION	
S.R. 25	LAKE COUNTY	FINANCIAL PROJECT ID	238421-1-52-01

SIGNALIZATION PLAN		SHEET NO.	
GREEN SWAMP RD/GLENBROOK BLVD.		T-7	

06/30/2005 01:39:50 PM G:\Transportation\041118 SR 25\010238421\501\Signalization\037.rvt.dgn