

LAKE COUNTY, FLORIDA

SECTION 11070 - M.P. 8.299
 SR 50 AT CR 565A REALIGNMENT
 PERMIT NO. 06-A-592-0071

2715

SIGNALIZATION PLANS

INDEX OF SIGNALIZATION PLANS

SHEET NO.	SHEET DESCRIPTION
T-1	KEY SHEET
T-2	TABULATION OF QUANTITIES
T-3	GENERAL NOTES
T-4	SIGNALIZATION PLAN
T-5	SIGNALIZATION DETAILS
T-6	POLE SCHEDULE & DETAILS
T-7	GUIDESIGN WORKSHEET

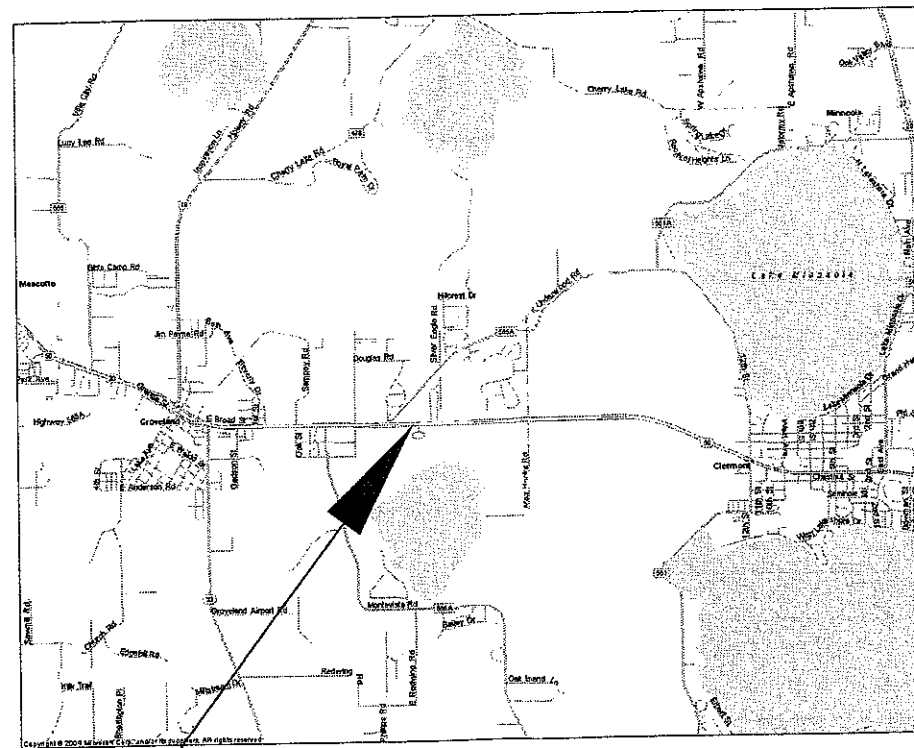

PROJECT LOCATION

VICINITY MAP
 N.T.S.

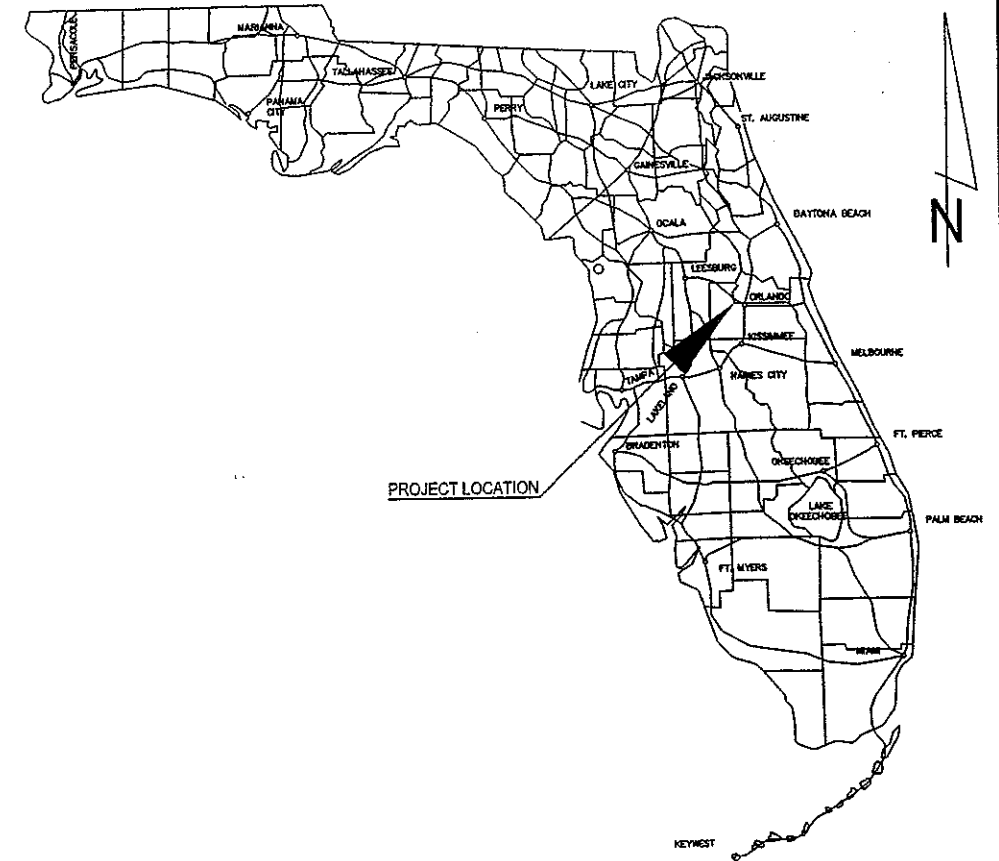

PROJECT LOCATION

SIGNALIZATION SHOP DRAWINGS
 TO BE SUBMITTED TO:
 FRED D. FERRELL, P.E.
 LASSITER TRANSPORTATION GROUP, INC.
 123 LIVE OAK AVENUE
 DAYTONA BEACH, FL 32114
 PH: 386.257.2571 FAX: 386.257.6996

PLANS PREPARED BY:

Lassiter Transportation Group, Inc.
Engineering and Planning
 123 LIVE OAK AVENUE
 DAYTONA BEACH, FL 32114
 PH: 386.257.2571 FAX: 386.257.6996
 E-MAIL: ltg@lassitertransportation.com
 ENGINEERING BUSINESS NO. 9227

NOTE: THE SCALE OF THESE PLANS MAY
 HAVE CHANGED BY REPRODUCTION.

GOVERNING STANDARDS AND SPECIFICATIONS:
 FLORIDA DEPARTMENT OF TRANSPORTATION,
 DESIGN STANDARDS DATED 2006, AND
 STANDARD SPECIFICATIONS FOR ROAD
 AND BRIDGE CONSTRUCTION DATED 2007,
 AS AMENDED BY CONTRACT DOCUMENTS.

KEY SHEET REVISIONS		
DATE	BY	DESCRIPTION
3/9/07	DMD	ADDED EASTBOUND DUAL LEFT-TURNS, 3 SECTION HEAD AND REMOVED ITEMS 659-106 AND 659-120.

SIGNALIZATION PLANS
 ENGINEER OF RECORD:
 DATE: 3/13/07
 P.E. NO.: 34868

R. SANS LASSITER, P.E.

SHEET
 NO.
 T-1

TABULATION OF QUANTITIES

BID ITEM NUMBER	DESCRIPTION	UNIT	SHEET T-4								TOTAL THIS SHEET		GRAND TOTAL	
			ORIG	FINAL	ORIG	FINAL	ORIG	FINAL	ORIG	FINAL	ORIG	FINAL	ORIG	FINAL
101-1	MOBILIZATION	LS	1									1		1
102-1	MAINTENANCE OF TRAFFIC	LS	1									1		1
555-1-1	CONDUIT - DIRECTIONAL BORE (LESS THAN 6")	LF	140									140		140
630-1-12	CONDUIT (UNDERGROUND)	LF	1524									1524		1524
632-7-1	CABLE (SIGNAL)	PI	1									1		1
634-4-112	SPAN WIRE ASSEMBLY (TWO-WIRE, DIAGONAL)	PI	1									1		1
635-1-11	PULL BOX	EA	12									12		12
635-1-15	PULL BOX (FIBER OPTIC)	EA	1									1		1
639-1-12	ELECTRIC POWER SERVICE (UNDERGROUND, PURCHASED BY CONTRACTOR)	AS	1									1		1
639-2-1	ELECTRICAL SERVICE WIRE	LF	1050									1050		1050
639-3-11	ELECTRICAL SERVICE DISCONNECT (POLE MOUNTED)	EA	1									1		1
641-16-154	PRESTRESSED CONCRETE POLES (TYPE N-VII, 54')	EA	1									1		1
641-16-156	PRESTRESSED CONCRETE POLES (TYPE N-VII, 56')	EA	1									1		1
650-51-311	TRAFFIC SIGNAL, 12" STANDARD (3 SECTION - 1 WAY)	AS	4									4		4
650-51-321	TRAFFIC SIGNAL, 12" STANDARD (3 SECTION - 2 WAY)	AS	6									6		6
650-51-511	TRAFFIC SIGNAL, 12" STANDARD (5 SECTION - 1 WAY)	AS	2									2		2
660-1-109	INDUCTIVE LOOP DETECTOR (TYPE 9, 2 CH, SS, RM)	EA	5									5		5
660-1-110	INDUCTIVE LOOP DETECTOR (TYPE 10, 2 CH, SS, RM, TD)	EA	2									2		2
660-2-102	LOOP ASSEMBLY (TYPE B) (6'x6')	AS	8									8		8
660-2-106	LOOP ASSEMBLY (TYPE F MOD) (6'x40')	AS	6									6		6
663-74-11	VEHICLE DETECTOR ASSEMBLIES (OPTICAL TYPE)	EA	3									3		3
670-5-111	TRAFFIC CONTROLLER ASSEMBLY (NEMA, ONE PREEMPTION PLAN)	AS	1									1		1
699-1-1	INTERNALLY ILLUMINATED SIGN (F&I)	EA	3									3		3
690-10	SIGNAL HEAD ASSEMBLY - REMOVE	EA	7									7		7
690-33-1	POLE REMOVAL - DEEP (2 POLES)	LF	30									30		30
690-50-1	CONTROLLER ASSEMBLY - REMOVE	EA	1									1		1
690-80	SPAN WIRE ASSEMBLY - REMOVE	EA	1									1		1
690-90	CONDUIT AND CABLING - REMOVE	PI	1									1		1

R. Sans Lassiter
3/13/07

REVISIONS DATE BY DESCRIPTION 3/9/07 DMD ADDED EASTBOUND DUAL LEFT-TURNS, 3 SECTION HEAD AND REMOVED ITEMS 659-106 AND 659-120.			DESIGN BY: DMD DRAWN BY: GCD REVIEWED BY: RSL APPROVED BY: RSL JOB NUMBER: 3389.01 FILE NAME: Tabqsg01			Lassiter Transportation Group, Inc. <i>Engineering and Planning</i> R. SANS LASSITER, P.E. (#34868) 123 LIVE OAK AVENUE DAYTONA BEACH, FLORIDA 32114 PH: 386.257.2571 FAX: 386.257.6996 ENGINEERING BUSINESS NO. 9227	SR 50 AT CR 565A LAKE COUNTY, FLORIDA	TABULATION OF QUANTITIES	SHEET NO. T-2
--	--	--	---	--	--	--	--	--------------------------	------------------

GENERAL NOTES:

1. THE CONTRACTOR SHALL BE RESPONSIBLE FOR KEEPING RAY MARLIN (FDOT) AT (386) 943-5318 AND STEVE BOLLINGER LAKE COUNTY TRAFFIC ENGINEERING DEPARTMENT AT (352) 742-1766 INFORMED OF ALL PHASES OF CONSTRUCTION WITHIN AT LEAST 48 HOURS PRIOR TO BEGINNING CONSTRUCTION, AND AGAIN FOR LOOP INSTALLATION.
2. THE CONTRACTOR SHALL NOTIFY LAKE COUNTY TRAFFIC OPERATIONS AT LEAST 24 HOURS IN ADVANCE OF INSTALLING SIGNAL POLES, GROUND RODS, UNDERGROUND CONDUIT, AND SEALING SIGNAL HEAD ASSEMBLIES SO THAT THESE OPERATIONS CAN BE OBSERVED.
3. ALL MATERIALS AND HARDWARE SHALL BE F.D.O.T. APPROVED, AND PREAPPROVED BY LAKE COUNTY TRAFFIC OPERATIONS.
4. THE CONTRACTOR SHALL STAKE ALL POLE LOCATIONS AND HAVE POLE LOCATIONS APPROVED BY LAKE COUNTY TRAFFIC OPERATIONS.
5. THE CONTRACTOR SHALL VERIFY COLOR CODES FOR SIGNAL CABLE AND INTERCONNECT WITH LAKE COUNTY TRAFFIC OPERATIONS.
6. IT SHALL BE NOTED THAT NO TEST BORINGS WERE MADE WHERE CONDUIT RUNS ARE TO BE INSTALLED; IT SHALL BE THE CONTRACTORS RESPONSIBILITY TO EXAMINE THE JOB SITE CONDITIONS BEFORE SUBMITTING BID PROPOSALS.
7. CONTRACTOR SHALL PROVIDE 3 SETS OF CONSTRUCTION "AS-BUILTS" - ONE TO FDOT, ONE FOR THE CABINET, AND ONE FOR LAKE COUNTY TRAFFIC ENGINEERING DEPARTMENT.
8. TRAFFIC SHALL BE MAINTAINED IN ACCORDANCE WITH INDEX 600 OF FDOT'S DESIGN STANDARDS 2006 EDITION.
9. ALL SIGNAL HEADS SHALL HAVE TUNNEL VISORS AND LED DISPLAYS.
10. THE CONTRACTOR SHALL BE RESPONSIBLE FOR ACQUIRING ALL NECESSARY PERMITS INCLUDING THE ELECTRIC PERMIT, AND TO COORDINATE APPLICATION FOR POWER, WITH LAKE COUNTY TRAFFIC OPERATIONS AT (352) 742-1766.
11. REFER TO THE "INTERNALLY ILLUMINATED STREET NAME SIGN DETAIL FOR LAKE COUNTY PUBLIC WORKS" AND THE "LAKE COUNTY SUPPLEMENT SPECIFICATIONS FOR INTERNALLY ILLUMINATED SIGNS" FOR THE DESIGN AND INSTALLATION OF THE STREET NAME SIGN, MAST ARM, AND MAST ARM CONNECTION TO CONCRETE STRAIN POLE.
12. INTERNALLY ILLUMINATED SIGNS SHALL BE LED ILLUMINATED AND HAVE SEPARATE CIRCUIT BREAKERS.
13. THE CONTRACTOR SHALL NOTIFY THE APPROPRIATE UTILITY DEPARTMENT AT LEAST 48 HOURS IN ADVANCE OF POLE SETTING OPERATIONS WHERE A CONFLICT WITH OVERHEAD ELECTRICAL CONDUCTORS IS EXPECTED AND WHEN JOINT USE POLES ARE TO BE USED.
14. THE CONTRACTOR SHALL BE RESPONSIBLE FOR ESTABLISHING THE PROPER AMOUNT OF RAKE WITH RESPECT TO LOADING TO BE USED ON POLES AT THE TIME OF INSTALLATION.
15. THE CONTRACTOR SHALL FURNISH LAKE COUNTY TRAFFIC OPERATIONS WITH EMERGENCY CONTACTS AND PHONE NUMBERS AND HAVE AN IMSA LEVEL II CERTIFIED SIGNAL TECHNICIAN ON CALL WITHIN A TWO HOUR MINIMUM RESPONSE TIME.
16. IT IS THE RESPONSIBILITY OF THE CONTRACTOR TO HAVE EXACT LOCATIONS OF ALL UTILITIES PRIOR TO BEGINNING WORK.
17. SIGNAL CABLE SHALL BE ATTACHED TO MESSENGER WIRE USING PROPER SIZE SPIRAL WRAP.
18. THE COST FOR THE USE OF OFF DUTY LAW ENFORCEMENT OFFICERS IN THE EVENT OF LANE CLOSURES SHALL BE INCIDENTAL TO THE WORK AND WILL NOT BE PAID SEPARATELY.
19. A PRECONSTRUCTION MEETING SHALL BE SCHEDULED WITH LAKE COUNTY TRAFFIC OPERATIONS, (352) 742-1766, PRIOR TO ANY CONSTRUCTION.

GENERAL NOTES:

20. CONTRACTOR SHALL RESTORE LANDSCAPING WHICH HAS BEEN DISTURBED BY HIS ACTIVITIES TO COMPLY WITH THE LAKE COUNTY REQUIREMENTS.
21. FDOT OFFICE NEEDS 2 BUSINESS DAYS NOTICE PRIOR TO WORK WITHIN THE R/W OR LANE CLOSURE. CONTRACTOR TO NOTIFY THE LAKE COUNTY TRAFFIC ENGINEERING DEPARTMENT AND THE FDOT PRIOR TO BEGINNING CONSTRUCTION.
22. ENGINEER CERTIFICATION (IF REQUIRED) MUST BE RECEIVED WITHIN 30 DAYS OF COMPLETION OF THE PROJECT.
23. ALL WORK WITHIN THE RIGHT-OF-WAY SHALL BE IN CONFORMANCE WITH FLORIDA DEPARTMENT OF TRANSPORTATION STANDARD SPECIFICATIONS FOR ROAD AND BRIDGE CONSTRUCTION AND DESIGN STANDARDS, CURRENT EDITIONS.
24. THE CONTRACTOR SHALL HAND DIG THE FIRST 48 INCHES OF THE HOLE FOR THE STRAIN POLE FOUNDATION. SHOULD THERE BE OTHER UTILITIES, THE CONTRACTOR SHALL CONTACT THE PROJECT ENGINEER WHO WILL RESOLVE THE CONFLICT AND ADJUSTMENT IF REQUIRED.
25. ANY ITEM NOT SPECIFICALLY ADDRESSED IN THESE PLANS, USE F.D.O.T. SPECIFICATIONS.
26. CONTRACTOR SHALL BE RESPONSIBLE FOR CONTACTING THE POWER COMPANY, PROGRESS ENERGY, PROVIDING THE ELECTRICAL POWER TO DETERMINE IF ANY ADDITIONAL FEES ARE REQUIRED TO CONNECT POWER, AND FOR CONNECTION OF POWER. IF REQUIRED, THE FEE SHALL BE INCLUDED AS PART OF THE BID ITEM PAYMENT FOR ELECTRICAL SERVICE ASSEMBLY.
27. CONTRACTOR SHALL CONTACT PROGRESS ENERGY AT LEAST 48 HOURS PRIOR TO INSTALLING THE SIGNAL CABLE. THE ELECTRIC DEPARTMENT PERSONNEL SHALL BE ON SITE WHEN FEEDING THE SIGNAL CABLE IN BETWEEN THE EXISTING ELECTRICAL WIRE.
28. SEPARATE CONDUIT AND PULL BOXES SHALL BE PROVIDED FOR LOOP WIRE, SIGNAL CABLE, AND ELECTRICAL SERVICE WIRE.
29. THE CONTRACTOR SHALL FURNISH, INSTALL, AND MAINTAIN TEMPORARY VEHICLE DETECTION IF LOOPS ARE TO BE DESTROYED DURING CONSTRUCTION.
30. UNLESS OTHERWISE NOTED, ALL REMOVED EQUIPMENT SHALL BE TURNED OVER TO THE LAKE COUNTY SIGNAL DEPARTMENT (352.742.1766), EXCEPT POLES, WHICH SHALL BE DISPOSED OF BY THE CONTRACTOR IN AREAS PROVIDED BY HIM.
31. THE MAINTENANCE OF EXISTING SIGNALS, UNTIL REMOVED, SHALL REMAIN THE RESPONSIBILITY OF THE CONTRACTOR.
32. THE CONTRACTOR IS REQUIRED TO INSPECT THE INSTALLATION OF THE TRAFFIC SIGNALS IN ACCORDANCE WITH THE FDOT SPECIFICATION 105-5.10. THE CONTRACTOR SHALL COORDINATE THE FINAL ACCEPTANCE INSPECTION IN ACCORDANCE WITH FDOT SPECIFICATION 611-2.2 WITH THE ENGINEER AT LEAST TEN DAYS IN ADVANCE. THE (MAINTAINING AGENCY) AND RAY MARLIN AT (386) 943-5318 SHOULD ALSO BE CONTACTED TEN DAYS BEFORE THE INSPECTION IS TO BE PERFORMED SO THEY MAY BE PRESENT.
33. THE CONTRACTOR SHALL NOTIFY "CALL SUNSHINE" AT 1-800-432-4770 AT LEAST 48 HOURS IN ADVANCE OF ANY EXCAVATION OR ANY WORK WHICH WOULD OTHERWISE INTERFERE WITH ANY ABOVE GROUND OR BELOW GROUND UTILITIES. IN ADDITION, THE CONTRACTOR SHALL DIRECTLY NOTIFY ALL UTILITIES WHICH ARE NOT "CALL SUNSHINE" MEMBERS, BUT WHICH MAY HAVE EXISTING FACILITIES WITHIN THE VICINITY OF THE PROJECT. THE CONTRACTOR SHALL ALSO BE RESPONSIBLE FOR MAINTAINING A CURRENT LOCATE TICKET THROUGHOUT THE DURATION OF THE WORK.
34. NO LANES CLOSURE ARE ALLOWED ALONG SR 50 FROM: 6:00 A.M. - 7:00 P.M.
35. THE FOLLOWING UTILITY CONTACT INFORMATION IS PROVIDED:

UTILITY AGENCY OWNER:

CITY OF CLERMONT
LAKE APOPKA NATURAL GAS DISTRICT
PROGRESS ENERGY
MCI NETWORK SERVICES, INC.
SPRINT
BRIGHT HOUSE NETWORKS, LLC
LAKE COUNTY PUBLIC WORKS
LAKE COUNTY SIGNAL DEPARTMENT
SUNSHINE ONE-CALL

CONTACT:

TAMARA RICHARDSON
RICK GULLETT
SUE FREYSER
TIM COLE
CHRISTOPHER B. LOVE
JOHN WOSLKI
JUAN CHAN
STEVE BOLLINGER

PHONE:

(352) 241-0178
(407) 466-5117
(407) 646-8364
(407) 841-4226
(407) 814-5271
(386) 775-444 EXT 7879
(352) 253-4952
(352) 742-1766
(800) 432-4770

LOOPS / PULL BOXES:

1. EACH LOOP SHALL BE TREATED AS AN INDIVIDUAL LOOP WITH SEPARATE LOOP LEAD-INS FROM SPLICE POINT TO CABINET TERMINAL.
2. F TYPE LOOPS SHALL BE 40' LONG BY 6' WIDE AND EXTEND 5' BEYOND THE STOP BAR.
3. PULL BOXES AND COVERS SHALL BE FDOT APPROVED OF NONMETALLIC CONSTRUCTION WITH RECESSED COVER LOGO "TRAFFIC SIGNAL".
4. LOOP HOME RUNS SHALL NOT BE CUT INTO THE RADIUS.
5. ANY STRIPING / PAVEMENT MARKINGS DESTROYED BY CONTRACTOR DURING CONSTRUCTION SHALL BE REPLACED AT THE CONTRACTOR'S EXPENSE.
6. PULL BOXES SHALL BE LOCATED 10 FEET FROM EDGE OF PAVEMENT OR BEHIND A CURB WHEN POSSIBLE, ATTEMPTING TO KEEP FROM THE BOTTOM OF A DITCH OR RETENTION AREA.
7. A FIBER OPTIC PULL BOX AND CONDUIT INTO THE CONTROLLER CABINET ASSEMBLY SHALL BE INSTALLED.

TIMINGS / CONTROLLER:

1. DELAY TIMES SHALL BE SET TO 5 SECONDS.
2. A MANUAL PUSH BUTTON CORD SHALL BE FURNISHED IN THE CONTROLLER CABINET.
3. THE MOUNTING OF ELECTRICAL SERVICE TO THE TRAFFIC SIGNAL CABINET SHALL BE PROHIBITED.
4. THE CONTROLLER ASSEMBLY SHALL BE A "LAKE COUNTY" NAZTEC REGIONAL TS2-1, WITH A TS2-2 CONTROLLER ETHERNET ENABLED FOR COUNTY CLOSED LOOP SYSTEM, AND WILL INCLUDE A GENERATOR SWITCH BOX PANEL.
5. THE CABINET DOOR SHALL OPEN AWAY FROM THE INTERSECTION WHEN POSSIBLE.
6. A GENERATOR PAD, 3'X3'X4' CONCRETE SHALL BE INSTALLED.
7. GROUNDING FOR THE CONTROLLER ASSEMBLY SHALL MEASURE 25 OHMS OR LESS.

SIGNAL HEADS:

1. SIGNAL HEADS SHALL BE WIRED DIRECTLY TO THE TERMINAL BLOCKS. THE USE OF "JONES" PLUGS SHALL BE PROHIBITED.
2. THE INSIDE LANE DISCONNECT SHALL BE WIRED FOR FUTURE 5 SECTION HEADS.
3. VEHICLE SIGNAL HEAD ASSEMBLIES SHALL BE BLACK, CAST ALUMINUM, WITH TUNNEL VISORS, AND LED'S FOR ALL INDICATIONS, UNLESS OTHERWISE NOTED.

VEHICLE DETECTOR ASSEMBLIES:

1. THE OPTICAL TYPE VEHICLE DETECTOR ASSEMBLIES SHALL BE 3M OPTICOM OR EQUIVALENT. PAY ITEM 663-74-11 SHALL INCLUDE ALL MATERIALS NECESSARY TO ENABLE THE VEHICLE DETECTOR TO BE OPERATIONAL.

CONSTRUCTION SCHEDULE:

1. FULL SIGNAL OPERATION SHALL REMAIN IN PLACE AT THE EXISTING SR 50 / CR 565A INTERSECTION. AT THE TIME OF ACTIVATION OF THE NEW SIGNAL, THE EXISTING SIGNAL SHALL BE PLACED IN FLASH MODE, WITH MOVEMENTS 2 AND 6 FLASHING YELLOW AND ALL OTHERS FLASHING RED. THE SIGNAL CONTRACTOR SHALL COORDINATE CONSTRUCTION SCHEDULES WITH THE GENERAL CONTRACTOR. THE SIGNAL AT THE EXISTING LOCATION SHALL BE REMOVED ONCE THE PROPOSED MEDIAN MODIFICATIONS AT THE EXISTING INTERSECTION ARE COMPLETE.

[Handwritten Signature]
3/3/07

<table border="1"> <thead> <tr> <th colspan="2">REVISIONS</th> </tr> <tr> <th>DATE</th> <th>BY</th> </tr> </thead> <tbody> <tr> <td>3/9/07</td> <td>DMD</td> </tr> </tbody> </table>		REVISIONS		DATE	BY	3/9/07	DMD	<table border="1"> <tr> <td>DESIGN BY:</td> <td>DMD</td> </tr> <tr> <td>DRAWN BY:</td> <td>GCD</td> </tr> <tr> <td>REVIEWED BY:</td> <td>RSL</td> </tr> <tr> <td>APPROVED BY:</td> <td>RSL</td> </tr> <tr> <td>JOB NUMBER:</td> <td>3389.01</td> </tr> <tr> <td>FILE NAME:</td> <td>Gnntssg01</td> </tr> </table>	DESIGN BY:	DMD	DRAWN BY:	GCD	REVIEWED BY:	RSL	APPROVED BY:	RSL	JOB NUMBER:	3389.01	FILE NAME:	Gnntssg01	<p>Lassiter Transportation Group, Inc. Engineering and Planning R. SANS LASSITER, P.E. (#34888) 123 LIVE OAK AVENUE DAYTONA BEACH, FLORIDA 32114 PH: 386.257.2571 FAX: 386.257.8996 ENGINEERING BUSINESS NO. 9227</p>	<p>SR 50 AT CR 565A LAKE COUNTY, FLORIDA</p>	<p>SHEET NO. T-3</p>
REVISIONS																							
DATE	BY																						
3/9/07	DMD																						
DESIGN BY:	DMD																						
DRAWN BY:	GCD																						
REVIEWED BY:	RSL																						
APPROVED BY:	RSL																						
JOB NUMBER:	3389.01																						
FILE NAME:	Gnntssg01																						

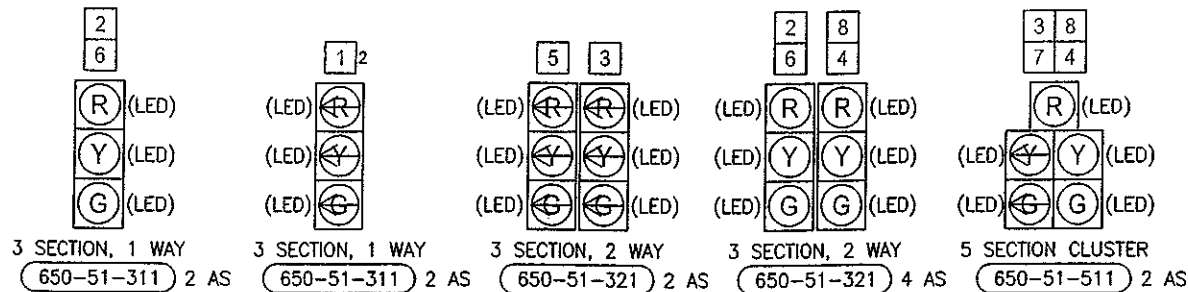

* NOTE - ELECTRICAL POWER SOURCE LOCATED APPROXIMATELY 350' EAST OF CR 565A, ALONG SR 50. CONTRACTOR TO INSTALL PULLBOX AT THE BASE OF POWER POLE AND RUN ELECTRICAL SERVICE WIRE AND CONDUIT UNDERGROUND TO POLE 1.

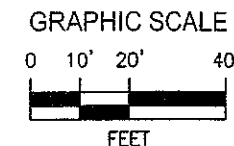

REMOVALS
(TO BE REMOVED FROM EXISTING SR 50/CR 565A INTERSECTION)

- 690-10 7 EA
- 690-33-1 30 LF
- 690-50-1 1 EA
- 690-80 1 EA
- 690-90 1 PI

DETECTOR CONFIGURATION CHART

MOVEMENT	LOOP I.D.	LOOP TYPE	DETECTOR I.D.	DETECTOR TYPE	CHANNEL NUMBER	SECONDS OF DELAY
1	L-1I & L0	F(MOD)	L1	9	1	-
2	L-2A & 2B	B	L2	9	1	-
	L-2C & 2D	B			2	-
3	L-3	F(MOD)	L3	9	1	-
4	L-4	F(MOD)	L4	10	1	5
5	L-5	F(MOD)	L5	9	1	5
6	L-6A & 6B	B	L6	9	1	-
	L-6C & 6D	B			2	-
8	L-8	F(MOD)	L8	10	1	0
	L-8R	F(MOD)			2	5

CONTROLLER TIMINGS

MOVEMENT	MIN. GREEN		MAX. GREEN		YELLOW CLEAR	ALL RED	WALK	F.D.W.	RECALL	MEMORY
	INIT.	EXT.	I	II						
1	6	3.0	25	45	4.0	1.0	-	-	-	NL
2	17	3.0	60	45	5.0	2.0	-	-	MIN	L
3	8	3.0	35	45	4.0	1.0	-	-	-	NL
4	6	3.0	15	45	4.0	1.0	-	-	-	NL
5	6	3.0	25	45	4.0	1.0	-	-	-	NL
6	17	3.0	60	45	5.0	2.0	-	-	MIN	L
8	8	3.0	35	45	4.0	1.0	-	-	-	NL

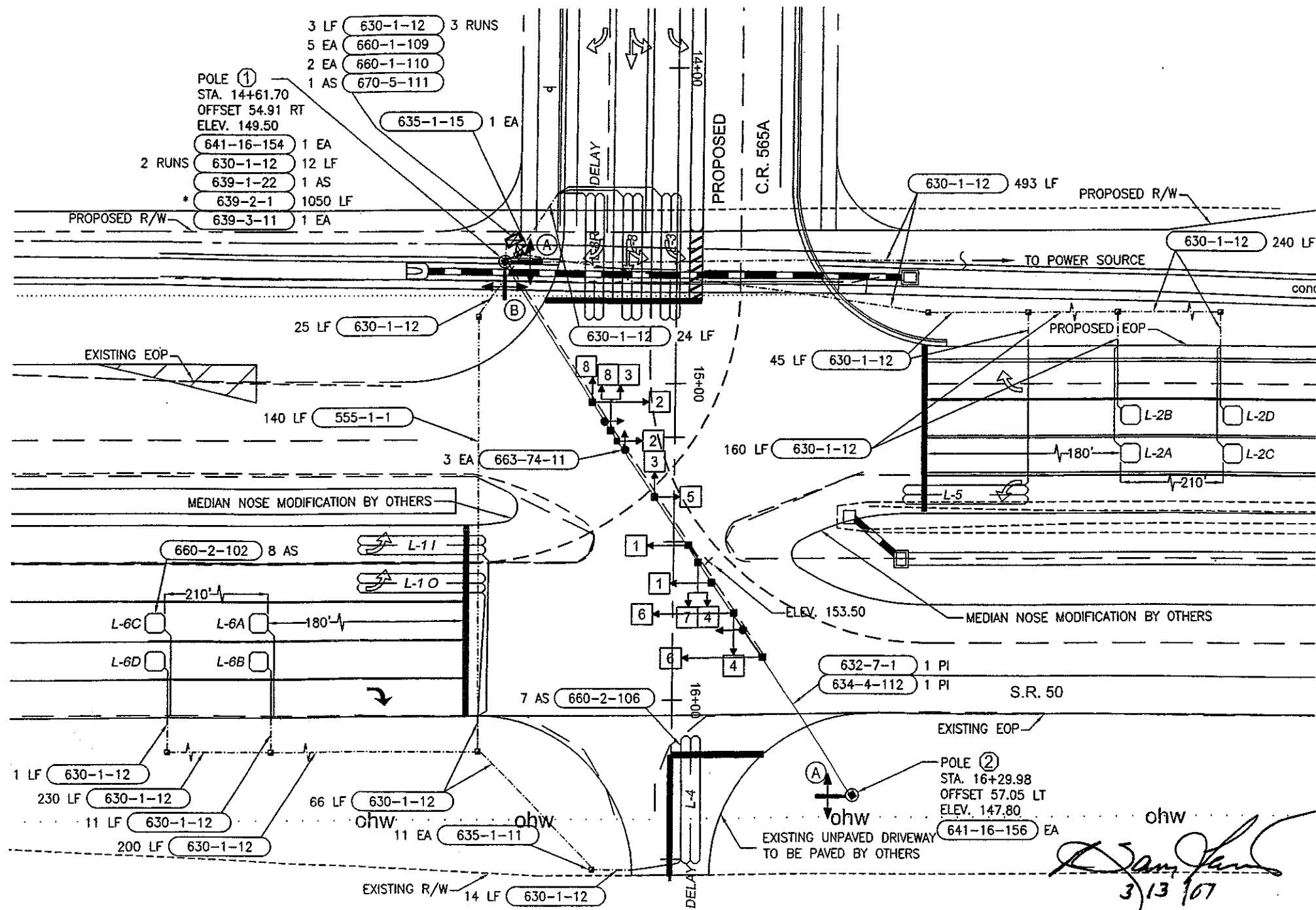

REVISIONS		DESIGN BY:	DMD
DATE	BY	DESCRIPTION	DRAWN BY:
3/9/07	DMD	ADDED EASTBOUND DUAL LEFT-TURNS, 3 SECTION HEAD AND REMOVED ITEMS 659-106 AND 659-120.	RSL
			APPROVED BY:
			RSL
			JOB NUMBER:
			3389.01
			FILE NAME:
			Plansg00

Lassiter Transportation Group, Inc.
Engineering and Planning
R. SANS LASSITER, P.E. (#34868)
123 LIVE OAK AVENUE
DAYTONA BEACH, FLORIDA 32114
PH: 386.257.2571 FAX: 386.257.6996
ENGINEERING BUSINESS NO. 9227

SR 50 AT CR 565A
LAKE COUNTY, FLORIDA

SIGNALIZATION PLAN

SHEET NO.
T-4

[Signature]
3/13/07

CONTROLLER OPERATIONS:

1. THE MAJOR STREET IS SR 50 (MOVEMENTS 1, 2, 5, AND 6).
2. THE MINOR STREET IS CR 565A (MOVEMENTS 3, 4, 7, AND 8).
3. FLASHING OPERATION IS YELLOW FOR MOVEMENTS 2 AND 6 AND RED FOR MOVEMENTS 1, 3, 4, 5, 7, AND 8.
4. THE CONTROLLER CABINET SHALL BE FULLY WIRED AND FURNISHED WITH ALL EQUIPMENT NECESSARY TO RUN THE CONTROLLER AS SOP 10 WITH PEDESTRIAN MOVEMENTS.

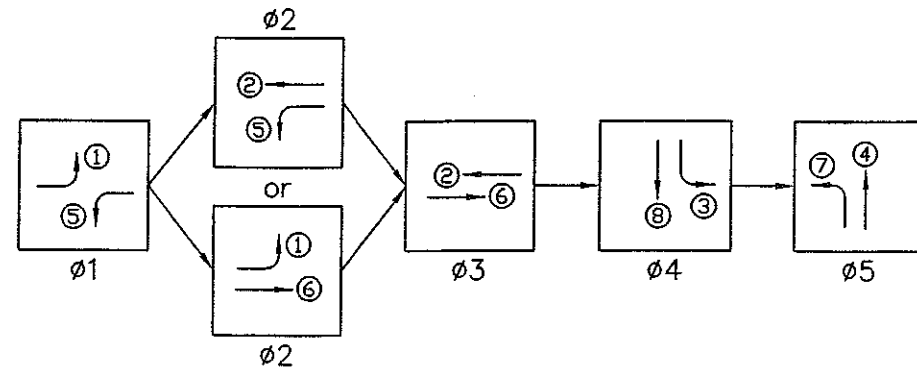

SIGNAL OPERATION PLAN
SOP 9

SIGN DETAIL

SEE SHEET T-7 FOR SIGN DETAIL
(SIGNS A AND B ARE DUAL SIDED, LED ILLUMINATED)

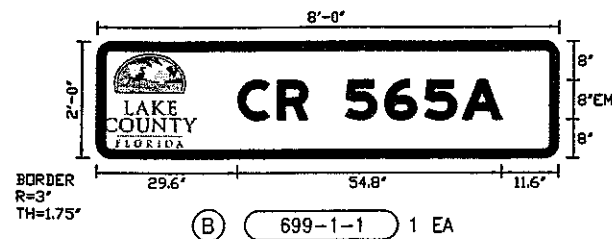
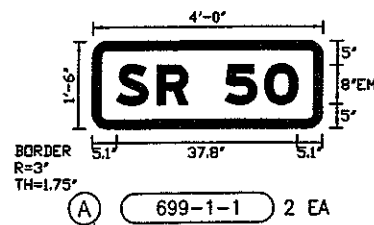

LEGEND:

- TYPE "F" (MOD) LOOP 6'X40'
- TYPE "B" LOOP 6'X6'
- CONDUIT (UNDERGROUND)
- CONDUIT (DIRECTIONAL BORE)
- MOVEMENT NUMBER
- CONCRETE STRAIN POLE
- CONTROLLER CABINET
- POLE NUMBER
- 3-SECTION HEAD
- 5-SECTION HEAD
- OPTICOM EMERGENCY PRE-EMPTION DETECTOR
- INTERNALLY ILLUMINATED STREET NAME SIGN
- PULL BOX
- FIBER OPTIC PULL BOX

[Signature]
3/13/07

REVISIONS		DESIGN BY:	DMD	Lassiter Transportation Group, Inc. Engineering and Planning R. SANS LASSITER, P.E. (#34868) 123 LIVE OAK AVENUE DAYTONA BEACH, FLORIDA 32114 PH: 386.257.2571 FAX: 386.257.6996 ENGINEERING BUSINESS NO. 9227	SR 50 AT CR 565A	SIGNALIZATION DETAILS	SHEET NO.
DATE	BY	DESCRIPTION	GCD		LAKE COUNTY, FLORIDA		T-5
			RSL				
			RSL				
			3389.01				
			Sigdet01				

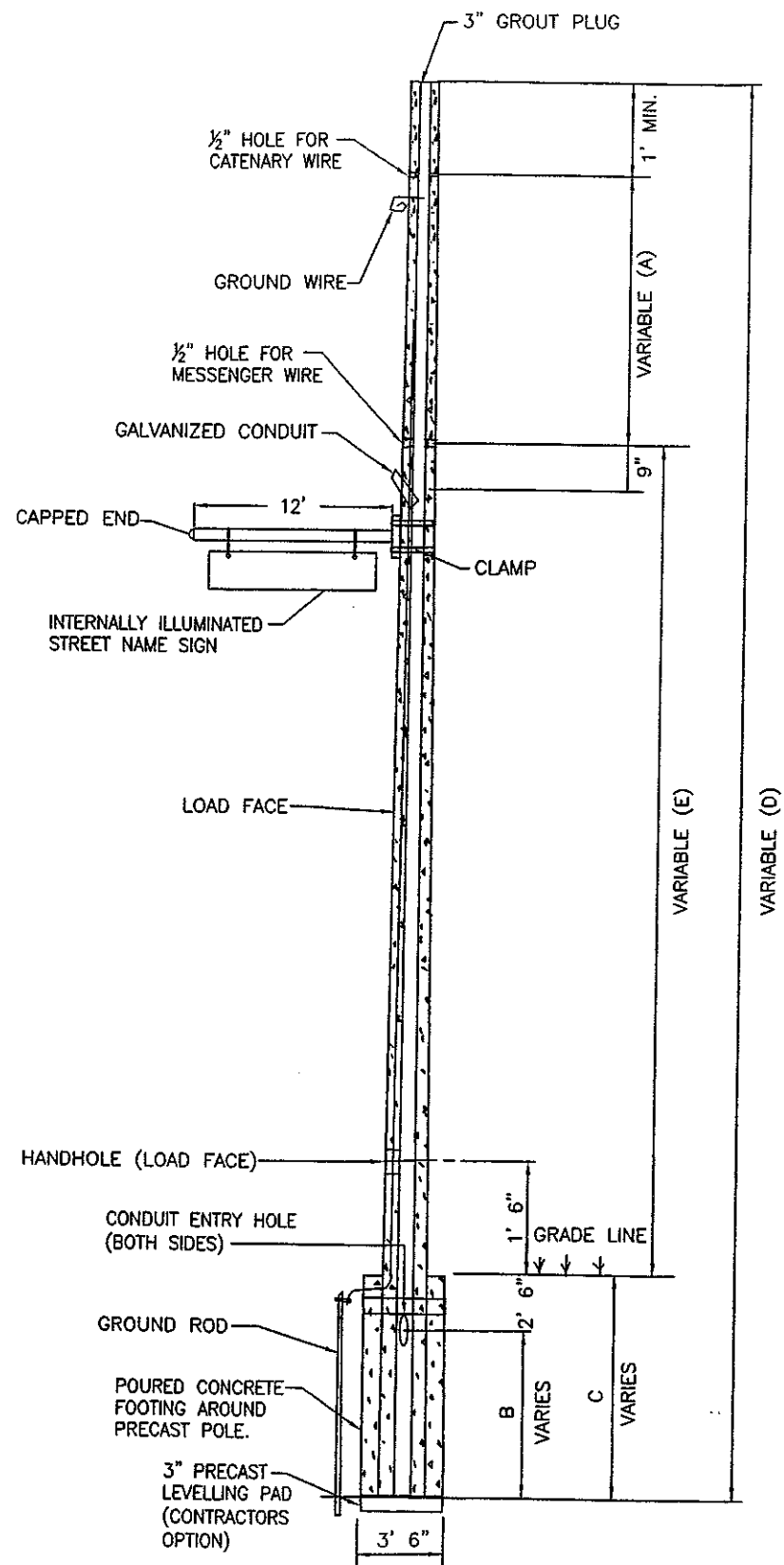

DETAIL OF PRESTRESSED CONCRETE POLE

POLE SCHEDULE
(DIMENSIONS ARE SHOWN IN FEET)

ITEM NO.	POLE NO.	POLE TYPE	QUANTITY	A	B	C	D	E
641-16-154	1	N-VII	1	13.0	9.0	13.5	54.0	26.5
641-16-156	2	N-VII	1	13.0	9.3	13.8	56.0	28.2

MESSENGER WIRE DIAMETER: 7/16" UTILITY GRADE
 CATENARY WIRE DIAMETER: 3/8" UTILITY GRADE
 CATENARY WIRE SHALL BE INSTALLED WITH MINIMUM VERTICAL SEPARATION OF 1.0' FROM MESSENGER WIRE.

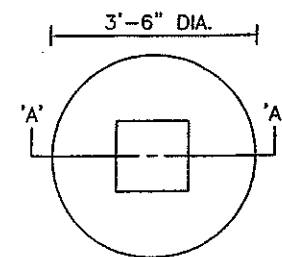

FOUNDATION PLAN

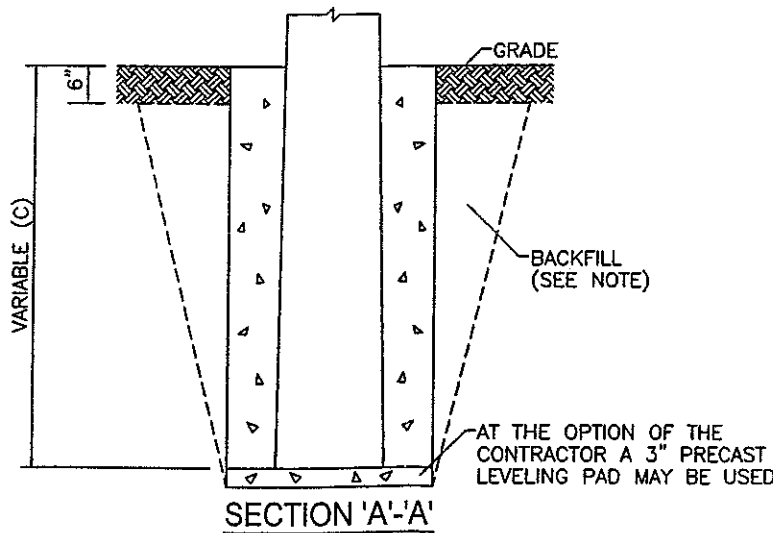

NOTES:

- FOOTING CONSTRUCTION SHALL COMPLY WITH FDOT SPECIFICATION SECTION 641 - CONCRETE STRAIN POLES.
- DESIGN WIND SPEED = 80 MPH.
- THE METHOD OF ATTACHMENT IS TWO-POINT FOR THE CONCRETE STRAIN POLE OVERHEAD ASSEMBLY.
- CONCRETE STRAIN POLES SHALL BE CLASS V SPECIAL CONCRETE, $f'_c = 6,000$ psi.
- DESIGN OF THE CONCRETE STRAIN POLE SHALL BE IN ACCORDANCE WITH THE LATEST STANDARDS AND SPECIFICATIONS.
- FOR ALL OTHER DETAILS AND REQUIREMENTS ON CONCRETE STRAIN POLES, REFER TO FDOT STANDARD SPECIFICATIONS FOR ROAD AND BRIDGE CONSTRUCTION, 2007.

FOUNDATION NOTES:

EXCAVATION & BACKFILL: EXCAVATION AND BACKFILL FOR THE FOOTINGS SHALL BE IN ACCORDANCE WITH ARTICLES 125-4 AND 125-8.2 WITH THE EXCEPTION OF THE BACKFILL, IN LIEU OF THE REQUIREMENTS FOR OBTAINING THE SPECIFIED DENSITY, MAY BE HAND TAMPED IN FOUR INCH MAXIMUM LAYERS OR MACHINE TAMPED IN SIX INCH MAXIMUM LAYERS. THE MATERIAL SHOULD BE NEITHER DRY NOR SATURATED. AT THE CONTRACTORS OPTION BACKFILLING MAY BE DONE WITH POURED CONCRETE.

CONCRETE: FOOTING TO BE POURED WITH CLASS I CONCRETE (SECTION 345).

FORMS: FORMS SHALL BE IN ACCORDANCE WITH ARTICLE 700-8.3. (IF THE FOOTING IS POURED IN A OVERSIZED HOLE, THE CONCRETE IN THE TOP SIX INCHES SHALL BE PLACED IN A FORM. ALL EXPOSED SURFACES SHALL BE TROWELED TO A SMOOTH FINISH.

[Handwritten Signature]
3/13/07

REVISIONS			DESIGN BY:	DMD	Lassiter Transportation Group, Inc. <i>Engineering and Planning</i> R. SANS LASSITER, P.E. (#34868) 123 LIVE OAK AVENUE DAYTONA BEACH, FLORIDA 32114 PH: 386.257.2571 FAX: 386.257.6996 ENGINEERING BUSINESS NO. 9227	SR 50 AT CR 565A LAKE COUNTY, FLORIDA		POLE SCHEDULE AND DETAIL		SHEET NO.
DATE	BY	DESCRIPTION	DRAWN BY:	GCD		T-6				
			REVIEWED BY:	RSL						
			APPROVED BY:	RSL						
			JOB NUMBER:	3389.01						
			FILE NAME:	Dsgnsg01						

