

SOP 1

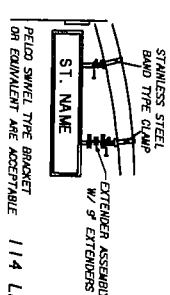

TWO POINT MAST ARM SIGN MOUNTING ASSEMBLY DETAIL



REMOVE EXISTING STOP SIGN (SEE NOTE 8)

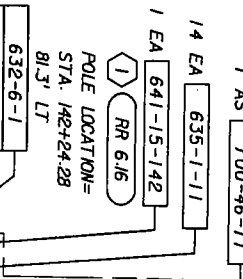

- PRE CONSTRUCTION NOTES**
- 1) CONTRACTOR TO NOTIFY THE PROJECT ENGINEER (SEE NOTE 8) 48 HRS. PRIOR TO BEGINNING CONSTRUCTION.
 - 2) IN ORDER TO EXPEDITE ENGINEERING THE SIGNAL, CONTACT LAKE COUNTY STEVE BOLLINGER @ (352) 742-1760 TO VERIFY THAT AN APPLICATION FOR POWER HAS BEEN MADE PRIOR TO BEGINNING CONSTRUCTION. IF NO APPLICATION HAS BEEN MADE, CONTACT THE FOOT PROJECT ENGINEER (SCOTT SILVA @ (386) 943-5371).
 - 3) CONTRACTOR TO SUBMIT CLASS 1 CONCRETE DESIGN MIX TO PROJECT ENGINEER PRIOR TO BEGINNING CONSTRUCTION.
 - 4) GENERAL NOTES
 - 5) TRAFFIC CONTROL SHALL BE PERFORMED IN ACCORDANCE WITH FLORIDA DEPARTMENT OF TRANSPORTATION DESIGN STANDARDS INCHES 600 & 618 AS APPLICABLE. EXISTING SPEED LIMITS SHALL BE MAINTAINED DURING CONSTRUCTION.
 - 6) THE CONTRACTOR SHALL HAND DIG THE FIRST 4' AT EACH POLE LOCATION TO VERIFY NO UTILITY CONFLICTS.
 - 7) THE CONTRACTOR IS REQUIRED TO INSPECT THE INSTALLATION OF THE TRAFFIC SIGNALS IN ACCORDANCE WITH FOOT SPECIFICATION 105-5.10.
 - 8) IN ACCORDANCE WITH FOOT SPECIFICATION 611-2.2 WITH THE BOLLINGER (352) 742-1760 SHOULD ALSO BE CONTACTED TEN DAYS BEFORE THE INSPECTION IS TO BE PERFORMED SO THEY MAY BE PRESENT. ONLY ONE LANE CAN BE CLOSED DURING ACTIVE WORK PERIODS. ALL LANE CLOSURES TO BE APPROVED BY FOOT PROJECT ENGINEER. TRAFFIC SIGNAL SHALL FLASH FOR NO LESS THAN 7 DAYS AND NO MORE THAN 14 DAYS PRIOR TO TURN ON INSPECTION.
 - 9) THE CONTRACTOR SHALL VERIFY THE POWER SERVICE REQUIREMENTS WITH LAKE COUNTY STEVE BOLLINGER @ (352) 742-1760.
 - 10) SPEED LIMIT ON SR 46 - 55 MPH.
 - 11) STOP SIGN ASSEMBLY TO BE REMOVED AT THE SAME TIME THE SIGNAL IS SWITCHED INTO FULL OPERATION.
 - 12) FULL BOXES AND COVERS SHALL BE FOOT APPROVED OF NON-METALLIC CONSTRUCTION WITH RECESSED COVER LID. TRAFFIC SIGNAL.
 - 13) THE FAR ADVANCE TYPED 'B' LOOPS ARE TO BE WIRED TO THE SYSTEM PANEL. ADDITIONALLY, EACH 'B' LOOP SHALL HAVE SEPARATE DETECTOR CHANNEL.
 - 14) SIGNAL CABLE AND LOOP WIRES TO BE IN A SEPARATE PULL BOXES.
 - 15) SIGNAL CABLE IS TO ENSURE THAT LOOP WINDOWS ARE LOCATED OFF THE RADIUS.
 - 16) ALL SIGNAL DISPLAYS SHALL BE LED.
 - 17) ALL SIGNAL HEADS SHALL BE CAST ALUMINUM.
 - 18) DELAY DETECTORS SHALL BE SET TO 5 SECONDS.
 - 19) CONTRACTOR IS NOT TO USE JONES PULSES.
 - 20) THE OVERHEAD SIGNS ARE TO BE INSTALLED ONE FOOT BELOW THE MESSANGER CABLE.
 - 21) VARIABLE MESSAGES ARE TO BE IN PLACE 500' BEFORE THE STOP BAR WITH THE MESSAGE 'CAUTION AHEAD', 'NEW SIGNAL AHEAD' FOR 2 WEEKS BEFORE AND 2 WEEKS AFTER THE SIGNAL INSTALLATION.
 - 22) OVERHEAD SPAN AND CONCRETE PILES HAVE BEEN DESIGNED TO ACCOMMODATE FUTURE SIGNAL HEADS FOR MOVEMENTS 1 AND 5.
 - 23) INSTALL SIGNAL AHEAD SIGN, W-3 (35'x36'), 750' FROM STOP BAR IN E/B AND W/B DIRECTIONS ON SR 46.

2024 11/11/23 5318

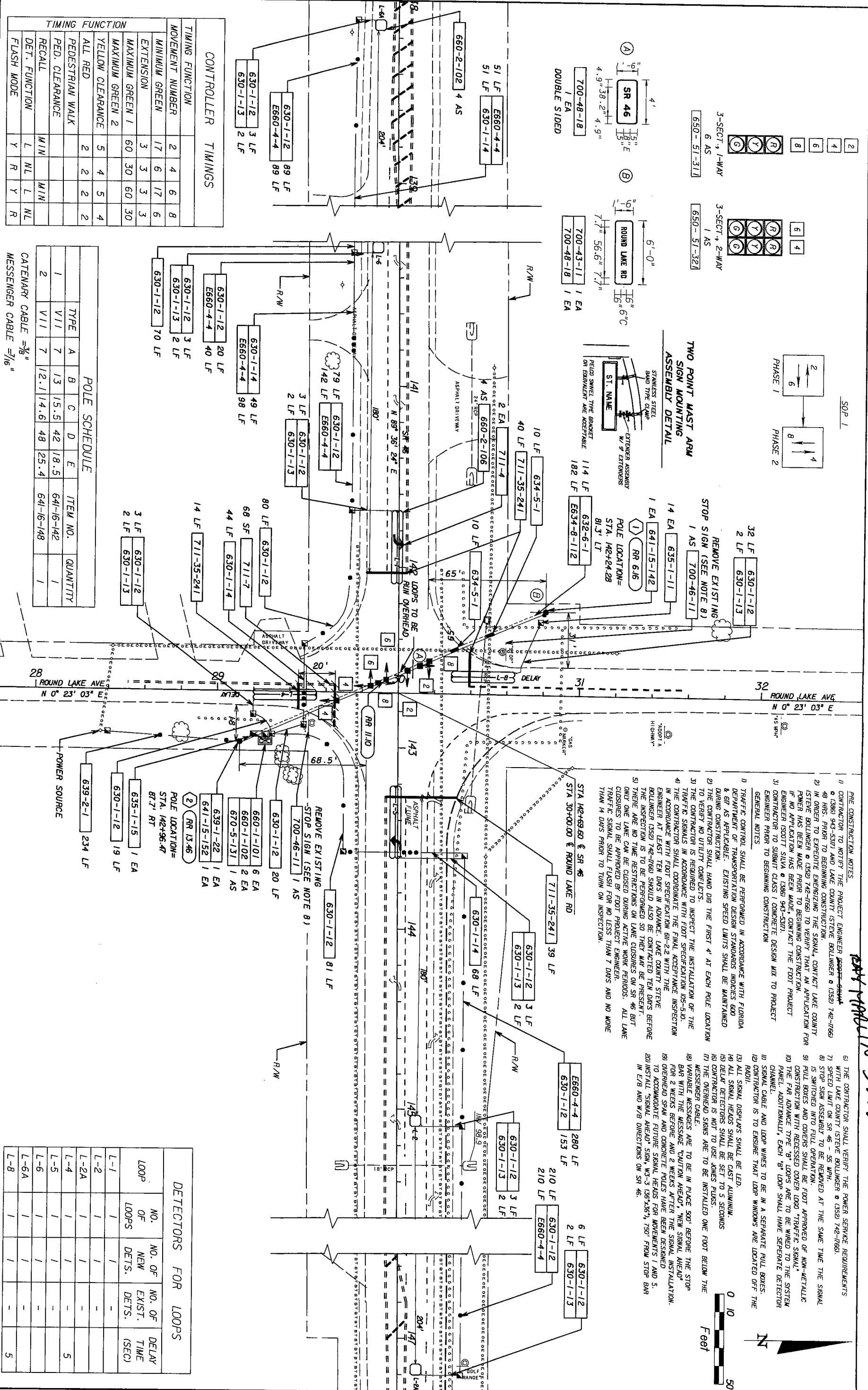

CONTROLLER TIMINGS

TIMING FUNCTION	MOVEMENT NUMBER	2	4	6	8
MINIMUM GREEN	17	6	17	6	
EXTENSION	3	3	3	3	
MAXIMUM GREEN 1	60	30	60	30	
MAXIMUM GREEN 2	5	4	5	4	
YELLOW CLEARANCE	2	2	2	2	
ALL RED					
PEDESTRIAN WALK					
PED. CLEARANCE					
RECALL					
DET. FUNCTION					
FLASH MODE					

POLE SCHEDULE

TYPE	A	B	C	D	E	ITEM NO.	QUANTITY
V11	1	7	13	15.5	42	64-16-142	1
V11	7	12.1	14.6	48	25.4	64-16-148	1

CATENARY CABLE = 3/8"
MESSENGER CABLE = 7/16"

DETECTORS FOR LOOPS

LOOP	NO. OF NEW DETS.	NO. OF EXIST. DETS.	DELAY TIME (SEC)
L-1	1	1	-
L-2	1	1	-
L-2A	1	1	-
L-4	1	1	-
L-5	1	1	-
L-6	1	1	-
L-6A	1	1	-
L-8	1	1	-

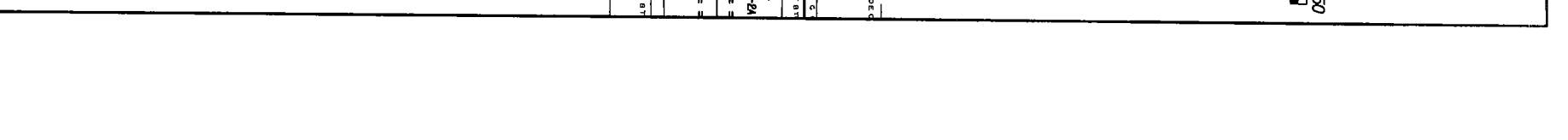
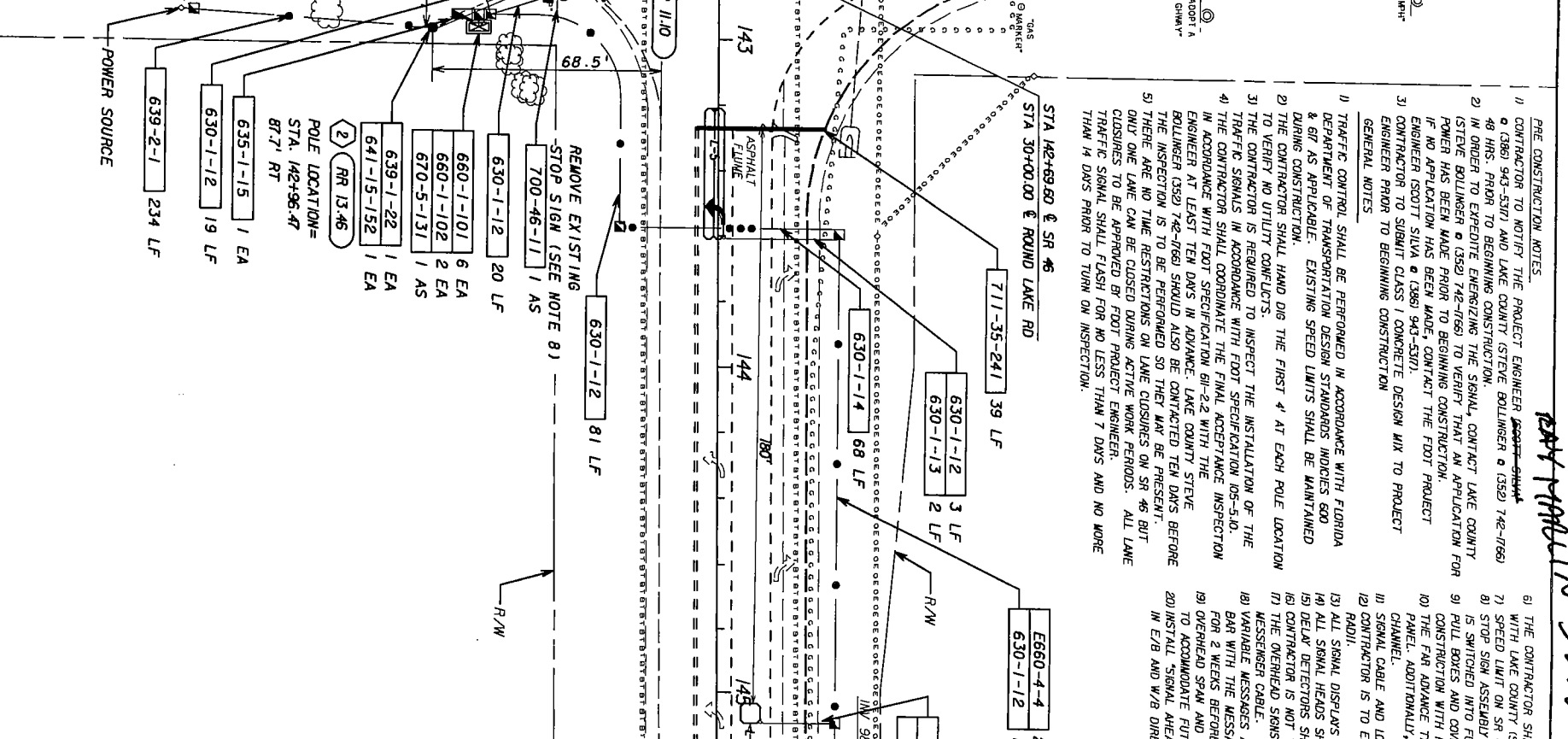
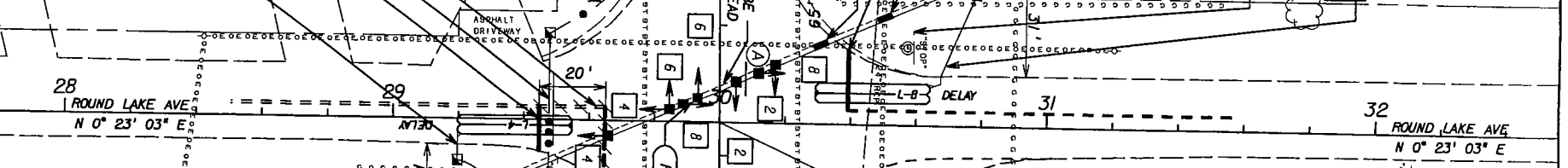

DATE: _____ BR: _____ DESCRIPTION: _____

REVISIONS

DATE	BR	DESCRIPTION

METRIC ENGINEERING, INC.
2260 LEE ROAD, SUITE 200
WINTER PARK, FLORIDA 32789
TEL (407) 644-1888
FAX (407) 644-2376
FLORIDA CERT. NO. EB-0002294
VENDOR # F-59-1696550
DALE W. CODY, P.E.
P.E. NUMBER 53995

STATE OF FLORIDA
DEPARTMENT OF TRANSPORTATION
ROAD NO. SR 46 COUNTY LAKE FINANCIAL PROJECT ID 238002-2-52-06

SIGNALIZATION PLANS
SR 46 & ROUND LAKE ROAD
SECTION 1150 M.P. 2.706

SHEET NO. 1