

POLE		EDULE					PAY ITEM
POLE NO.	TYPE	A	B	C	D	E	
A	H V 11	10	14.5	17	54	26	641-16-154
B	H V 11	10	12.5	15	50	24	641-16-150

SPAN CABLE SHALL BE 3/8" AND THE MESSENGER CABLE SHALL BE 7/16".
 S.O.P. 7

DETECTORS FOR LOOPS			
LOOP	NO. OF LOOPS	NO. OF NEW DETS.	DELAY TIME (SEC)
L-1	1	1	5
L-5	1	1	5
L-2A	1	1	
L-2B	1	1	
L-6A	1	1	
L-6B	1	1	
L-7	1	1	
L-8	1	1	2
L-4	1	1	5
L-8R	1	1	5

DELAY TIME IS INITIAL AND MAY REQUIRE FIELD ADJUSTING AS DIRECTED BY PROJECT ENGINEER.

TWO POINT SIGN MOUNTING ASSEMBLY DETAIL

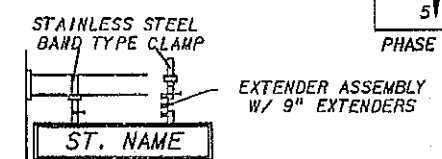

INTERLINE AND INTERWORD SPACING AT 50%

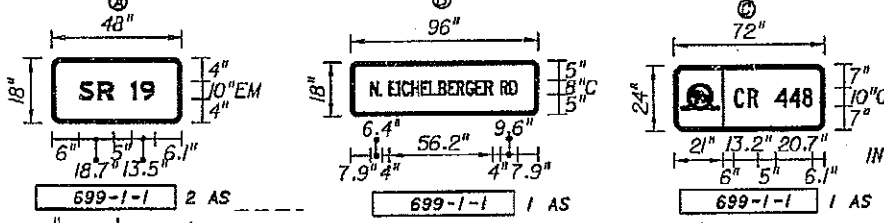

INTERLINE SPACING AT 50%

CONTROLLER TIMINGS							
TIMING FUNCTION	1	2	4	5	6	8	
MOVEMENT NUMBER	1	2	4	5	6	8	
MINIMUM GREEN	5	17	5	5	17	5	
EXTENSION	3	3	3	3	3	3	
MAXIMUM GREEN 1	15	60	30	15	60	30	
MAXIMUM GREEN 2							
YELLOW CLEARANCE	4	5	4	4	5	4	
ALL RED	2	2	2	2	2	2	
PEDESTRIAN WALK							
PED. CLEARANCE							
RECALL							
FUNCTION	NL	L	NL	NL	L	NL	
FLASH MODE		Y	R		Y	R	

PRE-EMPTION PHASING CHART		
DIRECTION	MOVEMENT	EXIT PHASE
NB	1 AND 6	2 AND 6
SB	2 AND 5	2 AND 6
EB	8	2 AND 6
WB	4	2 AND 6

UTILITY COMPANY	CONTACT PERSON	PHONE NUMBER
CITY OF TAVARES	ROB ERN	352-343-8481
FLORIDA CABLE	LARRY ENGLISH	352-759-2788
COMCAST TELEVISION	BILL GRAHAM	352-787-9601 x 159
PEOPLES GAS	BRUCE STOUT	407-420-2879
SUNTER ELECTRIC CO.	MICHAEL COLON	352-427-7582
EMBARQ	WADE RICH	407-814-5383

Michael L. Cornejo 1/10/07

MICHAEL L. CORNEJO, P.E. # 47734
 METRIC ENGINEERING, INC.
 615 CRESCENT EXECUTIVE COURT
 SUITE 524
 LAKE MARY, FLORIDA 32746
 TEL. (407) 644-1898
 FAX. (407) 644-2376
 FLORIDA CERT. NO. EB-0002294

STATE OF FLORIDA DEPARTMENT OF TRANSPORTATION		
ROAD NO.	COUNTY	FINANCIAL PROJECT ID
SR 19	LAKE	238002-2-52-34

**SR 19 @ CR 448
 SEC 11080 MP 3.280**

SHEET NO.
1

REVISIONS			
DATE	BY	DESCRIPTION	

PRE CONSTRUCTION NOTES

- 1) CONTRACTOR TO NOTIFY THE FLORIDA DEPARTMENT OF TRANSPORTATION (RAY MARLIN @ (386) 943-5318) AND LAKE COUNTY (STEVE BOLLINGER @ (352) 742-1766) 2 BUSINESS DAYS PRIOR TO BEGINNING CONSTRUCTION.
- 2) IN ORDER TO EXPEDITE ENERGIZING THE SIGNAL, CONTACT LAKE COUNTY (STEVE BOLLINGER @ (352) 742-1766) TO VERIFY AN APPLICATION FOR POWER HAS BEEN MADE PRIOR TO BEGINNING CONSTRUCTION. IF NO APPLICATION HAS BEEN MADE, CONTACT THE FDOT PROJECT ENGINEER (JIM STROZ @ (386) 943-5312).
- 3) CONTRACTOR TO PROVIDE CONCRETE MIX DESIGN PRIOR TO CONSTRUCTION.

GENERAL NOTES

- 1) TRAFFIC CONTROL SHALL BE PERFORMED IN ACCORDANCE WITH FLORIDA DEPARTMENT OF TRANSPORTATION DESIGN STANDARDS INDICIES 600 & 617 AS APPLICABLE. EXISTING SPEED LIMITS SHALL BE MAINTAINED DURING CONSTRUCTION.
- 2) THE CONTRACTOR SHALL HAND DIG THE FIRST 4' AT EACH POLE LOCATION TO VERIFY NO UTILITY CONFLICTS.
- 3) THE CONTRACTOR IS REQUIRED TO INSPECT THE INSTALLATION OF THE TRAFFIC SIGNALS IN ACCORDANCE WITH FDOT SPECIFICATION 105-5.10. THE CONTRACTOR SHALL COORDINATE THE FINAL ACCEPTANCE INSPECTION IN ACCORDANCE WITH FDOT SPECIFICATION 611-2.2 WITH THE ENGINEER AT LEAST 10 DAYS IN ADVANCE. LAKE COUNTY AND RAY MARLIN (386-943-5318) SHALL ALSO BE CONTACTED 10 DAYS BEFORE THE INSPECTION IS TO BE PERFORMED SO THEY MAY BE PRESENT.
- 4) NO LANE CLOSURES ARE ALLOWED ON SR 19 IN THE NORTH OR SOUTHBOUND DIRECTIONS FROM 7 AM TO 9 AM AND 3 PM TO 6 PM ALL LANE CLOSURES TO BE APPROVED BY FDOT PROJECT MANAGER.
- 5) TRAFFIC SIGNAL SHALL FLASH FOR NO LESS THAN 7 DAYS AND NO MORE THAN 14 DAYS PRIOR TO TURN ON INSPECTION.

- 6) THE CONTRACTOR SHALL VERIFY THE POWER SERVICE REQUIREMENTS WITH LAKE COUNTY (STEVE BOLLINGER @ (352) 742-1766). APPLICATION FOR POWER HAS BEEN SET-UP.
- 7) SPEED LIMIT ON SR 19 - 55 MPH.
- 8) STOP SIGN ASSEMBLIES TO BE REMOVED AT THE SAME TIME THE SIGNAL IS SWITCHED INTO FULL OPERATION. ONLY THE STOP SIGN PANEL IS TO BE REMOVED ON THE WEST APPROACH.
- 9) PULL BOXES AND COVERS SHALL BE FDOT APPROVED OF NON-METALLIC CONSTRUCTION WITH RECESSED COVER LOGO "TRAFFIC SIGNAL" OR "FDOT FIBER OPTICS" AS APPROPRIATE.
- 10) THE FAR ADVANCE TYPE "B" LOOPS ARE TO BE WIRED TO THE SYSTEM PANEL AND SHALL FUNCTION AS BOTH SYSTEM LOOPS AND ADVANCED LOOPS. ADDITIONALLY, EACH "B" LOOP SHALL HAVE SEPERATE DETECTOR CHANNEL.
- 11) SIGNAL CABLE AND LOOP WIRES TO BE IN A SEPARATE PULL BOXES.
- 12) CONTRACTOR IS TO ENSURE THAT LOOP WINDOWS ARE LOCATED OFF THE RADII.
- 13) ALL SIGNAL DISPLAYS SHALL BE LED.
- 14) ALL SIGNAL HEADS SHALL BE CAST ALUMINUM.
- 15) DELAY DETECTORS SHALL BE SET TO 5 SECONDS, EXCEPT L-8, WHICH SHALL BE SET AT 2 SECONDS.
- 16) ALL CANTILEVER SUPPORTED SIGNS ARE TO BE FREE SWINGING PER THE DETAIL.
- 17) CONTRACTOR IS NOT TO USE JONES PLUGS.
- 18) THE OVERHEAD SIGNS ARE TO BE INSTALLED 1' BELOW THE MESSENGER CABLE.
- 19) PAY ITEM NO. 102-99 INCLUDES ONE VARIABLE MESSAGE SIGNS ON THE NORTHBOUND AND SOUTHBOUND APPROACHES FOR A TOTAL OF 14 DAYS AFTER SIGNAL ACTIVATION, EACH TO READ "CAUTION CAUTION CAUTION" ON PANEL ONE AND "NEW SIGNAL AHEAD" ON PANEL TWO.
- 20) OVERHEAD SPAN AND CONCRETE POLES HAVE BEEN DESIGNED TO ACCOMMODATE FUTURE 5 SECTION HEADS FOR MOVEMENTS 4 & 8 (INSIDE HEADS). BACKPLATES ARE NOT INCLUDED IN DESIGN.
- 21) REMOVE ALL STRIPING BETWEEN THE STOP BARS.
- 22) AN AUXILIARY SIGNAL HEAD FOR MOVEMENT 8 SHALL BE INSTALLED ON POLE "A" 12' ABOVE GROUND LEVEL.

- 23) CONTRAC. TO CONTACT LAKE COUNTY FOR CONTROLLER REQUIREMENTS.
- 24) CONTRACTOR TO USE THE 50' TYPE VII SIGNAL POLE THAT IS BEING STORED AT THE POLE MANUFACTURER THAT WAS ORIGINALLY ORDERED FOR THE SR 44 AND I-95 NORTHBOUND OFF RAMP PROJECT.
- 25) CONTRACTOR TO PLACE CAN IN THE SOUTHWEST SIGNAL POLE FOUNDATION TO PREVENT CONCRETE FROM ENCASING UTILITIES.
- 26) GROUNDING FOR THE CONTROLLER ASSEMBLY SHALL MEASURE NO MORE THAN 25 OHMS. CONTRACTOR TO CONTACT LAKE COUNTY ENGINEERING TO VERIFY THE RESISTANCE OF THE GROUND RODS.

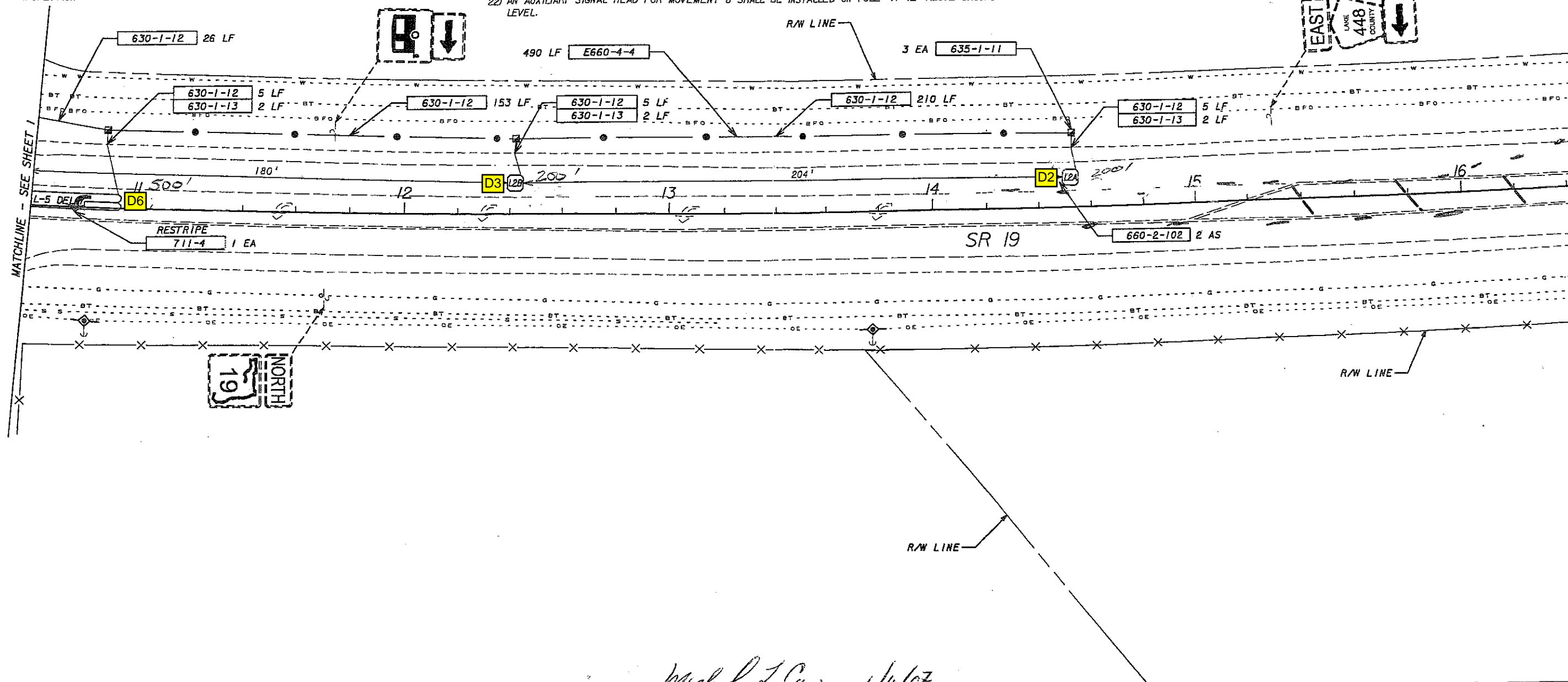
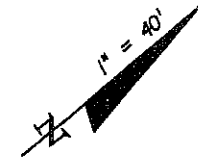

REVISIONS					
DATE	BY	DESCRIPTION	DATE	BY	DESCRIPTION

MICHAEL L. CORNEJO, P.E. # 47734
 METRIC ENGINEERING, INC.
 615 CRESCENT EXECUTIVE COURT
 SUITE 524
 LAKE MARY, FLORIDA 32746
 TEL. (407) 644-1898
 FAX. (407) 644-2376
 FLORIDA CERT. NO. EB-0002294

STATE OF FLORIDA DEPARTMENT OF TRANSPORTATION		
ROAD NO.	COUNTY	FINANCIAL PROJECT ID
SR 19	LAKE	238002-2-52-34

**SR 19 @ CR 448
 SEC 11080 MP. 3.280**

SHEET NO.
2