

LAKE COUNTY PUBLIC WORKS DEPARTMENT
ENGINEERING DIVISION

CONTRACT PLANS

LAKE COUNTY
HOOKS STREET AT
CITRUS TOWER BLVD

SIGNALIZATION PLANS

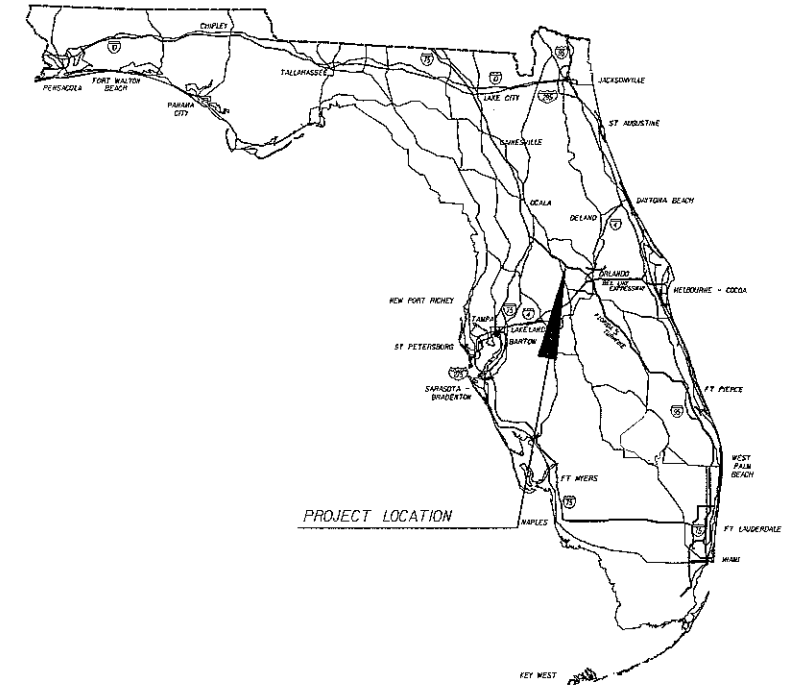

INDEX OF SIGNALIZATION PLANS

SHEET NO.	SHEET DESCRIPTION
T-1	KEY SHEET
T-2 - T-3	TABULATION OF QUANTITIES
T-4	GENERAL NOTES
T-5	SIGNALIZATION PLAN
T-6	SIGNING AND PAVEMENT MARKING PLAN
T-7	CONCRETE STRAIN POLE SCHEDULE
T-8	INTERNALLY ILLUMINATED STREET NAME SIGN DETAIL
T-9 - T-21	INTERCONNECT PLAN

COUNTY COMMISSIONERS

JENNIFER S. HILL, VICE CHAIR	DISTRICT ONE
ELAINE RENICK	DISTRICT TWO
DEBBIE STIVENDER	DISTRICT THREE
LINDA STEWART	DISTRICT FOUR
WELTON G. CADWELL, CHAIR	DISTRICT FIVE
CINDY HALL	COUNTY MANAGER

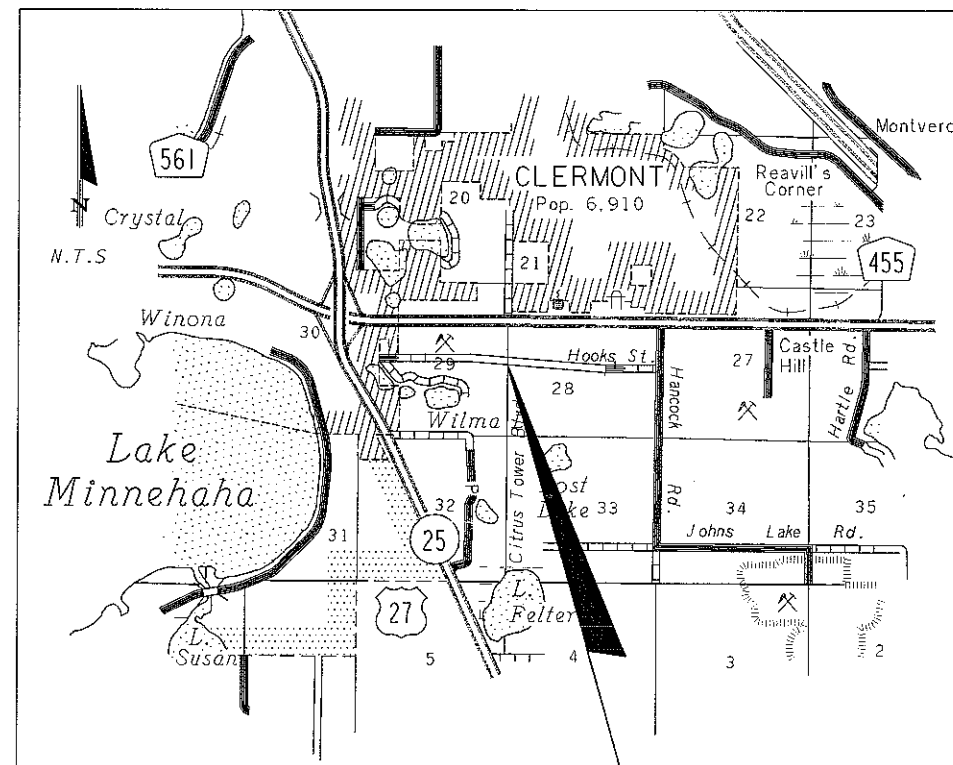

PROJECT LOCATION

GOVERNING STANDARDS AND SPECIFICATIONS:
FLORIDA DEPARTMENT OF TRANSPORTATION,
DESIGN STANDARDS DATED 2006, AND
STANDARD SPECIFICATIONS FOR ROAD AND BRIDGE
CONSTRUCTION DATED 2007,
AS AMENDED BY CONTRACT DOCUMENTS.

HNTB

HNTB CORPORATION
300 PRIMERA BLVD., SUITE 200
LAKE MARY, FL. 32746
(407) 805-0355
VENDOR NO.: F431623092009
CERT. OF AUTH. NO.6500

NOTE: THE SCALE OF THESE PLANS MAY
HAVE CHANGED DUE TO REPRODUCTION.

SIGNALIZATION PLANS
ENGINEER OF RECORD: MAFC W. HUSTAD, P.E.

P.E. NO. 66761

M. Hustad
12-3-07

KEY SHEET REVISIONS		
DATE	BY	DESCRIPTION

LAKE COUNTY PROJECT MANAGER: JUAN CHAN, P.E.

FISCAL YEAR: 08
SHEET NO.: T-1

12/3/2007 4:04:40 PM

sgshsh

sgshsh

N:\22323.08\DCN 2007\keysq01.dgn

TABULATION OF QUANTITIES

BID ITEM NO.	DESCRIPTION	UNIT	SHEET NUMBER																				TOTAL THIS SHEET
			T-5		T-6		T-9		T-10		T-11		T-12		T-13		T-14		T-15		T-16		
			ORIGINAL	FINAL	ORIGINAL	FINAL	ORIGINAL	FINAL	ORIGINAL	FINAL	ORIGINAL	FINAL	ORIGINAL	FINAL	ORIGINAL	FINAL	ORIGINAL	FINAL	ORIGINAL	FINAL	ORIGINAL	FINAL	
101-1	MOBILIZATION	LS	1																			1	
630-1-12	CONDUIT, UNDERGROUND	LF	1149				307		332		266		260		446		510		475		393	4138	
630-1-14	CONDUIT, UNDERGROUND JACKED	LF	419				280		230		130		295		91		50		45		180	1720	
632-7-1	SIGNAL CABLE	PI	1																			1	
633-121-1	CABLE FIBER OPTIC (24SM)	LF	346				612		587		421		580		562		585		545		598	4836	
634-4-113	SPAN WIRE ASSEMBLY (BOX)	PI	1																			1	
635-1-11	PULL BOX	EA	14																			14	
635-1-15	FIBER OPTIC PULL BOX	EA					1		1		1		1		1		1		1		1	8	
635-1-16	SPECIAL PULL BOX	EA	1																			1	
639-1-12	ELECTRICAL POWER SERVICE (OVERHEAD)	AS	1																			1	
639-2-1	ELECTRICAL SERVICE WIRE	LF	15																			15	
641-16-46	CONCRETE STRAIN POLES (46 FOOT)	EA	2																			2	
641-16-50	CONCRETE STRAIN POLES (50 FOOT)	EA	2																			2	
650-51-311	TRAFFIC SIGNAL, 3 SECTION, 1WAY (LED)	AS	8																			8	
650-51-511	TRAFFIC SIGNAL, 5 SECTION, 1WAY (LED)	AS	2																			2	
653-191	PEDESTRIAN SIGNAL, 1 SECTION, 1WAY (LED)	AS	8																			8	
660-1-109	INDUCTIVE LOOP DETECTOR TYPE 9	EA	3																			3	
660-1-110	INDUCTIVE LOOP DETECTOR TYPE 10	EA	3																			3	
660-2-102	LOOP ASSEMBLY TYPE B	AS	4																			4	
660-2-106	LOOP ASSEMBLY TYPE F	AS	8																			8	
663-74-11	VEHICLE DETECTOR ASSEMBLIES (OPTICAL TYPE)	EA	2																			2	
665-11	PEDESTRIAN DETECTOR	EA	8																			8	
670-5-110	ACTUATED SOLID STATE CONTROLLER ASSEMBLY	AS	1																			1	
685-128	SYSTEM AUXILIARIES, INTERFACE PANEL	EA	1																			1	
685-140	SYSTEM AUXILIARIES, FIBER OPTIC MODULATOR/DEMODULATOR	EA	1																			1	
699-1-1	INTERNALLY ILLUMINATED STREET NAME SIGN (DOUBLE SIDED)	EA	4																			4	
700-20-11	SIGN SINGLE POST (<= 12SF)	AS																					
	R4-7, OMI-1 (24"X30", 18"X18")	AS					1															1	
700-20-60	SIGN SINGLE POST (REMOVE)	AS					1															1	
706-3	RETRO RELECTIVE PAVEMENT MARKERS (WHITE/RED)	EA					34															34	
711-11-160	PAVEMENT MESSAGES	EA					5															5	
711-11-170	DIRECTIONAL ARROW	EA					5															5	
711-11-121	SOLID TRAFFIC STRIPE (6" WHITE)	LF					972															972	
711-11-125	SOLID TRAFFIC STRIPE (24" WHITE)	LF					167															167	
711-11-141	SKIP TRAFFIC STRIPE (10'-30' SKIP, 6" WHITE)	LF					182															182	
711-11-221	SOLID TRAFFIC STRIPE (6" YELLOW)	LF					575															575	
711-17	REMOVE EXISTING PAVEMENT MARKINGS	SF					684															684	

PAY ITEM NOTES

1. PAY ITEM NO. 630-1-12 SHALL BE INSTALLED PER SECTION 630, CONDUIT OF THE STANDARD SPECIFICATIONS. ALL CONDUITS SHALL ENTER PULL BOXES AS REQUIRED IN STANDARD INDEX 17721, SHEET 2 OF 2.
2. WHEN JACKING CONDUIT UNDER PAVEMENT, THE CONTRACTOR MAY USE AN FDOT APPROVED GUIDED BORING SYSTEM AS AN ALTERNATE METHOD OF CONSTRUCTION. AN ACCEPTABLE METHOD IS THE DITCH WITCH JET-TRAC OR EQUIVALENT, PAID FOR UNDER PAY ITEM NUMBER 630-1-14.
3. PAY ITEM NO. 632-7-1 SHALL BE INSTALLED PER STANDARD INDEX 17727, AS APPLICABLE, AND AS STATED IN THE GENERAL NOTES.
4. PAY ITEM NO. 639-1-12 SHALL INCLUDE THE COST OF ALL LABOR, MATERIALS AND PERMITS REQUIRED TO FURNISH AND INSTALL THE ASSEMBLY. THE CONTRACTOR SHALL BE RESPONSIBLE FOR COORDINATION WITH ALL AGENCIES REQUIRED FOR APPROVAL OF THE COMPLETED INSTALLATION. STANDARD INDEX 17736, AS APPLICABLE, SHALL APPLY.
5. PAY ITEM NO. 639-2-1 THE CONTRACTOR SHALL BE RESPONSIBLE FOR SIZING THE CONDUCTORS FOR THE POWER SERVICE.
6. PAY ITEM NO. 670-5-110 SHALL BE A TYPE V CABINET.
7. PAY ITEM NO. 699-1-1 SHALL INCLUDE CANTILEVER ARMS, BRACKETS AND ALL HARDWARE NECESSARY TO INSTALL STREET NAME SIGNS AND PROVIDE FOR A COMPLETE INSTALLATION.
8. INTERNALLY ILLUMINATED STREET NAME SIGNS SHALL HAVE A SEPARATE CIRCUIT BREAKER IN THE MAIN CIRCUIT BREAKER PANEL CONTROLLED BY A SINGLE PHOTOCELL ACCESSIBLE BY A LIFT TRUCK.
9. INTERNALLY ILLUMINATED STREET NAME SIGN SHALL BE DOUBLE SIDED AND ILLUMINATED BY LED.

M. W. HUSTAD
12-3-07

R E V I S I O N S						HNTB HNTB CORPORATION 300 CRIMERA BLVD, SUITE 200 LAKE MARY, FL 32746 (407) 205-0355 CERT. OF AUTH. NO. 6520	LAKE COUNTY TRAFFIC ENGINEERING DEPARTMENT			SHEET NO. T-2
DATE	BY	DESCRIPTION	DATE	BY	DESCRIPTION		ROAD NO.	COUNTY	PROJECT NO.	
						ENGINEER OF RECORD: MARC W. HUSTAD, P.E. FL. REGISTRATION NO. 66761	HOOKS ST AT CITRUS TOWER BLVD	LAKE	22323.08, 43817.00	TABULATION OF QUANTITIES

12/3/2007 4:21:32 PM

sgshosh

N:\22323.08\DWG 2007\TAB05G01.dgn

12/3/2007

TABULATION OF QUANTITIES

BID ITEM NO.	DESCRIPTION	UNIT	SHEET NUMBER																TOTAL THIS SHEET	GRAND TOTAL		
			T-17		T-18		T-19		T-20		T-21											
			ORIGINAL	FINAL	ORIGINAL	FINAL	ORIGINAL	FINAL	ORIGINAL	FINAL	ORIGINAL	FINAL	ORIGINAL	FINAL	ORIGINAL	FINAL	ORIGINAL	FINAL				
101-1	MOBILIZATION	LS																			1	
630-1-12	CONDUIT, UNDERGROUND	LF	254		325		125		78		98										880	5018
630-1-14	CONDUIT, UNDERGROUND JACKED	LF	282		114		437		495		7										1335	3055
632-7-1	SIGNAL CABLE	PI																				1
633-121-1	CABLE FIBER OPTIC (24SM)	LF	586		684		587		598		130										2585	
634-4-113	SPAN WIRE ASSEMBLY (BOX)	PI																				1
635-1-11	PULL BOX	EA																				14
635-1-15	FIBER OPTIC PULL BOX	EA	2				1		1		1										5	
635-1-16	SPECIAL PULL BOX	EA																				1
639-1-12	ELECTRICAL POWER SERVICE (OVERHEAD)	AS																				1
639-2-1	ELECTRICAL SERVICE WIRE	LF																				15
641-16-46	CONCRETE STRAIN POLES (46 FOOT)	EA																				2
641-16-50	CONCRETE STRAIN POLES (50 FOOT)	EA																				2
650-51-311	TRAFFIC SIGNAL, 3 SECTION, 1WAY (LED)	AS																				8
650-51-511	TRAFFIC SIGNAL, 5 SECTION, 1WAY (LED)	AS																				2
653-191	PEDESTRIAN SIGNAL, 1SECTION, 1WAY (LED)	AS																				8
660-1-109	INDUCTIVE LOOP DETECTOR TYPE 9	EA																				3
660-1-110	INDUCTIVE LOOP DETECTOR TYPE 10	EA																				3
660-2-102	LOOP ASSEMBLY TYPE B	AS																				4
660-2-106	LOOP ASSEMBLY TYPE F	AS																				8
663-74-11	VEHICLE DETECTOR ASSEMBLIES (OPTICAL TYPE)	EA																				2
665-11	PEDESTRIAN DETECTOR	EA																				8
670-5-110	ACTUATED SOLID STATE CONTROLLER ASSEMBLY	AS																				1
685-128	SYSTEM AUXILIARIES, INTERFACE PANEL	EA																				1
685-140	SYSTEM AUXILIARIES, FIBER OPTIC MODULATOR/DEMULATOR	EA																				1
699-1-1	INTERNALLY ILLUMINATED STREET NAME SIGN (DOUBLE SIDED)	EA																				4
700-20-11	SIGN SINGLE POST (<= 12SF)	AS																				
	R4-7, OMI-1 (24"x30", 18"x18")	AS																				1
700-20-60	SIGN SINGLE POST (REMOVE)	AS																				1
706-3	RETRO RELECTIVE PAVEMENT MARKERS (WHITE/RED)	EA																				34
711-11-160	PAVEMENT MESSAGES	EA																				5
711-11-170	DIRECTIONAL ARROW	EA																				5
711-11-121	SOLID TRAFFIC STRIPE (6" WHITE)	LF																				972
711-11-125	SOLID TRAFFIC STRIPE (24" WHITE)	LF																				167
711-11-141	SKIP TRAFFIC STRIPE (10'-30' SKIP, 6" WHITE)	LF																				182
711-11-221	SOLID TRAFFIC STRIPE (6" YELLOW)	LF																				575
711-17	REMOVE EXISTING PAVEMENT MARKINGS	SF																				684

12/3/2007 4:21:08 PM N:\22323.08\DWG 2007\TAB05602.dgn sghosh

M-w 12-3-07

<p>REVISIONS</p> <table border="1"> <thead> <tr> <th>DATE</th> <th>BY</th> <th>DESCRIPTION</th> <th>DATE</th> <th>BY</th> <th>DESCRIPTION</th> </tr> </thead> <tbody> <tr> <td> </td> <td> </td> <td> </td> <td> </td> <td> </td> <td> </td> </tr> </tbody> </table>						DATE	BY	DESCRIPTION	DATE	BY	DESCRIPTION							 <p>HNTB CORPORATION 300 PRINERA BLVD, SUITE 200 LAKE MARY, FL 32746 (407) 805-0355 CERT. OF AUTH. NO. 6500</p> <p>ENGINEER OF RECORD: MARC W. HUSTAD, P.E. FL. REGISTRATION NO. 66761</p>			<p>LAKE COUNTY TRAFFIC ENGINEERING DEPARTMENT</p> <table border="1"> <tr> <td>ROAD NO.</td> <td>COUNTY</td> <td>PROJECT NO.</td> </tr> <tr> <td>HOOKS ST AT CITRUS TOWER BLVD</td> <td>LAKE</td> <td>22323.08, 43817.00</td> </tr> </table>			ROAD NO.	COUNTY	PROJECT NO.	HOOKS ST AT CITRUS TOWER BLVD	LAKE	22323.08, 43817.00	<p>TABULATION OF QUANTITIES</p>			<p>SHEET NO. T-3</p>
DATE	BY	DESCRIPTION	DATE	BY	DESCRIPTION																												
ROAD NO.	COUNTY	PROJECT NO.																															
HOOKS ST AT CITRUS TOWER BLVD	LAKE	22323.08, 43817.00																															

12/3/2007

SIGNALIZATION GENERAL NOTES

1. THESE PLANS HAVE BEEN PREPARED IN ACCORDANCE WITH THE MANUAL ON UNIFORM TRAFFIC CONTROL DEVICES (MUTCD), THE FLORIDA DEPARTMENT OF TRANSPORTATION STANDARD SPECIFICATIONS FOR ROAD AND BRIDGE CONSTRUCTION, AND THE FLORIDA DEPARTMENT OF TRANSPORTATION DESIGN STANDARDS (JANUARY, 2006, AND ALL SUPPLEMENTS APPLICABLE THERETO).
2. ALL WORK SHALL CONFORM TO THE ABOVE STANDARD REQUIREMENTS, ANY LOCAL JURISDICTIONAL REQUIREMENTS THAT EXCEED THOSE LISTED ABOVE, AND ANY MANUFACTURER'S REQUIREMENTS THAT ARE NOT COVERED ABOVE.
3. THE MAINTAINING AGENCY SHALL BE LAKE COUNTY.
4. NO TEST BORINGS WERE MADE IN THE VICINITY OF PROPOSED CONDUIT RUNS OR DIRECTIONAL BORES. IT SHALL BE THE RESPONSIBILITY OF THE CONTRACTOR TO EXAMINE JOB SITE CONDITIONS PRIOR TO THE SUBMISSION OF BID PROPOSALS PER SECTION 2-4 OF THE FDOT SPECIFICATIONS.
5. THESE PLANS REFLECT CONDITIONS KNOWN AT THE TIME OF PLAN DEVELOPMENT. IN THE EVENT THAT ACTUAL FIELD CONDITIONS PREVENT THE APPLICATION OF THESE PLANS AND/OR THE SPECIFICATIONS OR THE PROGRESSION OF THE WORK SPECIFIED IN THE PLANS, THE CONTRACTOR SHALL NOTIFY THE ENGINEER IN CHARGE IMMEDIATELY AND PRIOR TO ANY FURTHER PROSECUTION OF THE WORK.
6. ALUMINUM HOUSINGS SHALL BE USED FOR ALL TRAFFIC SIGNAL HEADS. NO POLYCARBONATE HOUSING OR MOUNTING HARDWARE WILL BE PERMITTED. TUNNEL VISORS SHALL BE FULL VISORS (NOT CUT-AWAY TYPE) AND PAYMENT FOR TUNNEL VISORS SHALL BE INCIDENTAL TO PAY ITEMS FOR TRAFFIC SIGNAL HEAD ASSEMBLIES. SIGNAL HOUSINGS SHALL BE BLACK IN COLOR. ALL SIGNAL HEADS ON THE EAST AND WEST APPROACHES SHALL HAVE BACK PLATES.
7. THE CONTRACTOR SHALL VERIFY WITH THE MAINTAINING AGENCY, COLOR CODES FOR THE SIGNAL CABLE CONDUCTORS PRIOR TO ORDERING.
8. ONE ADDITIONAL (SPARE) CONDUIT SHALL BE RUN FROM THE CONTROLLER CABINET BASE TO THE NEAREST PULL BOX FOR DETECTION EQUIPMENT WIRES AND SIGNAL CABLE RESPECTIVELY.
9. PULL BOXES SHALL BE QUAZITE 1324 OR EQUIVALENT AND SHALL BE PLACED BEHIND CURB AND GUTTER. IF THERE IS NO CURB AND GUTTER, THE PULL BOXES SHALL BE PLACED A MINIMUM OF 10' FROM THE EDGE OF PAVEMENT, BUT NOT AT THE BOTTOM OF ANY DITCH OR RETENTION AREA. THE LIDS SHALL BE NON-METALLIC, TRAFFIC BEARING MATERIAL AND PRESSED COVER LOGO WITH "TRAFFIC SIGNAL". ALL PULL BOXES AND COVERS SHALL BE FDOT APPROVED.
10. DURING NON-WORKING HOURS, THE CONTRACTOR SHALL NOT STORE ANY MATERIALS OR PARK ANY EQUIPMENT WITHIN 30' OF THE EDGE OF THE TRAVELWAY. IF THE ABOVE IS NOT POSSIBLE, THE CONTRACTOR SHALL REQUEST THE ENGINEER IN CHARGE TO APPOINT AN APPROVED STORAGE AREA AND SUCH AREA SHALL BE PROPERLY DELINEATED AND ADVANCE WARNING SHALL BE UTILIZED.
11. PER FDOT STANDARD SPECIFICATIONS, ALL FIELD WIRING SHALL BE CLEARLY IDENTIFIED WITH WEATHER PROOF TAGS THAT ARE SECURELY ATTACHED TO EACH CABLE. THE CONTRACTOR SHALL SUBMIT THE PROPOSED TAGGING SYSTEM WITH THE SUBMITTALS PACKAGE AS REQUIRED FOR PERMIT JOBS.
12. THE CONTROLLER BASE ELEVATION SHALL BE 4"-8" ABOVE THE GRADE.
13. THREE SPARE CONDUCTORS PER SIGNAL CABLE ARE REQUIRED. SPARES SHALL BE BOUND TOGETHER AND GROUNDED TO THE BUS GROUNDING FACILITY IN THE CONTROLLER CABINET.
14. ALL TRAFFIC SIGNAL HEAD ASSEMBLIES SHALL HAVE A MINIMUM LOW POINT OF CLEARANCE OF 17.5' AND A MAXIMUM HIGH POINT OF CLEARANCE OF 19' FROM THE BOTTOM OF THE ASSEMBLY TO THE ROADWAY.
15. AT THE TIME OF FINAL INSPECTION OF THE INSTALLATION, THE CONTRACTOR SHALL PROVIDE TWO SETS OF CONSTRUCTION AS-BUILT PLANS, THAT INCLUDE CONDUIT AND PULL BOX LOCATIONS, AND FDOT FORMAT SERIES RESISTENCE DATA FORMS FOR ALL GROUNDING ELECTRODES.
16. THE CONTRACTOR SHALL FURNISH ALL NECESSARY EQUIPMENT INCLUDING A BUCKET TRUCK FOR TESTING AND INSPECTION OF TRAFFIC SIGNALS.
17. UPON COMPLETION OF THE TRAFFIC SIGNAL INSTALLATION, THE TRAFFIC SIGNAL SHALL BE PLACED IN FLASHING OPERATION FOR A PERIOD OF 7-14 DAYS PRIOR TO COMMENCEMENT OF FULL STOP CONTROL OPERATION.
18. SIGNAL CABLE AND LOOP WIRES TO BE IN SEPARATE PULL BOXES.
19. THE CONTRACTOR SHALL STAKE ALL POLE LOCATIONS AND HAVE THEM APPROVED BY LAKE COUNTY TRAFFIC ENGINEERING.
20. AS DIRECTED BY THE PROJECT ENGINEER, THE CONTRACTOR SHALL ADJUST CONDUIT AND PULL BOXES HORIZONTALLY AND/OR VERTICALLY IN ORDER TO AVOID ANY POSSIBLE CONFLICTS WITH UNDERGROUND UTILITIES.
21. ALL CONDUIT SHALL BE 2-INCH MINIMUM UNLESS OTHERWISE SPECIFIED IN THE PLANS AND SHALL HAVE A LOCATE WIRE INSTALLED IN ALL FIBER OPTIC AND FUTURE USE CONDUITS.
22. TYPE "F" LOOPS SHALL BE 40' LONG BY 6' WIDE QUADRAPOLE, CENTERED IN THE LANE AND EXTEND 5' IN FRONT OF THE STOP BAR UNLESS OTHERWISE SHOWN ON PLAN SHEET.
23. THE CONTRACTOR SHALL MAKE ALL LOOP ASSEMBLIES AND LOOP DETECTORS INSTALLED AS PART OF THE PROJECT FULLY OPERATIONAL IN ACCORDANCE WITH THEIR ASSOCIATED ISOLATED INTERSECTION SIGNAL TIMING CHART. ALL LOOP ASSEMBLIES SHALL BE SEALED WITH AN FDOT APPROVED LOOP SEALANT. ALL SAW CUTS SHALL BE SEALED IMMEDIATELY AFTER THE LOOP WIRES AND LEAD-IN WIRES HAVE BEEN PLACED IN THE SAW CUTS. LOOPS SHALL NOT BE INSTALLED IN SERIES.
24. NO LOOP HOME RUNS SHALL BE CUT IN THE RADIUS.
25. ALL SPLICES OF LOOP WIRE TO LEAD-IN CABLE SHALL BE LOCATED IN PULL BOXES AND SOLDERED AND TAPED WITH A WATERPROOF COATING APPLIED IN A MANNER APPROVED BY THE ENGINEER.

26. ALL TRAFFIC SIGNAL LOOP ASSEMBLY WIRES AND SHIELDED LEAD-IN CABLES SHALL BE ROUTED TO THE TRAFFIC SIGNAL CONTROLLER CABINET IN ONE CONTINUOUS RUN. THERE SHALL BE NO SPLICING ALLOWED EXCEPT IN INSTANCES WHERE LOOP WIRE IS SPLICED TO SHIELDED LEAD-IN CABLE. ALL SHIELDED LOOP LEAD-IN WIRES MUST BE GROUNDED TO THE CONTROLLER CABINET GROUND.
27. THE CONTRACTOR SHALL BE RESPONSIBLE FOR ALL UTILITY LOCATION COORDINATION EFFORTS AS REQUIRED BY FLORIDA STATUTE REGARDING PROTECTION OF EXISTING UTILITIES. THE CONTRACTOR IS REMINDED THAT NOT ALL UTILITY PROVIDERS ARE SUBSCRIBERS TO THE SUNSHINE STATE ONE-CALL SYSTEM, AND IT SHALL BE INCUMBENT UPON THE CONTRACTOR TO MAKE EVERY EFFORT TO INSURE THAT ALL UTILITIES ARE LOCATED PRIOR TO CONSTRUCTION.

COMPANIES	PHONE NUMBERS
BELL SOUTH - AT&T FL BROADBAND	(407) 539-0644 (512) 742-6676
CITY OF CLERMONT	(352) 394-7178
PROGRESS ENERGY OF FLORIDA	(407) 938-6638
LAKE APOPKA NATURAL GAS	(407) 656-2734
MCI	(972) 729-6016
EMBARQ	(407) 814-5344
BRIGHT HOUSE NETWORKS	(366) 445-8804 EXT: 1308

28. THE CONTRACTOR SHALL NOTIFY THE APPROPRIATE UTILITY DEPARTMENT AT LEAST 2 FULL BUSINESS DAYS IN ADVANCE OF POLE SETTING OPERATIONS WHERE A CONFLICT WITH OVERHEAD ELECTRICAL CONDUCTORS IS EXPECTED AND WHEN JOINT USE POLES ARE TO BE USED.
29. THE CONTRACTOR SHALL ADHERE TO ALL LOCAL MAINTAINING AGENCY AND STATE REGULATIONS DURING ALL CONSTRUCTION OPERATIONS.
30. THE CONTRACTOR SHALL NOTIFY LAKE COUNTY TRAFFIC OPERATIONS AT LEAST 2 FULL BUSINESS DAYS PRIOR TO BEGINNING CONSTRUCTION AND LOOP CUTTING, NOTIFY DENIS DEITZ OR STEVE BOLLINGER 352-742-1766. THE CONTRACTOR SHALL NOTIFY LAKE COUNTY TRAFFIC OPERATIONS AT LEAST 24 HOURS IN ADVANCE OF INSTALLING SIGNAL POLES, GROUND RODS, UNDERGROUND CONDUIT, AND SEALING SIGNAL HEAD ASSEMBLIES SO THAT THESE OPERATIONS CAN BE OBSERVED.
31. THE CONTRACTOR IS RESPONSIBLE FOR NOTIFYING THE POWER COMPANY AND MAINTAINING AGENCY OF THEIR PROPOSED DATE ON WHICH THE NEW ELECTRICAL SERVICE FOR THIS SIGNAL WILL BE COMPLETE IN ORDER THAT ARRANGEMENTS CAN BE MADE FOR ESTABLISHING AN ACCOUNT FOR THE LOCAL MAINTAINING AGENCY AND HOOK-UP DATE WITH THE LOCAL POWER COMPANY.
32. ALL SIGNAL HEADS SHALL USE FDOT APPROVED LED'S FOR ALL INDICATIONS, UNLESS OTHERWISE NOTED. PEDESTRIAN ASSEMBLIES SHALL BE FDOT APPROVED COUNT DOWN FULL HAND/PERSON LED.
33. THE CONTRACTOR SHALL HAND DIG THE FIRST 4' AT THE STRAIN POLE FOUNDATION LOCATIONS TO INSURE THERE ARE NO UTILITY CONFLICTS.
34. THE CONTRACTOR IS RESPONSIBLE FOR ALL STATE AND LOCAL PERMITS. THE CONTRACTOR SHALL BE RESPONSIBLE FOR ACQUIRING THE ELECTRIC PERMIT AND TO COORDINATE APPLICATION FOR POWER WITH LAKE COUNTY TRAFFIC OPERATIONS, KATHY WILSON, 352-742-1766.
35. ALL MAINTENANCE OF TRAFFIC SHALL CONFORM TO STANDARD INDEX 600 SERIES AND SHALL BE PAID FOR UNDER MOBILIZATION (M1-1). THE COST FOR THE USE OF OFF-DUTY LAW ENFORCEMENT OFFICERS TO DIRECT TRAFFIC IN CASE OF LANE CLOSURES SHALL BE INCIDENTAL TO THE WORK AND WILL NOT BE PAID SEPARATELY.
36. ALL MATERIALS AND HARDWARE SHALL BE FDOT APPROVED AND PRE-APPROVED BY LAKE COUNTY TRAFFIC ENGINEERING.
37. ALL REMOVED EQUIPMENT SHALL BE DELIVERED TO LAKE COUNTY TRAFFIC OPERATIONS, 28127 C.R. 561, TAVARES, 352-742-1766, EXCEPT SIGNAL POLES, WHICH SHALL BE DISPOSED OF BY THE CONTRACTOR.
38. SIGNAL HEADS SHALL BE WIRED DIRECTLY TO THE TERMINAL BLOCKS. THE USE OF "JONES" PLUGS SHALL BE PROHIBITED.
39. SIGNAL CABLE SHALL BE ATTACHED TO MESSENGER WIRE USING PROPER SIZE SPIRAL WRAP.
40. NO POWER SERVICE INSTALLATION WILL BE ALLOWED ON THE CABINET.
41. THE CONTROLLER ASSEMBLY SHALL BE LAKE COUNTY NAZTEC REGIONAL TS2-1 WITH A TS2-1 CONTROLLER ETHERNET ENABLED REQUIRED FOR COUNTY'S CLOSED LOOP SYSTEM WHICH SHOULD INCLUDE A GENERATOR SWITCH BOX PANEL.
42. THE CONTRACTOR SHALL BE RESPONSIBLE FOR ESTABLISHING THE PROPER AMOUNT OF RAKE WITH RESPECT TO LOADING TO BE USED ON POLES AT THE TIME OF INSTALLATION.
43. THE CONTRACTOR SHALL FURNISH LAKE COUNTY TRAFFIC OPERATIONS WITH EMERGENCY CONTACTS AND TELEPHONE NUMBERS AND HAVE AN IMSA LEVEL II CERTIFIED SIGNAL TECHNICIAN ON CALL WITHIN A TWO-HOUR MAXIMUM RESPONSE.
44. ANY STRIPING/PAVEMENT MARKINGS DESTROYED BY CONTRACTOR DURING CONSTRUCTION SHALL BE REPLACED AT THE CONTRACTOR'S EXPENSE.

M. W. HUSTAD
12-3-07

N:\22323.08\JGN 2007\GNNTSG02.dgn 12/3/2007 2:57:13 PM sghosh

REVISIONS						 <small>HNTB CORPORATION 300 PRIMA BLVD, SUITE 200 LAKE HAVY, FL 32746 (407) 805-0355 CERT. OF AUTH. NO. 6500</small>	LAKE COUNTY TRAFFIC ENGINEERING DEPARTMENT			SHEET NO. T-4
DATE	BY	DESCRIPTION	DATE	BY	DESCRIPTION		ROAD NO.	COUNTY	PROJECT NO.	
						ENGINEER OF RECORD: MARC W. HUSTAD, P.E. FL. REGISTRATION NO. 66761	HOOKS ST AT CITRUS TOWER BLVD	LAKE	22323.08, 43817.00	

GENERAL NOTES

12/3/2007

SIGNAL HEAD DETAILS

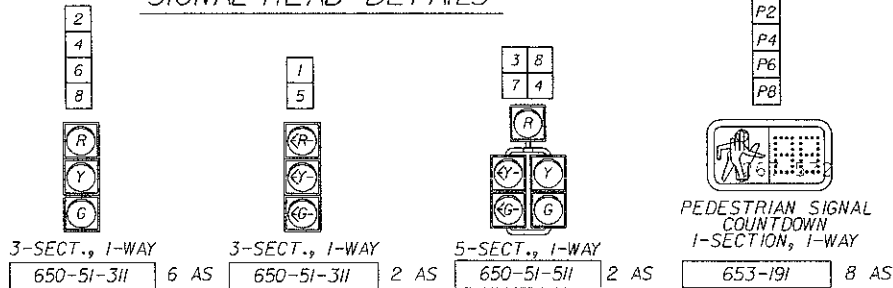

SIGNAL OPERATING PLAN

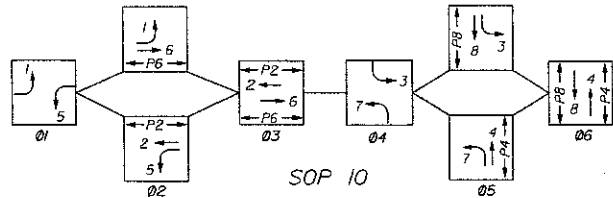

PEDESTRIAN SIGN DETAILS

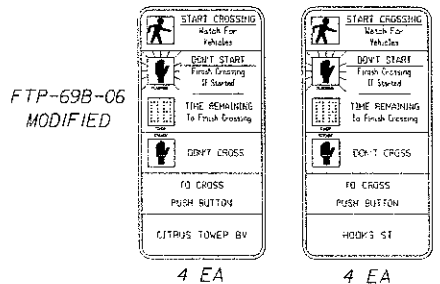

STREET NAME SIGN DETAILS

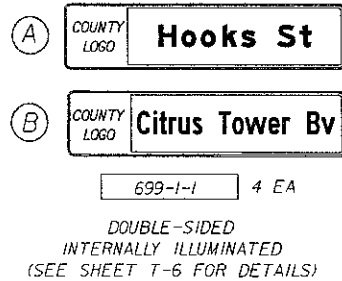

SUGGESTED CONTROLLER TIMINGS								
TIMING FUNCTIONS	1	2	3	4	5	6	7	8
MOVEMENT NUMBER	1	2	3	4	5	6	7	8
INITIAL	5	15	5	6	5	15	5	6
EXTENSION	3.5	3.5	-	3.5	3.5	3.5	-	3.5
MAXIMUM GREEN I	20	45	-	30	20	45	-	30
MAXIMUM GREEN II	-	-	-	-	-	-	-	-
YELLOW CLEARANCE	4.0	4.0	4.0	4.0	4.0	4.0	4.0	4.0
RED CLEARANCE	1.0	1.0	1.0	1.0	1.0	1.0	1.0	1.0
PED. WALK	-	7	-	7	-	7	-	7
FCW	-	28	-	28	-	28	-	28
MIN. RECALL	-	MIN	-	MIN	-	MIN	-	MIN
DETECTOR FUNCTION	NL	LOCK	-	NL	NL	LOCK	-	-

DETECTORS FOR LOOPS				
LOOP	NO. OF LOOPS	NO. OF NEW DETS.	CHANNEL NO.	DELAY TIME (SEC)
L-1	1	1	1	5
L-5	1	1	2	5
L-3	1	1	1	5
L-7	1	1	2	5
L-4R	1	1	1	5
L-8R	1	1	2	5
L-4	1	1	1	-
L-8	1	1	2	-
L-20	1	1	1	-
L-21	1	1	2	-
L-60	1	1	1	-
L-61	1	1	2	-

FLASH DO NOT WALK CALCULATED BASED ON 4 FEET PER SECOND WALKING SPEED.

DELAY TIME IS INITIAL AND MAY REQUIRE FIELD ADJUSTING AS DIRECTED BY PROJECT ENGINEER.

MATCHLINE - STA. 16+80 - SEE SHEET T-19

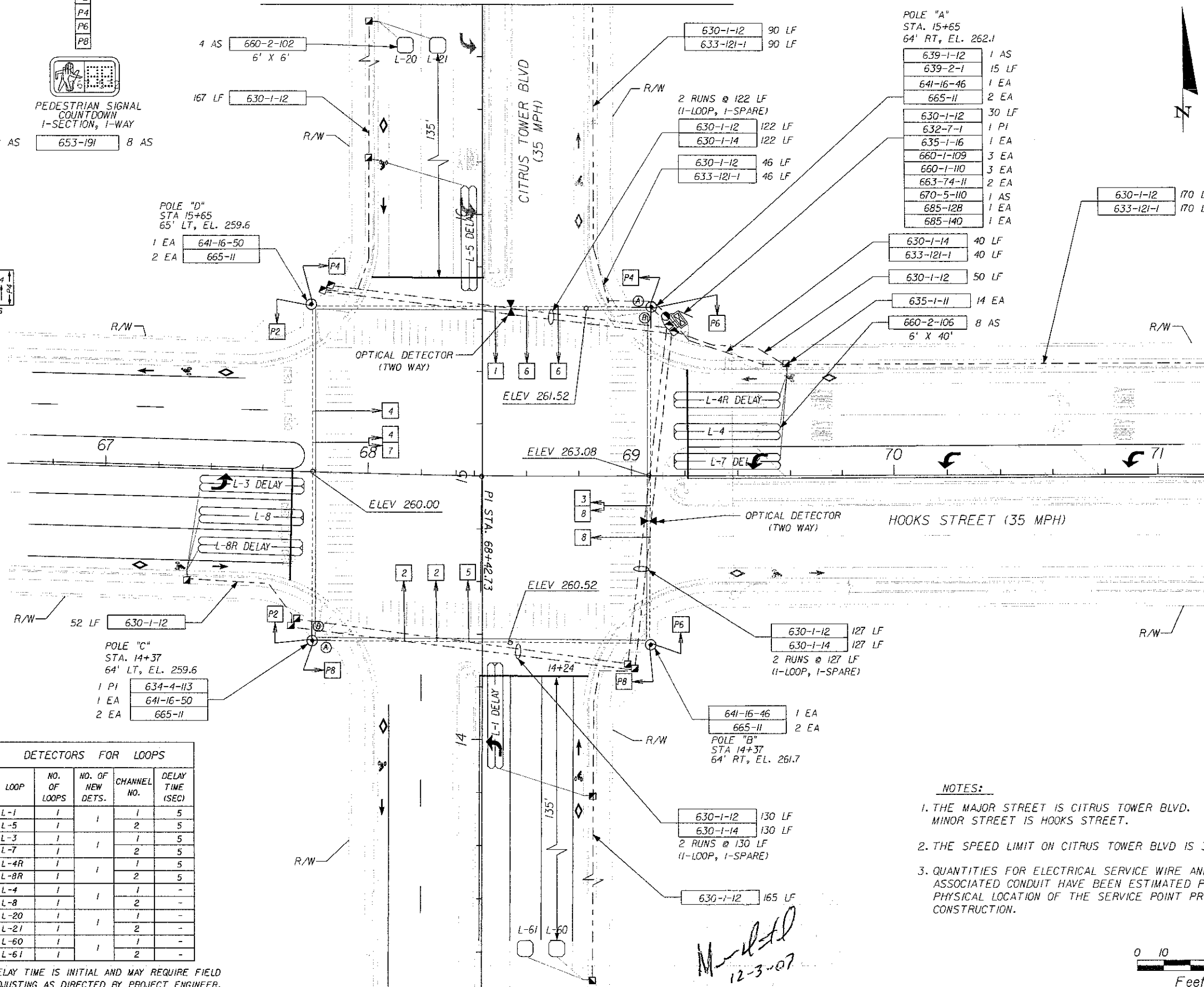

- POLE "A"
STA. 15+65
64' RT, EL. 262.1
- 639-1-12 1 AS
 - 639-2-1 15 LF
 - 641-16-46 1 EA
 - 665-11 2 EA
 - 630-1-12 30 LF
 - 632-7-1 1 PI
 - 635-1-16 1 EA
 - 660-1-109 3 EA
 - 660-1-110 3 EA
 - 663-74-11 2 EA
 - 670-5-110 1 AS
 - 685-12B 1 EA
 - 685-140 1 EA

- 630-1-14 40 LF
- 633-121-1 40 LF
- 630-1-12 50 LF
- 635-1-11 14 EA
- 660-2-106 8 AS
- 6' X 40'

- 630-1-12 170 LF
- 633-121-1 170 LF

- 630-1-12 127 LF
- 630-1-14 127 LF
- 2 RUNS @ 127 LF (1-LOOP, 1-SPARE)

- 641-16-46 1 EA
- 665-11 2 EA

- 630-1-12 130 LF
- 630-1-14 130 LF
- 2 RUNS @ 130 LF (1-LOOP, 1-SPARE)

- 630-1-12 165 LF

- NOTES:
- THE MAJOR STREET IS CITRUS TOWER BLVD. THE MINOR STREET IS HOOKS STREET.
 - THE SPEED LIMIT ON CITRUS TOWER BLVD IS 35 MPH.
 - QUANTITIES FOR ELECTRICAL SERVICE WIRE AND THE ASSOCIATED CONDUIT HAVE BEEN ESTIMATED PENDING PHYSICAL LOCATION OF THE SERVICE POINT PRIOR TO CONSTRUCTION.

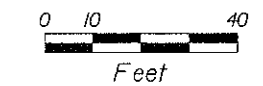

MATCHLINE - STA. 71+20 - SEE SHEET T-9

12/31/2007 4:59:55 PM sgtrsh N:\22323.08\JGN 2007\PLAN\SG01.dgn

REVISIONS					
DATE	BY	DESCRIPTION	DATE	BY	DESCRIPTION

HNTB
HNTB CORPORATION
300 PRIMA BLVD,
SUITE 200
LAKE MARY, FL 32746
(407) 805-0355
CERT. OF AUTH. NO. 6500
ENGINEER OF RECORD: MARC W. HUSTAD, P.E.
FL. REGISTRATION NO. 66761

LAKE COUNTY
TRAFFIC ENGINEERING DEPARTMENT

ROAD NO.	COUNTY	PROJECT NO.
HOOKS ST AT CITRUS TOWER BLVD	LAKE	22323.08, 43817.00

SIGNALIZATION PLAN

SHEET NO.
T-5

12/31/2007

12/3/2007 3:04:19 PM

sgtosh

N:\22323.08\JGN 2007\PLANS\PO1.dgn

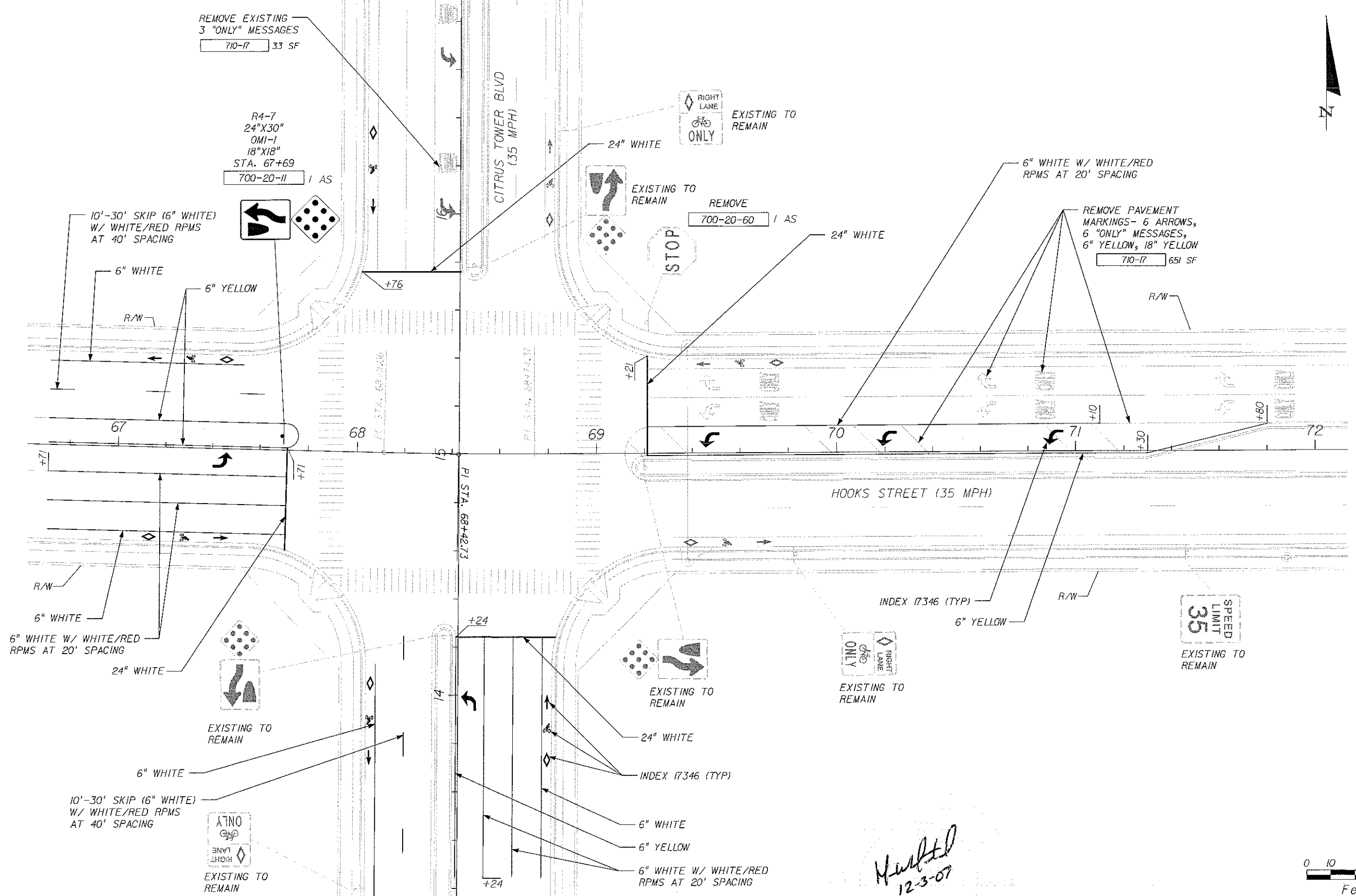

EXISTING TO REMAIN

Hustad
12-3-07

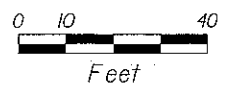

REVISIONS					
DATE	BY	DESCRIPTION	DATE	BY	DESCRIPTION

HNTB
 HNTB CORPORATION
 300 PRIMA BLVD,
 SUITE 200
 LAKE MARY, FL 32746
 (407) 805-0355
 CERT. OF AUTH. NO. 6500
 ENGINEER OF RECORD: MARC W. HUSTAD, P.E.
 FL. REGISTRATION NO. 66761

LAKE COUNTY TRAFFIC ENGINEERING DEPARTMENT		
ROAD NO.	COUNTY	PROJECT NO.
HOOKS ST AT CITRUS TOWER BLVD	LAKE	22323.08; 43817.00

SIGNING AND
PAVEMENT MARKING PLAN

SHEET NO.
T-6

12/3/2007

12/5/2007 3:01:21 PM

sgshosh

N:\22323.08\DGN 2007\polesched.dgn

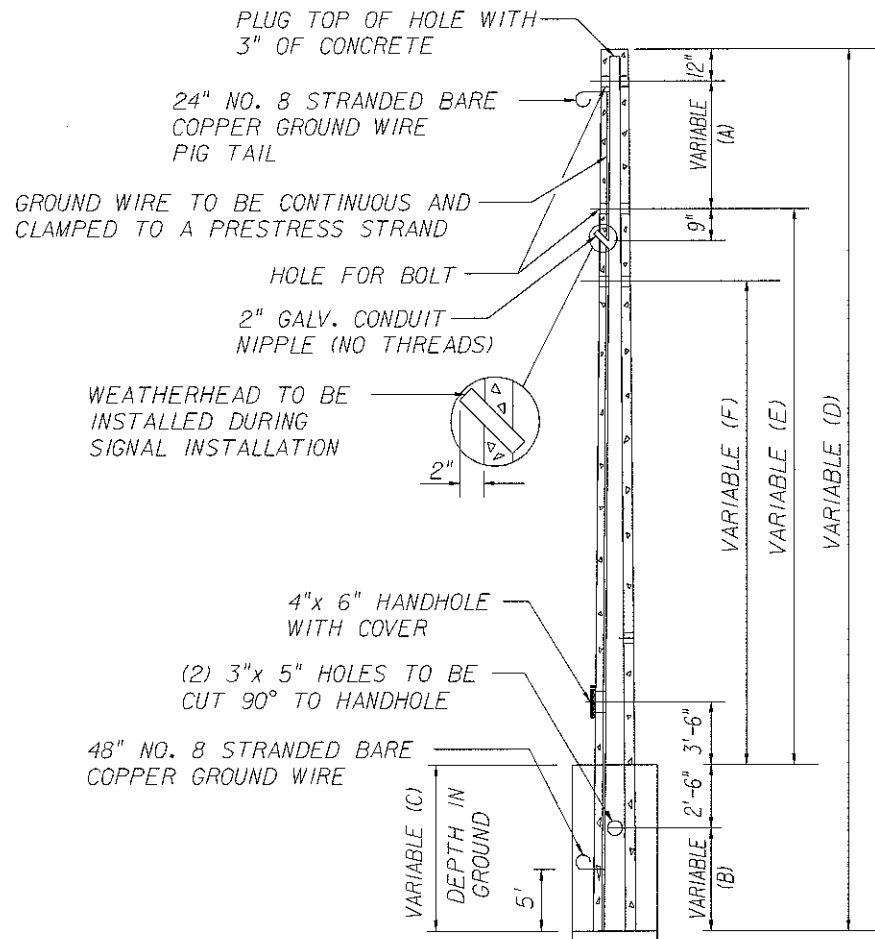

POLE SECTION

POLE SCHEDULE

POLE NO.	TYPE	A	B	C	D	E	F
A	VII	8'	9.5'	12.0'	46.0'	25.0'	23.5'
B	VII	8'	9.1'	11.6'	46.0'	25.4'	22.6'
C	VII	10.8'	11.0'	13.5'	50.0'	24.7'	N/A
D	VII	9.5'	11.0'	13.5'	50.0'	26.0'	24.7'

SPAN WIRE CABLE NOTES

CATENARY WIRE CABLE = 3/8"
 MESSENGER WIRE CABLE = 7/16"

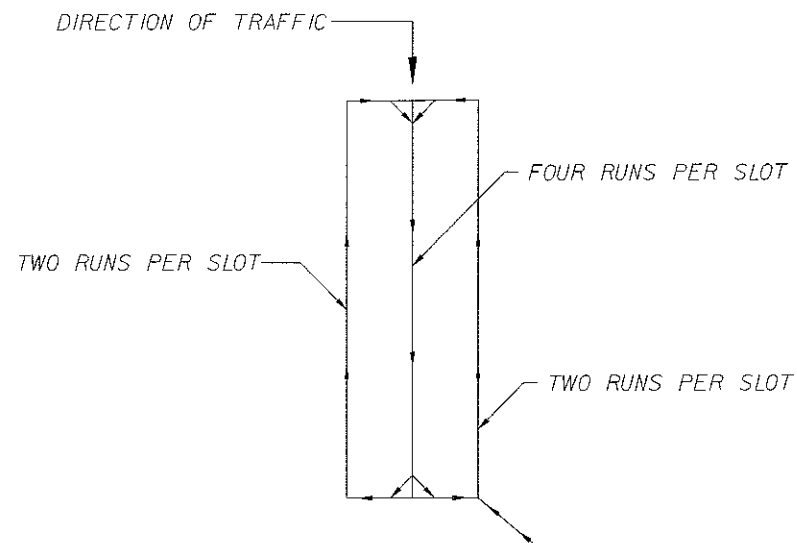

LOOP WINDING DETAIL
 (QUADRAPOLE PRESENCE LOOP)

NOTE: LOOP WIRE SHALL BE PLACED IN THE ABOVE MANNER TO AVOID CENTER SLOT CANCELLATION.

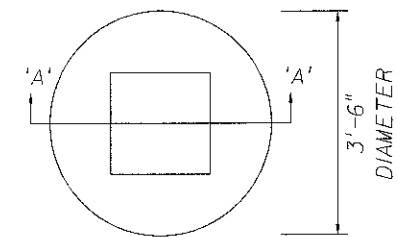

FOUNDATION PLAN

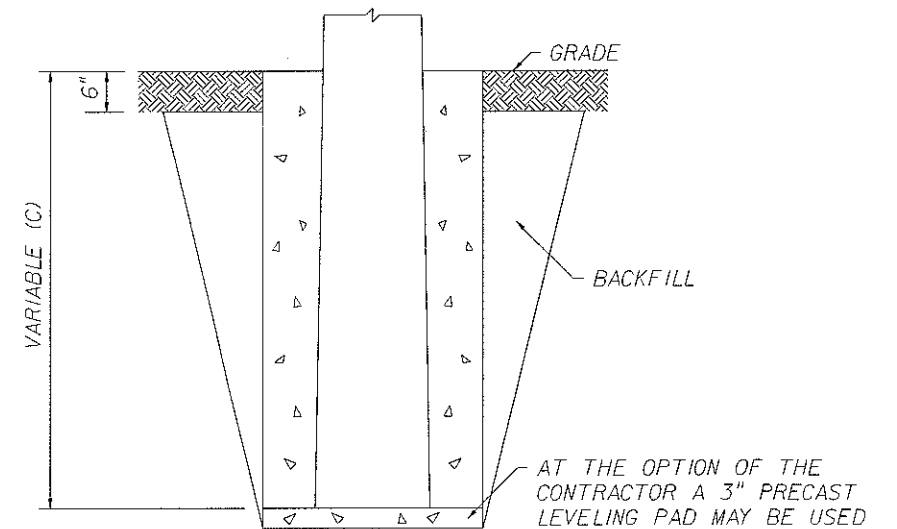

SECTION 'A' - 'A'

FOUNDATION NOTES

EXCAVATION & BACKFILL: EXCAVATION & BACKFILL FOR THE FOOTINGS SHALL BE IN ACCORDANCE WITH ARTICLES 125-4 AND 125-82 WITH THE EXCEPTION THE BACKFILL, IN LIEU OF THE REQUIREMENTS FOR OBTAINING THE SPECIFIED DENSITY, MAY BE HAND TAMPED IN FOUR INCH MAXIMUM LAYERS OR MACHINE TAMPED IN SIX INCH MAXIMUM LAYERS. THE MATERIAL SHOULD BE NEITHER DRY NOR SATURATED. AT THE CONTRACTOR'S OPTION BACKFILLING MAY BE DONE WITH Poured CONCRETE.

CONCRETE: FOOTING TO BE Poured WITH CLASS I CONCRETE. (SECTION 345)

FORMS: FORMS SHALL BE IN ACCORDANCE WITH ARTICLE 700-8-3. (IF THE FOOTING IS Poured IN AN OVERSIZED HOLE, THE CONCRETE IN THE TOP SIX INCHES SHALL BE PLACED IN A FORM. ALL EXPOSED SURFACES SHALL BE Troweled TO A SMOOTH FINISH.

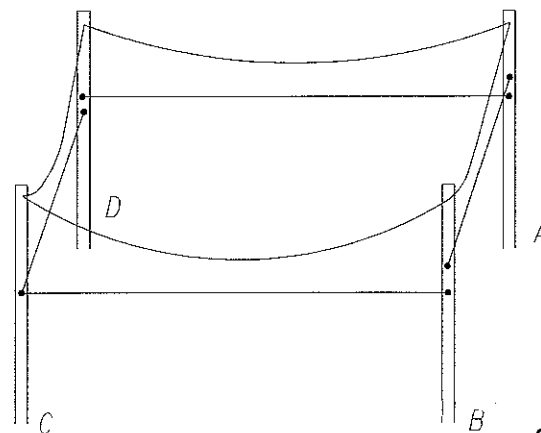

*M. W. HUSTAD
 12-3-07*

REVISIONS						HNTB			LAKE COUNTY TRAFFIC ENGINEERING DEPARTMENT			CONCRETE STRAIN POLE SCHEDULE		SHEET NO.
DATE	BY	DESCRIPTION	DATE	BY	DESCRIPTION	ENGINEER OF RECORD: MARC W. HUSTAD, P.E. FL. REGISTRATION NO. 66761			ROAD NO.	COUNTY	PROJECT NO.	CONCRETE STRAIN POLE SCHEDULE		T-7
						HNTB CORPORATION 300 PHINERA BLVD., SUITE 300 LAKE MARY, FL 32746 (407) 805-0355 CERT. OF AUTH. NO. 6500			HOOKS ST AT CITRUS TOWER BLVD	LAKE	22323.08, 43817.00			

12/5/2007

INTERNALLY ILLUMINATED SIGN NOTES

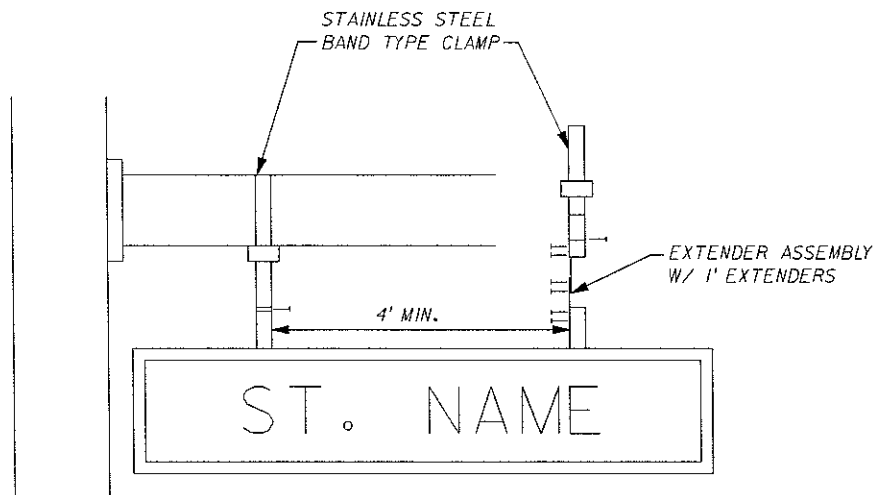

SIGN BRACKET ATTACHMENT DETAIL

TWO POINT CLAMP-ON CANTILEVER ARM
SIGN MOUNTING ASSEMBLY DETAIL

1. PHOTO CELL SHALL BE INSTALLED IN THE SIGNAL CABINET WITH A 2 INCH PLEXIGLAS WINDOW.
2. A "HANDS OFF PHOTO TEST SWITCH" SHALL BE INSTALLED.
3. INTERNALLY ILLUMINATED STREET NAME SIGN SHALL BE ILLUMINATED BY LED. THE INTERNALLY ILLUMINATED STREET NAME SIGN SHALL BE FROM THE FLORIDA DEPARTMENT OF TRANSPORTATION APPROVED PRODUCTS LIST.
4. THE INTERNALLY ILLUMINATED STREET NAME SIGN SHALL BE THE 22 INCH/24 INCH STYLE CONTAINER, 22 INCH VIEWABLE SIGN FACE HEIGHT, 24 INCH CONTAINER HEIGHT.
5. THE INTERNALLY ILLUMINATED STREET NAME SIGN SHALL BE INSTALLED ON A SEPARATE BREAKER.
6. THE SIGN BRACKET AND CLAMP-ON CANTILEVER ARM SHOULD BE INSTALLED BELOW THE MESSENGER CABLE, LEVEL WITH THE RED INDICATION.
10. A PHOTOCELL SHALL BE INSTALLED NEAR THE ELECTRIC SERVICE WITHIN REACH OF A LIFT TRUCK. CARE TO BE GIVEN TO INSTALL WHERE STREET LIGHTING DOES NOT AFFECT OPERATION.
11. INTERNALLY ILLUMINATED STREET NAME SIGN FACING SPECIFICATIONS: THE BACKING SHALL BE 1/8 INCH CLEAR LEXAN. THE SHEETING SHALL BE WHITE DIAMOND GRADE VIP SHEETING, 3-M SERIES 3990 OR COMPARABLE. THE FACING SHALL BE COVERED WITH GREEN ACRYLIC ELECTRIC CUTTABLE FILM, 3-M SERIES 1177C OR COMPARABLE.
12. A 21 INCH WIDE AREA ON THE LEFT SIDE OF THE SIGN FACING SHALL BE WHITE TO ACCOMMODATE THE LAKE COUNTY LOGO.
13. THE LAKE COUNTY LOGO SHALL BE SUPPLIED BY LAKE COUNTY AND INSTALLED BY THE CONTRACTOR INSTALLING THE SIGNS.
14. THE CONTRACTOR SHALL BE RESPONSIBLE FOR FIELD VERIFYING THE MESSAGE WITH LOCAL MAINTAINING AGENCY BEFORE FABRICATION THE SIGNS. SHOP DRAWINGS SHALL BE REQUIRED.

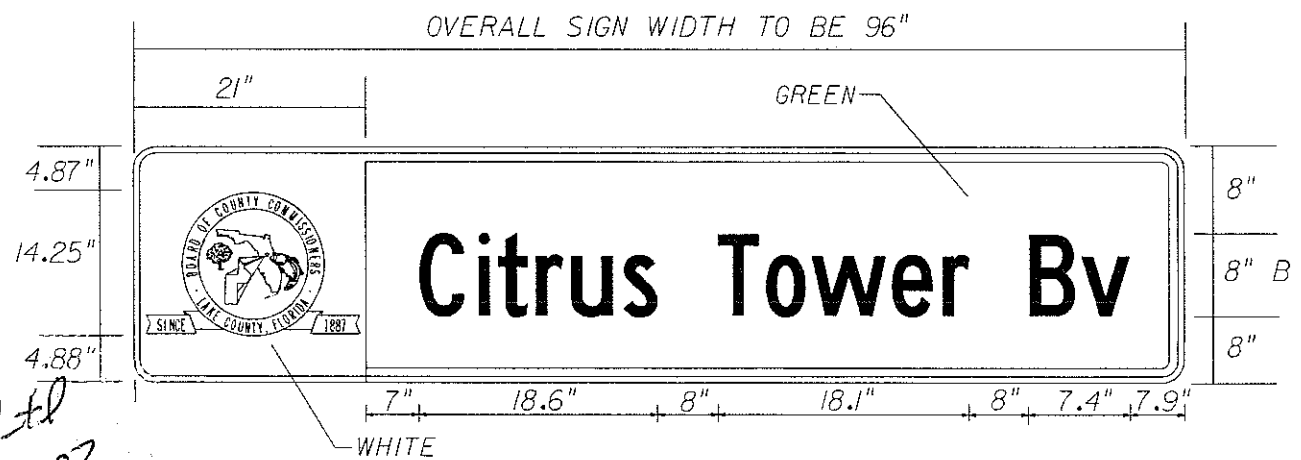
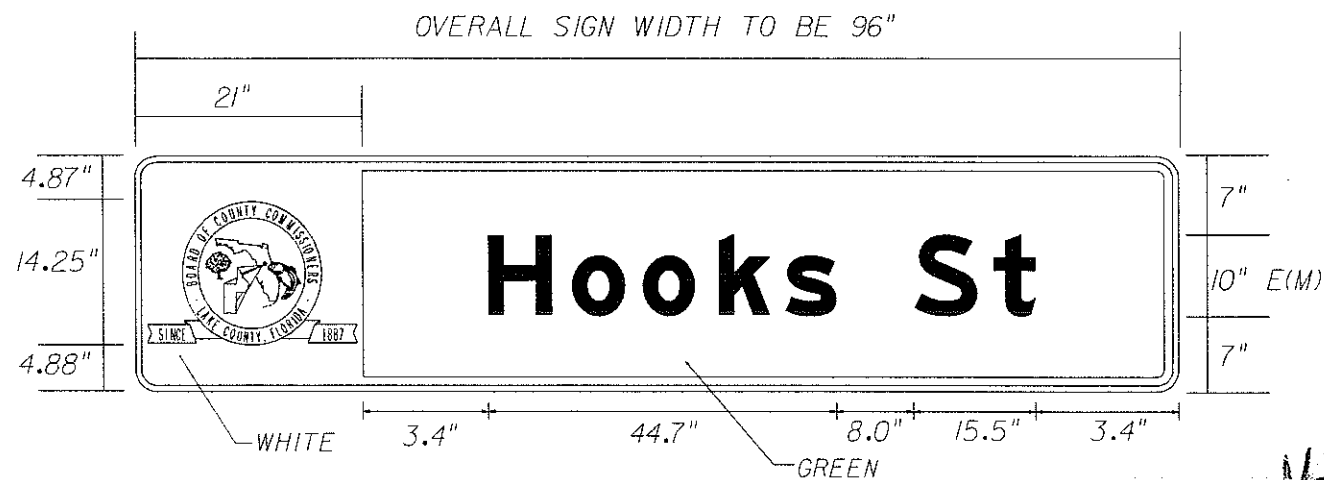

REVISIONS						HNTB HNTB CORPORATION 300 PRIMERIA BLVD. SUITE 100 LAKE MARY, FL 32746 (407) 805-0355 CERT. OF AUTH. NO. 6500 ENGINEER OF RECORD: MARC V. HUSTAD, P.E. FL. REGISTRATION NO. 96761	LAKE COUNTY TRAFFIC ENGINEERING DEPARTMENT			INTERNALLY ILLUMINATED STREET NAME SIGN DETAIL	SHEET NO. T-8
DATE	BY	DESCRIPTION	DATE	BY	DESCRIPTION		ROAD NO.	COUNTY	PROJECT NO.		
							HOOKS ST AT CITRUS TOWER BLVD	LAKE	22323.08, 43817.00		

N:\22323.08\DCN 2007\Internally illuminated Streetsigns.dgn 12/3/2007 4:55:51 PM

12/3/2007

12/3/2007 2:58:06 PM

sgtosh

N:\22323.08\DCN 2007\PLANS\002.dgn

MATCHLINE - STA. 71+20 - SEE SHEET T-5

MATCHLINE - STA. 77+00 - SEE SHEET T-10

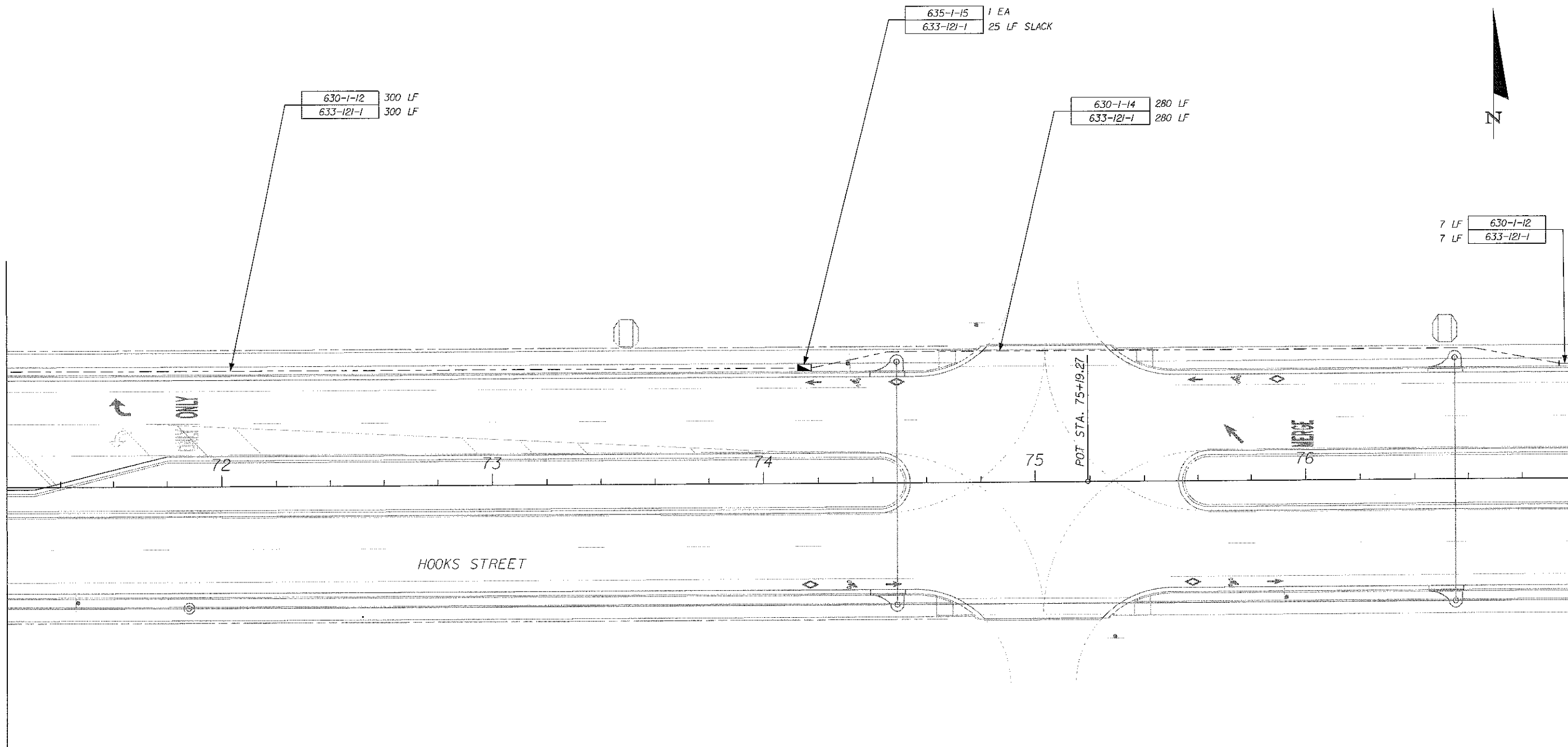

7 LF 630-1-12
7 LF 633-121-1

630-1-12 300 LF
633-121-1 300 LF

635-1-15 1 EA
633-121-1 25 LF SLACK

630-1-14 280 LF
633-121-1 280 LF

HOOKS STREET

72

73

74

75

76

POT STA. 75+19.27

ONLY

HERE

*Marked
12-3-07*

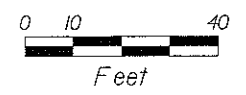

REVISIONS					
DATE	BY	DESCRIPTION	DATE	BY	DESCRIPTION

HNTB
 HNTB CORPORATION
 300 PRIMEKA BLVD,
 SUITE 200
 LAKE HAVY, FL 32746
 (407) 805-0355
 CERT. OF AUTH. NO. 0500

ENGINEER OF RECORD: MARC W. HUSTAD, P.E.
 FL. REGISTRATION NO. 66761

LAKE COUNTY TRAFFIC ENGINEERING DEPARTMENT		
ROAD NO.	COUNTY	PROJECT NO.
HOOKS ST AT CITRUS TOWER BLVD	LAKE	22323.08, 43817.00

INTERCONNECT PLAN

SHEET NO.
T-9

12/3/2007

12/3/2007 2:58:19 PM

sgphosh

N:\22323.08\DCN 2007\PLANS003.dgn

MATCHLINE - STA. 77+00 - SEE SHEET T-9

MATCHLINE - STA. 82+60 - SEE SHEET T-11

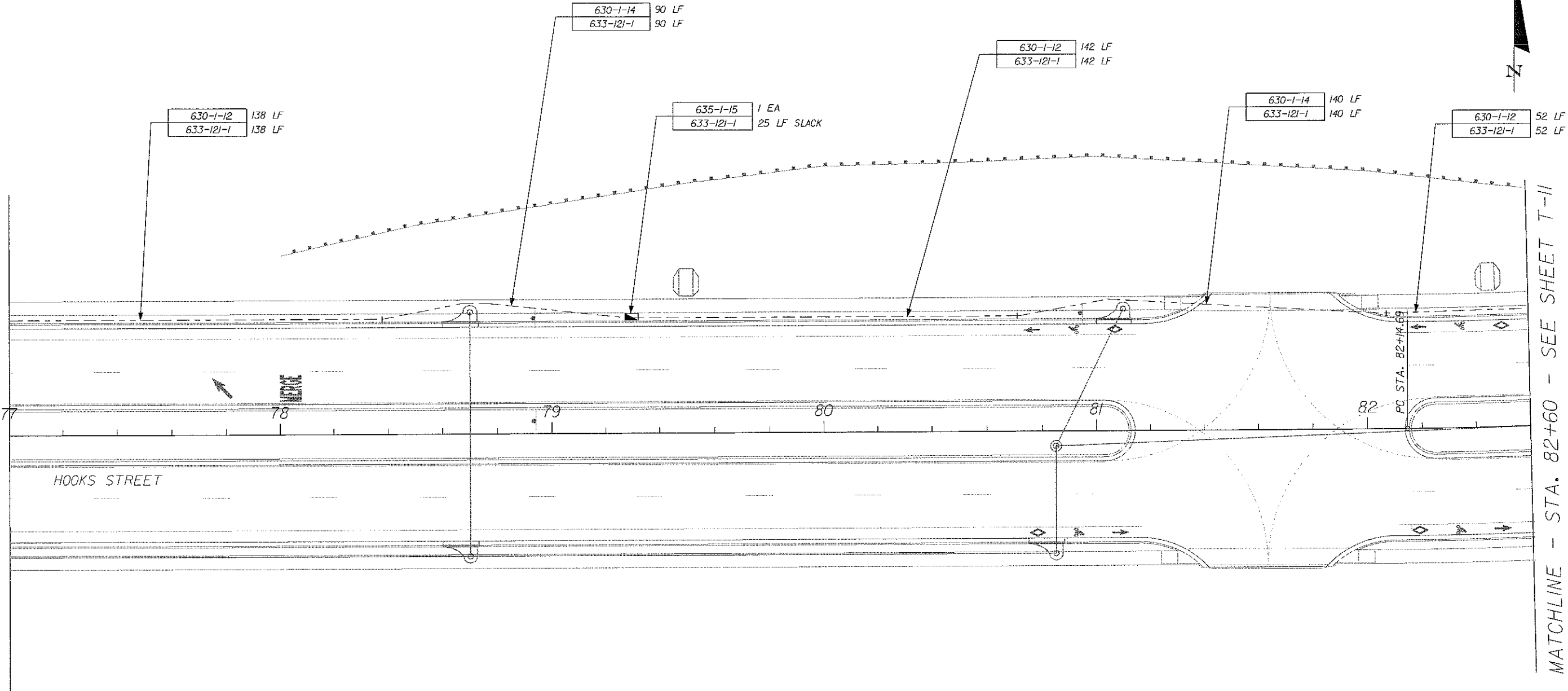

HOOKS STREET

78

79

80

81

82

P.C. STA. 82+14.69

M. Willard
12-3-07



REVISIONS					
DATE	BY	DESCRIPTION	DATE	BY	DESCRIPTION

HNTB
 HNTB CORPORATION
 300 PRIMAVERA BLVD.
 SUITE 200
 LAKE MARY, FL 32746
 (407) 865-0355
 CERT. OF AUTH. NO. 5500
 ENGINEER OF RECORD: MARC W. HUSTAD, P.E.
 FL. REGISTRATION NO. 66761

LAKE COUNTY TRAFFIC ENGINEERING DEPARTMENT		
ROAD NO.	COUNTY	PROJECT NO.
HOOKS ST AT CITRUS TOWER BLVD	LAKE	22323.08, 43817.00

INTERCONNECT PLAN

SHEET NO.
T-10

12/3/2007

12/3/2007 2:58:33 PM

sgfosh

N:\22323.08\DGN 2007\PLANS004.dgn

MATCHLINE - STA. 82+60 - SEE SHEET T-10

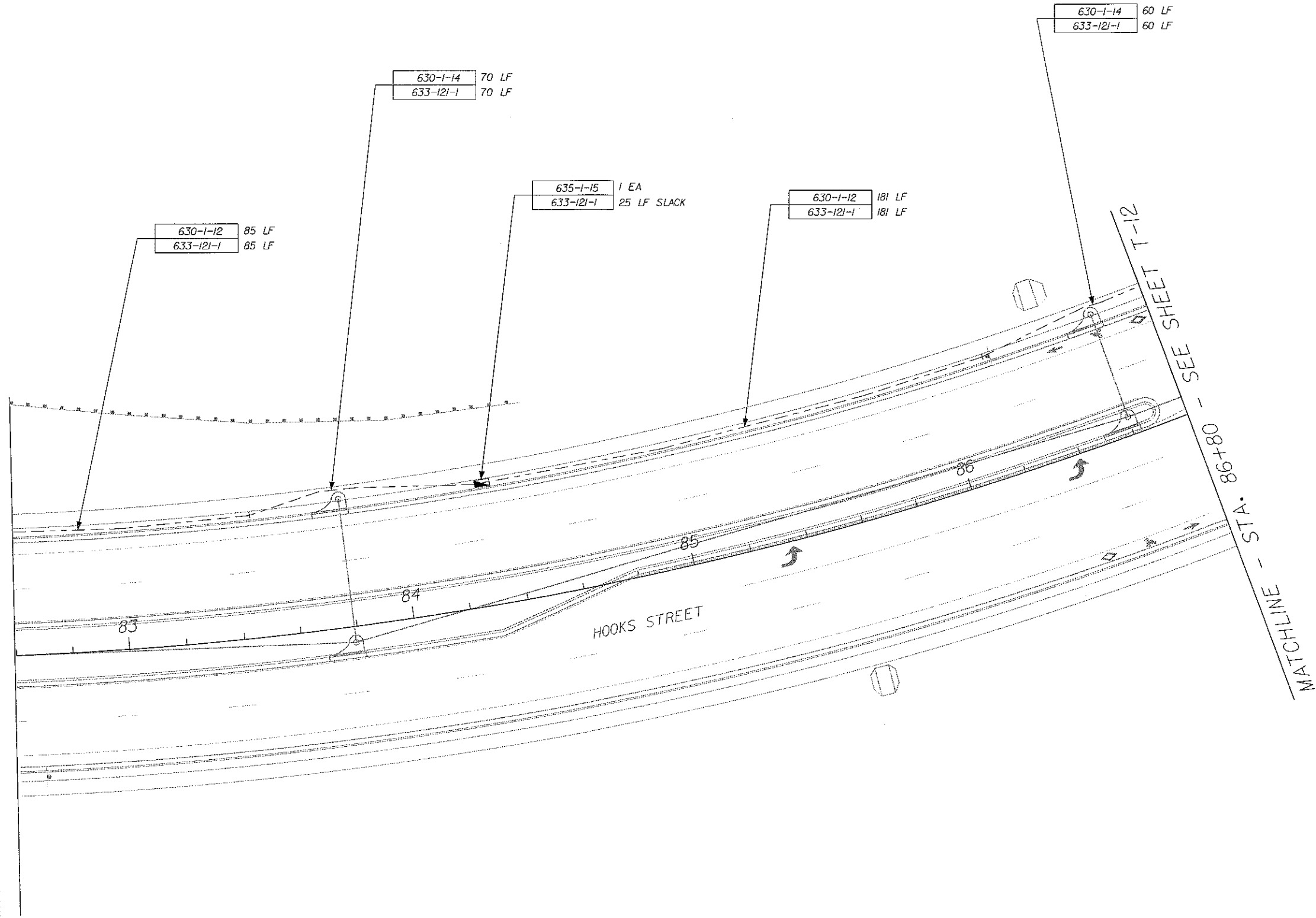

MATCHLINE - STA. 86+80 - SEE SHEET T-12

Marc W. Hustad
12-3-07

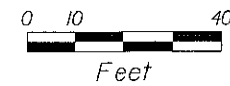

REVISIONS					
DATE	BY	DESCRIPTION	DATE	BY	DESCRIPTION

HNTB
 HNTB CORPORATION
 300 PRINCIPA BLVD,
 SUITE 200
 LAKE MARY, FL 32746
 (407) 805-0355
 CERT. OF AUTH. NO. 6500

ENGINEER OF RECORD: MARC W. HUSTAD, P.E.
 FL. REGISTRATION NO. 66761

LAKE COUNTY TRAFFIC ENGINEERING DEPARTMENT		
ROAD NO.	COUNTY	PROJECT NO.
HOOKS ST AT CITRUS TOWER BLVD	LAKE	22323.08, 43817.00

INTERCONNECT PLAN

SHEET NO.
T-11

12/3/2007

12/31/2007 2:58:45 PM

sghost

N:\22323.08\DWG 2007\PLANS\605.dgn

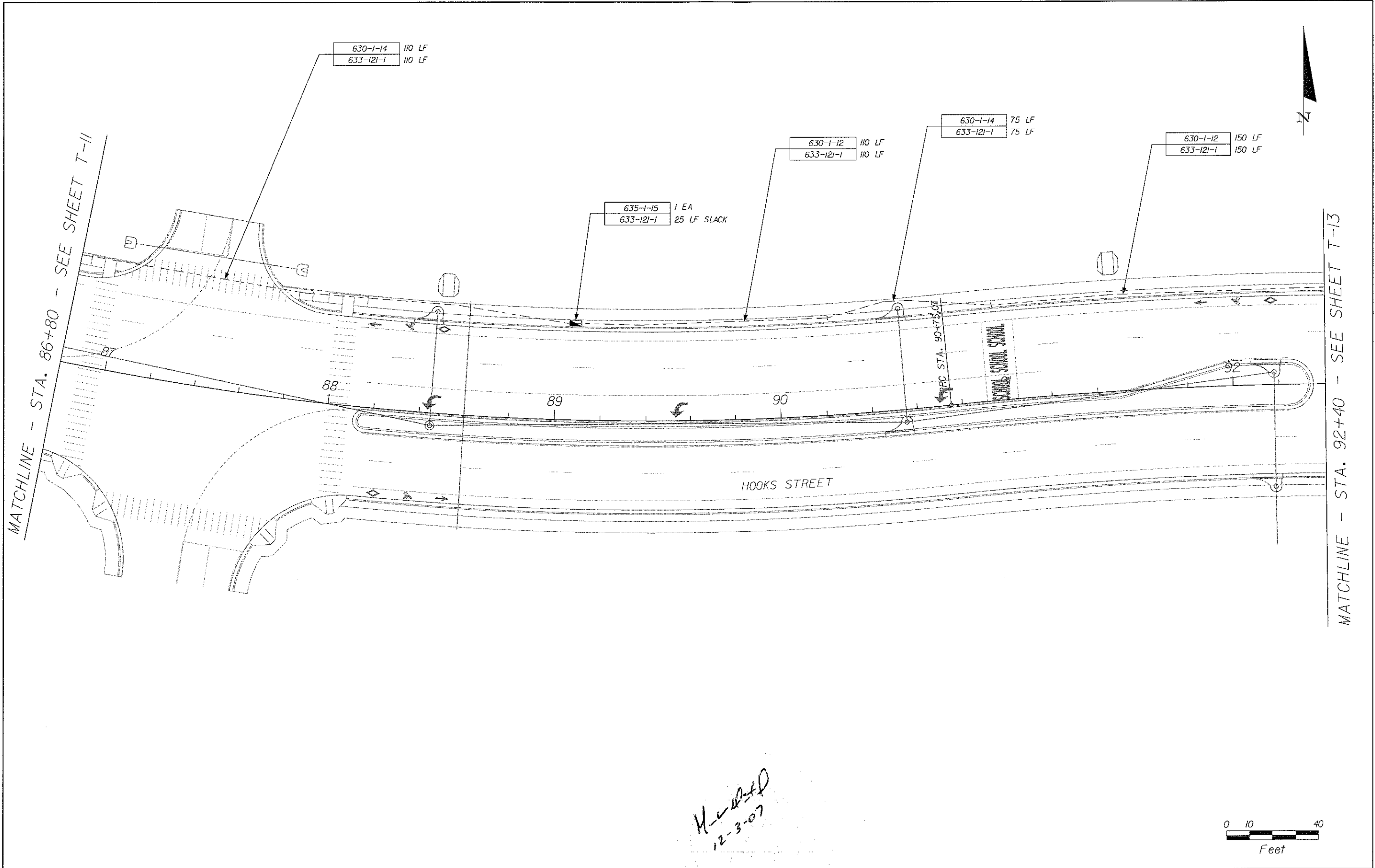

Handwritten: H. W. HUSTAD
12-3-07

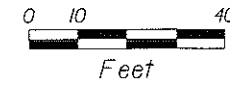

REVISIONS					
DATE	BY	DESCRIPTION	DATE	BY	DESCRIPTION



HNTB CORPORATION
 300 PRINCEA BLVD,
 SUITE 200
 LAKE MARY, FL 32746
 (407) 805-0355
 CERT. OF AUTH. NO. 6500

ENGINEER OF RECORD: MARC W. HUSTAD, P.E.
 FL. REGISTRATION NO. 66761

LAKE COUNTY TRAFFIC ENGINEERING DEPARTMENT		
ROAD NO.	COUNTY	PROJECT NO.
HOOKS ST AT CITRUS TOWER BLVD	LAKE	22323.08, 43817.00

INTERCONNECT PLAN

SHEET NO.

T-12

12/31/2007

12/3/2007 2:59:06 PM

sghosh

N:\22323.08\CGM 2007\PLANS\606.dgn

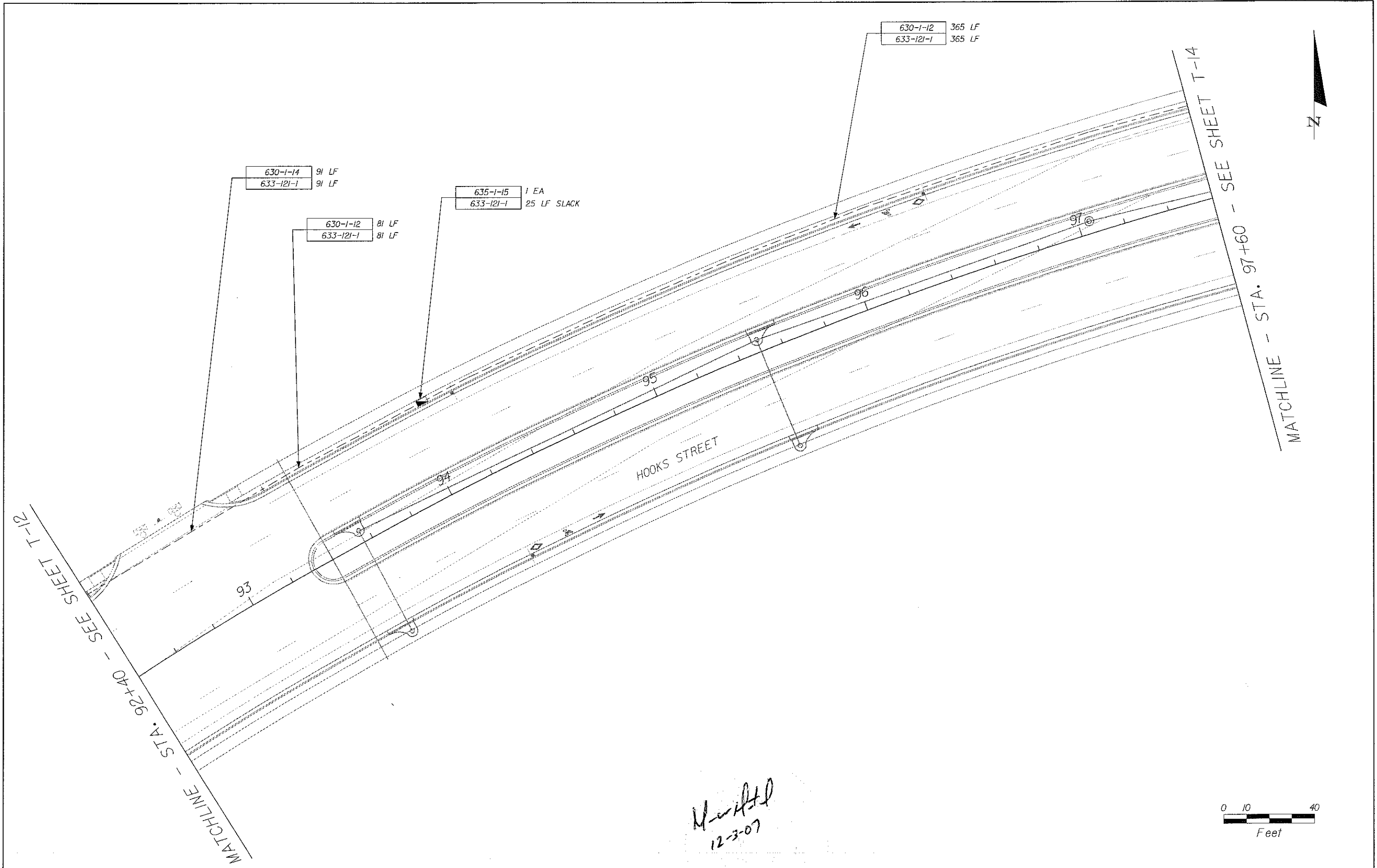

REVISIONS					
DATE	BY	DESCRIPTION	DATE	BY	DESCRIPTION

HNTB
 HNTB CORPORATION
 300 PRIMAVERA BLVD.
 SUITE 200
 LAKE MARY, FL 32746
 (407) 805-0355
 CERT. OF AUTH. NO. 0507

ENGINEER OF RECORD: MARC W. HUSTAD, P.E.
 FL. REGISTRATION NO. 66761

LAKE COUNTY TRAFFIC ENGINEERING DEPARTMENT		
ROAD NO.	COUNTY	PROJECT NO.
HOOKS ST AT CITRUS TOWER BLVD	LAKE	22323.08, 4387.00

INTERCONNECT PLAN

SHEET NO.
T-13

12/3/2007

12/3/2007 2:59:18 PM

sghosh

N:\22323.08 DGN 2007\PLANS\G07.dgn



MATCHLINE - STA. 97+60 - SEE SHEET T-13

MATCHLINE - STA. 103+00 - SEE SHEET T-15

630-1-12 160 LF
633-121-1 160 LF

635-1-15 1 EA
633-121-1 25 LF SLACK

630-1-12 350 LF
633-121-1 350 LF

50 LF 630-1-14
50 LF 633-121-1

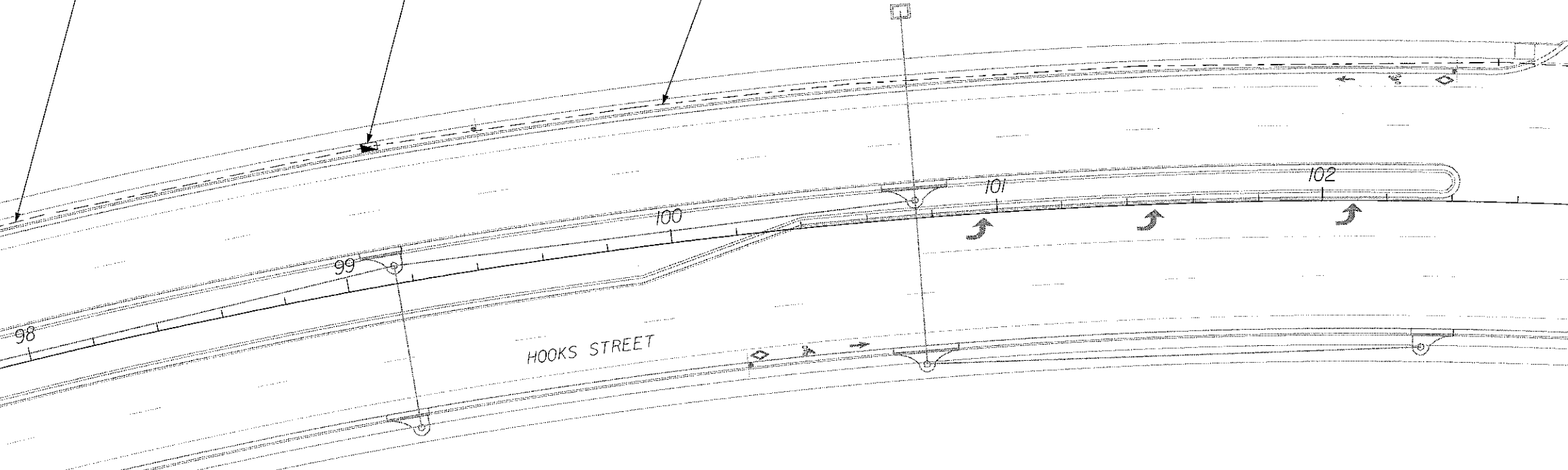

HOOKS STREET

M-W-H-LD
12-3-07

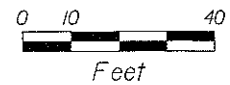

REVISIONS					
DATE	BY	DESCRIPTION	DATE	BY	DESCRIPTION



HNTB CORPORATION
300 PRINCEA BLVD,
SUITE 200
LAKE MARY, FL 32746
(407) 805-0355
CERT. OF AUTH. NO. 6500

ENGINEER OF RECORD: MARC W. HUSTAD, P.E.
FL. REGISTRATION NO. 66761

LAKE COUNTY TRAFFIC ENGINEERING DEPARTMENT		
ROAD NO.	COUNTY	PROJECT NO.
HOOKS ST AT CITRUS TOWER BLVD	LAKE	22323.08, 43817.00

INTERCONNECT PLAN

SHEET NO.
T-14

12/3/2007

N:\22323.08\DWG 2007\PLANS\08.dgn 12/3/2007 2:59:31 PM sghash

MATCHLINE - STA. 103+00 - SEE SHEET T-14

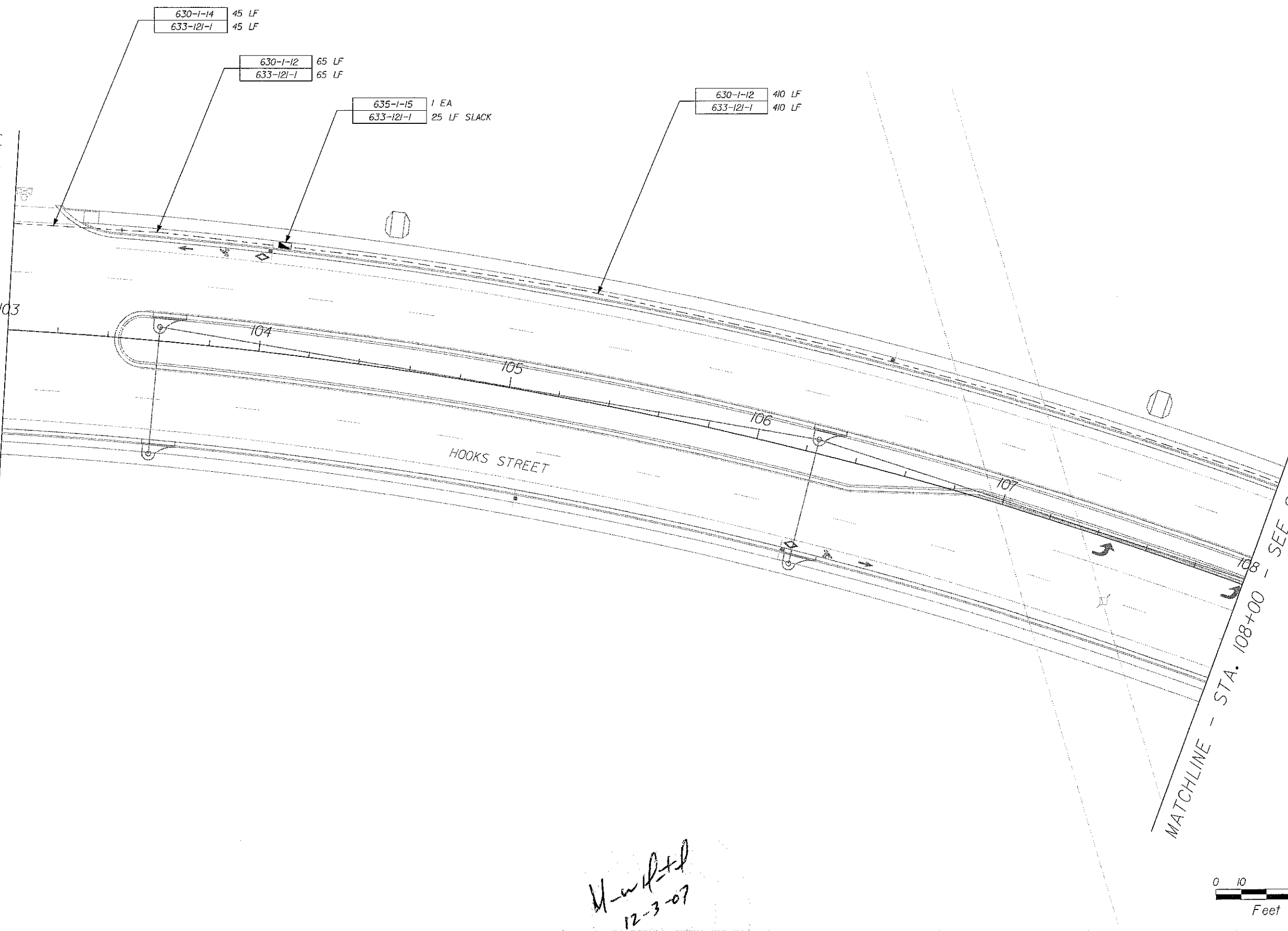

MATCHLINE - STA. 108+00 - SEE SHEET T-16

M. W. Hustad
12-3-07

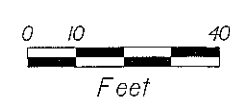

REVISIONS					
DATE	BY	DESCRIPTION	DATE	BY	DESCRIPTION

HNTB

HNTB CORPORATION
300 PRINERA BLVD,
SUITE 200
LAKE MARY, FL 32746
(407) 805-0355
CERT. OF AUTH. NO. 6500

LAKE COUNTY TRAFFIC ENGINEERING DEPARTMENT		
ROAD NO.	COUNTY	PROJECT NO.
HOOKS ST AT CITRUS TOWER BLVD	LAKE	22323.08, 43817.00

INTERCONNECT PLAN

SHEET NO.
T-15

12/3/2007

N:\22323.08\DWG\2007\PLANS\G09.dgn 12/3/2007 2:59:44 PM sghosh

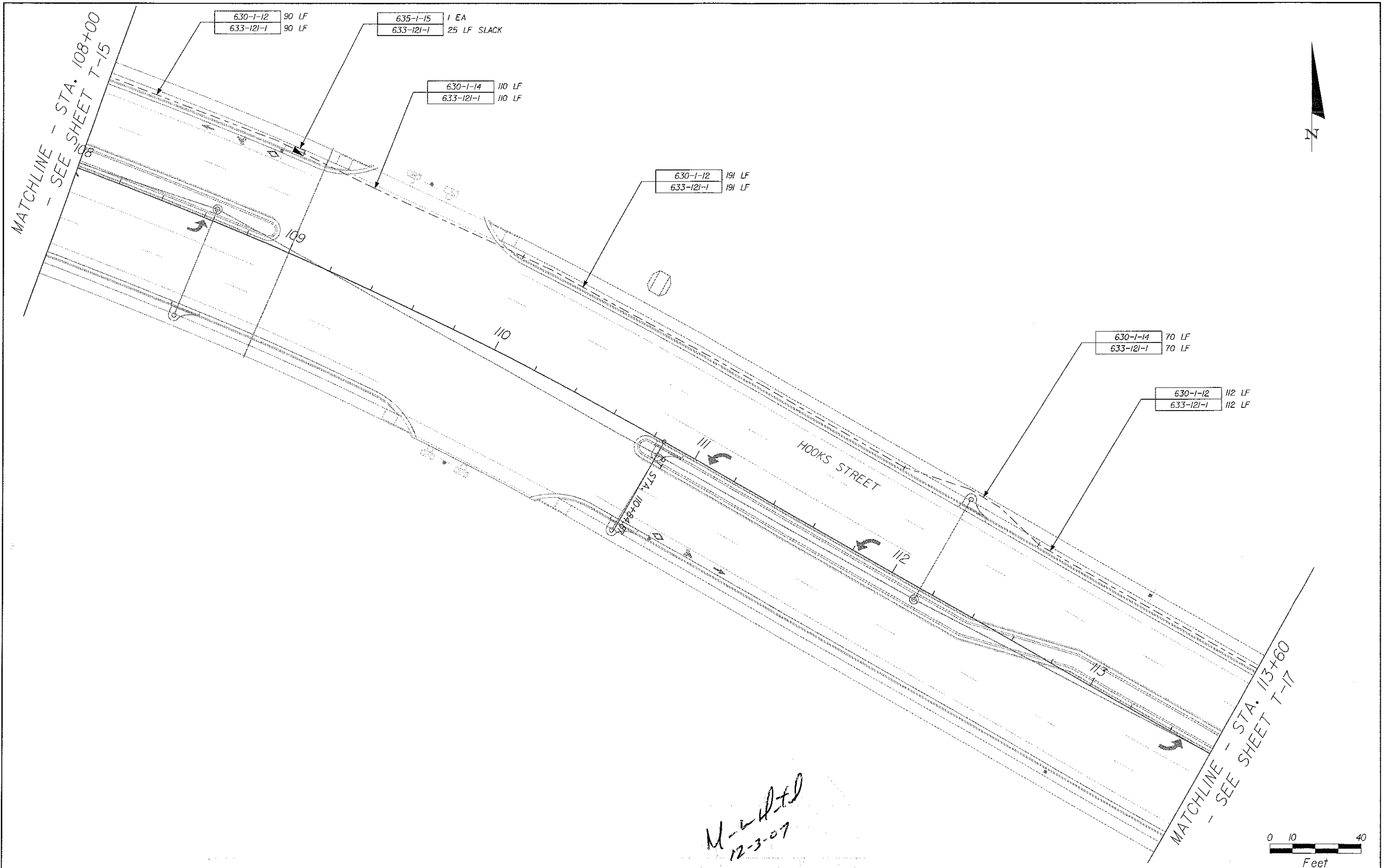

REVISIONS					
DATE	BY	DESCRIPTION	DATE	BY	DESCRIPTION

HNTB
 HNTB CORPORATION
 300 PRIMERA BLVD,
 SUITE 200
 LAKE MARY, FL 32746
 (407) 805-0355
 CERT. OF AUTH. NO. 6500

ENGINEER OF RECORD: MARC W. HUSTAD, P.E.
 FL. REGISTRATION NO. 66761

LAKE COUNTY TRAFFIC ENGINEERING DEPARTMENT		
ROAD NO.	COUNTY	PROJECT NO.
HOOKS ST. AT CITRUS TOWER BLVD	LAKE	22323.08, 43817.00

INTERCONNECT PLAN

SHEET NO.
T-16

12/3/2007

12/3/2007 3:00:00 PM

sghosh

N:\22323.08\DGN 2007\PLAN\SG10.dgn

MATCHLINE - STA. 113+60
- SEE SHEET T-16

630-1-12 20 LF
633-121-1 20 LF

635-1-15 1 EA
633-121-1 25 LF SLACK

630-1-12 72 LF
633-121-1 72 LF

630-1-14 235 LF
633-121-1 235 LF

630-1-12 162 LF
633-121-1 162 LF

47 LF 630-1-14
47 LF 633-121-1

1 EA 635-1-15
25 LF SLACK 633-121-1

PC STA. 115+42.75

PI STA. 118+87.50

HOOKS STREET



MATCHLINE - STA. 119+00
- SEE SHEET T-18

M. W. HUSTAD
12-3-07

REVISIONS					
DATE	BY	DESCRIPTION	DATE	BY	DESCRIPTION



HNTB CORPORATION
300 PRIMA BLVD,
SUITE 200
LAKE MARY, FL 32746
(407) 805-0355
CERT. OF AUTH. NO. 6500

ENGINEER OF RECORD: MARC W. HUSTAD, P.E.
FL. REGISTRATION NO. 66761

LAKE COUNTY		
TRAFFIC ENGINEERING DEPARTMENT		
ROAD NO.	COUNTY	PROJECT NO.
HOOKS ST AT CITRUS TOWER BLVD	LAKE	22323.08, 43817.00

INTERCONNECT PLAN

SHEET NO.
T-17

12/3/2007

12/3/2007 3:00:13 PM

sghosh

N:\22323.08\OGN 2007\PLANS\GII.dgn

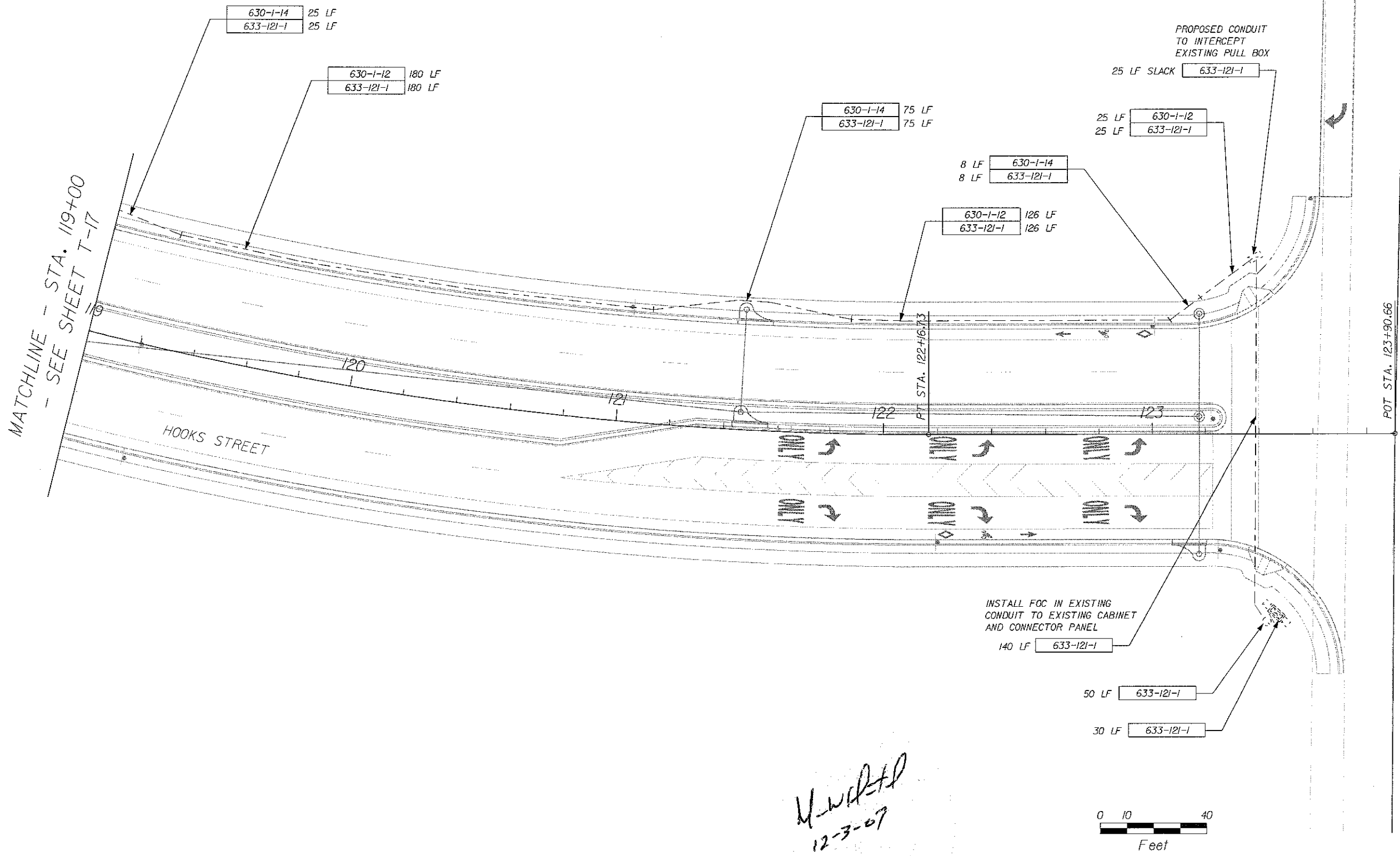

M. W. HUSTAD
12-3-07

REVISIONS					
DATE	BY	DESCRIPTION	DATE	BY	DESCRIPTION

HNTB
 HNTB CORPORATION
 300 PRINERA BLVD.,
 SUITE 200
 LAKE MARY, FL 32746
 (407) 805-0355
 CERT. OF AUTH. NO. 6500
 ENGINEER OF RECORD: MARC W. HUSTAD, P.E.
 FL. REGISTRATION NO. 66761

LAKE COUNTY TRAFFIC ENGINEERING DEPARTMENT		
ROAD NO.	COUNTY	PROJECT NO.
HOOKS ST AT CITRUS TOWER BLVD	LAKE	22323.08, 43817.00

INTERCONNECT PLAN

SHEET NO.
T-18

12/3/2007



MATCHLINE - STA. 16+80 - SEE SHEET T-5

MATCHLINE - STA. 22+40 - SEE SHEET T-20

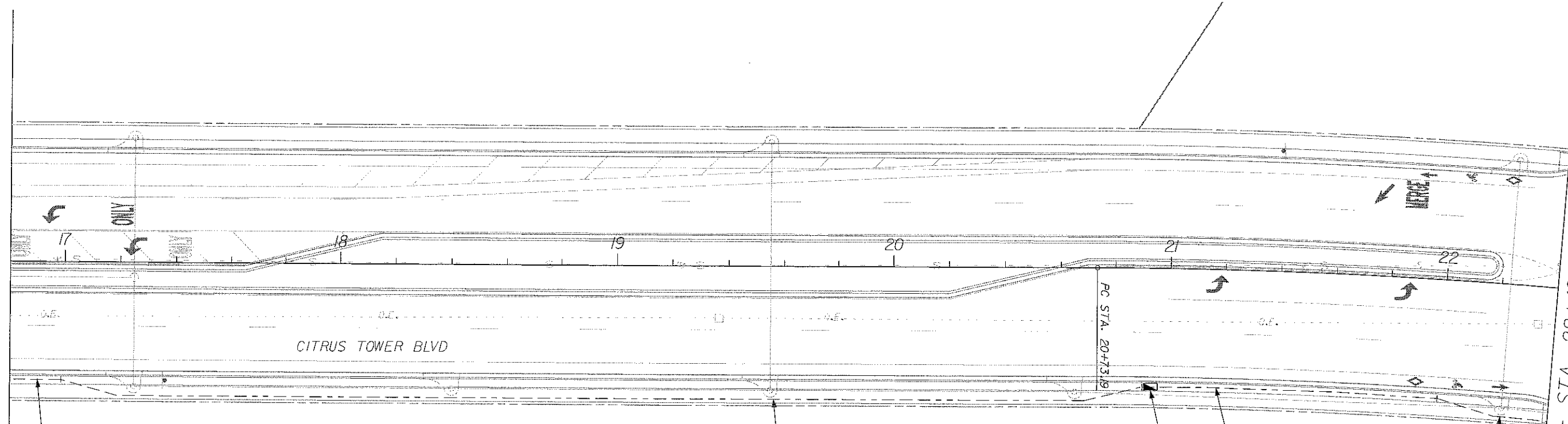

CITRUS TOWER BLVD

630-1-12 20 LF
633-121-1 20 LF

630-1-14 395 LF
633-121-1 395 LF

635-1-15 1 EA
633-121-1 25 LF SLACK

630-1-12 105 LF
633-121-1 105 LF

630-1-14 42 LF
633-121-1 42 LF

M. W. HUSTAD
12-3-07



N:\22323.08\UGW 2007\PLANS\G12.dgn 12/3/2007 3:00:26 PM sqhosh

REVISIONS					
DATE	BY	DESCRIPTION	DATE	BY	DESCRIPTION

HNTB
 HNTB CORPORATION
 300 PRIMERA BLVD,
 SUITE 200
 LAKE MARY, FL 32746
 (407) 805-0355
 CERT. OF AUTH. NO. 6500
 ENGINEER OF RECORD: MARC W. HUSTAD, P.E.
 FL. REGISTRATION NO. 66761

LAKE COUNTY TRAFFIC ENGINEERING DEPARTMENT		
ROAD NO.	COUNTY	PROJECT NO.
HOOKS ST AT CITRUS TOWER BLVD	LAKE	22323.08, 43817.00

INTERCONNECT PLAN

SHEET NO.
T-19

12/3/2007



MATCHLINE - STA. 22+40 - SEE SHEET T-19

MATCHLINE - STA. 28+00 - SEE SHEET T-21

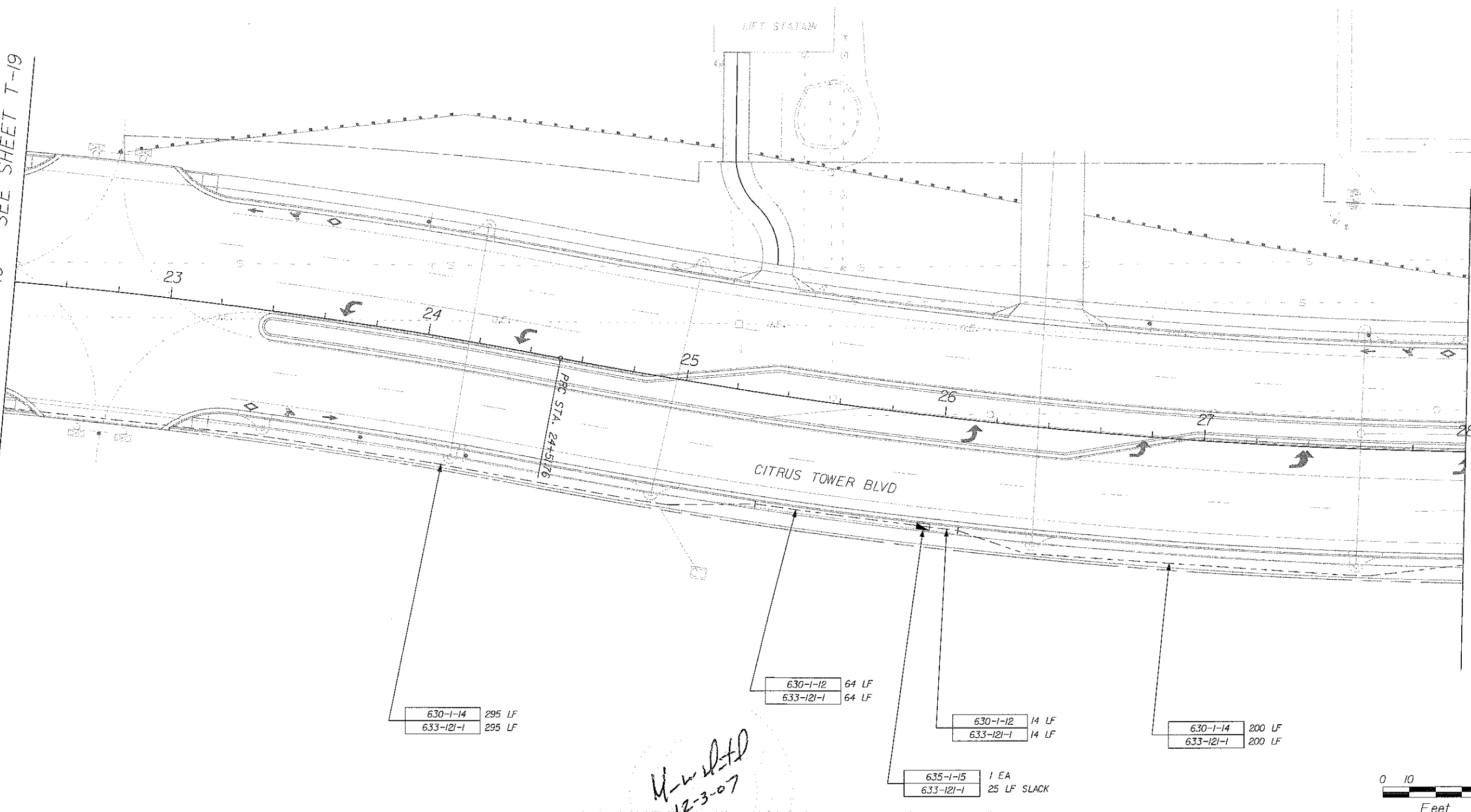

630-1-14 295 LF
633-121-1 295 LF

630-1-12 64 LF
633-121-1 64 LF

630-1-12 14 LF
633-121-1 14 LF

630-1-14 200 LF
633-121-1 200 LF

635-1-15 1 EA
633-121-1 25 LF SLACK

M-W-H-D
12-3-07



12/3/2007 3:00:40 PM

sghosh

N:\222323.08\DWG 2007\PLANS\G13.dgn

REVISIONS					
DATE	BY	DESCRIPTION	DATE	BY	DESCRIPTION

HNTB
HNTB CORPORATION
300 PRIMEA BLVD.
SUITE 200
LAKE MARY, FL 32746
(407) 805-0355
CERT. OF A.U.T. NO. 6500
ENGINEER OF RECORD: MARC W. HUSTAD, P.E.
FL. REGISTRATION NO. 66761

LAKE COUNTY TRAFFIC ENGINEERING DEPARTMENT		
ROAD NO.	COUNTY	PROJECT NO.
HOOKS ST AT CITRUS TOWER BLVD	LAKE	222323.08, 43817.00

INTERCONNECT PLAN

SHEET NO.
T-20

12/3/2007



MATCHLINE - STA. 28+00
- SEE SHEET T-20

- 68 LF 630-1-12
- 68 LF 633-121-1
- 1 EA 635-1-15
- 25 LF SLACK 633-121-1
- 7 LF 630-1-14
- 7 LF 633-121-1
- 30 LF 630-1-12
- 30 LF 633-121-1

EXISTING CABINET TO REMAIN

M. W. HUSTAD
12-3-07

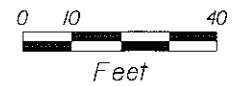

REVISIONS					
DATE	BY	DESCRIPTION	DATE	BY	DESCRIPTION

HNTB
 HNTB CORPORATION
 300 PRIMA BLVD,
 SUITE 200
 LAKE MARY, FL 32746
 (407) 805-0355
 CERT. OF AUTH. NO. 5503

ENGINEER OF RECORD: MARC W. HUSTAD, P.E.
 FL. REGISTRATION NO. 66761

LAKE COUNTY TRAFFIC ENGINEERING DEPARTMENT		
ROAD NO.	COUNTY	PROJECT NO.
HOOKS ST AT CITRUS TOWER BLVD	LAKE	22323.08, 43817.00

INTERCONNECT PLAN

SHEET NO.
T-21

N:\22323.08\CGM 2007\PLANS\G14.dgn 12/31/2007 4:26:15 PM sghosh

12/31/2007