

Request Details Report

Request Number
MA3-16297-R

Associated Work Order

Observed Date/Time
12/4/17 2:04:P

Citizen Information

Name Margaret Hahn

Phone (303) 579-4000 **Ext.**

Address 55248

Alternate Phone

Claire St (9689)

Email Address

Astor FL

Organization

Requestor

Contact

Issue and Location

Activity

Issue

Tree Removal

Map Page

SEC TWN RNG

Address Number

Route Claire St (9689)

Intersect Route

Details

Citizen reports that a large tree fell during the hurricane, "on County property" between address 55248 and 55316. It's down near the water's edge.

Notes

History

12/6/2018 Not Coutny Right-of-Way. Called and left message

Lee, Steven

Resolution _____

Request Response Date 12/06/2018

Date _____

Time Arrived _____

Time Departed _____

Wall, Treeva

From: Wall, Treeva
Sent: Wednesday, December 6, 2017 1:05 PM
To: Lee, Steve
Subject: Claire St - MA3-16297-R

Margaret Hahn
55248 Claire St
Astor

303-579-4000

Citizen reports that a large tree fell during the hurricane, "on County property" between address 55248 and 55316. It's down near the water's edge.



Wall, Treeva

From: Wall, Treeva
Sent: Wednesday, December 13, 2017 7:58 AM
To: Dean, Randy
Cc: Lee, Steve
Subject: Upset Citizen

Randy,

Steve can tell you about this. He spoke with her late yesterday, and she wants to talk to Steve's boss.

Margaret Hahn
Claire St
Astor

303-579-4000

Citizen reports that a large tree fell during the hurricane, "on County property" between address 55248 and 55316. It's down near the water's edge.

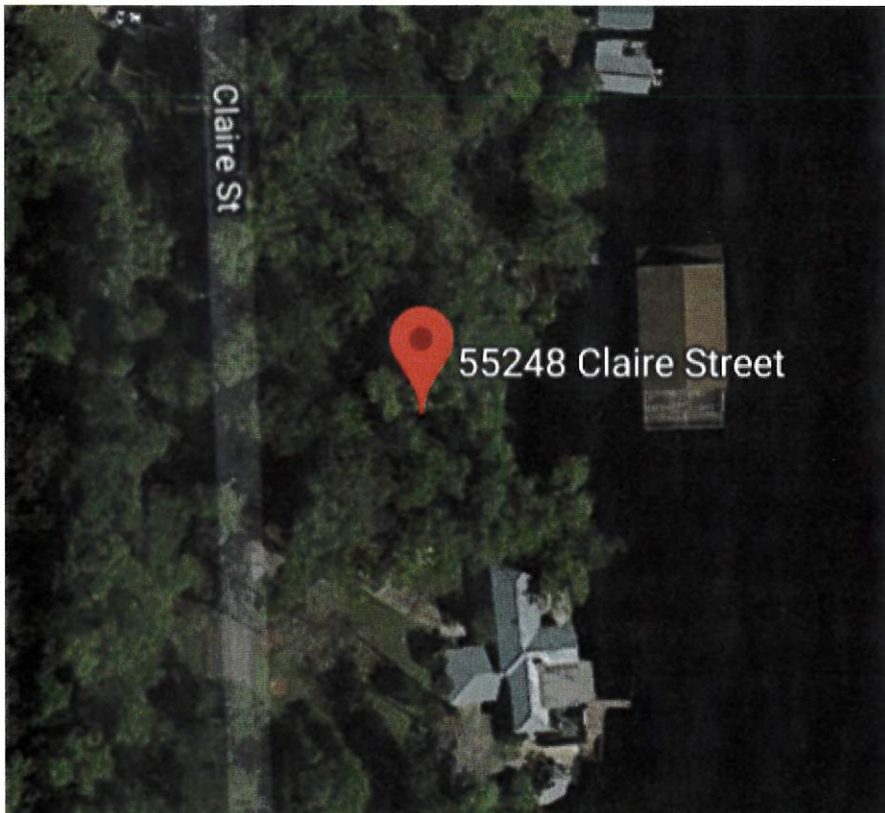

Wall, Treeva

From: Wall, Treeva
Sent: Monday, December 18, 2017 8:01 AM
To: Dean, Randy
Cc: Lee, Steve
Subject: RE: Upset Citizen

Yes, she left a lengthy message on Friday night. She is upset, saying that you need to "walk back in there". She says that it's definitely not her tree. It's "your" tree, and it fell down down by the river, and fell across the boardwalk that goes up to her house. She says that it doesn't seem right that "you" would have that property and not be responsible for it.



TREEVA WALL

Office Associate III

PUBLIC WORKS

Road Operations Division, Maintenance Area III

A PO Box 7800, Tavares FL 32778

P 352-669-2814 | **F** 352-669-2836

E twall@lakecountyfl.gov | **W** www.lakecountyfl.gov

NOTE: Florida has a very broad public records law.

Your email communications may be subject to public disclosure.

From: Wall, Treeva
Sent: Wednesday, December 13, 2017 7:58 AM
To: Dean, Randy <RDean@lakecountyfl.gov>
Cc: Lee, Steve <slee@lakecountyfl.gov>
Subject: Upset Citizen

Randy,

Steve can tell you about this. He spoke with her late yesterday, and she wants to talk to Steve's boss.

Margaret Hahn
Claire St
Astor

303-579-4000

Citizen reports that a large tree fell during the hurricane, "on County property" between address 55248 and 55316. It's down near the water's edge.