



To _____ From: **Public Works Road Operations**

Fax: _____ Phone : **(352) 343-6439**

Phone: _____ Pages: **1**

Re: Sod Installation

REQUEST FOR SOD INSTALLED

Install Date Requested: _____ Road Segment # 3-4561-06 through 11

Delivery address: 3800 Progress Bv, Eustis to 4200 N. CR 19A, Eustis

Section: 23 Town: 19 Range: 26

Directions to Delivery Point: See attached.

Type of sod: Bahia Quantity : 2,500 sq ft

Notes: Start/Stop points marked with paint.

Prior to performance of work, questions concerning the measurements shall be addressed and agreed upon in writing either by the Maintenance Area Supervisor or the Senior Contracting Officer. No work shall be done without an agreement. Please send invoice to the address listed below.

Please Contact us if there is a different quantity needed than what was ordered.

County Representative: _____

Date:

S.L.

| | |
|--|--------------|
| Work completed and OK to Pay, Yes <input type="checkbox"/> No <input type="checkbox"/> | |
| Invoice # | |
| Inspected by : | Date: |

Request Details Report

Request Number
MA3-14668-R

Associated Work Order

Observed Date/Time
7/5/16 10:22:A

Citizen Information

Name John Tremain

Phone (352) 383-0512 Ext.

Address 600
Marion Dr (4262D)
Mount Dora FL

Alternate Phone (352) 551-9168

Email Address

Organization

Requestor

Contact

Issue and Location

Activity

Issue

Drainage

Map Page

SEC TWN RNG

Address Number

Route CR 19A (4561)

Intersect Route

Details

Citizen reports that when it rained heavily the other day, the entire road (South of the bridge, near The Yard Stop) was under water. He says that we need to use the GradAll to dig a deeper swale.

Notes

History

7/28/2016 Contract sod installation requested.

Lee, Steven

Resolution _____

Request Response Date _____

Date _____

Time Arrived _____

Time Departed _____

Lake County Public Works Department

THIS MAP WAS PREPARED FOR THE USE OF THE LAKE COUNTY PUBLIC WORKS DEPARTMENT, AND WAS COMPILED FROM THE MOST AUTHENTIC INFORMATION AVAILABLE. LAKE COUNTY DOES NOT ASSUME RESPONSIBILITY FOR ERRORS OR OMISSIONS CONTAINED HEREON.

| | | | | | |
|------|------|------|------|------|------|
| P-15 | P-16 | P-17 | P-18 | P-19 | P-20 |
| P-21 | P-22 | P-23 | P-24 | P-25 | P-26 |
| P-27 | P-28 | P-29 | P-30 | P-31 | P-32 |
| P-33 | P-34 | P-35 | | | |

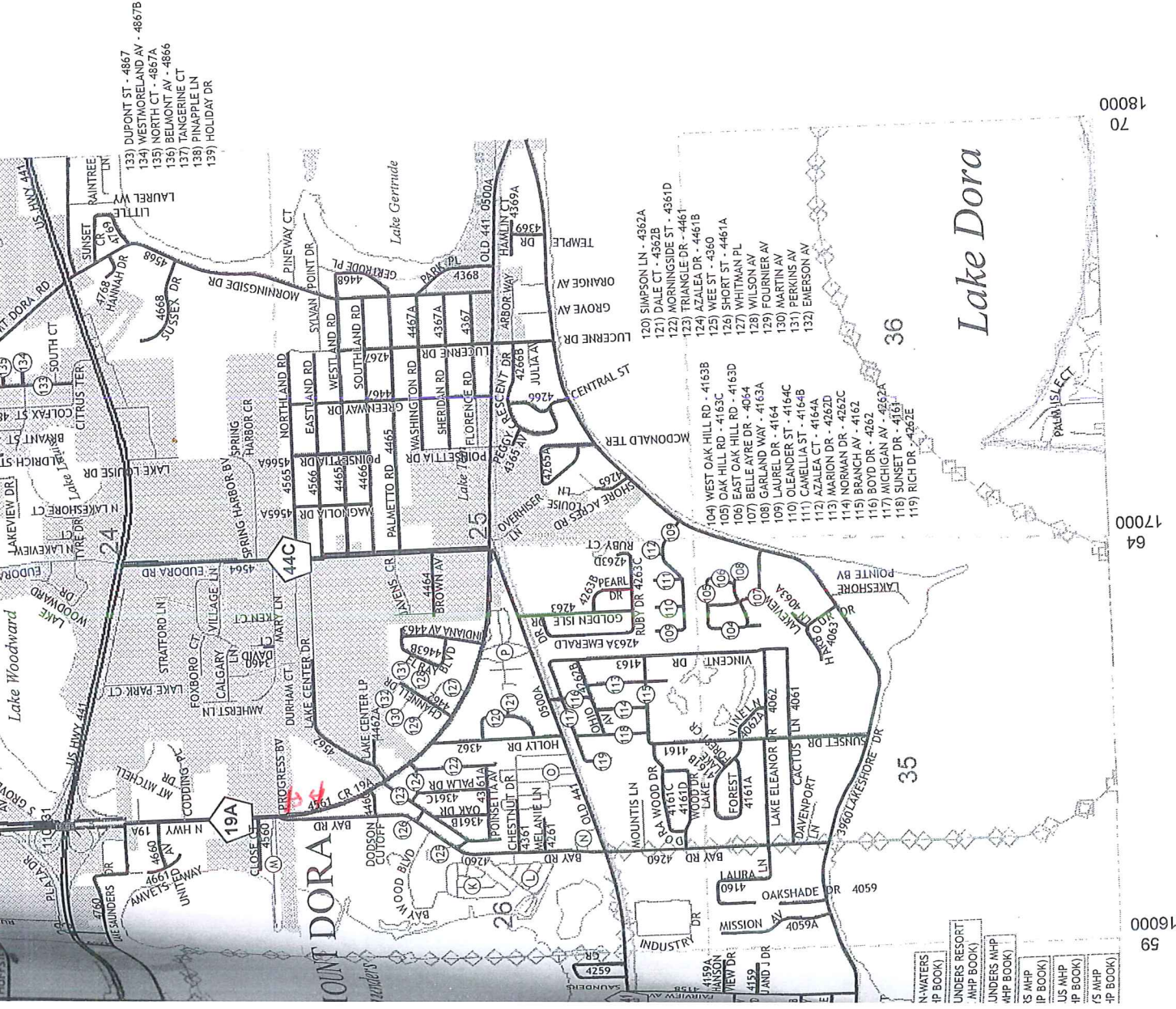
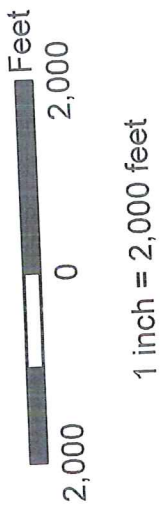

- 133 DUPONT ST - 4867
- 134 WESTMORELAND AV - 4867B
- 135 NORTH CT - 4867A
- 136 BELMONT AV - 4866
- 137 TANGERINE CT
- 138 PINAPPLE LN
- 139 HOLIDAY DR

| | |
|---------------|---------|
| N-WATERS | -P BOOK |
| UNDERS RESORT | -P BOOK |
| UNDERS MHP | -P BOOK |
| UNDERS MHP | -P BOOK |
| US MHP | -P BOOK |
| US MHP | -P BOOK |
| US MHP | -P BOOK |

59
64
70
16000
17000
18000

YOUR TRIP TO:



3800 Progress Blvd, Mount Dora, FL 32757

6 MIN | 2.9 MI

Trip time based on traffic conditions as of 10:36 AM on July 28, 2016. Current Traffic: Moderate

- 1. Start out going west on E Orange Ave/FL-44 toward N Dewey St.
Then 0.25 miles 0.25 total miles
- 2. Turn left onto S Bay St/FL-44/FL-19/County Hwy-19A. Continue to follow County Hwy-19A.
County Hwy-19A is just past S Eustis St.
Bank Of America is on the corner.
If you are on W Orange Ave and reach Morin St you've gone a little too far.
Then 2.56 miles 2.81 total miles
- 3. Turn left onto Progress Blvd.
Progress Blvd is just past Close Ct.
If you reach Bay Rd you've gone a little too far.
Then 0.09 miles 2.90 total miles
- 4. 3800 PROGRESS BLVD is on the right.
If you reach the end of Progress Blvd you've gone a little too far.

Use of directions and maps is subject to our [Terms of Use](#). We don't guarantee accuracy, route conditions or usability. You assume all risk of use.

