



LAKE COUNTY
FLORIDA

To: _____ From: **Public Works/Road Ops**

Fax: _____ Pages: **1**

Phone: _____ Date: **11/5/2012**

E-Mail: _____

TREE REMOVAL REQUEST

Road Name: Cherry Ln Segment No.: 3-4480A-04

Nearest City: Mount Dora

Address: 1721

Section 28 Township: 19 Range: 27

Description of Tree: Oak

Location of Tree: in ROW

Size of tree (s): 40"

Grind Stump? yes Remove Stump? _____

If trim what class? Class 1 Class 2 Class 3

Power Lines or other hazards involved? Yes No

Sod? Yes No Type of sod Needed: _____

Comments: _____

Questions concerning tree size(s) shall be addressed and agreed upon in writing by either the Project Manager or designee prior to the performance of the work. Any work performed without agreement by all parties shall be paid in accordance with the terms and conditions of the Contract. Invoices should be sent to the address listed below.

Approved by: _____ Date: _____

County Representative

Work Completed and OK to Pay: Yes <input type="checkbox"/> No <input type="checkbox"/>	
Inspected by: _____	Date: _____
Invoice # _____	

Lake County Road Operations, Public Works 12901 County Landfill Road, Tavares.
Mailing Address, PO Box 7800, Tavares Florida 32778,
Phone Number: 352-343-6439 - Fax Number: 352-742-3888

Request Details Report

Request Number MA3-10221-R Associated Work Order Observed Date/Time 11/2/12 2:24:P

Citizen Information

Name Heidi Sommer Phone (352) 383-8454 Ext.
Address 1710 Heather St (4480B) Alternate Phone
Mount Dora FL Email Address

Organization
Requestor
Contact

Issue and Location	Issue	Tree Removal
Activity	Map Page 223	Section 27

Address Number

Route Cherry Ln (4480A)

Intersect Route

Details

Citizen reports a dead tree in the ROW at her neighbor's house, across the road from her address.

Notes

History

11/2/2012 Request has been printed and given to the Supervisor. Wall, Treeva

Resolution _____

Request Response Date Talked to Heidi while at site 11/5/12

Date _____

Time Arrived _____

Time Departed _____

(Tree is at 1721 Cherry Ln.)

No Power lines

~~40' 4"~~ 40" Oak

Grind Stump no soil

Click here to change page title

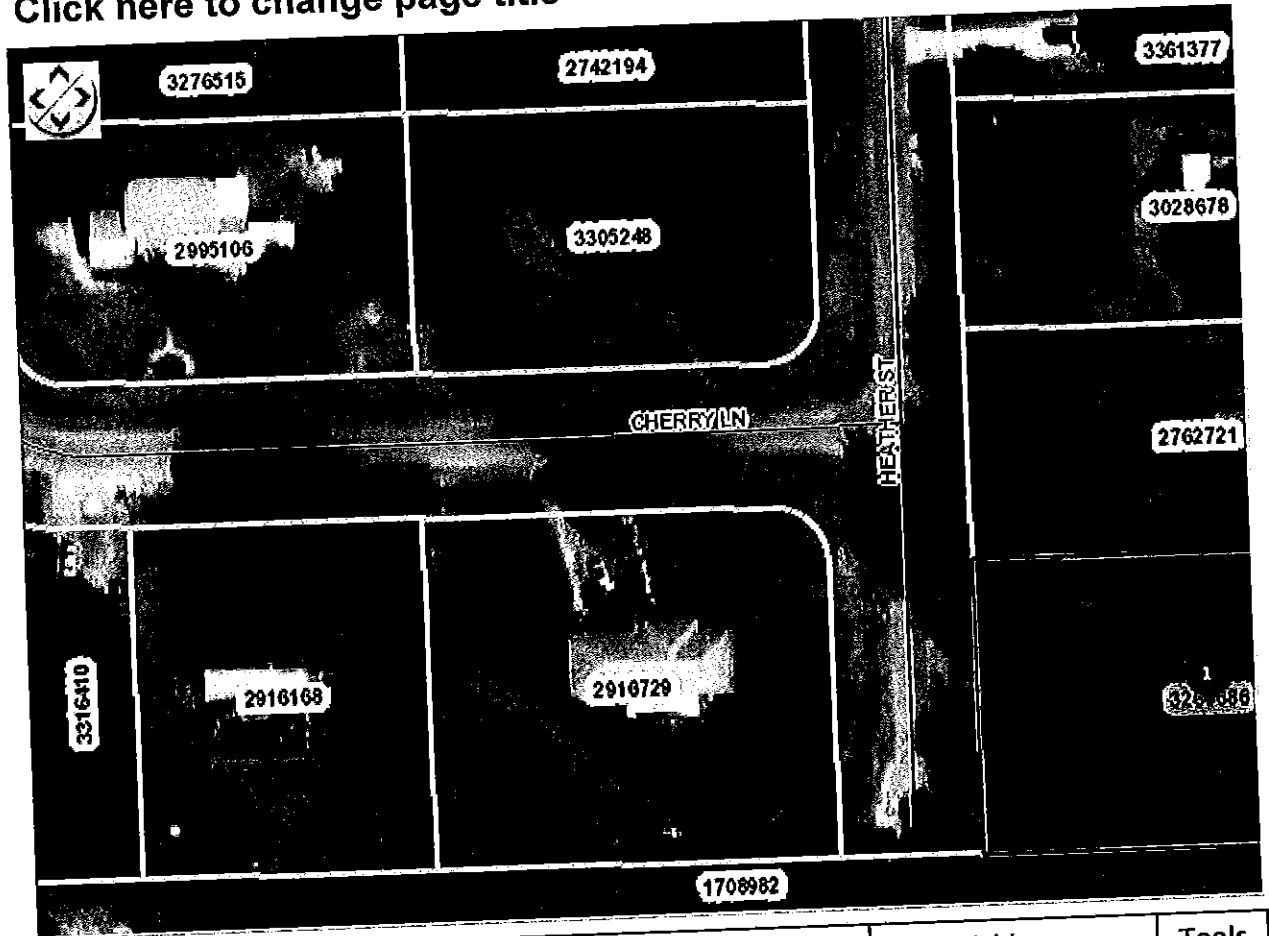

#	Alt Key	Owner	Parcel Address	Owner Address	Tools
1	3260686	SOMMER HEIDI	1710 HEATHER ST MOUNT DORA FL 32757	1710 HEATHER ST MOUNT DORA, FL 32757	Zoom in



11/05/2012 11:15 AM

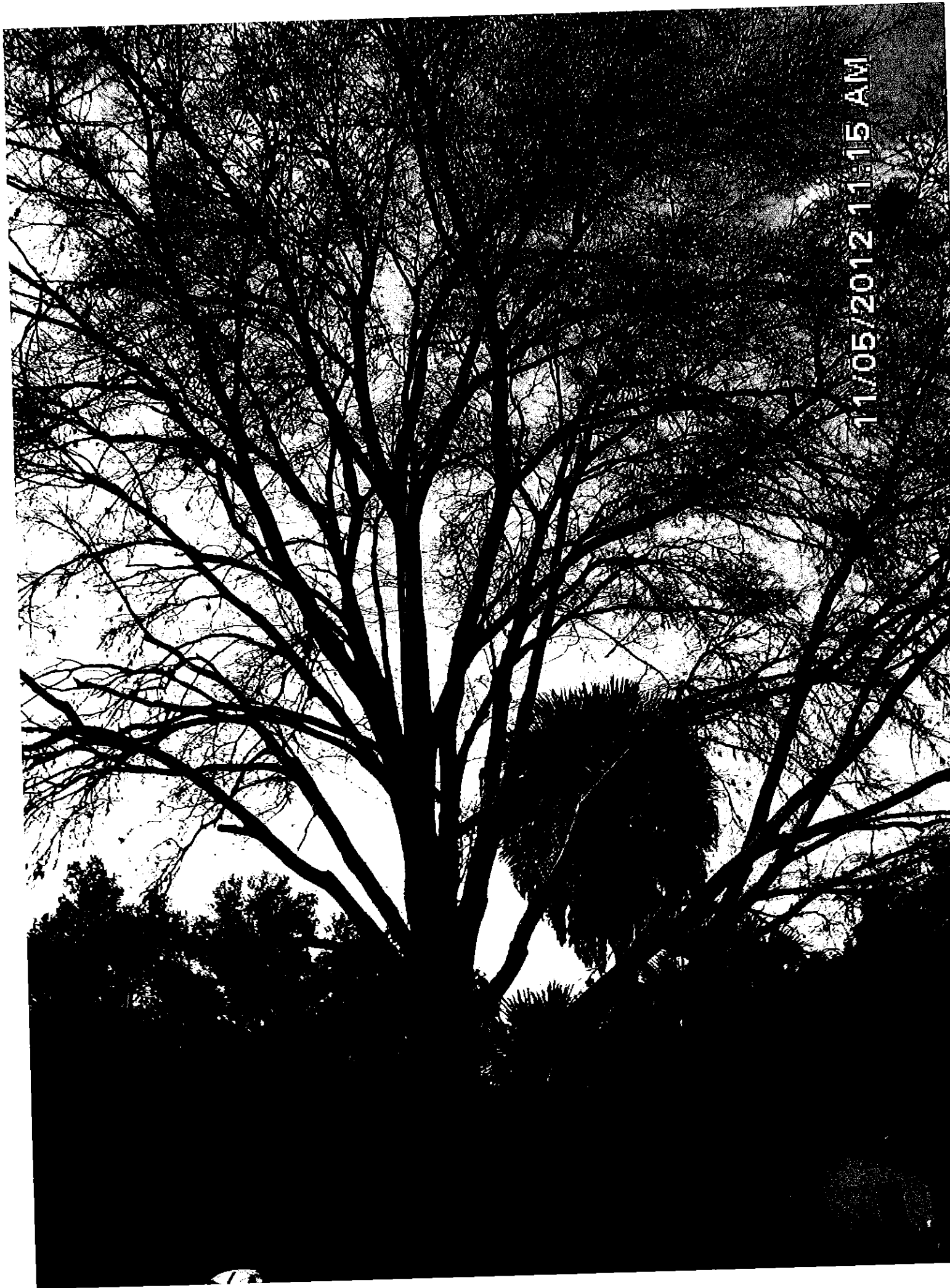

11/05/2012 11:15 AM