



To: _____ **From: Public Works Road Operations**

Fax: _____ **Phone :** (352) 253-4980

Phone: _____ **Pages: 1**

Re: Sod Installation _____

REQUEST FOR SOD INSTALLED

Install Date Requested: _____

Deliver to: 34745 La Place Ct (3-5685-01)

Section:12 Town: 19 Range:27

Directions to Delivery Point: See attached map.

Type of sod:Bahia Quantity : 13,600 sq. ft.

Notes: _____

Prior to performance of work, questions concerning the measurements shall be addressed and agreed upon in writing either by the Maintenance Area Supervisor or the Senior Contracting Officer. No work shall be done without an agreement. Please send invoice to the address listed below.

Please Contact us if there is a different quantity needed than what was ordered.

County Representative: _____

Date:

Work completed and OK to Pay, Yes <input type="checkbox"/> No <input type="checkbox"/>	
Invoice #	
Inspected by :	Date:

Request Details Report

Request Number MA3-6671-R **Associated Work Order** OSC-996-WO **Observed Date/Time** 9/24/09 9:04:A

Citizen Information

Name Carol Peters **Phone** (352) 255-8138 **Ext.**
Address 34745 **Alternate Phone**
La Place Ct (5685) **Email Address**
Eustis FL

Organization
Requestor
Contact

Issue and Location

Activity **Issue** **Washout**
OSC Sod Installation **Map Page** **Section**
Address Number
Route La Place Ct (5685)

Intersect Route
Details

Flooding on property being caused run off from hillside of the road. The water is running straight down the hill onto property overrunning her swales and causing washout.

Notes

Work done by Maintenance Area: MA3-10560-WO.

History

9/24/2009	Supervisor said to generate a work order for this request. Request hjenkins printed and given to the supervisor and converted to a work order.	
9/24/2009	Randy spoke with citizen and informed her it would be a couple of weeks until the new fiscal year.	Dean, Randy
9/30/2009	14 ft wide, 1,050 ft of swale, bahia, marked with paint. May be contracted. Projected start date 11/01/09.	Dean, Randy
10/14/2009	Requested contract work.	Dean, Randy
1/15/2010	No funding for contract gradall work. Will need to be done by Maintenance Area.	Warren, Dennis
2/4/2010	Requested contract sod installation.	Lee, Steven

Resolution _____

Request Response Date 09/24/2009 _____
Date _____
Time Arrived _____
Time Departed _____



MAPQUEST.

Map of 34745 la Place Ct
Eustis, FL 32736-9298

Notes

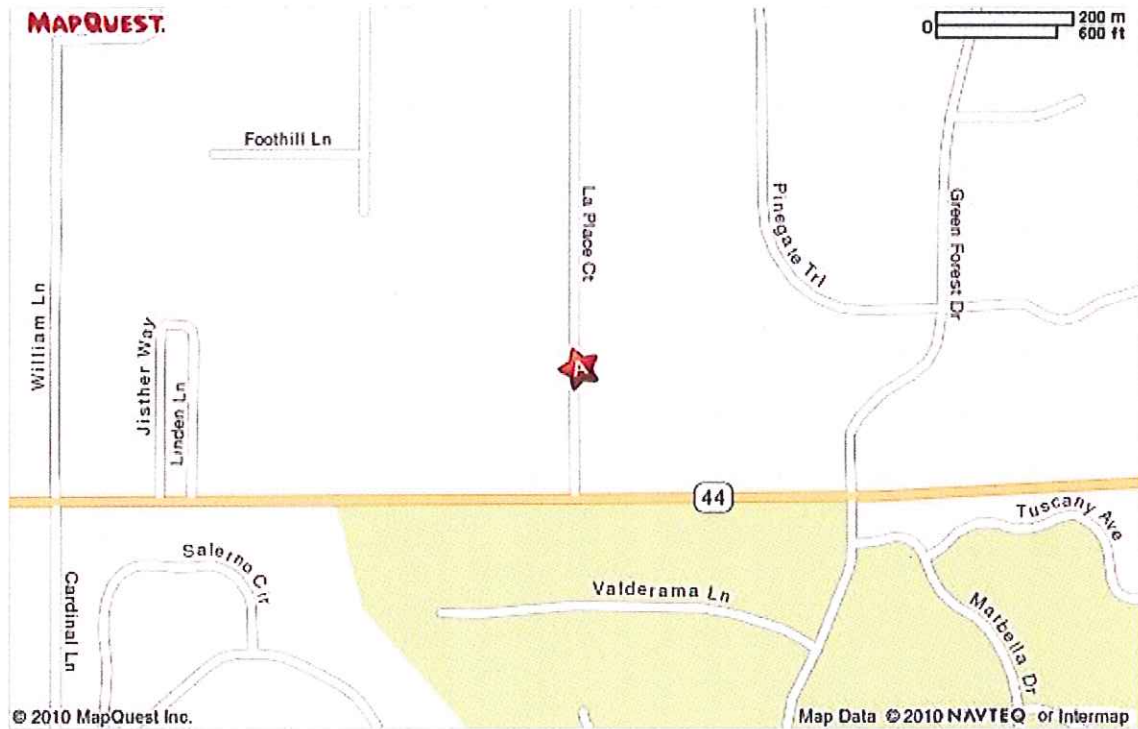

[All rights reserved. Use subject to License/Copyright](#) | [Map Legend](#)

Directions and maps are informational only. We make no warranties on the accuracy of their content, road conditions or route usability or expeditiousness. You assume all risk of use. MapQuest and its suppliers shall not be liable to you for any loss or delay resulting from your use of MapQuest. Your use of MapQuest means you agree to our [Terms of Use](#)