

V & S SURVEYING, INC.

2412 Orsota Circle, Ocoee, Florida 34761. Tel: 407-342-1510 Fax: 407-656-8365 Email: vssurveying@aol.com

BOUNDARY & TOPOGRAPHIC SURVEY FOR AS-BUILT PURPOSE

Bearings shown hereon are based on State Plane Coordinates Florida East Zone, per reference points " LK 39" & " LK 40".

Field Date : 04/20/20
Date Completed : 04/23/20

Project: EAST LAKE COMMUNITY PARK
ALTERNATE KEY : 1802709

Address:XXX WALLICK RD,
SORRENTO, FLORIDA 32776.

BENCHMARK USED
VERTICAL DATUM IS N.A.V.D '88, REFERENCE
LAKE COUNTY VERTICAL DENSIFICATION
PROJECT BENCHMARK, "A-23, ELEVATION 82.21.

SURVEY NO : VS 2401-2

Certified To :
PROFESSIONAL DIRT SERVICES
LAKE COUNTY BCC.

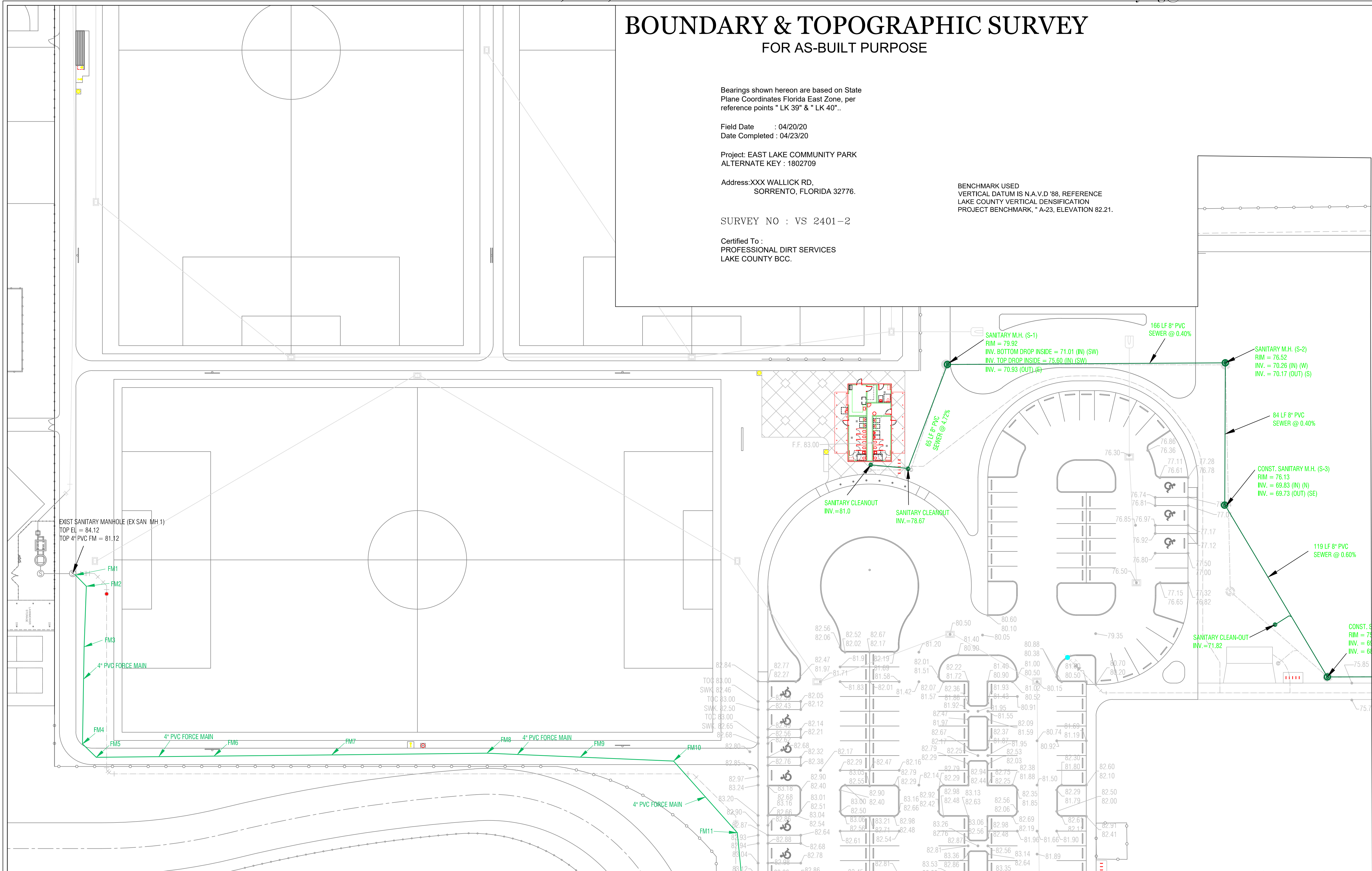
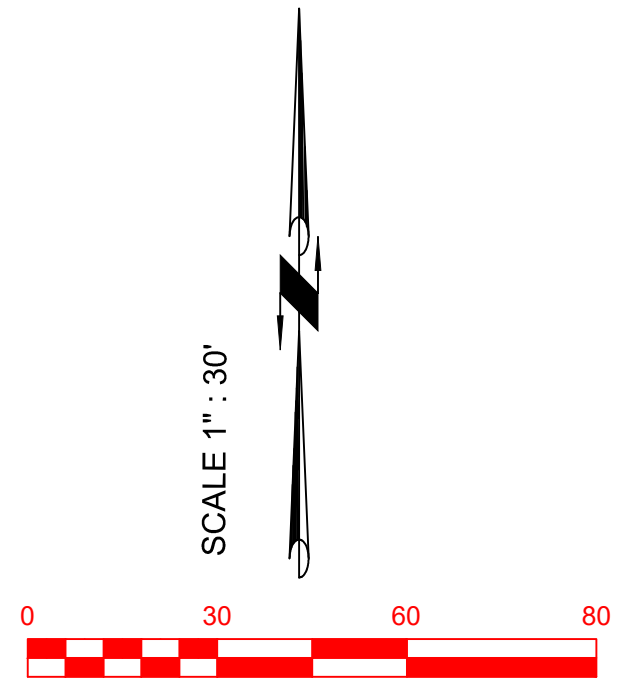

Point	Northing	Easting	Elevation	Description
EX SAN MH 1	1629908.999	480307.960	84.12	TOP EXISTING SANITARY MANHOLE
FM1	1629907.962	480309.670	81.12	TOP 4" PVC FORCE MAIN
FM2	1629901.158	480316.299	81.92	TOP 4" 45' BEND
FM3	1629864.273	480314.919	80.71	TOP 4" PVC FORCE MAIN
FM4	1629805.143	480313.924	81.19	TOP 4" 45' BEND
FM5	1629797.003	480322.333	81.12	TOP 4" 45' BEND
FM6	1629797.724	480394.054	80.80	TOP 4" PVC FORCE MAIN
FM7	1629798.445	480465.774	80.45	TOP 4" PVC FORCE MAIN
FM8	1629793.476	480560.371	80.15	TOP 4" PVC FORCE MAIN
FM9	1629797.086	480617.258	81.00	TOP 4" PVC FORCE MAIN
FM10	1629794.696	480674.139	80.89	TOP 4" 45' BEND
FM11	1629751.017	480712.954	80.84	TOP 4" 45' BEND
FM12	1629692.316	480718.727	81.28	TOP 4" PVC FORCE MAIN
FM13	1629687.155	480718.871	80.18	TOP 4" HDPE FORCE MAIN
FM14	1629644.584	480720.009	79.17	TOP 4" HDPE FORCE MAIN
FM15	1629634.886	480720.641	80.32	TOP 4" PVC FORCE MAIN
FM16	1629555.434	480723.639	80.06	TOP 4" 45' BEND
FM17	1629527.765	480751.907	78.88	TOP 4" 45' BEND
FM18	1629527.603	480831.461	79.53	TOP 4" PVC FORCE MAIN
FM19	1629528.561	480919.197	79.14	TOP 4" PVC FORCE MAIN
FM20	1629529.202	481008.882	78.65	TOP 4" PVC FORCE MAIN
FM21	1629530.066	481087.676	78.37	TOP 4" PVC FORCE MAIN
FM22	1629531.470	481177.478	84.68	TOP 4" 45' BEND
FM23	1629560.272	481205.269	81.80	TOP 4" PVC FORCE MAIN
FM24	1629573.282	481217.855	81.71	TOP 4" PVC FORCE MAIN
FM25	1629599.004	481242.842	74.40	TOP 4" 45' BEND
SV1	1629599.492	481248.727	75.27	TOP 4" SEWER VALVE
FM26	1629599.655	481250.702	74.33	TOP 4" WYE
FM27	1629599.887	481253.501	74.24	TOP 4" 45' BEND
FM28	1629596.994	481256.750	74.30	TOP 4" FORCE MAIN
FM29	1629595.514	481255.347	74.30	TOP 4" FORCE MAIN
SVB1	1629594.878	481257.329	76.75	TOP SANITARY VALVE BOX
SLS1	1629588.188	481264.884	76.75	TOP SANITARY LIFT STATION

LEGEND	
A/C	Air Condition
A	Arc Length
B.M	Bench Mark
B.S	Building Setback
CATV	Cable TV Riser
C	Calculated
CL	Centerline
CLF	Chain Link Fence
C.B	Chord Bearing
C LEN	Chord Length
C/O	Cleanout
CONC	Concrete
C.B.S	Concrete Block Structure
C.M	Concrete Monument
Δ	Delta
D.E	Drainage Easement
D.F	Drainfield
D/W	Driveway
E.O.P	Edge of Pavement
E.O.P	Edge of Pavement
E.O.W	Edge of Water
EL	Elevation
F	Field
F.F	Finish Floor
FH	Fire Hydrant
F.D	Found
⊙	Found Iron Rod or Iron Pipe
⊙	Found Nail and Disk
IP	Iron Pipe
IR	Iron Rod
L.P	Light Pole
L.A.E	Limited Access Easement
MH	Manhole
M	Measured
MP	Meter Pole
N+D	Nail and Disc
N.R	Non Radial
NHWE	Normal High Water Elevation
N.T.S	Not to Scale
O.R	Official Record
O.R.B	Official Record Book
O.H.L	Overhead Lines
Pg	Page
P.C.P	Permanent Control Point
P.R.M	Permanent Reference Marker
P	Plat
P.O.B	Point of Beginning
P.O.C	Point of Commencement
P.R.C	Point of Curvature
P.I	Point of Intersection
P.R.C	Point of Reverse Curve
P.T	Point of Tangency
P.O.L	Point on Line
PP	Power Pole
PROP	Proposed
RAD	Radial
R	Radius
R.P	Radius Point
R.W	Right of Way
S.T	Septic Tank
S.I.R	Set Iron Rod #7772
O.H.L	Overhead Lines
SW	Sidewalk
SW.E	Sidewalk Easement
X 98.50	Spot Elevation
TEL	Telephone Riser
T.B.M	Temporary Bench Mark
T.O.B	Top of Bank
TRANS	Transformer
TYP	Typical
U.E	Utility Easement
W.M	Water Meter
WF	Wood Fence

Surveyor's Notes

- This survey is based on the legal description as provided by the Client.
- This Surveyor has not abstracted the land shown hereon for easements rights of way or restrictions of records which may affect the title or use of the land.
- No underground improvements or installations have been located unless noted. Only visible utilities located.
- Elevations if shown hereon are based on NAVD 1988 unless otherwise stated.
- Dimensions shown for the location of improvements hereon should not be used to reconstruct boundary lines.

- Dimensions and bearings shown are plat and measured only unless otherwise noted.
- Attention is directed to the fact that this plan may have altered in size by reproduction. This must be considered when obtaining scaled data.
- Features shown by symbols as indicated in legend may not be to scale.
- Wall ties are to face of wall.
- Only visible utilities and encroachment located.
- This survey is valid for 90 days from the completed date or revised date shown.
- Septic Tanks and drainfield location are approximate and should be verified by the appropriate utility company.
- The accuracy of this survey is according to the Standards of Practice by the Board of Professional Land Surveyors and Mappers in Rule 53-17 Florida Administrative Code.

This survey is not valid without the signature and the original raised embossed seal of a Florida licensed Surveyor and Mapper

I certify that this survey was made under my direction and that it meets the Standards of Practice set forth by the Board of Professional Land Surveyors and Mappers in Chapter 53-17, Florida Administrative Code, pursuant to Section 472-027, Florida Statutes.

18.7772
Harry H. Sobhraj
Professional Surveyor and Mapper No. 5342