

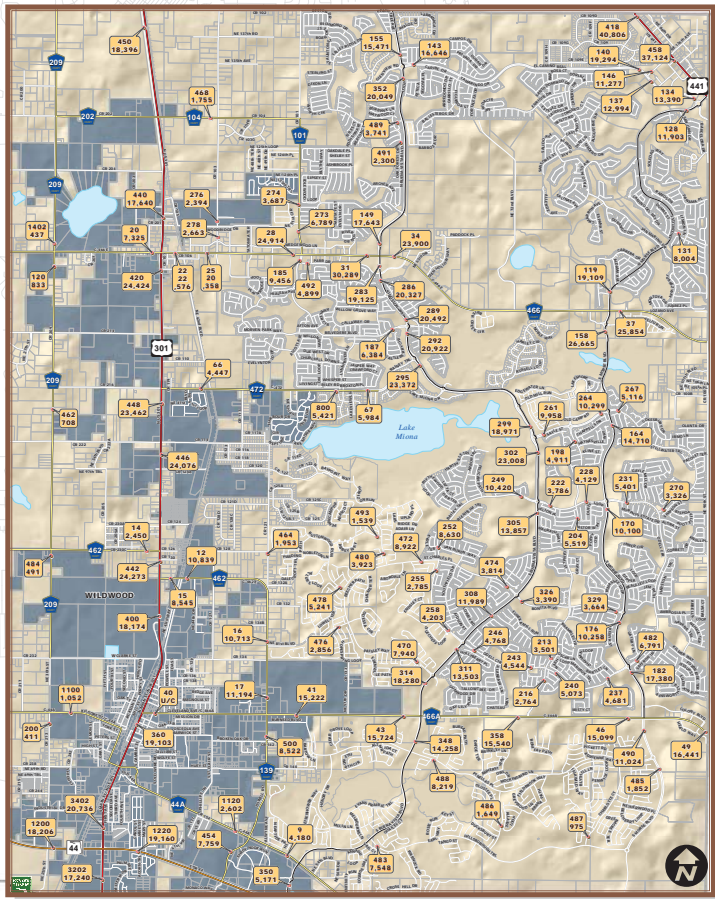

2014 Sumter County Traffic Counts AVERAGE DAILY TRAFFIC



INSET-A

0 0.25 0.5 1 1.5 2
1 INCH EQUALS 0.5 MILES



0 1.25 2.5 3.75 5 6.25 7.5 8.75 10
1 INCH EQUALS 1.25 MILES

LEGEND

- Station ID
ADT
 - Traffic Count Station Location
 - County Road
 - State Road
 - US Highway
 - Interstate
 - Turnpike
 - Water Body
 - Active Railroad
 - County Boundary
- Incorporated Area**
- Bushnell
 - Center Hill
 - Coleman
 - Webster
 - Wildwood



** City Limit boundaries are subject to change and do not necessarily reflect annexations which have occurred. This map is the official Sumter County Average Annual Daily Traffic Counts Map and is kept on file for viewing in Sumter County Public Works.



DATA SOURCES:
Planimetrics by Sumter County GIS Department.
2014 Traffic Counts data collection, compilation and map production by HDR and K&M Data Collection in cooperation with the Lake-Sumter MPO.

This map product was prepared from a Geographic Information System established by HDR and the Lake-Sumter Metropolitan Planning Organization. Its employees, agents and personnel, make no warranty as to its accuracy, and in particular its accuracy as to labeling, dimensions, contours, property boundaries, or placement or location of any map features thereon. The Lake-Sumter Metropolitan Planning Organization and its employees, agents and personnel MAKE NO WARRANTY OF MERCHANTABILITY OR WARRANTY FOR FITNESS OF USE FOR A PARTICULAR PURPOSE EXPRESS OR IMPLIED WITH RESPECT TO THIS MAP PRODUCT. Independent verification of all data contained on this map product should be obtained by any user of this map.

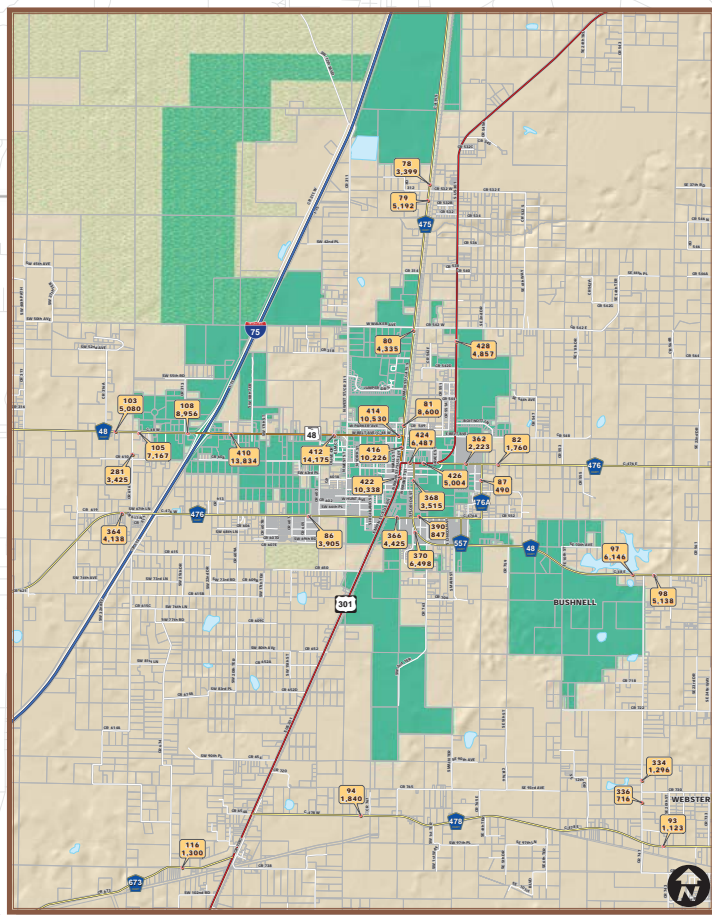

INSET-B

0 0.25 0.5 1 1.5 2
1 INCH EQUALS 0.5 MILES

MARION COUNTY

CITRUS COUNTY

HERNANDO COUNTY

PASCO COUNTY

POLK COUNTY

INSET-A

INSET-B

LAKE COUNTY