

EAGLE POINTE PHASE IV

A REPLAT

REPLATTING A PORTION OF PARCELS 1, 2 AND 3,
EAGLE POINTE, PHASE I, AS RECORDED IN PLAT BOOK 59, PAGES 36 THROUGH 42
LOCATED IN SECTION 9, TOWNSHIP 22 SOUTH, RANGE 25 EAST
CITY OF GROVELAND, LAKE COUNTY, FLORIDA

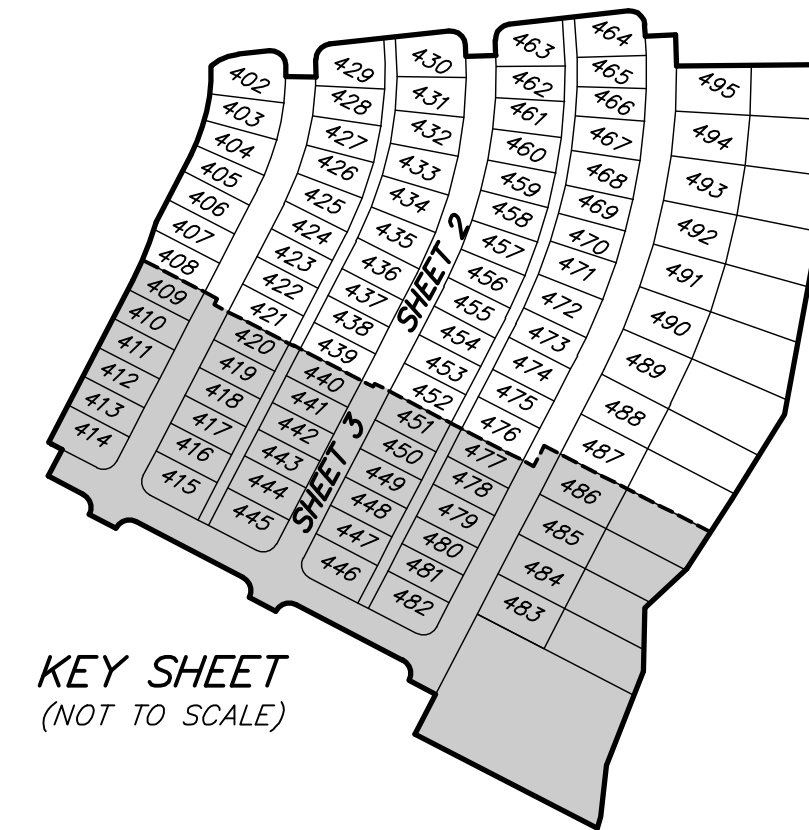
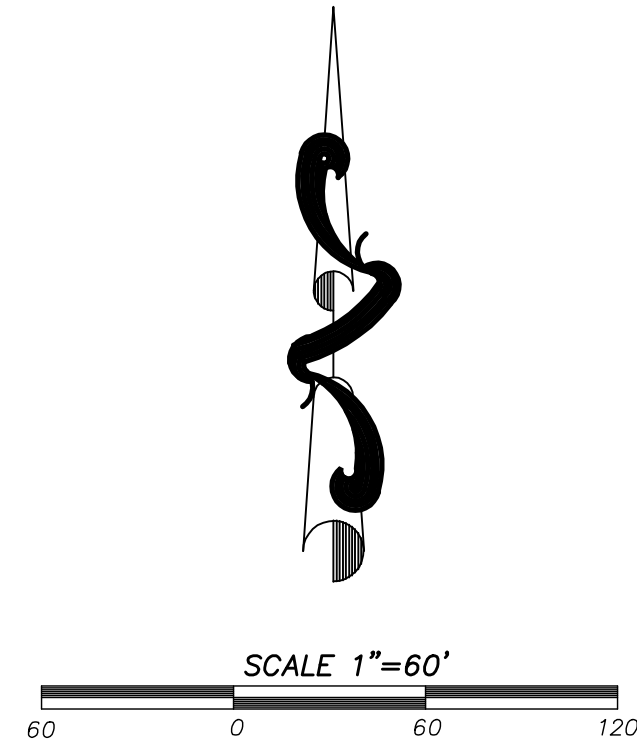

CURVE	RADIUS	DELTA	LENGTH	CHORD	CH. BEARING
C-1	450.00'	26°26'28"	207.67'	205.83'	N14°11'47"E
C-2	750.00'	29°30'05"	386.17'	381.92'	N12°39'59"E
C-3	1050.00'	30°45'13"	563.59'	556.85'	N12°02'25"E
C-4	1075.00'	30°45'13"	577.01'	570.10'	N12°02'25"E
C-5	1025.00'	30°45'13"	550.17'	543.59'	N12°02'25"E
C-6	25.00'	90°00'00"	39.27'	35.36'	N22°25'02"E
C-7	25.00'	90°00'00"	39.27'	35.36'	N17°34'58"W
C-8	775.00'	29°30'05"	399.04'	394.65'	N12°39'59"E
C-9	725.00'	29°30'05"	373.30'	369.19'	N12°39'59"E
C-10	25.00'	90°00'00"	39.27'	35.36'	S72°25'02"W
C-11	25.00'	90°00'00"	39.27'	35.36'	N17°34'58"W
C-12	475.00'	26°26'28"	219.21'	217.27'	N14°11'47"E
C-13	425.00'	26°26'28"	196.13'	194.40'	N14°11'47"E
C-14	25.00'	90°00'00"	39.27'	35.36'	S72°25'02"W
C-15	1075.00'	3°59'51"	75.00'	74.98'	N01°26'03"E
C-16	1075.00'	3°59'51"	75.00'	74.98'	N05°25'53"E
C-17	1075.00'	3°59'51"	75.00'	74.98'	N09°25'44"E
C-18	1075.00'	3°59'51"	75.00'	74.98'	N13°25'35"E
C-19	1075.00'	3°59'51"	75.00'	74.98'	N17°25'25"E
C-20	1075.00'	3°59'51"	75.00'	74.98'	N21°25'16"E
C-21	1075.00'	3°59'51"	75.00'	74.98'	N25°25'06"E
C-22	1025.00'	2°52'37"	51.47'	51.46'	S02°59'21"E
C-23	1025.00'	3°03'37"	54.75'	54.75'	S00°01'14"E
C-24	1025.00'	3°03'37"	54.75'	54.74'	S03°02'23"W
C-25	1025.00'	3°40'12"	65.65'	65.64'	S06°24'18"W
C-26	1025.00'	3°40'12"	65.65'	65.64'	S10°04'30"W
C-27	1025.00'	3°03'37"	54.75'	54.74'	S13°26'24"W
C-28	1025.00'	3°03'37"	54.75'	54.74'	S16°30'02"W
C-29	1025.00'	3°40'12"	65.65'	65.64'	S19°51'56"W
C-30	1025.00'	3°40'12"	65.65'	65.64'	S23°36'54"W
C-31	1025.00'	1°53'16"	33.77'	33.77'	S26°28'24"W
C-32	775.00'	11°51'	16.20'	16.20'	N26°49'06"E
C-33	775.00'	15°02'	51.94'	51.93'	N24°17°59"E
C-34	775.00'	15°02'	51.99'	51.98'	N20°27'28"E
C-35	775.00'	15°02'	51.99'	51.98'	N16°36'51"E
C-36	775.00'	15°02'	51.99'	51.98'	N12°46'13"E
C-37	775.00'	15°02'	51.99'	51.98'	N08°55'36"E
C-38	775.00'	15°02'	51.99'	51.98'	N05°04'58"E
C-39	775.00'	15°02'	51.99'	51.98'	N01°14'20"E
C-40	725.00'	31°02'	44.22'	44.22'	N02°10'17"W
C-41	725.00'	47°02'	54.44'	54.43'	S01°27'39"E
C-42	725.00'	51°34'	66.16'	66.14'	S03°18'17"W
C-43	725.00'	51°34'	66.16'	66.14'	S08°32'01"W
C-44	725.00'	51°34'	66.16'	66.14'	S13°45'45"W
C-45	725.00'	51°34'	66.17'	66.15'	S18°59'30"W
C-46	725.00'	51°34'	66.16'	66.10'	S24°13'08"W
C-47	725.00'	0°35'08"	2.41'	2.41'	S27°07'28"W
C-48	475.00'	0°35'45"	4.94'	4.94'	N27°07'09"E
C-49	475.00'	6°00'53"	49.86'	49.84'	N23°18'51"E
C-50	475.00'	6°01'28"	49.94'	49.92'	N17°47'40"E
C-51	475.00'	6°01'27"	49.94'	49.92'	N11°46'13"E
C-52	475.00'	6°01'28"	49.94'	49.92'	N05°44'45"E
C-53	475.00'	6°01'27"	49.94'	49.92'	N00°06'17"E
C-54	425.00'	8°31'00"	63.11'	63.12'	S02°41'16"W
C-55	425.00'	8°27'49"	62.78'	62.72'	S11°04'11"W
C-56	425.00'	8°27'49"	62.78'	62.72'	S19°38'30"W
C-57	425.00'	3°32'38"	26.29'	26.28'	S25°38'43"W
C-58	550.00'	3°57'50"	38.05'	38.04'	N25°26'07"E
C-59	550.00'	5°42'01"	54.72'	54.70'	N20°36'12"E
C-60	550.00'	11°64'42"	18.22'	18.22'	N17°06'50"E
C-61	300.00'	3°35'32"	18.55'	18.64'	N25°38'46"E
C-62	300.00'	8°27'49"	44.32'	44.28'	N19°38'35"E
C-63	300.00'	8°27'49"	44.32'	44.28'	N11°04'46"E
C-64	300.00'	9°00'34"	47.17'	47.12'	N02°26'34"E
C-65	590.00'	8°16'05"	85.14'	85.07'	S01°24'02"E
C-66	590.00'	6°01'28"	62.04'	62.01'	S05°44'45"W
C-67	590.00'	6°01'27"	62.03'	62.00'	S11°46'17"W
C-68	590.00'	6°01'28"	62.04'	62.00'	S17°47'40"W
C-69	590.00'	6°00'53"	61.94'	61.91'	S23°48'51"W
C-70	590.00'	0°35'45"	6.13'	6.13'	S27°07'09"W
C-71	610.00'	0°35'08"	6.23'	6.23'	N27°07'28"E
C-72	610.00'	5°13'32"	55.63'	55.61'	N24°13'08"E
C-73	610.00'	5°13'45"	55.67'	55.65'	N19°59'29"E
C-74	610.00'	5°13'44"	55.67'	55.65'	N14°45'45"E
C-75	610.00'	5°13'44"	55.67'	55.65'	N08°32'01"E
C-76	610.00'	5°13'44"	55.67'	55.65'	N03°18'12"E
C-77	610.00'	6°15'03"	66.55'	66.52'	N02°26'07"W
C-78	890.00'	5°07'11"	79.53'	79.50'	S03°14'34"E
C-79	890.00'	3°50'37"	59.70'	59.69'	S01°14'21"W
C-80	890.00'	3°50'38"	59.71'	59.70'	S05°04'58"W
C-81	890.00'	3°50'38"	59.71'	59.70'	S08°55'36"W
C-82	890.00'	3°50'37"	59.70'	59.69'	S12°46'14"W
C-83	890.00'	3°50'38"	59.71'	59.70'	S16°36'51"W
C-84	890.00'	3°50'37"	59.70'	59.69'	S20°27'28"W
C-85	890.00'	3°50'24"	59.65'	59.64'	S24°17'59"W
C-86	890.00'	11°51'	18.60'	18.60'	S26°49'06"W
C-87	910.00'	1°53'16"	29.98'	29.98'	N26°28'24"E
C-88	910.00'	3°40'12"	60.81'	60.80'	N23°36'54"E
C-89	910.00'	3°40'12"	58.29'	58.28'	N19°51'56"E
C-90	910.00'	3°03'37"	48.60'	48.60'	N16°30'01"E
C-91	910.00'	3°03'37"	48.60'	48.60'	N13°26'25"E
C-92	910.00'	3°40'12"	58.29'	58.28'	N10°04'30"E
C-93	910.00'	3°40'12"	58.29'	58.28'	N06°24'18"E
C-94	910.00'	3°03'37"	48.60'	48.60'	N03°02'24"E
C-95	910.00'	3°03'38"	48.61'	48.60'	N00°01'14"W
C-96	910.00'	4°15'48"	67.71'	67.70'	N03°40'57"W
C-97	590.00'	3°25'06"	339.32'	334.66'	N10°36'29"E
C-98	610.00'	3°25'40"	361.10'	346.27'	N10°55'42"E
C-99	890.00'	3°31'11"	516.01'	508.82'	N10°48'26"E
C-100	910.00'	3°31'52"	527.79'	520.43'	N10°48'05"E
C-101	1200.00'	3°59'51"	83.72'	83.70'	N01°26'03"E
C-102	1200.00'	3°59'51"	83.72'	83.70'	N05°25'53"E
C-103	1200.00'	3°59'51"	83.72'	83.70'	N09°25'44"E
C-104	1200.00'	3°59'51"	83.72'	83.70'	N13°25'35"E
C-105	1200.00'	3°59'51"	83.72'	83.70'	N17°25'25"E
C-106	1200.00'	3°59'51"	83.72'	83.70'	N21°25'16"E
C-107	1200.00'	3°59'51"	83.72'	83.70'	N25°25'06"E
C-108	1200.00'	2°25'54"	588.05'	580.24'	N13°25'35"E