



www.lakecopropappr.com
CAREY BAKER
LAKE COUNTY PROPERTY APPRAISER
320 W. MAIN STREET
TAVARES, FLORIDA 32778

17	20	19	M	18	L	17	17	16	G	6	7	8	9	10	11	E								
DEER CROSSING RD																								
18	22	23	24	1	2	3	4	5	6	7	8	9	10	11	12	13	14	15	16	17	18	19	20	
FOREST-CAMPSITES-SUB PB 13/23																								
SR 19																								

G							1	2	3	4	5	6	7		
GARDENIA RD															
10	9	8	7	6	5	4	3	2	1	PONSETT RD			5	6	
4	3	2	1											4	3
3	2	1											3	2	
2	1											2	1		
CAMELLIA RD															
10	9	8	7	6	5	4	3	2	1	PONSETT RD			5	6	
4	3	2	1											4	3
3	2	1											3	2	
2	1											2	1		
AZALEA RD															
1	2	3	4	5	6	7	J								
SR 19															

OCALA FOREST CAMPSITES #4 PB 17/26

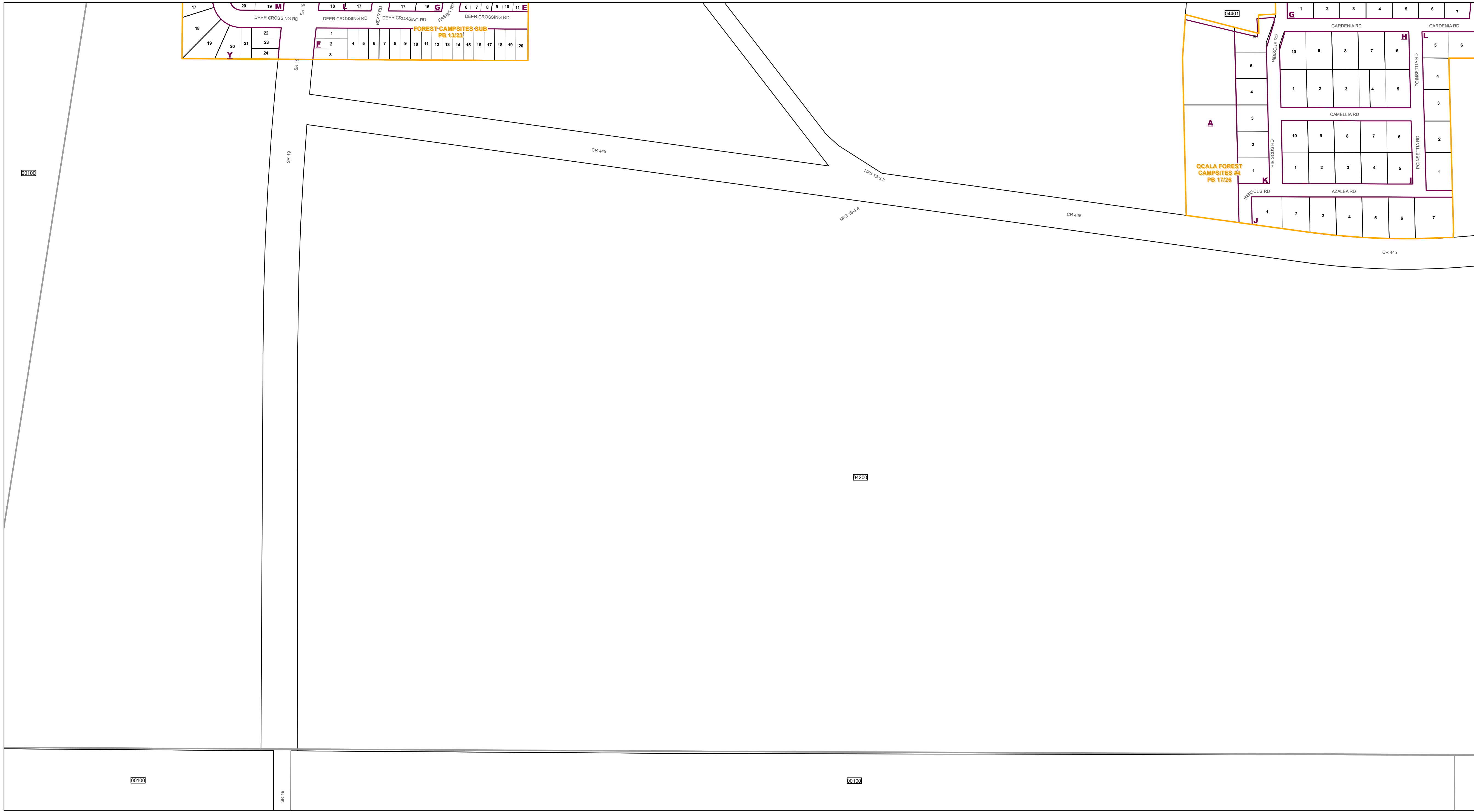

	Tax Parcels		Easements		Government Lots
	Subdivision Lots		Right of Way		Section Lines
	Subdivision Blocks		City Limits		County Boundary
	Subdivision Boundaries		Lakes		

Lake County Property Appraiser (LCPA) digital Geographic Information System (GIS) cadastral maps are produced solely for ad valorem property assessment purposes and are provided to the public for informational purposes only. LCPA's GIS cadastral maps are NOT legal land surveys and should not be used or relied upon as such. No warranties, expressed or implied, are provided for the map data herein, its positional or thematic accuracy, its use, or its interpretation.

ASSESSMENT MAP
LAKE COUNTY, FLORIDA

Coordinate System: NAD 1983 HARN StatePlane Florida East FIPS 0901 Feet

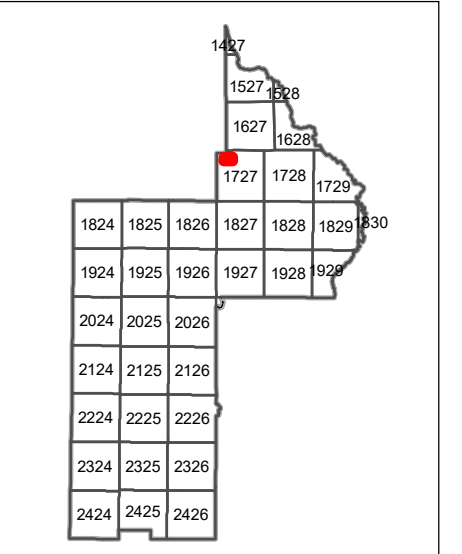

T17-R27-Sec05 S1/2
Date: 1/19/2020