

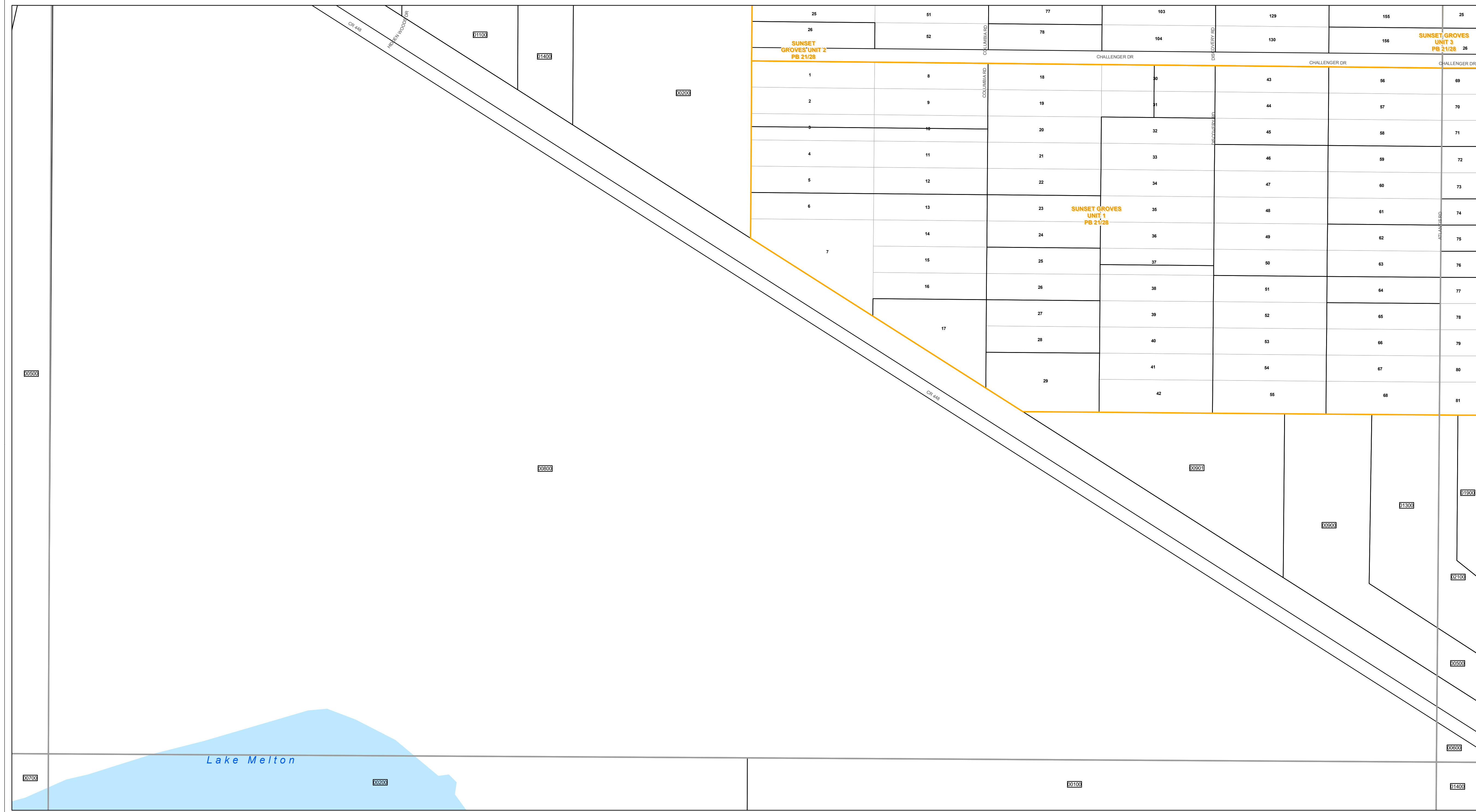

www.lakecopropappr.com  
 CAREY BAKER  
 LAKE COUNTY PROPERTY APPRAISER  
 320 W. MAIN STREET  
 TAVARES, FLORIDA 32778



25	51	77	103	129	155	25
26	52	78	104	130	156	SUNSET GROVES UNIT 3 PB 21/28 26
SUNSET GROVES UNIT 2 PB 21/28						
1	8	18	30	43	56	69
2	9	19	31	44	57	70
3	10	20	32	45	58	71
4	11	21	33	46	59	72
5	12	22	34	47	60	73
6	13	23	35	48	61	74
SUNSET GROVES UNIT 1 PB 21/28						
7	14	24	36	49	62	75
	15	25	37	50	63	76
	16	26	38	51	64	77
	17	27	39	52	65	78
		28	40	53	66	79
		29	41	54	67	80
			42	55	68	81

Path: \\lakegov\bcclcgis\Workgroups\PropertyAppraiser\TaxMaps\2019\TaxMap\_HalfSection\_Updated.mxd

Tax Parcels	Easements	Government Lots
Subdivision Lots	Right of Way	Section Lines
Subdivision Blocks	City Limits	County Boundary
Subdivision Boundaries	Lakes	

Lake County Property Appraiser (LCPA) digital Geographic Information System (GIS) cadastral maps are produced solely for ad valorem property assessment purposes and are provided to the public for informational purposes only. LCPA's GIS cadastral maps are NOT legal land surveys and should not be used or relied upon as such. No warranties, expressed or implied, are provided for the map data herein, its positional or thematic accuracy, its use, or its interpretation.

ASSESSMENT MAP  
**LAKE COUNTY, FLORIDA**

Coordinate System: NAD 1983 HARN StatePlane Florida East FIPS 0901 Feet

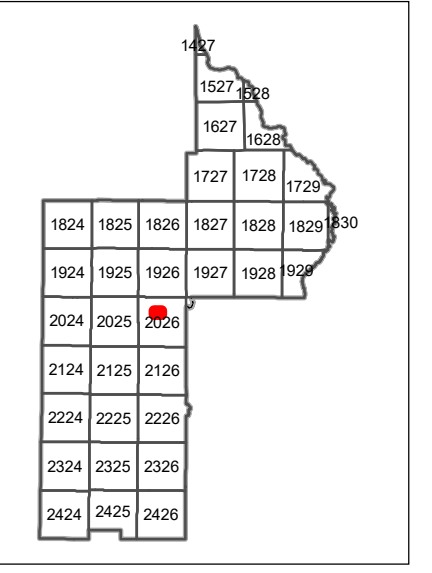

**T20-R26-Sec09 S1/2**  
 Date: 1/17/2020