

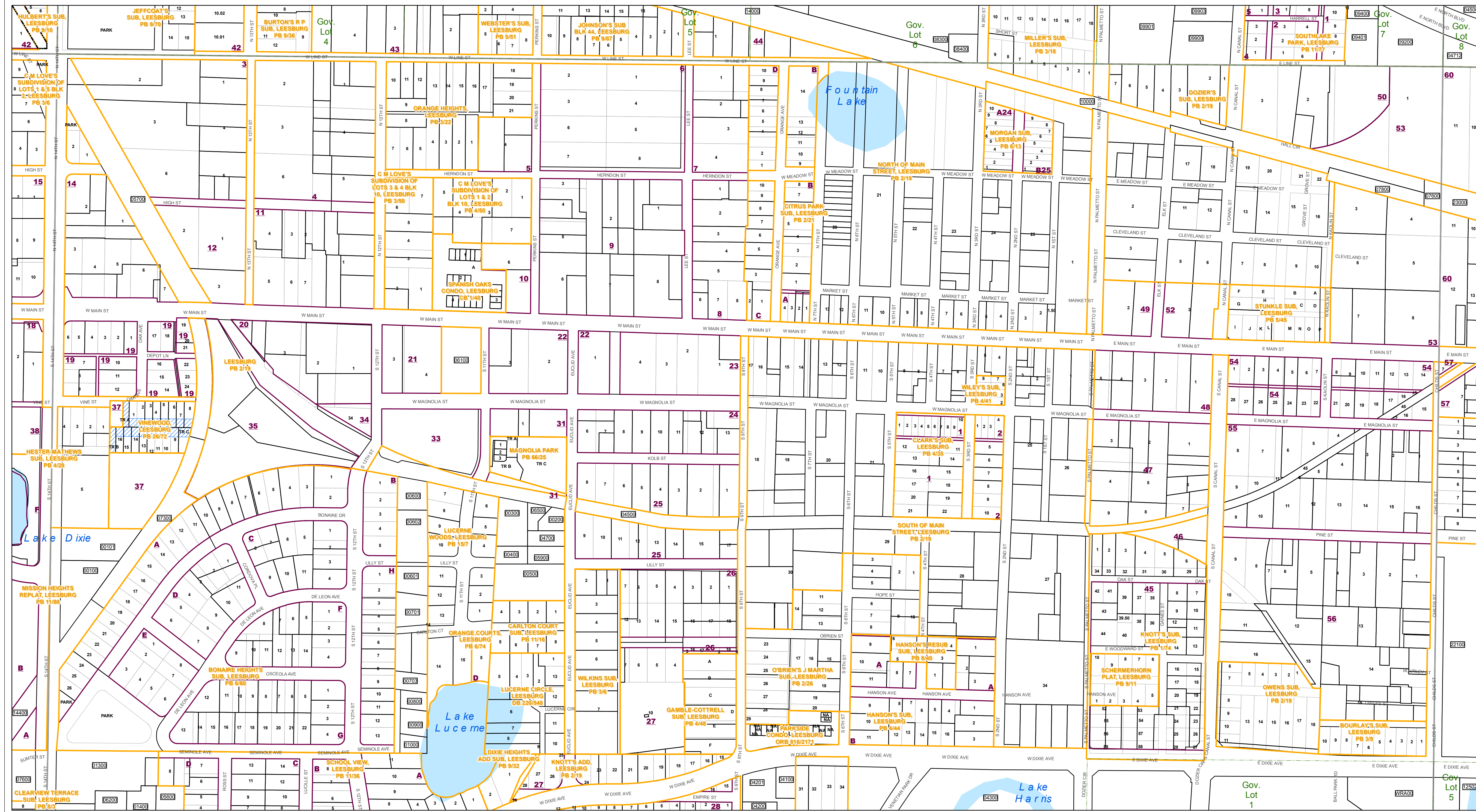

www.lakecoprappr.com
CAREY BAKER
LAKE COUNTY PROPERTY APPRAISER
320 W. MAIN STREET
TAVARES, FLORIDA 32778



Inset map showing a grid of map sheets with coordinates.

1824	1825	1826	1827	1828	1829	1830
1831	1832	1833	1834	1835	1836	1837
1838	1839	1840	1841	1842	1843	1844
1845	1846	1847	1848	1849	1850	1851
1852	1853	1854	1855	1856	1857	1858
1859	1860	1861	1862	1863	1864	1865

Legend for map symbols:

- Tax Parcels (thin black line)
- Subdivision Lots (dashed line)
- Subdivision Blocks (dotted line)
- Subdivision Boundaries (thick black line)
- Easements (blue hatched)
- Right of Way (dashed line)
- City Limits (dotted line)
- Lakes (blue fill)
- Government Lots (green hatched)
- Section Lines (dotted line)
- County Boundary (thick grey line)

Lake County Property Appraiser (LCPA) digital Geographic Information System (GIS) cadastral maps are produced solely for ad valorem property assessment purposes and are provided to the public for informational purposes only. LCPA's GIS cadastral maps are NOT legal land surveys and should not be used or relied upon as such. No warranties, expressed or implied, are provided for the map data herein, its positional or thematic accuracy, its use, or its interpretation.



ASSESSMENT MAP
LAKE COUNTY, FLORIDA
Coordinate System: NAD 1983 HARN StatePlane Florida East FIPS 0901 Feet

T19-R24-Sec26 N1/2
Date: 1/21/2020

Path: \\lakegov\bcclgis\Workgroups\PropertyAppraiser\TaxMaps\2019\TaxMap_HalfSection_Updated.mxd