

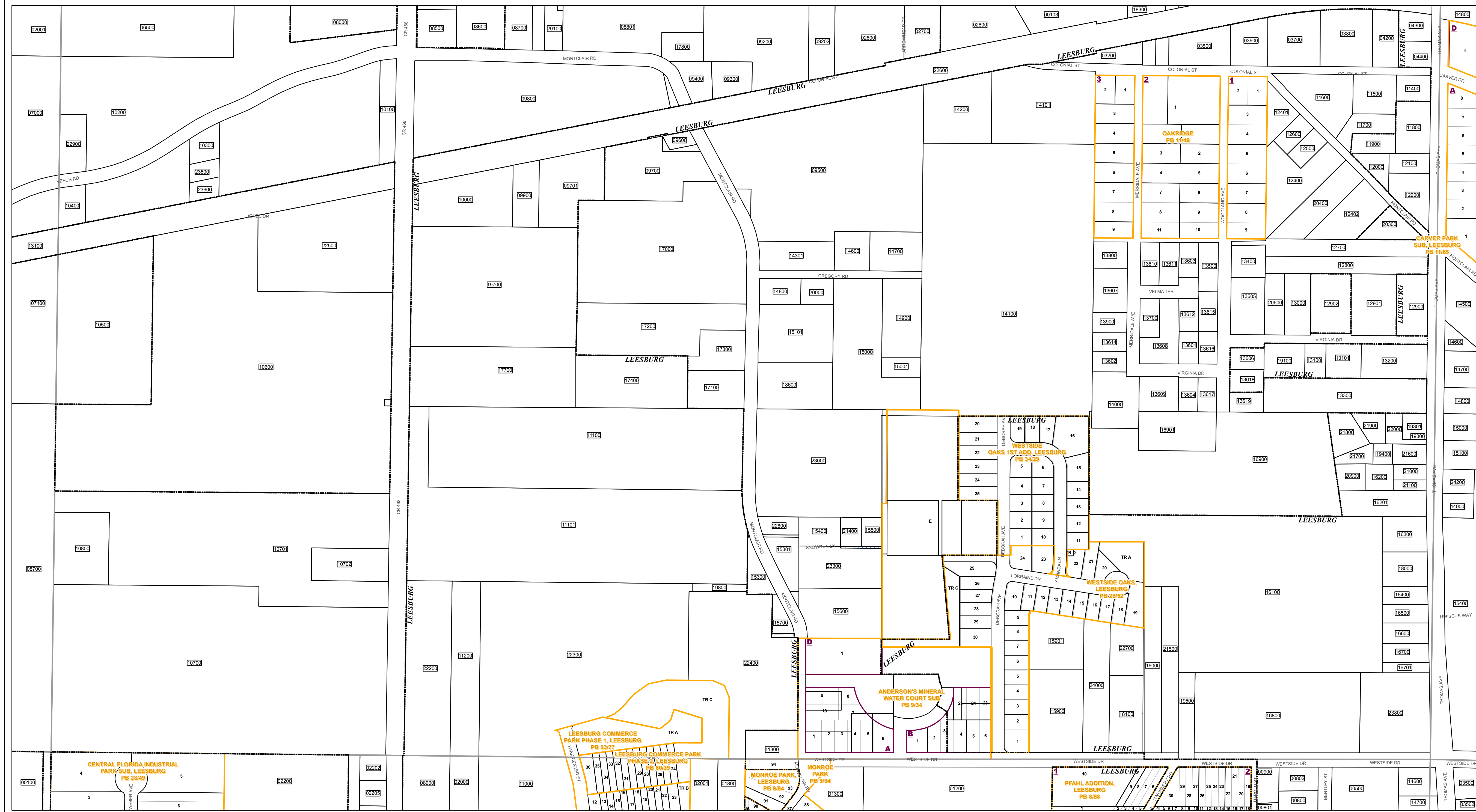

www.lakecopappr.com  
CAREY BAKER  
LAKE COUNTY PROPERTY APPRAISER  
320 W. MAIN STREET  
TAVARES, FLORIDA 32778



CARVER PARK SUB, LEESBURG PB 11/65

WESTSIDE OAKS 1ST ADD, LEESBURG PB 34/29

WESTSIDE OAKS, LEESBURG PB 28/62

ANDERSON'S MINERAL WATER COURT SUB PB 9/34

LEESBURG COMMERCE PARK PHASE 1, LEESBURG PB 53/77

LEESBURG COMMERCE PARK PHASE 2, LEESBURG PB 60/63

MONROE PARK, LEESBURG PB 9/84

MONROE PARK, LEESBURG PB 9/84

PFÄHL ADDITION, LEESBURG PB 8/58

- Tax Parcels
- Subdivision Lots
- Subdivision Blocks
- Subdivision Boundaries
- Easements
- Right of Way
- City Limits
- Lakes
- Government Lots
- Section Lines
- County Boundary

Lake County Property Appraiser (LCPA) digital Geographic Information System (GIS) cadastral maps are produced solely for ad valorem property assessment purposes and are provided to the public for informational purposes only. LCPA's GIS cadastral maps are NOT legal land surveys and should not be used or relied upon as such. No warranties, expressed or implied, are provided for the map data herein, its positional or thematic accuracy, its use, or its interpretation.

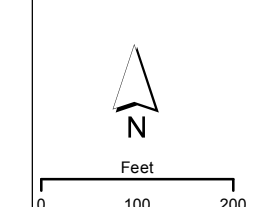

ASSESSMENT MAP  
LAKE COUNTY, FLORIDA

Coordinate System: NAD 1983 HARN StatePlane Florida East FIPS 0901 Feet

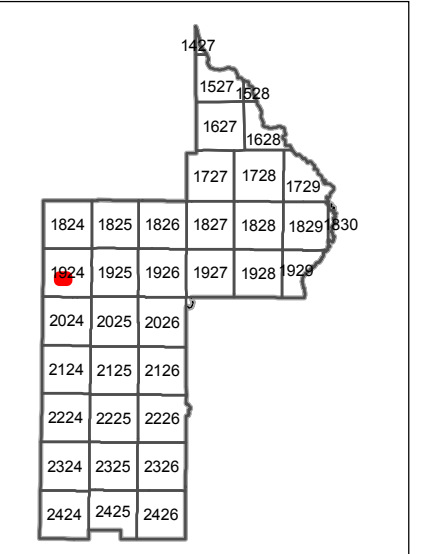

T19-R24-Sec21 S1/2

Date: 1/21/2020