

Marion County

Marion County

Marion County

Marion County

Gov. Lot 1

Gov. Lot 2

Gov. Lot 3

Gov. Lot 4

Gov. Lot 1

00100

00300

00400

00200

00500

04200

00400

00100

00100

SR 19A

CR 445

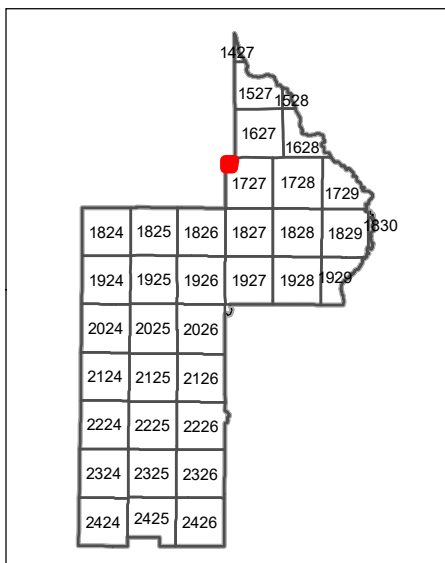
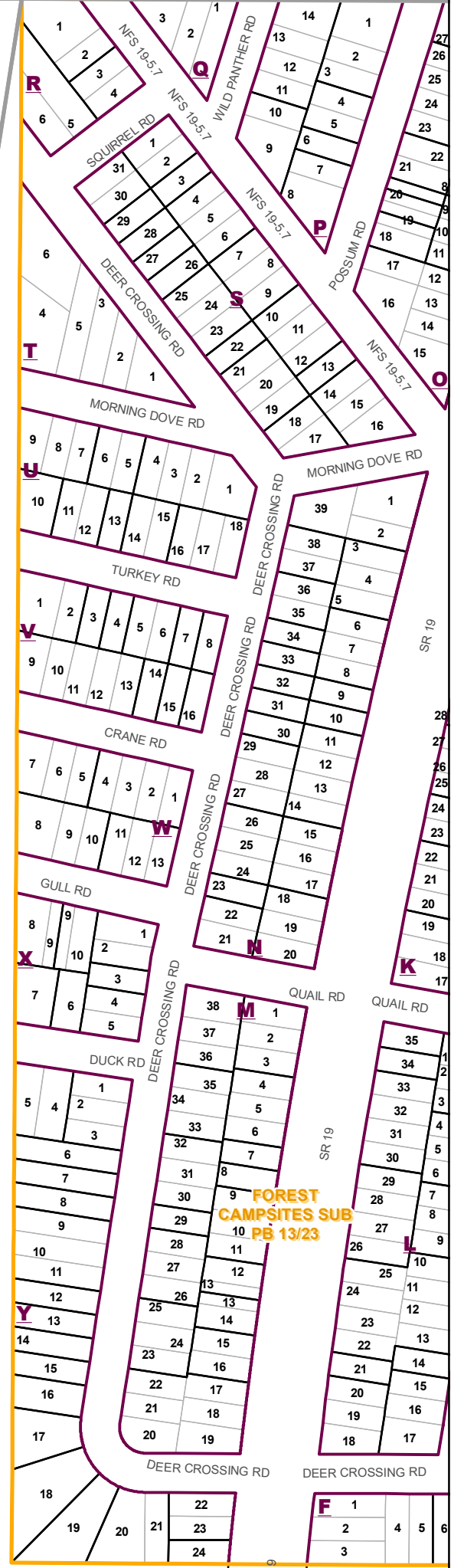

ASSESSMENT MAP  
**LAKE COUNTY, FLORIDA**

**T17-R27-Sec06**  
Date: 10/23/2020

Coordinate System: NAD 1983 HARN StatePlane Florida East FIPS 0901 Feet

- Tax Parcels
- Subdivision Lots
- Subdivision Boundaries
- Conservation Easements
- Right of Way
- City Limits
- Lakes
- Government Lots
- Section Lines
- County Boundary

Lake County Property Appraiser (LCPA) digital Geographic Information System (GIS) cadastral maps are produced solely for ad valorem property assessment purposes and are provided to the public for informational purposes only. LCPA's GIS cadastral maps are NOT legal land surveys and should not be used or relied upon as such. No warranties, expressed or implied, are provided for the map data herein, its positional or thematic accuracy, its use, or its interpretation.

**TAX YEAR 2021**



www.lakecoppa.com  
CAREY BAKER  
LAKE COUNTY PROPERTY APPRAISER  
330 W. MAIN STREET  
TAVARES, FLORIDA 32778