

Sheldon Rubin Trust MASS GRADING

Section 26 & 27, T24S, R26W Lake County, Florida

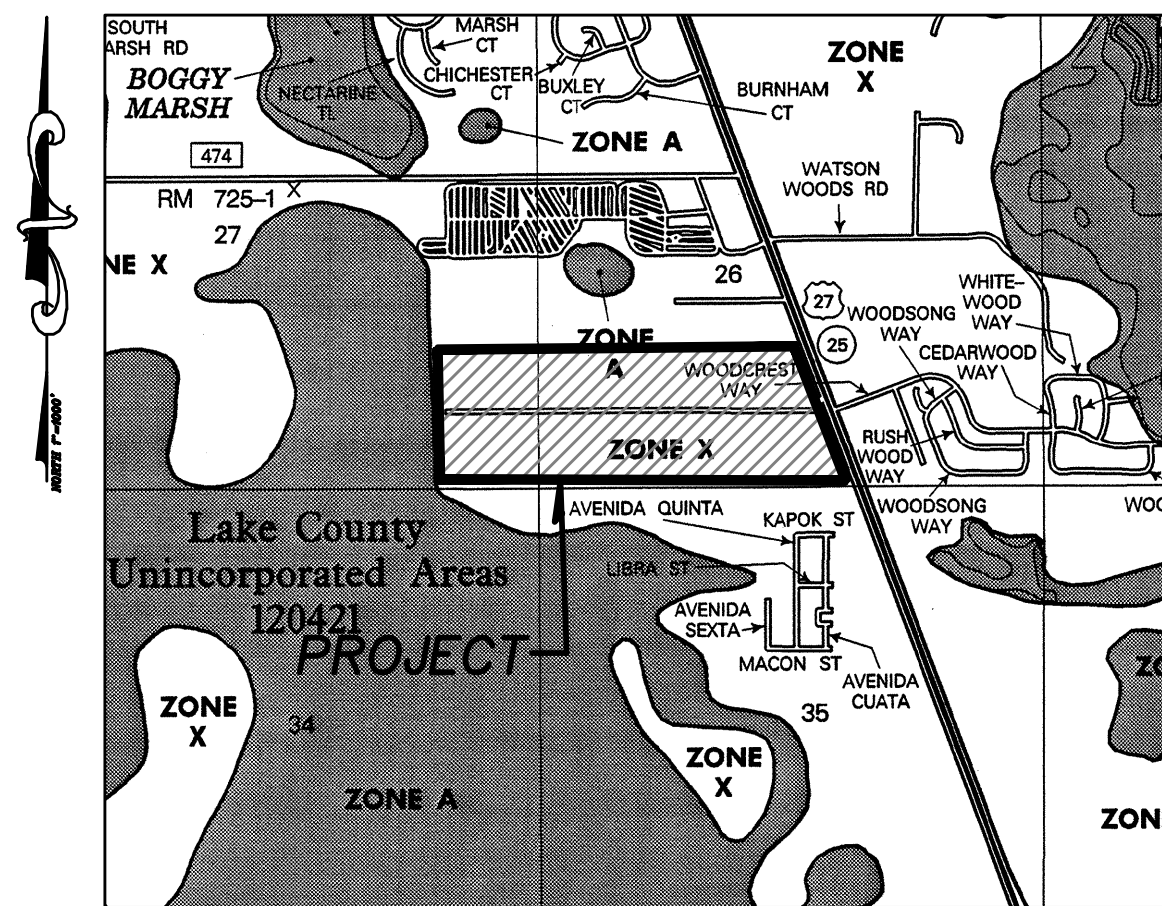

FLOOD MAP
Source
FEMA FIRM MAPS PANELS
No. 12069C0725 D
1"=2000'

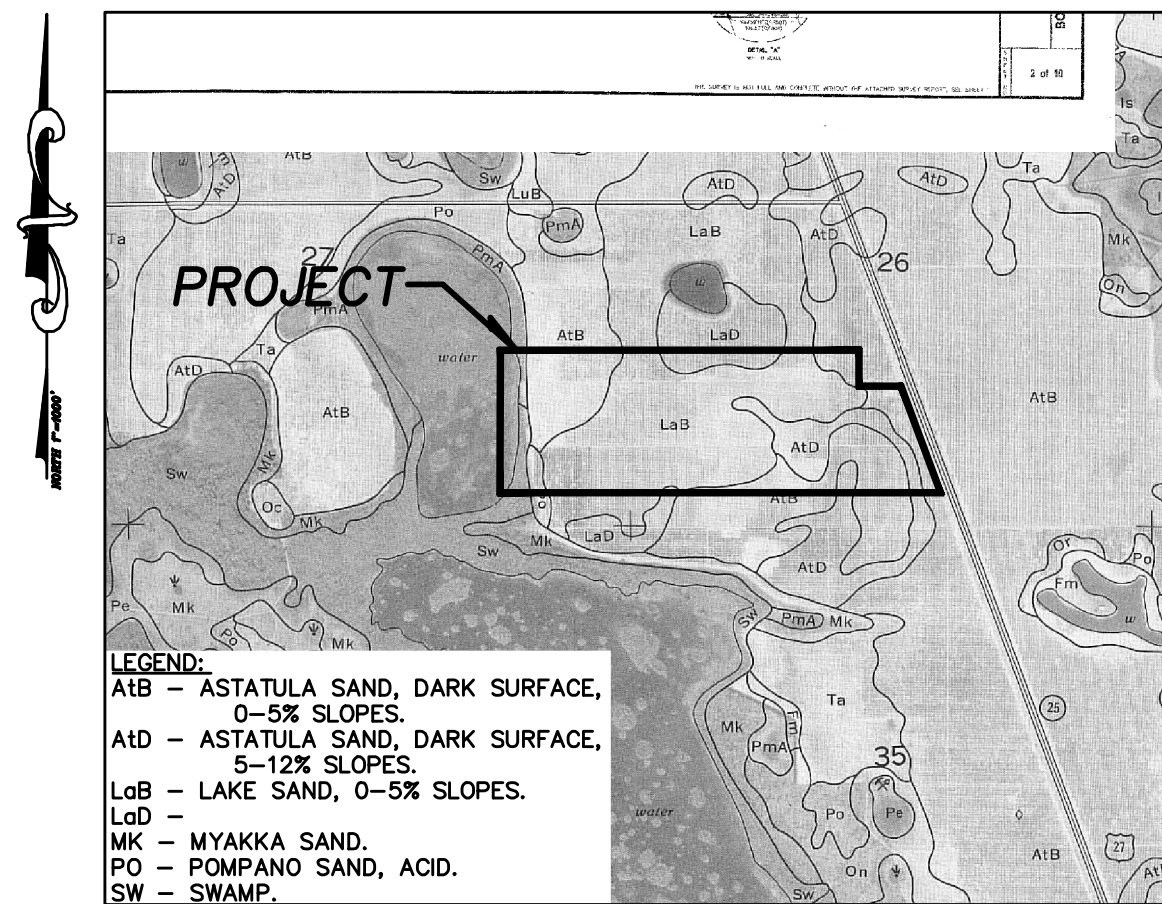

SOILS MAP
1"=2000'

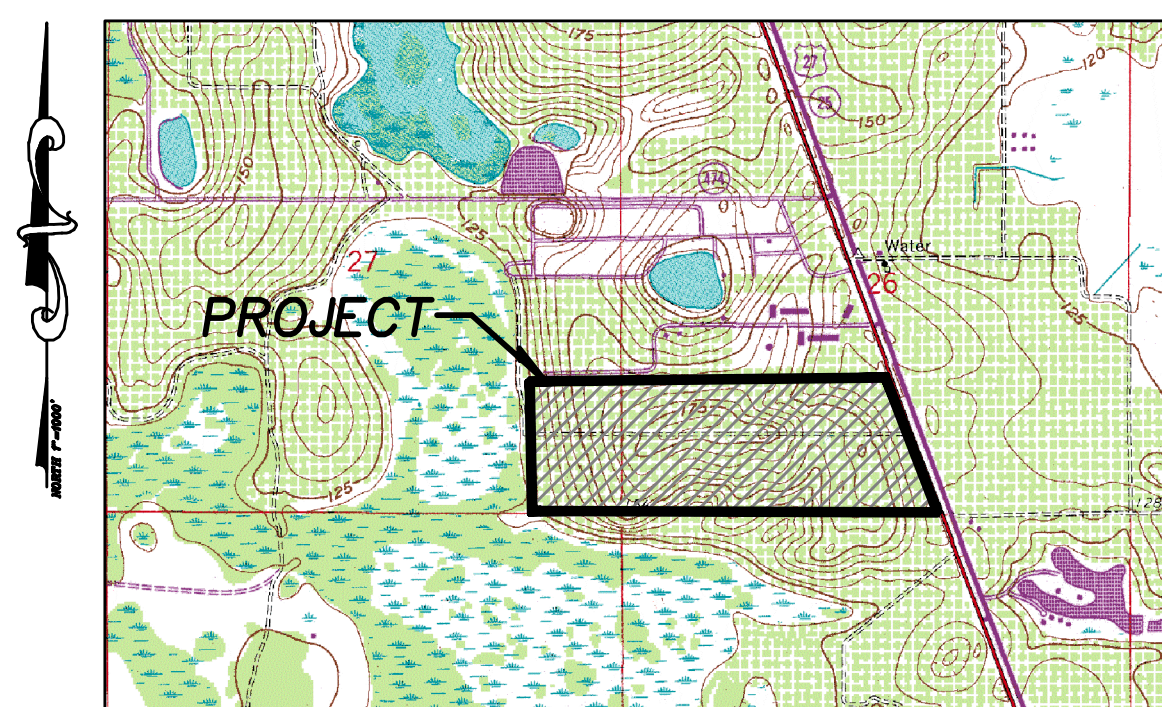

QUAD MAP
Source
LAKE LOUISA SW, FLA
1"=2000'

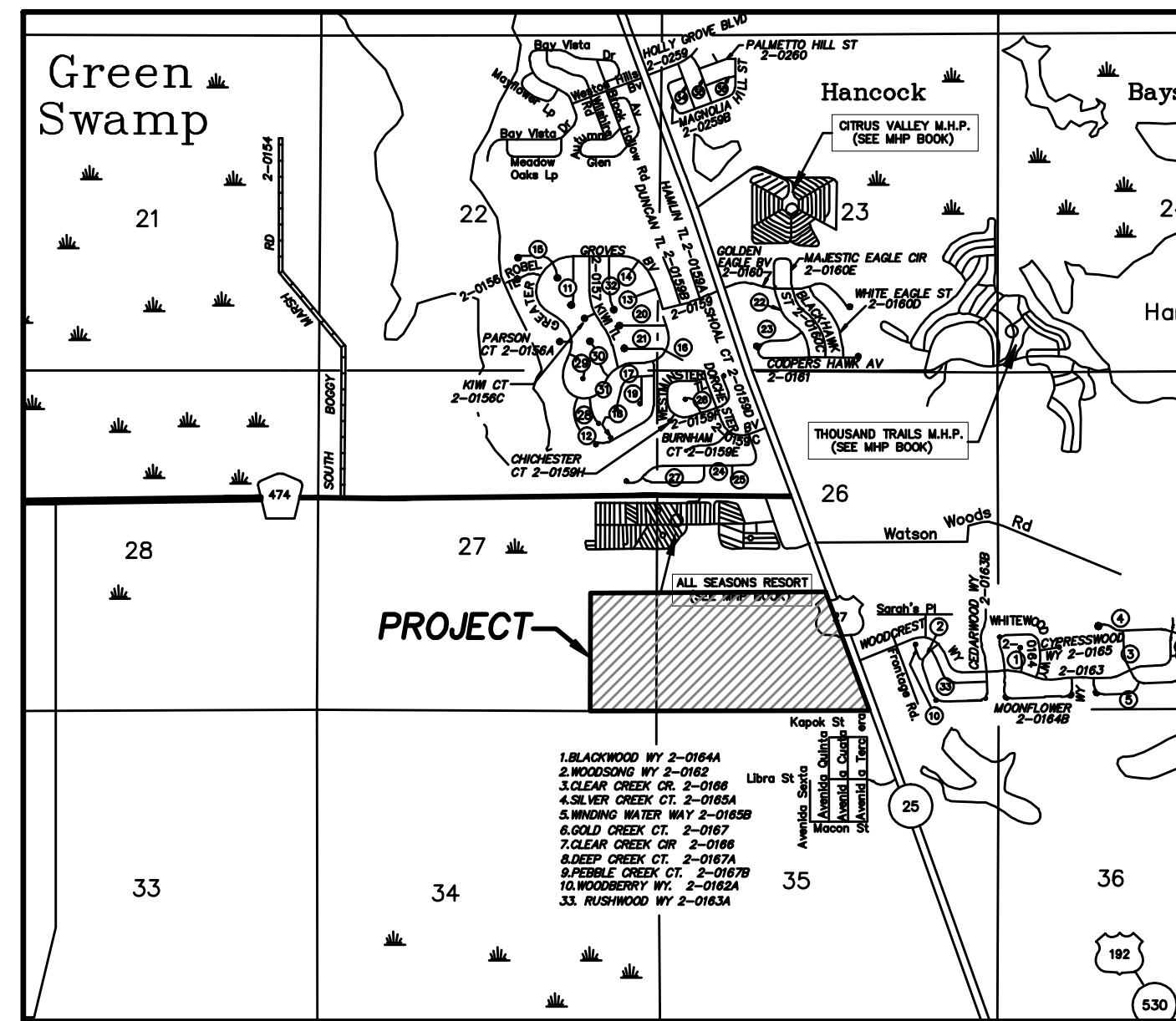

LOCATION MAP
NTS

- INDEX OF SHEETS
- 1 COVER SHEET
 - 2 EXISTING CONTOURS
 - 3 MASS GRADING PROPOSED CONTOURS

Parcel No. 1:
The North 681 feet of the South 1485 feet of the East 1/2 of the Southeast 1/4 of Section 27, Township 24 South, Range 26 East, Lake County, Florida.

Parcel No. 2:
The North 681 feet of the South 1485 feet of Section 26, Township 24 South, Range 26 East, Lake County, Florida, lying West of the right of way of U.S. Highway No. 27.

LESS and EXCEPT the following described parcels:
From the Southwest corner of Section 26, Township 24 South, Range 26 East, Lake County, Florida, run South 89°41'50" East, along the South line of said Section 26, 3386.26 feet to a point on the centerline of U.S. Highway #27, run thence along said centerline, North 20°05'20" West, 1384.28 feet; run thence North 89°41'50" West, 119.49 feet to the Point of Beginning; said Point of Beginning being on the Westerly right-of-way line of U.S. Highway #27; continue thence North 89°41'50" West, 269.69 feet; run thence North 00°18'10" East, 187.47 feet; run thence South 89°41'50" East, 200.0 feet to the aforesaid Westerly right-of-way line of U.S. Highway #27; run thence South 20°05'20" East, 200.0 feet to the Point of Beginning.

AND
From the Southwest corner of Section 26, Township 24 South, Range 26 East, Lake County, Florida, run South 89°41'50" East, along the South line of said Section 26, 3386.26 feet to a point on the centerline of U.S. Highway #27, run thence along the said centerline of U.S. Highway #27, North 20°05'20" West, 1384.28 feet; thence North 89°41'50" West, 119.49 feet to a Point of Beginning, said Point of Beginning being on the Westerly right-of-way line of the aforesaid U.S. Highway #27; run thence along said Westerly right-of-way line South 20°05'20" East, 200.0 feet; thence North 89°41'50" West, 439.38 feet; thence North 00°18'10" East, 374.93 feet; thence South 89°41'50" East, 100.00 feet; thence South 00°18'10" East, 187.47 feet; thence South 89°41'50" East, 269.69 feet to the Point of Beginning.

Parcel No. 3
That part of the South 1/4 of the Southwest 1/4 of the Southeast 1/4 lying West of the right of way of U.S. Highway No. 27; The South 1/4 of the Southeast 1/4 of the Southwest 1/4; and the South 1/4 of the Southwest 1/4 of the Southwest 1/4; Section 26, Township 24 South, Range 26 East, Lake County, Florida;

The South 1/4 of the Southeast 1/4 of the Southeast 1/4 of Section 27, Township 24 South, Range 26 East, Lake County, Florida.

Parcel No. 4
The North 494 feet of the South 824 feet of Section 26, Township 24 South, Range 26 East, Lake County, Florida, lying West of the right of way of U.S. Highway No. 27, and the North 494 feet of the South 824 feet of the Southeast 1/4 of the Southeast 1/4 of Section 27, Township 24 South, Range 26 East, Lake County, Florida.

ALSO LESS THE FOLLOWING DESCRIBED PARCEL (RaceTrac)
LEGAL DESCRIPTION: SUBJECT PARCEL

A part of Section 28, Township 24 South, Range 26 East, Lake County, Florida, being more particularly described as follows:

Commence at the Southeast corner of said Section 26; thence along the South line of said Section 26, North 89°59'11" West, a distance of 2034.49 feet, to the westerly right-of-way line of U.S. Highway 27 (State Road 25) per Florida Department of Transportation Right-of-Way Map Section 11200, for a point of beginning. Thence continue along said South line, North 89°59'11" West, a distance of 469.14 feet; thence leaving said South line, North 20°17'17" West, a distance of 1164.20 feet; thence South 89°53'15" East, a distance of 469.45 feet, to a point on the westerly right-of-way line of said U.S. Highway 27; thence along said westerly right-of-way line, South 20°17'17" East, a distance of 1183.34 feet, to the point of beginning.

Containing 11.95 acres, more or less.

Subject to:
Legal description: ingress/egress easement

A part of Section 26, Township 24 South, Range 26 East, Lake County, Florida, being more particularly described as follows:

Commence at the Southeast corner of said Section 26; thence along the South line of said Section 26, North 89°59'11" West, a distance of 2503.63 feet; thence leaving said South line, North 20°17'17" West, a distance of 635.57 feet, for a Point of Beginning; thence continue North 20°17'17" west, a distance of 75.00 feet; thence North 69°43'18" West, a distance of 440.00 feet, to the westerly right-of-way line of U.S. Highway 27 (State Road 25) per Florida Department of Transportation Right-of-Way Map Section 11200; thence along said westerly right-of-way line, South 20°17'17" East, a distance of 75.00 feet; thence leaving said westerly right-of-way line, South 69°43'18" West, a distance of 440.00 feet, to the Point of Beginning.

Containing 0.75 acres, more or less.

Total Project Acreage = 143.80 Acres

KENNETH R. WICKS, P.E. FL. REG. NO.
DATE: 33274

Wicks Engineering Services, Inc.
225 West Main Street, Tavares, Florida 32778
www.wicksengineering.com (352) 343-8667
C.A. #00062

Mr. Sheldon Rubin, Trustee
9210 Equus Circle
Boynton Beach, Florida, 33472
(561) 704-1959

Rubin Groves of Clermont
COVER SHEET
Lake County, Florida

Drawn: WSR	REVISION:	DATE:
Checked: KRW		
Date: 10-14-13		
Scale: AS SHOWN		
File No.: 09116		